



COUNTY OF SAN JOAQUIN

DEPARTMENT OF PUBLIC WORKS
P.O. BOX 1810-1810 E. HAZELTON AVENUE
STOCKTON, CALIFORNIA 95201
(209) 468-3000
FAX # (209) 468-9324

Permit No: PS-1600950
Date Issued: 04/08/2016
Start Date: 04/08/2016
Exp. Date: 05/15/2016
Project No: PWP7110005
Quad: SE

ENCROACHMENT PERMIT

To: PACIFIC GAS & ELECTRIC - SACRAMENTO
2730 GATEWAY OAKS DRIVE
SACRAMENTO, CA 95833

Encroachment Type:

Bore (up to 12 inch Dia)	Trench		
--------------------------	--------	--	--

Location:

S/S W MATHEWS RD 365' E/O BRIGHT RD

In compliance with your request of 04/08/2016, permission is hereby granted to do work in County right-of-way as shown on attached application and subject to all the terms, conditions and restrictions written below or printed as general or special provisions on any part of this form. See reverse side and attached sheet, if any.

Trench excavations for service connections will not be permitted within ten feet (10') of pavement centerline unless otherwise approved by the Director. Surface of trench patches shall match in kind and be smooth and even with that of abutting surface. Special attention shall be given to depth of utilities through roadside area in anticipation of future drainage facilities, road profile and/or frontage development. All underground utility facilities are to be established and accurately dimensioned on sketches from surveyed centerline of road right of way, or from right of way (border) lines.

~~Permittee shall call the Department of Public Works, Field Engineering Division (Permit Inspections) at (209)953-7421 at least forty-eight hours prior to beginning any work within the County right of way.~~ All work performed under this permit shall conform to the rules and regulations pertaining to safety established by the California Division of Industrial Safety and Cal-OSHA.

The jobsite shall be kept in a safe condition at all times by the daily removal of any excess dirt or debris which might be a hazard to either pedestrian or automobile traffic. All necessary traffic convenience and warning devices and personnel shall be provided, placed and maintained by and at the sole expense of the Permittee in accordance with the latest edition of the CALTRANS Manual of Traffic Control.

After completion of the work permitted herein, all debris, lumber, barricades, or any excess material shall be removed and the jobsite left in a neat workmanlike manner. ~~Immediately following completion of construction permitted herein, Permittee shall fill out and mail notice of completion (see attached post card) provided by Grantor.~~

Special Comments:

Traffic Control Per MUTCD

FORMS: SS/WW, R-29

Est. Permit Fee: \$720.25

KRIS BALAJI, Director
Department of Public Works

WHITE -Permittee
GOLDENROD -PWD Central File
YELLOW -Field Inspection
PINK -Permit Section

By: 
Permit Section

ENCROACHMENT PERMIT GENERAL PROVISIONS

13-1

1. This permit is issued under and subject to all laws and ordinances of agencies-governing the encroachment herein permitted. See the following references:
STREETS AND HIGHWAYS CODE
 1. Division 1, Chapter 3
 2. Division 2, Chapter 2, Section 942
 3. Division 2, Chapter 4, Section 1126
 4. Division 2, Chapter 5.5 and Chapter 6

SAN JOAQUIN COUNTY ORDINANCES NUMBERED: 324, 441, 648, 662, 672, 695, 700, 860, 892, 3359, and 3675.

2. It is understood and agreed by the Permittee that the performance of any work under this permit shall constitute an acceptance of all the provisions contained herein and failure on the Permittee's part to comply with any provision will be cause for revocation of this permit. Except as otherwise provided for public agencies and franchise holders, this permit is revocable on five days notice.
3. All work shall be done subject to the supervision of and the satisfaction of the grantor. The Permittee shall at all times during the progress of the work keep the County Highway in as neat and clean condition as is possible and upon completion of the work authorized herein, shall leave the County Highway in a thoroughly neat, clean and usable condition.
4. The Permittee also agrees by the acceptance of this permit to properly maintain any encroachment structure placed by the Permittee on any part of the County Highway and to immediately repair any damage to any portion of the highway, which occurs as a result of the maintenance of the said encroachment structure, until such time as the Permittee may be relieved of the responsibility for such maintenance by the County of San Joaquin.
5. The Permittee also agrees by the acceptance of this permit to make, at its own expense, such repairs as may be deemed necessary by the County Department of Public Works.
6. It is further agreed by the Permittee that whenever construction, reconstruction or maintenance work upon the highway is necessary, the installation provided for herein shall, upon request of the County Department of Public Works, be immediately moved or removed by and at the sole expense of the Permittee.
7. No material used for fill or backfill in the construction of the encroachment shall be borrowed or taken from within the County right of way.
8. All work shall be planned and carried out with as little inconvenience as possible to the traveling public. No material shall be stacked within eight feet (8') of the edge of the pavement or traveled way unless otherwise provided herein. Adequate provision shall be made for the protection of the traveling public. Traffic control standards shall be utilized including barricades; approved signs and lights; and flagmen, as required by the particular work in progress.
9. The Permittee, by the acceptance of this permit, shall assume full responsibility for all liability for personal injury or damage to property which may arise out of the work herein permitted or which may arise out of the failure of the part of the Permittee to properly perform the work provided under this permit. In the event any claim of such liability is made against the County of San Joaquin or any department, official or employee thereof, the Permittee shall defend, indemnify, and hold each of them harmless for such claim.
10. All backfill material is to be moistened as necessary and thoroughly compacted with mechanical means. If required by the County Director of Public Works, such backfill shall consist of gravel or crushed rock. The Permittee shall maintain the surface over structures placed hereunder as may be necessary to insure the return of the roadway to a completely stable condition and until relieved of such responsibility by the County Department of Public Works. Wherever a gravel, crushed rock or asphalt surface is removed or damaged in the course of work related to the permitted encroachment, such material shall either be separately stored and replaced in the roadway as nearly as possible in its original state or shall be replaced in kind, and the roadway shall be left in at least as good a condition as it was before the commencement of operations of placing the encroachment structure.
11. Whenever it becomes necessary to secure permission from abutting property owners for the proposed work, such authority must be secured by the Permittee prior to starting work.
12. The current and future safety and convenience of the traveling public shall be given every consideration in the location and methods of construction utilized.
13. The Permittee is responsible for the preservation of survey monuments located within the area of work herein permitted. Prior to the start of construction, survey monuments that potentially may be disturbed shall be located and referenced by a Licensed Land Surveyor, and a Corner Record filed with the County Surveyor. Any Survey Monuments disturbed during the course of construction shall be reestablished by a Licensed Land Surveyor and another Corner Record filed with the County Surveyor. (Land Surveyors' Act Section 8771)
14. Prior to any excavation, the Permittee shall notify USA North (Underground Service Alert of Northern California and Nevada) at 811 or 800-227-2600 forty-eight (48) hours in advance.

APPLICATION FOR ENCROACHMENT PERMIT

PLEASE PRINT:

Date 2-24-16

To: San Joaquin County
Department of Public Works

PAGE, NATALIE SWIETANSKI
(Applicant Name)

11239 MIDWAY RD.
(Mailing Address)

CHICO, CA. 95928
(City, State, Zip Code)

(530) 896-4587
(Area Code - Telephone Number)

OFFICE USE ONLY

JOB # 730052 REF # _____
APN _____ CR # _____
EXP. DATE 5-15-16
VALID 4-8-16 TO 5-15-16 DRIVEWAYS:
STREET Mathews Rd *
AREA French Camp QUAD SE *
TYPE Bore *
FORMS SSWW R29
NOTES _____

Sketch (Detailed plans may be submitted)

PLANS ATTACHED

The undersigned hereby applies for permission to excavate, construct and/or otherwise encroach on County Highway Right-of-Way on the SOUTH side of W. MATTHEWS RD. approximately 365 (feet/mile) EAST of BRIGHT RD., by performing the following work (description of work):

INSTALLATION OF (1) 4" CONDUIT BY METHOD OF DIRECTIONAL BORE AND OPEN TRENCH ACROSS W. MATTHEWS RD. (65' ±)

Work will commence on or about MARCH 28TH, 2016 for approximately 2 days.

I, the undersigned, certify that I am the owner of the respective property, or am qualified to represent the owner and agree to do the work described above in accordance with the rules and regulations of San Joaquin County and subject to inspection and approval.

John Cowan - DESIGN ENGINEER (CIVTEL INC.)
Signature of Applicant - Title

2-24-16
Date



Know what's **below**.
Call before you dig.

French Camp Fiber Entry Project

French Camp, CA

Permit Submittal

DRAWING INDEX

T-1	TITLE SHEET, SITE MAP, INDEX, CONTACTS
G-1	GENERAL NOTES & ABBREVIATIONS
C-1 to C-2	CONSTRUCTION PLAN
CD-1 to CD-2	CONSTRUCTION DETAILS
TC-1 to TC-2	TRAFFIC CONTROL PLANS

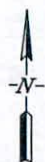

PROJECT LOCATION

LOCATION MAP
NO SCALE

**CALL BEFORE YOU DIG
UNDERGROUND SERVICE ALERT
1-800-227-2600**



3501 Sunrise Blvd
Suite 15
Rancho Cordova, CA 95742
(916) 861-2220

Rev.	Description	Date
1	SUBMITAL	3/22/10
2	RESUBMITAL	4/7/10

**TITLE
SHEET**



French Camp Fiber Entry Project

Designed By : JC	Scale : AS SHOWN
Drawn By : JC	Date : 2/22/15
Checked By : PRM	Job No. : 2015-PG17

1990s

T-4

GENERAL NOTES

1. ALL WORK SHALL COMPLY WITH APPLICABLE LOCAL AND REGULATORY AGENCIES INCLUDING, BUT NOT LIMITED TO OSHA, ETC. GENERAL NOTES SHALL APPLY TO ALL DRAWINGS.
2. EXISTING UTILITIES ARE SHOWN IN APPROXIMATE LOCATIONS. SOME EXISTING UTILITIES MAY NOT BE DEPICTED ON THIS PLAN.
3. IT WILL BE THE RESPONSIBILITY OF THE CONTRACTOR TO MAINTAIN CONSTRUCTION AS-BUILT DATA.
4. APPROXIMATE LOCATIONS OF MANHOLES, SPICE BOXES AND HANDHOLE'S ARE SHOWN ON THE PLANS. EXACT FINAL LOCATION OF SPICE BOXES AND HH'S SHALL BE DETERMINED IN THE FIELD AFTER ALL EXISTING UTILITIES IN THE AREA OF WORK HAVE BEEN LOCATED. COORDINATE FINAL SPICE BOX/HH LOCATIONS WITH PG&E.

CONSTRUCTION NOTES

1. ALL TRAFFIC CONTROL DEVICES SHALL BE IN PLACE BEFORE WORK IS STARTED. DEVICES NO LONGER REQUIRED SHALL BE REMOVED AS SOON AS POSSIBLE.
2. PEDESTRIAN TRAFFIC MUST BE MAINTAINED AT ALL TIMES. PEDESTRIANS MAY BE RELOCATED ONTO PRIVATE PROPERTY WITH OWNERS PERMISSION ONLY.
3. NO EQUIPMENT OR MATERIALS SHALL BE STORED OR PERMITTED TO STAND UNPROTECTED WHERE TRAFFIC IS MAINTAINED UNLESS IT IS ALLOWED BY LOCAL JURISDICTION IN WRITING.
4. NO EQUIPMENT OR MATERIALS SHALL BE STORED ON ROAD SURFACE DURING NON-WORKING PERIODS UNLESS IT IS ALLOWED BY LOCAL JURISDICTION IN WRITING.
5. NO EQUIPMENT OR MATERIALS SHALL BE STORED ON SIDEWALK UNLESS IT IS ALLOWED BY LOCAL JURISDICTION.
6. EXCAVATION MATERIAL SHALL BE STORED AWAY FROM THE PAVED ROADWAY WHENEVER POSSIBLE. ALL SPILLED MATERIAL IS TO BE REMOVED TO AVOID SLIPPERY CONDITIONS.
7. EXISTING SIGNS, DELINEATIONS, GUARDRAILS, MARKERS, TREES, SHRUBS, FENCES, WALKS, STEPS, ETC. THAT ARE DISTURBED BY THIS CONSTRUCTION SHALL BE REPLACED OR RESTORED TO THEIR ORIGINAL OR BETTER CONDITION.
8. CONTRACTOR SHALL VERIFY EXACT LOCATION AND ELEVATION OF ALL EXISTING UTILITIES IN AREA OF WORK PRIOR TO CONSTRUCTION. CALL UNDERGROUND SERVICE ALERT (CALIFORNIA, 1-800-227-2600) AT LEAST 48 HRS PRIOR TO START OF CONSTRUCTION ACTIVITIES.
9. CONTRACTOR SHALL HAND DIG AND USE EXTREME CARE WHEN WORKING IN CLOSE PROXIMITY TO EXISTING UTILITIES. CONTRACTOR MUST POTHOLE & EXPOSE EXISTING UTILITIES WHEN NEW CONSTRUCTION CROSSES IT.
10. TRAFFIC SIGNAL DETECTOR LOOP CIRCUITS ARE NOT SHOWN. CONTRACTOR SHALL LOCATE ALL TRAFFIC SIGNAL DETECTOR LOOP CIRCUITS PRIOR TO ANY TRENCHING OR BORING. ALL TRAFFIC LOOP DETECTOR CIRCUITS SHALL BE MAINTAINED AND PROTECTED. NOTIFY TRAFFIC DEPARTMENT 48 HOURS PRIOR TO ANY WORK IN THESE AREAS.
11. THE REMOVAL, STORAGE, AND REPLACEMENT OF ALL SHRUBBERY WILL BE THE RESPONSIBILITY OF THE CONTRACTOR OR SUBCONTRACTOR.
12. CONTRACTOR IS RESPONSIBLE TO ARRANGE A PRE-CONSTRUCTION MEETING WITH THE COUNTY INSPECTORS AT LEAST 72 HOURS BEFORE STARTING WORK.

13. BORING PITS: EXCAVATION AND RESTORATION OF BORING PITS SHALL BE IN ACCORDANCE WITH THE COUNTY STANDARDS FOR UTILITY EXCAVATIONS AND LOCATED TO THE SATISFACTION OF THE COUNTY INSPECTOR.
14. MAINTAIN 12" SEPARATION FROM PRIVATE UTILITIES. MAINTAIN 5' SEPARATION FROM WATER, SEWER AND STORM DRAIN.
15. DEPTHS OF EXISTING UTILITIES NOT REQUIRED OR AVAILABLE. LIGHT VERTICAL LINES SHOWN IN PROFILES INDICATE APPROXIMATE UTILITY LOCATION ALONG THE DUCT. THE CONTRACTOR SHALL POTHOLE TO CONFIRM EACH DEPTH.
16. THE CONTRACTOR IS RESPONSIBLE FOR THE PRESERVATION OF SURVEY MONUMENTS LOCATED WITHIN THE AREA OF WORK HEREIN PERMITTED. PRIOR TO THE START OF CONSTRUCTION, SURVEY MONUMENTS THAT POTENTIALLY MAY BE DISTURBED SHALL BE LOCATED AND REFERENCED BY A LICENSED LAND SURVEYOR, AND A CORNER RECORD FILED WITH THE COUNTY SURVEYOR. ANY SURVEY MONUMENTS DISTURBED DURING THE COURSE OF CONSTRUCTION SHALL BE REESTABLISHED BY A LICENSED LAND SURVEYOR AND ANOTHER CORNER RECORD FILED WITH THE COUNTY SURVEYOR. (LAND SURVEYORS ACT SECTION 8771)

SAFETY

1. THE CONTRACTOR IS RESPONSIBLE FOR JOB-SITE SAFETY AND SHALL BE RESPONSIBLE FOR ALL LIABILITY IMPOSED BY LAW FOR PERSONAL INJURY OR PROPERTY DAMAGE WHICH MAY ARISE OUT OF THE WORK PERFORMED UNDER THE ENCROACHMENT PERMIT, OR WHICH MAY ARISE OUT OF THE SAFETY FAILURE ON THE PART OF THE PERMITTEE TO PERFORM HIS OBLIGATIONS UNDER THIS PERMIT IN RESPECT TO MAINTENANCE OF THE ENCROACHMENT.
2. ALL TRAFFIC CONTROL SHALL CONFORM TO THE CURRENT CALIFORNIA DEPARTMENT OF TRANSPORTATION ("MANUAL OF TRAFFIC CONTROLS FOR CONSTRUCTION AND MAINTENANCE WORK ZONE") ("MANUAL OF WARNING SIGNS, LIGHTS AND DEVICES FOR USE IN PERFORMANCE OF WORK UPON HIGHWAYS").
3. ALL EXCAVATIONS SHALL CONFORM TO THE REQUIREMENTS OF THE STATE OF CALIFORNIA DIVISION OF OCCUPATIONAL SAFETY AND HEALTH. THE PERMITTEE MAY BE REQUIRED TO OBTAIN A "PERMIT TO EXCAVATE" FROM THE DIVISION OF INDUSTRIAL SAFETY, DEPARTMENT OF INDUSTRIAL RELATIONS, STATE OF CALIFORNIA.
4. CONTRACTOR SHALL FURNISH AND MAINTAIN ALL DEVICES FOR PEDESTRIAN AND VEHICULAR TRAFFIC SAFETY. UNSAFE CONDITIONS WILL BE CORRECTED BY COUNTY PERSONNEL (OR AGENTS THEREOF) AND THE PERMITTEE WILL BE BILLED FOR ALL EXPENSES INCURRED, OR COSTS SHALL BE RECOVERED FROM CASH DEPOSITS HELD FOR SUCH PURPOSES.

PROJECT CONTACTS

CIVTEL, INC. (Engineering Consultant)

PAUL MARSHALL
CIVIL ENGINEER
3501 SUNRISE BLVD., STE. 15
RANCHO CORDOVA, CA 95742

OFFICE: (916) 861-2220
MOBILE: (510) 703-0671
FAX: (916) 861-2222
EMAIL: pmarshall@civtel.com

PG&E

NATALIE SWIETANSKI

MOBILE: (530) 966-0103
EMAIL: njab@pgae.com

USA (Call before you dig service alert)

CALIFORNIA/NEVADA

OFFICE: (800) 227-2600

ABBREV.

B/C	BACK OF CURB
CB	CATCH BASIN
CATV	COMMUNITY ANTENNA TELEVISION
C/L	CENTERLINE
CNDT	CONDUIT
CONC	CONCRETE
CSW	CONCRETE SIDEWALK
D/W	DRAINAGE
EDC	EDGE OF CURB
EOP	EDGE OF PAVEMENT
FCC	FACE OF CURB
FCB	FIRE CALL BOX
FH	FIRE HYDRANT
GSP	GALVANIZED STEEL PIPE
GM	GAS METER
GV	GAS VALVE
GI	GAS INLET
HDPE	HAND HOLE
HD	HIGH DENSITY POLYETHYLENE
IC	IRRIGATION CONTROLLER
INDT	INDUCT
I/O	INDOOR/OUTDOOR
JB	JUNCTION BOX
JT	JOINT TRENCH
MH	MANHOLE
MON	CITY MONUMENT
MP	MILE POST
NTS	NOT TO SCALE
O/S	OFFSET
PED	PEDESTAL (UTIL)
PP	POWER POLE
PVC	POLY VINYL CHLORIDE
P/L	PROPERTY LINE
R/L	RUNNING LINE
R/W	RIGHT OF WAY
RR	RAILROAD
STA	STATION (0+00)
SS	SANITARY SEWER
STM MH	STORM MANHOLE
SL	STREET LIGHT
STLT HH	STREET LIGHT HANDHOLE
STS	STREET SIGN
T	TELEPHONE
TEL HH	TELEPHONE HANDHOLE
TEL MH	TELEPHONE MANHOLE
TS	TRAFFIC SIGNAL
TS SL	TRAFFIC SIGNAL STREET LIGHT
TS HH	TRAFFIC SIGNAL HANDHOLE
VNT	VENT
WH	WATER HANDHOLE
WM	WATER METER
WV	WATER VALVE

DESCRIPTION

PG&E	NEW PG&E CONDUIT
MC	EXISTING MC CONDUIT
MFS	EXISTING MFS CONDUIT
SPT	EXISTING SPRINT CONDUIT
OWT	EXISTING ONEST CONDUIT
C	EXISTING CONDUIT(S)
G	EXISTING PG&E NATURAL GAS
NZ	EXISTING AIR PRODUCTS NITROGEN MAN
SS	EXISTING SANITARY SEWER
SD	EXISTING STORM DRAIN
RCW	EXISTING RECLAIMED WATER
W	EXISTING WATER
E	EXISTING ELECTRIC
JT	EXISTING JOINT TRENCH
T	EXISTING TELEPHONE
FD	EXISTING FIBER OPTIC LINE
CTV	EXISTING CABLE TV
W/ METAL COVER	EXISTING U/E MANHOLE
S	SUBSCRIBER CONDUIT
MANHOLE	EXISTING MANHOLE
HYDRANT	EXISTING FIRE HYDRANT
POLE	EXISTING LIGHT POLE
TREE	EXIST. TREE
VALVE	WATER VALVE
ADDRESS	PROPERTY ADDRESS



CALL BEFORE YOU DIG
UNDERGROUND SERVICE ALERT
1-800-227-2600



Rev.	Description	Date
1	ADDITIONAL	2/22/16

GENERAL
NOTES



**French Camp Fiber
Entry Project**

Designed By : JC	Scale : AS SHOWN
Drawn By : JC	Date : 2/22/16
Checked By : PRM	Job No. : 2016-PG17

UWL NO.

G-1

NOTE:
CONTRACTOR TO REMOVE AND REPLACE SECTION
OF CURB, GUTTER, AND SIDEWALK PER SAN
JOAQUIN COUNTY STANDARDS AS NEEDED FOR
CONSTRUCTION

**Restore Pavement Markings,
Pavement Markers, and
Traffic Lines to Original or
Better Condition**

NOTES:

1. FOR GENERAL NOTES, ABBREVIATIONS, AND SYMBOLS SEE SHEET G-1.
2. LOCATION OF UNDERGROUND FACILITIES IS APPROXIMATE. CONTRACTOR TO U.S.A. AND POTHOLE TO VERIFY EXACT LOCATION.

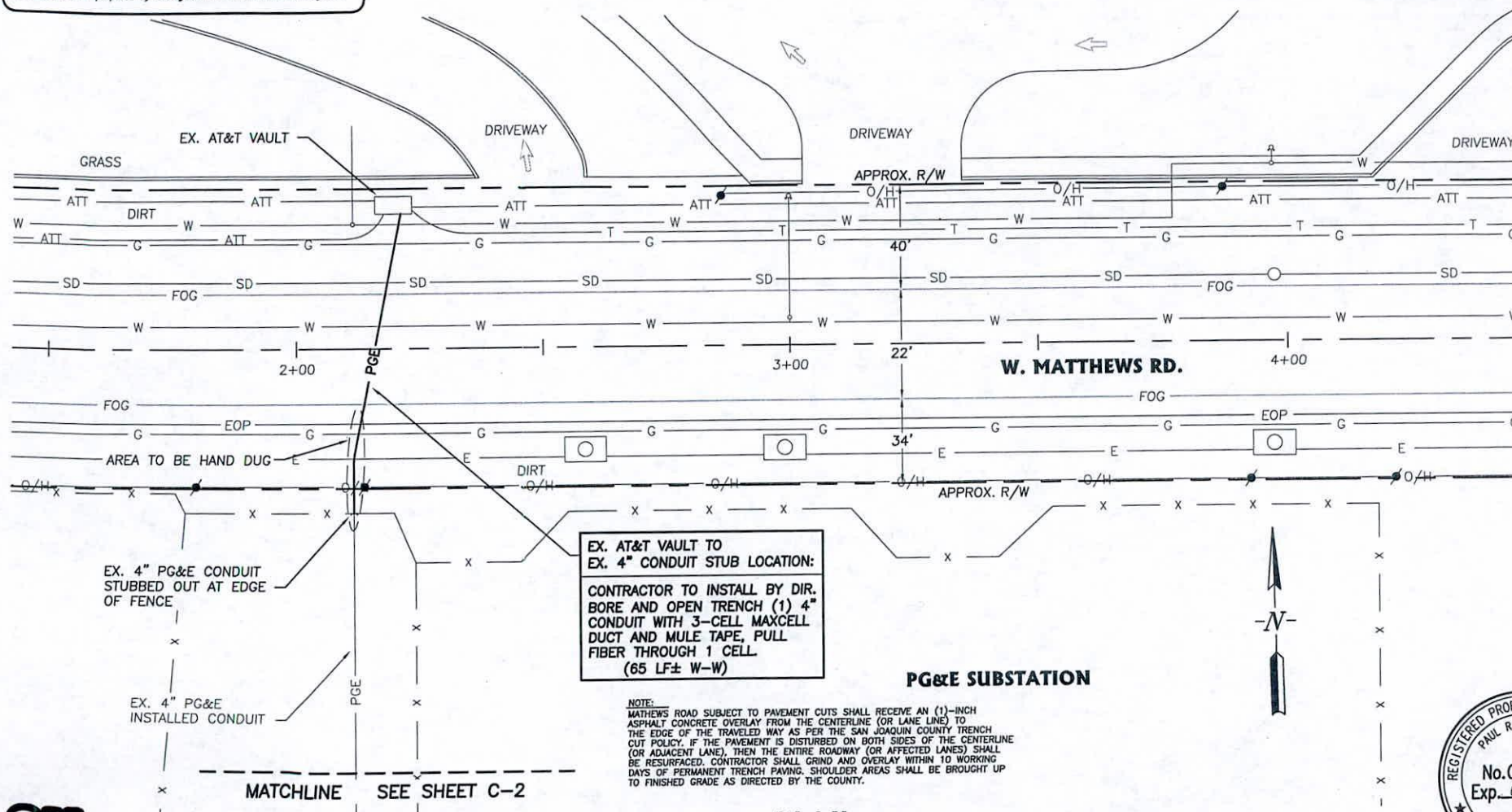

PLAN
1"=20'

10 0 10 20
1"=20'



Know what's **below.**
Call before you dig.



**Civtel
inc.**

3501 Sunrise Blvd
Suite 15
Rancho Cordova, CA 95742
(916) 861-2220

[illegible]

CONSTRUCTION PLAN



French Camp Fiber Entry Project

Designed By : JC	Scale : 1"=20'
Drawn By : JC	Date : 2/22/16
Checked By : PRM	Job No. : 2016-PCI

FIGURE NO.

C-1



The Contractor shall submit detail drawings showing design of shoring, bracing, sloping or other provisions for the safety of structures and worker, and public protection when trench excavation will exceed a depth of five feet. If such a plan varies from the shoring systems standards established by the CAL-OSHA Construction Safety Orders, the detail drawings shall be prepared by a Registered Civil or Structural Engineer.

NOTE:
CONTRACTOR TO REMOVE AND REPLACE SECTION OF CURB, GUTTER, AND SIDEWALK PER SAN JOAQUIN COUNTY STANDARDS AS NEEDED FOR CONSTRUCTION

Restore Pavement Markings,
Pavement Markers, and
Traffic Lines to Original or
Better Condition

NOTES:
1. FOR GENERAL NOTES, ABBREVIATIONS, AND SYMBOLS SEE SHEET C-1.
2. LOCATION OF UNDERGROUND FACILITIES IS APPROXIMATE. CONTRACTOR TO U.S.A. AND POTHOLE TO VERIFY EXACT LOCATION.

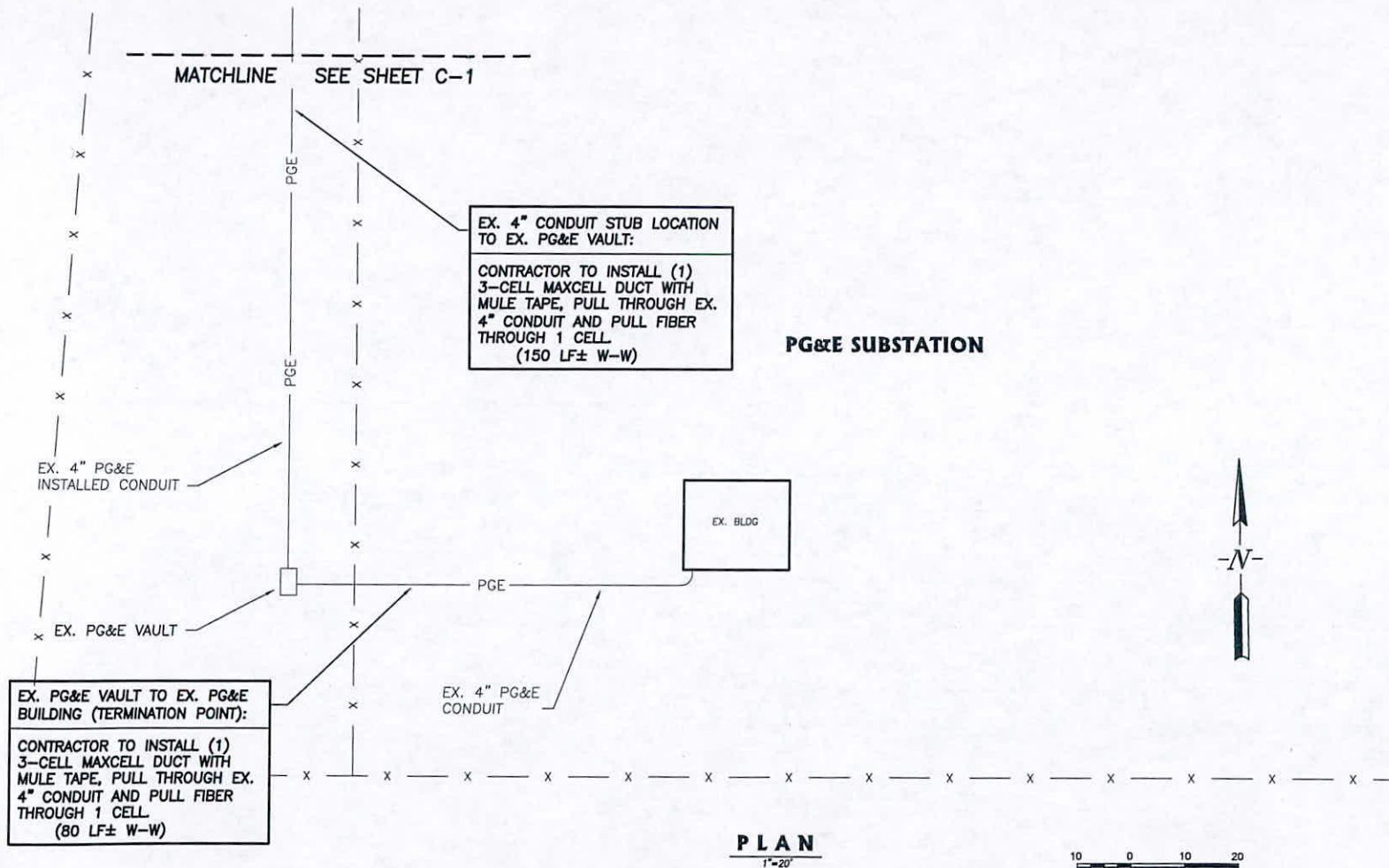

Know what's below.
Call before you dig.

Civtel Inc.
3501 Sunrise Blvd
Suite 15
Rancho Cordova, CA 95742
(916) 861-2220

Rev.	Description	Date
1	SUBMITTAL	2/22/18

CONSTRUCTION
PLAN



**French Camp Fiber
Entry Project**

Designed By: JC
Drawn By: JC
Checked By: PRM
Scale: 1"=20'
Date: 2/22/18
Job No.: 2016-PG17

DWG. NO.

C-2



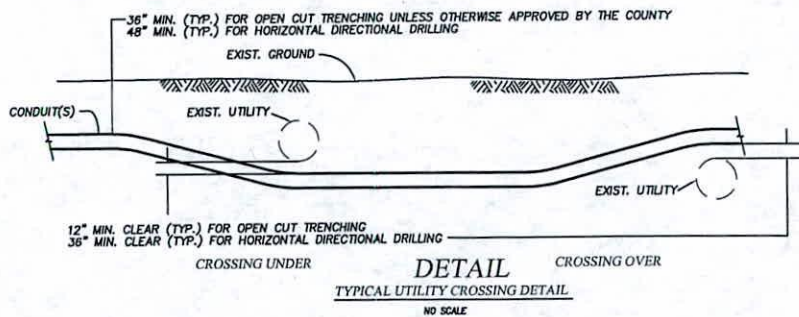

CONTROLLED DENSITY FILL

Material	Abs. Vol.
Cement (1.25 Sacks)	0.60
Flyash	0.64
Water	6.41
Sand	19.35
	27.00

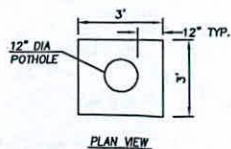
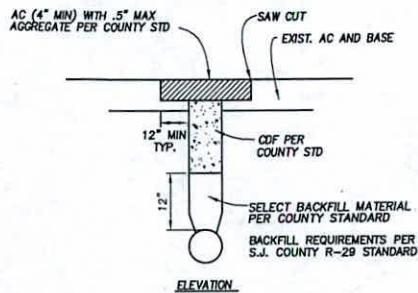

POTHOLE REPAIR DETAIL

NO SCALE



Know what's below.
Call before you dig.

NOTES:

1. FOR EXISTING PAVEMENT, SAWCUT EDGE OR USE A WHEEL TYPE GUTTER.
2. APPLY TACK COAT TO CUT EDGE OF EXISTING PAVEMENT.
3. FOR PAVED SURFACES FOR WHICH THE PERMANENT SURFACING CANNOT BE INSTALLED BEFORE RETURNING THE PAVEMENT TO USE BY THE PUBLIC, A TEMPORARY SURFACING OF 2" MIN. OF CUTBACK SHALL BE INSTALLED, FLUSH WITH THE ADJACENT PAVEMENT, UNTIL SUCH TIME AS THE PERMANENT SURFACING IS INSTALLED. TEMPORARY SURFACING SHALL BE CONSTRUCTED FLUSH WITH THE ADJACENT PAVEMENT AND SHALL BE MAINTAINED FLUSH.
4. TEMPORARY SURFACING SHALL NOT BE USED FOR MORE THAN TWO WEEKS.

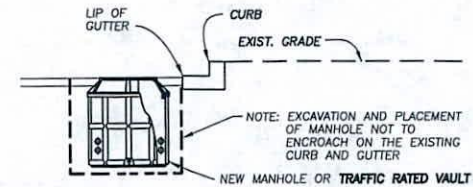

MH/HH PLACEMENT

NO SCALE

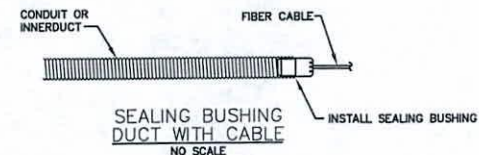
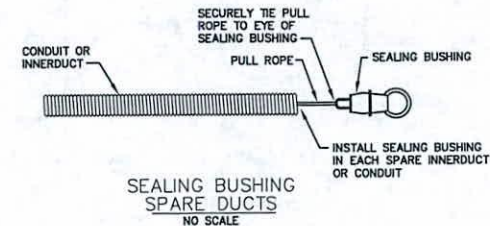

3501 Sunrise Blvd
Suite 15
Rancho Cordova, CA 95742
(916) 861-2220

Rev	Description	Date
1	ADD ADDITIONAL 8" CONDUIT	3/22/18

CONSTRUCTION

DETAILS



**French Camp Fiber
Entry Project**

Designed By : JC	Scale : NO SCALE
Drawn By : JC	Date : 2/22/16
Checked By : PRM	Job No. : 2016-PG17

DWG. NO.

CD-1

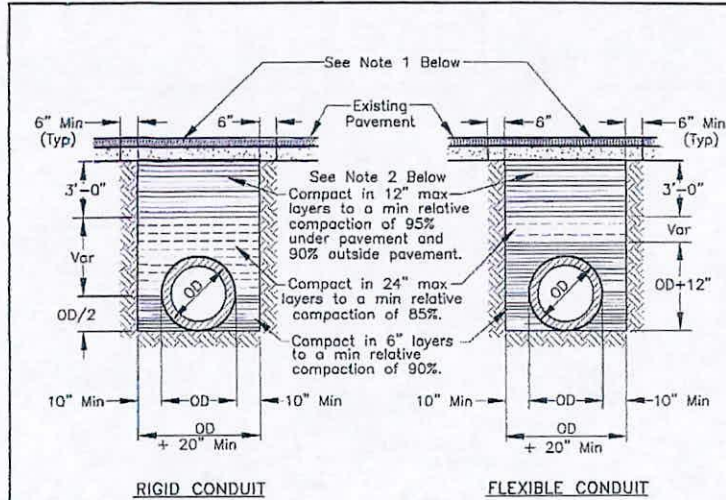

NOTES:

1. New pavement shall be 1" thicker than existing pavement, minimum of 0.25 Ft. New base shall be 1" thicker than existing base, min of 0.50 Ft.
2. Select native material or imported granular material as approved by the Director of Public Works. Backfill with materials equal to or better than the existing pavement and base in quality.
3. Relative compaction of materials shall be tested in accordance with the State of California, Dept. of Transportation Testing Manuals, test method No. California 216 or 231.
4. All existing pavement shall be neatly cut to line prior to trench excavation.
5. Jetting or ponding will be permitted within the street right-of-way with a 3 year bond, when approved by the Director of Public Works.
6. When shown by soil composition and compactability, ninety percent (90%) compaction may be used, when approved by the Director of Public Works.
7. Special bedding and backfill requirements may be shown on the plans or specified in the special provisions.



TYPICAL TRENCH BACKFILL

COUNTY OF SAN JOAQUIN
DEPARTMENT OF PUBLIC WORKS

Date: DEC 2014

Approved by:

Thomas M. Lee

No. Revision Description Date

Std. Dwg. No. **R-29**



Know what's below.
Call before you dig.



No.	Description	Date
1	ADD ADDITIONAL 8" CONDUIT	3/22/18

CONSTRUCTION

DETAILS



**French Camp Fiber
Entry Project**

Designed By:	Scale:
JC	NO SCALE
Drawn By:	Date:
JC	2/22/18
Checked By:	Job No.:
PRM	2016-PC17

DWG. NO.

CD-2

Speed S (mph)	Minimum Taper Length** for Width of Offset 12 ft (W)			
	Merging L (ft)	Shifting L/S (ft)	Shoulder L/S (ft)	Down Stream (ft)
20	80	40	27	50
25	125	63	42	50
30	180	90	60	50
35	245	123	82	50
40	320	160	107	50
45	540	270	180	50
50	800	300	200	50
55	860	330	220	50
60	720	360	240	50
65	780	390	260	50
70	840	420	280	50

* - POSTED SPEED, OFF-PEAK 85TH PERCENTILE SPEED PRIOR TO WORK STARTING, OR THE ANTICIPATED OPERATING SPEED.
 ** - FOR OTHER OFFSETS USE THE FOLLOWING MERGING TAPER LENGTH

FORMULA FOR L:
 FOR SPEEDS OF 65 KM/H (40MPH) OR LESS, $L = WSS/155$ ($L = WSS/60$)
 FOR SPEEDS OF 70 KM/H (45MPH) OR MORE, $L = WS/1.6$ ($L = WS$)

REQUIREMENTS/STANDARDS

*2012 CALIF MUTCD

WORK HOURS

9:30 AM TO 3:00 PM
 (SINGLE LANE CLOSURE ONLY)

TRAFFIC PLAN CAN BE USED
 FOR OTHER SIDE OF STREET

ROAD TYPE	DISTANCE BETWEEN SIGNS**		
	A	B	C
Urban (low speed)* 25 mph or less	30 (100)	30 (100)	30 (100)
Urban (high speed)* more than 25 mph to 40 mph	76 (250)	76 (250)	76 (250)
Urban (high speed)* more than 40 mph	100 (350)	100 (350)	100 (350)
Rural	150 (500)	150 (500)	150 (500)
Expressway / Freeway	300 (1,000)	450 (1,500)	800 (2,640)

* SPEED CATEGORY TO BE DETERMINED BY HIGHWAY AGENCY.

** DISTANCES ARE SHOWN IN METERS (FEET). THE COLUMN HEADINGS A, B, AND C ARE THE DIMENSIONS SHOWN IN FIGURES 6H-1 THROUGH 6H-4B. THE DIMENSION A IS THE DISTANCE FROM THE TRANSITION OR POINT OF RESTRICTION TO THE FIRST SIGN. THE B DIMENSION IS THE DISTANCE BETWEEN THE FIRST AND SECOND SIGNS. THE C DIMENSION IS THE DISTANCE BETWEEN THE SECOND AND THIRD SIGNS. (THE THIRD SIGN IS THE FIRST ONE IN A THREE-SIGN SERIES ENCOUNTERED BY A DRIVER APPROACHING A TTC ZONE.)

BICYCLE CONSIDERATIONS:

1. UNLESS A SEPARATE BIKE PATH THROUGH OR AROUND THE TRAFFIC CONTROL ZONE IS PROHIBITED, ADEQUATE ROADWAY LANE TO ALLOW BICYCLISTS AND MOTOR VEHICLES TO TRAVEL SIDE BY SIDE THROUGH OR AROUND THE WORK ZONE SHALL BE PROVIDED.

2. BICYCLISTS SHOULD NOT BE LED INTO DIRECT CONFLICT WITH MAINLINE TRAFFIC. WORK SITE VEHICLES, OR EQUIPMENT MOVING THROUGH OR AROUND THE TRAFFIC CONTROL ZONE.

PROVIDE PEDESTRIAN ESCORT
 AS NEEDED, AND POST PEDESTRIAN
 TRAFFIC SIGNAGE AT WORK AREA

CONTRACTOR TO MAINTAIN ACCESS TO ALL
 DRIVEWAYS & CROSSWALKS DURING THE TIME
 OF CONSTRUCTION.

CONTRACTOR TO PLACE "NO PARKING" SIGNS
 AT LEAST 24 HRS IN ADVANCE AND NOTIFY
 SAN JOAQUIN COUNTY SHERIFF'S DEPT 48 HRS
 IN ADVANCE FOR POSTING VERIFICATION

PORTABLE SIGN TYPES

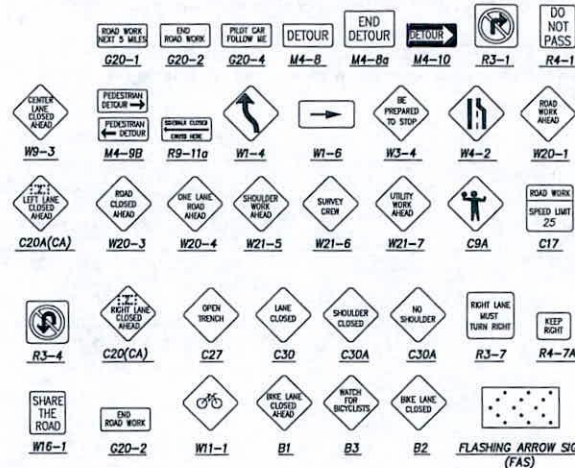

NOTES

1. All advance warning sign installations shall be equipped with flags for daytime closures.
2. Flaggers are required to control traffic whenever the contractor must interrupt traffic flow to access the work area with materials or equipment.
3. Allow access to driveways in work area.
4. All warning signs placed within work zone shall have a black legend on an orange background.
5. Cone spacing shall be:
 Tangent: 15' (4.6 M)
 Taper: 15' (4.6 M)

LEGEND

- ⊙ TRAFFIC CONE
- ↑ PORTABLE SIGN
- ▨ WORK AREA
- ⚠ FLAGGER/ RESERVE OFFICER

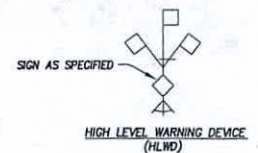

NOTE:

TRAFFIC CONTROL PER CA MUTCD

W. MATTHEWS RD.

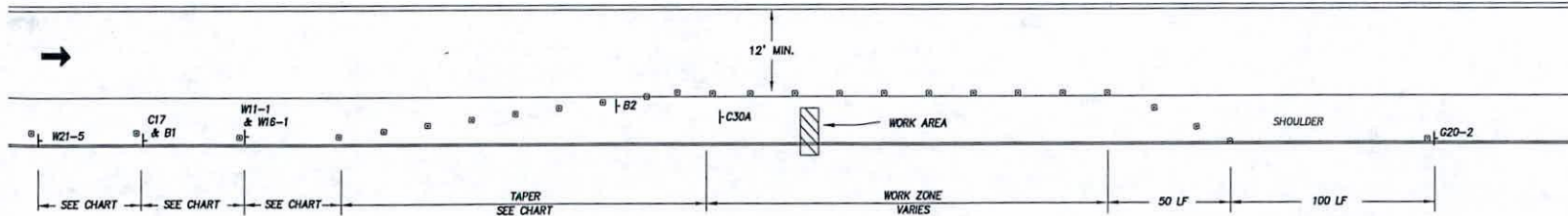

TYPICAL TRAFFIC CONTROL (SHOULDER CLOSURE)

NO SCALE



Rev	Description	Date
1	ADD ADDITIONAL "S" CONDUIT	2/22/18

TRAFFIC
 CONTROL



French Camp Fiber
Entry Project

Designed By: JC
 Drawn By: JC
 Checked By: PRM
 Scale: AS SHOWN
 Date: 2/22/18
 Job No.: 2016-PC17

DWG. NO.

TC-1



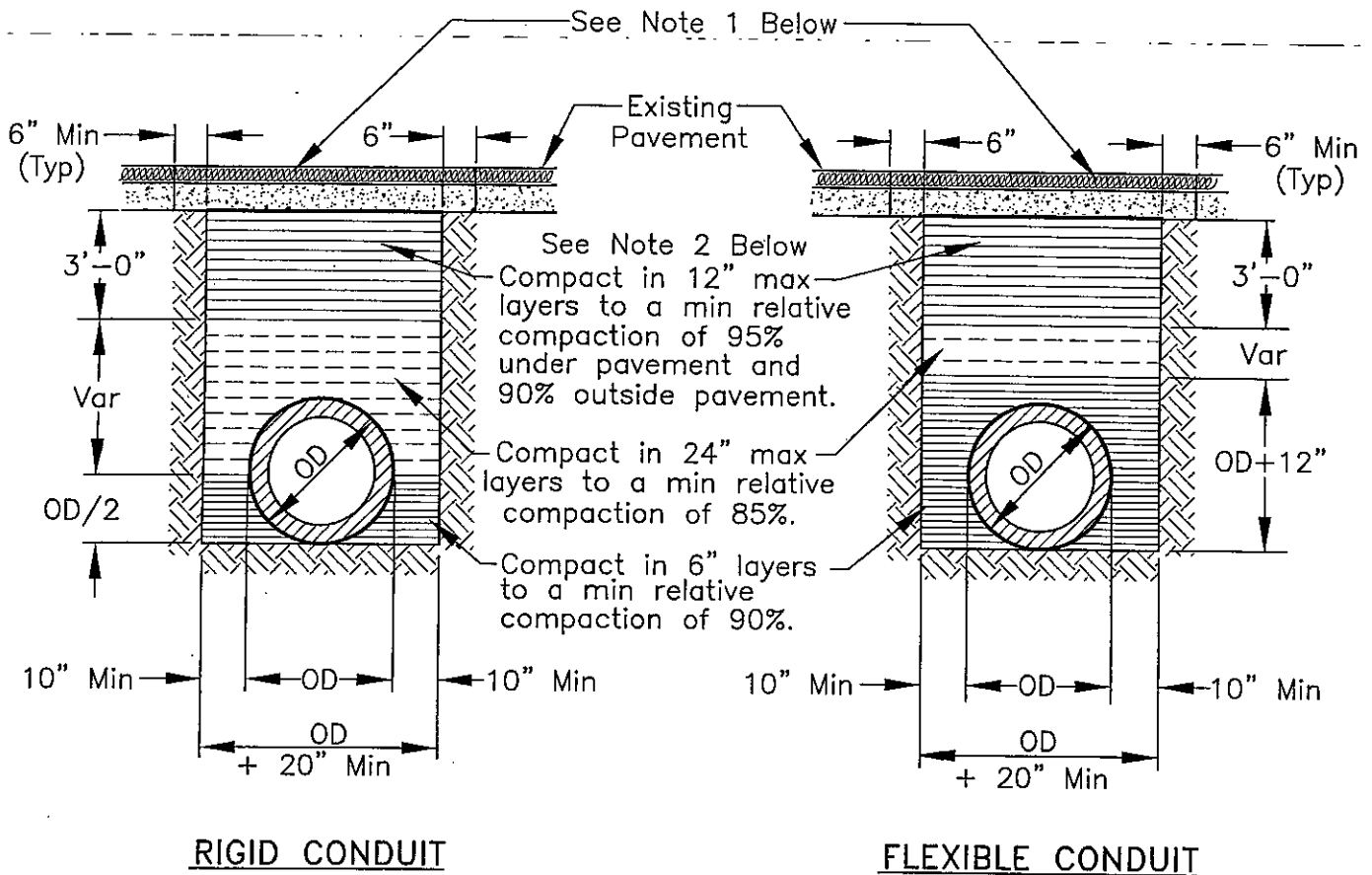

NOTES:

1. New pavement shall be 1" thicker than existing pavement, minimum of 0.25 Ft. New base shall be 1" thicker than existing base, min of 0.50 Ft.
2. Select native material or imported granular material as approved by the Director of Public Works. Backfill with materials equal to or better than the existing pavement and base in quality.
3. Relative compaction of materials shall be tested in accordance with the State of California, Dept. of Transportation Testing Manuals, test method No. California 216 or 231.
4. All existing pavement shall be neatly cut to line prior to trench excavation.
5. Jetting or ponding will be permitted within the street right-of-way with a 3 year bond, when approved by the Director of Public Works.
6. When shown by soil composition and compactability, ninety percent (90%) compaction may be used, when approved by the Director of Public Works.
7. Special bedding and backfill requirements may be shown on the plans or specified in the special provisions.

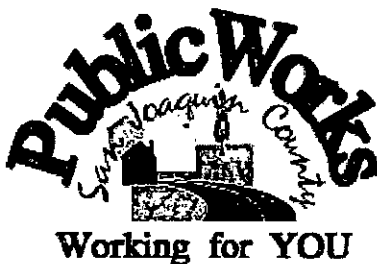

TYPCAL TRENCH BACKFILL

COUNTY OF SAN JOAQUIN
DEPARTMENT OF PUBLIC WORKS

Approved by:

No.	Revision	Description	Date

Date: DEC 2014

Std. Dwg. No.

R-29

GENERAL PROVISIONS

GOVERNING INSTALLATION OF SUBSURFACE STRUCTURES AND PIPELINES WITHIN COUNTY ROAD RIGHTS-OF-WAY

PUBLIC CONVENIENCE AND SAFETY:

- A. Before obstructing any private driveway entrance or County road traveled way with a trench, spoil bank, equipment or other barrier permitted for any prolonged period of time, the Permittee shall notify the known users of the respective thoroughfare(s) involved, and shall provide access for vehicular and pedestrian traffic to and from the road.
 - 1. Unless otherwise permitted, all work shall be conducted in such a manner that no less than one lane of the existing County road traveled way will be maintained open to public traffic during working hours in a smooth and safe riding condition(s). Two lanes shall be open after working hours.
 - 2. In cases where road closure is permitted, the permission to close the road will be granted under the condition that the Permittee notify the following persons and/or agencies of the time, the period of closure, and the detour route at least twenty-four (24) hours prior to said road closure.
 - a. The County of San Joaquin Public Works Department
 - b. The County of San Joaquin Sheriff's Office
 - c. The local postal service
 - d. The local fire district
 - e. The local school district
 - f. The local residents involved
- B. Should hazardous conditions relative to the installation operations warrant flagmen, as many capable flagmen as may be necessary shall be provided by the Permittee and stationed in advance of work to warn and direct traffic.
- C. Lights, signs and barricades shall be furnished, erected and maintained by the Permittee for the adequate warning and convenience of the public, with particular attention to be taken in this regard after dark.
- D. Any excess dirt and/or debris which might be a hazard to either automobile or pedestrian traffic, uncontrollable by lights, signs and barricades, shall be removed from the jobsite daily.

STRUCTURES:

- A. Walls of structures shall be such quality and strength that they will resist all pressures and will not crack or be deformed in such a way as to create a hazard or maintenance problem at any time. Therefore, the minimum structural requirements for concrete pipe placed under county road rights-of-way shall conform to the following American Association of State Highway and Transportation Officials (AASHTO) designations.
 - 1. For concrete pipe up to and including thirty-three inches (33") inside diameter, extra strength concrete conforming to AASHTO Designation M 170M.
 - 2. For concrete pipe thirty-six inches (36") inside diameter and larger, reinforced concrete pipe conforming to AASHTO Designation M 170M Class III.
 - 3. Plastic pipe conforming to AASHTO Designation M294.
- B. All concrete pipe joints with County road rights-of-way shall be sealed against leakage and/or infiltration with rubber gasket in conformance with Section 65-1.06 of the California Standard Specifications, or with other methods as may be permitted under the Special Provisions.
- C. Cast-in-place concrete pipe, vitrified clay pipe, spiral welded steel pipe, or corrugated aluminum alloy pipe shall not be installed within the County road rights-of-way unless specifically so stated in the Special Provisions, and only under the conditions as provided.
- D. All structures to be buried within the County rights-of-way shall be set at such elevations as to allow minimum coverage of thirty inches (30") to the centerline of the roadways and twelve inches (12") at the bottoms of borrow ditches each side of the roadways. The depths of structures shall be established below a flat plane extending across the rights-of-way, no part of which shall extend above the elevations stated above; manholes, lampholes, valves, etc. not included. Future surface elevations shall be anticipated as nearly as possible and structure elevations shall be established for future adjustments accordingly.
- E. The County hereby reserves the right to specify in the Special Provisions the gage and surface treatment of any galvanized corrugated metal pipe that is to be installed.
- F. All longitudinal utility facilities are to be established (and dimensioned on sketches) from surveyed centerline of road right-of-way, not from right-of-way (border) lines.

REPAIRS OF THE COUNTY RIGHT-OF-WAY:

- A. All excavations shall be backfilled and compacted immediately after work therein has been completed.
- B. Trenched shall not be left open farther than 300 feet in advance of pipe laying operations, or 200 feet to the rear thereof, unless otherwise permitted by the Engineer.
- C. Unless otherwise permitted under the Special Provisions, backfill shall be placed and mechanically compacted in such a manner that the relative compaction throughout the entire fill within the County road right-of-way shall conform to the percentages of compaction as shown on the Trench detail.
- D. Backfill material shall be placed in horizontal uniform layers not to exceed in thickness, before compaction, 0.67 foot in the bedding region, one foot where 90% compaction is required, and two feet where 80% compaction is required.
- E. No portion of the excavation(s) shall be compacted by ponding or jetting unless a maintenance bond is provided.
- F. Gravel backfill material shall be utilized only where specifically so stated on the face of the permit. It shall be compacted by means of a high-frequency internal vibrator, the compactor to be a size and type approved by the Engineer. Points of compaction shall not be greater than 18" centers and to the full depth of the lift.
- G. All pavements, curbs, gutters, sidewalks, borrow ditches, pipes, head walls, road signs, trees, shrubbery, and/or other permanent road facilities impaired by or as a result of construction operations at the construction site(s) occupied by materials and/or equipment, shall be restored immediately upon backfilling of the excavation to the original grades and cross sections, and to a condition as good as, or better than existing prior to construction.
- H. All surfacing materials of roadways and driveway approaches cut or damaged by or as a result of construction operations, shall be replaced within ONE WEEK following the backfilling of excavation, weather permitting, with compacted layers of surfacing materials at least as thick as the existing, and no less than two inches (2") of asphalt concrete over six inches (6") of aggregate base, both as specified below.
 - 1. Asphalt Concrete: Combined mineral aggregate shall conform to the quality and gradation requirements for Type "B" one-half inch (1/2") maximum aggregate, coarse or medium gradation as specified in Section 39 of the California Standard Specifications. The bituminous binder to be mixed with mineral aggregate shall be paving asphalt having (Grade PG 64-10), unless otherwise directed by the Engineer. Placement of asphalt concrete surfacing shall conform to the applicable provisions of Section 39 of the California Standard Specifications.
 - 2. Aggregate Base: Combined mineral aggregates shall conform to the quality and the grading for three-quarter inch (3/4") maximum size aggregate Class 2 Aggregate Base specified in Section 26 of the California Standard Specifications.
- I. Before acceptance of repairs to the County road rights-of-way, all unsightly and detrimental dirt, dust and/or debris shall be removed and the construction areas left in a neat and presentable condition(s).
 - 1. If necessary, County road traveled way and driveway pavements shall be washed with water to remove dirt and dust.
 - 2. Driveway approaches and field entrance pavements damaged by equipment or spoil banks shall be repaired as directed by the Engineer.
- J. Upon request by the County, any settlement, sagging of surface, or cracking of pavement shall be repaired immediately by and at the sole expense of the Permittee for a period of one year following acceptance of the work.

SPECIAL PROVISIONS

Winter Weather Utility Work

1. **SUPERVISION:** The utility company (permittee) shall furnish full-time supervision of all work to insure compliance with the permit provision.
2. **START OF WORK:** No work within the County right-of-way shall be started until the utility company representative has made an evaluation of weather conditions and has determined the work can be accomplished under the provisions of the permit.
3. **CLEAN PAVEMENT:** Dirt and mud shall not be deposited on the pavement outside the area of work, and if inadvertently tracked onto the road travel way shall be removed immediately.
4. **DAILY RESTORATION:** Private driveways and road intersections shall be restored daily.
5. **WEATHER-TIGHT CONDITIONS:** All trenches shall be filled and compacted, ditches and other drainage facilities regarded and opened, and the entire work area restored to weather-tight condition prior to any rain.