



SAN JOAQUIN COUNTY PERMIT PACKAGE

SITE #: 2.3 J
SITE NAME: PLEASANTON RING

WORK LOCATION:
S LAMMERS RD.
TRACY, CA

CALL BEFORE YOU DIG
UNDERGROUND SERVICE ALERT
1-800-227-2600



Know what's below.
Call before you dig.

Project Location

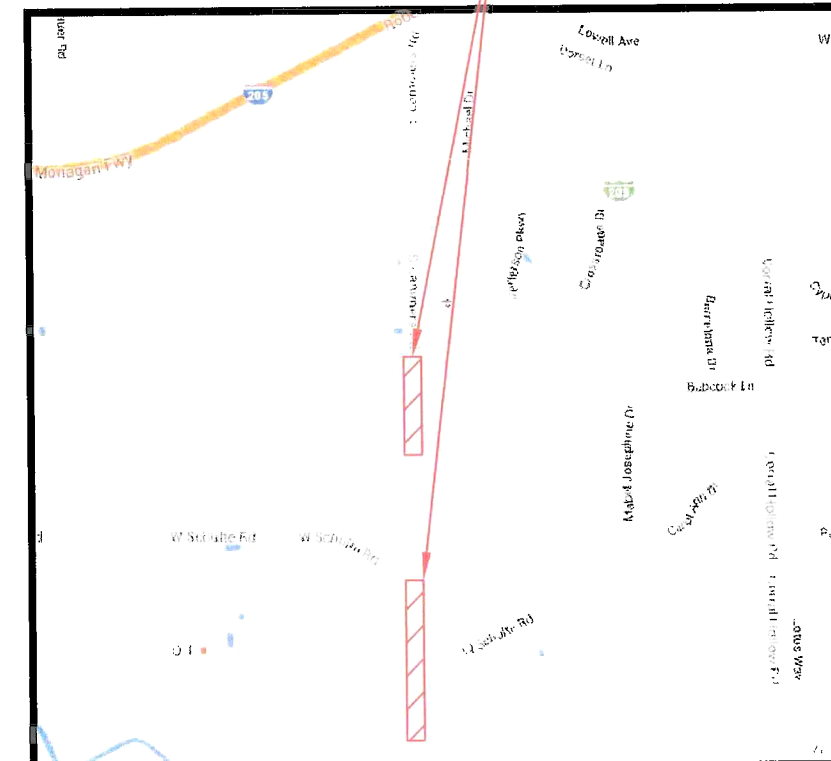

ZAYO PROJECT TEAM

Contact List:
JUSTIN MATA
PROJECT MANAGER
MOUNTAIN TOP COMMUNICATION SERV.
1902 ORANGE TREE LANE, STE. 140
REDLANDS, CA 92374
PHONE: 909-798-4400

JAMES SMALL
PROJECT MANAGER
ZAYO GROUP
2700 MERCED ST
SAN LEANDRO CA 94577
PHONE: 916-207-3637

SHEET INDEX	
P-CS	Permit Cover Sheet
GN	General Notes
OM	Overview Map
CD-LD	Construction Legend
CD-D1/CD-D2	Construction Details
CD-01	Construction Design
TC-LD	TCP Legend/Gen. Notes
TC-KM	Traffic Control Key Map
TC-01/TC-06	Traffic Control Layout

MATERIALS	UNIT	TOTAL
Bore	LF	0
Trench	LF	469
Asphalt Rem/Rep	SF	0
S/W Rem/Rep	SF	0
UTILITY NOTE: THE UTILITY LOCATIONS SHOWN HEREON ARE APPROXIMATE IN LOCATION AND SIZE. THE CONTRACTOR ASSUMES ALL RESPONSIBILITY IN VERIFYING THE EXACT LOCATION/DEPTH OF ALL EXISTING UTILITIES.		

PROJECT OWNER & ADDRESS

ZAYO GROUP
2700 MERCED ST
SAN LEANDRO, CA. 94577

PROJECT NAME & ADDRESS

SITE #: 2.3 J
SITE NAME: PLEASANTON RING
S LAMMERS ROAD
TRACY, CA
95377

SHEET DESCRIPTION:

PERMIT PACKAGE COVER SHEET

DATE: 11/12/2015

SCALE: AS SHOWN

SHEET

P-CS

GENERAL NOTES

GENERAL NOTES

1. ALL MATERIALS AND WORKMANSHIP SHALL CONFORM TO THE CITY'S STANDARD DETAILS, TECHNICAL SPECIFICATIONS, AND GENERAL REQUIREMENTS.

2. CONTRACTOR SHALL SECURE A ENCROACHMENT PERMIT FROM THE CITY ENGINEERING DEPT. AND PAY APPROPRIATE FEE PRIOR TO COMMENCEMENT OF WORK. ALL WORK WITHIN THE PUBLIC RIGHT OF WAY SHALL BE DONE UNDER AN ENCROACHMENT PERMIT.

3. IT IS THE CONTRACTORS RESPONSIBILITY TO VERIFY THE LOCATION OF ALL EXISTING UTILITIES WITH THE APPROPRIATE UTILITY AGENCIES PRIOR TO THE COMMENCEMENT OF CONSTRUCTION. CONTRACTOR SHALL NOTIFY ALL PUBLIC & PRIVATE UTILITY OWNERS 48 HOURS PRIOR TO COMMENCEMENT OF WORK ADJACENT TO THE UTILITY. CONTACT UNDERGROUND SERVICE ALERT (USA) AT 800-642-2444.

4. ALL SIDEWALK, CURB, AND GUTTER SHALL BE REMOVED AND REPLACED TO THE NEAREST SCORE MARK OR AS DIRECTED BY THE ENGINEER. INSTALLATION OF NEW SIDEWALK, CURB & GUTTER AGAINST EXISTING IMPROVEMENTS SHALL REQUIRE A SIDEWALK CONTACT JOINT (DOWELS REQUIRED).

5. UNLESS OTHERWISE DIRECTED BY THE CITY ENGINEER IN THE FIELD: AT EACH LOCATION WHERE NEW CURB/GUTTER IS TO BE INSTALLED ON AN EXISTING STREET (DRIVEWAY INSTALLATION, DRIVEWAY ABANDONMENT, CURB RAMP INSTALLATION, CURB FACE DRAINAGE INSTALLATION, ETC.) PAVEMENT RECONSTRUCTION SHALL BE REQUIRED. AN 18" WIDE BAND OF PAVEMENT SHALL BE REMOVED AND REPLACED ALONG THE ENTIRE LENGTH OF CURB/GUTTER INSTALLATION. REMOVAL DEPTH (SAW CUTS REQUIRED) SHALL BE TO THE BASE MATERIAL ON STREETS WITH A.C. OR P.C.C. PAVEMENT FOUR (4) INCHES OR LESS IN THICKNESS. REMOVAL DEPTH SHALL BE TWO INCHES MINIMUM ON STREETS WITH A.C. (GRIND) / P.C.C. (SAW CUT) PAVEMENT THICKNESS GREATER THAN FOUR (4) INCHES. REPLACE WITH A.C. PAVEMENT.

6. BLACK SAND SLURRY SEAL SHALL BE REQUIRED ON ALL NEW STREET PAVEMENT FOR TRENCH WORK, POTHOLES, AND STREET WIDENINGS. SLURRY SEAL SHALL EXTEND 12" BEYOND THE LIMIT OF PAVEMENT RECONSTRUCTION.

7. THE CONTRACTOR SHALL NOTIFY, BY CIRCULAR, ALL BUSINESS ESTABLISHMENTS & RESIDENCES LOCATED IN AREAS AFFECTED BY THE WORK AT LEAST (48) HOURS PRIOR TO START OF CONSTRUCTION. CIRCULAR SHALL BE SUBJECT TO THE APPROVAL OF THE CITY ENGINEER.

8. ALL MANHOLES, VALVE BOXES, MONUMENT BOXES, AND OTHER STRUCTURES IN THE PAVEMENT AREA SHALL BE ADJUSTED TO FINISH GRADE BEFORE PAVING FINAL LIFT.

9. GRADE BREAKS ON CURBS AND SIDEWALKS ARE TO BE ROUNDED OFF ON FORM WORK & FINISHED SURFACING.

10. IT IS THE CONTRACTORS RESPONSIBILITY TO REPLACE ALL STREET MONUMENTS OR LOT CORNER PIPES DISTURBED DURING THE PROCESS OF CONSTRUCTION. IF A STREET MONUMENT HAS THE POTENTIAL OF BEING DISTURBED, A CORNER RECORD SHALL BE FILED WITH GOVERNING CITY/COUNTY SURVEYOR (PER SECTION 8773.2 OF THE PUBLIC LAND SURVEYORS ACT) AS REQUIRED BY THE SUBDIVISION MAP ACT TO PRESERVE THE LOCATION OF SAID STREET MONUMENT. CONTRACTOR SHALL, AT HIS/HER EXPENSE, HIRE A CIVIL ENGINEER OR LAND SURVEYOR TO PERFORM THE WORK.

11. ALL SURPLUS & UNSUITABLE MATERIAL SHALL BE REMOVED FROM PUBLIC RIGHT OF WAY.

12. CONTRACTOR SHALL PROVIDE ADEQUATE DUST CONTROL & KEEP MUD & DEBRIS OFF THE PUBLIC RIGHT OF WAY AT ALL TIMES.

13. ALL TRENCHES & EXCAVATIONS SHALL BE CONSTRUCTED IN STRICT COMPLIANCE WITH THE APPLICABLE SECTIONS OF CALIF. & FEDERAL O.S.H.A. REQUIREMENTS & OTHER APPLICABLE SAFETY ORDINANCES. CONTRACTOR SHALL BEAR FULL RESPONSIBILITY FOR TRENCH SHORING DESIGN & INSTALLATION.

14. EXISTING UTILITIES SHOWN ARE BASED UPON RECORD INFORMATION & ARE APPROXIMATE IN LOCATION & DEPTH. THE CONTRACTOR SHALL POTHOLE ALL EXISTING UTILITIES THAT MAY BE AFFECTED BY NEW FACILITIES IN THIS CONTRACT, VERIFY ACTUAL LOCATION & DEPTH, & REPORT POTENTIAL CONFLICTS TO THE ENGINEER PRIOR TO EXCAVATING FOR NEW FACILITIES.

15. THE CONTRACTOR SHALL POTHOLE ALL EXISTING UTILITIES THAT MAY BE ALLOW HARMFUL POLLUTANTS TO ENTER THE STORM DRAIN SYSTEM. TO ENSURE COMPLIANCE, THE CONTRACTOR SHALL IMPLEMENT THE APPROPRIATE BEST MANAGEMENT PRACTICE (BMP) AS OUTLINED IN THE BROCHURES ENTITLED "BEST MANAGEMENT PRACTICE FOR THE CONSTRUCTION INDUSTRY" ISSUED BY THE MARIN COUNTY VALLEY NONPOINT SOURCE POLLUTION CONTROL PROGRAM, TO SUIT THE CONSTRUCTION SITE & JOB CONDITION.

16. OVERNIGHT PARKING OF CONSTRUCTION EQUIPMENT IN THE PUBLIC RIGHT OF WAY SHALL NOT BE PERMITTED, EXCEPT AT LOCATION(S) APPROVED BY THE CITY TRAFFIC ENGINEER.

17. UNLESS OTHERWISE NOTED, CLASS 2 A.B. UNDER CURB, GUTTER, & STREET SECTIONS PAVED WITH ASPHALT CONCRETE SHALL BE COMPACTED TO 95% RELATIVE COMPACTION (MINIMUM).

18. ALL TRAFFIC CONTROL DEVICES SHALL BE IN PLACE BEFORE WORK IS STARTED. DEVICES NO LONGER REQUIRED SHALL BE REMOVED AS SOON AS POSSIBLE.

19. PEDESTRIAN TRAFFIC MUST BE MAINTAINED AT ALL TIMES. PEDESTRIANS MAY BE RELOCATED ONTO PRIVATE PROPERTY WITH OWNERS PERMISSION ONLY.

20. NO EQUIPMENT OR MATERIALS SHALL BE STORED OR PERMITTED TO STAND UNPROTECTED WHERE TRAFFIC IS MAINTAINED UNLESS IT IS ALLOWED BY THE CITY ENGINEER IN WRITING.

21. NO EQUIPMENT OR MATERIALS SHALL BE STORED ON ROAD SURFACE DURING NON-WORKING PERIODS UNLESS IT IS ALLOWED BY CITY ENGINEER IN WRITING.

22. NO EQUIPMENT OR MATERIALS SHALL BE STORED ON SIDEWALK AT ANYTIME.

23. EXCAVATION MATERIALS SHALL BE STORED AWAY FROM THE PAVED ROADWAY WHENEVER POSSIBLE. ALL SPILLED MATERIAL IS TO BE REMOVED TO AVOID SLIPPERY CONDITIONS.

24. EXISTING SIGNS, DELINEATIONS, GUARDRAILS, MARKERS, TREES, SHRUBS, FENCES, WALKS, STEPS, ETC. THAT ARE DISTURBED BY THIS CONSTRUCTION SHALL BE REPLACED OR RESTORED TO THEIR ORIGINAL CONDITION OR TO THE SATISFACTION OF THE ADJACENT PROPERTY OWNERS AND THE GOVERNING CITY/COUNTY AGENCY.

CONSTRUCTION NOTES

1. THE METHOD OF CONSTRUCTION SHALL BE BY HORIZONTAL BORING UNLESS OTHERWISE APPROVED BY THE CITY.

2. (1)4" PVC W/(3) 1.25" INDT. SHALL BE INSTALLED ON ALL OPEN TRENCHING UNLESS SHOWN OTHERWISE.

3. EXISTING UTILITIES ARE SHOWN IN APPROXIMATE LOCATIONS ONLY. NOT ALL EXISTING UTILITIES ARE SHOWN ON THIS PLAN. THE CONTRACTOR SHALL FIELD VERIFY DEPTH AND LOCATION OF ALL UTILITIES BY EXPOSING UTILITY CROSSINGS PRIOR TO DIRECTIONAL BORING. THE CONTRACTOR SHALL USE HAND TOOLS AND EXTREME CARE WHEN WORKING IN CLOSE PROXIMITY TO EXISTING UTILITIES.

4. FOR OPEN CUT TRENCHING THE FOLLOWING MINIMUM CLEARANCES SHALL APPLY: A 12" VERTICAL CLEARANCE AT ALL CROSSINGS SHALL BE MAINTAINED BETWEEN PROPOSED CONDUITS AND OTHER EXISTING UTILITIES. A 8' MINIMUM HORIZONTAL CLEARANCE SHALL BE MAINTAINED BETWEEN PROPOSED CONDUITS AND EXISTING SANITARY SEWER AND STORM DRAIN MAINS THAT RUN PARALLEL, UNLESS APPROVED BY THE CITY. THE CONTRACTOR SHALL MAINTAIN A MINIMUM OF 5' HORIZONTAL CLEARANCE FOR ALL OTHER UTILITIES UNLESS OTHERWISE APPROVED BY THE CITY, EXCEPT WHEN AT THE SAME ELEVATION AS WATER MAINS, 8' HORIZONTAL CLEARANCE SHALL BE MAINTAINED UNLESS OTHERWISE APPROVED BY THE CITY. CLEARANCES ALSO APPLY TO FIRE HYDRANTS.

5. THE FOLLOWING MINIMUM CLEARANCES (FROM REAMED PERIMETER OF THE BORE HOLE TO THE OUTER PERIMETER OF THE UTILITY) SHALL BE USED AS A GUIDELINE. THE GEOTECHNICAL REPORT CONCLUSIONS & RECOMMENDATIONS OR THE CITY'S DETERMINATION SHALL BE FOLLOWED, IF MORE RESTRICTIVE.

(A) LOCATE HDD 8 FT. CLEAR (HORIZONTALLY) FROM THE EXISTING STORM DRAIN & SANITARY SEWER MAINS, EXCEPT WHEN AT THE SAME ELEVATION AS WATER MAINS, 8 FT. HORIZONTAL CLEARANCE SHALL BE MAINTAINED. MINIMUM OF 5 FT. HORIZONTAL CLEARANCE SHALL BE MAINTAINED FROM FIRE HYDRANTS, ELECTRICAL, GAS, ETC.). CROSSING SHALL BE AT 90-DEGREE.

(B) USE THE FOLLOWING CHART FOR MINIMUM DEPTH OF COVER (IN THE PAVEMENT & SIDEWALK AREAS) & MINIMUM CLEARANCE WHEN CROSSING UTILITIES (STORM DRAIN, SANITARY SEWER, WATER, ELECTRICAL CONDUITS, BOXES, & VAULTS).

BORE DIAMETER	Min. DEPTH OF COVER	Min. CLEARANCE FROM CROSSING UTILITIES
6" OR LESS	4'	3'
14" OR LESS	6'	5'
24" OR LESS	10'	7'
48" OR LESS	25'	15'

6. AT THE END OF EACH DAY, CONDUIT CAPS SHALL BE PLACED ON ALL VACANT DUCTS. DUCT IN BUILDING ENTRANCES, NEW OR EXISTING SHALL BE SEALED PRIOR AND AFTER PLACEMENT OF FIBER OPTIC CABLE IS COMPLETED, INCLUDING DUCTS ON WALL WHERE CORING IS REQUIRED.

7. THE REMOVAL, STORAGE, AND REPLACEMENT OF ALL SHRUBBERY SHALL BE THE RESPONSIBILITY OF CONTRACTOR. ALL LANDSCAPING SHALL BE RESTORED TO ORIGINAL OR BETTER CONDITIONS.

8. TRAFFIC SIGNAL CIRCUITS AND INTERCONNECT CONDUITS MAY NOT BE SHOWN. CONTRACTOR SHALL LOCATE ALL TRAFFIC SIGNAL CIRCUITS AND INTERCONNECT CONDUITS PRIOR TO ANY TRENCHING OR BORING. PROVIDE 3' SEPARATION BETWEEN NEW CONDUITS AND ALL TRAFFIC SIGNAL AND INTERCONNECT CONDUITS AND 5' FROM ALL TRAFFIC SIGNAL CONTROLLERS AND PULL BOXES. ALL TRAFFIC SIGNAL AND INTERCONNECT CONDUITS SHALL BE MAINTAINED AND PROTECTED. LOOPS OR CONDUITS DAMAGED SHALL BE REPLACED BY THE CONTRACTOR TO CITY SPECIFICATIONS. NOTIFY CITY INSPECTOR IMMEDIATELY AND TRAFFIC DEPARTMENT 48 HOURS PRIOR TO ANY WORK IN THESE AREAS.

9. APPROXIMATE LOCATIONS OF SPLICE BOXES ARE SHOWN ON THE PLANS. EXACT FINAL LOCATION OF SPLICE BOXES SHALL BE DETERMINED IN THE FIELD WITH CITY APPROVAL AFTER ALL EXISTING UTILITIES IN THE AREA OF WORK HAVE BEEN LOCATED.

10. TOPS OF SPLICE BOXES SHALL BE SET FOR FUTURE SIDEWALK INSTALLATION IN SPECIFIED LOCATIONS. ALL SPLICE BOXES SHALL BE PLACED WITH PEDESTRIAN TRAFFIC SAFETY IN MIND UNTIL ALL WORK IS COMPLETE.

11. THE CITY WATER DEPARTMENT SHALL BE NOTIFIED A MINIMUM OF 24 HOURS PRIOR TO POT HOLING ANY CITY WATER OR RECLAIMED WATER MAINS OR SERVICES.

CITY ARBORIST NOTES:

1. NO TRENCHING SHALL BE DONE WITHIN THE DRIPLINE OF EXISTING TREES WITHOUT THE APPROVAL OF THE CITY ARBORIST. OPEN TRENCHING IN THE ROOT ZONE OF A PUBLIC TREE IS PROHIBITED EXCEPT IN CASES WHERE THE TRENCHING FALLS OUTSIDE THE TREE INVOLVED. EXCEPTIONS WILL BE ALLOWED IF, IN THE OPINION OF THE CITY ARBORIST, THE IMPACT OF TRENCHING UPON THE TREE WILL BE NEGLIGIBLE.

2. NO CUTTING OF ANY PART OF CITY TREES, INCLUDING ROOTS SHALL BE DONE WITHOUT SECURING APPROVAL AND DIRECT SUPERVISION FROM THE CITY ARBORIST.

3. NO CUTTING OF ANY PART OF PRIVATE TREES, INCLUDING ROOTS, SHALL BE DONE WITHOUT SECURING SUPERVISION OF A CERTIFIED ARBORIST (CERTIFICATION OF INTERNATIONAL SOCIETY OF ABORICULTURE).

4. BORE OUTSIDE THE DRIPLINE OF ALL TREES TO PREVENT ROOT DAMAGE. NO BORE PITS ARE ALLOWED WITHIN THE DRIPLINE OF ANY EXISTING TREE.

5. TUNNELING: ALL PUBLIC TREES IN EXCESS OF 5" DBH, WHERE THERE IS INSUFFICIENT SPACE TO BYPASS THE DRIPLINE BY TRENCHING, MUST BE TUNNELED. THE BEGINNING/ ENDING DISTANCE OF THE TUNNEL FROM THE FACE OF THE TREE IN ANY DIRECTION IS DETERMINED BY THE DIAMETER OF THE TREE AS SPECIFIED BY THE ACCOMPANYING TABLE:

WHEN THE TREE DIAMETER AT 4.5 FEET IS:	TRENCHING WILL BE REPLACED BY TUNNELING AT THIS MIN. DISTANCE FROM THE FACE OF THE TREE IN ANY DIRECTION:
6"-9"	5 FEET
10"-14"	10 FEET
15"-19"	12 FEET
OVER 19"	15 FEET

DEPTH OF TUNNELING	
TREE DIAMETER	DEPTH OF TUNNEL
9" OR LESS	2.5'
10"-14"	3.0'
15"-19"	3.5'
20" OR MORE	4.0'

PROJECT OWNER & ADDRESS

2700 MERCED ST
SAN LEANDRO, CA. 94577

PROJECT NAME & ADDRESS

SITE #: 2.3 J
SITE NAME: PLEASANTON RING
S LAMMERS ROAD
TRACY, CA
95377

SHEET DESCRIPTION:

GENERAL NOTES

DATE: 11/12/2015

SCALE: AS SHOWN

SHEET

GN

OVERVIEW MAP

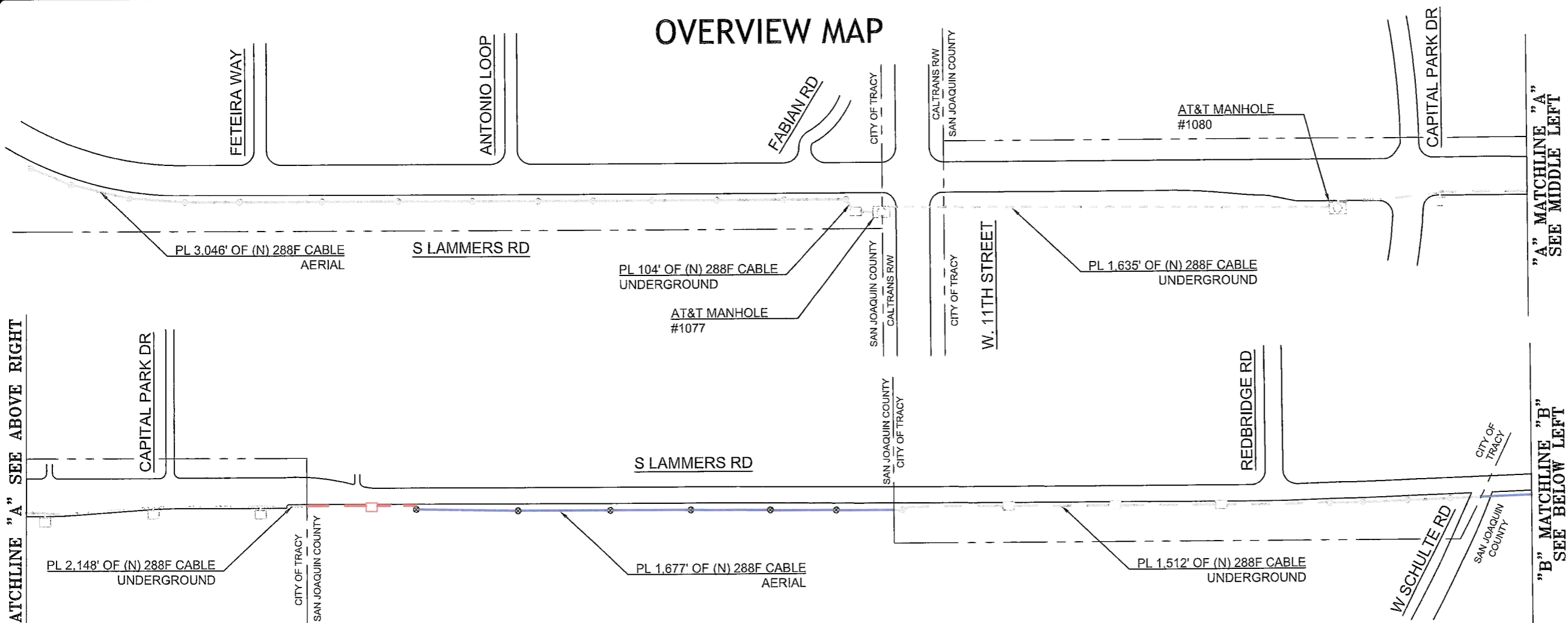

"A" MATCHLINE "A" SEE ABOVE RIGHT

"A" MATCHLINE "A" SEE MIDDLE LEFT

"B" MATCHLINE "B" SEE BELOW LEFT

SEE MIDDLE RIGHT
"B" MATCHLINE "B"

- UTILITY POLES
- MANHOLES/HANDHOLES/SPLICE BOXES
- PROPOSED FIBER OPTIC UNDERGROUND (ZAYO)
- PROPOSED FIBER OPTIC AERIAL
- PROPOSED FIBER OPTIC UNDERGROUND (3RD PARTY/LEASED)

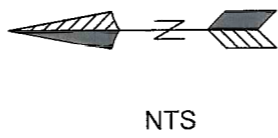

JURISDICTIONS	
①	CITY OF TRACY
②	SAN JOAQUIN COUNTY
③	CALTRANS
④	UPRR
⑤	
⑥	

QUANTITIES NOTE:
ALL BUILD FOOTAGES SHOWN ON THIS PAGE ARE FOR THE WHOLE PROJECT AND ARE NOT NECESSARILY ACCURATE FOR THIS SUBMITTAL. SUBMITTAL SPECIFIC QUANTITIES CAN BE FOUND ON THE PERMIT PACKAGE COVER SHEET (P-CS).

BUILD FOOTAGE	
LEASED DUCT	1,635'
EXISTING MANHOLES	2
EXISTING HH/SB	0
CORES	2
POLES	42
AERIAL FOOTAGE	8,362'
(N) RISER	4
NEW BUILD FOOTAGE	3,764'
NEW MANHOLES	0
NEW HANDHOLES	9

PROJECT OWNER & ADDRESS

GROUP
2700 MERCED ST
SAN LEANDRO, CA. 94577

PROJECT NAME & ADDRESS

SITE #: 2.3 J
SITE NAME: PLEASANTON RING
S LAMMERS ROAD
TRACY, CA
95377

SHEET DESCRIPTION:	SHEET
OVERVIEW MAP	OM
DATE: 11/12/2015	
SCALE: AS SHOWN	

LEGEND

CONVENTIONAL SYMBOLS

DESCRIPTION	ABBREVIATION	SYMBOL
BOX CULVERT	BXC	
BRIDGE	BR	
BUS STOP	BS	
CABLE TV PEDESTAL	CTVP	
CATCH BASIN / INLET	ST DR	
CRASH BARRIER	CRB	
CULVERT	CUL	
DOWN GUY	DG	
DRIVEWAY	DWY	
ELECTRICAL MANHOLE	EMH	
ELECTRIC HANDHOLE	EHH	
ELECTRIC VAULT	EV	
ELECTRIC WATER PUMP	EWP	
FENCE POST	FP	
FIBER OPTIC CABLE HANDHOLE	FOHH	
FIBER OPTIC CABLE MANHOLE	FOMH	
FIBER OPTIC CABLE PEDESTAL	FOPED	
FIRE HYDRANT	FH	
GAS HANDHOLE	GHH	
GAS METER	GM	
GAS VALVE	GV	
GATE	GATE	
ICG MANHOLE	ICGMH	
INTERMEDIA COMMUNICATIONS MANHOLE	INMH	
PARKWAY	PKWY	
PAYPHONE	P PH	
PILLAR	PIL	
POWER PEDESTAL	PPD	
ROAD SIGN	RS	
TRAFFIC FLOW	TF	
SANITARY SEWER MANHOLE	SSMH	
SANITARY SEWER CLEAN OUT	SSCO	
SPLICE	SPL	
SPLICE BOX	SPLB	
SPRINKLER CONTROL BOX	SCB	

POLE SYMBOLS

DESCRIPTION	ABBREVIATION	SYMBOL
STEEL POLE	STP	
POWER POLE JOINT USE	PP	
POWER ONLY	PO	
TELEPHONE ONLY	TO	
FOREIGN POWER	STFP	

CONVENTIONAL SYMBOLS CONT.

DESCRIPTION	ABBREVIATION	SYMBOL KEY
SPRINKLER HEAD	SPH	
STEAM MANHOLE	STMH	
STORM DRAIN MANHOLE	SDMH	
STREET LIGHT	STL	
UTILITY MARKER	UM	
SURVEY MARKER	SM	
SWING OR DRAW BRIDGE	SWBR	
RAILROAD SWITCH BOX	RRSB	
TELEPHONE MANHOLE	TMH	
TELEPHONE PEDESTAL	TPD	
TRAFFIC CONTROL BOX	TCB	
TRAFFIC CONTROL HANDHOLE	TCHH	
TRAFFIC LIGHT	TL	
TRANSFORMER	TX	
TREE	TREE	
UNIDENTIFIED HANDHOLE	UHH	
UNIDENTIFIED MANHOLE	UMH	
UNIDENTIFIED PEDESTAL	UPED	
UTILITY BOX	UB	
VENT	VT	
WATER MANHOLE	WMH	
WATER METER	WM	
WATER VALVE	WV	
WEATHER TOWER	WTWR	
MONITORING WELL	MW	
WIND DEFLECTOR	WD	
IRRIGATION BOX	IBX	

ENGINEERING SYMBOLS

DESCRIPTION	ABBREVIATION	SYMBOL
EXISTING ZAYO MANHOLE	EX MH	
ZAYO PROPOSED MANHOLE	PL MH	
EXISTING ZAYO HANDHOLE	EX HH	
ZAYO PROPOSED HANDHOLE	PL HH	
BOND AND GROUND	GRD	
BORE/RECEIVE PIT	PL BP	
EXISTING ATT HH/SB	EX ATT HH	
EXISTING ATT MH	EX ATT MH	
CELL TOWER	CELL TOWER	

POLE HARDWARE









DESCRIPTION	ABBREVIATION	SYMBOL
EXISTING POWER ANCHOR	EPA	
PROPOSED ANCHOR	PA	
EXISTING ANCHOR	TA	
SIDEWALK ANCHOR	SA	
BOW TIE	BT	
EXISTING OVERHEAD GUY	EOHG	
PROPOSED OVERHEAD GUY	POHG	
EXISTING VERTICAL GROUND	EVG	

CONVENTIONAL SYMBOLS CONT.

EXISTING UNDERGROUND UTILITIES

ELECTRIC	E	
TV	TV	
TELEPHONE	I	
EX. FIBER OPTIC CABLE	FO	
STEAM	ST	
WATER	W	
STORM DRAIN	SD	
SANITARY SEWER	SS	
GAS	GAS	

EXISTING CONDITIONS

GUARD RAIL	
CURB/EOP	
BARBED WIRE FENCE	X 
FENCE	O 
RAILROAD	
TREE LINE	
WATER	
CONCRETE WALL OR SOUND BARRIER	

PROPOSED CONSTRUCTION

DIRECTIONAL BORE (DB)	
1' WIDE TRENCH LINE	
PROPOSED ENCASING	
CENTERLINE (C/L)	
RIGHT-OF-WAY (R/W)	
DITCH	
SECTION LINE	
EASEMENT	

PROJECT OWNER & ADDRESS

GROUP
2700 MERCED ST
SAN LEANDRO, CA. 94577

PROJECT NAME & ADDRESS

SITE #: 2.3 J
SITE NAME: PLEASANTON RING
S LAMMERS ROAD
TRACY, CA
95377

SHEET DESCRIPTION:

CONSTRUCTION LEGEND

DATE: 11/12/2015

SCALE: AS SHOWN

SHEET

CD-LD

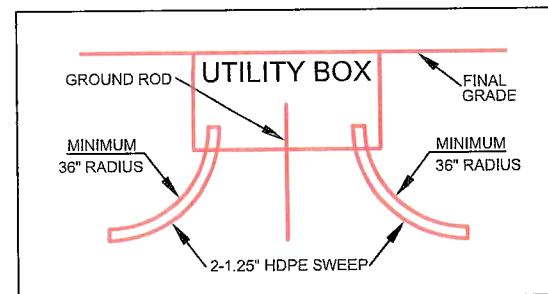
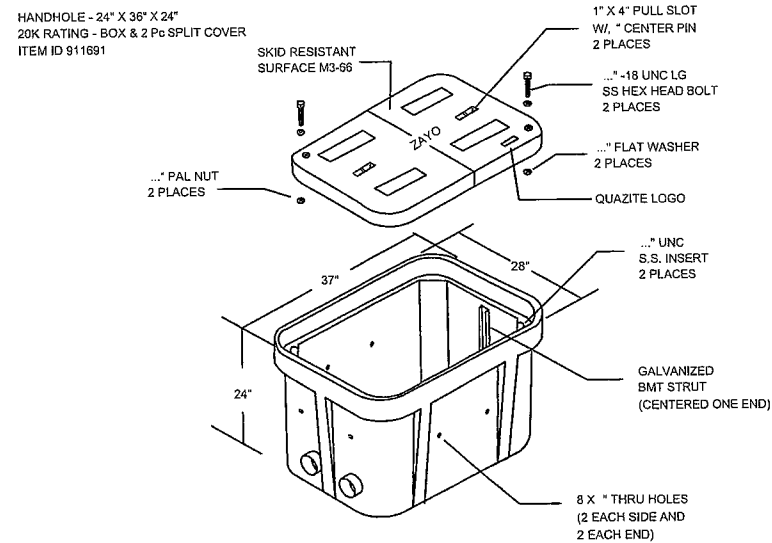

SWEEP DETAIL

TYPICAL 17"x30" HANDHOLE DETAIL

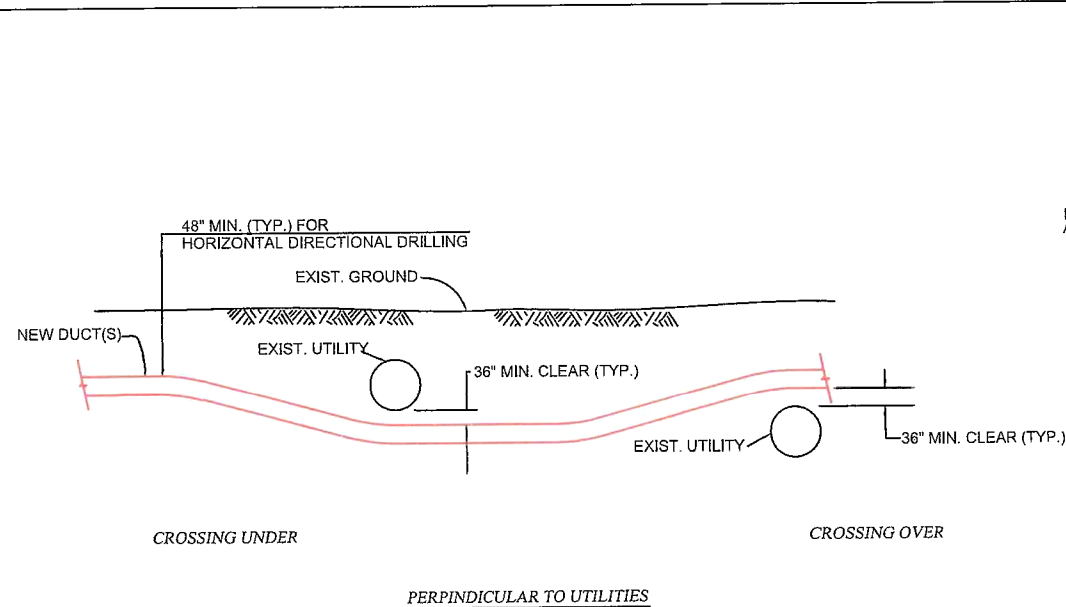

UTILITY CROSSING DETAIL

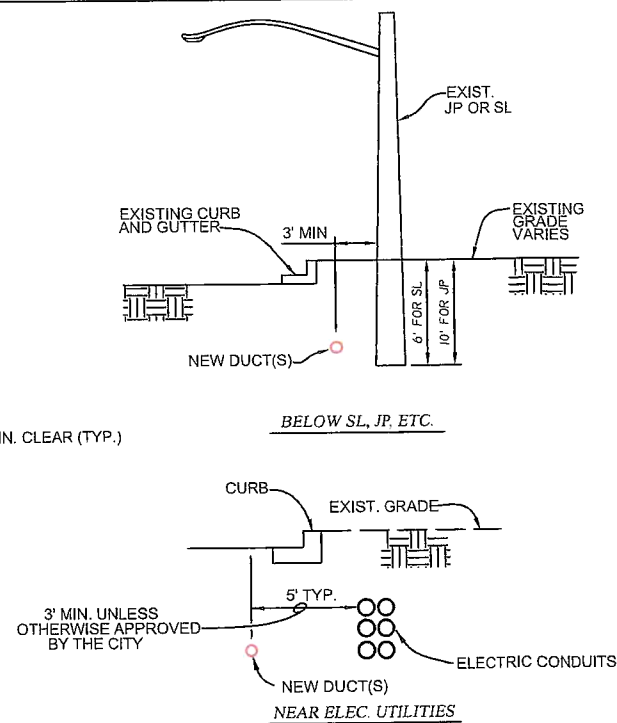

WATER LINE CROSSING DETAILS

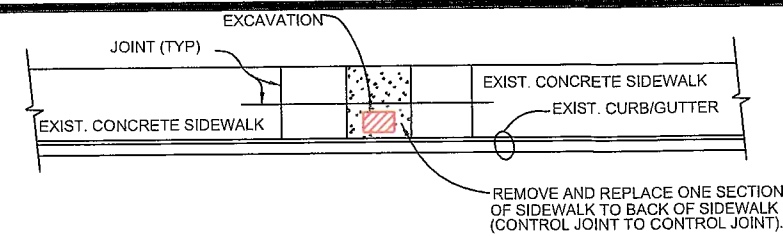

SIDEWALK REPAIR DETAIL

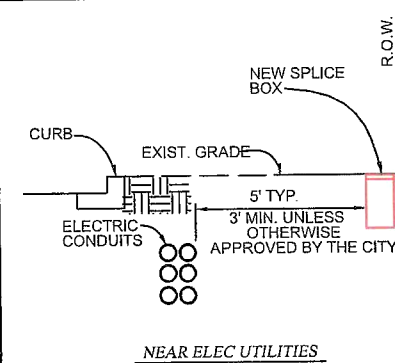

BOX LOCATION DETAIL

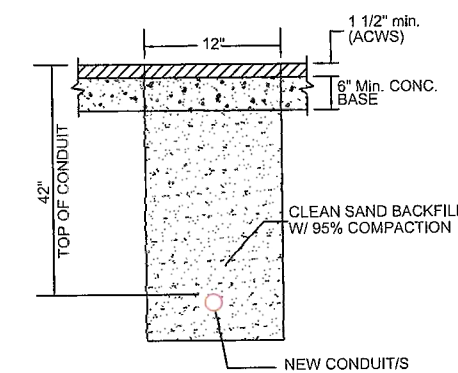

TRENCH DETAIL

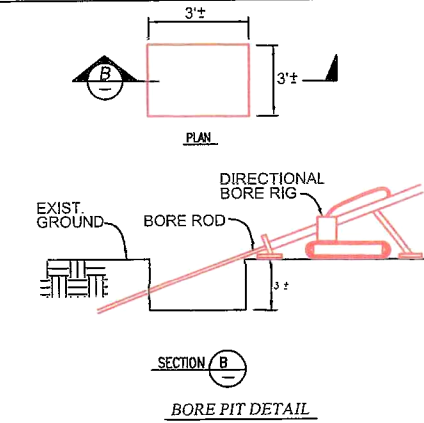
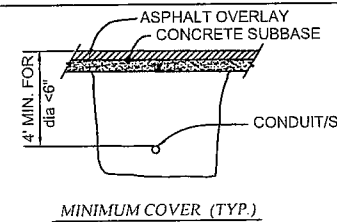

DIRECTIONAL BORE DETAILS

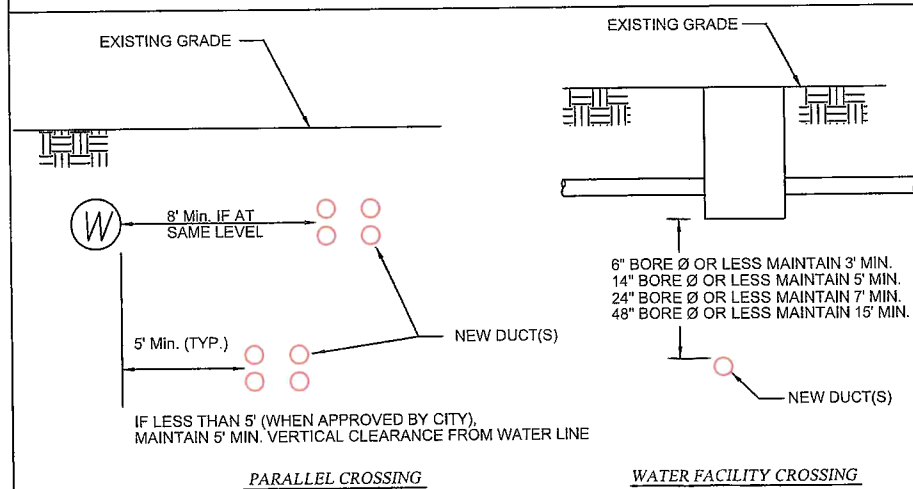

PROJECT OWNER & ADDRESS

GROUP

2700 MERCED ST
SAN LEANDRO, CA. 94577

PROJECT NAME & ADDRESS

SITE #: 2.3 J

SITE NAME: PLEASANTON RING
S LAMMERS ROAD
TRACY, CA
95377

SHEET DESCRIPTION:	SHEET
CONSTRUCTION DETAILS	CD-D1
DATE: 11/12/2015	
SCALE: AS SHOWN	

PLAN VIEW

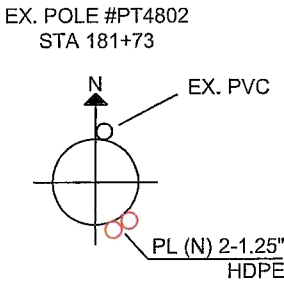

PL 2-1.25" HDPE
W/ MIN. 36" SWEEP

ELEVATION

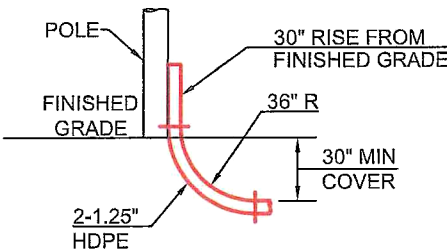

POLE RISER DETAIL

1

PROJECT OWNER & ADDRESS

ZAVO
GROUP
2700 MERCED ST
SAN LEANDRO, CA. 94577

PROJECT NAME & ADDRESS

SITE #: 2.3 J
SITE NAME: PLEASANTON RING
S LAMMERS ROAD
TRACY, CA
95377

SHEET DESCRIPTION:

CONSTRUCTION DETAILS

DATE: 11/12/2015

SCALE: AS SHOWN

SHEET

CD-D2

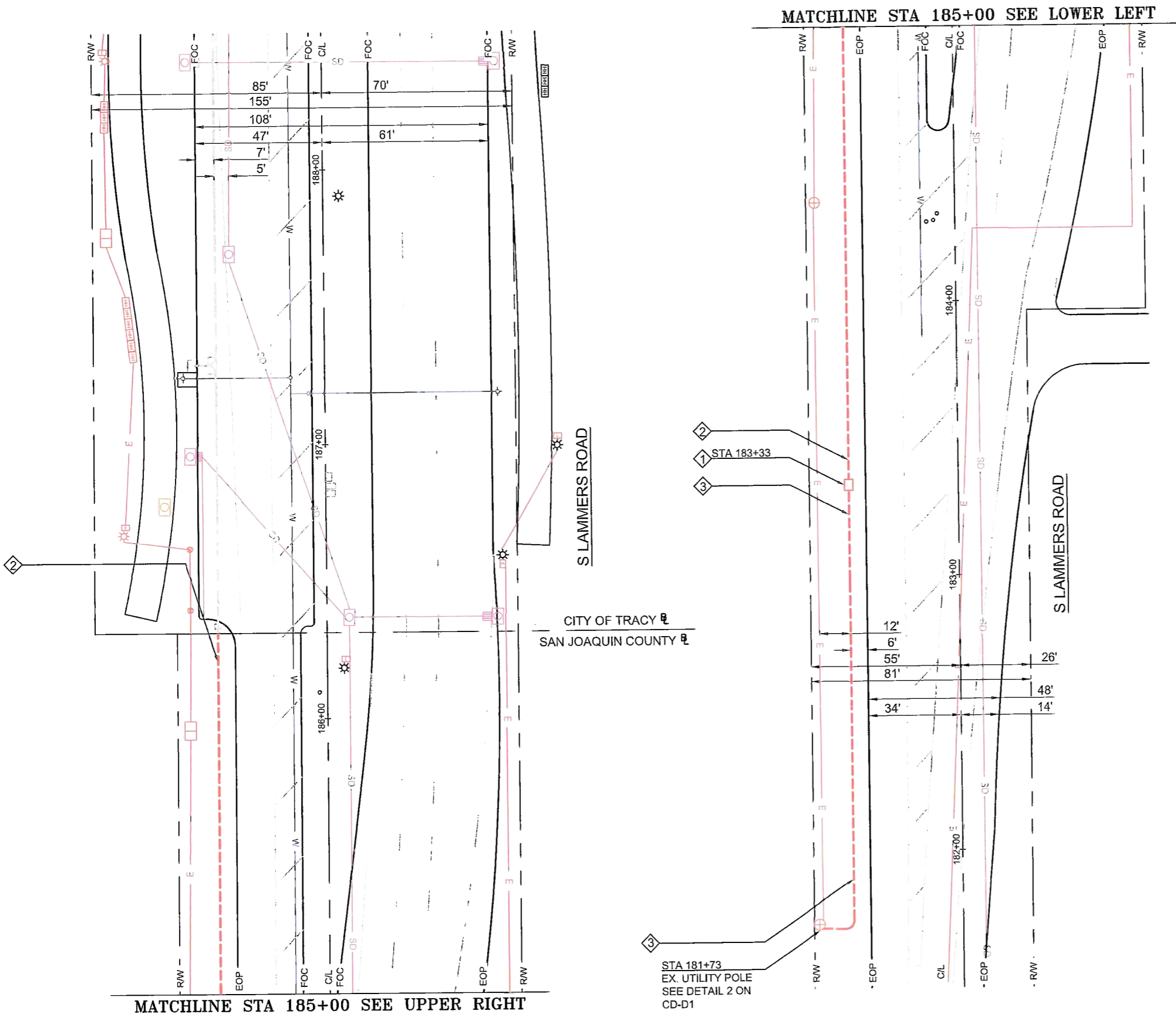

CALL BEFORE YOU DIG
UNDERGROUND SERVICE ALERT
1-800-227-2600



Know what's below.
Call before you dig.

CONTRACTORS NOTE:
ALL UTILITY LOCATIONS ARE APPROXIMATE
CONTRACTOR IS RESPONSIBLE FOR
EXACT LOCATIONS.

CL-CL INTERSECTION
STA 200+00 S LAMMERS RD= STA 20+00 CAPITAL PARK DR



SCALE: 1"=40'
ON 11"x17" SHEET

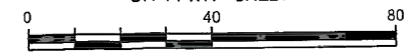

KEY NOTES

- 1 PLACE 3'X4' ZAYO HH
- 2 TRENCH AND PLACE 299' OF 2-1 25" HDPE FROM BORE PIT STA 186+34 TO NEW ZAYO HAND HOLE STA 183+33
- 3 TRENCH AND PLACE 170' OF 2-1 25" HDPE FROM NEW ZAYO HAND HOLE STA 183+33 TO EX. UTILITY POLE STA 181+73

PROJECT OWNER & ADDRESS

rayo
GROUP
2700 MERCED ST
SAN LEANDRO, CA. 94577

PROJECT NAME & ADDRESS

SITE #: 2.3 J
SITE NAME: PLEASANTON RING
S LAMMERS ROAD
TRACY, CA
95377

SHEET DESCRIPTION:

CONSTRUCTION DESIGN

DATE: 11/12/2015

SCALE: AS SHOWN

SHEET

CD-01

TRAFFIC CONTROL LEGEND AND GENERAL NOTES

WARNING SIGNS

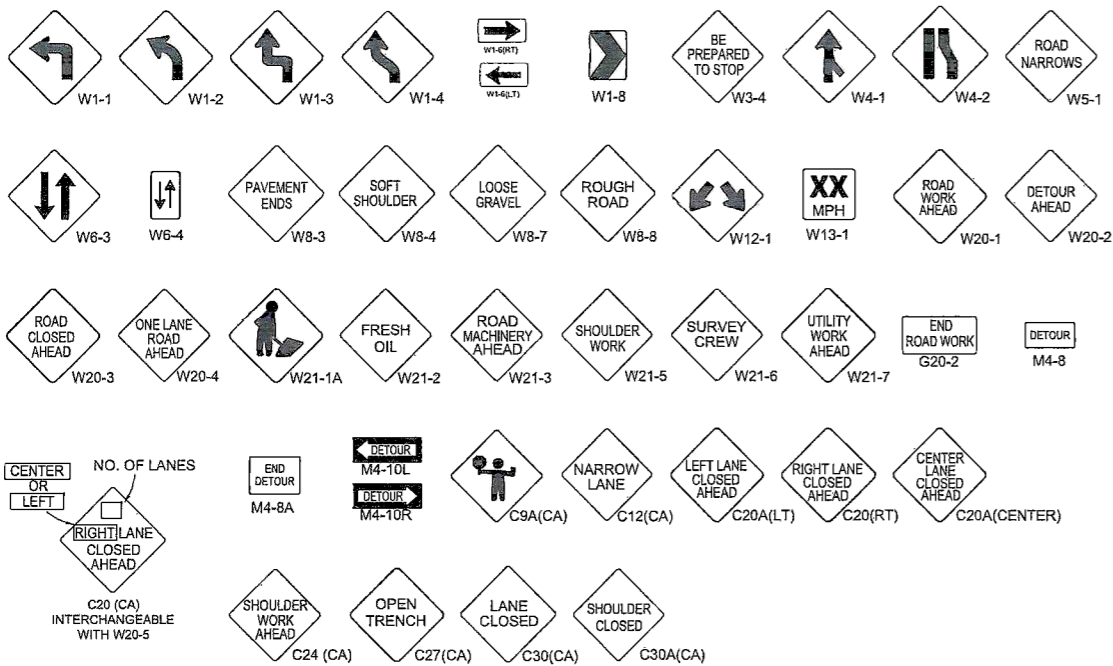

REGULATORY SIGNS

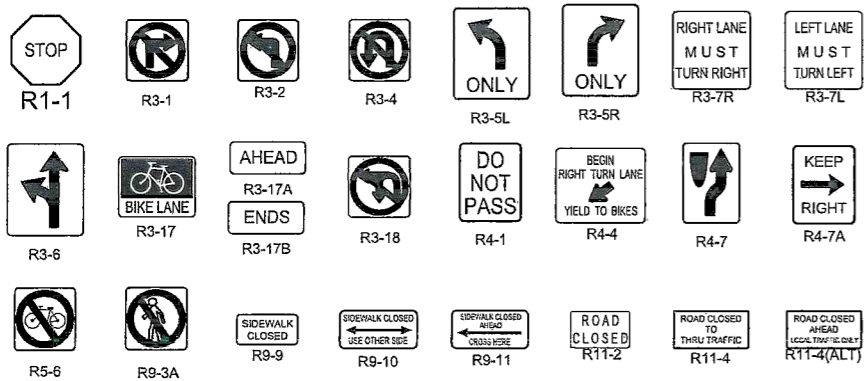

MISCELLANEOUS DEVICES

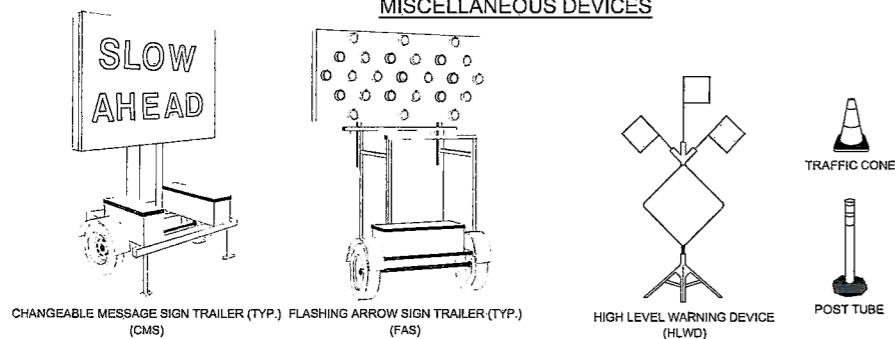

RECOMMENDED ADVANCED WARNING SIGN SPACING

ROAD TYPE	DISTANCE BETWEEN SIGNS		
	A	B	C
URBAN (LOW SPEED) 25 MPH OR LESS	100	100	100
URBAN (HIGH SPEED) MORE THAN 25 MPH TO 40 MPH	250	250	250
URBAN (HIGH SPEED) MORE THAN 40 MPH	350	350	350
RURAL	500	500	500
EXPRESSWAY/FREEWAY	1000	1500	2540

SPEED** S (MPH)	MINIMUM TAPER LENGTH*** FOR WIDTH OF OFFSET 12 FT (W)				BUFFER SPACE (FT)
	MERGING L (FT)	SHIFTING L/2 (FT)	SHOULDER L/3 (FT)	DOWN STREAM (FT)****	
20	80	40	27	50	115
25	125	63	42	50	155
30	180	90	60	50	200
35	245	123	82	50	250
40	320	160	107	50	305
45	540	270	180	50	360
50	600	300	200	50	425
55	660	330	220	50	495
60	720	360	240	50	570
65	780	390	260	50	645
70	840	420	280	50	730

* - DISTANCES SHOWN IN FEET. THE A DIMENSION IS THE DISTANCE FROM THE TRANSITION OR POINT OF RESTRICTION TO THE FIRST SIGN. THE B DIMENSION IS THE DISTANCE BETWEEN THE FIRST AND SECOND SIGNS. THE C DIMENSION IS THE DISTANCE BETWEEN THE SECOND AND THIRD SIGNS. (THE "FIRST SIGN" IS THE SIGN IN A THREE-SIGN SERIES THAT IS CLOSEST TO THE TTC ZONE. THE "THIRD SIGN" IS THE SIGN THAT IS FURTHEST UPSTREAM FROM THE TTC ZONE.)

** - POSTED SPEED LIMIT, OFF PEAK 85TH-PERCENTILE SPEED PRIOR TO WORK STARTING, OR THE ANTICIPATED OPERATING SPEED IN MPH.

*** - FOR OTHER OFFSETS USE THE FOLLOWING MERGING TAPER LENGTH FORMULA FOR L
FOR SPEEDS OF 40 MPH OF LESS, L*WS/60
FOR SPEEDS OF 45 MPH OR MORE, L*WS

WHERE L = TAPER LENGTH IN FEET
W = WIDTH OF OFFSET IN FEET
S = POSTED SPEED LIMIT, OFF PEAK 85TH-PERCENTILE SPEED PRIOR TO WORK STARTING, OR THE ANTICIPATED OPERATING SPEED IN MPH

**** - MAXIMUM DOWNSTREAM TAPER LENGTH IS 100 FEET.

GENERAL NOTES:

- 1) INDIVIDUALS WHO ARE KNOWLEDGABLE IN THE PRINCIPLES OF TEMPORARY TRAFFIC CONTROL(TTC) SHOULD BE ASSIGNED RESPONSIBILITY FOR SAFETY IN TTC ZONES TO CHECK THAT ALL TTC DEVICES OF THE PROJECT ARE REASONABLY CONSISTENT WITH THE TTC PLAN AND ARE EFFECTIVE IN PROVIDING REASONABLY SAFE CONDITIONS FOR MOTORISTS, BICYCLISTS, PEDESTRIANS, AND WORKERS.
- 2) AS WORK PORGRESSES TTC AND/OR WORKING CONDITIONS SHOULD BE MODIFIED IN ORDER TO PROVIDE REASONABLY SAFE AND EFFICIENT ROAD USER MOVEMENT AND TO PROVIDE WORKER SAFETY. THE INDIVIDUAL RESPONSIBLE FOR TTC SHOULD HAVE THE AUTHORITY TO HALT WORK UNTIL APPLICABLE OR REMEDIAL SAFETY MEASURE ARE TAKEN.
- 3) ALL TTC DEVICES SHALL BE REMOVED AS SOON AS PRACTICAL WHEN THEY ARE NO LONGER NEEDED.
- 4) WHEN WORK IS SUSPENDED FOR SHORT PERIODS OF TIME TTC DEVICES THAT ARE NO LONGER APPROPRIATE SHALL BE REMOVED OR COVERED.
- 5) AUDIBLE INFORMATION DEVICES ARE TO BE USED TO ASSIST PEDESTRIANS WITH VISUAL DISABILITIES WHERE NEEDED.
- 6) CONTRACTOR SHALL PROVIDE FOR ACCESS TO ALL ADJACENT PROPERTIES.
- 7) CONTRACTOR SHALL COVER OR REMOVE ALL CONFLICTING SIGNS.
- 8) AS OF SEPTEMBER 26, 2006, THE CALIFORNIA MANUAL ON UNIFORM TRAFFIC CONTROL DEVICES (MUTCD) HAS BEEN COMBINED WITH THE FEDERAL HIGHWAY ADMINISTRATION (FHWA) MUTCD 2014 AND THE CALIFORNIA SUPPLEMENT (MAY 20, 2004). CHAPTER 6, OF THE CALIFORNIA MUTCD COVERS TTC TYPICAL SETUPS AND THE USE WITHIN PUBLIC RIGHT-OF-WAY.
- 9) AS A TRAFFIC CONTROL PRACTITIONERS, THE CITY EXPECTS THE CONTRACTOR TO DESIGN AND PROVIDE A TTC PLAN WITH HIGH-LEVEL WARNING DEVICES, CHANNELING CONES, FLASHING ARROW BOARDS, AND SIGNING AND BE ABLE TO INSTALL THESE ITEMS AS SHOWN ON THE APPROVED PLAN. IN ADDITION, IT IS ACCEPTABLE TO CONTRACT A RESPONSIBLE SIGNING AND STRIPING COMPANY FOR TTC DESIGNING AND ALL UPDATES, WHICH COMPLIES WITH THE CALIFORNIA MUTCD.
- 10) SIGNS USED FOR STATIONARY OR TEMPORARY TRAFFIC CONTROL ZONE, MAY BE FABRICATED FROM FIBERGLASS REINFORCED PLASTIC, METAL, REFLECTIVE MESH, OR OTHER REFLECTIVE MATERIAL AS APPROVED BY THE ASSISTANT CITY ENGINEER OR ACTING AGENT. ABSOLUTELY NO PAPER SIGNS SHALL BE ALLOWED.
- 11) SIGNS SHALL BE IN GOOD CONDITION, NO TEARS, NOT WORN OUT, OR NOT MISSING REFLECTIVE PROPERTIES.
- 12) TYPICAL TTC SETUP AND OTHER BENEFICIAL MATERIAL HAVE BEEN PRINTED IN THE 2006 WORK AREA TRAFFIC CONTROL HANDBOOK (WATCH). THE 2006 WATCH GUIDE IS IN CONFORMANCE WITH CALIFORNIA MUTCD.
- 13) ALL TTC SIGNING SHALL BE STANDARD/CONVENTIONAL IN SIZE.
- 14) CHANNELING CONES SHALL BE 28" IN HEIGHT AND IN GOOD CLEAN CONDITION. REFLECTIVE SHEETING IS ADVISABLE AND MANDATORY WHEN LEFT OVERNIGHT OR FOR NIGHT WORK.
- 15) EACH HIGH-LEVEL WARNING DEVICE SHALL HAVE FLAGS AND AT LEAST ONE (1) CONE ON THE LEFT VEHICLE APPROACH SIDE. IN SOME CASES, BARRICADES MAY BE REQUIRED, HOWEVER WHEN LEFT OVERNIGHT OR FOR NIGHT WORK, THE DEVICE SHALL HAVE A FLASHING BEACON.
- 16) IN MOST CASES, THERE MAY BE A SPECIAL NEED TO PROTECT BICYCLES AND PEDESTRIANS, WHICH ARE NOT FULLY COVERED IN PART 6 OF THE MUTCD. SPECIAL BIKE AND PEDESTRIAN SIGNAGE MAY BE REQUIRED.
- 17) CONSTRUCTION SIGNING SHALL NOT BE PLACED IN BIKE LANE OR IN PEDESTRIAN WALKWAY, UNLESS THE BIKE LANE, SIDEWALK, OR PEDESTRIAN PATH HAS BEEN APPROVED FOR CLOSURE.
- 18) CONSTRUCTION SIGNING SHALL NOT BE INSTALLED ON TRAFFIC SIGNAL POLES. IT IS OKAY TO INSTALL CONSTRUCTION SIGNS ON CITY OWNED ELECTROLIERS.
- 19) COMMON TTC SIGNING (CALIFORNIA IN PARENTHESES): W20-1 (C23) ROAD WORK AHEAD, W9-3 (C20) XXX LANE CLOSED AHEAD (L, R, CENTER, BIKE), C30 (CA) LANE CLOSED, G20-2 (C14) END ROAD WORK, SC11 (CA) BIKE LANE CLOSED, W16-1 SHARE THE ROAD (BLACK ON YELLOW), R9-9 SIDEWALK CLOSED (BLACK ON WHITE), R9-11(L,R) SIDEWALK CLOSED AHEAD (BLACK ON WHITE), C9 (CA) FLAGGER (W/STOP PADDLE), W4-2 (W11) LANE DROP.

LEGEND

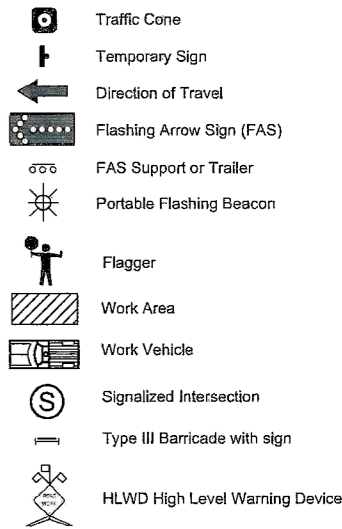

PROJECT OWNER & ADDRESS

2700 MERCED ST
SAN LEANDRO, CA. 94577

PROJECT NAME & ADDRESS

SITE #: 2.3 J
SITE NAME: PLEASANTON RING
S LAMMERS ROAD
TRACY, CA
95377

SHEET DESCRIPTION:

TCP LEG./DET./GEN. NOTES

DATE: 11/12/2015

SCALE: AS SHOWN

SHEET

TC-LD

TRAFFIC CONTROL KEY MAP

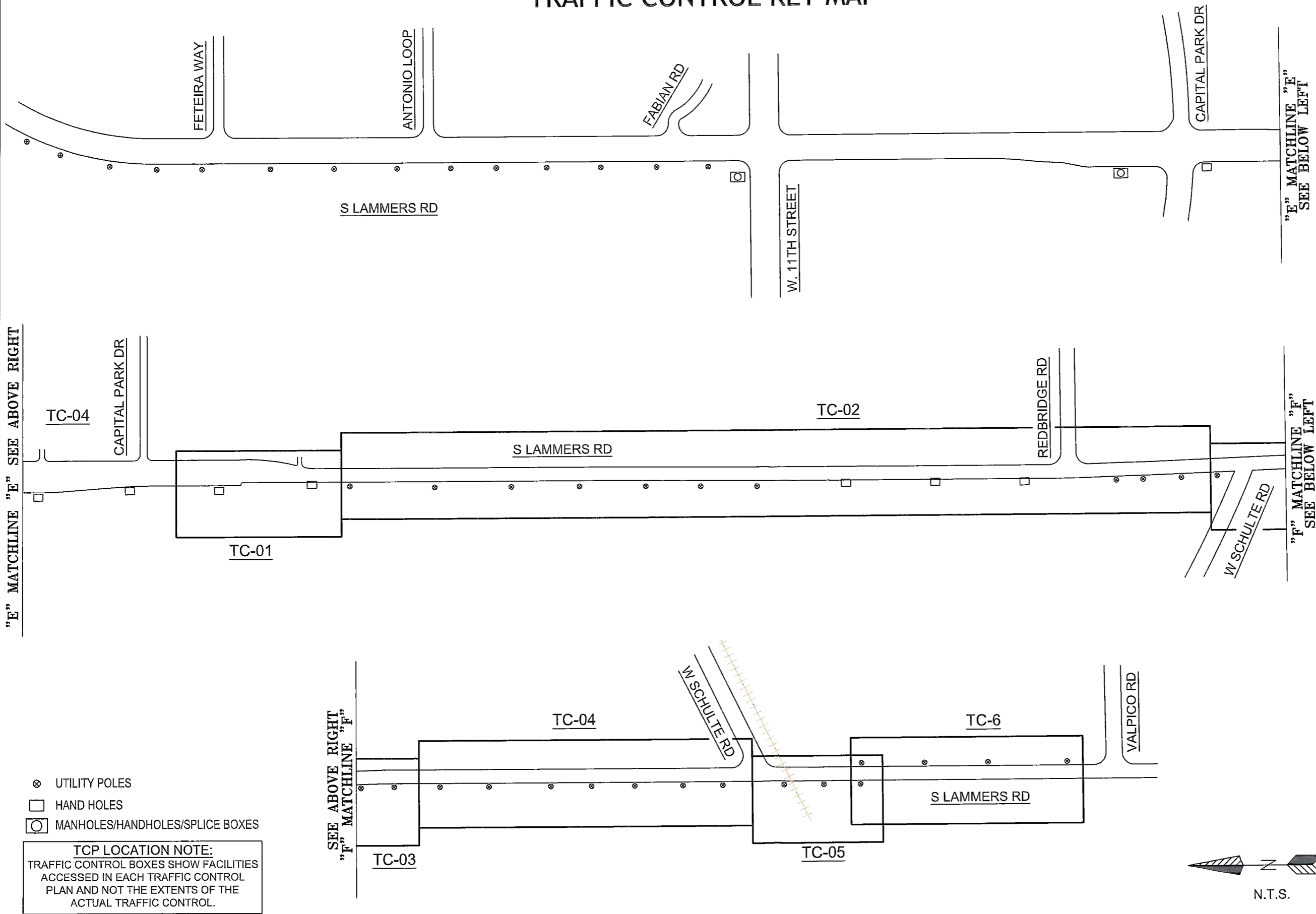

PROJECT OWNER & ADDRESS

GROUP
2700 MERCED ST
SAN LEANDRO, CA. 94577

PROJECT NAME & ADDRESS

SITE #: 2.3 J
SITE NAME: PLEASANTON RING
S LAMMERS ROAD
TRACY, CA
95377

SHEET DESCRIPTION:

TCP KEY MAP

DATE: 11/12/2015

SCALE: AS SHOWN

SHEET

TC-KM

S LAMMERS ROAD (35 MPH)

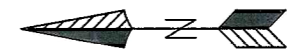
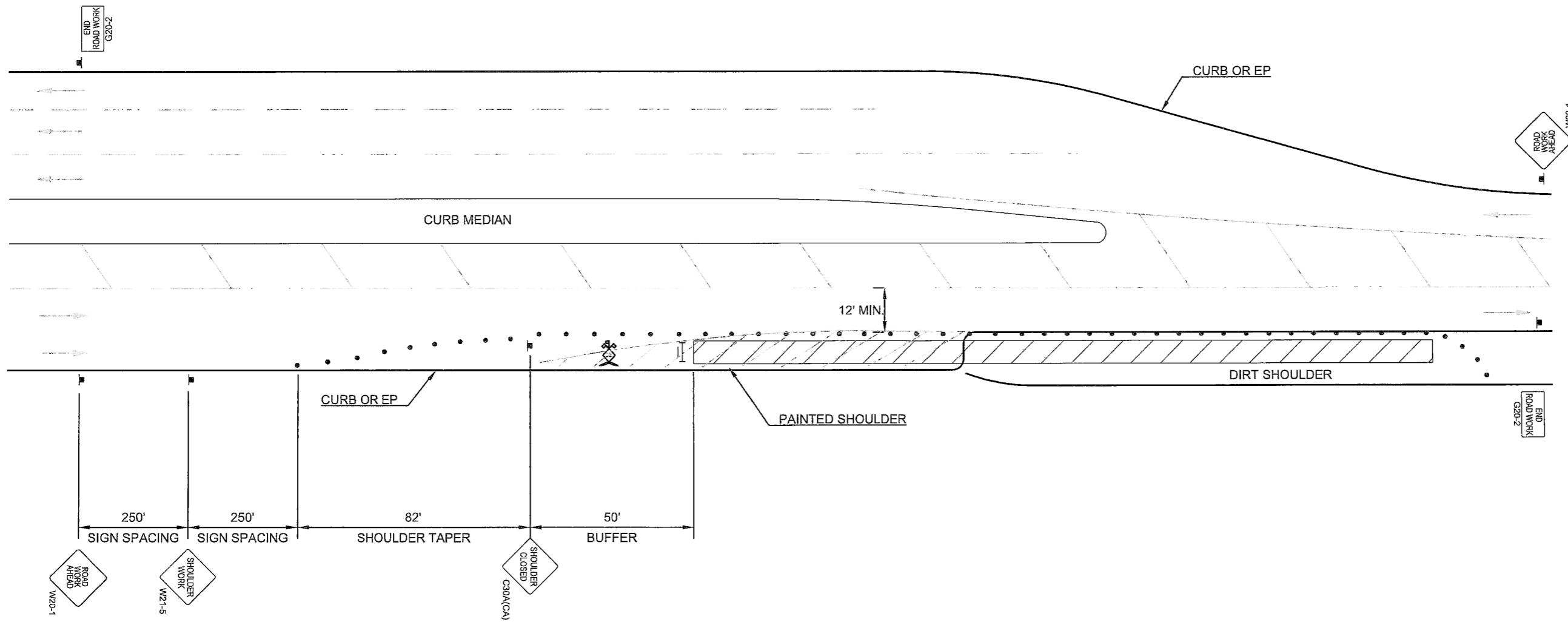

N.T.S.

SCOPE OF WORK
WORK CREW TO PLACE (2) HAND HOLES
AND TRENCH AND BORE TO PLACE
FIBER OPTIC CABLE IN ORDER TO
PROVIDE SERVICE TO CUSTOMER.

NOTES

- 1) CONE SPACING SHALL BE 25' MINIMUM.
- 2) TEMPORARY "NO PARKING" SIGNS SHALL BE INSTALLED AT 72 HOURS BEFORE ENFORCEMENT
- 3) WORK CREW TO COORDINATE WITH APPROPRIATE TRANSIT AUTHORITY. NOTIFICATION TO BE AT LEAST 36 HOURS PRIOR TO CONSTRUCTION AND MUST BE ACKNOWLEDGED BY SAID AUTHORITY.
- 4) WORK CREW TO COORDINATE WORK HOURS WITH SCHOOLS AFFECTED BY WORK SHOWN HEREON.

LEGEND

- Traffic Cone
- Temporary Sign
- Direction of Travel
- Flashing Arrow Sign (FAS)
- FAS Support or Trailer
- Portable Flashing Beacon
- Flagger
- Work Area
- Work Vehicle
- Signalized Intersection
- Type III Barricade with sign
- HLWD High Level Warning Device

PROJECT OWNER & ADDRESS

2300 GROUP
2700 MERCED ST
SAN LEANDRO, CA. 94577

PROJECT NAME & ADDRESS

SITE #: 2.3 J
SITE NAME: PLEASANTON RING
S LAMMERS ROAD
TRACY, CA
95377

SHEET DESCRIPTION:

TCP SHEET 01

DATE: 11/12/2015

SCALE: AS SHOWN

SHEET

TC-01

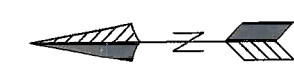
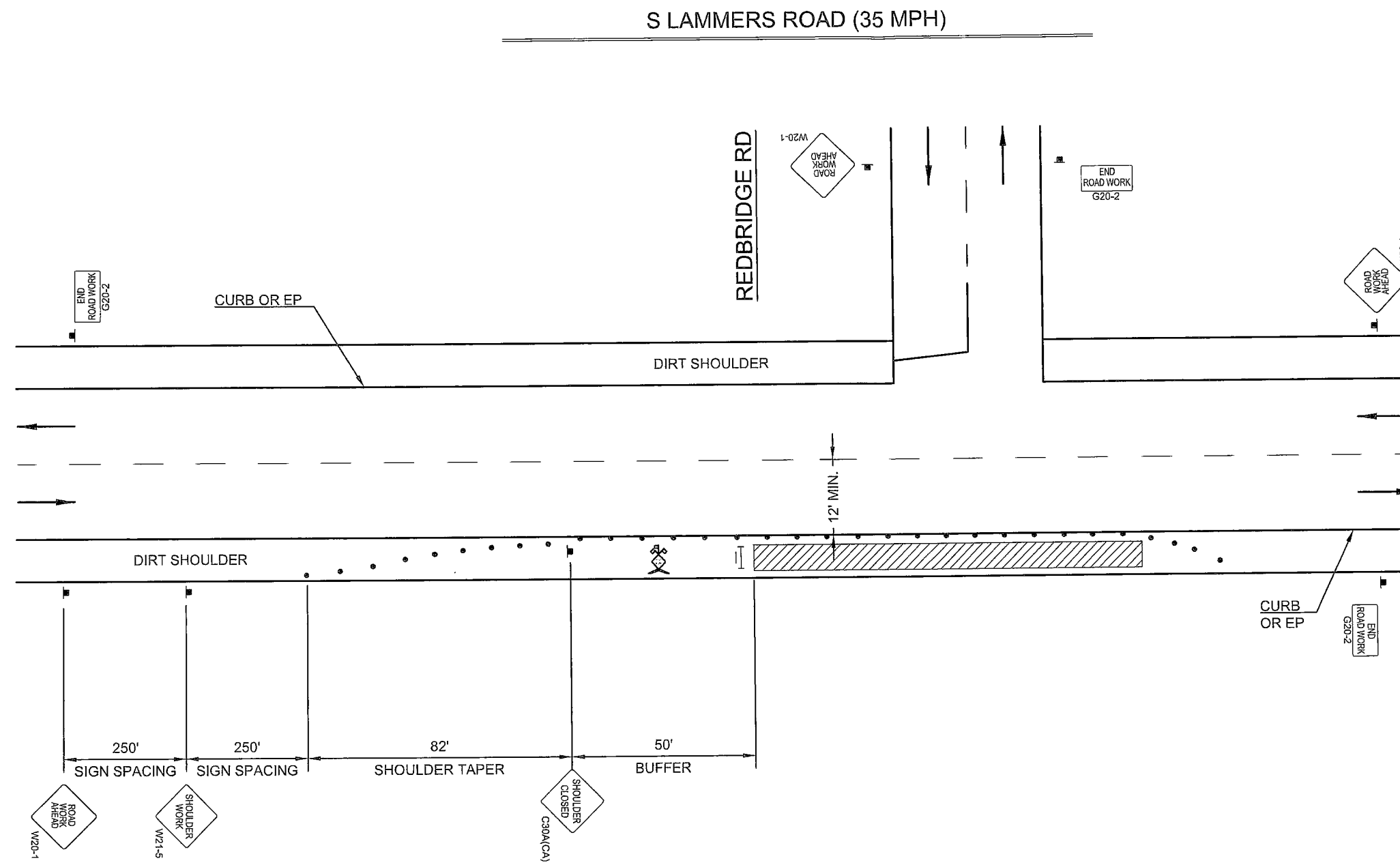

SCOPE OF WORK
WORK CREW TO ACCESS (11) EX. UTILITY POLES AND PLACE (3) HAND HOLES AND TRENCH TO PLACE FIBER OPTIC CABLE IN ORDER TO PROVIDE SERVICE TO CUSTOMER.

NOTES

- 1) CONE SPACING SHALL BE 25' MINIMUM.
- 2) TEMPORARY "NO PARKING" SIGNS SHALL BE INSTALLED AT 72 HOURS BEFORE ENFORCEMENT
- 3) WORK CREW TO COORDINATE WITH APPROPRIATE TRANSIT AUTHORITY. NOTIFICATION TO BE AT LEAST 36 HOURS PRIOR TO CONSTRUCTION AND MUST BE ACKNOWLEDGED BY SAID AUTHORITY.
- 4) WORK CREW TO COORDINATE WORK HOURS WITH SCHOOLS AFFECTED BY WORK SHOWN HEREON.

LEGEND

- Traffic Cone
- Temporary Sign
- Direction of Travel
- Flashing Arrow Sign (FAS)
- FAS Support or Trailer
- Portable Flashing Beacon
- Flagger
- Work Area
- Work Vehicle
- Signalized Intersection
- Type III Barricade with sign
- HLWD High Level Warning Device

PROJECT OWNER & ADDRESS

GROUP
2700 MERCED ST
SAN LEANDRO, CA. 94577

PROJECT NAME & ADDRESS

SITE #: 2.3 J
SITE NAME: PLEASANTON RING
S LAMMERS ROAD
TRACY, CA
95377

SHEET DESCRIPTION:

TCP SHEET 02

DATE: 11/12/2015

SCALE: AS SHOWN

SHEET

TC-02

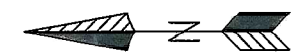
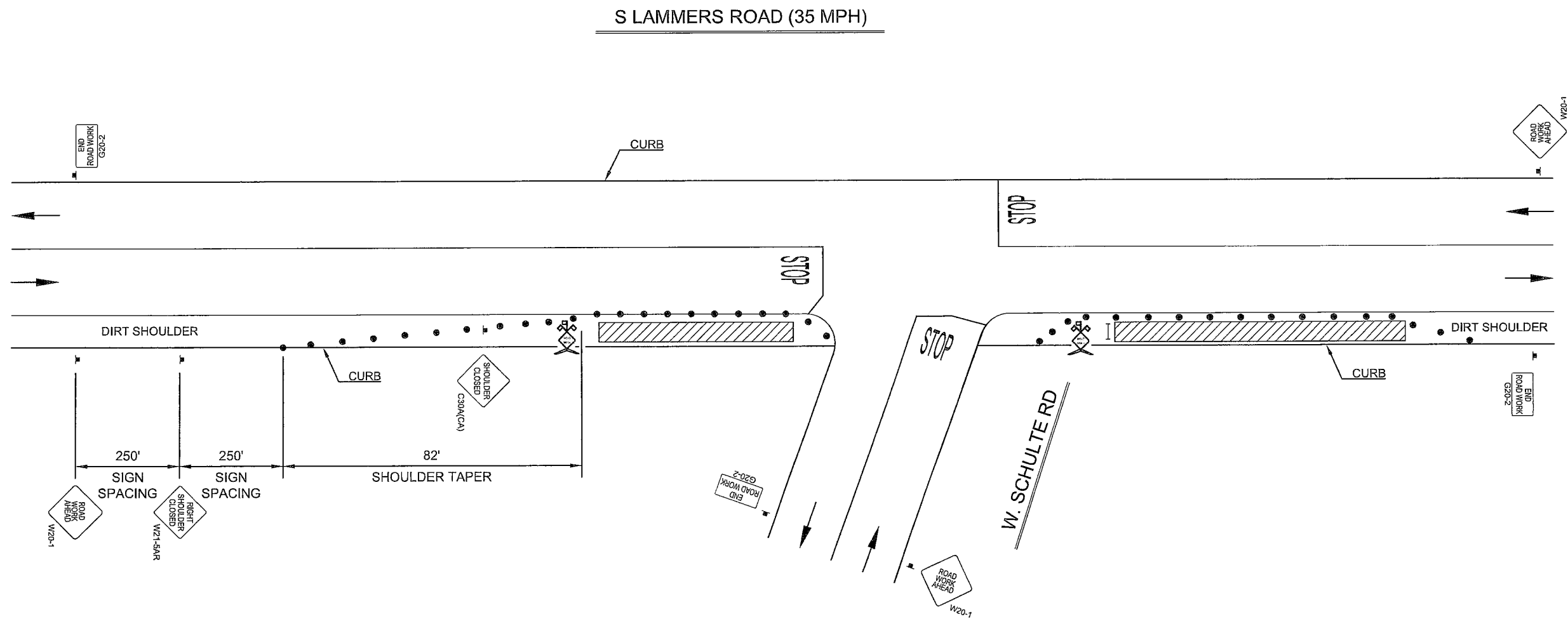

SCOPE OF WORK
WORK CREW TO ACCESS (3) EX. UTILITY
POLES TO PLACE FIBER OPTIC CABLE IN
ORDER TO PROVIDE SERVICE TO
CUSTOMER.

NOTES

- 1) CONE SPACING SHALL BE 25' MINIMUM.
- 2) TEMPORARY "NO PARKING" SIGNS SHALL BE INSTALLED AT 72 HOURS BEFORE ENFORCEMENT
- 3) WORK CREW TO COORDINATE WITH APPROPRIATE TRANSIT AUTHORITY. NOTIFICATION TO BE AT LEAST 36 HOURS PRIOR TO CONSTRUCTION AND MUST BE ACKNOWLEDGED BY SAID AUTHORITY.
- 4) WORK CREW TO COORDINATE WORK HOURS WITH SCHOOLS AFFECTED BY WORK SHOWN HEREON.

LEGEND

- Traffic Cone
- Temporary Sign
- Direction of Travel
- Flashing Arrow Sign (FAS)
- FAS Support or Trailer
- Portable Flashing Beacon
- Flagger
- Work Area
- Work Vehicle
- Signalized Intersection
- Type III Barricade with sign
- HLWD High Level Warning Device

PROJECT OWNER & ADDRESS

GROUP
2700 MERCED ST
SAN LEANDRO, CA. 94577

PROJECT NAME & ADDRESS

SITE #: 2.3 J
SITE NAME: PLEASANTON RING
S LAMMERS ROAD
TRACY, CA
95377

SHEET DESCRIPTION:	SHEET
TCP SHEET 03	
DATE: 11/12/2015	TC-03
SCALE: AS SHOWN	

- 1) CONE SPACING SHALL BE 25' MINIMUM.
- 2) TEMPORARY "NO PARKING" SIGNS SHALL BE INSTALLED AT 72 HOURS BEFORE ENFORCEMENT
- 3) WORK CREW TO COORDINATE WITH APPROPRIATE TRANSIT AUTHORITY. NOTIFICATION TO BE AT LEAST 36 HOURS PRIOR TO CONSTRUCTION AND MUST BE ACKNOWLEDGED BY SAID AUTHORITY.
- 4) WORK CREW TO COORDINATE WORK HOURS WITH SCHOOLS AFFECTED BY WORK SHOWN HEREON.

	Traffic Cone
	Temporary Sign
	Direction of Travel
	Flashing Arrow Sign (FAS)
	FAS Support or Trailer
	Portable Flashing Beacon
	Flagger
	Work Area
	Work Vehicle
	Signalized Intersection
	Type III Barricade with sign
	HLWD High Level Warning Device

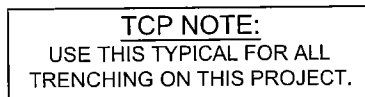













SCOPE OF WORK
**WORK CREW TO ACCESS (7) EX. UTILITY
 POLES TO PLACE FIBER OPTIC CABLE IN
 ORDER TO PROVIDE SERVICE TO
 CUSTOMER.**

SHEET DESCRIPTION:	SHEET
TCP SHEET 04	TC-04
DATE: 11/12/2015	
SCALE: AS SHOWN	

NOTES

- 1) CONE SPACING SHALL BE 25' MINIMUM.
- 2) TEMPORARY "NO PARKING" SIGNS SHALL BE INSTALLED AT 72 HOURS BEFORE ENFORCEMENT
- 3) WORK CREW TO COORDINATE WITH APPROPRIATE TRANSIT AUTHORITY. NOTIFICATION TO BE AT LEAST 36 HOURS PRIOR TO CONSTRUCTION AND MUST BE ACKNOWLEDGED BY SAID AUTHORITY.
- 4) WORK CREW TO COORDINATE WORK HOURS WITH SCHOOLS AFFECTED BY WORK SHOWN HEREON.

LEGEND

-  Traffic Cone
-  Temporary Sign
-  Direction of Travel
-  Flashing Arrow Sign (FAS)
-  FAS Support or Trailer
-  Portable Flashing Beacon
-  Flagger
-  Work Area
-  Work Vehicle
-  Signalized Intersection
-  Type III Barricade with sign
-  HLWD High Level Warning Device

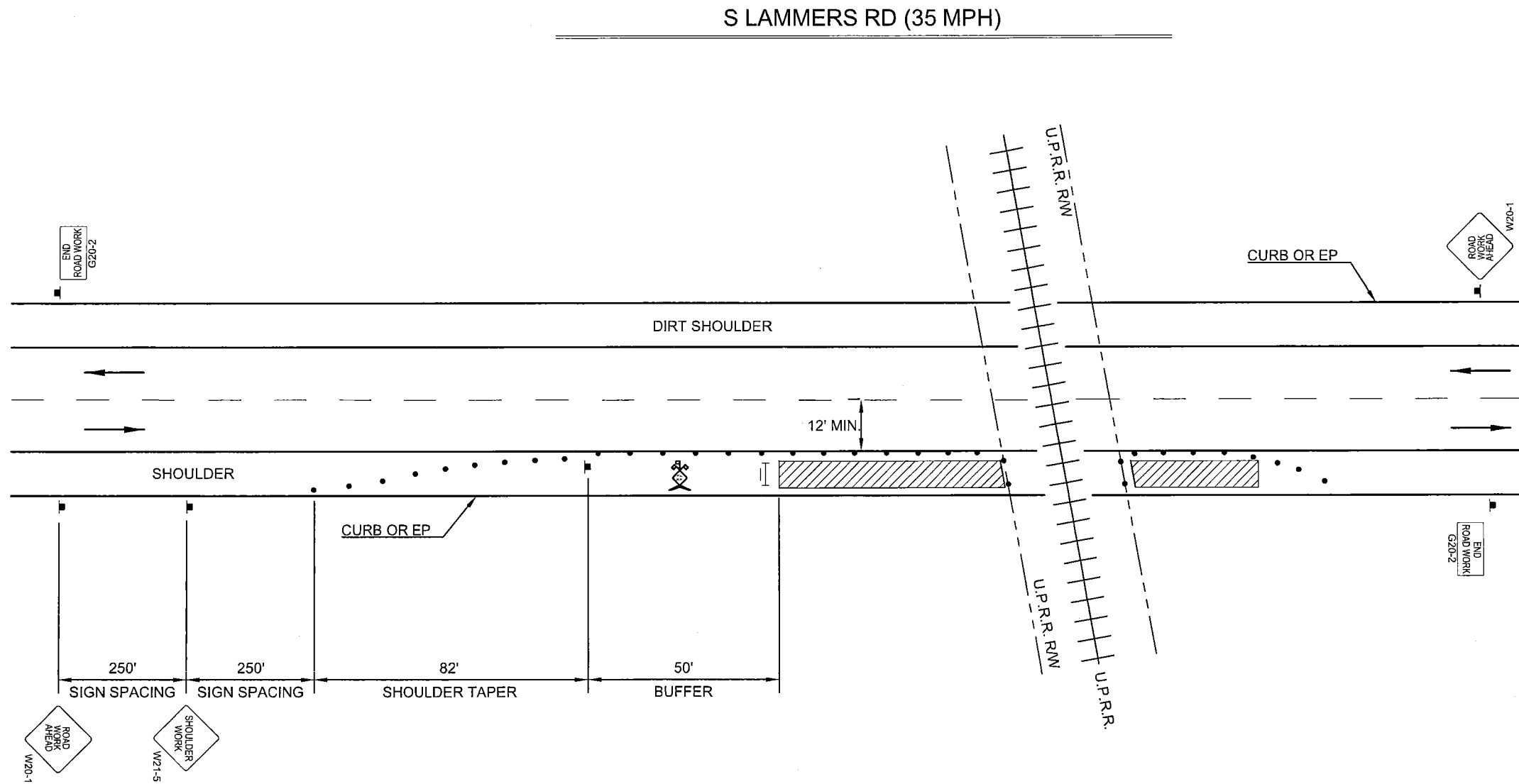

N.T.S.

SCOPE OF WORK
WORK CREW TO ACCESS (3) EX. UTILITY
POLES TO PLACE FIBER OPTIC CABLE IN
ORDER TO PROVIDE SERVICE TO
CUSTOMER.

PROJECT OWNER & ADDRESS

GROUP
2700 MERCED ST
SAN LEANDRO, CA. 94577

PROJECT NAME & ADDRESS

SITE #: 2.3 J
SITE NAME: PLEASANTON RING
S LAMMERS ROAD
TRACY, CA
95377

SHEET DESCRIPTION:

TCP SHEET 05

DATE: 11/12/2015

SCALE: AS SHOWN

SHEET

TC-05

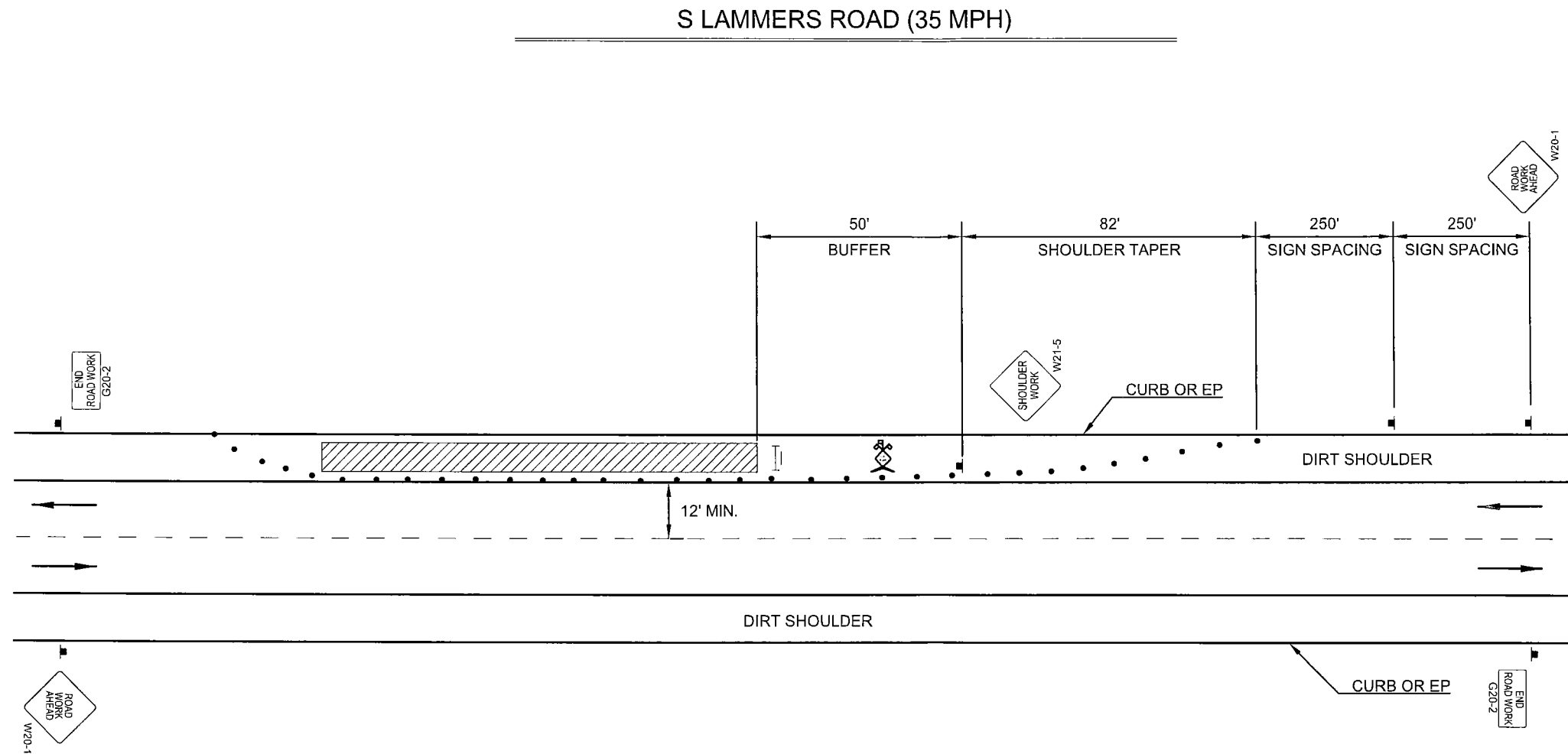

N.T.S.

SCOPE OF WORK
WORK CREW TO ACCESS (4) EX. UTILITY
POLES TO PLACE FIBER OPTIC CABLE IN
ORDER TO PROVIDE SERVICE TO
CUSTOMER.

NOTES

- 1) CONE SPACING SHALL BE 25' MINIMUM.
- 2) TEMPORARY "NO PARKING" SIGNS SHALL BE INSTALLED AT 72 HOURS BEFORE ENFORCEMENT
- 3) WORK CREW TO COORDINATE WITH APPROPRIATE TRANSIT AUTHORITY. NOTIFICATION TO BE AT LEAST 36 HOURS PRIOR TO CONSTRUCTION AND MUST BE ACKNOWLEDGED BY SAID AUTHORITY.
- 4) WORK CREW TO COORDINATE WORK HOURS WITH SCHOOLS AFFECTED BY WORK SHOWN HEREON.

LEGEND

- Traffic Cone
- Temporary Sign
- Direction of Travel
- Flashing Arrow Sign (FAS)
- FAS Support or Trailer
- Portable Flashing Beacon
- Flagger
- Work Area
- Work Vehicle
- Signalized Intersection
- Type III Barricade with sign
- HLWD High Level Warning Device

PROJECT OWNER & ADDRESS

GROUP
2700 MERCED ST
SAN LEANDRO, CA. 94577

PROJECT NAME & ADDRESS

SITE #: 2.3 J
SITE NAME: PLEASANTON RING
S LAMMERS ROAD
TRACY, CA
95377

SHEET DESCRIPTION:

TCP SHEET 06

DATE: 11/12/2015

SCALE: AS SHOWN

SHEET

TC-06



COUNTY OF SAN JOAQUIN

DEPARTMENT OF PUBLIC WORKS
P.O. BOX 1810-1810 E. HAZELTON AVENUE
STOCKTON, CALIFORNIA 95201
(209) 468-3000
FAX # (209) 468-9324

Permit No: **PS-1503575**
Date Issued: 12/14/2015
Start Date: 12/14/2015
Exp. Date: 01/15/2016
Project No: PWP7110005
Quad: SW

ENCROACHMENT PERMIT

To: ZAYO GROUP
75 E SANTA CLARA ST
SAN JOSE CA 95133

Encroachment Type:

Trench			
--------	--	--	--

Location:

LAMMERS RD 1337' N/O SCHULTE RD

In compliance with your request of **12/14/2015**, permission is hereby granted to do work in County right-of-way as shown on attached application and subject to all the terms, conditions and restrictions written below or printed as general or special provisions on any part of this form. See reverse side and attached sheet, if any.

Trench excavations for service connections will not be permitted within ten feet (10') of pavement centerline unless otherwise approved by the Director. Surface of trench patches shall match in kind and be smooth and even with that of abutting surface. Special attention shall be given to depth of utilities through roadside area in anticipation of future drainage facilities, road profile and/or frontage development. All underground utility facilities are to be established and accurately dimensioned on sketches from surveyed centerline of road right of way, or from right of way (border) lines.

Permittee shall call the Department of Public Works, Field Engineering Division (Permit Inspections) at (209)953-7421 at least forty-eight hours prior to beginning any work within the County right of way. All work performed under this permit shall conform to the rules and regulations pertaining to safety established by the California Division of Industrial Safety and Cal-OSHA.

The jobsite shall be kept in a safe condition at all times by the daily removal of any excess dirt or debris which might be a hazard to either pedestrian or automobile traffic. All necessary traffic convenience and warning devices and personnel shall be provided, placed and maintained by and at the sole expense of the Permittee in accordance with the latest edition of the CALTRANS Manual of Traffic Control.

After completion of the work permitted herein, all debris, lumber, barricades, or any excess material shall be removed and the jobsite left in a neat workmanlike manner. Immediately following completion of construction permitted herein, Permittee shall fill out and mail notice of completion (see attached post card) provided by Grantor.

Special Comments:

Traffic Control Per MUTCD

FORMS:	SS/WW, R-29		
--------	-------------	--	--

Est. Permit Fee: \$620.15

WHITE	-Permittee
GOLDENROD	-PWD Central File
YELLOW	-Field Inspection
PINK	-Permit Section

KRIS BALAJI, Director
Department of Public Works

By: [Signature]
Permit Section

ENCROACHMENT PERMIT GENERAL PROVISIONS

13-1

1. This permit is issued under and subject to all laws and ordinances of agencies governing the encroachment herein permitted. See the following references:

STREETS AND HIGHWAYS CODE

1. Division 1, Chapter 3
2. Division 2, Chapter 2, Section 942
3. Division 2, Chapter 4, Section 1126
4. Division 2, Chapter 5.5 and Chapter 6

SAN JOAQUIN COUNTY ORDINANCES NUMBERED: 324, 441, 648, 662, 672, 695, 700, 860, 892, 3359, and 3675.

2. It is understood and agreed by the Permittee that the performance of any work under this permit shall constitute an acceptance of all the provisions contained herein and failure on the Permittee's part to comply with any provision will be cause for revocation of this permit. Except as otherwise provided for public agencies and franchise holders, this permit is revocable on five days notice.
3. All work shall be done subject to the supervision of and the satisfaction of the grantor. The Permittee shall at all times during the progress of the work keep the County Highway in as neat and clean condition as is possible and upon completion of the work authorized herein, shall leave the County Highway in a thoroughly neat, clean and usable condition.
4. The Permittee also agrees by the acceptance of this permit to properly maintain any encroachment structure placed by the Permittee on any part of the County Highway and to immediately repair any damage to any portion of the highway, which occurs as a result of the maintenance of the said encroachment structure, until such time as the Permittee may be relieved of the responsibility for such maintenance by the County of San Joaquin.
5. The Permittee also agrees by the acceptance of this permit to make, at its own expense, such repairs as may be deemed necessary by the County Department of Public Works.
6. It is further agreed by the Permittee that whenever construction, reconstruction or maintenance work upon the highway is necessary, the installation provided for herein shall, upon request of the County Department of Public Works, be immediately moved or removed by and at the sole expense of the Permittee.
7. No material used for fill or backfill in the construction of the encroachment shall be borrowed or taken from within the County right of way.
8. All work shall be planned and carried out with as little inconvenience as possible to the traveling public. No material shall be stacked within eight feet (8') of the edge of the pavement or traveled way unless otherwise provided herein. Adequate provision shall be made for the protection of the traveling public. Traffic control standards shall be utilized including barricades; approved signs and lights; and flagmen, as required by the particular work in progress.
9. The Permittee, by the acceptance of this permit, shall assume full responsibility for all liability for personal injury or damage to property which may arise out of the work herein permitted or which may arise out of the failure of the part of the Permittee to properly perform the work provided under this permit. In the event any claim of such liability is made against the County of San Joaquin or any department, official or employee thereof, the Permittee shall defend, indemnify, and hold each of them harmless for such claim.
10. All backfill material is to be moistened as necessary and thoroughly compacted with mechanical means. If required by the County Director of Public Works, such backfill shall consist of gravel or crushed rock. The Permittee shall maintain the surface over structures placed hereunder as may be necessary to insure the return of the roadway to a completely stable condition and until relieved of such responsibility by the County Department of Public Works. Wherever a gravel, crushed rock or asphalt surface is removed or damaged in the course of work related to the permitted encroachment, such material shall either be separately stored and replaced in the roadway as nearly as possible in its original state or shall be replaced in kind, and the roadway shall be left in at least as good a condition as it was before the commencement of operations of placing the encroachment structure.
11. Whenever it becomes necessary to secure permission from abutting property owners for the proposed work, such authority must be secured by the Permittee prior to starting work.
12. The current and future safety and convenience of the traveling public shall be given every consideration in the location and methods of construction utilized.
13. The Permittee is responsible for the preservation of survey monuments located within the area of work herein permitted. Prior to the start of construction, survey monuments that potentially may be disturbed shall be located and referenced by a Licensed Land Surveyor, and a Corner Record filed with the County Surveyor. Any Survey Monuments disturbed during the course of construction shall be reestablished by a Licensed Land Surveyor and another Corner Record filed with the County Surveyor. (Land Surveyors' Act Section 8771)
14. Prior to any excavation, the Permittee shall notify USA North (Underground Service Alert of Northern California and Nevada) at 811 or 800-227-2600 forty-eight (48) hours in advance.

APPLICATION FOR ENCROACHMENT PERMIT

PLEASE PRINT:

Date 08/03/2015

To: San Joaquin County
Department of Public Works

JAMES SMALL
(Applicant Name)

2700 MERCED ST
(Mailing Address)

SAN LEANDRO, CA 94577
(City, State, Zip Code)

(916) 207-3637
(Area Code - Telephone Number)

OFFICE USE ONLY

JOB #	110005	REF #	
APN		CR #	
EXP. DATE	1-15-16		
VALID	12-14-15 TO 1-15-16	DRIVEWAYS:	
STREET	Lammers Rd	*	
AREA	Tracy	QUAD	9W
TYPE	Trench	*	
FORMS	99WWW R29	*	
NOTES			

Sketch (Detailed plans may be submitted)

The undersigned hereby applies for permission to excavate, construct and/or otherwise encroach on County Highway Right-of-Way on the WEST side of S LAMMERS ROAD approximately 1,331 feet/mile NORTH of W. SCHULTE ROAD, SAN JOAQUIN COUNTY, by performing the following work (description of work):
WORK CREWS TO ACCESS (22) UTILITY POLES & TRENCH AND PLACE 4695' OF CONDUIT AND SET UP TRAFFIC CONTROL. WORK CREW TO THEN PLACE FIBER OPTIC CABLE TO PROVIDE SERVICE TO A CUSTOMER.

Work will commence on or about 12-1-2015 for approximately 30 days.

I, the undersigned, certify that I am the owner of the respective property, or am qualified to represent the owner and agree to do the work described above in accordance with the rules and regulations of San Joaquin County and subject to inspection and approval.

Signature of Applicant - Title

11/13/2015
Date

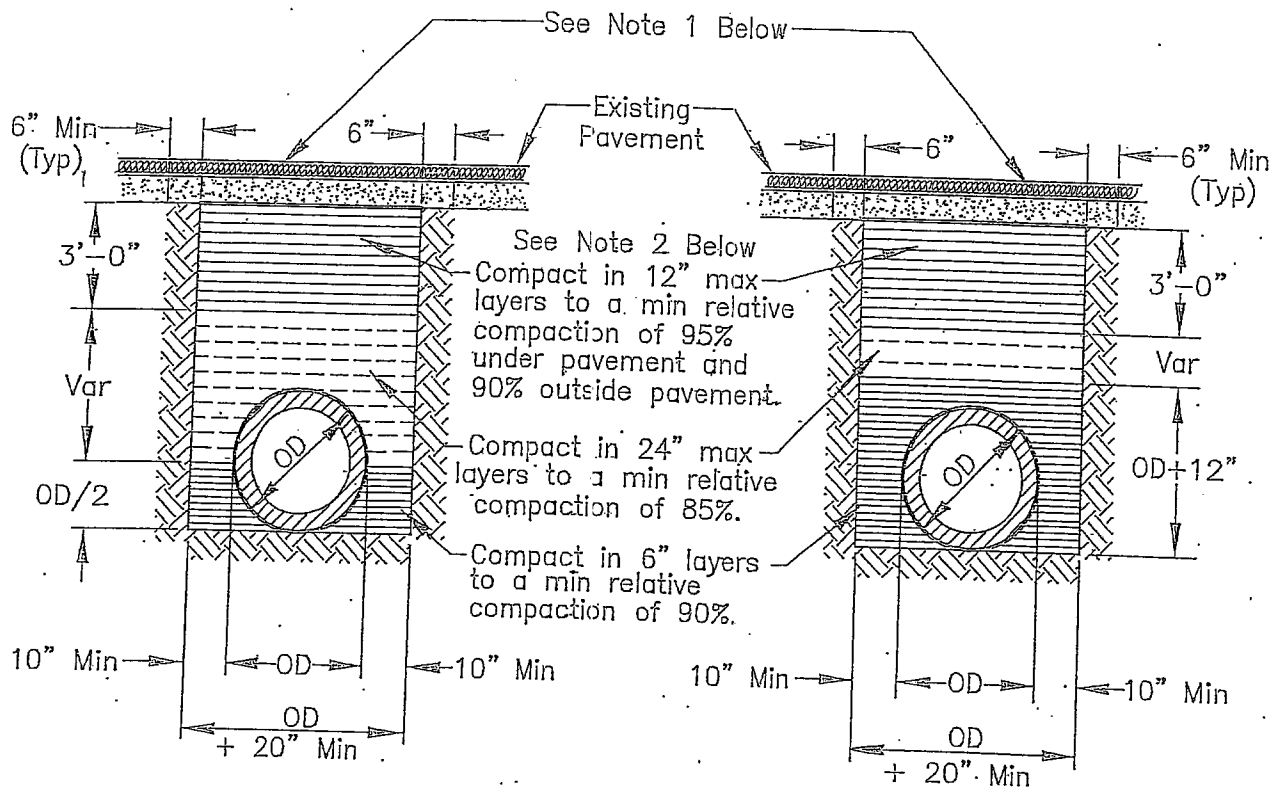

RIGID CONDUIT

FLEXIBLE CONDUIT

NOTES:

1. New pavement shall be 1" thicker than existing pavement, minimum of 0.25 Ft. New base shall be 1" thicker than existing base, min of 0.50 Ft.
2. Select native material or imported granular material as approved by the Director of Public Works. Backfill with materials equal to or better than the existing pavement and base in quality.
3. Relative compaction of materials shall be tested in accordance with the State of California, Dept. of Transportation Testing Manuals, test method No. California 216 or 231.
4. All existing pavement shall be neatly cut to line prior to trench excavation.
5. Jetting or ponding will be permitted within the street right-of-way with a 3 year bond, when approved by the Director of Public Works.
6. When shown by soil composition and compactability, ninety percent (90%) compaction may be used, when approved by the Director of Public Works.
7. Special bedding and backfill requirements may be shown on the plans or specified in the special provisions.

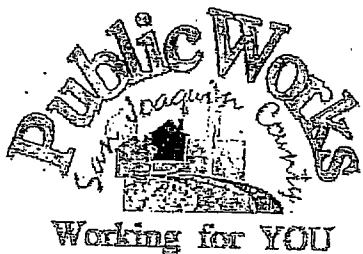

TYPICAL TRENCH BACKFILL

COUNTY OF SAN JOAQUIN
DEPARTMENT OF PUBLIC WORKS

Approved by:

Thomas M. Hall

No.	Revision	Description	Date

Std. Dwg. No.

R-29

Date: DEC 2014

GENERAL PROVISIONS

GOVERNING INSTALLATION OF SUBSURFACE STRUCTURES AND PIPELINES WITHIN COUNTY ROAD RIGHTS-OF-WAY

PUBLIC CONVENIENCE AND SAFETY:

- A. Before obstructing any private driveway entrance or County road traveled way with a trench, spoil bank, equipment or other barrier permitted for any prolonged period of time, the Permittee shall notify the known users of the respective thoroughfare(s) involved, and shall provide access for vehicular and pedestrian traffic to and from the road.
 - 1. Unless otherwise permitted, all work shall be conducted in such a manner that no less than one lane of the existing County road traveled way will be maintained open to public traffic during working hours in a smooth and safe riding condition(s). Two lanes shall be open after working hours.
 - 2. In cases where road closure is permitted, the permission to close the road will be granted under the condition that the Permittee notify the following persons and/or agencies of the time, the period of closure, and the detour route at least twenty-four (24) hours prior to said road closure.
 - a. The County of San Joaquin Public Works Department
 - b. The County of San Joaquin Sheriff's Office
 - c. The local postal service
 - d. The local fire district
 - e. The local school district
 - f. The local residents involved
- B. Should hazardous conditions relative to the installation operations warrant flagmen, as many capable flagmen as may be necessary shall be provided by the Permittee and stationed in advance of work to warn and direct traffic.
- C. Lights, signs and barricades shall be furnished, erected and maintained by the Permittee for the adequate warning and convenience of the public, with particular attention to be taken in this regard after dark.
- D. Any excess dirt and/or debris which might be a hazard to either automobile or pedestrian traffic, uncontrollable by lights, signs and barricades, shall be removed from the jobsite daily.

STRUCTURES:

- A. Walls of structures shall be such quality and strength that they will resist all pressures and will not crack or be deformed in such a way as to create a hazard or maintenance problem at any time. Therefore, the minimum structural requirements for concrete pipe placed under county road rights-of-way shall conform to the following American Association of State Highway and Transportation Officials (AASHTO) designations.
 - 1. For concrete pipe up to and including thirty-three inches (33") inside diameter, extra strength concrete conforming to AASHTO Designation M 170M.
 - 2. For concrete pipe thirty-six inches (36") inside diameter and larger, reinforced concrete pipe conforming to AASHTO Designation M 170M Class III.
 - 3. Plastic pipe conforming to AASHTO Designation M294.
- B. All concrete pipe joints with County road rights-of-way shall be sealed against leakage and/or infiltration with rubber gasket in conformance with Section 65-1.06 of the California Standard Specifications, or with other methods as may be permitted under the Special Provisions.
- C. Cast-in-place concrete pipe, vitrified clay pipe, spiral welded steel pipe, or corrugated aluminum alloy pipe shall not be installed within the County road rights-of-way unless specifically so stated in the Special Provisions, and only under the conditions as provided.
- D. All structures to be buried within the County rights-of-way shall be set at such elevations as to allow minimum coverage of thirty inches (30") to the centerline of the roadways and twelve inches (12") at the bottoms of borrow ditches each side of the roadways. The depths of structures shall be established below a flat plane extending across the rights-of-way, no part of which shall extend above the elevations stated above; manholes, lampholes, valves, etc. not included. Future surface elevations shall be anticipated as nearly as possible and structure elevations shall be established for future adjustments accordingly.
- E. The County hereby reserves the right to specify in the Special Provisions the gage and surface treatment of any galvanized corrugated metal pipe that is to be installed.
- F. All longitudinal utility facilities are to be established (and dimensioned on sketches) from surveyed centerline of road right-of-way, not from right-of-way (border) lines.

REPAIRS OF THE COUNTY RIGHT-OF-WAY:

- A. All excavations shall be backfilled and compacted immediately after work therein has been completed.
- B. Trenched shall not be left open farther than 300 feet in advance of pipe laying operations, or 200 feet to the rear thereof, unless otherwise permitted by the Engineer.
- C. Unless otherwise permitted under the Special Provisions, backfill shall be placed and mechanically compacted in such a manner that the relative compaction throughout the entire fill within the County road right-of-way shall conform to the percentages of compaction as shown on the Trench detail.
- D. Backfill material shall be placed in horizontal uniform layers not to exceed in thickness, before compaction, 0.67 foot in the bedding region, one-foot where 90% compaction is required, and two-feet where 80% compaction is required.
- E. No portion of the excavation(s) shall be compacted by ponding or jetting unless a maintenance bond is provided.
- F. Gravel backfill material shall be utilized only where specifically so stated on the face of the permit. It shall be compacted by means of a high-frequency internal vibrator, the compactor to be a size and type approved by the Engineer. Points of compaction shall not be greater than 18" centers and to the full depth of the lift.
- G. All pavements, curbs, gutters, sidewalks, borrow ditches, pipes, head walls, road signs, trees, shrubbery, and/or other permanent road facilities impaired by or as a result of construction operations at the construction site(s) occupied by materials and/or equipment, shall be restored immediately upon backfilling of the excavation to the original grades and cross sections, and to a condition as good as, or better than existing prior to construction.
- H. All surfacing materials of roadways and driveway approaches cut or damaged by or as a result of construction operations, shall be replaced within ONE WEEK following the backfilling of excavation, weather permitting, with compacted layers of surfacing materials at least as thick as the existing, and no less than two inches (2") of asphalt concrete over six inches (6") of aggregate base, both as specified below.
 - 1. Asphalt Concrete: Combined mineral aggregate shall conform to the quality and gradation requirements for Type "B" one-half inch (1/2) maximum aggregate, coarse or medium gradation as specified in Section 39 of the California Standard Specifications. The bituminous binder to be mixed with mineral aggregate shall be paving asphalt having (Grade PG 64-10), unless otherwise directed by the Engineer. Placement of asphalt concrete surfacing shall conform to the applicable provisions of Section 39 of the California Standard Specifications.
 - 2. Aggregate Base: Combined mineral aggregates shall conform to the quality and the grading for three-quarter inch (3/4") maximum size aggregate Class 2 Aggregate Base specified in Section 26 of the California Standard Specifications.
- I. Before acceptance of repairs to the County road rights-of-way, all unsightly and detrimental dirt, dust and/or debris shall be removed and the construction areas left in a neat and presentable condition(s).
 - 1. If necessary, County road traveled way and driveway pavements shall be washed with water to remove dirt and dust.
 - 2. Driveway approaches and field entrance pavements damaged by equipment or spoil banks shall be repaired as directed by the Engineer.
- J. Upon request by the County, any settlement, sagging of surface, or cracking of pavement shall be repaired immediately by and at the sole expense of the Permittee for a period of one year following acceptance of the work.

SPECIAL PROVISIONS

Winter Weather Utility Work

1. **SUPERVISION:** The utility company (**permittee**) shall furnish full-time supervision of all work to insure compliance with the permit provision.
2. **START OF WORK:** No work within the County right-of-way shall be started until the utility company representative has made an evaluation of weather conditions and has determined the work can be accomplished under the provisions of the permit.
3. **CLEAN PAVEMENT:** Dirt and mud shall not be deposited on the pavement outside the area of work, and if inadvertently tracked onto the road travel way shall be removed immediately.
4. **DAILY RESTORATION:** Private driveways and road intersections shall be restored daily.
5. **WEATHER-TIGHT CONDITIONS:** All trenches shall be filled and compacted, ditches and other drainage facilities regarded and opened, and the entire work area restored to weather-tight condition prior to any rain.