



COUNTY OF SAN JOAQUIN

DEPARTMENT OF PUBLIC WORKS
P.O. BOX 1810-1810 E. HAZELTON AVENUE
STOCKTON, CALIFORNIA 95201
(209) 468-3000
FAX # (209) 468-9324

Permit No: **PS-1803094**
Date Issued: 08/27/2018
Start Date: 08/20/2018
Exp. Date: 01/01/2019
Project No: PWP730079
Quad: NE

UE/CR/PM NO:9743405

ENCROACHMENT PERMIT

To: AT & T - FRESNO
5555 E. OLIVE RM#300III
FRESNO, CA 93727

Encroachment Type:

TCP			
-----	--	--	--

Location:

E/S THORNTON RD 10' N/O KILE RD

In compliance with your request of **08/27/2018**, permission is hereby granted to do work in County right-of-way as shown on attached application and subject to all the terms, conditions and restrictions written below or printed as general or special provisions on any part of this form. See reverse side and attached sheet, if any.

Trench excavations for service connections will not be permitted within ten feet (10') of pavement centerline unless otherwise approved by the Director. Surface of trench patches shall match in kind and be smooth and even with that of abutting surface. Special attention shall be given to depth of utilities through roadside area in anticipation of future drainage facilities, road profile and/or frontage development. All underground utility facilities are to be established and accurately dimensioned on sketches from surveyed centerline of road right of way, or from right of way (border) lines.

Permittee shall call the Department of Public Works, Field Engineering Division (Permit Inspections) at (209)953-7421 at least **forty-eight hours prior to beginning any work within the County right of way**. All work performed under this permit shall conform to the rules and regulations pertaining to safety established by the California Division of Industrial Safety and Cal-OSHA.

The jobsite shall be kept in a safe condition at all times by the daily removal of any excess dirt or debris which might be a hazard to either pedestrian or automobile traffic. All necessary traffic convenience and warning devices and personnel shall be provided, placed and maintained by and at the sole expense of the Permittee in accordance with the latest edition of the CALTRANS Manual of Traffic Control.

After completion of the work permitted herein, all debris, lumber, barricades, or any excess material shall be removed and the jobsite left in a neat workmanlike manner. Immediately following completion of construction permitted herein, Permittee shall fill out and mail notice of completion (see attached post card) provided by Grantor.

Special Comments:

Traffic Control Per MUTCD*****See Attached "Special Conditions"*****
--

FORMS:

SS/WW		
-------	--	--

Est. Permit Fee: \$436.00

KRIS BALAJI, Director
Department of Public Works

WHITE -Permittee
GOLDENROD -PWD Central File
YELLOW -Field Inspection
PINK -Permit Section

By: 
Permit Section

ENCROACHMENT PERMIT GENERAL PROVISIONS

13-1

1. This permit is issued under and subject to all laws and ordinances of agencies governing the encroachment herein permitted. See the following references:
STREETS AND HIGHWAYS CODE
 1. Division 1, Chapter 3
 2. Division 2, Chapter 2, Section 942
 3. Division 2, Chapter 4, Section 1126
 4. Division 2, Chapter 5.5 and Chapter 6

SAN JOAQUIN COUNTY ORDINANCES NUMBERED: 324, 441, 648, 662, 672, 695, 700, 860, 892, 3339, and 3675.

2. It is understood and agreed by the Permittee that the performance of any work under this permit shall constitute an acceptance of all the provisions contained herein and failure on the Permittee's part to comply with any provision will be cause for revocation of this permit. Except as otherwise provided for public agencies and franchise holders, this permit is revocable on five days notice.
3. All work shall be done subject to the supervision of and the satisfaction of the grantor. The Permittee shall at all times during the progress of the work keep the County Highway in as neat and clean condition as is possible and upon completion of the work authorized herein, shall leave the County Highway in a thoroughly neat, clean and usable condition.
4. The Permittee also agrees by the acceptance of this permit to properly maintain any encroachment structure placed by the Permittee on any part of the County Highway and to immediately repair any damage to any portion of the highway, which occurs as a result of the maintenance of the said encroachment structure, until such time as the Permittee may be relieved of the responsibility for such maintenance by the County of San Joaquin.
5. The Permittee also agrees by the acceptance of this permit to make, at its own expense, such repairs as may be deemed necessary by the County Department of Public Works.
6. It is further agreed by the Permittee that whenever construction, reconstruction or maintenance work upon the highway is necessary, the installation provided for herein shall, upon request of the County Department of Public Works, be immediately moved or removed by and at the sole expense of the Permittee.
7. No material used for fill or backfill in the construction of the encroachment shall be borrowed or taken from within the County right of way.
8. All work shall be planned and carried out with as little inconvenience as possible to the traveling public. No material shall be stacked within eight feet (8') of the edge of the pavement or traveled way unless otherwise provided herein. Adequate provision shall be made for the protection of the traveling public. Traffic control standards shall be utilized including barricades; approved signs and lights; and flagmen, as required by the particular work in progress.
9. The Permittee, by the acceptance of this permit, shall assume full responsibility for all liability for personal injury or damage to property which may arise out of the work herein permitted or which may arise out of the failure of the part of the Permittee to properly perform the work provided under this permit. In the event any claim of such liability is made against the County of San Joaquin or any department, official or employee thereof, the Permittee shall defend, indemnify, and hold each of them harmless for such claim.
10. All backfill material is to be moistened as necessary and thoroughly compacted with mechanical means. If required by the County Director of Public Works, such backfill shall consist of gravel or crushed rock. The Permittee shall maintain the surface over structures placed hereunder as may be necessary to insure the return of the roadway to a completely stable condition and until relieved of such responsibility by the County Department of Public Works. Wherever a gravel, crushed rock or asphalt surface is removed or damaged in the course of work related to the permitted encroachment, such material shall either be separately stored and replaced in the roadway as nearly as possible in its original state or shall be replaced in kind, and the roadway shall be left in at least as good a condition as it was before the commencement of operations of placing the encroachment structure.
11. Whenever it becomes necessary to secure permission from abutting property owners for the proposed work, such authority must be secured by the Permittee prior to starting work.
12. The current and future safety and convenience of the traveling public shall be given every consideration in the location and methods of construction utilized.
13. The Permittee is responsible for the preservation of survey monuments located within the area of work herein permitted. Prior to the start of construction, survey monuments that potentially may be disturbed shall be located and referenced by a Licensed Land Surveyor, and a Corner Record filed with the County Surveyor. Any Survey Monuments disturbed during the course of construction shall be reestablished by a Licensed Land Surveyor and another Corner Record filed with the County Surveyor. (Land Surveyors' Act Section 8771)
14. Prior to any excavation, the Permittee shall notify USA North (Underground Service Alert of Northern California and Nevada) at 811 or 800-227-2600 forty-eight (48) hours in advance.

APPLICATION FOR ENCROACHMENT PERMIT

PLEASE PRINT:

Date 7/18/18

To: San Joaquin County
Department of Public Works

ANDREW QUEIROLO / LASAR UNDERGROUND AT&T
(Applicant Name)

2565 N SUNNYSIDE AVE
(Mailing Address)

FRESNO CA 95727
(City, State, Zip Code)

(209) 400-7075
(Area Code - Telephone Number)

trafficplanrequest@gmail.com
(Email Address)

trafficplanrequest@gmail.com

OFFICE USE ONLY	
JOB #	<u>110005</u> REF #
APN	CR #
EXP. DATE	
VALID	TO
STREET	
AREA	QUAD
TYPE	
FORMS	
NOTES	
DRIVEWAYS:	
*	
*	
*	

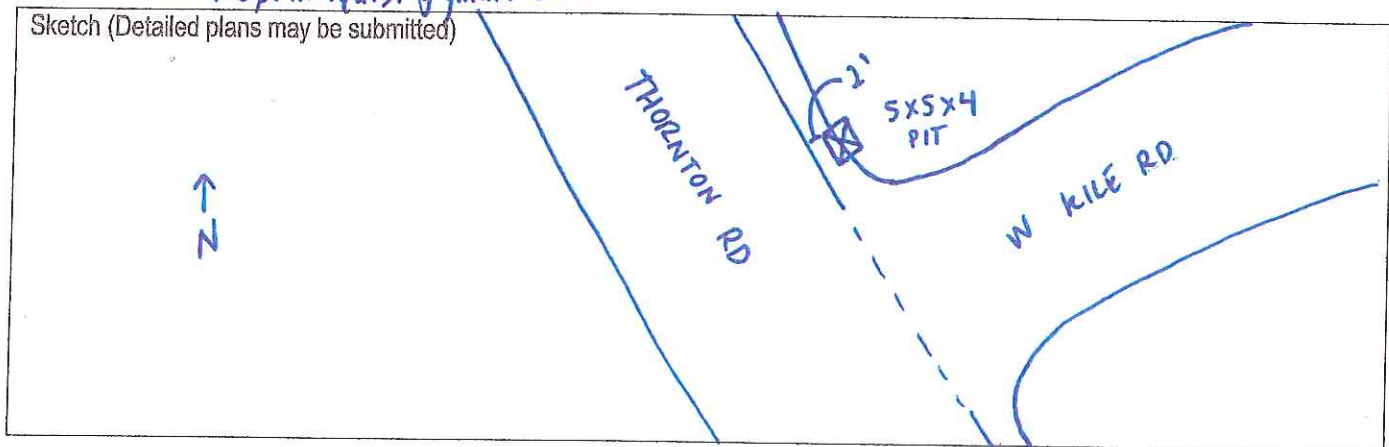

The undersigned hereby applies for permission to excavate, construct and/or otherwise encroach on County Highway Right-of-Way on the EAST side of THORNTON RD approximately 10 feet mile NORTH of WEST KILE RD, by performing the following work (description of work):

DIG A 5X5X4 PIT TO REPAIR A TELEPHONE SPLICE. BACKFILL AND PLACE TEMPORARY ASPHALT, PAVE

Work will commence on or after 7/26 for approximately 1 days.

I, the undersigned, certify that I am the owner of the respective property, or am qualified to represent the owner and agree to do the work described above in accordance with the rules and regulations of San Joaquin County and subject to inspection and approval.

[Signature]

PERMIT COORDINATOR

Signature of Applicant - Title

7/18/18
Date

Work Address: 24026 N. THORNTON RD

• Work Description:

Dig a 5x5x4ft pit to repair a telephone splice that is 2ft East from the fog line in road

JOB#: 9743405

VICINITY MAP



BUILD

Bore Footage:	~0'
Bore Pits:	0
Potholes (2X2):	0
New B36 Vaults:	0
Existing Vault(s):	0
New Pedestals:	0
Existing Pedestals:	0
Overpull Existing Conduit:	~0'

LEGEND

Cover-Title	#1
Symbolology & Abbreviations	#2
Construction Plans	#2
Underground Details	#3

THIS IS AN COMCAST DOCUMENT, PROPRIETARY & CONFIDENTIAL

DESIGN:	REV	DESCRIPTION	DATE
DRAWN BY:			
APPROVED:			
APPROVED:			

24026 N. THORNTON RD, THORNTON

PROJ#: 9743405

CONSTRUCTION TYPE: Dig pit to repair phone splice.

SYSTEM:

NODE:

SHEET: 1 OF 2

mph		feet		Cones Spacing - feet	
SPEED	TAPER	SIGN SPACING	TAPER	TANGENT	
25	125'	100'	25'	50	
30	180'	250'	30'	60	
35	245'	500'	35'	70	
40	320'		40'	80	
45	540'		45'	90	
50	600'	Shoulder(1/3taper)		50	100

SIGNS BEING USED

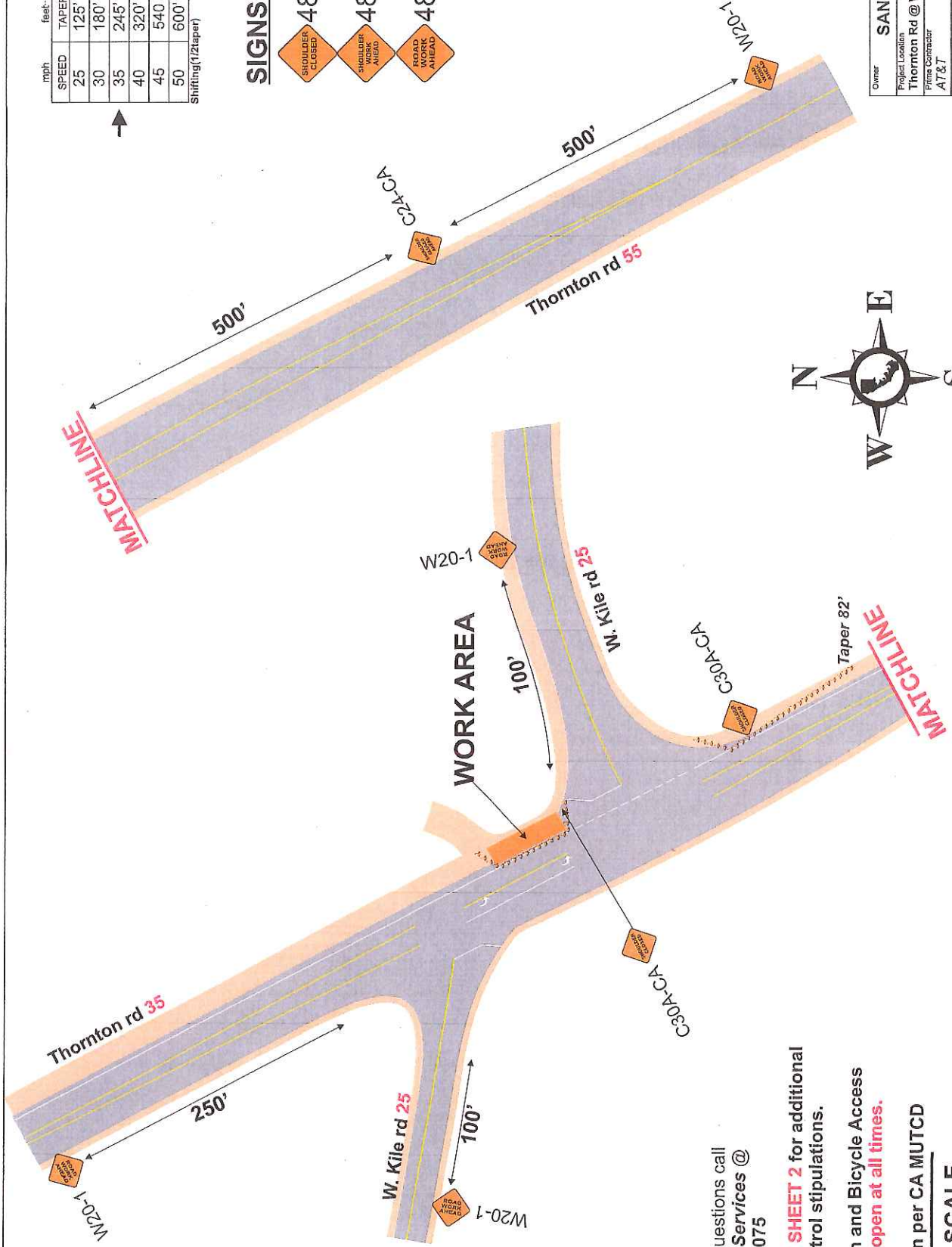
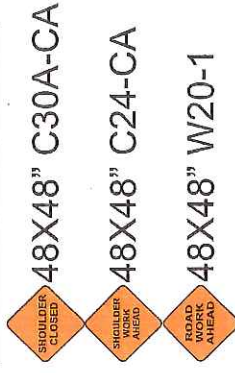

For TCP questions call
City Rise Services @
209-400-7075

See **SHEET 2** for additional
traffic control stipulations.

Pedestrian and Bicycle Access
to remain **open at all times**.

Traffic plan per CA MUTCD

NOT TO SCALE

HOURS OF WORK SHALL BE DETERMINED BY SAN JAUQUIN COUNTY

Owner		SAN JAUQUIN COUNTY	
Project Location	Thornton Rd @ W. Kile Rd	Project City	Thornton, CA
Prime Contractor	AT&T	Traffic Control Contractor	City Rise Services, Inc.
Phone	209-333-0807	Sheet Number	PS-1
Prepared By	CITY RISE SERVICES, INC.		
		Date	7/16/2018