



COUNTY OF SAN JOAQUIN

DEPARTMENT OF PUBLIC WORKS
P.O. BOX 1810-1810 E. HAZELTON AVENUE
STOCKTON, CALIFORNIA 95201
(209) 468-3000
FAX # (209) 468-9324

Permit No: PS-1602799
Date Issued: 09/09/2016
Start Date: 09/12/2016
Exp. Date: 12/29/2017
Project No: PWP221601
Quad: LV
Extended To: 12/15/2018

ENCROACHMENT PERMIT

To: RAMSEY MEDEIROS
GOODFELLOW TOP GRADE CONSTRUCTION
94551

RIDER # 1
Date 4/12/18

Encroachment Type:

Road Widening	SW, C&G	Traffic Signal	
---------------	---------	----------------	--

Location:

Thornton Road from Bear Creek to Pershing Ave

In compliance with your request of **09/06/2016**, permission is hereby granted to do work in County right-of-way as shown on attached application and subject to all the terms, conditions and restrictions written below or printed as general or special provisions on any part of this form. See reverse side and attached sheet, if any.

Trench excavations for service connections will not be permitted within ten feet (10') of pavement centerline unless otherwise approved by the Director. Surface of trench patches shall match in kind and be smooth and even with that of abutting surface. Special attention shall be given to depth of utilities through roadside area in anticipation of future drainage facilities, road profile and/or frontage development. All underground utility facilities are to be established and accurately dimensioned on sketches from surveyed centerline of road right of way, or from right of way (border) lines.

Permittee shall call the Department of Public Works, Field Engineering Division (Permit Inspections) at (209)953-7421 at least **forty-eight hours prior to beginning any work within the County right of way**. All work performed under this permit shall conform to the rules and regulations pertaining to safety established by the California Division of Industrial Safety and Cal-OSHA.

The jobsite shall be kept in a safe condition at all times by the daily removal of any excess dirt or debris which might be a hazard to either pedestrian or automobile traffic. All necessary traffic convenience and warning devices and personnel shall be provided, placed and maintained by and at the sole expense of the Permittee in accordance with the latest edition of the CALTRANS Manual of Traffic Control.

After completion of the work permitted herein, all debris, lumber, barricades, or any excess material shall be removed and the jobsite left in a neat workmanlike manner. Immediately following completion of construction permitted herein, Permittee shall fill out and mail notice of completion (see attached post card) provided by Grantor.

Special Comments:

Traffic Control Per MUTCD and approved plans****See attached Special Conditions****WAUDMAN AVE. CLOSED ON MONDAY (4/16/2018) FROM 7:00 AM TO 4:30 PM*****

FORMS: SS/WW, R-29

Est. Permit Fee: \$0.00

WHITE -Permittee
GOLDENROD -PWD Central File
YELLOW -Field Inspection
PINK -Permit Section

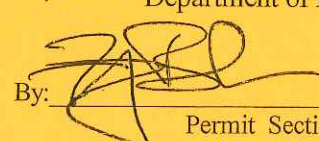
 KRIS BALAJI, Director
Department of Public Works

By: Permit Section

ENCROACHMENT PERMIT GENERAL PROVISIONS

13-1

1. This permit is issued under and subject to all laws and ordinances of agencies governing the encroachment herein permitted. See the following references:
STREETS AND HIGHWAYS CODE
 1. Division 1, Chapter 3
 2. Division 2, Chapter 2, Section 942
 3. Division 2, Chapter 4, Section 1126
 4. Division 2, Chapter 5.5 and Chapter 6
- SAN JOAQUIN COUNTY ORDINANCES NUMBERED: 324, 441, 648, 662, 672, 695, 700, 860, 892, 3359, and 3675.
2. It is understood and agreed by the Permittee that the performance of any work under this permit shall constitute an acceptance of all the provisions contained herein and failure on the Permittee's part to comply with any provision will be cause for revocation of this permit. Except as otherwise provided for public agencies and franchise holders, this permit is revocable on five days notice.
 3. All work shall be done subject to the supervision of and the satisfaction of the grantor. The Permittee shall at all times during the progress of the work keep the County Highway in as neat and clean condition as is possible and upon completion of the work authorized herein, shall leave the County Highway in a thoroughly neat, clean and usable condition.
 4. The Permittee also agrees by the acceptance of this permit to properly maintain any encroachment structure placed by the Permittee on any part of the County Highway and to immediately repair any damage to any portion of the highway, which occurs as a result of the maintenance of the said encroachment structure, until such time as the Permittee may be relieved of the responsibility for such maintenance by the County of San Joaquin.
 5. The Permittee also agrees by the acceptance of this permit to make, at its own expense, such repairs as may be deemed necessary by the County Department of Public Works.
 6. It is further agreed by the Permittee that whenever construction, reconstruction or maintenance work upon the highway is necessary, the installation provided for herein shall, upon request of the County Department of Public Works, be immediately moved or removed by and at the sole expense of the Permittee.
 7. No material used for fill or backfill in the construction of the encroachment shall be borrowed or taken from within the County right of way.
 8. All work shall be planned and carried out with as little inconvenience as possible to the traveling public. No material shall be stacked within eight feet (8') of the edge of the pavement or traveled way unless otherwise provided herein. Adequate provision shall be made for the protection of the traveling public. Traffic control standards shall be utilized including barricades; approved signs and lights; and flagmen, as required by the particular work in progress.
 9. The Permittee, by the acceptance of this permit, shall assume full responsibility for all liability for personal injury or damage to property which may arise out of the work herein permitted or which may arise out of the failure of the part of the Permittee to properly perform the work provided under this permit. In the event any claim of such liability is made against the County of San Joaquin or any department, official or employee thereof, the Permittee shall defend, indemnify, and hold each of them harmless for such claim.
 10. All backfill material is to be moistened as necessary and thoroughly compacted with mechanical means. If required by the County Director of Public Works, such backfill shall consist of gravel or crushed rock. The Permittee shall maintain the surface over structures placed hereunder as may be necessary to insure the return of the roadway to a completely stable condition and until relieved of such responsibility by the County Department of Public Works. Wherever a gravel, crushed rock or asphalt surface is removed or damaged in the course of work related to the permitted encroachment, such material shall either be separately stored and replaced in the roadway as nearly as possible in its original state or shall be replaced in kind, and the roadway shall be left in at least as good a condition as it was before the commencement of operations of placing the encroachment structure.
 11. Whenever it becomes necessary to secure permission from abutting property owners for the proposed work, such authority must be secured by the Permittee prior to starting work.
 12. The current and future safety and convenience of the traveling public shall be given every consideration in the location and methods of construction utilized.
 13. The Permittee is responsible for the preservation of survey monuments located within the area of work herein permitted. Prior to the start of construction, survey monuments that potentially may be disturbed shall be located and referenced by a Licensed Land Surveyor, and a Corner Record filed with the County Surveyor. Any Survey Monuments disturbed during the course of construction shall be reestablished by a Licensed Land Surveyor and another Corner Record filed with the County Surveyor. (Land Surveyors' Act Section 8771)
 14. Prior to any excavation, the Permittee shall notify USA North (Underground Service Alert of Northern California and Nevada) at 811 or 800-227-2600 forty-eight (48) hours in advance.

SPECIAL CONDITIONS FOR
ENCROACHMENT PERMIT
RIDER

1. Maintain traffic controls for all roads. Traffic control delays shall not exceed 15 minutes. Two-way traffic shall be maintained during non-working hours with excavated areas backfilled or plated. During working hours, two-way traffic control shall be maintained with one lane open and appropriate flaggers.
2. Waudman Avenue CLOSED on Monday (4/16/2018) from 7:00 AM to 4:30 PM.
3. Access to all properties shall be maintained at all times except when work is occurring at the access point. Minimal delays will be allowed to provide access within the work zone area. Driveway access shall be fully restored at the end of each workday. Driveways disturbed by the contractor shall be replaced with in-kind or better materials.
4. Residents and businesses shall be notified in writing, as approved by the County, 48 hours in advance of any impacts to their access.
5. Any areas where parking is to be restricted shall have signs noting the restrictions in place at least 48 hours in advance.
6. Existing fences shall not be removed without written consent of the property owner. Such consent shall be submitted to the County prior to the removal. Fences removed shall be restored with in-kind or better materials. Restored fences shall not encroach into County right-of-way.
7. All destroyed or obliterated pavement markings must be replaced in kind by the permittee. Typical pavement markings include but not limited to lane lines, centerlines, stop and stop ahead legends, limit lines, raised pavement markers and miscellaneous delineators.
8. The Permittee is responsible for the preservation of survey monuments located within the area of work herein permitted. Prior to the start of construction, survey monuments that potentially may be disturbed shall be located and referenced by a Licensed Land Surveyor, and a Corner Record filed with the County Surveyor. Any Survey Monuments disturbed during the course of construction shall be reestablished by a Licensed Land Surveyor and another Corner Record filed with the County Surveyor. (Land Surveyors' Act Section 8771)
9. All future maintenance of the pipeline and related facilities within the County right-of-way will require a San Joaquin County Encroachment Permit.
10. Trenches shall be maintained in a smooth and even condition to the satisfaction of the County throughout the project limits at all times.
11. All trenches shall be completely backfilled or shored and plated at the end of each workday, and the roadway restored to two-way traffic. If plating is to be used, a trench shoring and plating plan suitable for traffic loadings shall be prepared by a registered civil engineer and submitted for prior approval by the County.

12. The contractor shall use San Joaquin County Improvement Standard R-29 when backfilling trenches within the County right-of-way. Where the existing road structural section is below standard, a minimum section of 3 inches of asphalt concrete over 8 inches of aggregate base shall be required.
13. Areas of Thornton Road subject to pavement cuts shall be repaired per San Joaquin County Department of Public Works Improvement Standards Section 2-5.0 Trench Cut Policy.
14. Final paving for trench repair or road resurfacing shall be per Caltrans' specifications and shall not occur between November 1 and March 31, without prior authorization from the San Joaquin County Department of Public Works Field Engineering Division, contact them at 209-953-7421.
15. No paving joints are allowed within paved shoulder; contractor shall pave all the way to outer edge of paved shoulder.
16. All standard roadway striping and signage shall be clearly visible, maintained and restored throughout the construction zone during and after the project.
17. In addition to standard dust control measures, streets shall be maintained in a clean condition, free of dirt, mud and debris during construction activities. The contractor shall provide daily, or as needed, street sweeping using a modern mechanical or vacuum-assisted street sweeper.
18. The contractor shall not conduct construction operations in rain or heavy fog conditions.

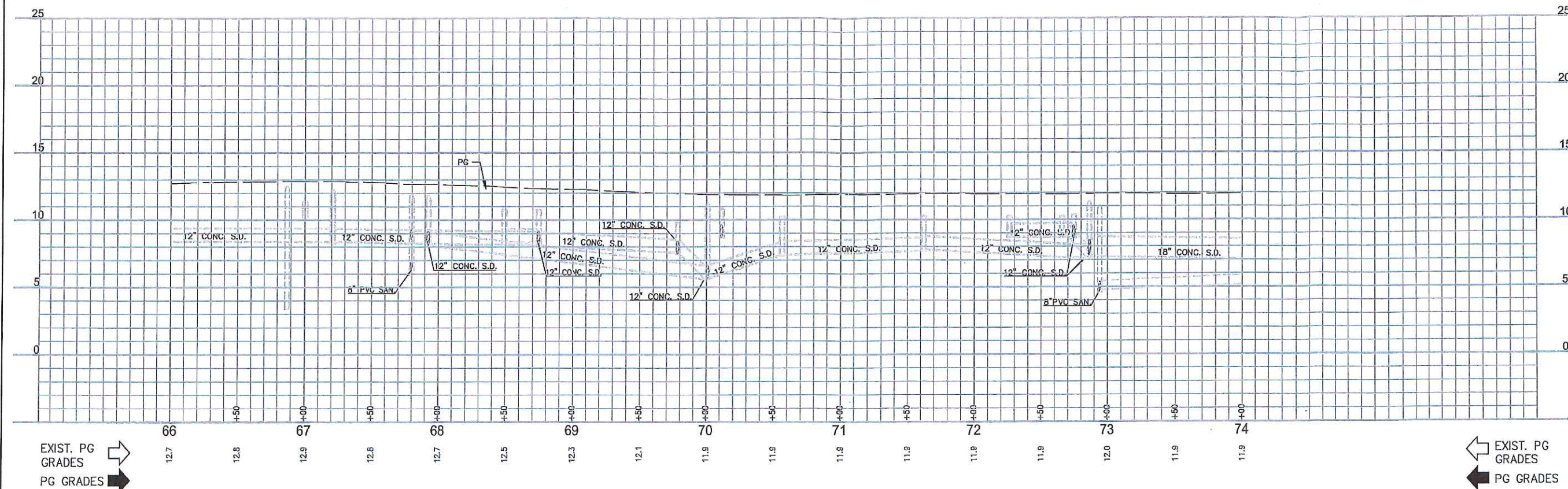

THORNTON ROAD

CURVE DATA				
#	R	Δ	T	L
30	330.12'	23°23'57"	68.36'	134.82'

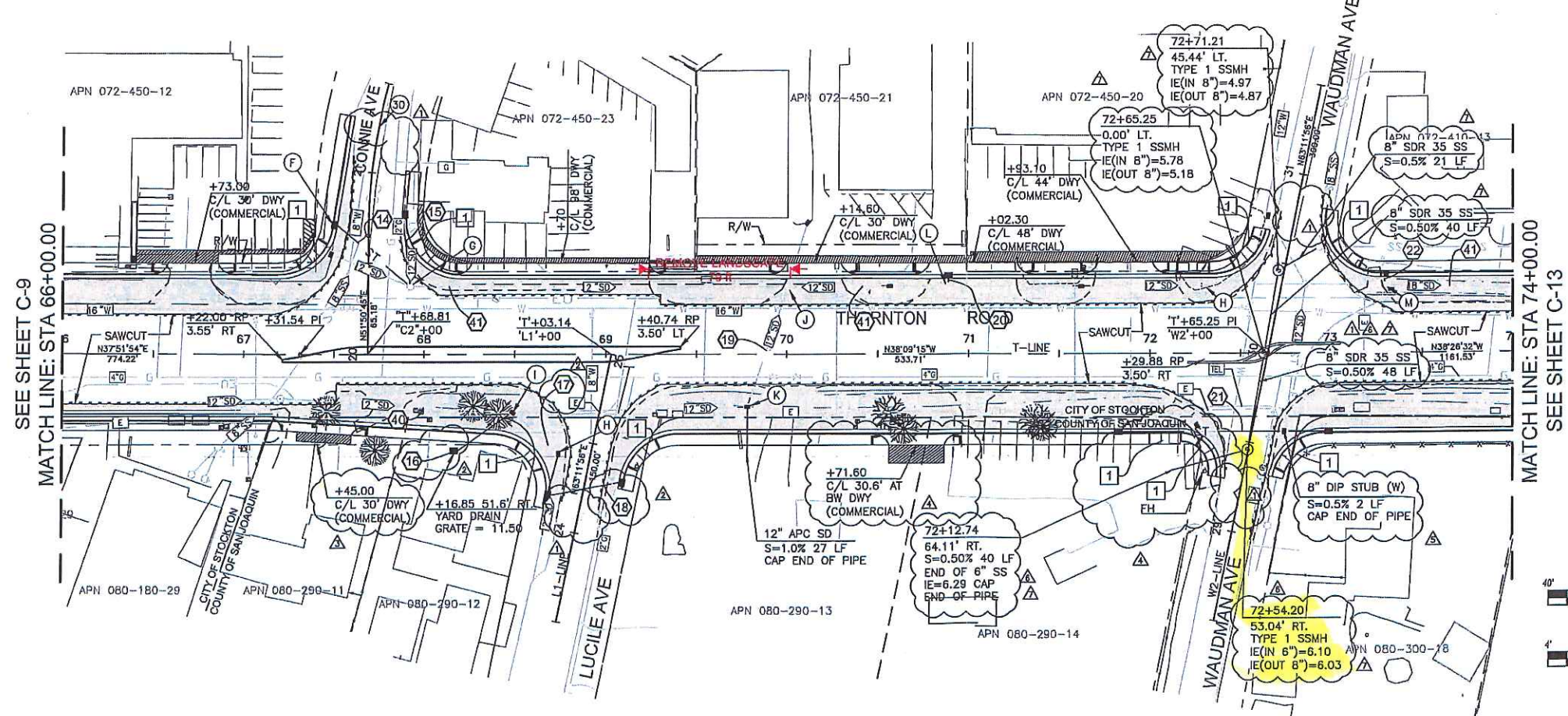

SHEET NOTES:
 1 CURB RAMP PER CITY OF STOCKTON STANDARD DWG. 32.

- LEGEND**
- (10) DRAINAGE SYSTEM NUMBER
 - (A) STORM DRAIN COMMON POINT
 - [] PAVEMENT LIMITS

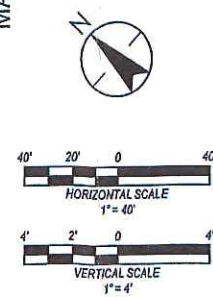

NOTE: PLAN IS ACCURATE FOR ROAD WORK ONLY.



Rev	Date	Description	By	Appd.
1	10/17	SANITARY SEWER MODS	CJA	
2	08/17	RFI 215 SANITARY SEWER MODS	CJA	
3	06/17	STORM DRAIN STUD	CJA	
4	05/17	CURB RETURN ADJUSTMENTS FOR DRELLY	CJA	
5	04/17	CURB AND DRAINWAY REVISIONS	CJA	
6	11/16	STORM DRAIN AND SIDEWALK REVISIONS	CJA	
7	09/16	BIDDING REVISIONS	CJA	
8	08/16		CJA	
9	07/16		CJA	
10	06/16		CJA	
11	05/16		CJA	
12	04/16		CJA	
13	03/16		CJA	
14	02/16		CJA	
15	01/16		CJA	
16	12/15		CJA	
17	11/15		CJA	
18	10/15		CJA	
19	09/15		CJA	
20	08/15		CJA	
21	07/15		CJA	
22	06/15		CJA	
23	05/15		CJA	
24	04/15		CJA	
25	03/15		CJA	
26	02/15		CJA	
27	01/15		CJA	
28	12/14		CJA	
29	11/14		CJA	
30	10/14		CJA	
31	09/14		CJA	
32	08/14		CJA	
33	07/14		CJA	
34	06/14		CJA	
35	05/14		CJA	
36	04/14		CJA	
37	03/14		CJA	
38	02/14		CJA	
39	01/14		CJA	
40	12/13		CJA	
41	11/13		CJA	
42	10/13		CJA	
43	09/13		CJA	
44	08/13		CJA	
45	07/13		CJA	
46	06/13		CJA	
47	05/13		CJA	
48	04/13		CJA	
49	03/13		CJA	
50	02/13		CJA	
51	01/13		CJA	
52	12/12		CJA	
53	11/12		CJA	
54	10/12		CJA	
55	09/12		CJA	
56	08/12		CJA	
57	07/12		CJA	
58	06/12		CJA	
59	05/12		CJA	
60	04/12		CJA	
61	03/12		CJA	
62	02/12		CJA	
63	01/12		CJA	
64	12/11		CJA	
65	11/11		CJA	
66	10/11		CJA	
67	09/11		CJA	
68	08/11		CJA	
69	07/11		CJA	
70	06/11		CJA	
71	05/11		CJA	
72	04/11		CJA	
73	03/11		CJA	
74	02/11		CJA	
75	01/11		CJA	
76	12/10		CJA	
77	11/10		CJA	
78	10/10		CJA	
79	09/10		CJA	
80	08/10		CJA	
81	07/10		CJA	
82	06/10		CJA	
83	05/10		CJA	
84	04/10		CJA	
85	03/10		CJA	
86	02/10		CJA	
87	01/10		CJA	
88	12/09		CJA	
89	11/09		CJA	
90	10/09		CJA	
91	09/09		CJA	
92	08/09		CJA	
93	07/09		CJA	
94	06/09		CJA	
95	05/09		CJA	
96	04/09		CJA	
97	03/09		CJA	
98	02/09		CJA	
99	01/09		CJA	
100	12/08		CJA	

Client/Project
 CITY OF STOCKTON
 Thornton Road Widening
 Stockton, California

Title
 PLAN AND PROFILE
 STA. 66+00.00 TO STA. 74+00.00

Permit Seal

Project Engineer: Joseph Moctus
 Submitted Date: April 18, 2016

THORNTON ROAD WIDENING PROJECT
 Stockton, California
PLAN AND PROFILE

DEPARTMENT OF PUBLIC WORKS
 CITY OF STOCKTON, CALIFORNIA

SCALE: DESIGNED BY: JAM
 DRAWN BY: BME
 CHECKED BY: CJA
 RECORD DWG:

APPROVED BY: CITY ENGINEER STOCKTON, CA.
 DATE:

Sheet No. Revision
 C-11 7
 16 OF 146
 JOB NO. 183910142

Thornton Road Widening Project

City of Stockton; Project No. 14-28

GTGC Job No. 036-032

Typical Traffic Control Plan for Construction of Sanitary Sewer at Waudman Ave & Thornton Road

A temporary detour will need to be implemented at Waudman and Thornton Road in order to construct two manholes on Waudman Ave which are located at centerline of roadway on Waudman Ave which is preventing a 10' minimum lane width.

Traffic Control Notes:

- 1. Residents and businesses affected by construction shall be notified a minimum of 72 hours prior to commencing roadway work
- 2. Public Entities, including but not limited to, Police Department, Fire Department, Unified School District, RTD, etc., shall be notified a minimum of 72 hours prior to commencing roadway work
- 3. No-parking signs shall be posted a minimum of 72 Hours in advance prior to commencing roadway work
- 4. All Traffic Control shall abide by MUTCD and all State and OSHA laws
- 5. Spacing between temporary traffic signs shall be 250 LF
- 6. Any existing roadway signs or striping in conflict with the proposal lane closure shall be removed or covered during temporary lane closure. Existing striping and signage to be restored/uncovered once lane closure is no longer implemented.
- 7. Access to driveways shall be maintained at all times
- 8. All lanes shall be open to the Public between 4:30 PM and 8:30 AM for all major commute streets. In some areas, road closure to through traffic may start at 7 AM or 8:30 AM
- 9. All requirements in Sections 7-1.04 and 7-1.09, "Public Safety & Maintaining Traffic" shall apply to the contract

NOTES:

1. ALL SIGNS AND SPACING SHALL MEET MUTCD STANDARDS.
2. PROVIDE NOTIFICATION LETTERS TO RESIDENTS. INDICATE CLOSURE DATES AND TIMES.

Detour #2



Detour #1

