

NOTES

-
- Profile view of a proposed roadway. The vertical axis represents elevation in feet, ranging from 30 to 44. The horizontal axis represents stationing. Key points and labels include:
- BCR** (Beginning of Construction Right-of-Way) at station 0+00, elevation 41.97.
 - 1+00 L.P. & D.C.B. & E.C.R.** (Line of Proposed & Design Centerline & End of Construction Right-of-Way) at station 1+00, elevation 41.68.
 - 1+01.5 End Ex. C.G. & 1+01.68 Match Ex.** (End of Existing Centerline & Match with Existing Profile) at station 1+01.5, elevation 41.68.
 - 2+00 G.B.** (Grade Break) at station 2+00, elevation 41.93.
 - 2+49 End C.G. & 2+49.15** (End of Construction Right-of-Way) at station 2+49, elevation 42.15.
 - Exist Ground @ R/W** (Existing Ground at Right-of-Way) at station 1+00, elevation 41.68.
 - Gutter E.** (Gutter Elevation) at station 1+00, elevation 41.68.
 - Exist E.P.** (Existing Elevation Profile) at station 2+49, elevation 42.15.
 - E. of Ditch** (Elevation of Ditch) at station 2+49, elevation 42.15.
 - Future Gutter E.** (Future Gutter Elevation) at station 2+49, elevation 42.15.
 - Grades:** 0.25% (from station 1+00 to 2+00) and 0.44% (from station 2+00 to 2+49).

[illegible]

QUANTITIES

Lump Sum
2187 SF
1029 SF
52.4 Tons (2187 SF)
26.8 Tons (2187 SF)
147 LF

4" Sanitary Sewer Service

671-F

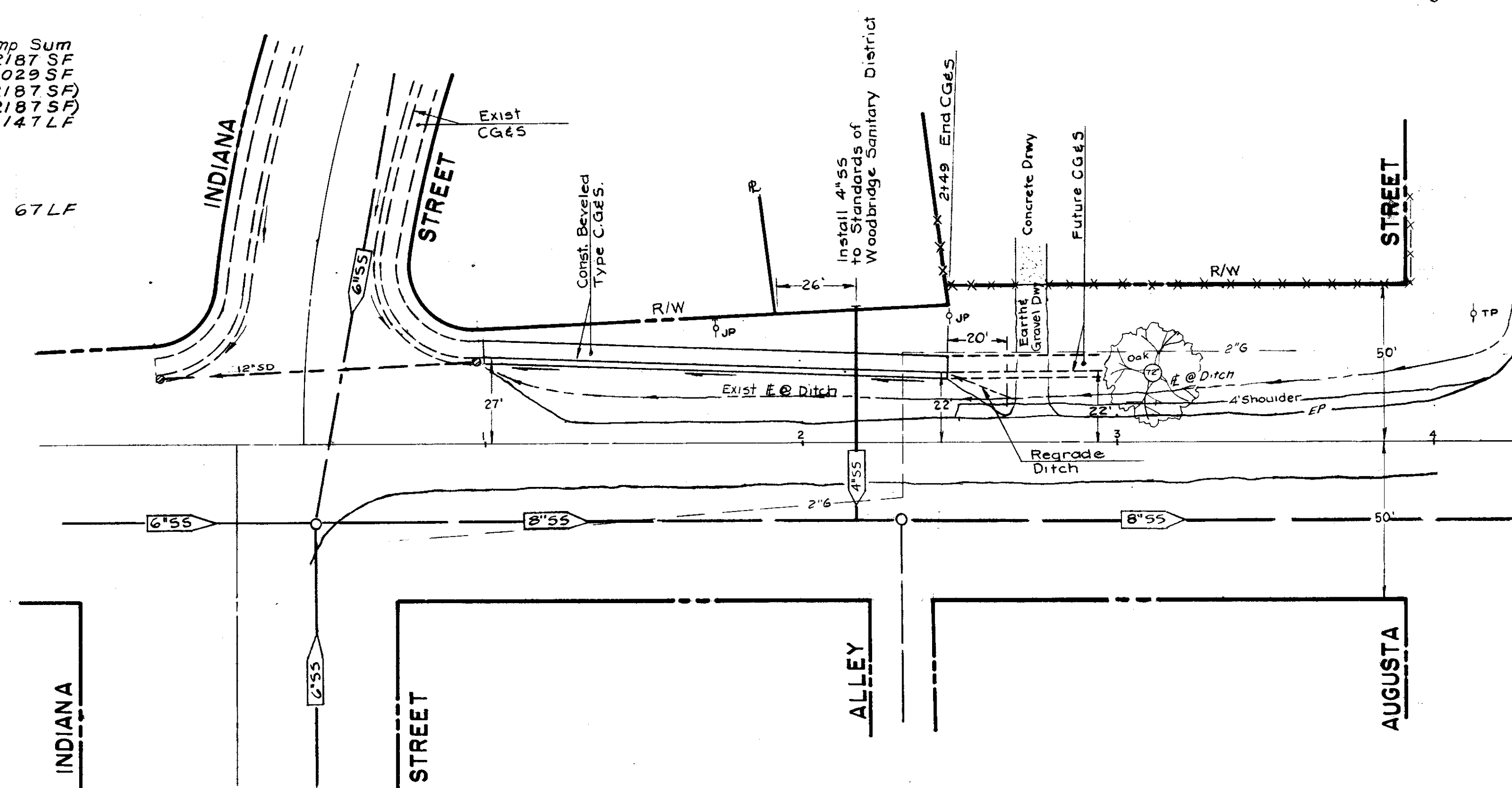

TYPICAL TRENCH BACKFILL DETAIL

This diagram illustrates the cross-section of a trench backfill. The trench is defined by a Right of Way (R/W) line on the left. The backfill structure consists of several layers and dimensions:

- Dimensions:**
 - The total width of the backfill area is **8' to 21.5'**.
 - The trench width is **5'**.
 - The trench depth is **1'**.
 - The backfill slope is **2.5 to 4% X-Slope**.
 - The shoulder width is **4'**.
 - The backfill length is **Varies**.
- Materials and Construction:**
 - Beveled CG&S** (Cement Grout and Sand) is applied to the trench walls.
 - 12" ~ 90% RC Concrete Subgrade Compaction** forms the base of the trench.
 - The backfill layers, from bottom to top, are:
 - 6" 90% R.C. Compacted Q.G.** (Native Mat'l.)
 - 6" 95% R.C. Compacted**
 - 4" Aggregate Base Cl. II**
 - 2" Asphalt Concrete Type I/B**
 - The top surface is labeled **Existing E.P.** (Existing Edge Profile).

[illegible]

NO.	DATE	REVISIONS	BY	DESIGN <u>GR</u>	DRAWN BY <u>TP</u>
				<u>Glenn D. Brumbach</u>	
				APPROVED BY	
				R.C.E. <u>12485</u>	DATE <u>6-14-78</u>

COUNTY OF SAN JOAQUIN
DEPARTMENT OF PUBLIC WORKS
APPROVED William J. Ward DATE 6-19-78
WILLIAM J. WARD R.E. 9338
DIRECTOR OF PUBLIC WORKS

BAUMBACH & PIAZZA
CIVIL ENGINEERS — SURVEYORS
221 W. OAK ST., LODI, CALIF. 95240 PH. 209-368-8098

SHEET	OF
JOB NO.	7827
FILE NO.	