



# COUNTY OF SAN JOAQUIN

## DEPARTMENT OF PUBLIC WORKS

P.O. BOX 1810-1810 E. HAZELTON AVENUE  
STOCKTON, CALIFORNIA 95201  
(209) 468-3000  
FAX # (209) 468-9324

Permit No: **PS-1702619**  
Date Issued: 08/22/2017  
Start Date: 02/01/2019  
Exp. Date: 09/30/2019  
Project No: PWP791710  
Quad: NE

## ENCROACHMENT PERMIT

To: LODI UNIFIED SCHOOL DISTRICT  
1305 E VINE ST  
LODI, CA 95240

### Encroachment Type:

Road Improvements

### Location:

JACK TONE RD S/O HAMMOND ST

In compliance with your request of **08/23/2017**, permission is hereby granted to do work in County right-of-way as shown on attached application and subject to all the terms, conditions and restrictions written below or printed as general or special provisions on any part of this form. See reverse side and attached sheet, if any.

Trench excavations for service connections will not be permitted within ten feet (10') of pavement centerline unless otherwise approved by the Director. Surface of trench patches shall match in kind and be smooth and even with that of abutting surface. Special attention shall be given to depth of utilities through roadside area in anticipation of future drainage facilities, road profile and/or frontage development. All underground utility facilities are to be established and accurately dimensioned on sketches from surveyed centerline of road right of way, or from right of way (border) lines.

Permittee shall call the Department of Public Works, Field Engineering Division (Permit Inspections) at (209)953-7421 at least **forty-eight hours prior to beginning any work within the County right of way**. All work performed under this permit shall conform to the rules and regulations pertaining to safety established by the California Division of Industrial Safety and Cal-OSHA.

The jobsite shall be kept in a safe condition at all times by the daily removal of any excess dirt or debris which might be a hazard to either pedestrian or automobile traffic. All necessary traffic convenience and warning devices and personnel shall be provided, placed and maintained by and at the sole expense of the Permittee in accordance with the latest edition of the CALTRANS Manual of Traffic Control.

After completion of the work permitted herein, all debris, lumber, barricades, or any excess material shall be removed and the jobsite left in a neat workmanlike manner. Immediately following completion of construction permitted herein, Permittee shall fill out and mail notice of completion (see attached post card) provided by Grantor.

### Special Comments:

Cotton Street Improvements

**\*\*Traffic Control per MUTCD\*\***

### FORMS:

SS/WW, R-29

Est. Permit Fee: \$17,567.00

KRIS BALAJI, Director  
Department of Public Works

WHITE  
GOLDENROD  
YELLOW  
PINK

-Permittee  
-PWD Central File  
-Field Inspection  
-Permit Section

By:

Permit Section



## ENCROACHMENT PERMIT GENERAL PROVISIONS

13-1

1. This permit is issued under and subject to all laws and ordinances of agencies governing the encroachment herein permitted. See the following references:

### STREETS AND HIGHWAYS CODE

1. Division 1, Chapter 3
2. Division 2, Chapter 2, Section 942
3. Division 2, Chapter 4, Section 1126
4. Division 2, Chapter 5.5 and Chapter 6

SAN JOAQUIN COUNTY ORDINANCES NUMBERED: 324, 441, 648, 662, 672, 695, 700, 860, 892, 3359, and 3675.

2. It is understood and agreed by the Permittee that the performance of any work under this permit shall constitute an acceptance of all the provisions contained herein and failure on the Permittee's part to comply with any provision will be cause for revocation of this permit. Except as otherwise provided for public agencies and franchise holders, this permit is revocable on five days notice.
3. All work shall be done subject to the supervision of and the satisfaction of the grantor. The Permittee shall at all times during the progress of the work keep the County Highway in as neat and clean condition as is possible and upon completion of the work authorized herein, shall leave the County Highway in a thoroughly neat, clean and usable condition.
4. The Permittee also agrees by the acceptance of this permit to properly maintain any encroachment structure placed by the Permittee on any part of the County Highway and to immediately repair any damage to any portion of the highway, which occurs as a result of the maintenance of the said encroachment structure, until such time as the Permittee may be relieved of the responsibility for such maintenance by the County of San Joaquin.
5. The Permittee also agrees by the acceptance of this permit to make, at its own expense, such repairs as may be deemed necessary by the County Department of Public Works.
6. It is further agreed by the Permittee that whenever construction, reconstruction or maintenance work upon the highway is necessary, the installation provided for herein shall, upon request of the County Department of Public Works, be immediately moved or removed by and at the sole expense of the Permittee.
7. No material used for fill or backfill in the construction of the encroachment shall be borrowed or taken from within the County right of way.
8. All work shall be planned and carried out with as little inconvenience as possible to the traveling public. No material shall be stacked within eight feet (8') of the edge of the pavement or traveled way unless otherwise provided herein. Adequate provision shall be made for the protection of the traveling public. Traffic control standards shall be utilized including barricades; approved signs and lights; and flagmen, as required by the particular work in progress.
9. The Permittee, by the acceptance of this permit, shall assume full responsibility for all liability for personal injury or damage to property which may arise out of the work herein permitted or which may arise out of the failure of the part of the Permittee to properly perform the work provided under this permit. In the event any claim of such liability is made against the County of San Joaquin or any department, official or employee thereof, the Permittee shall defend, indemnify, and hold each of them harmless for such claim.
10. All backfill material is to be moistened as necessary and thoroughly compacted with mechanical means. If required by the County Director of Public Works, such backfill shall consist of gravel or crushed rock. The Permittee shall maintain the surface over structures placed hereunder as may be necessary to insure the return of the roadway to a completely stable condition and until relieved of such responsibility by the County Department of Public Works. Wherever a gravel, crushed rock or asphalt surface is removed or damaged in the course of work related to the permitted encroachment, such material shall either be separately stored and replaced in the roadway as nearly as possible in its original state or shall be replaced in kind, and the roadway shall be left in at least as good a condition as it was before the commencement of operations of placing the encroachment structure.
11. Whenever it becomes necessary to secure permission from abutting property owners for the proposed work, such authority must be secured by the Permittee prior to starting work.
12. The current and future safety and convenience of the traveling public shall be given every consideration in the location and methods of construction utilized.
13. The Permittee is responsible for the preservation of survey monuments located within the area of work herein permitted. Prior to the start of construction, survey monuments that potentially may be disturbed shall be located and referenced by a Licensed Land Surveyor, and a Corner Record filed with the County Surveyor. Any Survey Monuments disturbed during the course of construction shall be reestablished by a Licensed Land Surveyor and another Corner Record filed with the County Surveyor. (Land Surveyors' Act Section 8771)
14. Prior to any excavation, the Permittee shall notify USA North (Underground Service Alert of Northern California and Nevada) at 811 or 800-227-2600 forty-eight (48) hours in advance.

SPECIAL CONDITIONS FOR  
COTTON STREET IMPROVEMENTS  
ENCROACHMENT PERMIT

1. Maintain traffic controls for all roads. Traffic control delays shall not exceed 15 minutes. Two-way traffic shall be maintained during non-working hours with excavated areas backfilled or plated. During working hours, two-way traffic control shall be maintained with one lane open and appropriate flaggers. The contractor shall submit traffic control plans for all signing, detours, and any lane closure impacting County right-of-way. Traffic control plans shall be submitted two weeks prior to the closure date.
2. Access to the school property shall be maintained at all times except when work is occurring at the access point. Minimal delays will be allowed to provide access within the work zone area. Driveway access shall be fully restored at the end of each workday. Driveways disturbed by the contractor shall be replaced with in-kind or better materials.
3. Lockeford Elementary School shall be notified in writing, as approved by the County, 48 hours in advance of any impacts to their access.
4. Any areas where parking is to be restricted shall have signs noting the restrictions in place at least 48 hours in advance.
5. School Buses shall be passed through the work zone with minimal delays.
6. All destroyed or obliterated pavement markings must be replaced in kind by the permittee. Typical pavement markings include but not limited to lane lines, centerlines, stop and stop ahead legends, limit lines, raised pavement markers and miscellaneous delineators.
7. The Permittee is responsible for the preservation of survey monuments located within the area of work herein permitted. Prior to the start of construction, survey monuments that potentially may be disturbed shall be located and referenced by a Licensed Land Surveyor, and a Corner Record filed with the County Surveyor. Any Survey Monuments disturbed during the course of construction shall be reestablished by a Licensed Land Surveyor and another Corner Record filed with the County Surveyor. (Land Surveyors' Act Section 8771)
8. All future maintenance of the pipeline and related facilities within the County right-of-way will require a San Joaquin County Encroachment Permit.
9. Trenches shall be maintained in a smooth and even condition to the satisfaction of the County throughout the project limits at all times.
10. All trenches shall be completely backfilled or shored and plated at the end of each workday, and the roadway restored to two-way traffic. If plating is to be used, a trench shoring and plating plan suitable for traffic loadings shall be prepared by a registered civil engineer and submitted for prior approval by the County.
11. The contractor shall use San Joaquin County Improvement Standard R-29 when backfilling trenches within the County right-of-way. Where the existing road structural section is below

standard, a minimum section of 3 inches of asphalt concrete over 8 inches of aggregate base shall be required.

12. Hammond Street & Jack Tone Road subject to pavement cuts shall receive a Type II slurry seal for half of the roadway that will have pavement cuts as per San Joaquin County Department of Public Works Improvement Standards Section 2-5.0 Trench Cut Policy. Shoulder areas shall be brought up to the finish grade as directed by the County.
13. No paving joints are allowed within paved shoulder; contractor shall pave all the way to outer edge of paved shoulder.
14. Class II Aggregate Base shoulder backing is required from the edge of pavement, a minimum of 4-inches thick by 4-feet wide.
15. Contractor shall establish existing roadway and drainage grades within the construction area. Any repair to roadways and adjacent areas shall match existing grades. Any proposed grade changes shall receive prior approval from County.
16. Above ground vaults, panels and/or other similar facilities will be allowed within the right-of-way if located as far to the outside edge as possible. Utility vaults shall be located a minimum of 4'-0" from edge of pavement.
17. County roads shall be kept clean from mud and debris at all times along the access points and work zone areas during entire project. All standard roadway striping and signage shall be clearly visible, maintained and restored throughout the construction zone during and after the project.
18. In addition to standard dust control measures, streets shall be maintained in a clean condition, free of dirt, mud and debris during construction activities. The contractor shall provide daily, and as determined to be necessary by County inspectors, street sweeping using a modern mechanical or vacuum-assisted street sweeper.
19. The contractor shall not conduct construction operations in rain or heavy fog conditions.



# APPLICATION FOR ENCROACHMENT PERMIT

PLEASE PRINT:

Date August 11, 2017

To: San Joaquin County  
Department of Public Works

Lodi Unified School District-Warren, Sun

(Applicant Name)

1305 E Vine St

(Mailing Address)

Lodi, CA 95240

(City, State, Zip Code)

(209) 331-7218

(Area Code - Telephone Number)

wsun@lodilusd.net

(Email Address)

## OFFICE USE ONLY

JOB #	<u>791710</u>	REF #	
APN	<u>019-020-60</u>	CR #	
EXP. DATE	<u>10/01/2019</u>		
VALID	<u>03/01/2019</u> TO <u>09/30/2019</u>	DRIVEWAYS:	
STREET	<u>Cotton Street</u>	*	
AREA	<u>Lockeford</u> QUAD <u>NE</u>	*	
TYPE	<u>Trenching, Driveways</u>	*	
FORMS	<u>SS/WW, R-29, Trenchcut Policy</u>		
NOTES	<u>Special Conditions</u>		

Sketch (Detailed plans may be submitted)

Plans & Drainage Study are attached hereto.

Any comments need to be addressed to Jeff Sanguinetti of AR Sanguinetti & Assoc.  
at 1150 W Robinhood Dr., Ste 1-C, Stockton, CA 95207  
(209) 477-0899 or (209) 482-6599.  
jmsang@aol.com

The undersigned hereby applies for permission to excavate, construct and/or otherwise encroach on County Highway Right-of-Way on the    side of Jack Tone Rd approximately 250ft feet/mile south of Hammond Street, by performing the following work (description of work):  
construction of a 2ft wide conc median, approx. 60 ft together with some shoulder  
widening on both sides of median just south of Lock Rd at the abandoned RR crossing.

Work will commence on or after October 2017 for approximately 60 days days.

I, the undersigned, certify that I am the owner of the respective property, or am qualified to represent the owner and agree to do the work described above in accordance with the rules and regulations of San Joaquin County and subject to inspection and approval.

Warren Sun  
Signature of Applicant - Title

8/22/17  
Date



**SAN JOAQUIN**  
COUNTY  
*Greatness grows here.*



**Department of Public Works**

Kris Balaji, Director of Public Works

Fritz Buchman, Deputy Director/Development

Michael Selling, Deputy Director/Engineering

Jim Stone, Deputy Director/Operations

Kristi Rhea, Manager of Strategic Initiatives

## Acknowledgement of Monument Preservation

I, Michael D. Farley, a duly Licensed Land Surveyor or a Professional Engineer  
(Please print)

authorized to perform Land Surveying in the State of California, Registration No. LS6939,

hereby acknowledge and accept all responsibility for the monument preservation as required

per Section 8771(a-f) of the Business and Professions Code within the bounds of the

construction activity permitted by San Joaquin County Permit No. PS-1702619.

I further acknowledge that I am hereby responsible for the Acknowledgement of Monument  
Preservation prior to final acceptance of the construction activity.

Signature [Signature] Seal  
Date 11/2/18

PS-MONUMENT PRESERVATION

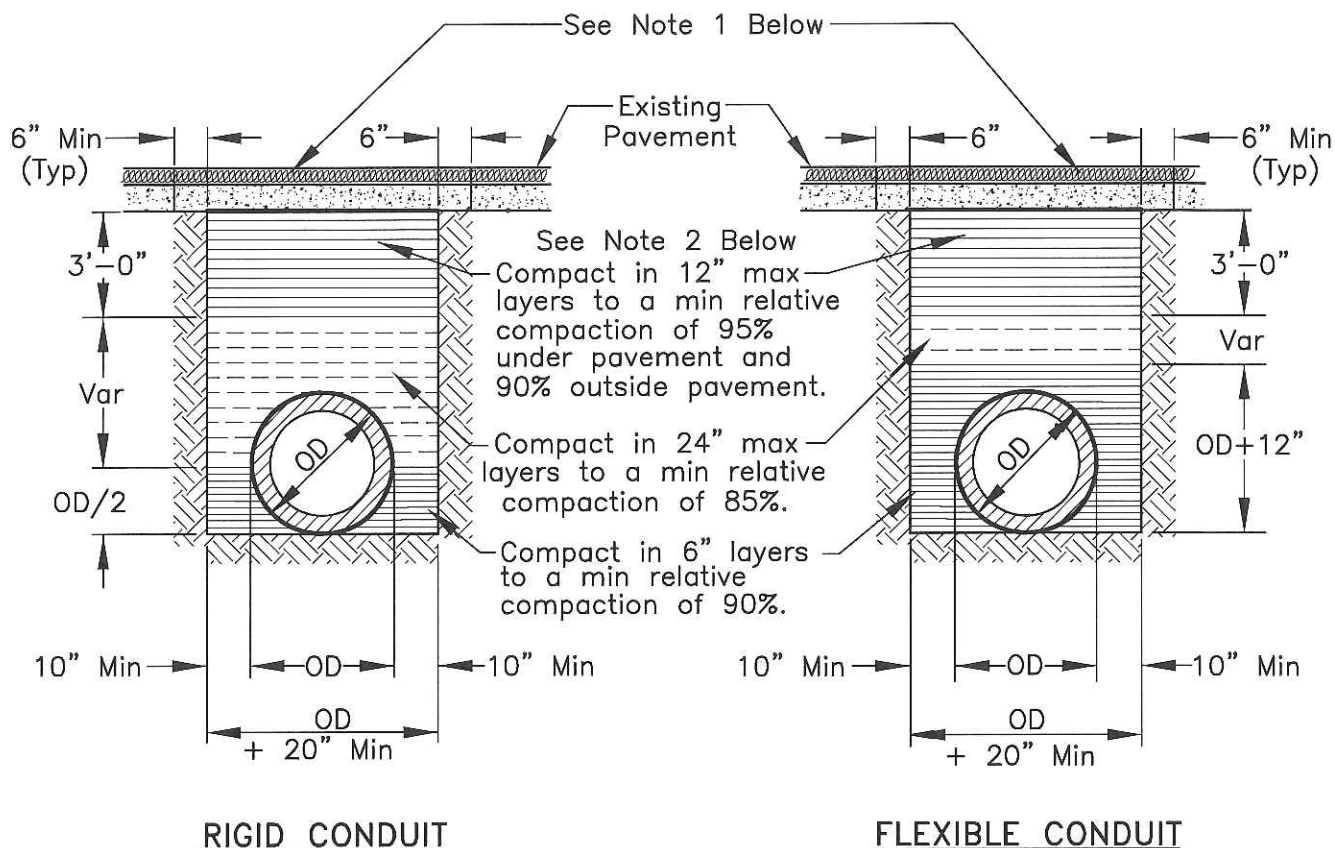

#### NOTES:

1. New pavement shall be 1" thicker than existing pavement, minimum of 0.25 Ft. New base shall be 1" thicker than existing base, min of 0.50 Ft.
2. Select native material or imported granular material as approved by the Director of Public Works. Backfill with materials equal to or better than the existing pavement and base in quality.
3. Relative compaction of materials shall be tested in accordance with the State of California, Dept. of Transportation Testing Manuals, test method No. California 216 or 231.
4. All existing pavement shall be neatly cut to line prior to trench excavation.
5. Jetting or ponding will be permitted within the street right-of-way with a 3 year bond, when approved by the Director of Public Works.
6. When shown by soil composition and compactability, ninety percent (90%) compaction may be used, when approved by the Director of Public Works.
7. Special bedding and backfill requirements may be shown on the plans or specified in the special provisions.

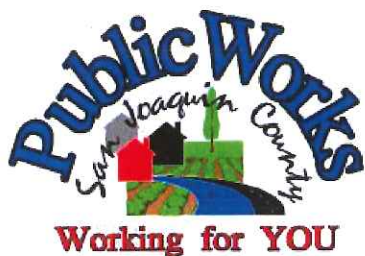

## TYPICAL TRENCH BACKFILL

COUNTY OF SAN JOAQUIN  
DEPARTMENT OF PUBLIC WORKS

Approved by:

*Thomas M. Hall*

No.	Revision	Description	Date

Date: DEC 2014

Std. Dwg. No.

**R-29**



★ 2-5.0 TRENCH CUT POLICY

★ 2-5.01 General Requirements

- A. Resurfacing requirements specified in this policy are in addition to the trench resurfacing requirements specified by County Standard Drawing No. R-29.
- B. For the purpose of this policy, "Surfacing Age" is defined as the age of the most recently completed roadway surfacing, including construction, reconstruction, or major overlay.
- C. Where the application of seal coats is required, a Type II Slurry Seal will be used in accordance with State Standard Specifications, Section 37-2.
- D. The permittee must post a one-year maintenance bond or cash deposit, in an amount specified by the Department.
- E. All pavement markings destroyed or obliterated must be replaced in kind by the permittee. Typical pavement markings include, but are not limited to, lane lines, centerlines, stop and stop ahead legends, limit lines, raised pavement markers, and miscellaneous delineators.
- F. The permittee is responsible for Survey Monuments disturbed by trenching and is required to file a corner record and to reestablish them using a Licensed Land Surveyor after the trench restoration is completed.
- G. Functional classification maps and Public Works Project Advertising Schedules are references for this policy.
- H. To facilitate scheduling and planning, Public Works staff will make available the most current Project Advertising Schedule at the monthly Utility Coordination Meeting and make it available to the public, at the Permits Counter, in January each year.

2-5.02 Collectors, Arterials and Expressways

- A. Surfacing Age less than Three (3) Years: No pavement cuts. Exceptions may be approved in accordance with Section 2-5.04 EXCEPTIONS.
- B. Surfacing Age Three (3) Years and Over:
  - 1. Longitudinal Trench Cutting in Paved Shoulder



Areas:

The entire shoulder of the road is to be resurfaced. The existing surfacing adjacent to the trenched area shall be planed to accommodate the overlay in a manner that does not cause drainage concerns. The nearest pavement cut shall be a minimum of three (3) feet from the edge of pavement, or the remaining pavement shall also be removed and replaced. (See County Standard Drawing No. R-37).

2. Longitudinal Trenches within Traveled Lanes:

The entire traveled lane where the trench is located is to be resurfaced with a one (1) inch asphalt concrete overlay. The existing surfacing adjacent to the trenched area shall be planed to accommodate the overlay in a manner that does not cause drainage concerns. The overlay shall be in accordance with State Standard Specifications, Section 39. Aggregate gradation shall be consistent with the existing surfacing material. (See County Standard Drawing No. R-37).

3. Cross-Cutting:

Cross-cutting is allowed at a minimum interval of 150 feet. At each cross-cut location a minimum of ten (10) feet on each side of trench shall be planed and resurfaced with one (1) inch asphalt concrete. If cross cuts are within the 150 feet minimum interval, the entire section between the first and last cross cut shall be planed and resurfaced with one (1) inch asphalt concrete. (See County Standard Drawing No. R-36).

4. The conditions described in paragraphs 1, 2 and 3 above will not apply if resurfacing is scheduled within two years.



2-5.03 Local Roads

- A. Surfacing Age Under Three (3) years: No pavement cuts allowed. Exceptions may be approved in accordance with Section 2-5.04  
EXCEPTIONS.



B. Surfacing Age Three (3) to Five (5) Years:

1. Longitudinal cuts are permitted. A seal coat is required for that half of the roadway containing the trench. (See County Standard Drawing No. R-37).

2. Cross-cutting is allowed under the same conditions as Section 2-5.02(B)(3). If cross-cuts occur within the 150 feet minimum interval, resurfacing may be substituted with a slurry seal for that half of the roadway. (See County Standard Drawing No. R-36).

#### 2-5.04 Exceptions

Excavation is prohibited in newly renovated County roadways for three (3) years after a notice of completion has been filed for a roadway improvement project, or a new roadway has been accepted. The Director of Public Works may approve exceptions that are in the best interest of the public, including but not limited to:

- A. An emergency that endangers life or property.
- B. For repair or modification to prevent interruption of essential utility service.
- C. For relocation work that is mandated by County, State or Federal law.
- D. For service for buildings where no other reasonable means of providing service exists.
- E. For potholing to verify utility depth or location.
- F. For trenchless excavations greater than three feet in depth of cover over the utility facility, and not requiring a significant surface incision greater than industry bore pit standards.

Exceptions must be requested and submitted in writing to the Department. Payment of a nonrefundable processing fee is also required. Exceptions will be reviewed using the Departments Action Approval process, which requires the recommendation of a Deputy Director.



**NOTES:**

1. If the distance between cross-cuts are less then 150' the entire area between corss-cuts shall be planed and resurfaced with one (1) inch of Asphalt Concrete.
2. The resurfacing requirements shall be in addition to County Standard Drawing No. R-29.
3. Resurfacing for Bell Holes shall meet these requirements. If excavation occurs within the shoulder or lane, only that area shall be resurfaced as shown.
4. If cross-cutting is performed on Local Roads at intervals less then 150' a Seal Coat for that half of the roadway containing the trench can be used in lieu of resurfacing. Section 2-5.03 (B-2).

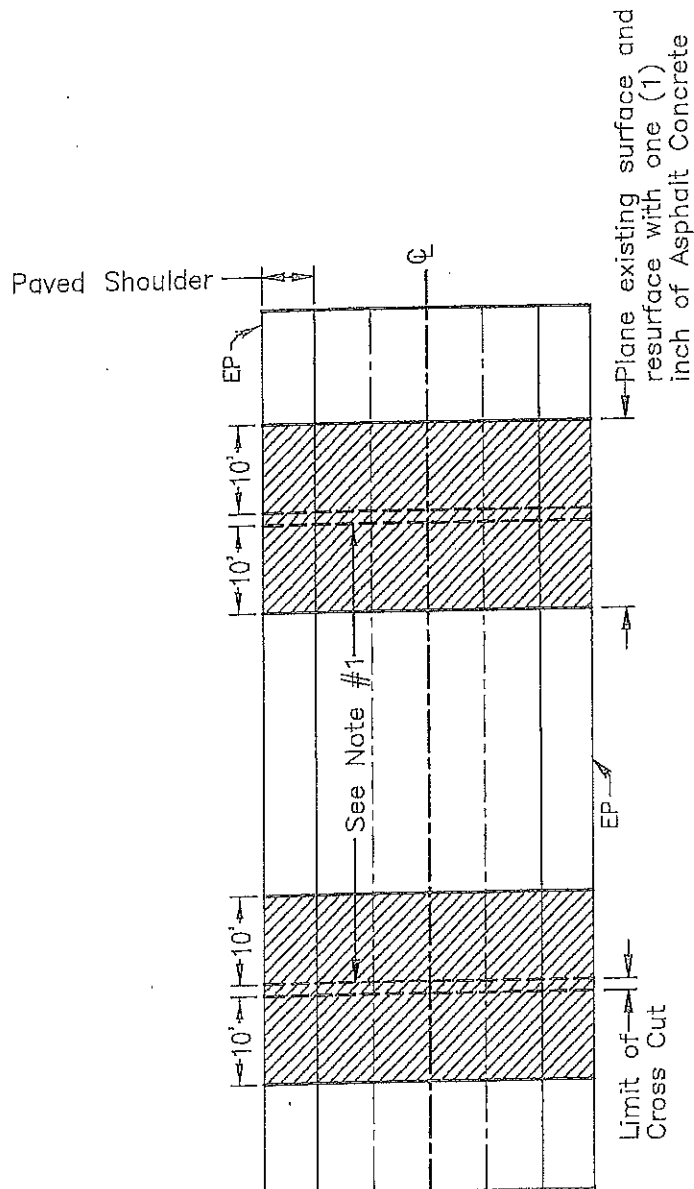

**TRENCH CUTTING POLICY  
CROSS CUTTING OF  
COUNTY ROADWAYS**

**COUNTY OF SAN JOAQUIN**  
DEPARTMENT OF PUBLIC WORKS

Date: MAY 2015

Approved by:

*Michael J. Kelly*

No.	Revision	Description	Date

Std. Dwg. No.

**R-36**

**NOTES:**

1. The resurfacing requirements shall be in addition to County Standard Drawing No. R-29.
2. If longitudinal cuts are required on a Local Road a Seal Coat can be used for that half of the roadway containing the trench. Section 2-5.03 (B-1).

Area to be resurfaced with one (1) inch Asphalt Concrete overlay existing surface to be planed, to accommodate overlay. Section 2-5.02 (B-2).

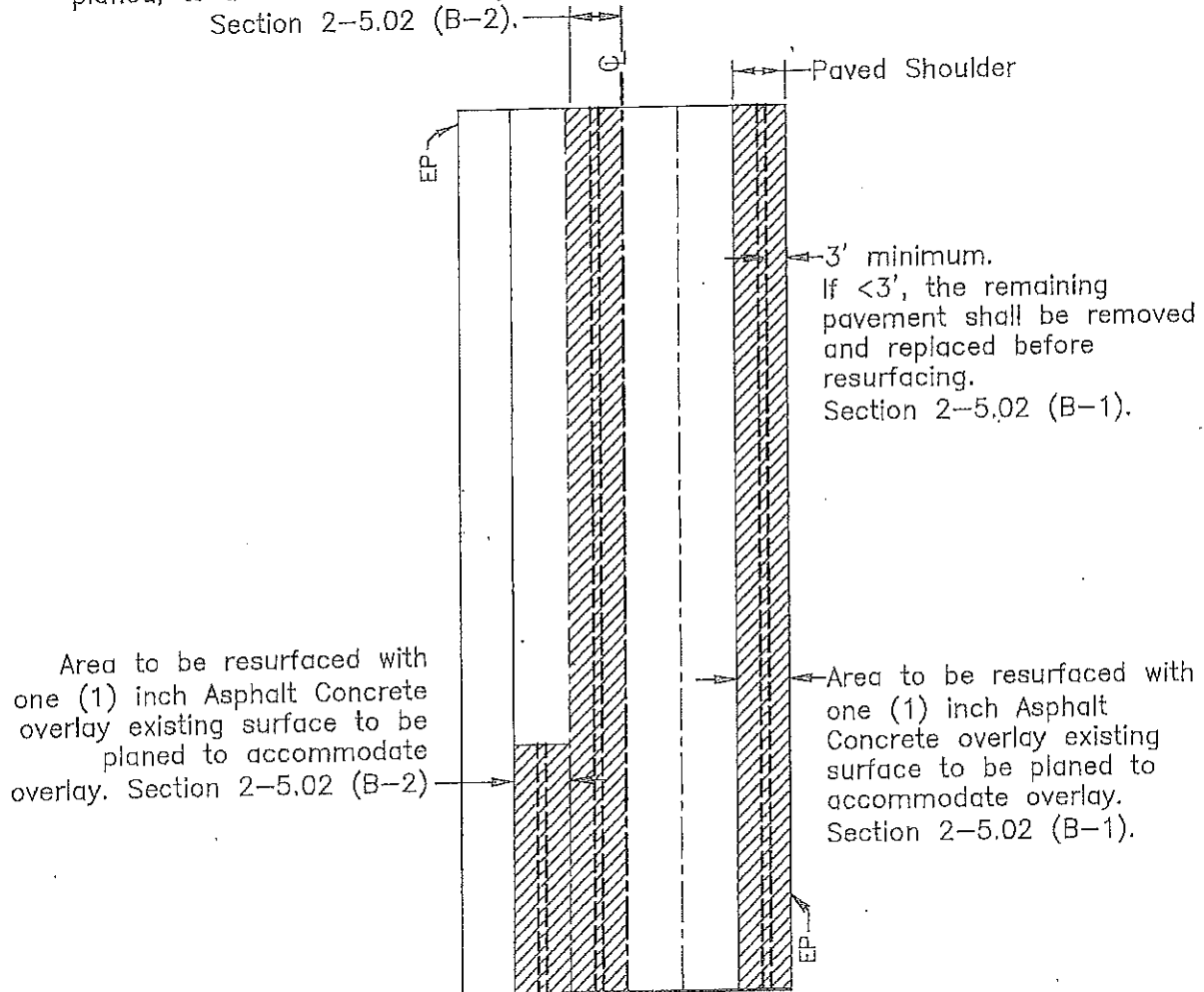

**TRENCH CUTTING POLICY  
LONGITUDINAL CUTTING  
OF COUNTY ROADWAYS**

**COUNTY OF SAN JOAQUIN**  
DEPARTMENT OF PUBLIC WORKS

Date: MAY 2015

Approved by:

*Michael Kling*

No.	Revision	Description	Date

Std. Dwg. No.

**R-37**



## **GENERAL PROVISIONS**

### **GOVERNING INSTALLATION OF SUBSURFACE STRUCTURES AND PIPELINES WITHIN COUNTY ROAD RIGHTS-OF-WAY**

#### **PUBLIC CONVENIENCE AND SAFETY:**

- A. Before obstructing any private driveway entrance or County road traveled way with a trench, spoil bank, equipment or other barrier permitted for any prolonged period of time, the Permittee shall notify the known users of the respective thoroughfare(s) involved, and shall provide access for vehicular and pedestrian traffic to and from the road.
  - 1. Unless otherwise permitted, all work shall be conducted in such a manner that no less than one lane of the existing County road traveled way will be maintained open to public traffic during working hours in a smooth and safe riding condition(s). Two lanes shall be open after working hours.
  - 2. In cases where road closure is permitted, the permission to close the road will be granted under the condition that the Permittee notify the following persons and/or agencies of the time, the period of closure, and the detour route at least twenty-four (24) hours prior to said road closure.
    - a. The County of San Joaquin Public Works Department
    - b. The County of San Joaquin Sheriff's Office
    - c. The local postal service
    - d. The local fire district
    - e. The local school district
    - f. The local residents involved
- B. Should hazardous conditions relative to the installation operations warrant flagmen, as many capable flagmen as may be necessary shall be provided by the Permittee and stationed in advance of work to warn and direct traffic.
- C. Lights, signs and barricades shall be furnished, erected and maintained by the Permittee for the adequate warning and convenience of the public, with particular attention to be taken in this regard after dark.
- D. Any excess dirt and/or debris which might be a hazard to either automobile or pedestrian traffic, uncontrollable by lights, signs and barricades, shall be removed from the jobsite daily.

#### **STRUCTURES:**

- A. Walls of structures shall be such quality and strength that they will resist all pressures and will not crack or be deformed in such a way as to create a hazard or maintenance problem at any time. Therefore, the minimum structural requirements for concrete pipe placed under county road rights-of-way shall conform to the following American Association of State Highway and transportation Officials (AASHTO) designations.
  - 1. For concrete pipe up to and including thirty-three inches (33") inside diameter, extra strength concrete conforming to AASHTO Designation M 170M.
  - 2. For concrete pipe thirty-six inches (36") inside diameter and larger, reinforced concrete pipe conforming to AASHTO Designation M 170M Class III.
  - 3. Plastic pipe conforming to AASHTO Designation M294.
- B. All concrete pipe joints with County road rights-of-way shall be sealed against leakage and/or infiltration with rubber gasket in conformance with Section 65-1.06 of the California Standard Specifications, or with other methods as may be permitted under the Special Provisions.
- C. Cast-in-place concrete pipe, vitrified clay pipe, spiral welded steel pipe, or corrugated aluminum alloy pipe shall not be installed within the County road rights-of-way unless specifically so stated in the Special Provisions, and only under the conditions as provided.
- D. All structures to be buried within the County rights-of-way shall be set at such elevations as to allow minimum coverage of thirty inches (30") to the centerline of the roadways and twelve inches (12") at the bottoms of borrow ditches each side of the roadways. The depths of structures shall be established below a flat plane extending across the rights-of-way, no part of which shall extend above the elevations stated above; manholes, lampholes, valves, etc. not included. Future surface elevations shall be anticipated as nearly as possible and structure elevations shall be established for future adjustments accordingly.
- E. The County hereby reserves the right to specify in the Special Provisions the gage and surface treatment of any galvanized corrugated metal pipe that is to be installed.
- F. All longitudinal utility facilities are to be established (and dimensioned on sketches) from surveyed centerline of road right-of-way, not from right-of-way (border) lines.

#### **REPAIRS OF THE COUNTY RIGHT-OF-WAY:**

- A. All excavations shall be backfilled and compacted immediately after work therein has been completed.
- B. Trenched shall not be left open farther than 300 feet in advance of pipe laying operations, or 200 feet to the rear thereof, unless otherwise permitted by the Engineer.
- C. Unless otherwise permitted under the Special Provisions, backfill shall be placed and mechanically compacted in such a manner that the relative compaction throughout the entire fill within the County road right-of-way shall conform to the percentages of compaction as shown on the Trench detail.
- D. Backfill material shall be placed in horizontal uniform layers not to exceed in thickness, before compaction, 0.67 foot in the bedding region, one -foot where 90% compaction is required, and two-feet where 80% compaction is required.
- E. No portion of the excavation(s) shall be compacted by ponding or jetting unless a maintenance bond is provided.
- F. Gravel backfill material shall be utilized only where specifically so stated on the face of the permit. It shall be compacted by means of a high-frequency internal vibrator, the compactor to be a size and type approved by the Engineer. Points of compaction shall not be greater than 18" centers and to the full depth of the lift.
- G. All pavements, curbs, gutters, sidewalks, borrow ditches, pipes, head walls, road signs, trees, shrubbery, and/or other permanent road facilities impaired by or as a result of construction operations at the construction site(s) occupied by materials and/or equipment, shall be restored immediately upon backfilling of the excavation to the original grades and cross sections, and to a condition as good as, or better than existing prior to construction.
- H. All surfacing materials of roadways and driveway approaches cut or damaged by or as a result of construction operations, shall be replaced within ONE WEEK following the backfilling of excavation, weather permitting, with compacted layers of surfacing materials at least as thick as the existing, and no less than two inches (2") of asphalt concrete over six inches (6") of aggregate base, both as specified below.
  - 1. Asphalt Concrete: Combined mineral aggregate shall conform to the quality and gradation requirements for Type "B" one-half inch(1/2) maximum aggregate, coarse or medium gradation as specified in Section 39 of the California Standard Specifications. The bituminous binder to be mixed with mineral aggregate shall be paving asphalt having (Grade PG 64-10), unless otherwise directed by the Engineer. Placement of asphalt concrete surfacing shall conform to the applicable provisions of Section 39 of the California Standard Specifications.
  - 2. Aggregate Base: Combined mineral aggregates shall conform to the quality and the grading for three-quarter inch (3/4") maximum size aggregate Class 2 Aggregate Base specified in Section 26 of the California Standard Specifications.
- I. Before acceptance of repairs to the County road rights-of-way, all unsightly and detrimental dirt, dust and/or debris shall be removed and the construction areas left in a neat and presentable condition(s).
  - 1. If necessary, County road traveled way and driveway pavements shall be washed with water to remove dirt and dust.
  - 2. Driveway approaches and field entrance pavements damaged by equipment or spoil banks shall be repaired as directed by the Engineer.
- J. Upon request by the County, any settlement, sagging of surface, or cracking of pavement shall be repaired immediately by and at the sole expense of the Permittee for a period of one year following acceptance of the work.

## SPECIAL PROVISIONS

### Winter Weather Utility Work

---

1. **SUPERVISION:** The utility company (**permittee**) shall furnish full-time supervision of all work to insure compliance with the permit provision.
2. **START OF WORK:** No work within the County right-of-way shall be started until the utility company representative has made an evaluation of weather conditions and has determined the work can be accomplished under the provisions of the permit.
3. **CLEAN PAVEMENT:** Dirt and mud shall not be deposited on the pavement outside the area of work, and if inadvertently tracked onto the road travel way shall be removed immediately.
4. **DAILY RESTORATION:** Private driveways and road intersections shall be restored daily.
5. **WEATHER-TIGHT CONDITIONS:** All trenches shall be filled and compacted, ditches and other drainage facilities regarded and opened, and the entire work area restored to weather-tight condition prior to any rain.



# LODI UNIFIED SCHOOL DISTRICT PROPOSED TRAFFIC CIRCULATION LOCKEFORD ELEMENTARY SCHOOL

A.R. SANGUINETTI & ASSOCIATES  
CONSULTING CIVIL ENGINEERS  
STOCKTON, CALIFORNIA

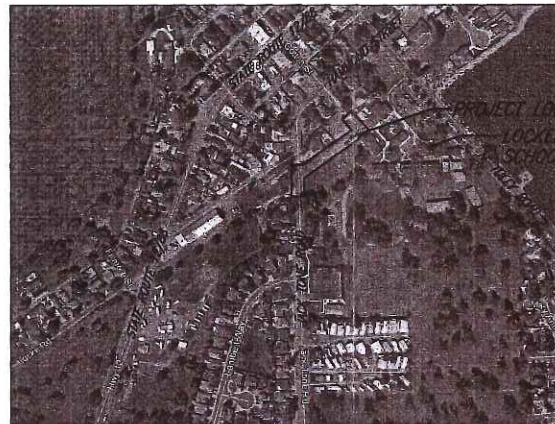

VICINITY MAP  
(NO SCALE)

## ABBREVIATIONS

AB	AGGREGATE BASE	M	METER
AC	ASPHALT CONCRETE	MBX	MAILBOX
ACI	AMERICAN CONCRETE INSTITUTE	MH	MAINTENANCE HOLE
A.P.N.	ASSESSOR'S PARCEL NUMBER	MIN.	MINIMUM
BC	BEGIN OF CURVE	MAX.	MAXIMUM
BLOG	BUILDING	NO.	NUMBER
BRK-COL	BRICK COLUMN	OC	ON CENTER
C	CONCRETE	P	PAVEMENT
CC	CURB CUTOUT	POC	POINT ON CURVE
CHKV	CHECK VALVE	PP	POWER POLE
CJ	CONTRACTION (CONTROL) JOINT	PRC	POINT OF REVERSE CURVATURE
CL	CENTERLINE	PT	POINT
CLAN	CLEAN OUT	PIV	POST INDICATOR VALVE
CONC	CONCRETE	P.U.E.	PUBLIC UTILITY EASEMENT
DBLYEL	DOUBLE YELLOW	RIM	RIM ELEVATION
DI	DRAIN INLET	R.O.W.	RIGHT-OF-WAY
DIA	DIAMETER	S	SLOPE
DWG	DRAWING	SD	STORM DRAIN
DWY	DRIVEWAY	SDMH	STORM DRAIN MAINTENANCE HOLE
EC	END OF CURVE	SMH	SEWER MAINTENANCE HOLE
ELEV	ELEVATION	SS	SANITARY SEWER
EP	EDGE OF PAVEMENT	STD	STANDARD
EX	EXISTING	SW	SIDEWALK
EXIST	EXISTING	TEM	TEMPORARY BENCH MARK
F	FENCE	TC	TOP OF CURB
FDC	FIRE DEPARTMENT CONNECTION	TYP	TYPICAL
FG	FINISH GRADE	TYPE27	TYPE 27 STRIPE (EDGE LINE)
FL	FLOW LINE	W	WATER
FL-CMP	FLOW LINE CORRUGATED METAL PIPE	WM	WATER METER
GB	GRADE BREAK	WM	WATER METER
GS	GROUND	WV	WATER VALVE
GUY	GUY WIRE	W/	WITH
HB	HOSE BIB	(±)	PLUS OR MINUS
HIC	HIGH POINT	Ø	DIAMETER
IBX	IRRIGATION BOX	AT	AT
J	JUNCTION	Ø	DIAMETER
LP	LOW POINT	12" LIMIT	12" WIDE LIMIT LINE

## LEGEND

EXISTING	PROPOSED	DESCRIPTION
6.74 DESCRIPTION 21'50"	12'50"	DIRECTION & RATE OF SLOPE PER FOOT
12'50"	12'50"	ELEVATION & DESCRIPTION OF SHOT
12'50"	12'50"	STORM DRAIN SIZE & DIRECTION
12'50"	12'50"	SANITARY SEWER SIZE & DIRECTION
12'50"	12'50"	WATER LINE SIZE
12'50"	12'50"	WATER VALVE
12'50"	12'50"	MAINTENANCE HOLE
12'50"	12'50"	DRAIN INLET
12'50"	12'50"	DIRECTION OF STORM WATER FLOW
12'50"	12'50"	PROPERTY LINE
12'50"	12'50"	CHECK VALVE
12'50"	12'50"	FIRE DEPARTMENT CONNECTION
12'50"	12'50"	TEMPORARY BENCHMARK
12'50"	12'50"	CURB, GUTTER & SIDEWALK
12'50"	12'50"	DETAIL NUMBER
12'50"	12'50"	SHEET NUMBER

## SHEET INDEX

SHEET NO.	DESCRIPTION
1	TITLE SHEET
2	NOTES
3	DETAILS
4	DETAILS
5	DETAILS
6	GATE REPLACEMENT DETAILS
7	TOPOGRAPHICAL MAP
8	DEMOLITION PLAN
9	TRAFFIC CIRCLE DETAIL
10	JACK TONE ROAD
11	SCHOOL DROP-OFF
12	COTTON STREET
13	PAVING PLAN & CURVE DATA
14	OVERALL STRIPING PLAN
15	PEDESTRIAN PATH OF TRAVEL PLAN
16	EROSION CONTROL PLAN
17	EROSION CONTROL DETAILS & NOTES

## GENERAL NOTES CONTINUED:

- THE CONTRACTOR SHALL PROVIDE ALL SHORING, BRACING, SLOPING OR PROVISIONS TO PROTECT WORKMEN FOR ALL AREAS TO BE EXCAVATED TO A DEPTH OF FIVE (5) FEET OR MORE, IN ACCORDANCE WITH ALL STATE OF CALIFORNIA REGULATIONS.
- THE CONTRACTOR SHALL EXERCISE DUE CAUTION AND SHALL CAREFULLY PRESERVE BENCH MARKS, REFERENCE POINTS, CONTROL POINTS, AND ALL SURVEY STAKES, AND SHALL BEAR ALL EXPENSES FOR REPLACEMENT AND/OR ERRORS CAUSED BY THEIR UNNECESSARY LOSS OR DISTURBANCE OF SAID MONUMENTATION.
- ALL EARTHWORK/TRENCH WORK SHALL BE PERFORMED IN ACCORDANCE WITH THE CURRENT SAN JOAQUIN COUNTY IMPROVEMENT STANDARDS, AND THE SOILS REPORT BY WALLACE KUHLE & ASSOCIATES, INC., WKA NO. 7994.01, DATED FEBRUARY 13, 2008 AND KLEINFELDER MEMO, PROJECT NO. 20162851.001A, DATED NOVEMBER 28, 2017.
- CONTRACTOR TO IMPLEMENT BEST MANAGEMENT PRACTICES (BMP'S) AS REQUIRED BY SAN JOAQUIN COUNTY & STATE LAW. SEE SHEETS 16 & 17 FOR EROSION CONTROL REFERENCES.
- ALL DRAWINGS ISSUED WITHOUT THE APPROVAL DULY SIGNED AND DATED BY THE ENGINEER OF RECORD SHALL BE CONSIDERED PRELIMINARY AND SHALL NOT BE USED FOR CONSTRUCTION.
- BOUNDARY NOTE: BEARINGS & DISTANCES SHOWN ARE BASED UPON RECORD MAP INFORMATION, NO BOUNDARY SURVEY WAS PERFORMED.

## GENERAL NOTES:

- ALL IMPROVEMENTS SHALL BE CONSTRUCTED IN STRICT ACCORDANCE WITH THE FOLLOWING: THE LATEST CALIFORNIA BUILDING CODE (CBC 2016), THE SAN JOAQUIN COUNTY IMPROVEMENT STANDARDS DATED NOVEMBER 2014, AND ALL AMENDMENTS THERETO TO DATE, CALIFORNIA DEPARTMENT OF TRANSPORTATION STANDARD SPECIFICATIONS AND STANDARD PLANS (CALTRANS) LATEST EDITION, WHERE APPLICABLE. WHERE THERE IS A CONFLICT BETWEEN THE PLANS AND THE SAN JOAQUIN COUNTY IMPROVEMENT STANDARDS AND LOCAL BUILDING CODES, THE SAN JOAQUIN COUNTY IMPROVEMENT STANDARDS AND LOCAL BUILDING CODES SHALL PREVAIL.
- IT IS INTENDED THAT THESE PLANS, NOTES AND SPECIFICATIONS REQUIRE ALL LABOR AND MATERIALS NECESSARY AND PROPER FOR THE WORK CONTEMPLATED HEREIN AND THAT THE WORK BE COMPLETED IN ACCORDANCE WITH THEIR TRUE INTENT AND PURPOSE. THE CONTRACTOR SHALL NOTIFY THE ENGINEER IMMEDIATELY REGARDING ANY DISCREPANCIES OR AMBIGUITIES WHICH MAY EXIST IN THE PLANS OR SPECIFICATIONS. THE ENGINEER'S INTERPRETATION OF CORRECTION THEREOF SHALL BE CONCLUSIVE.
- WHERE THE PLANS OR SPECIFICATIONS DESCRIBE PORTIONS OF THE WORK IN GENERAL TERMS BUT NOT IN COMPLETE DETAIL, IT IS UNDERSTOOD THAT ONLY THE BEST GENERAL PRACTICE IS TO PREVAIL AND THAT ONLY MATERIALS AND WORKMANSHIP OF THE FIRST QUALITY ARE TO BE USED.
- THE CONTRACTOR AND/OR OWNER SHALL BE RESPONSIBLE FOR ALL PERMITS AND LICENSES REQUIRED FOR THE CONSTRUCTION AND COMPLETION OF THE PROJECT.
- THE CONTRACTOR SHALL BE HELD RESPONSIBLE FOR ANY FIELD CHANGES MADE WITHOUT WRITTEN AUTHORIZATION FROM THE ENGINEER FOR ON-SITE WORK AND FROM THE ENGINEER & SAN JOAQUIN COUNTY FOR WORK WITHIN THE PUBLIC RIGHT-OF-WAY. ANY AND ALL CHANGES MADE SHALL COMPLY WITH THE MOST RECENT APPLICABLE CODES AND LOCAL REQUIREMENTS.
- THE CONTRACTOR SHALL PROVIDE ALL LIGHTS, BARRICADES, SIGNS, FLAGMEN OR OTHER DEVICES NECESSARY FOR PUBLIC SAFETY. ALL CONSTRUCTION TRAFFIC SIGNS, DEVICES AND MARKINGS SHALL BE PER CA MUTCD (LATEST EDITION).
- THE CONTRACTOR SHALL CHECK WITH THE OWNER AND UTILITY COMPANIES AND VERIFY ALL UTILITY LOCATIONS. IT SHALL BE THE CONTRACTOR'S SOLE RESPONSIBILITY TO PROTECT ALL EXISTING UTILITIES SO THAT NO DAMAGE RESULTS TO THEM DURING THE PERFORMANCE OF THE CONTRACT. THE CONTRACTOR SHALL BE REQUIRED TO COOPERATE WITH OTHER CONTRACTORS, WHEN OTHERS ARE WORKING IN THE SAME AREA.
- PRIOR TO COMMENCING ANY WORK, IT SHALL BE THE CONTRACTOR'S RESPONSIBILITY TO HAVE EACH UTILITY COMPANY LOCATE IN THE FIELD THEIR MAIN AND SERVICE LINES. THE CONTRACTOR SHALL NOTIFY MEMBERS OF THE UNDERGROUND SERVICE ALERT (U.S.A.) 48 HOURS IN ADVANCE OF PERFORMING EXCAVATION WORK BY CALLING THE TOLL-FREE NUMBER (800) 227-2600.
- THE CONTRACTOR SHALL BE RESPONSIBLE FOR PROTECTING EXISTING IMPROVEMENTS FROM DAMAGE. THE COST OF REPLACING EXISTING IMPROVEMENTS SHALL BE INCLUDED IN THE UNIT PRICE BID FOR ITEMS REQUIRING REMOVAL AND REPLACEMENT OF EXISTING IMPROVEMENTS.
- WHENEVER PAVEMENT OR CONCRETE IS BROKEN OR CUT IN THE INSTALLATION OF THE WORK COVERED BY THESE PLANS AND SPECIFICATIONS, THE PAVEMENT OR CONCRETE SHALL BE REPLACED AFTER PROPER BACKFILLING WITH PAVEMENT OR CONCRETE MATERIALS EQUAL TO OR BETTER THAN THE REMOVED MATERIALS. UNLESS NOTED OTHERWISE THE FINISHED PAVEMENT OR CONCRETE SHALL BE SUBJECT TO THE APPROVAL OF THE ENGINEER & THE OWNER FOR ON-SITE WORK AND FROM THE ENGINEER & SAN JOAQUIN COUNTY FOR WORK WITHIN THE PUBLIC RIGHT-OF-WAY.
- PAYMENT FOR PAVEMENT OR CONCRETE WILL BE MADE ONLY FOR AREAS SHOWN ON THE PLANS. REPLACEMENT OF PAVEMENT OR CONCRETE WHICH IS BROKEN OR CUT IN THE INSTALLATION OF THE WORK COVERED BY THESE PLANS AND SPECIFICATIONS, AND WHICH LIES OUTSIDE OF SAID AREAS, SHALL BE INCLUDED IN THE CONTRACTOR'S UNIT PRICES, AND NO ADDITIONAL PAYMENT SHALL BE MADE FOR SUCH WORK.
- THE CONTRACTOR AGREES THAT THEY SHALL ASSUME SOLE AND COMPLETE RESPONSIBILITY FOR JOB SITE CONDITIONS DURING THE COURSE OF CONSTRUCTION OF THIS PROJECT, INCLUDING SAFETY OF ALL PERSONS AND ALL PROPERTY; THAT THIS REQUIREMENT SHALL APPLY CONTINUOUSLY AND NOT BE LIMITED TO NORMAL WORKING HOURS; AND THAT THE CONTRACTOR SHALL DEFEND, INDEMNIFY AND HOLD THE OWNER AND ENGINEER HARMLESS FROM ANY AND ALL LIABILITY, REAL OR ALLEGED, IN CONNECTION WITH THE PERFORMANCE OF WORK ON THIS PROJECT, EXCEPTING FOR THE LIABILITY ARISING FROM THE SOLE NEGLIGENCE OF THE OWNER OR THE ENGINEER.
- EXCAVATIONS OF 5 FEET OR MORE IN DEPTH WILL REQUIRE AN EXCAVATION PERMIT FROM THE STATE OF CALIFORNIA DEPARTMENT OF INDUSTRIAL SAFETY. FOR TRENCHES, 5 FEET OR MORE IN DEPTH, THE CONTRACTOR SHALL COMPLY WITH SECTION 5-1.02A OF THE CALTRANS STANDARDS, THE STATE OF CALIFORNIA LABOR CODE, AND ANY LOCAL CODES OR ORDINANCES.
- THE CONTRACTOR'S ATTENTION IS DIRECTED TO: SECTION 1540 (g) (1) OF THE CONSTRUCTION SAFETY ORDERS (TITLE 8 CALIFORNIA ADMINISTRATIVE CODE SECTION 1540), ISSUED BY THE NATIONAL SAFETY AND HEALTH STANDARDS BOARD PURSUANT TO THE CALIFORNIA OCCUPATIONS SAFETY AND HEALTH ACT OF 1973 AS AMENDED WHICH STATES:  
(1) PRIOR TO OPENING AN EXCAVATION, EFFORT SHALL BE MADE TO DETERMINE WHETHER UNDERGROUND INSTALLATIONS, I.E. SEWER, WATER, FUEL, ELECTRIC LINES, ETC. WILL BE ENCOUNTERED AND IF SO, WHERE SUCH UNDERGROUND INSTALLATIONS ARE LOCATED. WHEN THE EXCAVATION APPROACHES THE APPROXIMATE LOCATION OF SUCH AN INSTALLATION, THE EXACT LOCATION SHALL BE DETERMINED BY CAREFUL PROBING OR HAND DIGGING; AND, WHEN IT IS UNCOVERED, ADEQUATE PROTECTION SHALL BE PROVIDED FOR THE EXISTING INSTALLATION. ALL KNOWN OWNERS OF UNDERGROUND FACILITIES IN THE AREA CONCERNED SHALL BE ADVISED OF PROPOSED WORK AT LEAST 48 HOURS PRIOR TO THE START OF ACTUAL EXCAVATION.
- NO PRODUCTS CONTAINING ASBESTOS WILL BE PERMITTED ON THE JOB.
- ALL EXISTING GROUND ELEVATIONS ARE BASED ON THE TOPOGRAPHIC SURVEY NOTES DATED MAY 2017.
- DRAWING NUMBERS SHOWN ON THESE PLANS REFER TO DRAWINGS CONTAINED IN THE SAN JOAQUIN COUNTY IMPROVEMENT STANDARDS SHOWN THUS: DWG. NO. UNLESS STATED OTHERWISE.

<b>BENCHMARK INFO</b> BENCH MARK USED: SAN JOAQUIN COUNTY BENCH MARK LIST, DATED JANUARY 1983 SAN JOAQUIN COUNTY BENCH MARK, ELEVATION = 100.456 (+ BENCH = LM) (MARK * = -10.6) SECTION 31, T4N, R8E, TULLY ROAD, X-ROAD BRANDT USGS BRASS CAP CA-68, 425' N/O BRIDGE OVER BEAR CREEK (DATE 10/78) ELEV. = 101.74
<b>TEMPORARY BENCHMARK INFO</b> "FOUND 3/4" IRON PIN" IN JACK TONE ROAD MONUMENT WELL, NO TAG, LOCATED 42.30 FEET FROM THE INTERSECTION OF JACK TONE ROAD & HAMMOND STREET, SEE TOPOGRAPHICAL MAP FOR LOCATION. ELEV. = 101.74
<b>ORDER OF WORK</b> THE CONTRACTOR'S FIRST ORDER OF WORK SHALL BE TO VERIFY THE LOCATION & ELEVATION OF ALL EXISTING UTILITY FACILITIES WHICH ARE A PART OF OR MAY BE IN CONFLICT WITH A PART OF THE WORK HEREIN CONTEMPLATED. THIS INFORMATION SHALL BE PROVIDED TO THE DESIGN ENGINEER IMMEDIATELY. THE SECOND ORDER OF WORK SHALL BE TO COORDINATE THE RELOCATION OF THOSE FACILITIES IN THE EVENT OF CONFLICT.
<b>ATTENTION</b> 1) THE FIRM PREPARING THESE PLANS WILL NOT BE RESPONSIBLE FOR, OR LIABLE FOR, UNAUTHORIZED CHANGES TO OR USES OF THESE PLANS. ALL CHANGES TO THE PLANS MUST BE IN WRITING AND MUST BE APPROVED BY THE PREPARER OF THESE PLANS. 2) CONSTRUCTION STAKING IS NORMALLY PERFORMED BY THE FIRM WHO PREPARED THE PLANS. THIS PERMITS APPROPRIATE AND NECESSARY ON-SITE INTERPRETATION AND ADJUSTMENT OF THE PLANS. THIS NOTE GIVES FORMAL NOTICE THAT THE FIRM OF A.R. SANGUINETTI & ASSOCIATES CANNOT AND WILL NOT TAKE RESPONSIBILITY FOR ERRORS OR OMISSIONS, IF ANY, WHICH MIGHT OCCUR AND WHICH COULD HAVE BEEN AVOIDED OR DETECTED AND/OR CORRECTED OR MITIGATED HAD A.R. SANGUINETTI & ASSOCIATES PERFORMED THE CONSTRUCTION STAKING. 3) ALL MONUMENTS IN WORK SITE AREA THAT WILL BE DISTURBED DURING CONSTRUCTION SHALL BE REFERENCED BY A LAND SURVEYOR PRIOR TO STARTING WORK. 4) THE CONTRACTOR SHALL BE RESPONSIBLE FOR PROTECTING MONUMENTS DURING CONSTRUCTION AND FINANCIALLY RESPONSIBLE FOR RESETTLEMENT MONUMENTS IF DISTURBED. 5) CONSTRUCTION STAKING DONE BY A.R. SANGUINETTI & ASSOCIATES, INC. REQUIRES THE CONTRACTOR TO NOTIFY A.R. SANGUINETTI & ASSOCIATES 48 - 72 HOURS IN ADVANCE OF STAKING NEEDS. 6) THE ENGINEER A.R. SANGUINETTI & ASSOCIATES ASSUMES NO RESPONSIBILITY FOR THE SUPERVISION OF CONSTRUCTION OR PROPER EXECUTION OF THE WORK SHOWN ON THESE DRAWINGS, SAFETY METHODS AND TECHNIQUES ARE THE SOLE RESPONSIBILITY OF THE CONTRACTOR.
<b>PROJECT NOTE</b> 1) THIS PROJECT CONSTRUCTION AREA IS APPROXIMATELY 0.92+ ACRES.
<b>HAZARDOUS MATERIALS NOTES</b> 1) IF, DURING THE COURSE OF WORK UNDER THIS CONTRACT, THE CONTRACTOR ENCOUNTERS ANY SURFACE OR SUBSURFACE MATERIALS THAT THE CONTRACTOR BELIEVES ARE HAZARDOUS (AS DEFINED IN SECTION 25177 OF THE HEALTH AND SAFETY CODE), THE CONTRACTOR MUST INFORM THE OWNER OR THE OWNER'S REPRESENTATIVE IN WRITING IMMEDIATELY. 2) UPON DISCOVERY, THE MATERIAL IS TO REMAIN UNDISTURBED UNTIL INVESTIGATION BY THE OWNER. 3) THE REMOVAL AND/OR DISPOSAL OF HAZARDOUS MATERIALS, IF DISCOVERED, IS NOT INITIALLY PART OF THE SCOPE OF WORK OF THIS CONTRACT UNLESS SPECIFICALLY CALLED OUT IN THE CONTRACT DOCUMENTS. AT THE DISCRETION OF THE OWNER, SUCH WORK MAY BE ADDED TO THE CONTRACT BY MUTUAL AGREEMENT PURSUANT TO THE CONTRACT PROVISIONS FOR CHANGES. 4) ANY AND ALL REMOVAL OF HAZARDOUS MATERIAL SHALL BE PERFORMED BY A LICENSED CONTRACTOR WHO CAN LEGALLY REMOVE, HAUL, DISPOSE OF, ETC. HAZARDOUS MATERIALS AND OBTAIN ANY NECESSARY PERMITS FROM THE APPROPRIATE AGENCIES.



COUNTY OF SAN JOAQUIN DEPARTMENT OF PUBLIC WORKS ENCROACHMENT PERMIT PLAN SET APPROVAL	
THIS SET OF IMPROVEMENT PLANS CONTAINS BOTH PUBLIC AND PRIVATE IMPROVEMENTS. COUNTY ACCEPTANCE OF THE DESIGN AND IMPROVEMENTS IS LIMITED TO WORK PERFORMED WITHIN THE COUNTY RIGHTS-OF-WAY ONLY. REFER TO ENCROACHMENT PERMIT SPECIAL CONDITIONS FOR MORE INFORMATION.	
ACCEPTED: Alex Chetty	DATE: 11/5/18
RCE NO.: 55407	EXP. DATE: 12/31/18
ENCROACHMENT PERMIT NO.: 85-1702619 DATE ISSUED: 11/5/18 BY: CRH	

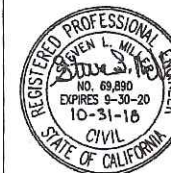

A.R. SANGUINETTI & ASSOCIATES  
CONSULTING CIVIL ENGINEERS  
1150 W. ROBINHOOD, DR., STE. 1C  
STOCKTON, CALIFORNIA



REVISIONS	DATE	DESCRIPTION	APPROVED

DESIGNED BY: JMS/SLM	DRAWN BY: SLM	CHECKED BY: JMS/SLM	SCALE: AS SHOWN
----------------------	---------------	---------------------	-----------------

LODI UNIFIED SCHOOL DISTRICT  
PROPOSED TRAFFIC CIRCULATION  
LOCKEFORD ELEMENTARY SCHOOL  
TITLE SHEET

SHEET  
1  
OF 17 SHEETS





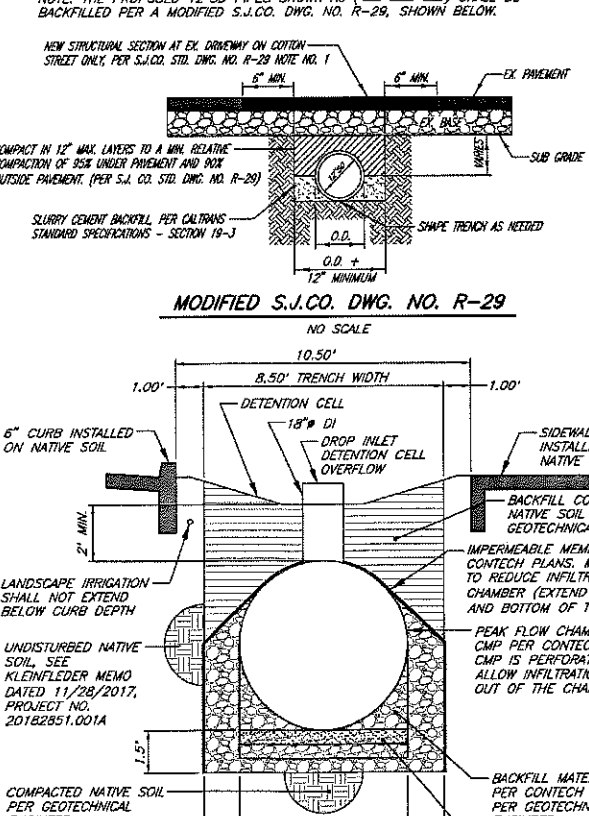
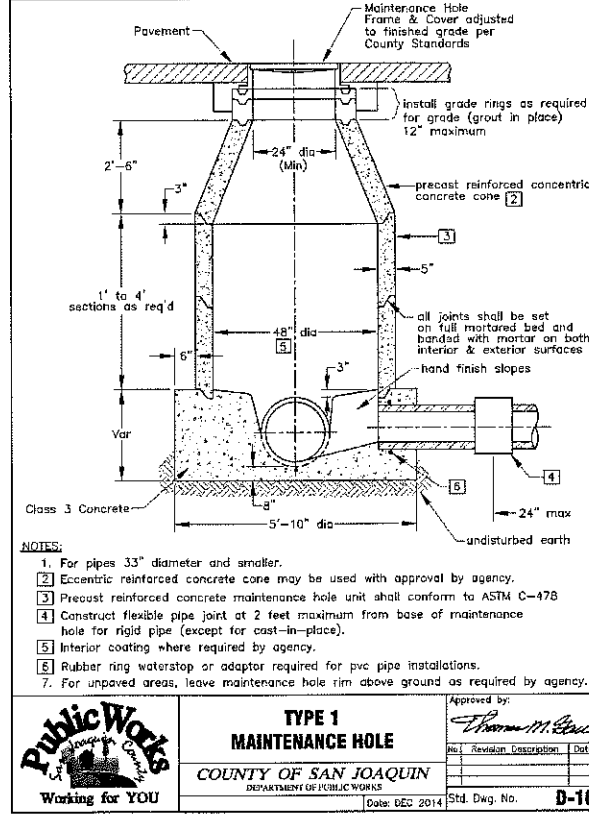
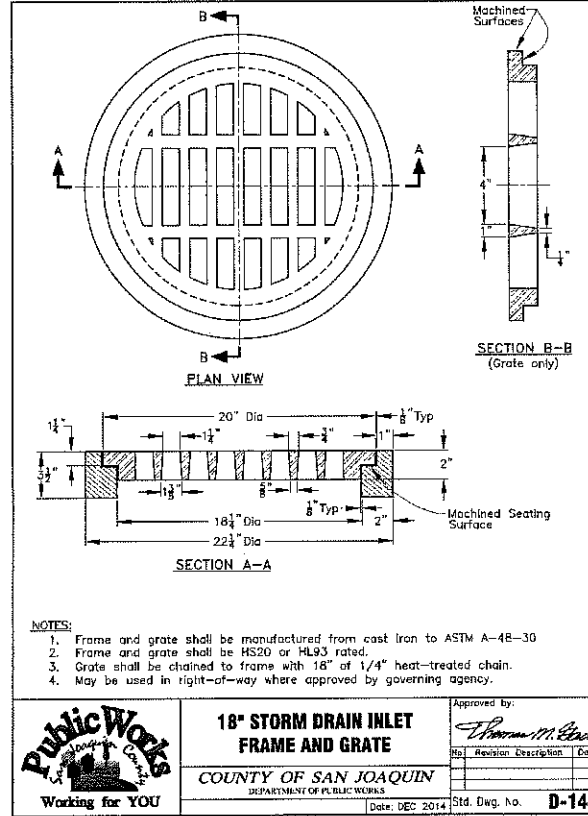
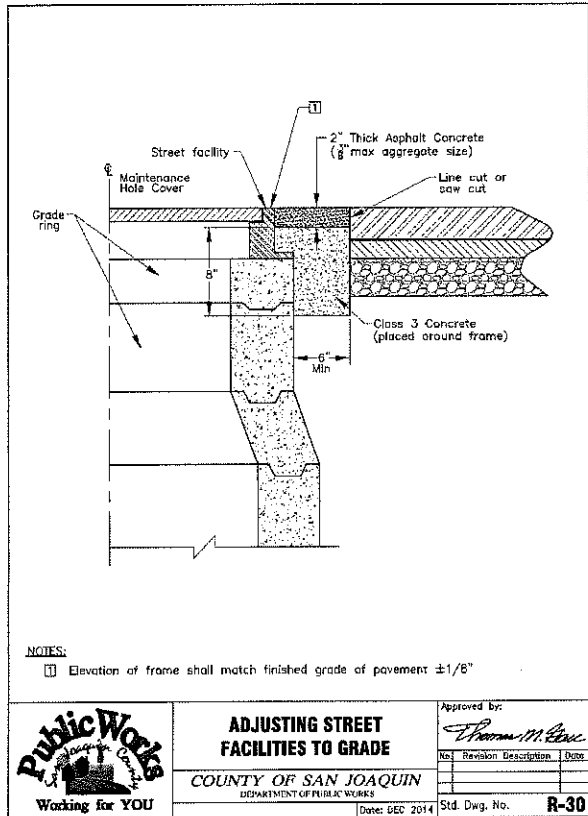
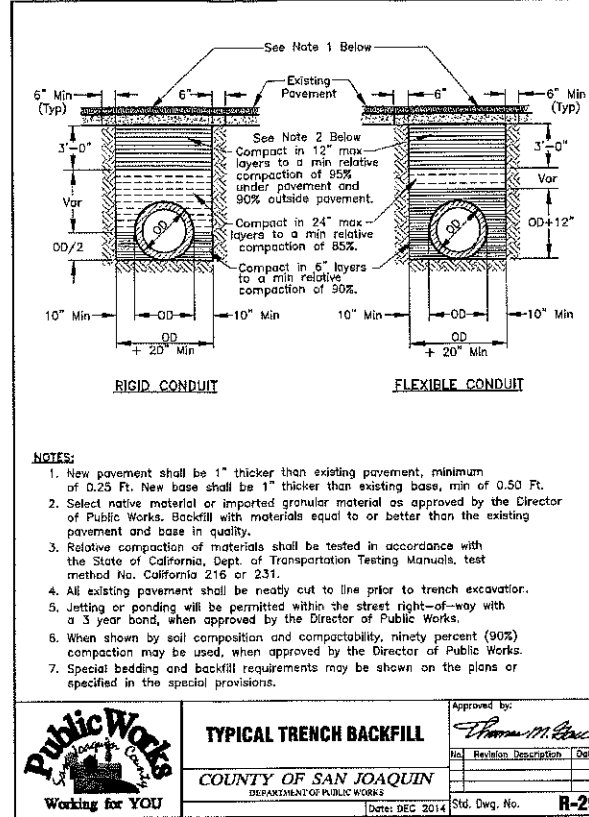
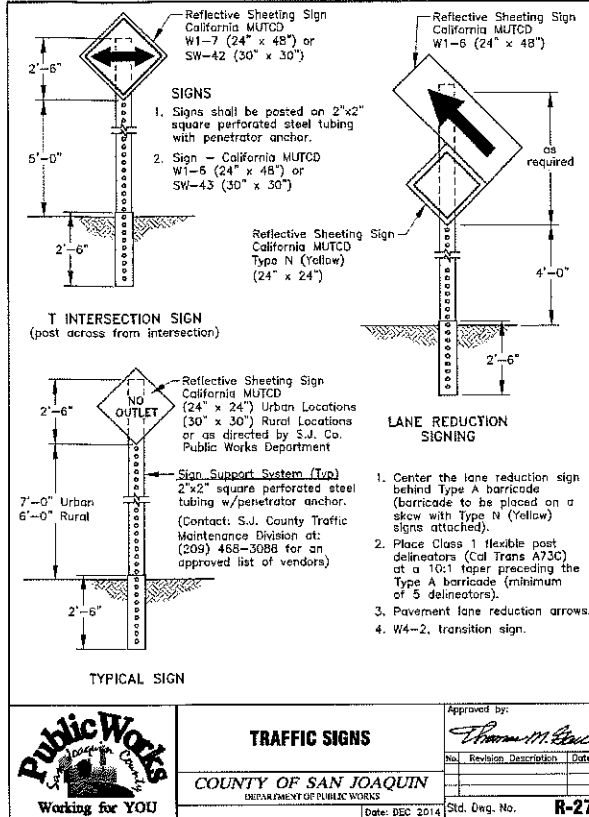
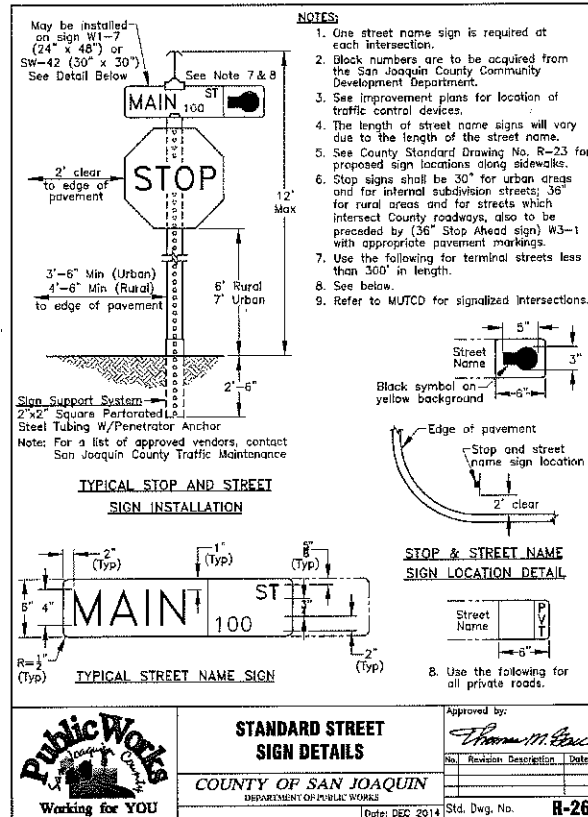
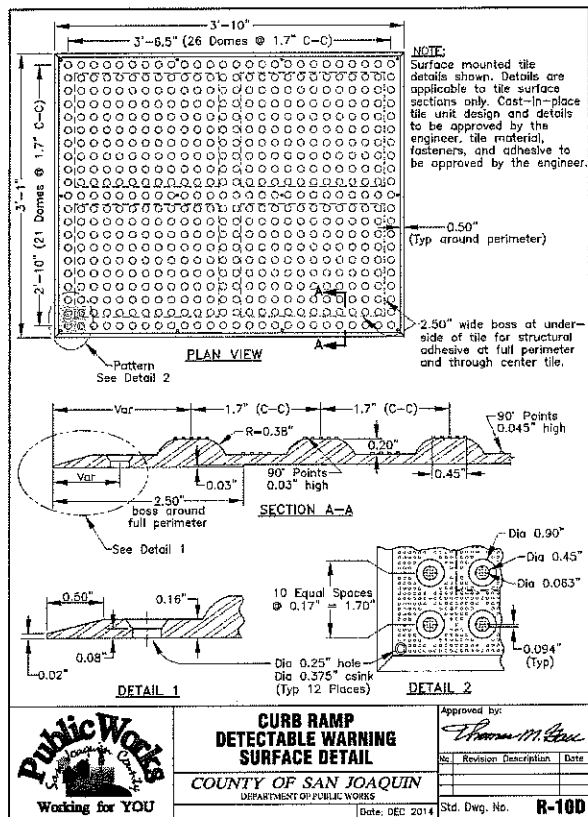

**A.R. SANGUNETI & ASSOCIATES**  
CONSULTING CIVIL ENGINEERS  
1150 W. ROBINHOOD, DR., STE. 1C  
STOCKTON, CALIFORNIA

**LODI UNIFIED SCHOOL DISTRICT**  
PROPOSED  
TRAFFIC CIRCULATION  
LOCKEFORD ELEMENTARY SCHOOL

**DESIGNED BY:** JMS/SLM  
**DRAWN BY:** SLJ  
**CHECKED BY:** JMS/SLM  
**SCALE:** AS SHOWN

**SHEET**  
**3**  
**OF 17 SHEETS**



APPROVED	REVISIONS
DATE	DESCRIPTION

DESIGNED BY: JMS/SLM  
 DRAWN BY: SLM  
 CHECKED BY: JMS/SLM  
 SCALE: AS SHOWN

LODI UNIFIED SCHOOL DISTRICT  
 PROPOSED  
 TRAFFIC CIRCULATION  
 LOCKEFORD ELEMENTARY SCHOOL

**DETAILS**

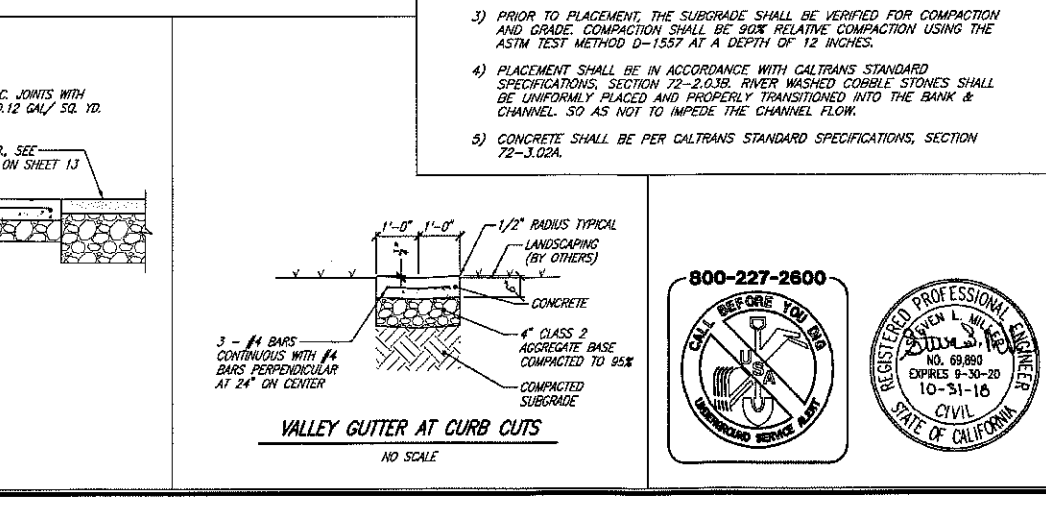
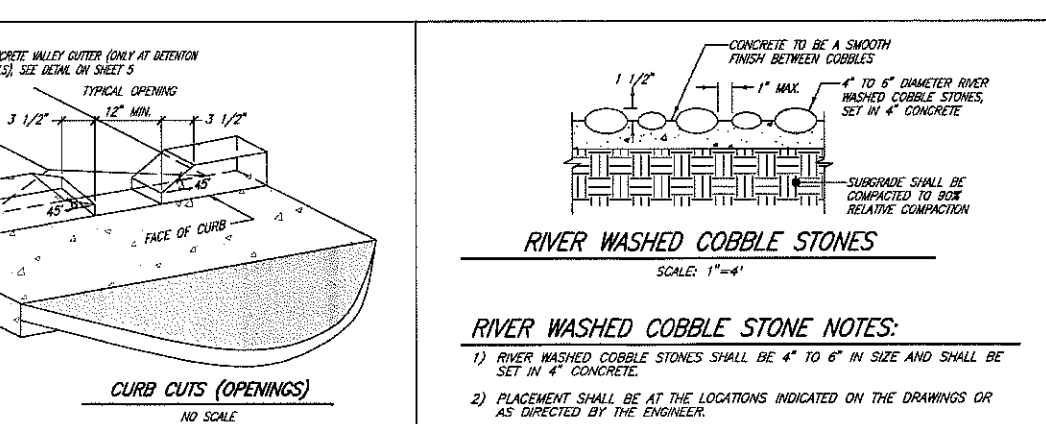
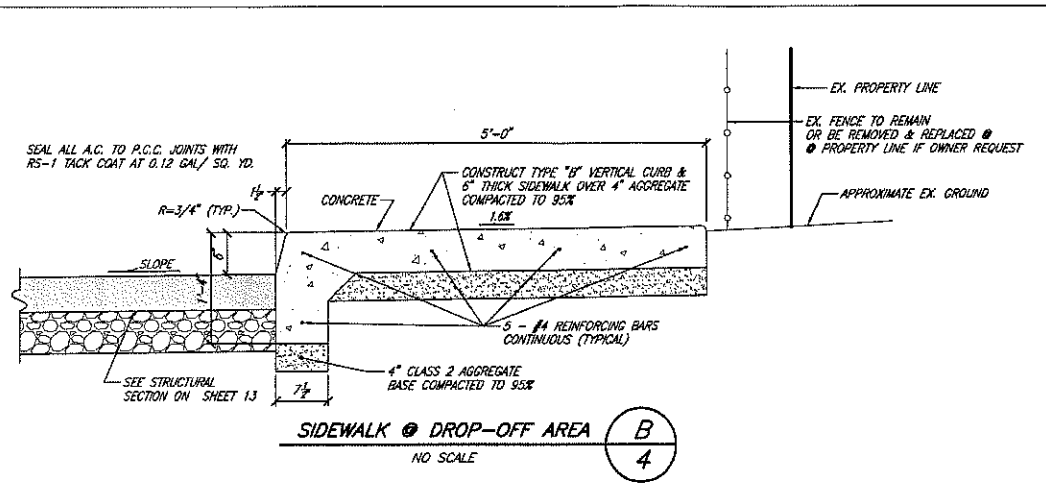
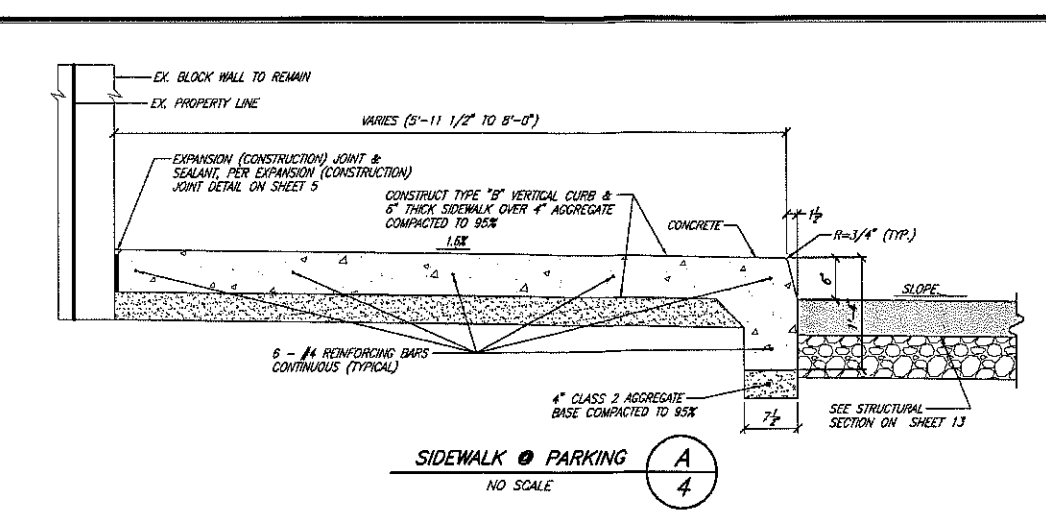
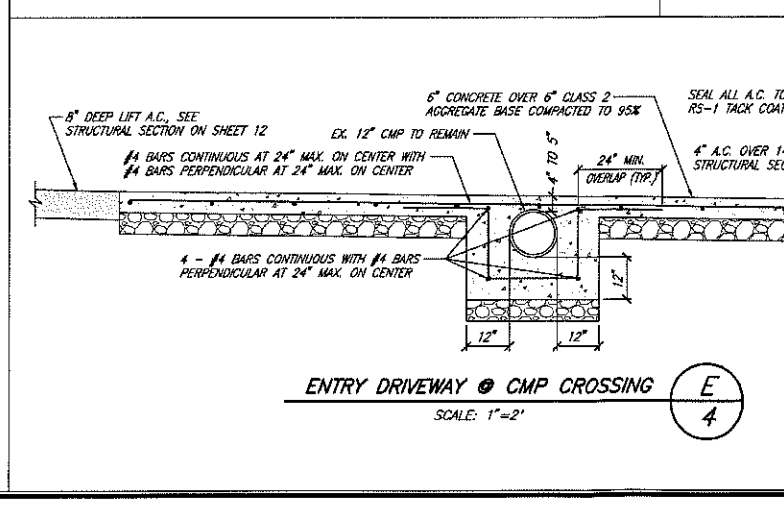
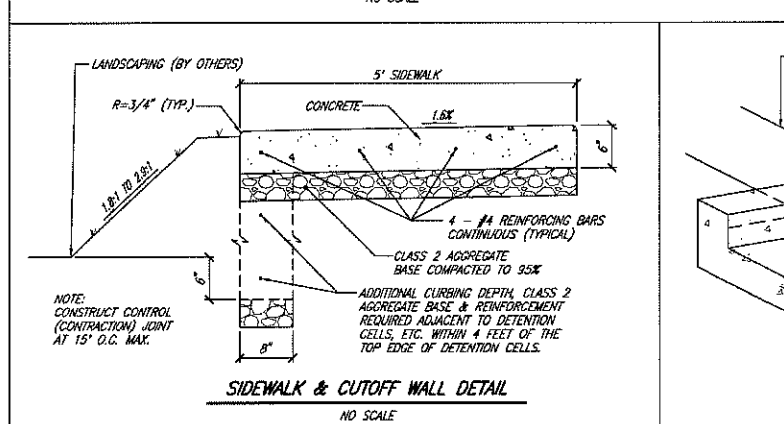
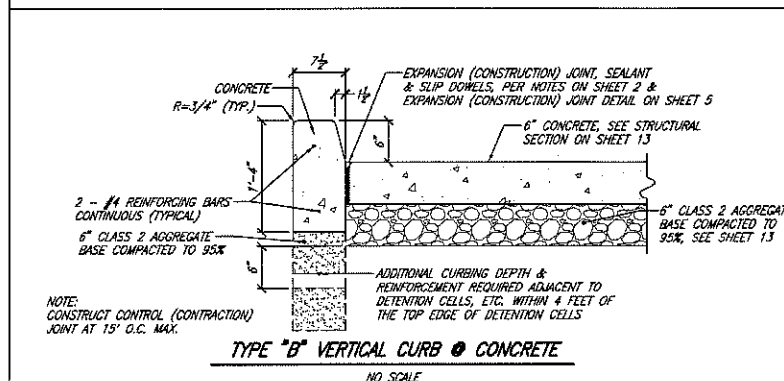
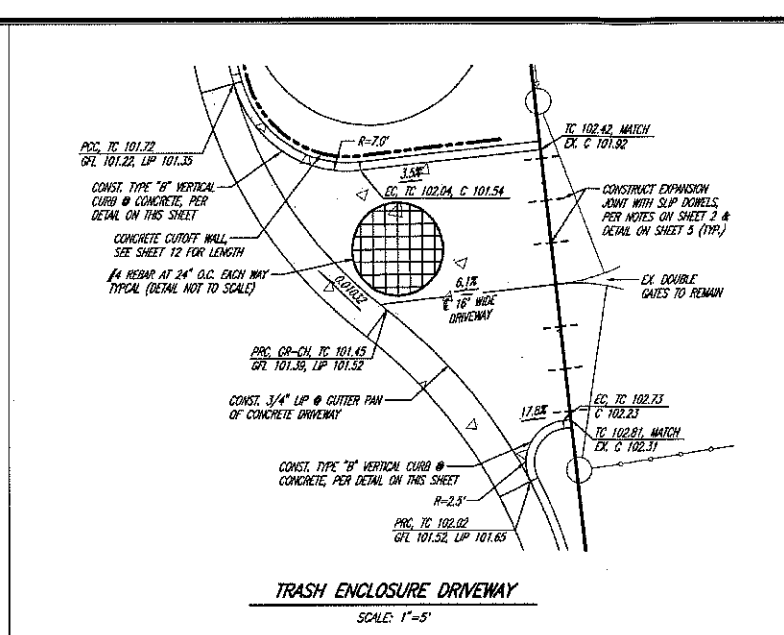
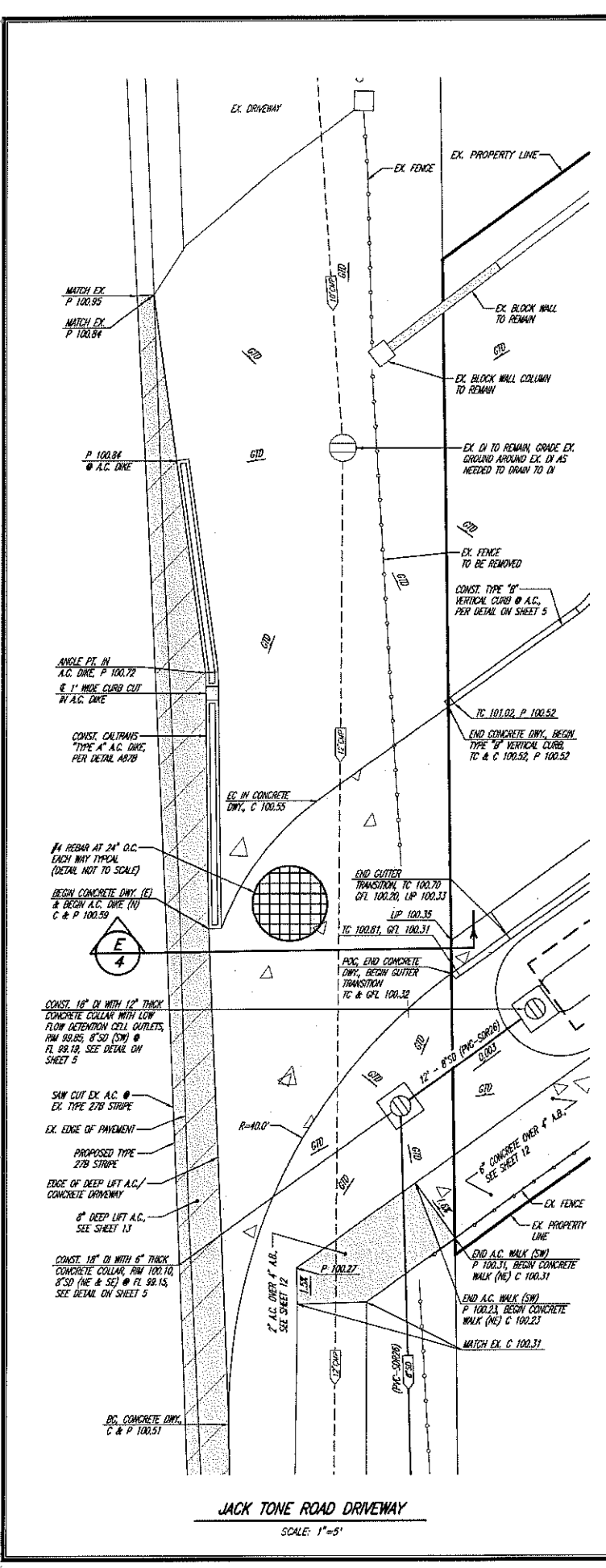

- RIVER WASHED COBBLE STONE NOTES:**
- 1) RIVER WASHED COBBLE STONES SHALL BE 4" TO 6" IN SIZE AND SHALL BE SET IN 4" CONCRETE.
  - 2) PLACEMENT SHALL BE AT THE LOCATIONS INDICATED ON THE DRAWINGS OR AS DIRECTED BY THE ENGINEER.
  - 3) PRIOR TO PLACEMENT, THE SUBGRADE SHALL BE VERIFIED FOR COMPACTION AND GRADE. COMPACTION SHALL BE 90% RELATIVE COMPACTION USING THE ASTM TEST METHOD D-1557 AT A DEPTH OF 12 INCHES.
  - 4) PLACEMENT SHALL BE IN ACCORDANCE WITH CALTRANS STANDARD SPECIFICATIONS, SECTION 72-2.03B. RIVER WASHED COBBLE STONES SHALL BE UNIFORMLY PLACED AND PROPERLY TRANSITIONED INTO THE BANK & CHANNEL, SO AS NOT TO IMPEDE THE CHANNEL FLOW.
  - 5) CONCRETE SHALL BE PER CALTRANS STANDARD SPECIFICATIONS, SECTION 72-3.02A.

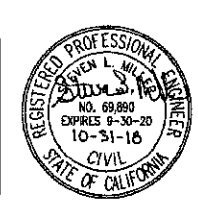







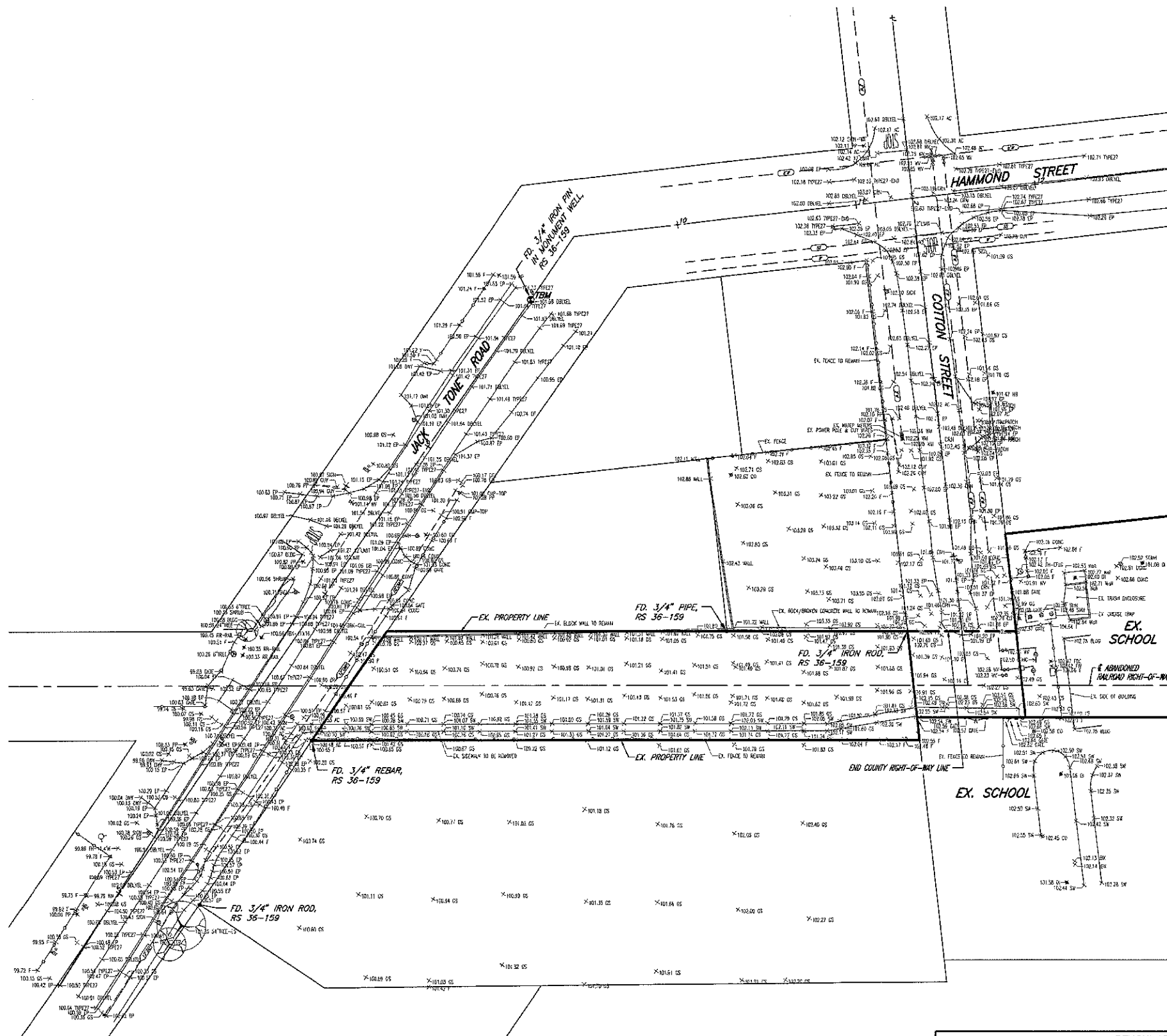











## ABBREVIATIONS

AC	ASPHALT CONCRETE
BLDG	BUILDING
BRK-COL	BRICK COLUMN
CHKV	CHECK VALVE
CONC	CONCRETE
DBLYEL	DOUBLE YELLOW LINE
DI	DRAIN INLET
DRWY	DRIVEWAY
EP	EDGE OF PAVEMENT
EX.	EXISTING
F	FENCE
FD	FOUND
FDC	FIRE DEPARTMENT CONNECTION
FL-CMP	FLOW LINE CORRUGATED METAL PIPE
GS	GROUND
GUY	GUY WIRE
HB	HOSE BIB
IBX	IRRIGATION BOX
MBX	MAILBOX
PIV	POST INDICATOR VALVE
PP	POWER POLE
RS	RECORD OF SURVEY, BOOK-PAGE
SD	STORM DRAIN
SDMH	STORM DRAIN MAINTENANCE HOLE
SMH	SANITARY SEWER MAINTENANCE HOLE
SS	SANITARY SEWER
SW	SIDEWALK
TYPE27	TYPE 27 STRIPE (EDGE LINE)
W	WATER
WALL	BLOCK WALL
WM	WATER METER
WV	WATER VALVE
12"LIMIT	12" WIDE LIMIT LINE

**LEGEND**

	EXISTING SANITARY SEWER SIZE & DIRECTION
	EXISTING SANITARY SEWER SIZE & DIRECTION
	EXISTING WATER LINE SIZE
	EXISTING FENCE
	EXISTING WATER VALVE
	EXISTING FIRE HYDRANT
	EXISTING MAINTENANCE HOLE
	EXISTING DRAIN INLET / CATCH BASIN
	SUBDIVISION BOUNDARY LINE
	EXISTING ELEVATION & DESCRIPTION OF SHOT

+ 120.00  
DESCRIPTION

**BOUNDARY NOTE:**

BEARINGS & DISTANCES SHOWN ARE BASED UPON RECORD MAP INFORMATION. NO BOUNDARY SURVEY WAS PERFORMED. THE BASIS BEARINGS CAME FROM THE RECORD OF SURVEY, RECORDED IN BOOK OF SURVEY, VOLUME 36, PAGE 159, SAN JOAQUIN COUNTY RECORDS.

### BENCHMARK INFO

BENCH MARK USED: SAN JOAQUIN COUNTY BENCH MARK LIST, DATED JANUARY 1983

SAN JOAQUIN COUNTY BENCH MARK, ELEVATION = 100.456

(\* BENCH = LM) (MARK \* = -10.6)  
SECTION 31. T4N. R8E. TULLY ROAD.

USCE BRASS CAP CA-68, 425' N/O BRIDGE OVER BEAR CREEK (DATE 10/78)

TEMPORARY BENCHMARK INFO

"FOUND 3/4" IRON PIN IN JACK TONE ROAD MONUMENT WELL, NO TAG, LOCATED 42.30 FEET FROM THE INTERSECTION OF JACK TONE ROAD & HAMMOND STREET, SEE TOPOGRAPHICAL MAP FOR LOCATION.  
ELEV. = 101.74



**LODI UNIFIED SCHOOL DISTRICT  
PROPOSED  
TRAFFIC CIRCULATION  
LOCKFORD ELEMENTARY SCHOOL**

# TOPOGRAPHICAL MAP

SHEET

7

OF 17 SHEETS

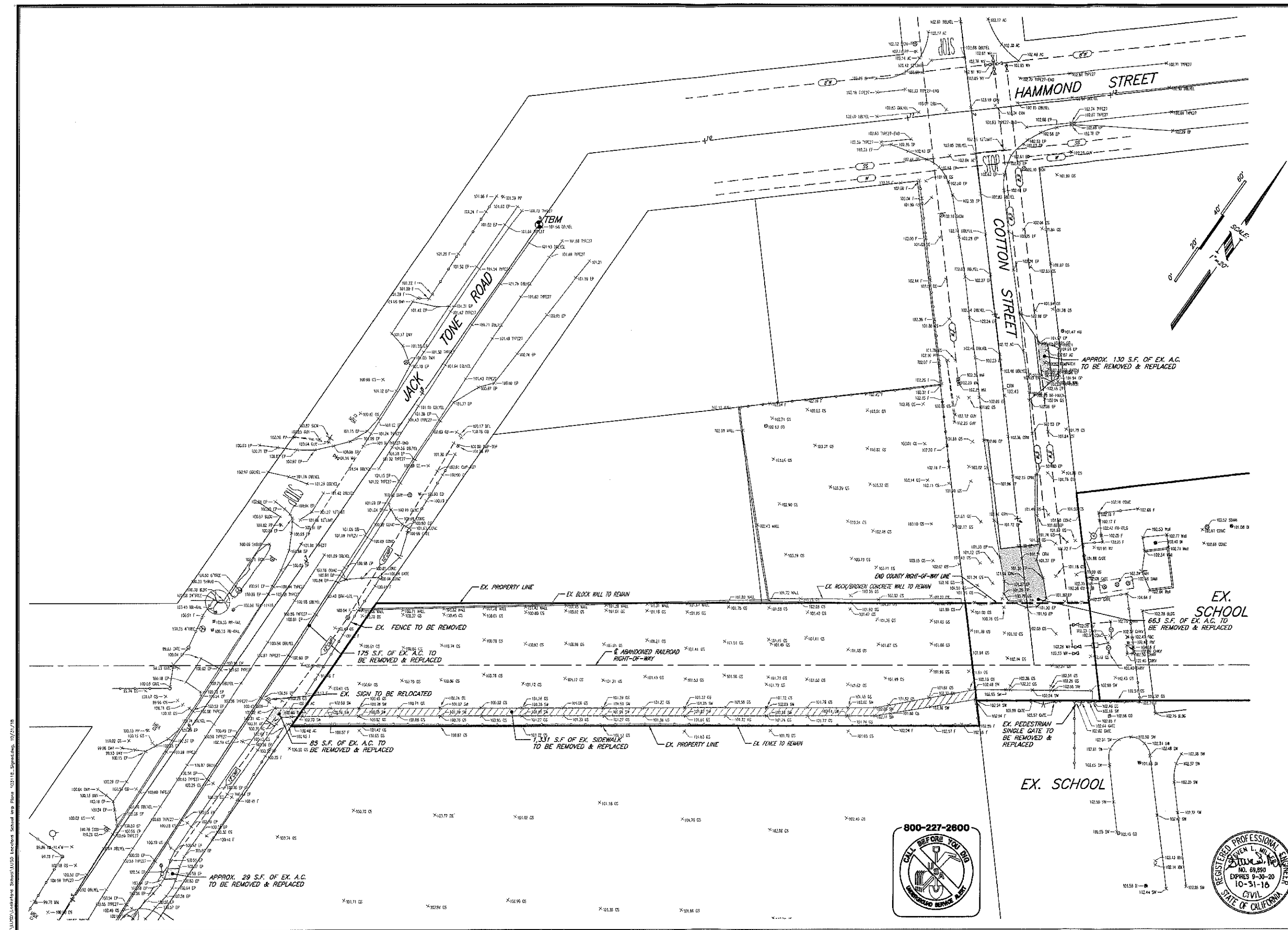

**HENRY+  
ASSOCIATES  
ARCHITECTS**

226 Howe Avenue, Suite 250  
Berkeley, CA 94705  
Phone: 916.921.2112  
Fax: 916.921.2212

[illegible]

DESIGNED BY: JMS/SLM	DRAWN BY: SLM	CHECKED BY: JMS/SLM	SCALE: AS SHOWN
-------------------------	------------------	------------------------	--------------------

**LODI UNIFIED SCHOOL DISTRICT  
PROPOSED  
TRAFFIC CIRCULATION  
LOCKFORD ELEMENTARY SCHOOL  
DEMOLITION PLAN**

SHEET  
8  
OF 17 SHEETS



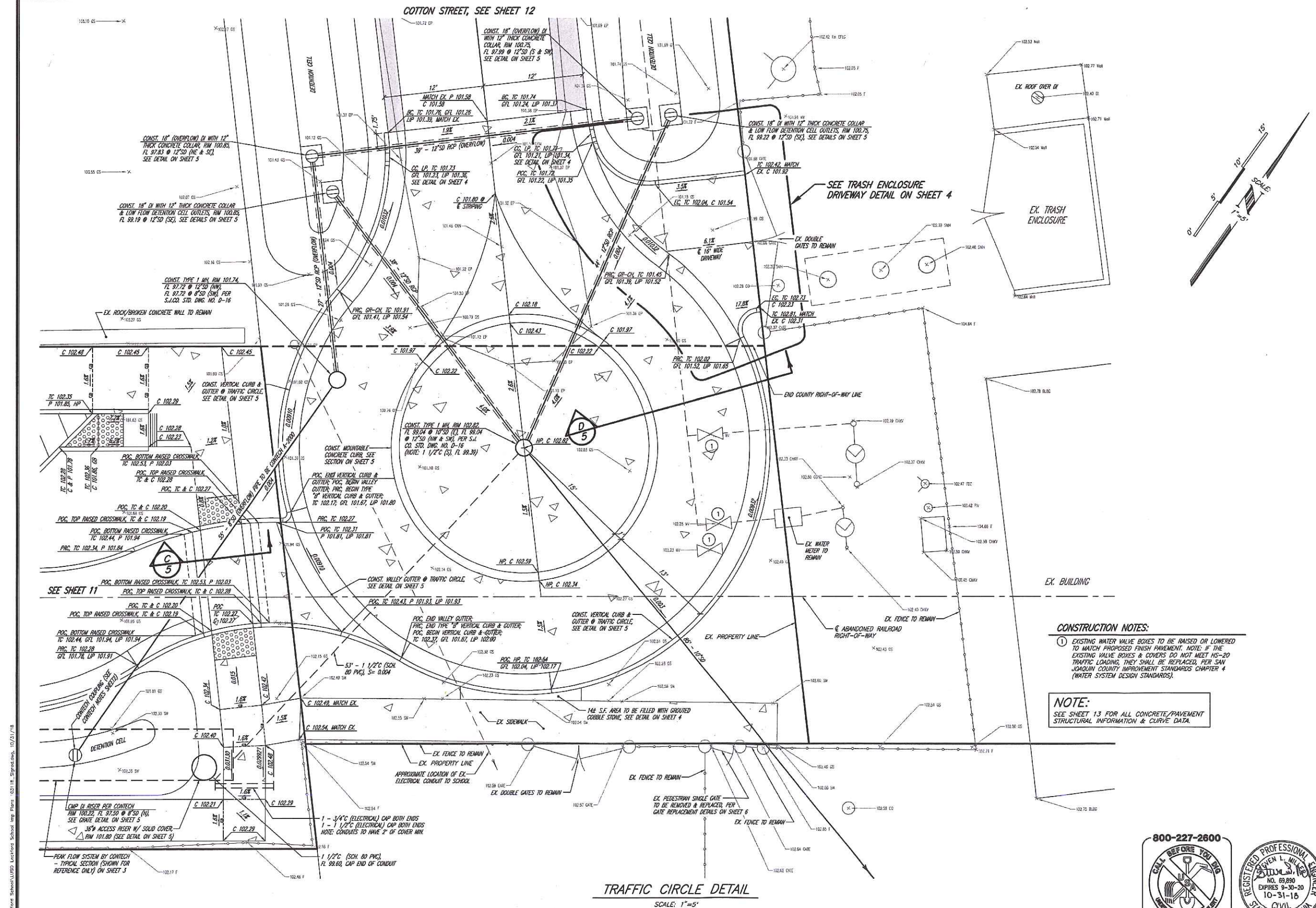

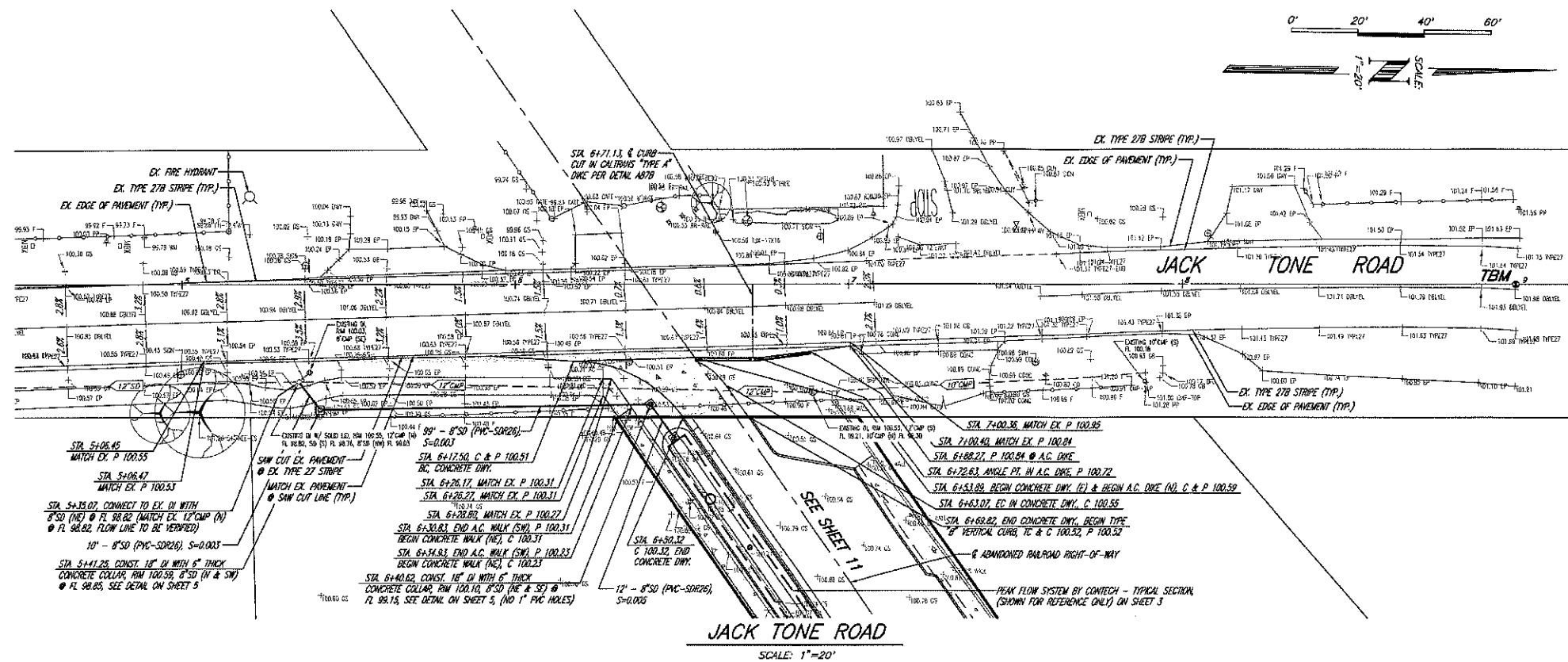

**TRAFFIC NOTE:**  
THE CONTRACTOR SHALL SUBMIT A TRAFFIC CONTROL PLAN TO SAN JOAQUIN COUNTY PRIOR TO THE START OF CONSTRUCTION.



**LODI UNIFIED SCHOOL DISTRICT  
PROPOSED  
TRAFFIC CIRCULATION  
LOCKEFORD ELEMENTARY SCHOOL  
JACK TONE ROAD**

**JACK TONE ROAD**

SHEET

10

OF **17** SHEETS

**R. SANGUINETTI & ASSOCIATES**  
CONSULTING CIVIL ENGINEERS  
1150 W. ROBINHOOD, DR., STE. 1C  
STOCKTON, CALIFORNIA

[illegible]

DESIGNED BY: JMS/SLM	DRAWN BY: SLM	CHECKED BY: JMS/SLM	SCALE: AS SHOWN
-------------------------	------------------	------------------------	--------------------





APPROVED	REVISIONS
DATE	DESCRIPTION

DESIGNED BY:	JMS/SJM
DRAWN BY:	SJM
CHECKED BY:	JMS/SJM
SCALE:	AS SHOWN

LODI UNIFIED SCHOOL DISTRICT  
PROPOSED  
TRAFFIC CIRCULATION  
LOCKEFORD ELEMENTARY SCHOOL  
COTTON STREET

SHEET

**12**

OF 17 SHEETS

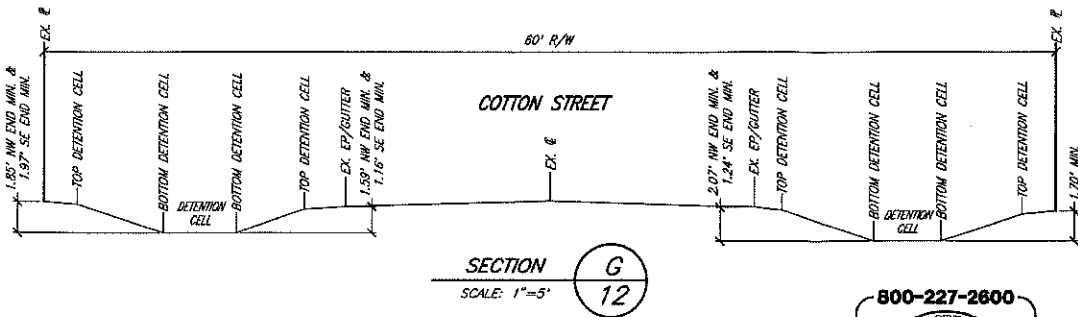
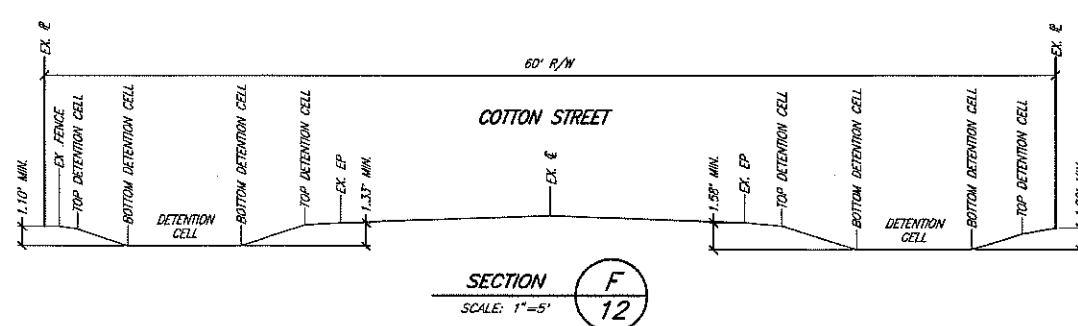
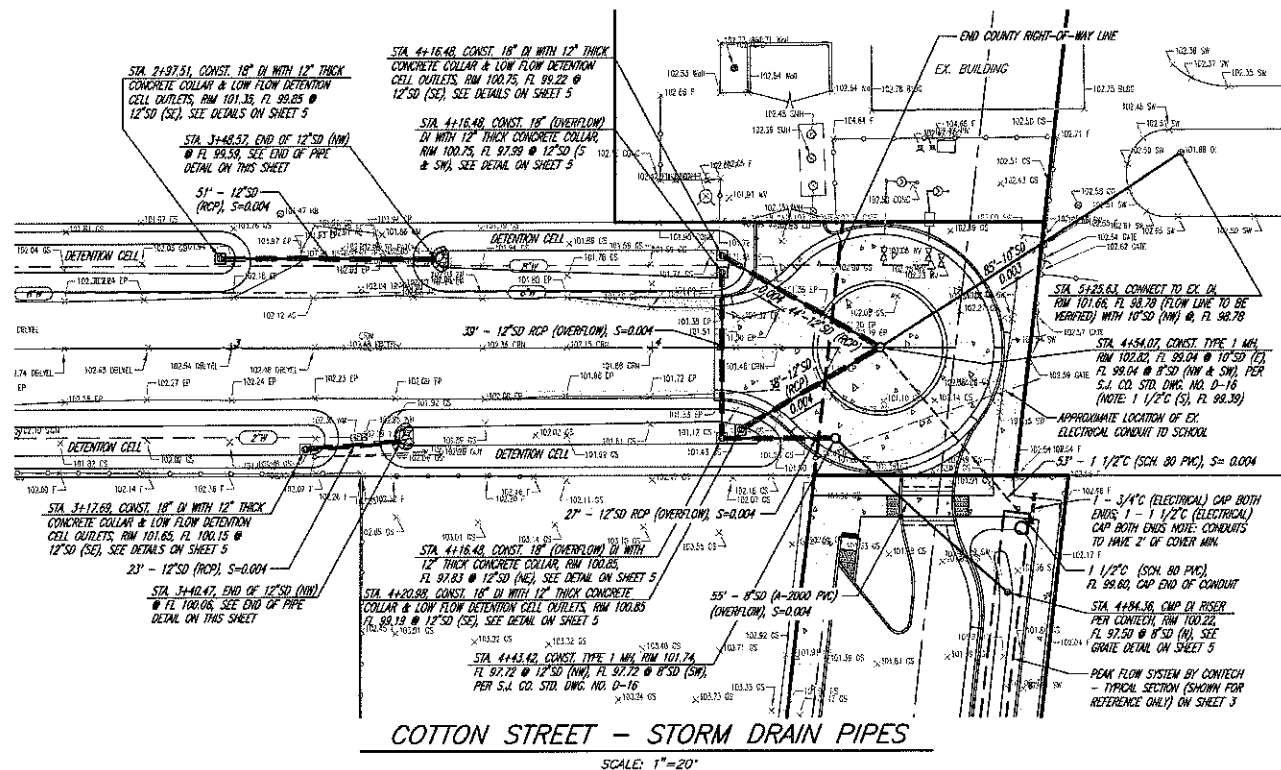
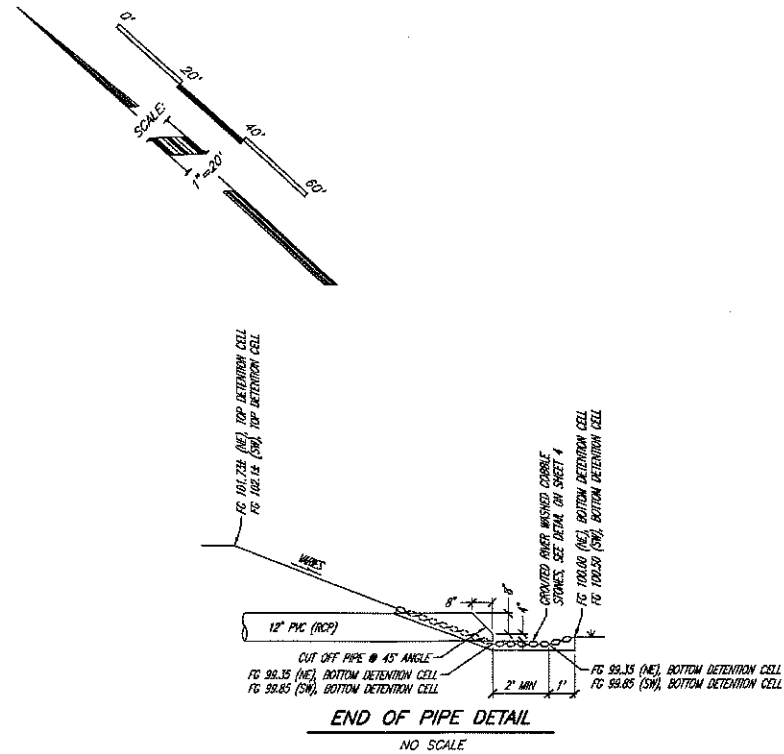
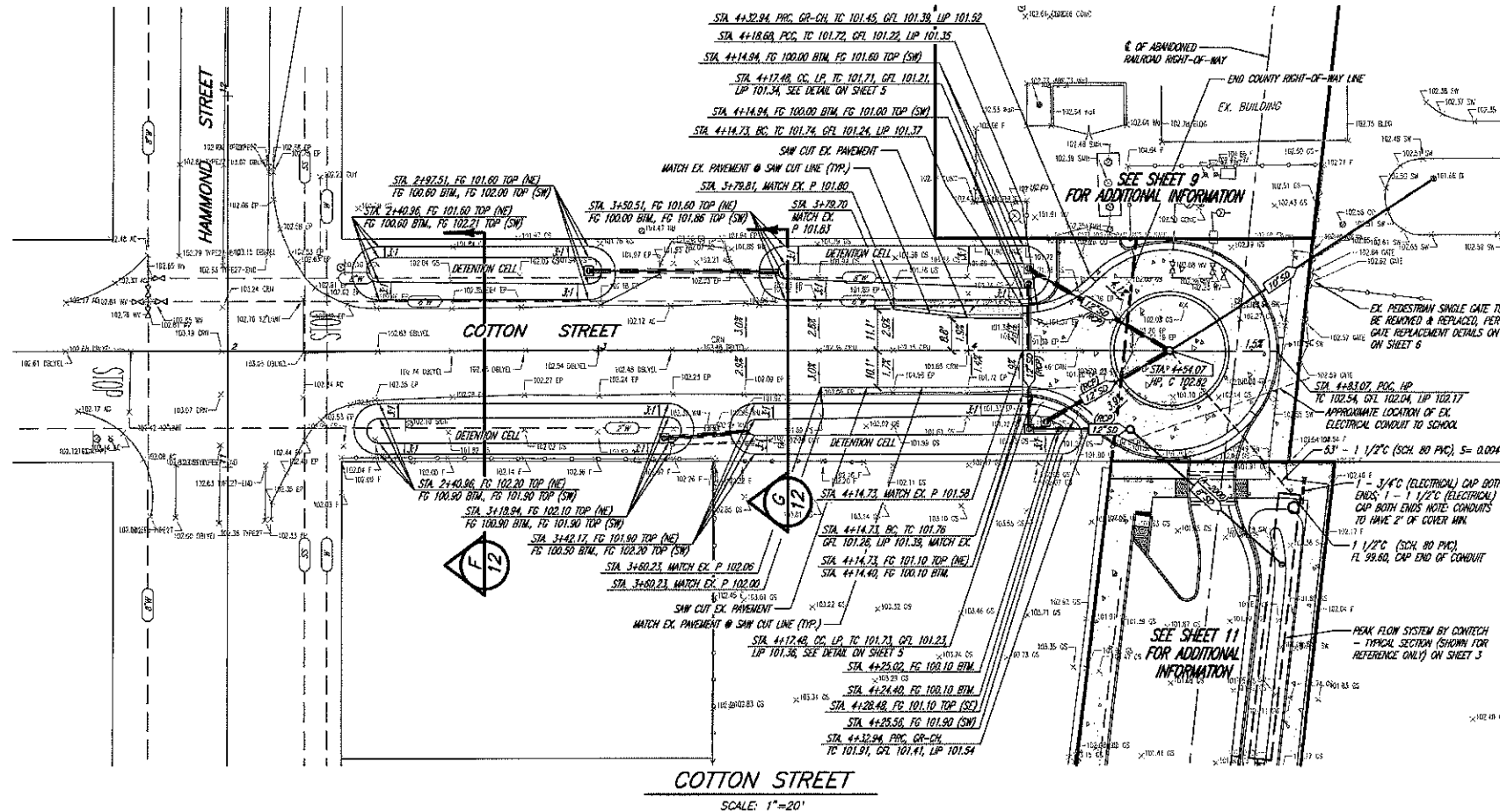

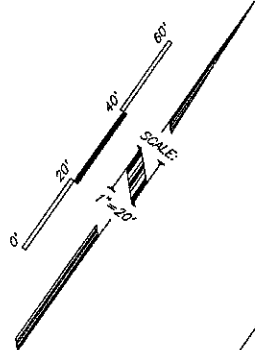

**NOTES:**

- 1) VERTICAL CURBS; VERTICAL CURB & GUTTER; MOUNTABLE CURBS AND VALLEY GUTTERS ARE NOT INCLUDED IN THE AREA TABULATIONS.
- 2) THE "TYPE A" A.C. DIKE (PER CALTRANS DETAIL AB7B) AND THE A.C. BELOW THE A.C. DIKE ARE NOT INCLUDED IN THE AREA TABULATIONS.

CURVE #	RADIUS	DELTA	LENGTH
C14	42.00'	24°48'09"	18.18'
C15	25.00'	46°44'59"	20.40'
C16	29.00'	55°29'59"	28.00'
C17	1.00'	106°28'57"	1.86'
C18	29.00'	44°20'08"	22.44'
C19	29.00'	36°54'51"	18.68'
C20	29.00'	110°25'01"	55.89'
C21	29.00'	26°19'58"	13.33'
C22	2.50'	110°25'01"	4.82'
C23	25.00'	37°39'42"	16.43'
C24	7.00'	80°54'42"	9.89'
C25	25.00'	9°05'18"	3.97'
C26	15.00'	360°00'00"	100.53'

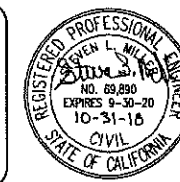

SHEET  
**13**  
OF 17 SHEETS

**AR**

**HENRY+ ASSOCIATES ARCHITECTS**  
730 Howe Avenue, Suite 410  
Sacramento, CA 95825  
Phone: 916.921.2112  
Fax: 916.921.2212

[illegible]

DESIGNED BY: JMS/SLM	DRAWN BY: SLM	CHECKED BY: JMS/SLM	SCALE: AS SHOWN
-------------------------	------------------	------------------------	--------------------

CLUSD\Lockeford School Imp Plans 10/31/18 - 5/1/med.docx 10/31/18





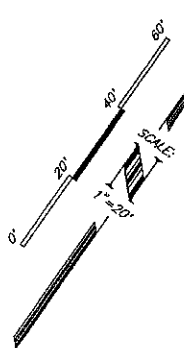

-TRANSITION FROM EXISTING A.C.  
(ASPHALT CONCRETE) TO CONCRETE  
SHEETS 10 & 11 FOR GRADES

-PROPOSED PEDESTRIAN PATH OF TRAVEL, SEE GRADES ON SHEET 11 & SECTIONS ON SHEET 4

—PROPOSED PEDESTRIAN PATH OF  
TRAVEL, SEE GRADES ON SHEET  
11 & SECTIONS ON SHEET 4

PROPOSED RAISED PEDESTRIAN PATH OF  
GRADES ON SHEETS 9, 11 & SECTION. O

—EXISTING CONCRETE  
PEDESTRIAN PATH OF  
TRAVEL TO SCHOOL,  
SEE SHEET 9 FOR  
EXISTING GRADES

—EXISTING PEDESTRIAN SINGLE GATE TO  
BE REMOVED & REPLACED, PER GATE  
REPLACEMENT DETAILS ON SHEET 6

REVISIONS		APPROVED	
SYMBOL	DATE	DESCRIPTION	
1	10/10/10	Initial design	
2	11/10/10	Revised design	
3	12/10/10	Final design	
4	01/11/10	Revised design	
5	02/11/10	Final design	
6	03/11/10	Revised design	
7	04/11/10	Final design	
8	05/11/10	Revised design	
9	06/11/10	Final design	
10	07/11/10	Revised design	
11	08/11/10	Final design	
12	09/11/10	Revised design	
13	10/11/10	Final design	
14	11/11/10	Revised design	
15	12/11/10	Final design	
16	01/12/10	Revised design	
17	02/12/10	Final design	
18	03/12/10	Revised design	
19	04/12/10	Final design	
20	05/12/10	Revised design	
21	06/12/10	Final design	
22	07/12/10	Revised design	
23	08/12/10	Final design	
24	09/12/10	Revised design	
25	10/12/10	Final design	
26	11/12/10	Revised design	
27	12/12/10	Final design	
28	01/01/11	Revised design	
29	02/01/11	Final design	
30	03/01/11	Revised design	
31	04/01/11	Final design	
32	05/01/11	Revised design	
33	06/01/11	Final design	
34	07/01/11	Revised design	
35	08/01/11	Final design	
36	09/01/11	Revised design	
37	10/01/11	Final design	
38	11/01/11	Revised design	
39	12/01/11	Final design	
40	01/02/11	Revised design	
41	02/02/11	Final design	
42	03/02/11	Revised design	
43	04/02/11	Final design	
44	05/02/11	Revised design	
45	06/02/11	Final design	
46	07/02/11	Revised design	
47	08/02/11	Final design	
48	09/02/11	Revised design	
49	10/02/11	Final design	
50	11/02/11	Revised design	
51	12/02/11	Final design	
52	01/03/11	Revised design	
53	02/03/11	Final design	
54	03/03/11	Revised design	
55	04/03/11	Final design	
56	05/03/11	Revised design	
57	06/03/11	Final design	
58	07/03/11	Revised design	
59	08/03/11	Final design	
60	09/03/11	Revised design	
61	10/03/11	Final design	
62	11/03/11	Revised design	
63	12/03/11	Final design	
64	01/04/11	Revised design	
65	02/04/11	Final design	
66	03/04/11	Revised design	
67	04/04/11	Final design	
68	05/04/11	Revised design	
69	06/04/11	Final design	
70	07/04/11	Revised design	
71	08/04/11	Final design	
72	09/04/11	Revised design	
73	10/04/11	Final design	
74	11/04/11	Revised design	
75	12/04/11	Final design	
76	01/05/11	Revised design	
77	02/05/11	Final design	
78	03/05/11	Revised design	
79	04/05/11	Final design	
80	05/05/11	Revised design	
81	06/05/11	Final design	
82	07/05/11	Revised design	
83	08/05/11	Final design	
84	09/05/11	Revised design	
85	10/05/11	Final design	
86	11/05/11	Revised design	
87	12/05/11	Final design	
88	01/06/11	Revised design	
89	02/06/11	Final design	
90	03/06/11	Revised design	
91	04/06/11	Final design	
92	05/06/11	Revised design	
93	06/06/11	Final design	
94	07/06/11	Revised design	
95	08/06/11	Final design	

DESIGNED BY: JUMS/SLM	DRAWN BY: SLM	CHECKED BY: JUMS/SLM	SCALE: AS SHOWN
--------------------------	------------------	-------------------------	--------------------

LODI UNIFIED SCHOOL DISTRICT  
PROPOSED  
TRAFFIC CIRCULATION  
LOCKEFORD ELEMENTARY SCHOOL  
PEDESTRIAN  
PATH OF TRAVEL PLAN

### PEDESTRIAN PATH OF TRAVEL PLAN

SHEET

15

OF **17** SHEETS



**A.R. SANGUNETTI & ASSOCIATES**  
CONSULTING CIVIL ENGINEERS  
1150 W. ROBINHOOD, DR., STE. 10



**HENRY+ ASSOCIATES ARCHITECTS**

730 Howe Avenue, Suite 450  
Sacramento, CA 95825  
Phone: 916.921.2112  
Fax: 916.921.2212

2:\USP\Lockford School\USP Lockford School 10-1-18.dwg, 10/21/18

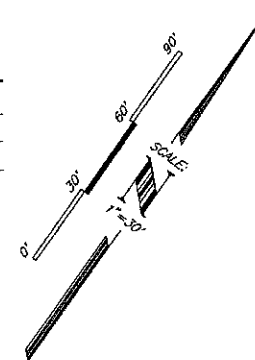
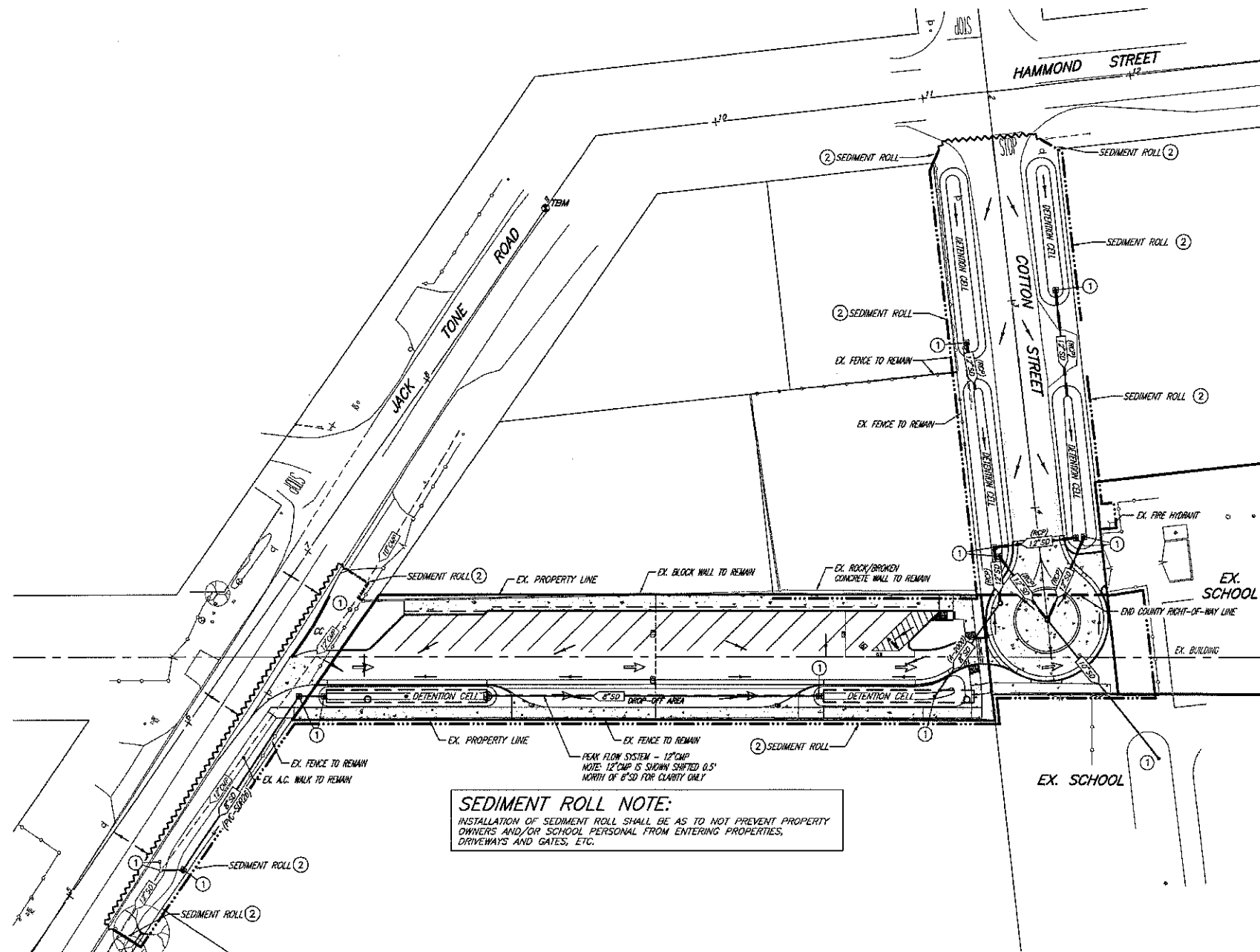

#### LEGEND

EXISTING	PROPOSED	
12" SD	12" SD	STORM DRAIN PIPE SIZE & DIRECTION OF FLOW
○	○	MAINTENANCE HOLE
●	●	DRAIN INLET
CC	CC	CURB CUT IN CALTRANS TYPE A DIKE
▲	▲	WASTE AREA, LOCATION TO BE PER OWNER/CONTRACTOR
■	■	MATERIALS STORAGE AREA, LOCATION TO BE PER OWNER/CONTRACTOR
■	■	CONCRETE WASHOUT AREA, SEE CONCRETE WASHOUT NOTES ON SHEET 17, LOCATION TO BE PER OWNER/CONTRACTOR
①	①	STORM DRAIN INLET FILTER BAG (DETAIL ON SHEET 17)
②	②	ROCK BAG INLET FILTER WITHOUT GUTTER WITH STORM DRAIN INLET FILTER BAG (DETAIL ON SHEET 17)
③	③	SEDIMENT ROLL (DETAIL ON SHEET 17)
—	—	CONSTRUCTION ENTRANCE (DETAIL ON SHEET 17), LOCATION TO BE PER OWNER/CONTRACTOR
→	→	DIRECTION OF SURFACE FLOW
—	—	PROJECT LIMITS
—	—	SEDIMENT ROLL / PROJECT LIMITS

**STABILIZED CONSTRUCTION ENTRANCE:**  
AT LEAST ONE STABILIZED CONSTRUCTION ENTRANCE SHALL BE CONSTRUCTED PRIOR TO ANY WORK, PER DETAIL ON SHEET 17. LOCATION TO BE PER OWNER/CONTRACTOR.

**PROJECT AREA NOTE:**  
1) THE PROJECT AREA CONSIST OF 0.92± ACRES.

**SEDIMENT ROLL NOTE:**  
INSTALLATION OF SEDIMENT ROLL SHALL BE AS TO NOT PREVENT PROPERTY OWNERS AND/OR SCHOOL PERSONAL FROM ENTERING PROPERTIES, DRIVEWAYS AND GATES, ETC.

PEAK FLOW SYSTEM - 12" CIP  
NOTE: 12" CIP IS SHOWN SHIFTED 0.5' NORTH OF 8" SD FOR CLARITY ONLY



REVISIONS	DATE	DESCRIPTION	APPROVED

DESIGNED BY: JMS/SLM	DRAWN BY: SLM	CHECKED BY: JMS/SLM	SCALE: AS SHOWN
-------------------------	------------------	------------------------	--------------------

LODI UNIFIED SCHOOL DISTRICT  
PROPOSED  
TRAFFIC CIRCULATION  
LOCKEFORD ELEMENTARY SCHOOL  
EROSION CONTROL PLAN

SHEET

16

OF 17 SHEETS

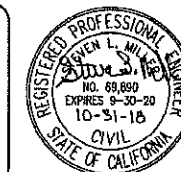

## NOTES:

- THE CONTRACTOR IS ADVISED THAT THE STATE OF CALIFORNIA HAS ADOPTED NATIONAL POLLUTION DISCHARGE ELIMINATION REQUIREMENTS (NPDES) IN ACCORDANCE WITH THE REQUIREMENTS OF THE CLEAN WATER ACT. THIS PROJECT IS SUBJECT TO ALL OF THE REQUIREMENTS CONTAINED IN THOSE ACTS. THE CONTRACTOR SHALL ABIDE BY ALL THE LAWS, ORDINANCES AND REGULATIONS ASSOCIATED WITH THE NPDES AND THE CLEAN WATER ACT.
- WHAT IS SHOWN ON THIS EROSION CONTROL PLAN IS TO BE USED AS A GUIDELINE FOR BMP'S AND DOES NOT REPRESENT ALL REQUIRED BMP'S PURSUANT TO FEDERAL, STATE & LOCAL LAWS. IT IS THE CONTRACTOR'S SOLE RESPONSIBILITY TO MEET ALL BMP REQUIREMENTS DURING THIS CONSTRUCTION OF THIS PROJECT.
- THE CONTRACTOR SHALL INCLUDE IN THE PROJECT COST (BID) ALL REQUIRED WORK FOR IMPLEMENTATION OF THE EROSION CONTROL PLAN, INCLUDING ONGOING MAINTENANCE OF THE EROSION CONTROL PLAN THROUGHOUT THE COURSE OF THE PROJECT UNTIL SUCH TIME THE WORK IS APPROVED BY THE PERMITTING AGENCY AND THE PROJECT IS DEEMED COMPLETE.
- THE EROSION CONTROL PLAN MUST BE MAINTAINED THROUGHOUT THE COURSE OF CONSTRUCTION. THE CONTRACTOR IS ADVISED THAT THEY SHALL CONFORM TO THIS REQUIREMENT AND THAT THEY SHALL IMPLEMENT ALL OF THE MEASURES SHOWN ON THE EROSION CONTROL PLAN.
- PRIOR TO COMMENCING CONSTRUCTION ACTIVITIES FOR THIS EROSION CONTROL PLAN, THE CONTRACTOR SHALL IDENTIFY THE CONCRETE WASH OUT AREA PLANNED FOR THE PROJECT, IDENTIFY THE MATERIAL STORAGE AREA FOR THE PROJECT, IDENTIFY STABILIZED CONSTRUCTION ACCESS POINTS TO THE SITE.
- THE CONTRACTOR SHALL CONFIRM & IDENTIFY A CONSTRUCTION WASTE AREA FOR THIS EROSION CONTROL PLAN. MULTIPLE CONSTRUCTION WASTE AREAS ARE PERMITTED. THE AREAS SHOULD BE CONTAINED TO AREAS LEAST SUSCEPTIBLE TO EROSION. ALL WASTE SHALL BE PROPERLY CONTAINED WITHIN THE IDENTIFIED AREA.
- PETROLEUM PRODUCTS, SOLVENTS, FERTILIZERS, METALS, PAINTS, ETC. SHALL BE STORED IN AREAS THAT PROVIDE COVER (E.G. GARAGE, STORAGE BUILDING, COVERED WASTE BINS, ETC.). IF ANY SUCH MATERIALS ARE TO BE KEPT WITHIN THE AREA OF THIS EROSION CONTROL PLAN, THE CONTRACTOR SHALL IDENTIFY WHERE SUCH PRODUCTS ARE STORED.
- THE CONTRACTOR SHALL PREVENT THE CHLORINATED FLUSHING OF THE WATER SYSTEM FROM ENTERING ANY STORM SYSTEM AND/OR CONTAMINATING THE EXISTING SOILS. DISCHARGE SHALL BE PER AGENCY REQUIREMENTS.
- THE CONTRACTOR SHALL FUEL ALL EQUIPMENT/VEHICLES AT A SINGLE LOCATION. THE CONTRACTOR SHALL PREVENT THE SPILLAGE OF ANY FUELS AND/OR PETROLEUM PRODUCTS FROM ENTERING THE STORM SYSTEM AND/OR CONTAMINATING THE SOIL. IN THE EVENT OF A SPILL, THE CONTRACTOR SHALL IMMEDIATELY CONTAIN THE AREA AND REPORT THE INCIDENT TO THE GOVERNING AGENCIES.
- THE CONTRACTOR SHALL INSTALL DRAIN INLET FILTERS AT ALL DRAIN INLETS SHOWN ON THIS EROSION CONTROL PLAN.
- THE CONTRACTOR SHALL CONFINE "CLEANUP" OF PAINT, SOLVENTS, ETC. TO AN AREA THAT PREVENTS SUCH CHEMICALS FROM REACHING THE DRAIN INLETS, AND/OR CONTAMINATING THE GROUND.
- ALL DESIGNATED AREAS FOR STORAGE AND WASTE MATERIALS SHALL BE KEPT CLEAN AT ALL TIMES AND SHALL BE DESIGNATED AWAY FROM DRAIN INLETS.
- THE APPLICATION OF PESTICIDES, FERTILIZERS, HERBICIDES, PAINTS, ETC. AND THE PLACEMENT OF CONCRETE SHALL BE AVOIDED PRIOR TO APPROACHING STORMS.
- THE CLEANING OF STREETS, DRIVEWAYS, ETC. SHALL BE MAXIMIZED BY SWEEPING OR OTHER MECHANICAL METHODS. THE USE OF WATER TO CLEAN OFF STREETS, DRIVEWAYS, ETC. IS HIGHLY DISCOURAGED AND SHALL ONLY BE DONE WHEN APPROPRIATE FILTERS ARE PROVIDED AT ALL DRAIN INLETS AND ALL MATERIAL BUILDUP HAS BEEN MECHANICALLY REMOVED.
- THE PLACEMENT OF PORTABLE TOILETS SHALL NOT BE PERMITTED ON THE SIDEWALKS AND/OR STREET RIGHT-OF-WAYS. ALL PORTABLE TOILETS SHALL BE PLACED A MINIMUM OF 10 FEET BEHIND THE BACK OF SIDEWALK IN ORDER TO PREVENT SPILLAGE OF SEWAGE, CHEMICALS, ETC. FROM ENTERING THE STORM WATER SYSTEM.
- DURING CONSTRUCTION OF THE INLET STRUCTURES THE CONTRACTOR SHALL PREVENT SILTATION FROM ENTERING THE STORM DRAIN SYSTEM. THE ENDS OF ALL PIPES SHALL BE PROTECTED BY ANY OF THE FOLLOWING OPTIONS:
  - SECURING FILTER FABRIC AROUND ALL PIPE OPENINGS.
  - SEALING THE END OF PIPES WITH PIPE PLUGS OR WRAPPING THE PIPE ENDS WITH PLASTIC OR CARPING PIPE ENDS.
  - EXTENDING THE PIPE STUBS A MIN. OF 1' (FOOT) ABOVE THE SURROUNDING GRADE.
  - PROVIDE TEMPORARY GRAVEL BAGS OR SAND BAG BARRIERS.
- THE CONTRACTOR SHALL COVER ALL RAW MATERIAL STOCKPILES (GRADING SPOILS, SAND, ROCK, ETC.) WITH 3 MIL (MIN.) PLASTIC SHEETING OR OTHER ACCEPTABLE EROSION CONTROL BLANKET MATERIAL WITH A SEDIMENT ROLL PERIMETER AT THE BASE OF THE STOCKPILE IS BEING ACTIVELY USED FOR MORE THAN 14 DAYS OR BEFORE AN APPROACHING RAIN OR HEAVY WIND EVENT.
- THE CONTRACTOR SHALL ENSURE THAT ALL CONCRETE, STUCCO, PLASTER, TILE OR MASONRY WORK AT THE SITE WILL BE NEATLY PERFORMED SO AS TO NOT ALLOW "TAILINGS" (SAND, SILT, SLURRY, CONSTRUCTION WATER, ETC.) TO ENTER THE STORM DRAIN SYSTEM. ADDITIONAL BMP'S MAY BE NEEDED TO CONFINE SUCH ACTIVITIES AND THE GENERAL CONTRACTOR SHALL ENSURE THAT EACH TRADE DISCIPLINE IS AWARE OF THE REQUIREMENTS AND HAS TAKEN ALL NECESSARY STEPS TO PREVENT "TAILINGS" FROM ENTERING THE STORM DRAIN SYSTEM OR LEAVING THE SITE.

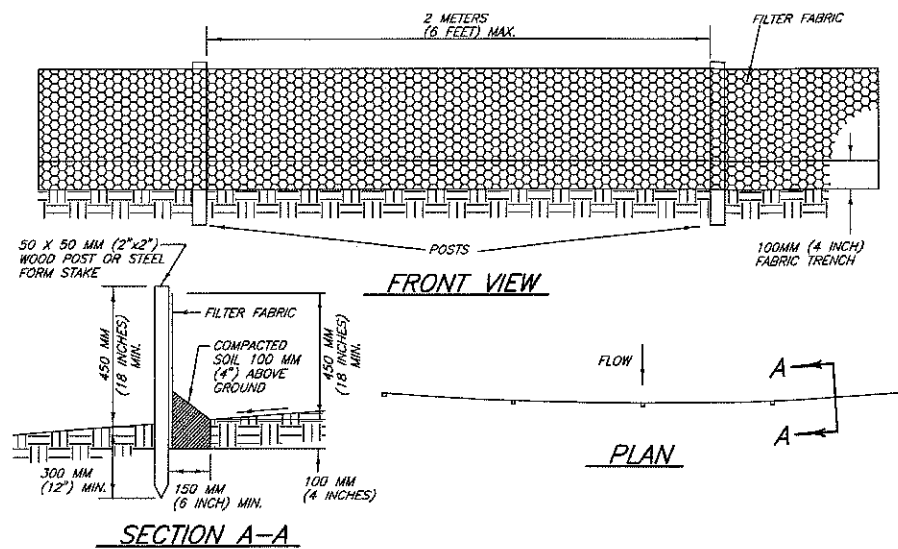

**SILT FENCE** ③

## SILT FENCE NOTES:

- FILTER BARRIER SHALL BE CONSTRUCTED LONG ENOUGH TO EXTEND ACROSS THE EXPECTED FLOW PATH AND AS APPROVED BY THE ADMINISTRATOR. THE MAXIMUM DISTANCE BETWEEN FILTER BARRIERS SHALL BE 4.5 METERS (14.76 FEET) X THE SLOPE EXPRESSED AS A RATIO.
- FILTER FABRIC SHALL BE PROPYLENE, NYLON, POLYESTER OR ETHYLENE YARN WITH A MINIMUM TENSILE STRENGTH OF 50 LBS. PER LINEAL FOOT AT 20 PERCENT MAXIMUM ELONGATION AND CONTAINING ULTRAVIOLET INHIBITORS. FILTER FABRIC SHALL RETAIN A MINIMUM OF 85% OF THE SOIL, BY WEIGHT, BASED ON SIEVE ANALYSIS, BUT IS NOT FINER THAN AN EQUIVALENT OPENING SIZE OF 70.
- SUPPORT POSTS SHALL BE A MINIMUM 75MM (30 INCH) LONG 50X50 MM (2"x2") WOOD POSTS OR STEEL FORM STAKES DRIVEN A MINIMUM OF 300MM (12 INCHES) INTO THE GROUND. POSTS SHALL BE SPACED A MAXIMUM OF 2 METERS (6 FEET) APART. FABRIC SHALL BE SECURELY FASTENED TO POSTS WITH 13MM (.5 INCH) STAPLES OR 16 GAUGE WIRE TIES SPACED A MAXIMUM OF 150MM (6 INCHES) APART.
- A 100MM (4 INCH) FABRIC TRENCH SHALL BE EXCAVATED ALONG THE UPHILL SIDE OF FILTER BARRIER POSTS. THE BOTTOM EDGE OF THE FABRIC SHALL EXTEND TO AND ACROSS THE BOTTOM OF THE TRENCH. THE TRENCH SHALL BE BACKFILLED TO 100MM (4 INCHES) ABOVE GROUND AND COMPACTED TO BURY AND SECURE THE BOTTOM OF THE FILTER FABRIC.
- CONTRACTOR SHALL MAKE INSPECTIONS WEEKLY DURING THE WET SEASON, MONTHLY DURING THE DRY SEASON AND IMMEDIATELY AFTER EACH RAINFALL TO DETERMINE IF REPAIRS AND SEDIMENT REMOVAL IS REQUIRED. SEDIMENT SHALL BE REMOVED BEFORE IT HAS REACHED ONE THIRD THE HEIGHT OF THE FILTER FABRIC.

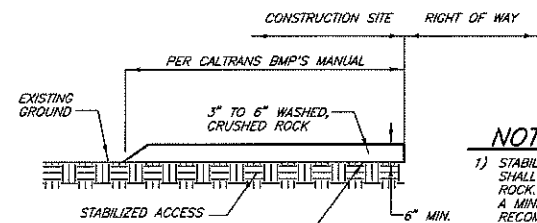

## NOTES:

- STABILIZED CONSTRUCTION ENTRANCE SHALL BE 3" TO 6" WASHED, CRUSHED ROCK. MATERIAL SHALL BE PLACED TO A MINIMUM THICKNESS OF 12" OR AS RECOMMENDED BY THE SOILS ENGINEER.
- LENGTH OF ENTRANCE SHALL BE PER THE CALTRANS BMP'S MANUAL. WIDTH MUST BE OF OR GREATER IF NECESSARY TO COVER ALL VEHICULAR INGRESS & EGRESS.
- THE ENTRANCE SHALL BE KEPT IN GOOD CONDITION BY REMOVAL & REPLACEMENT OF AGGREGATE BASE MATERIAL OR CLEANED ROUTINELY.
- CONTRACTOR SHALL INSPECT & MAINTAIN CONSTRUCTION ENTRANCE SEMI MONTHLY AND AFTER EACH RAINFALL.
- ALL SEDIMENT DEPOSITED ON PAVED ROADWAY SHALL BE SWEEPED AT THE END OF EACH WORKING DAY.

**SECTION A-A**

**PLAN VIEW**

**STABILIZED CONSTRUCTION SITE ACCESS**

NO SCALE

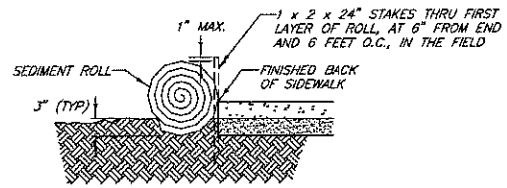

**SEDIMENT ROLL** ④

## SEDIMENT ROLL NOTES:

- SEDIMENT ROLL(S) SHALL BE USED IN ALL AREAS UNDER CONSTRUCTION WHERE STORM DRAIN SYSTEMS ARE INSTALLED, BUT CONSTRUCTION ACTIVITY IS INCOMPLETE.
- INSTALLATION OF SEDIMENT ROLL(S) MAY BE INSTALLED TIGHTLY AGAINST SIDEWALKS AND CURBS AND BACKFILLED BEHIND ROLLS WITHOUT STAKING. STAKING IS REQUIRED IN ALL AREAS THAT THE SEDIMENT ROLL(S) DO NOT TIGHTLY FIT AGAINST A PERMANENT STRUCTURE.
- THE CONTRACTOR SHALL ENSURE THAT THE SITE PERIMETER IS 3'-4" BELOW THE EXISTING CURB/SIDEWALK/PAVED SURFACE SO AS TO PROVIDE AN AREA FOR SEDIMENT ROLL PLACEMENT.

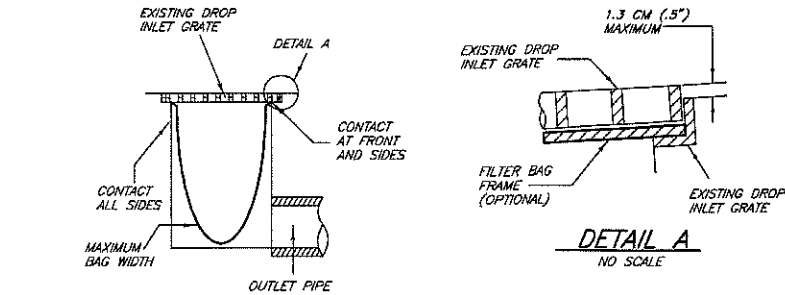

## STORM DRAIN INLET FILTER BAG NOTES: ①

- THE MAXIMUM DRAINAGE AREA PER FILTER SHALL BE NO MORE THAN 2 ACRES.
- THE FILTER BAG SHALL BE MANUFACTURED FROM UV RESISTANT POLYPROPYLENE NYLON, POLYESTER, OR ETHYLENE FABRIC WITH A MIN. TENSILE STRENGTH OF 50 LBS. PER LINEAL FOOT. AN EQUIVALENT OPENING SIZE NOT GREATER THAN 20 SIEVE AND WITH A MIN. FLOW RATE OF 40 GALLONS/ MINUTE/ SQ.FT.
- THE FILTER BAG MAY BE SUSPENDED FROM OR HELD IN PLACE BY EXISTING INLET GRATE, PROVIDED NO MODIFICATION OR DAMAGE SHALL BE DONE TO THE INLET GRATE OR FRAME. THE INLET GRATE SHALL NOT BE CAUSED TO REST MORE THAN 1.3CM (.5") ABOVE THE INLET FRAME (SEE DETAIL A.)
- THE FILTER BAG MAY EXTEND TO THE BOTTOM OF THE INLET BOX PROVIDED THE OUTLET PIPE IS UNOBSTRUCTED.
- FLOWS SHALL NOT BE ALLOWED TO BYPASS THE FILTER BAG. THE BAG OR ITS FRAME SHALL CATCH FLOWS AT ALL SIDES OF THE INLET EXCEPT AS SHOWN FOR FLOOD RELEASE.
- INLET FILTERBAGS SHALL BE INSPECTED WEEKLY AND AFTER EACH RAINFALL EVENT DURING THE WET SEASON AND MONTHLY DURING THE DRY SEASON. SEDIMENT AND DEBRIS SHALL BE REMOVED BEFORE ACCUMULATIONS HAVE REACHED ONE THIRD THE DEPTH OF THE BAG. BAGS SHALL BE REPAIRED OR REPLACED AS SOON AS DAMAGE OCCURS.

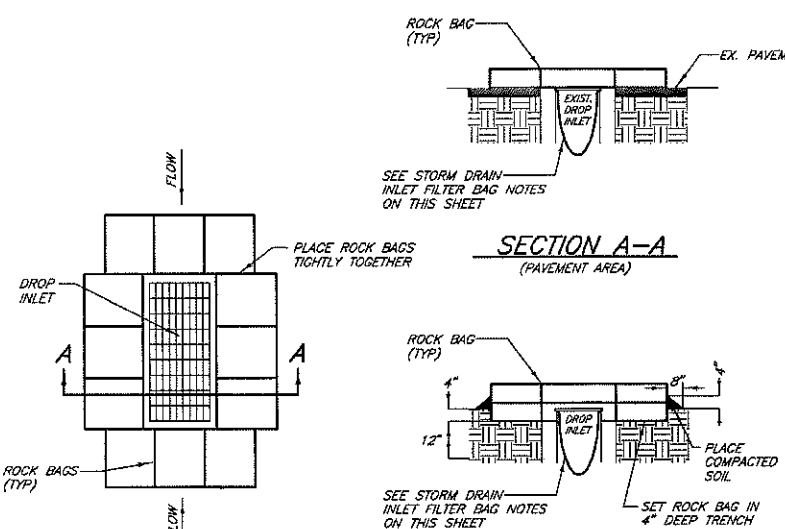

**PLAN VIEW**

**SECTION A-A**

**ROCK BAG INLET FILTER WITHOUT GUTTER** ②

NO SCALE

## ROCK BAG INLET FILTER WITHOUT GUTTER NOTES:

- ROCK BAGS SHALL BE PLACED TIGHTLY TOGETHER IN A TRENCH EXCAVATED A MINIMUM OF 4 INCHES BELOW THE INLET. ROCK BAGS SHALL BE PLACED WITH BINDING IN A HORIZONTAL POSITION.
- OUTER PERIMETER OF THE ROCK BAGS SHALL BE BACKFILLED AND COMPACTED TO A DEPTH OF APPROXIMATELY FOUR INCHES WITH EXCAVATED MATERIAL.
- CONTRACTOR SHALL MAKE PERIODIC INSPECTIONS TO DETERMINE IF REPAIR OR SEDIMENT REMOVAL IS REQUIRED. SEDIMENT SHALL BE REMOVED WHEN IT HAS BUILT UP TO A DEPTH OF APPROXIMATELY 6".
- ROCK BAGS SHALL BE REPLACED WHEN THEY HAVE BEEN DAMAGED OR DECOMPOSED.

## CONCRETE WASHOUT NOTES:

- THE CONCRETE WASHOUT SHALL BE AN ABOVE GROUND WASHOUT BOX THAT HAS BEEN APPROVED FOR USE BY THE STATE OF CALIFORNIA & THE LOCAL AGENCY OR SELF CONTAINED CONCRETE TRUCK.
- WASHOUT OF CONCRETE TRUCKS AND/OR CONCRETE MATERIAL SHALL BE IN DESIGNATED AREAS ONLY.
- WASHOUT AREA TO BE A MIN. OF 50 FT FROM STORM DRAIN INLETS, OPEN DITCHES, OR WATER BODIES.
- CONCRETE WASTE SHALL BE DEPOSED OF PROPERLY PER THE STATE OF CALIFORNIA & THE LOCAL AGENCY STANDARDS.



**A.R. SANGUINETTI & ASSOCIATES**  
CONSULTING CIVIL ENGINEERS  
1150 W. ROBINHOOD, DR., STE. 1C  
STOCKTON, CALIFORNIA



REVISIONS	DATE	DESCRIPTION	APPROVED

DESIGNED BY: JMS/SLM  
DRAWN BY: SLW  
CHECKED BY: JMS/SLM  
SCALE: AS SHOWN

LODI UNIFIED SCHOOL DISTRICT  
PROPOSED  
TRAFFIC CIRCULATION  
LOCKEFORD ELEMENTARY SCHOOL  
EROSION CONTROL DETAILS

SHEET

17

OF 17 SHEETS