



COUNTY OF SAN JOAQUIN

DEPARTMENT OF PUBLIC WORKS
P.O. BOX 1810-1810 E. HAZELTON AVENUE
STOCKTON, CALIFORNIA 95201
(209) 468-3000
FAX # (209) 468-9324

Permit No: PS-1900951
Date Issued: 04/01/2019
Start Date: 04/01/2019
Exp. Date: 10/25/2019
Project No: PWP7110005
Quad: SW

ENCROACHMENT PERMIT

To: RMC CONSTRUCTORS
5045 E.MCKINLEY AVENUE
FRESNO, C 93727

Encroachment Type:

Road Closure @ Gateway Blvd			
-----------------------------	--	--	--

Location:

Gateway Boulevard

In compliance with your request of 04/01/2019, permission is hereby granted to do work in County right-of-way as shown on attached application and subject to all the terms, conditions and restrictions written below or printed as general or special provisions on any part of this form. See reverse side and attached sheet, if any.

Trench excavations for service connections will not be permitted within ten feet (10') of pavement centerline unless otherwise approved by the Director. Surface of trench patches shall match in kind and be smooth and even with that of abutting surface. Special attention shall be given to depth of utilities through roadside area in anticipation of future drainage facilities, road profile and/or frontage development. All underground utility facilities are to be established and accurately dimensioned on sketches from surveyed centerline of road right of way, or from right of way (border) lines.

Permittee shall call the Department of Public Works, Field Engineering Division (Permit Inspections) at (209)953-7421 at least forty-eight hours prior to beginning any work within the County right of way. All work performed under this permit shall conform to the rules and regulations pertaining to safety established by the California Division of Industrial Safety and Cal-OSHA.

The jobsite shall be kept in a safe condition at all times by the daily removal of any excess dirt or debris which might be a hazard to either pedestrian or automobile traffic. All necessary traffic convenience and warning devices and personnel shall be provided, placed and maintained by and at the sole expense of the Permittee in accordance with the latest edition of the CALTRANS Manual of Traffic Control.

After completion of the work permitted herein, all debris, lumber, barricades, or any excess material shall be removed and the jobsite left in a neat workmanlike manner. Immediately following completion of construction permitted herein, Permittee shall fill out and mail notice of completion (see attached post card) provided by Grantor.

Special Comments:

Gateway Blvd Road Closure to result in vacation of Commerce Way/Court & Corporate Court.

****Traffic Control Per MUTCD****

FORMS:

SS/WW, R-29		
-------------	--	--

Est. Permit Fee: \$22,544.00

WHITE
GOLDENROD
YELLOW
PINK

-Permittee
-PWD Central File
-Field Inspection
-Permit Section

KRIS BALAJI, Director
Department of Public Works

By: Auni Taha
Permit Section

SPECIAL CONDITIONS FOR
GATEWAY BOULEVARD CLOSURE
ENCROACHMENT PERMIT

1. Maintain traffic controls for all roads. Traffic control delays shall not exceed 15 minutes. Two-way traffic shall be maintained during non-working hours with excavated areas backfilled or plated. During working hours, two-way traffic control shall be maintained with one lane open and appropriate flaggers. The contractor shall submit traffic control plans for all signing, detours, and any lane closure impacting County right-of-way. Traffic control plans shall be submitted two weeks prior to the closure date.
2. Access to all properties shall be maintained at all times except when work is occurring at the access point. Minimal delays will be allowed to provide access within the work zone area. Driveway access shall be fully restored at the end of each workday. Driveways disturbed by the contractor shall be replaced with in-kind or better materials.
3. Residents and businesses shall be notified in writing, as approved by the County, 48 hours in advance of any impacts to their access.
4. Any areas where parking is to be restricted shall have signs noting the restrictions in place at least 48 hours in advance.
5. Existing fences shall not be removed without written consent of the property owner. Such consent shall be submitted to the County prior to the removal. Fences removed shall be restored with in-kind or better materials. Restored fences shall not encroach into County right-of-way.
6. All destroyed or obliterated pavement markings must be replaced in kind by the permittee. Typical pavement markings include but not limited to lane lines, centerlines, stop and stop ahead legends, limit lines, raised pavement markers and miscellaneous delineators.
7. The Permittee is responsible for the preservation of survey monuments located within the area of work herein permitted. Prior to the start of construction, survey monuments that potentially may be disturbed shall be located and referenced by a Licensed Land Surveyor, and a Corner Record filed with the County Surveyor. Any Survey Monuments disturbed during the course of construction shall be reestablished by a Licensed Land Surveyor and another Corner Record filed with the County Surveyor. (Land Surveyors' Act Section 8771)
8. All pipe and pipeline related facilities including, but not limited to, valves, utility boxes and vaults, and frames and covers shall be maintained by Costco, including any facilities that are abandoned in place. Costco shall be responsible for any and all costs associated with the removal, relocation and/or adjustment of these facilities as determined by the County at Costco's expense. (Streets and Highways Code Section 1463)
9. All future maintenance of the pipeline and related facilities within the County right-of-way will require a San Joaquin County Encroachment Permit.
10. Trenches shall be maintained in a smooth and even condition to the satisfaction of the County throughout the project limits at all times.

Special Conditions for
Gateway Boulevard
Encroachment Permit

11. All trenches shall be completely backfilled or shored and plated at the end of each workday, and the roadway restored to two-way traffic. If plating is to be used, a trench shoring and plating plan suitable for traffic loadings shall be prepared by a registered civil engineer and submitted for prior approval by the County.
12. The contractor shall use San Joaquin County Improvement Standard R-29 when backfilling trenches within the County right-of-way. Where the existing road structural section is below standard, a minimum section of 3 inches of asphalt concrete over 8 inches of aggregate base shall be required.
13. Gateway Boulevard subject to pavement cuts shall receive a Type II slurry seal as per San Joaquin County Department of Public Works Improvement Standards Section 2-5.0 Trench Cut Policy. Shoulder areas shall be brought up to the finish grade as directed by the County.
14. No paving joints are allowed within paved shoulder; contractor shall pave all the way to outer edge of paved shoulder.
15. Class II Aggregate Base shoulder backing is required from the edge of pavement, a minimum of 4-inches thick by 4-feet wide.
16. Contractor shall establish existing roadway and drainage grades within the construction area. Any repair to roadways and adjacent areas shall match existing grades. Any proposed grade changes shall receive prior approval from County.
17. Above ground vaults, panels and/or other similar facilities will be allowed within the right-of-way if located as far to the outside edge as possible. Utility vaults shall be located a minimum of 4'-0" from edge of pavement.
18. County roads shall be kept clean from mud and debris at all times along the access points and work zone areas during entire project. All standard roadway striping and signage shall be clearly visible, maintained and restored throughout the construction zone during and after the project.
19. In addition to standard dust control measures, streets shall be maintained in a clean condition, free of dirt, mud and debris during construction activities. The contractor shall provide daily, and as determined to be necessary by County inspectors, street sweeping using a modern mechanical or vacuum-assisted street sweeper.
20. The contractor shall not conduct construction operations in rain or heavy fog conditions.

APPLICATION FOR ENCROACHMENT PERMIT

PLEASE PRINT:

Date 3-11-19

To: San Joaquin County
Department of Public Works

RMC Constructors

(Applicant Name)

5045 E McKinley

(Mailing Address)

Fresno Ca 93727

(City, State, Zip Code)

559 352-1653 - BRIAN PORTER

(Area Code - Telephone Number)

bporter@rmc-constructors.com

(Email Address)

OFFICE USE ONLY

JOB #	<u>110005</u>	REF #	<u>PS-1900951</u>
APN	<u>209-420-24</u>	CR #	
EXP. DATE	<u>1/1/2020</u>		
VALID	<u>4/1/2019</u> TO <u>12/1/2019</u>	DRIVEWAYS:	
STREET	<u>Gateway Blvd.</u>	*	
AREA	<u>Tracy</u> QUAD <u>SW</u>	*	
TYPE	<u>Road Closure - Gateway</u>	*	
FORMS	<u>SS/WW, R-29, Trench Lot</u>		
NOTES	<u>Special conditions Gateway Blvd</u>		
	<u>closure to result in the vacation of</u>		
	<u>Commerce Way/Court & Corporate Court.</u>		

Sketch (Detailed plans may be submitted)

The undersigned hereby applies for permission to excavate, construct and/or otherwise encroach on County Highway Right-of-Way on the side of Gateway Boulevard approximately 0 ft feet/mile South of W. Schulte Road, by performing the following work (description of work):

Request the closure of Gateway BLVD

Work will commence on or after 3-20-19 for approximately 200 days.

I, the undersigned, certify that I am the owner of the respective property, or am qualified to represent the owner and agree to do the work described above in accordance with the rules and regulations of San Joaquin County and subject to inspection and approval.

Brian Porter Project Manager
Signature of Applicant - Title

3-11-19

Date



SAN JOAQUIN
—COUNTY—

Greatness grows here.



Department of Public Works

Kris Balaji, Director of Public Works

Fritz Buchman, Deputy Director/Development

Alex Chetley, Interim Deputy Director/Engineering

Jim Stone, Deputy Director/Operations

Kristi Rhea, Manager of Strategic Initiatives

Acknowledgement of Monument Preservation

I, Dean Jurado, a duly Licensed Land Surveyor or a Professional Engineer
(Please print)

authorized to perform Land Surveying in the State of California, Registration No. 9032,

hereby acknowledge and accept all responsibility for the monument preservation as required
per Section 8771(a-f) of the Business and Professions Code within the bounds of the

construction activity permitted by San Joaquin County Permit No. PS-1900951.

I further acknowledge that I am hereby responsible for the Acknowledgement of Monument
Preservation prior to final acceptance of the construction activity.

[Signature]
Signature

Seal

3-15-19
Date

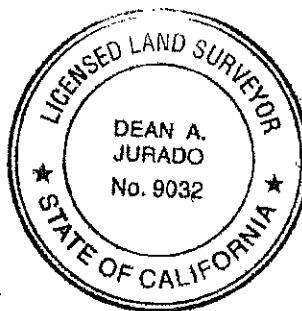

PS-MONUMENT PRESERVATION

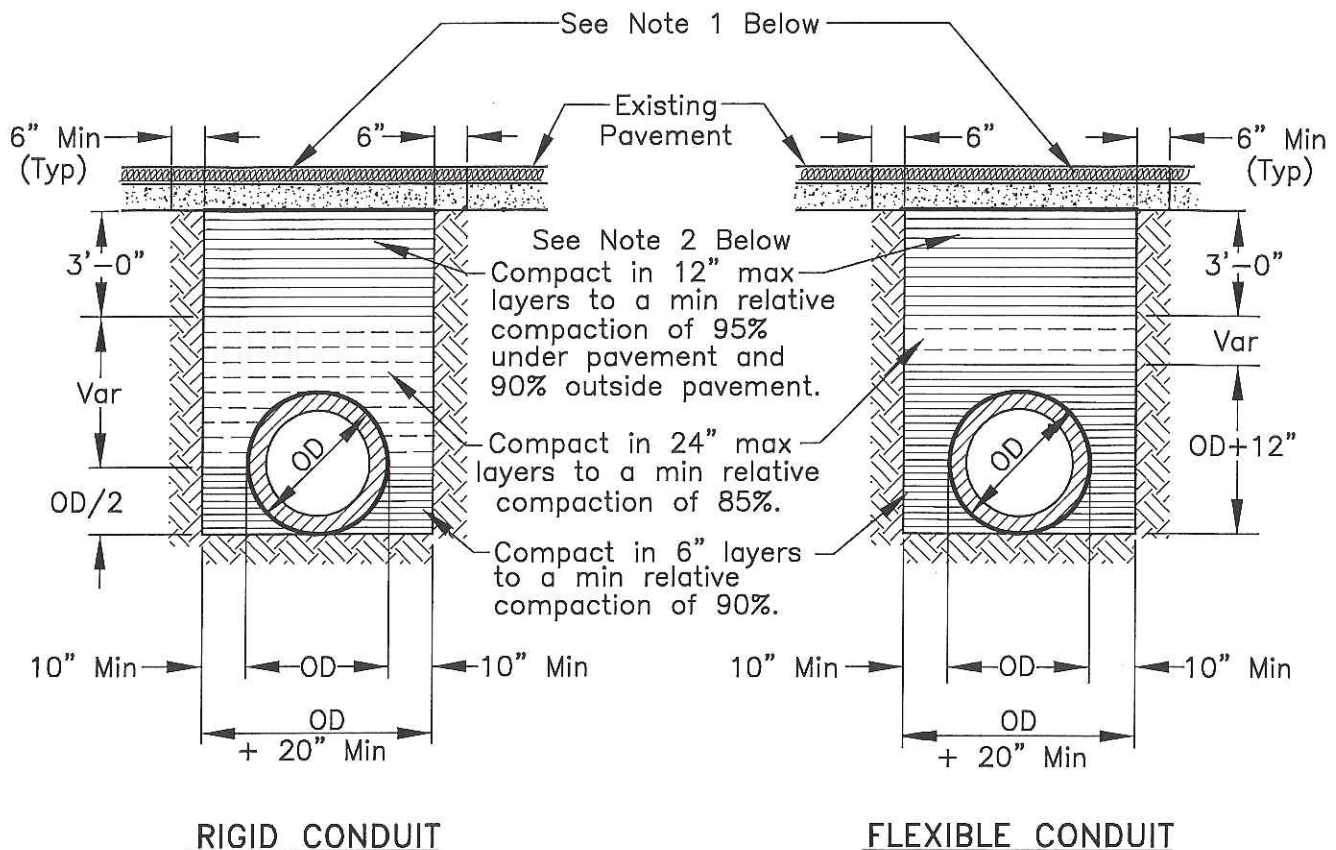

R-29

2-5.0 TRENCH CUT POLICY

2-5.01 General Requirements

- A. Resurfacing requirements specified in this policy are in addition to the trench resurfacing requirements specified by County Standard Drawing No. R-29.
- B. For the purpose of this policy, "Surfacing Age" is defined as the age of the most recently completed roadway surfacing, including construction, reconstruction, or major overlay.
- C. Where the application of seal coats is required, a Type II Slurry Seal will be used in accordance with State Standard Specifications, Section 37-2.
- D. The permittee must post a one-year maintenance bond or cash deposit, in an amount specified by the Department.
- E. All pavement markings destroyed or obliterated must be replaced in kind by the permittee. Typical pavement markings include, but are not limited to, lane lines, centerlines, stop and stop ahead legends, limit lines, raised pavement markers, and miscellaneous delineators.
- F. The permittee is responsible for Survey Monuments disturbed by trenching and is required to file a corner record and to reestablish them using a Licensed Land Surveyor after the trench restoration is completed.
- G. Functional classification maps and Public Works Project Advertising Schedules are references for this policy.
- H. To facilitate scheduling and planning, Public Works staff will make available the most current Project Advertising Schedule at the monthly Utility Coordination Meeting and make it available to the public, at the Permits Counter, in January each year.

2-5.02 Collectors, Arterials and Expressways

- A. Surfacing Age less than Three (3) Years: No pavement cuts. Exceptions may be approved in accordance with Section 2-5.04 EXCEPTIONS.
- B. Surfacing Age Three (3) Years and Over:
 - 1. Longitudinal Trench Cutting in Paved Shoulder

Areas:

The entire shoulder of the road is to be resurfaced. The existing surfacing adjacent to the trenched area shall be planed to accommodate the overlay in a manner that does not cause drainage concerns. The nearest pavement cut shall be a minimum of three (3) feet from the edge of pavement, or the remaining pavement shall also be removed and replaced. (See County Standard Drawing No. R-37).

2. Longitudinal Trenches within Traveled Lanes:

The entire traveled lane where the trench is located is to be resurfaced with a one (1) inch asphalt concrete overlay. The existing surfacing adjacent to the trenched area shall be planed to accommodate the overlay in a manner that does not cause drainage concerns. The overlay shall be in accordance with State Standard Specifications, Section 39. Aggregate gradation shall be consistent with the existing surfacing material. (See County Standard Drawing No. R-37).

3. Cross-Cutting:

Cross-cutting is allowed at a minimum interval of 150 feet. At each cross-cut location a minimum of ten (10) feet on each side of trench shall be planed and resurfaced with one (1) inch asphalt concrete. If cross cuts are within the 150 feet minimum interval, the entire section between the first and last cross cut shall be planed and resurfaced with one (1) inch asphalt concrete. (See County Standard Drawing No. R-36).

4. The conditions described in paragraphs 1, 2 and 3 above will not apply if resurfacing is scheduled within two years.

2-5.03 Local Roads

- A. Surfacing Age Under Three (3) years: No pavement cuts allowed. Exceptions may be approved in accordance with Section 2-5.04 EXCEPTIONS.

B. Surfacing Age Three (3) to Five (5) Years:

1. Longitudinal cuts are permitted. A seal coat is required for that half of the roadway containing the trench. (See County Standard Drawing No. R-37).

2. Cross-cutting is allowed under the same conditions as Section 2-5.02(B)(3). If cross-cuts occur within the 150 feet minimum interval, resurfacing may be substituted with a slurry seal for that half of the roadway. (See County Standard Drawing No. R-36).

2-5.04 Exceptions

Excavation is prohibited in newly renovated County roadways for three (3) years after a notice of completion has been filed for a roadway improvement project, or a new roadway has been accepted. The Director of Public Works may approve exceptions that are in the best interest of the public, including but not limited to:

- A. An emergency that endangers life or property.
- B. For repair or modification to prevent interruption of essential utility service.
- C. For relocation work that is mandated by County, State or Federal law.
- D. For service for buildings where no other reasonable means of providing service exists.
- E. For potholing to verify utility depth or location.
- F. For trenchless excavations greater than three feet in depth of cover over the utility facility, and not requiring a significant surface incision greater than industry bore pit standards.

Exceptions must be requested and submitted in writing to the Department. Payment of a nonrefundable processing fee is also required. Exceptions will be reviewed using the Departments Action Approval process, which requires the recommendation of a Deputy Director.

NOTES:

1. If the distance between cross-cuts are less than 150' the entire area between cross-cuts shall be planed and resurfaced with one (1) inch of Asphalt Concrete.
2. The resurfacing requirements shall be in addition to County Standard Drawing No. R-29.
3. Resurfacing for Bell Holes shall meet these requirements. If excavation occurs within the shoulder or lane, only that area shall be resurfaced as shown.
4. If cross-cutting is performed on Local Roads at intervals less than 150' a Seal Coat for that half of the roadway containing the trench can be used in lieu of resurfacing. Section 2-5.03 (B-2).

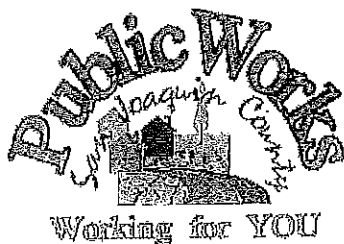
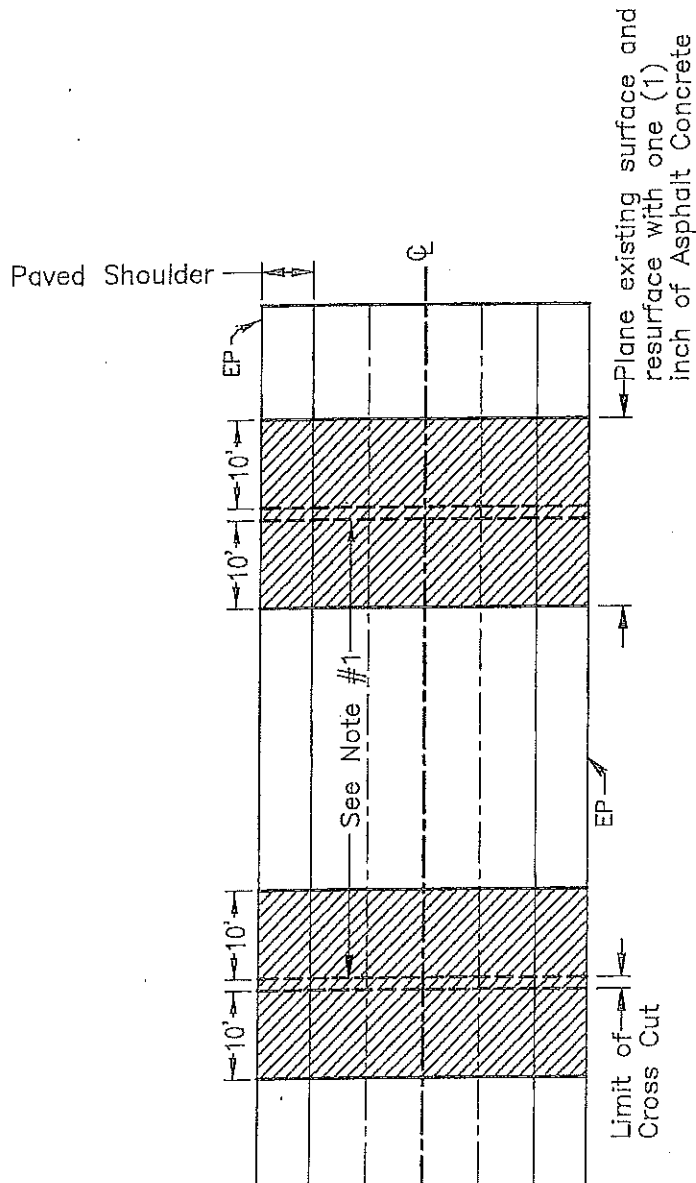

**TRENCH CUTTING POLICY
CROSS CUTTING OF
COUNTY ROADWAYS**

COUNTY OF SAN JOAQUIN
DEPARTMENT OF PUBLIC WORKS

Approved by:

Michael Selby

No.	Revision	Description	Date

Date: MAY 2015

Std. Dwg. No.

R-36

NOTES:

1. The resurfacing requirements shall be in addition to County Standard Drawing No. R-29.
2. If longitudinal cuts are required on a Local Road a Seal Coat can be used for that half of the roadway containing the trench. Section 2-5.03 (B-1).

Area to be resurfaced with one (1) inch Asphalt Concrete overlay existing surface to be planed, to accommodate overlay.

Section 2-5.02 (B-2).

Area to be resurfaced with one (1) inch Asphalt Concrete overlay existing surface to be planed to accommodate overlay. Section 2-5.02 (B-2)

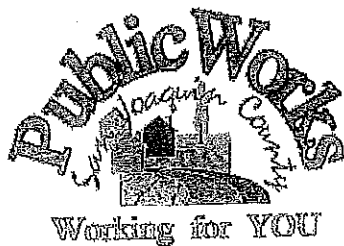
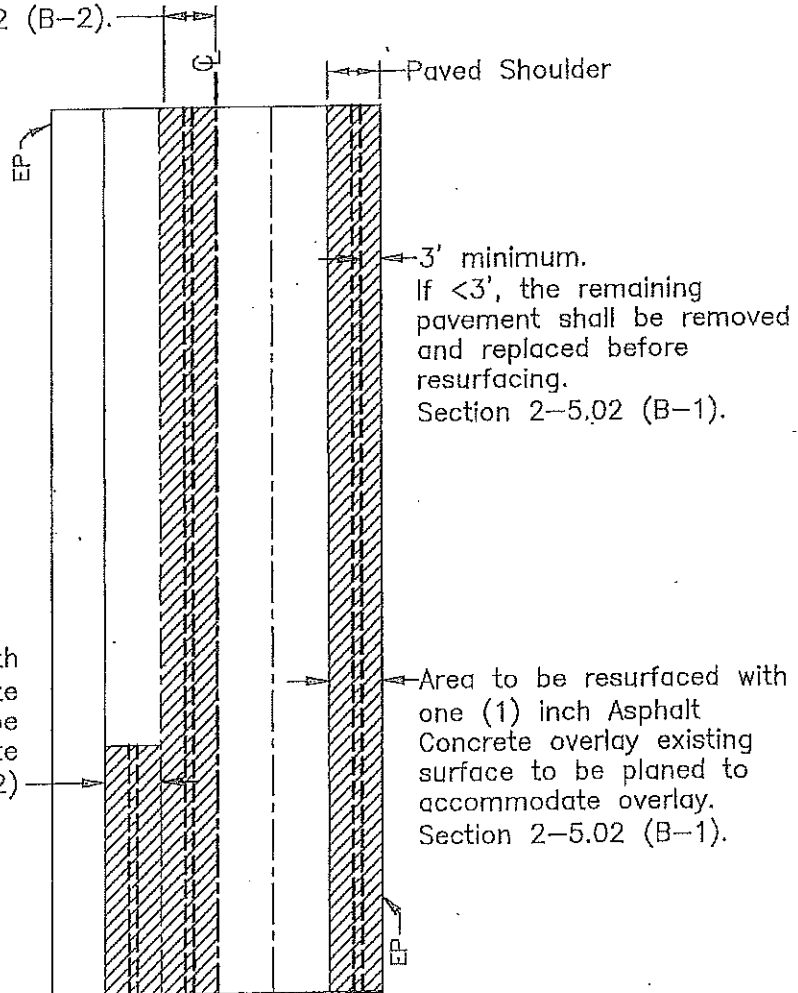

**TRENCH CUTTING POLICY
LONGITUDINAL CUTTING
OF COUNTY ROADWAYS**

COUNTY OF SAN JOAQUIN
DEPARTMENT OF PUBLIC WORKS

Date: MAY 2015

Approved by:

Michael J. Kelly

No.	Revision	Description	Date

Std. Dwg. No.

R-37

GENERAL PROVISIONS

GOVERNING INSTALLATION OF SUBSURFACE STRUCTURES AND PIPELINES WITHIN COUNTY ROAD RIGHTS-OF-WAY

PUBLIC CONVENIENCE AND SAFETY:

- A. Before obstructing any private driveway entrance or County road traveled way with a trench, spoil bank, equipment or other barrier permitted for any prolonged period of time, the Permittee shall notify the known users of the respective thoroughfare(s) involved, and shall provide access for vehicular and pedestrian traffic to and from the road.
 - 1. Unless otherwise permitted, all work shall be conducted in such a manner that no less than one lane of the existing County road traveled way will be maintained open to public traffic during working hours in a smooth and safe riding condition(s). Two lanes shall be open after working hours.
 - 2. In cases where road closure is permitted, the permission to close the road will be granted under the condition that the Permittee notify the following persons and/or agencies of the time, the period of closure, and the detour route at least twenty-four (24) hours prior to said road closure.
 - a. The County of San Joaquin Public Works Department
 - b. The County of San Joaquin Sheriff's Office
 - c. The local postal service
 - d. The local fire district
 - e. The local school district
 - f. The local residents involved
- B. Should hazardous conditions relative to the installation operations warrant flagmen, as many capable flagmen as may be necessary shall be provided by the Permittee and stationed in advance of work to warn and direct traffic.
- C. Lights, signs and barricades shall be furnished, erected and maintained by the Permittee for the adequate warning and convenience of the public, with particular attention to be taken in this regard after dark.
- D. Any excess dirt and/or debris which might be a hazard to either automobile or pedestrian traffic, uncontrollable by lights, signs and barricades, shall be removed from the jobsite daily.

STRUCTURES:

- A. Walls of structures shall be such quality and strength that they will resist all pressures and will not crack or be deformed in such a way as to create a hazard or maintenance problem at any time. Therefore, the minimum structural requirements for concrete pipe placed under county road rights-of-way shall conform to the following American Association of State Highway and transportation Officials (AASHTO) designations.
 - 1. For concrete pipe up to and including thirty-three inches (33") inside diameter, extra strength concrete conforming to AASHTO Designation M 170M.
 - 2. For concrete pipe thirty-six inches (36") inside diameter and larger, reinforced concrete pipe conforming to AASHTO Designation M 170M Class III.
 - 3. Plastic pipe conforming to AASHTO Designation M294.
- B. All concrete pipe joints with County road rights-of-way shall be sealed against leakage and/or infiltration with rubber gasket in conformance with Section 65-1:06 of the California Standard Specifications, or with other methods as may be permitted under the Special Provisions.
- C. Cast-in-place concrete pipe, vitrified clay pipe, spiral welded steel pipe, or corrugated aluminum alloy pipe shall not be installed within the County road rights-of-way unless specifically so stated in the Special Provisions, and only under the conditions as provided.
- D. All structures to be buried within the County rights-of-way shall be set at such elevations as to allow minimum coverage of thirty inches (30") to the centerline of the roadways and twelve inches (12") at the bottoms of borrow ditches each side of the roadways. The depths of structures shall be established below a flat plane extending across the rights-of-way, no part of which shall extend above the elevations stated above; manholes, lampoles, valves, etc. not included. Future surface elevations shall be anticipated as nearly as possible and structure elevations shall be established for future adjustments accordingly.
- E. The County hereby reserves the right to specify in the Special Provisions the gage and surface treatment of any galvanized corrugated metal pipe that is to be installed.
- F. All longitudinal utility facilities are to be established (and dimensioned on sketches) from surveyed centerline of road right-of-way, not from right-of-way (border) lines.

REPAIRS OF THE COUNTY RIGHT-OF-WAY:

- A. All excavations shall be backfilled and compacted immediately after work therein has been completed.
- B. Trenched shall not be left open farther than 300 feet in advance of pipe laying operations, or 200 feet to the rear thereof, unless otherwise permitted by the Engineer.
- C. Unless otherwise permitted under the Special Provisions, backfill shall be placed and mechanically compacted in such a manner that the relative compaction throughout the entire fill within the County road right-of-way shall conform to the percentages of compaction as shown on the Trench detail.
- D. Backfill material shall be placed in horizontal uniform layers not to exceed in thickness, before compaction, 0.67 foot in the bedding region, one-foot where 90% compaction is required, and two-feet where 80% compaction is required.
- E. No portion of the excavation(s) shall be compacted by ponding or jetting unless a maintenance bond is provided.
- F. Gravel backfill material shall be utilized only where specifically so stated on the face of the permit. It shall be compacted by means of a high-frequency internal vibrator, the compactor to be a size and type approved by the Engineer. Points of compaction shall not be greater than 18" centers and to the full depth of the lift.
- G. All pavements, curbs, gutters, sidewalks, borrow ditches, pipes, head walls, road signs, trees, shrubbery, and/or other permanent road facilities impaired by or as a result of construction operations at the construction site(s) occupied by materials and/or equipment, shall be restored immediately upon backfilling of the excavation to the original grades and cross sections, and to a condition as good as, or better than existing prior to construction.
- H. All surfacing materials of roadways and driveway approaches cut or damaged by or as a result of construction operations, shall be replaced within ONE WEEK following the backfilling of excavation, weather permitting, with compacted layers of surfacing materials at least as thick as the existing, and no less than two inches (2") of asphalt concrete over six inches (6") of aggregate base, both as specified below.
 - 1. Asphalt Concrete: Combined mineral aggregate shall conform to the quality and gradation requirements for Type "B" one-half inch (1/2) maximum aggregate, coarse or medium gradation as specified in Section 39 of the California Standard Specifications. The bituminous binder to be mixed with mineral aggregate shall be paving asphalt having (Grade PG 64-10), unless otherwise directed by the Engineer. Placement of asphalt concrete surfacing shall conform to the applicable provisions of Section 39 of the California Standard Specifications.
 - 2. Aggregate Base: Combined mineral aggregates shall conform to the quality and the grading for three-quarter inch (3/4") maximum size aggregate Class 2 Aggregate Base specified in Section 26 of the California Standard Specifications.
- I. Before acceptance of repairs to the County road rights-of-way, all unsightly and detrimental dirt, dust and/or debris shall be removed and the construction areas left in a neat and presentable condition(s).
 - 1. If necessary, County road traveled way and driveway pavements shall be washed with water to remove dirt and dust.
 - 2. Driveway approaches and field entrance pavements damaged by equipment or spoil banks shall be repaired as directed by the Engineer.
- J. Upon request by the County, any settlement, sagging of surface, or cracking of pavement shall be repaired immediately by and at the sole expense of the Permittee for a period of one year following acceptance of the work.

SPECIAL PROVISIONS

Winter Weather Utility Work

1. **SUPERVISION:** The utility company (**permittee**) shall furnish full-time supervision of all work to insure compliance with the permit provision.
2. **START OF WORK:** No work within the County right-of-way shall be started until the utility company representative has made an evaluation of weather conditions and has determined the work can be accomplished under the provisions of the permit.
3. **CLEAN PAVEMENT:** Dirt and mud shall not be deposited on the pavement outside the area of work, and if inadvertently tracked onto the road travel way shall be removed immediately.
4. **DAILY RESTORATION:** Private driveways and road intersections shall be restored daily.
5. **WEATHER-TIGHT CONDITIONS:** All trenches shall be filled and compacted, ditches and other drainage facilities regarded and opened, and the entire work area restored to weather-tight condition prior to any rain.

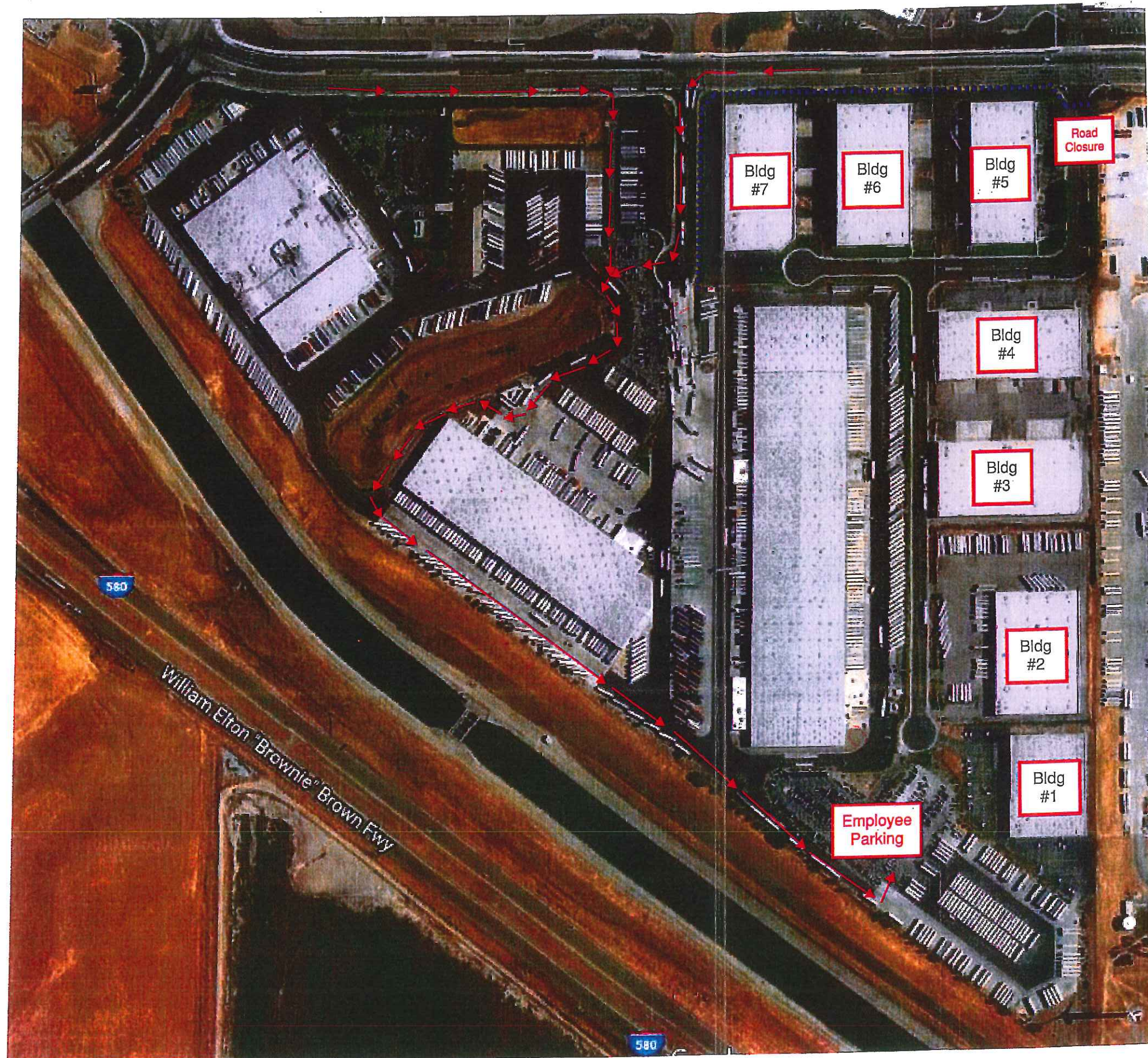

TRACY DEPOT
COSTCO
WHOLESALE

RMC

Employee
Parking
Route



Temp Fencing



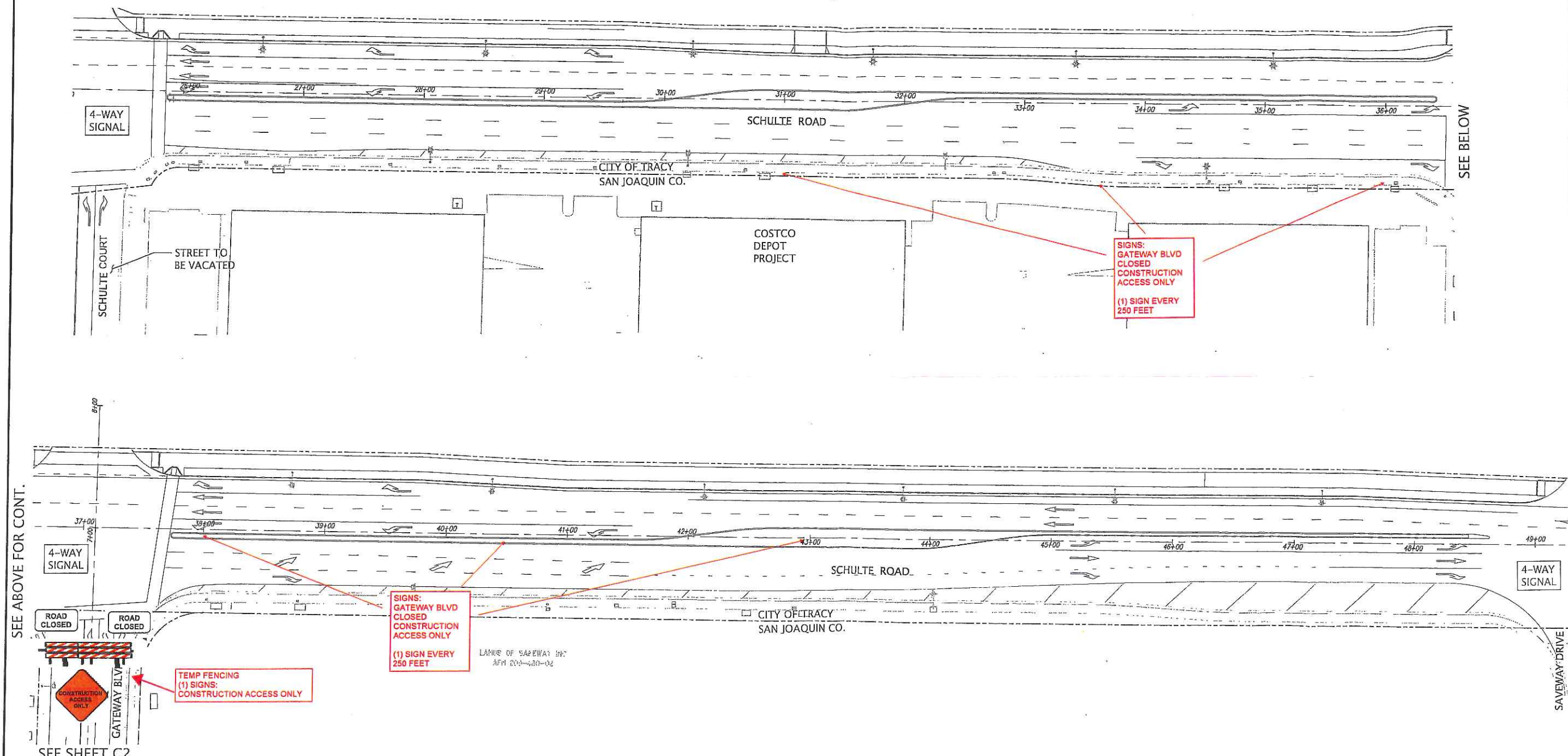
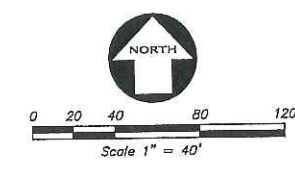

BY		REVISION	
NO.	BY	NO.	BY
1		1	
2		2	
3		3	
4		4	
5		5	
6		6	
7		7	
8		8	
9		9	
10		10	
11		11	
12		12	
13		13	
14		14	
15		15	
16		16	
17		17	
18		18	
19		19	
20		20	
21		21	
22		22	
23		23	
24		24	
25		25	
26		26	
27		27	
28		28	
29		29	
30		30	
31		31	
32		32	
33		33	
34		34	
35		35	
36		36	
37		37	
38		38	
39		39	
40		40	
41		41	
42		42	
43		43	
44		44	
45		45	
46		46	
47		47	
48		48	
49		49	
50		50	
51		51	
52		52	
53		53	
54		54	
55		55	
56		56	
57		57	
58		58	
59		59	
60		60	
61		61	
62		62	
63		63	
64		64	
65		65	
66		66	
67		67	
68		68	
69		69	
70		70	
71		71	
72		72	
73		73	
74		74	
75		75	
76		76	
77		77	
78		78	
79		79	
80		80	
81		81	
82		82	
83		83	
84		84	
85		85	
86		86	
87		87	
88		88	
89		89	
90		90	
91		91	
92		92	
93		93	
94		94	
95		95	
96		96	
97		97	
98		98	
99		99	
100		100	
101		101	
102		102	
103		103	
104		104	
105		105	
106		106	
107		107	
108		108	
109		109	
110		110	
111		111	
112		112	
113		113	
114		114	
115		115	
116		116	
117		117	
118		118	
119		119	
120		120	
121		121	
122		122	
123		123	
124		124	
125		125	
126		126	
127		127	
128		128	
129		129	
130		130	
131		131	
132		132	
133		133	
134		134	
135		135	
136		136	
137		137	
138		138	
139		139	
140		140	
141		141	
142		142	
143		143	
144		144	
145		145	
146		146	
147		147	
148		148	
149		149	
150		150	
151		151	
152		152	
153		153	
154		154	
155		155	
156		156	
157		157	
158		158	
159		159	
160		160	
161		161	
162		162	
163		163	
164		164	
165		165	
166		166	
167		167	
168		168	
169		169	
170		170	
171		171	
172		172	
173		173	
174		174	
175		175	
176		176	
177		177	
178		178	
179		179	
180		180	
181		181	
182		182	
183		183	
184		184	
185		185	
186		186	
187		187	
188		188	
189		189	
190		190	
191		191	
192		192	
193		193	
194		194	
195		195	
196		196	
197		197	
198		198	
199		199	
200		200	
201		201	
202		202	
203		203	
204		204	
205		205	
206		206	
207		207	
208		208	
209		209	
210		210	
211		211	
212		212	
213		213	
214		214	
215		215	
216		216	
217		217	
218		218	
219		219	
220		220	
221		221	
222		222	
223		223	
224		224	
225		225	
226		226	
227		227	
228		228	
229		229	
230		230	
231		231	
232		232	
233		233	
234		234	
235		235	
236		236	
237		237	
238		238	
239		239	
240		240	
241		241	
242		242	
243		243	
244		244	
245		245	
246		246	
247		247	
248		248	
249		249	
250		250	
251		251	
252		252	
253		253	
254		254	
255		255	
256		256	
257		257	
258		258	
259		259	
260		260	
261		261	
262		262	
263		263	
264		264	
265		265	
266		266	
267		267	
268		268	
269		269	
270		270	
271		271	
272		272	
273		273	
274		274	
275		275	
276		276	
277		277	
278		278	
279		279	
280		280	
281		281	
282		282	
283		283	
284		284	
285		285	
286		286	
287		287	
288		288	
289		289	
290		290	
291		291	
292		292	
293		293	
294		294	
295		295	
296		296	
297		297	
298		298	
299		299	
300		300	
301		301	
302		302	
303		303	
304		304	
305		305	
306		306	
307		307	
308		308	
309		309	
310		310	
311		311	
312		312	
313		313	
314		314	
315		315	
316		316	
317		317	
318		318	
319		319	
320		320	
321		321	
322		322	
323		323	
324		324	
325		325	
326		326	
327		327	
328		328	
329		329	
330		330	
331		331	
332		332	
333		333	
334		334	
335		335	
336		336	
337		337	
338		338	
339		339	
340		340	
341		341	
342		342	
343		343	
344		344	
345		345	
346		346	
347		347	
348		348	
349		349	
350		350	
351		351	
352		352	
353		353	
354		354	
355		355	
356		356	
357		357	
358		358	
359		359	
360		360	
361		361	
362		362	
363		363	
364		364	
365		365	
366		366	
367		367	
368		368	
369		369	
370		370	
371		371	
372		372	
373		373	
374		374	
375		375	
376		376	
377		377	
378		378	
379		379	
380		380	
381		381	
382		382	
383		383	
384		384	
385		385	
386		386	
387		387	
388		388	
389		389	
390		390	
391		391	
392		392	
393		393	
394		394	
395		395	
396		396	
397		397	
398		398	
399		399	
400		400	
401		401	
402		402	
403		403	
404		404	
405		405	
406		406	
407		407	
408		408	
409		409	
410		410	
411		411	
412		412	
413		413	
414		414	
415		415	
416		416	
417		417	
418		418	
419		419	
420		420	
421		421	
422		422	
423		423	
424		424	
425		425	
426		426	
427		427	
428		428	
429		429	
430		430	
431		431	
432		432	
433		433	

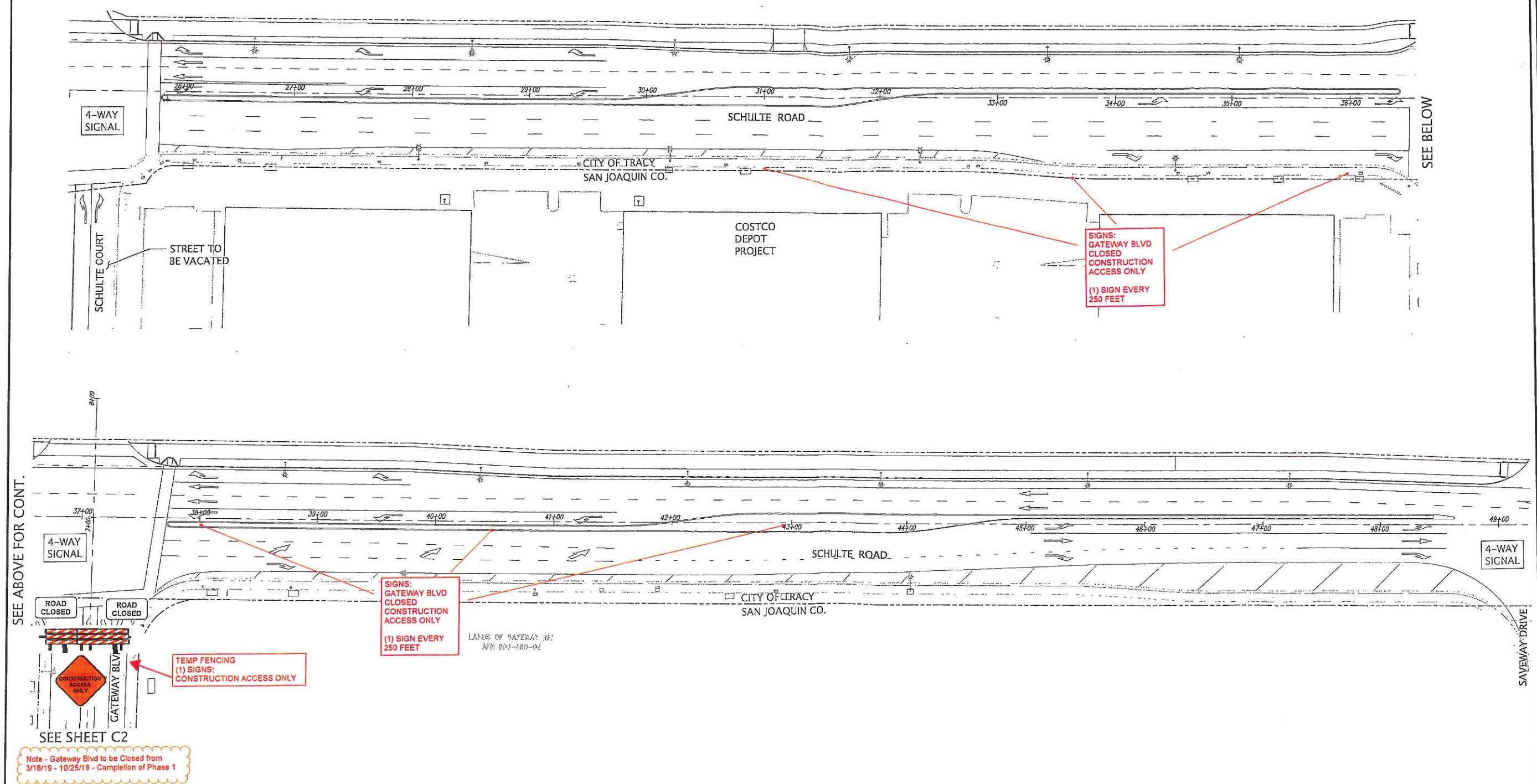
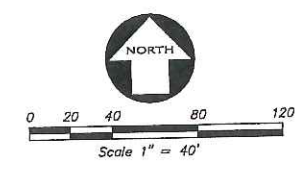

REVISION		BY	NO.

KIER & WRIGHT
CIVIL ENGINEERS & SURVEYORS, INC.
2550 Collier Canyon Road
Livermore, California 94551
Phone: (925) 245-8788
Fax: (925) 245-8796
www.kierwright.com

TRAFFIC CONTROL PLAN
OF
SHULTE ROAD & GATEWAY BOULEVARD
FOR
COSTCO DEPOT
SAN JOAQUIN COUNTY, CALIFORNIA

DATE	FEBRUARY, 2019
SCALE	1" = 40'
DESIGNER	CH
DRAFTER	SA
JOB NO.	A08579-14
SHEET	C1
OF	2 SHEETS

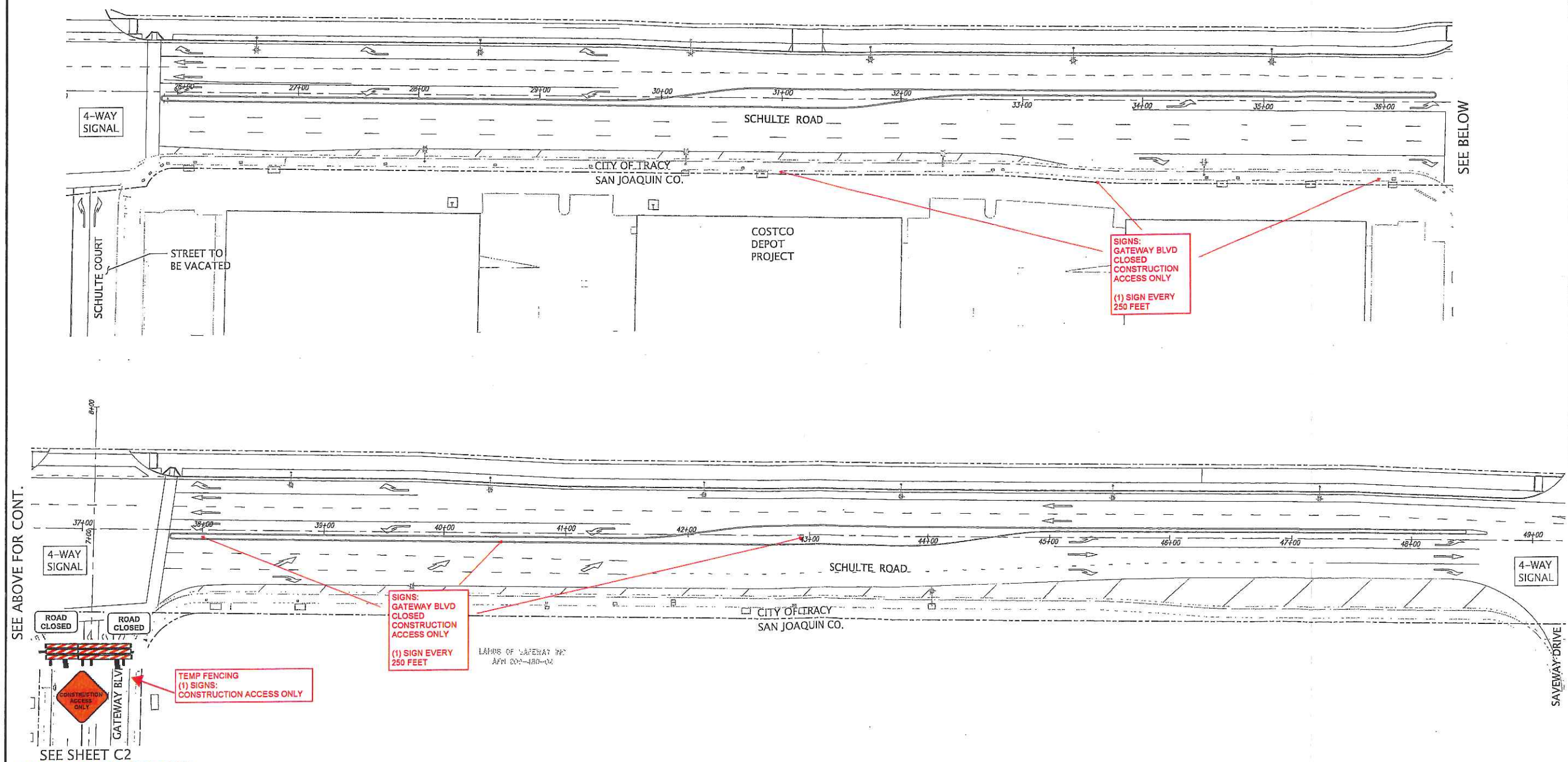
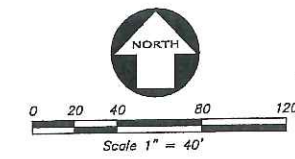

SEE ABOVE FOR CONT.

SEE BELOW

SEE SHEET C2

BY	REVISION	NO.

KIER & WRIGHT
CIVIL ENGINEERS & SURVEYORS, INC.
2850 Collier Canyon Road
Livermore, California 94551
Phone (925) 245-8788
Fax (925) 245-8796
www.kierwright.com

TRAFFIC CONTROL PLAN
OF
SHULTE ROAD & GATEWAY BOULEVARD
FOR
COSTCO DEPOT
SAN JOAQUIN COUNTY, CALIFORNIA

DATE	FEBRUARY, 2019
SCALE	1" = 40'
DESIGNER	CH
DRAFTER	SA
JOB NO.	A08579-14
SHEET	C1
OF	2 SHEETS