

PROFILE

SCALE: 1" = 20' Horiz.
1" = 1' Vert.

SAN JUAN COUNTY PUBLIC WORKS DEPARTMENT	
1. SUBMITTER	TERMINAL
2. DATE	10-17-86
3. CONTRACT NO.	N/A
4. PROJECT NO.	N/A
5. SHEET NO.	N/A
6. TOTAL SHEETS	N/A
Refer to DP-86-17	
APPROVED BY	DATE
Thomas M. Gau	10-17-86
DIRECTOR OF PUBLIC WORKS	

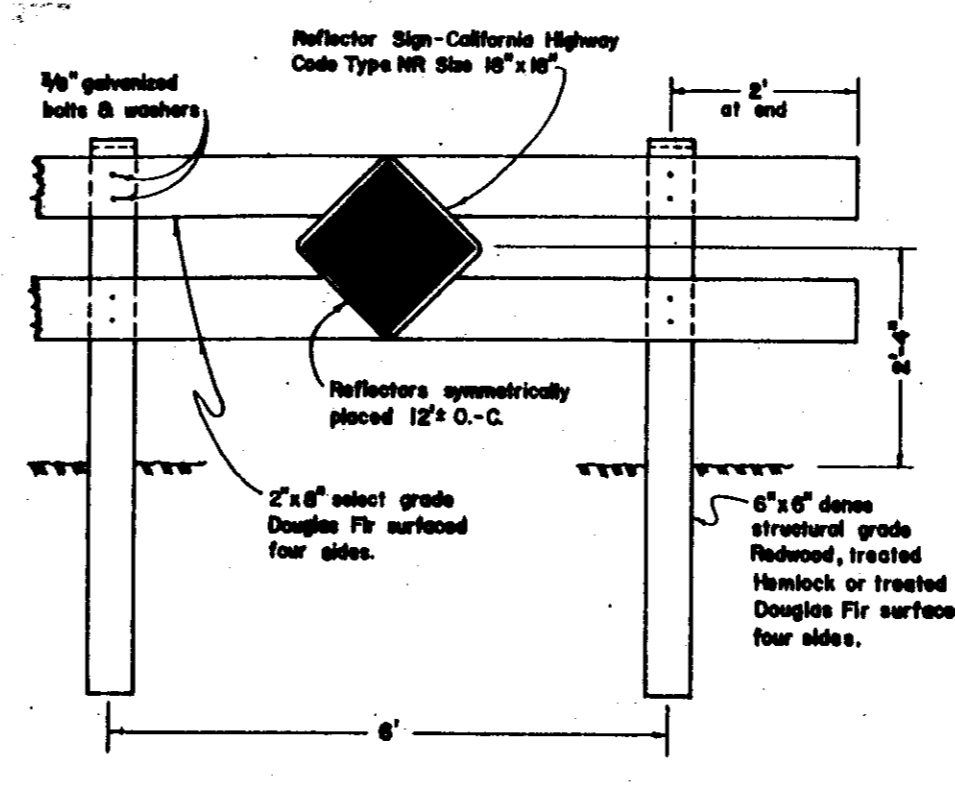

TYPE "A" BARRICADE

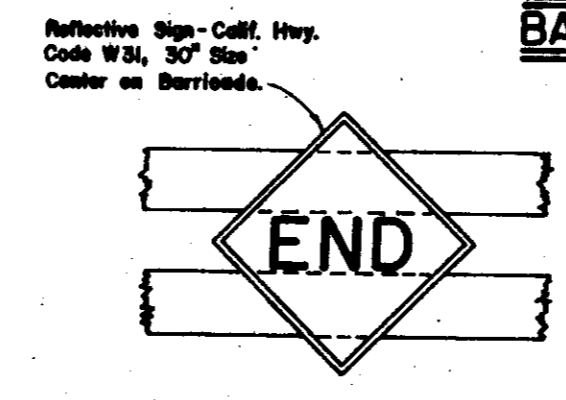

CENTER REFLECTOR FOR TYPE "A" BARRICADE

NOTES:
1. Barricades to be as wide as shown on plans.
2. Barricades to be painted white using 2 coats of "Esther Alloy Resin Hi-Gloss Enamel" over a compatible primer.

LEGEND

- Paving in R/W (4" A.C., 18" A.B.)
- Paving outside R/W (3" A.C., 6" A.B.)

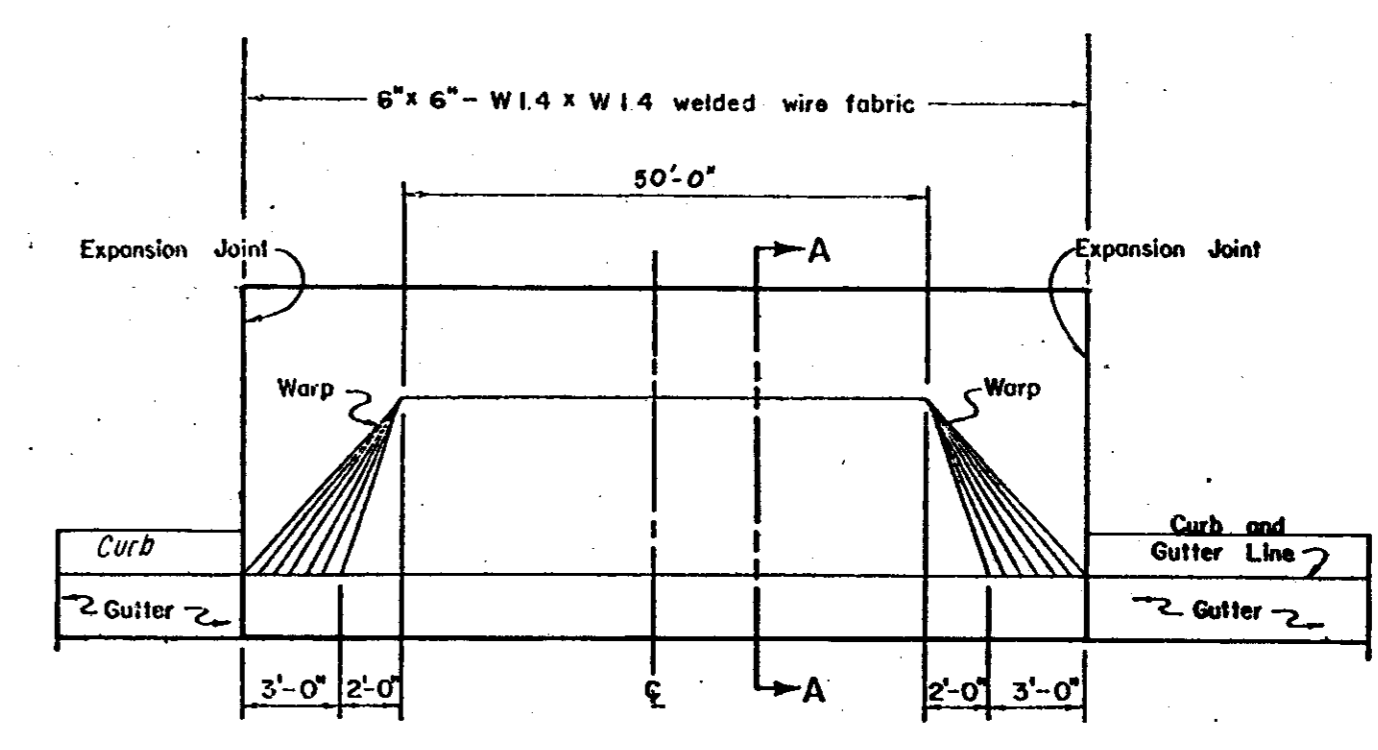

PLAN

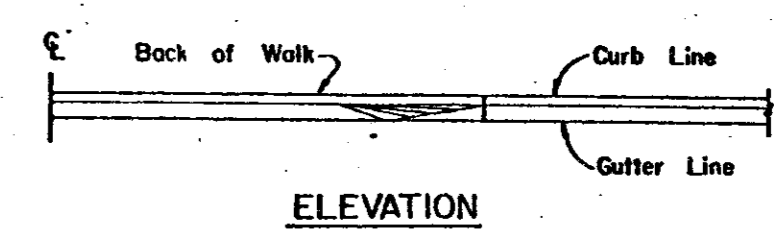

ELEVATION

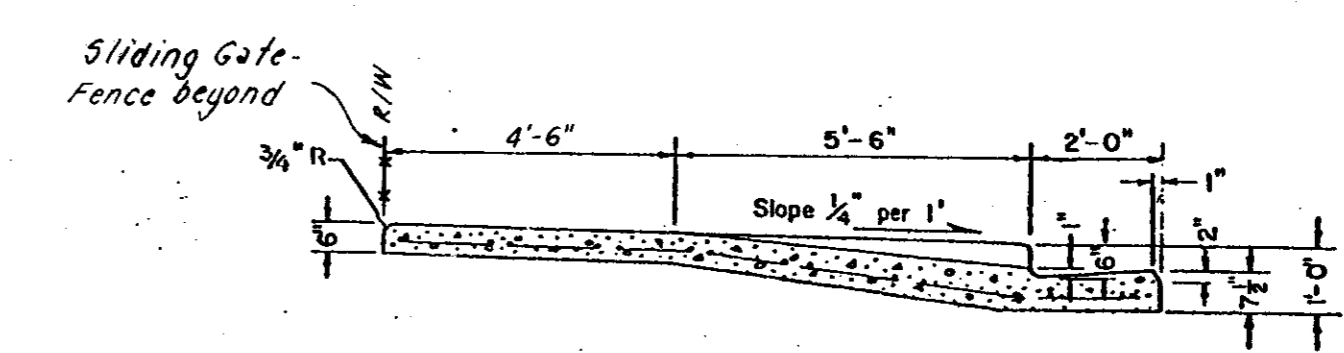

SECTION A-A

TYPICAL DRIVEWAY

No Scale

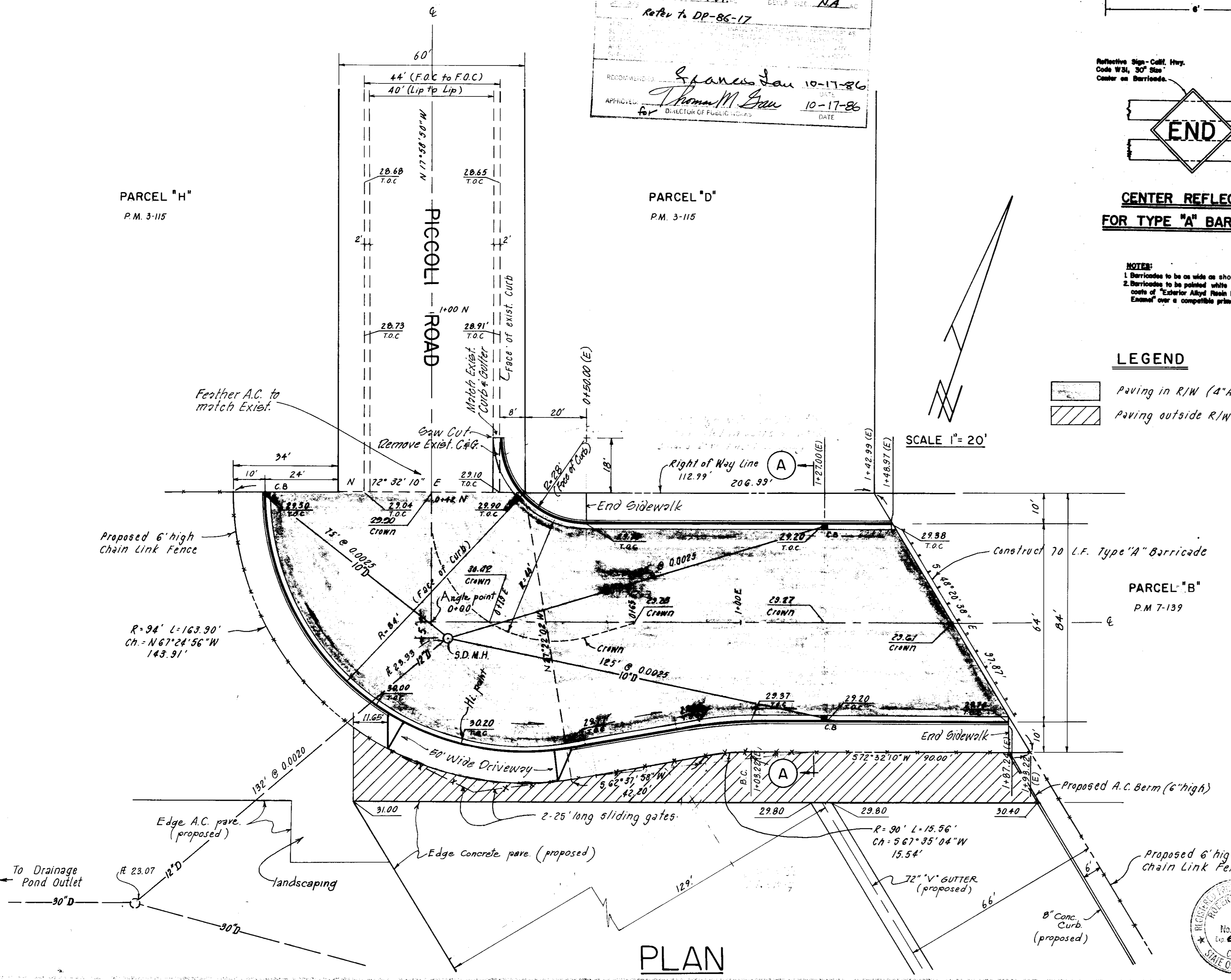

PLAN

SCALE 1" = 20'

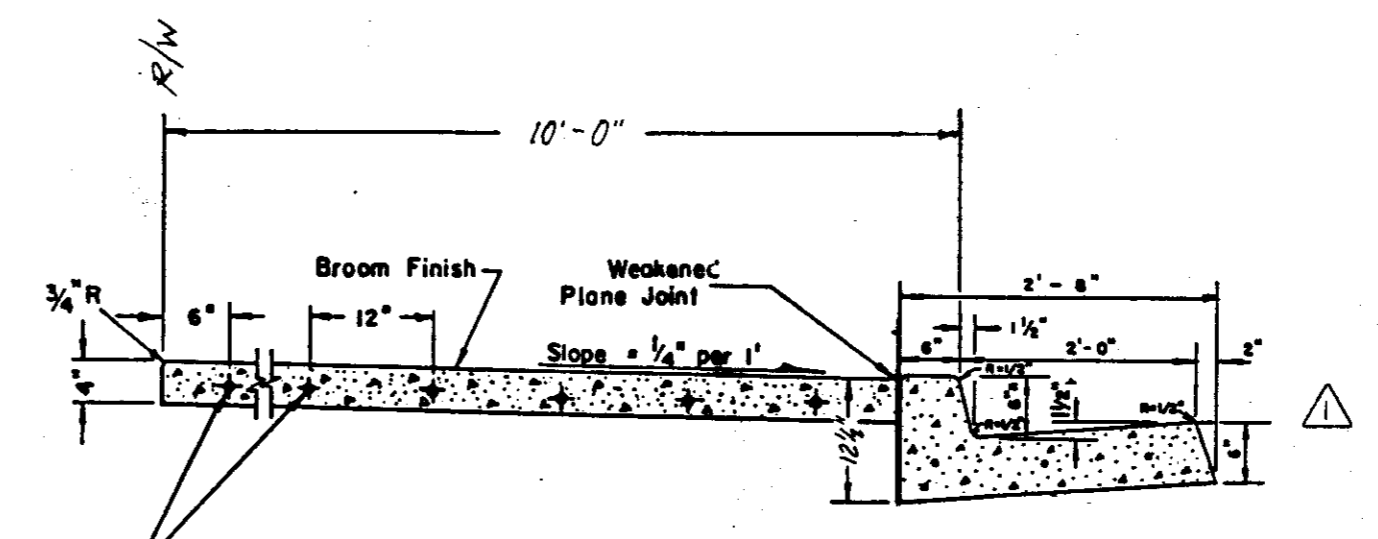

CURB, GUTTER & SIDEWALK

DEPRESSED LETTERS IN CURB TO IDENTIFY SERVICE LOCATIONS

- W - Water line
- S - Sanitary Sewer line
- G - Gas line

NOTES:
1. Construct expansion joints @ 200' maximum and at returns, around light poles, hydrants and other fixed objects at sidewalk.
2. Transverse weakened plane joints shall be constructed @ 12' maximum intervals.

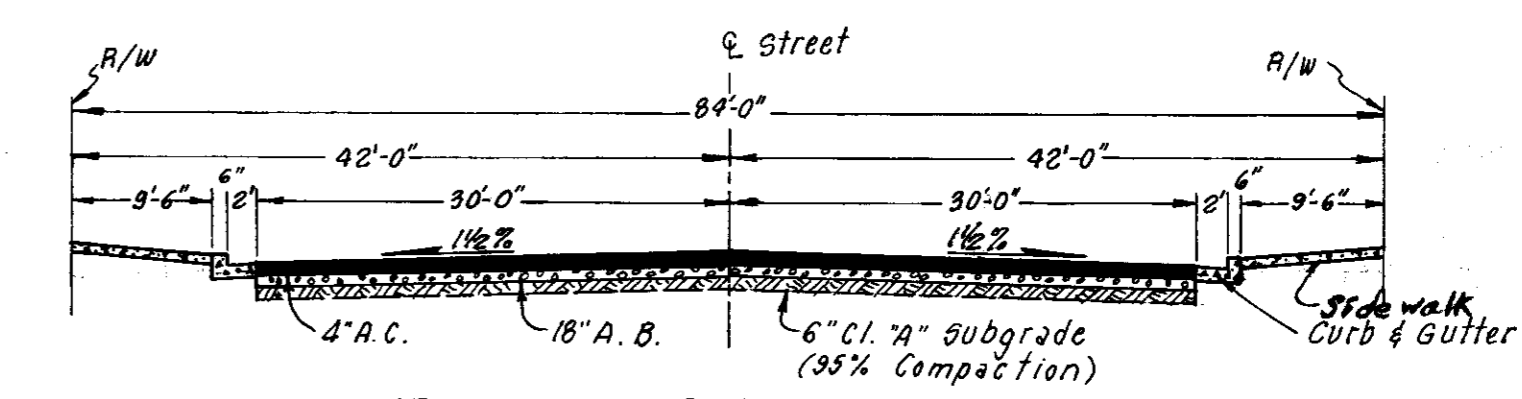

TYPICAL STREET SECTION SECTION (A)

12" Value = 10.0
T.I. = 8.0
No Scale

SU 1883

REVISOR CURB & GUTTER DETAIL 10-14-86 MFP

J.W. STEPHENSON & ASSOCIATES
REGISTERED PROFESSIONAL ENGINEERS
No. 17351
6-30-89
STATE OF CALIFORNIA

Robert G. Selum
17,351

4986-4
May 1986

INLAND INVESTMENT COMPANY - DISTRIBUTION CENTER

PICCOLI ROAD EXTENSION

PLAN & PROFILE AND SECTIONS

1
TWO
63170

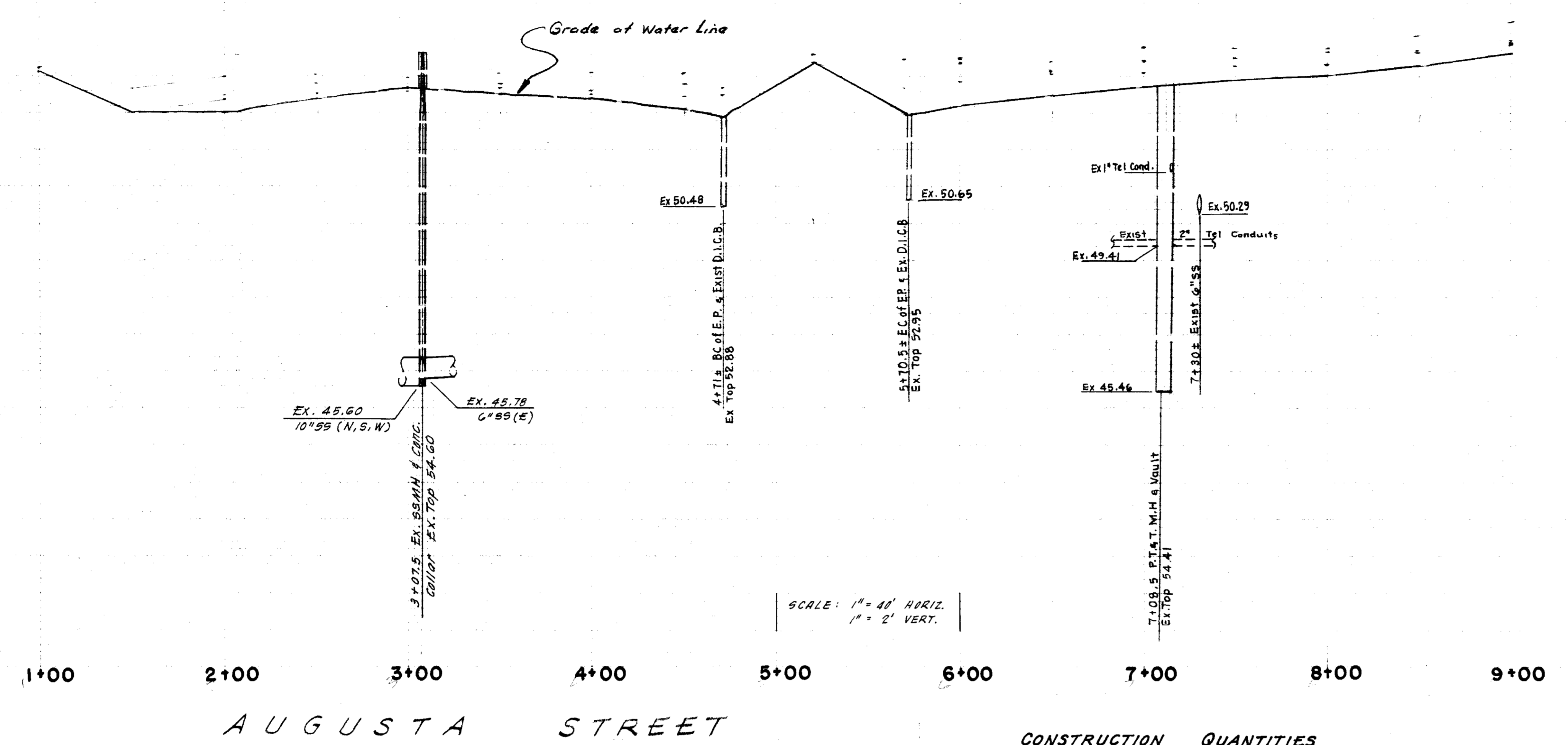

GENERAL NOTES

- Contractor to provide compaction tests and be solely responsible for safety conditions.
- All water pipe shall be A.C.P. Cl. 150 with Ring-Tite connections conforming to AWWA Standard C-400.
- Testing, sterilization, and installation shall conform to the applicable Standards of the Department of Public Works and the Local Health District.
- Jetting will not be allowed except by special arrangement with the Department of Public Works. All costs associated with jetting, if allowed, shall be borne by the Contractor.
- When cutting through Augusta, Orange and Main Streets make neat cut. Match existing structural section (6" A.C. - 3" A.B. min.). Maintain one way traffic at all times and two way at night.
- San Joaquin County Department of Public Works Specifications and Standard Plans are hereby made a part of these plans.
- Where water crosses SD or SS, use an 18-20 ft. length of Cl. 200 pipe, centered over the SS or SD if:
 - The water is under the SS or SD.
 - The vertical clearance is less than 1 ft.
- Fire hydrant shall be a Model 415 Long Beach Iron Works w/ 2 @ 2 1/2" outlets and 1 @ 4 1/2" steamer outlet, or equal, approved by the Chief, Woodbridge Fire District.

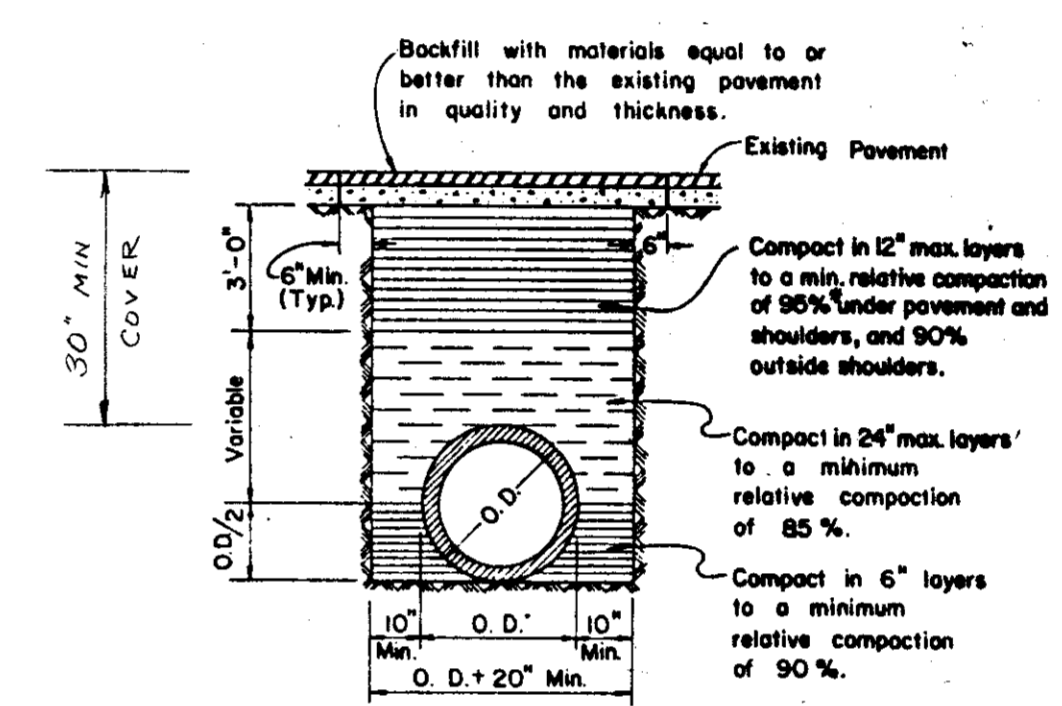

TYPICAL TRENCH BACKFILL

- NOTES:**
- Relative compaction of materials shall be tested by the State of California, Dept. of Transportation Testing Manual, test method No. California 216 or 231.
 - All existing pavement shall be neatly cut to line prior to trench excavation.
 - Jetting or ponding will be permitted within the street Right of Way with 3 year bond.
 - When shown by soil composition and compaction, ninety percent (90%) compaction may be used, when approved by the Director of Public Works.

CONSTRUCTION QUANTITIES

WATER SYSTEM	
8" Water	134 L.F.
6" Water	683 L.F.
6" Valve	3 EA.
Fire Hydrant	1 EA.
1" Water Service	1 EA.

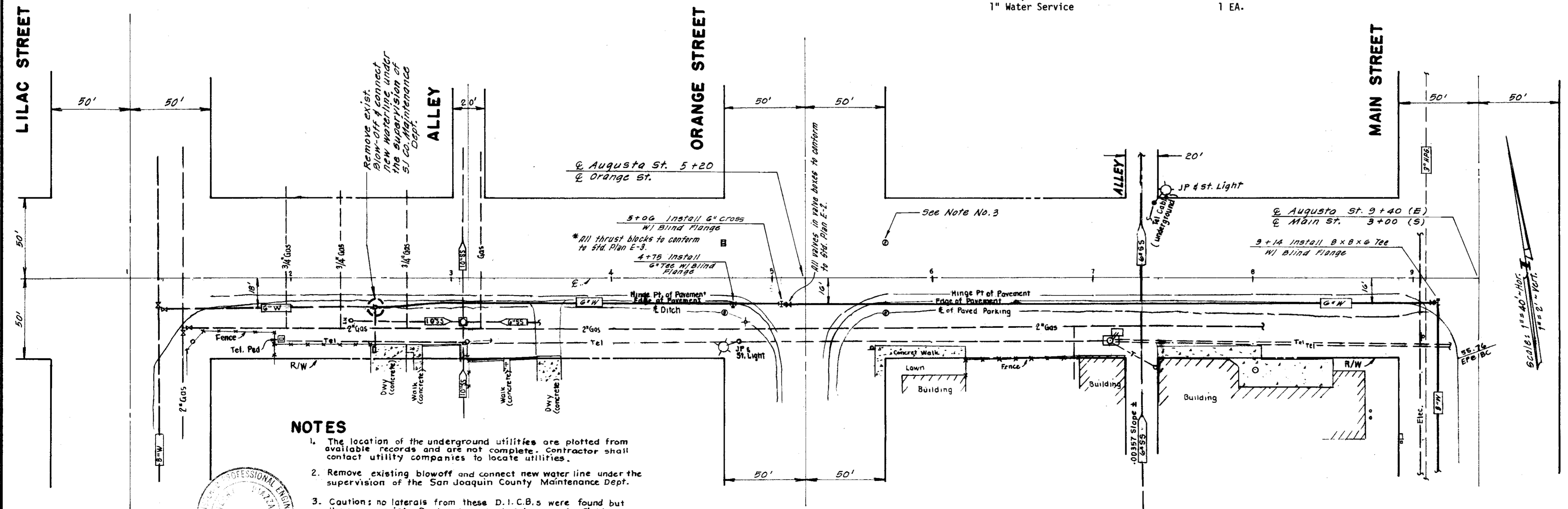

NOTES

- The location of the underground utilities are plotted from available records and are not complete. Contractor shall contact utility companies to locate utilities.
- Remove existing blowoff and connect new water line under the supervision of the San Joaquin County Maintenance Dept.
- Caution: no laterals from these D.I.C.B.s were found but they may exist. Contractor shall determine in field.



SU-1884

NO.	DATE	REVISIONS	BY	DESIGN	TP	DRAWN BY	ES	APPROVED BY
1	8-14		TP					

SUBMITTED BY: *[Signature]* R.C.E. 19638 DATE 7-22-84
 REVISIONS: *[Signature]* Rep. Expire 9-30-87
 APPROVED BY: *[Signature]* Nov 10 1986
 SAN JOAQUIN COUNTY DEPARTMENT OF PUBLIC WORKS

BAUMBACH & PIAZZA
 CIVIL ENGINEERS - SURVEYORS
 W. ST. LODI, CALIF. 95240 PH. 209-368-8098

AUGUSTA STREET
 WATER LINE
 WOODBRIDGE

SHEET 1 OF 1
 JOB NO. 8643
 FILE NO. G-798