

SU-1931

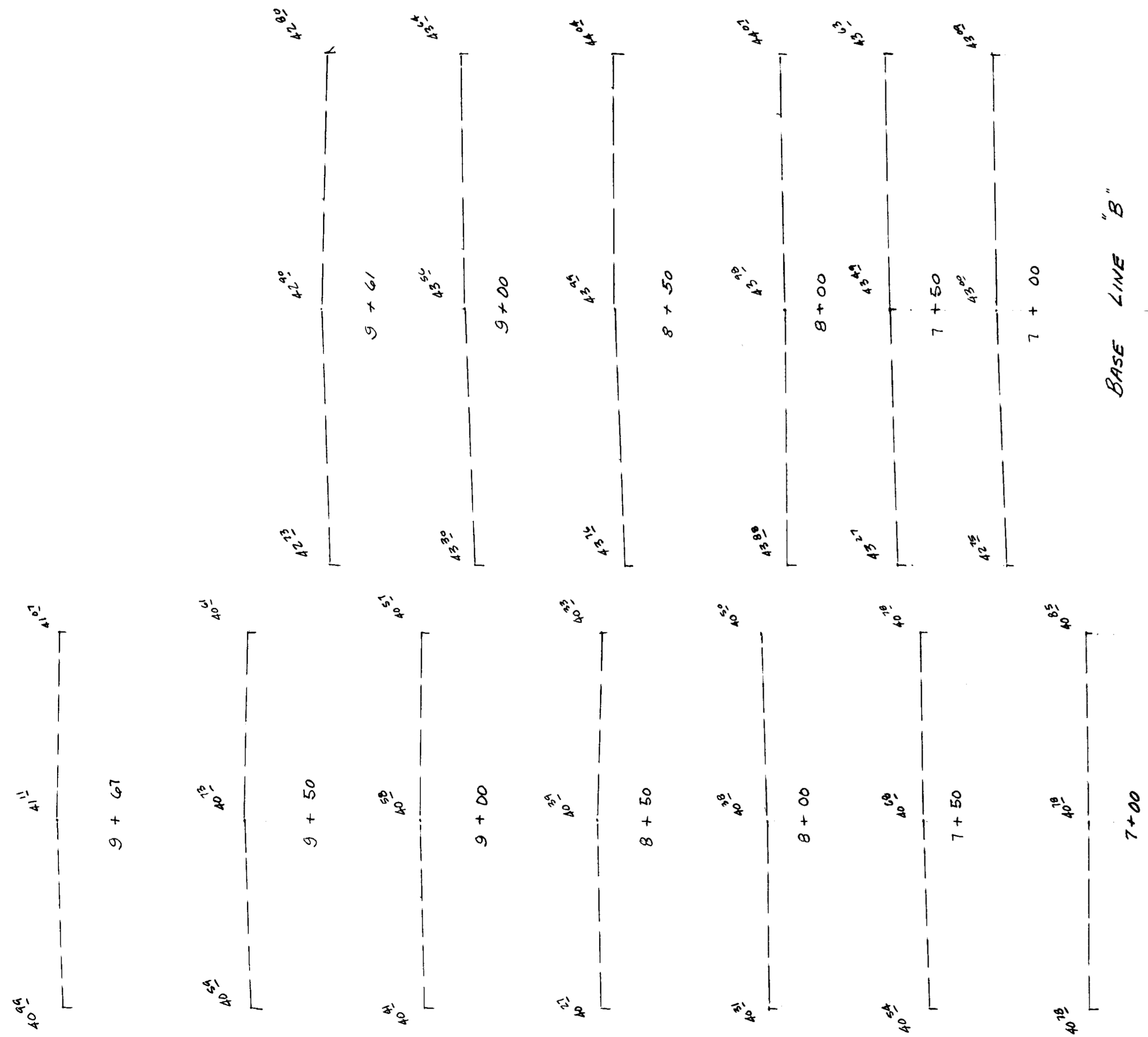

BASE LINE "B"

BASE LINE "A"

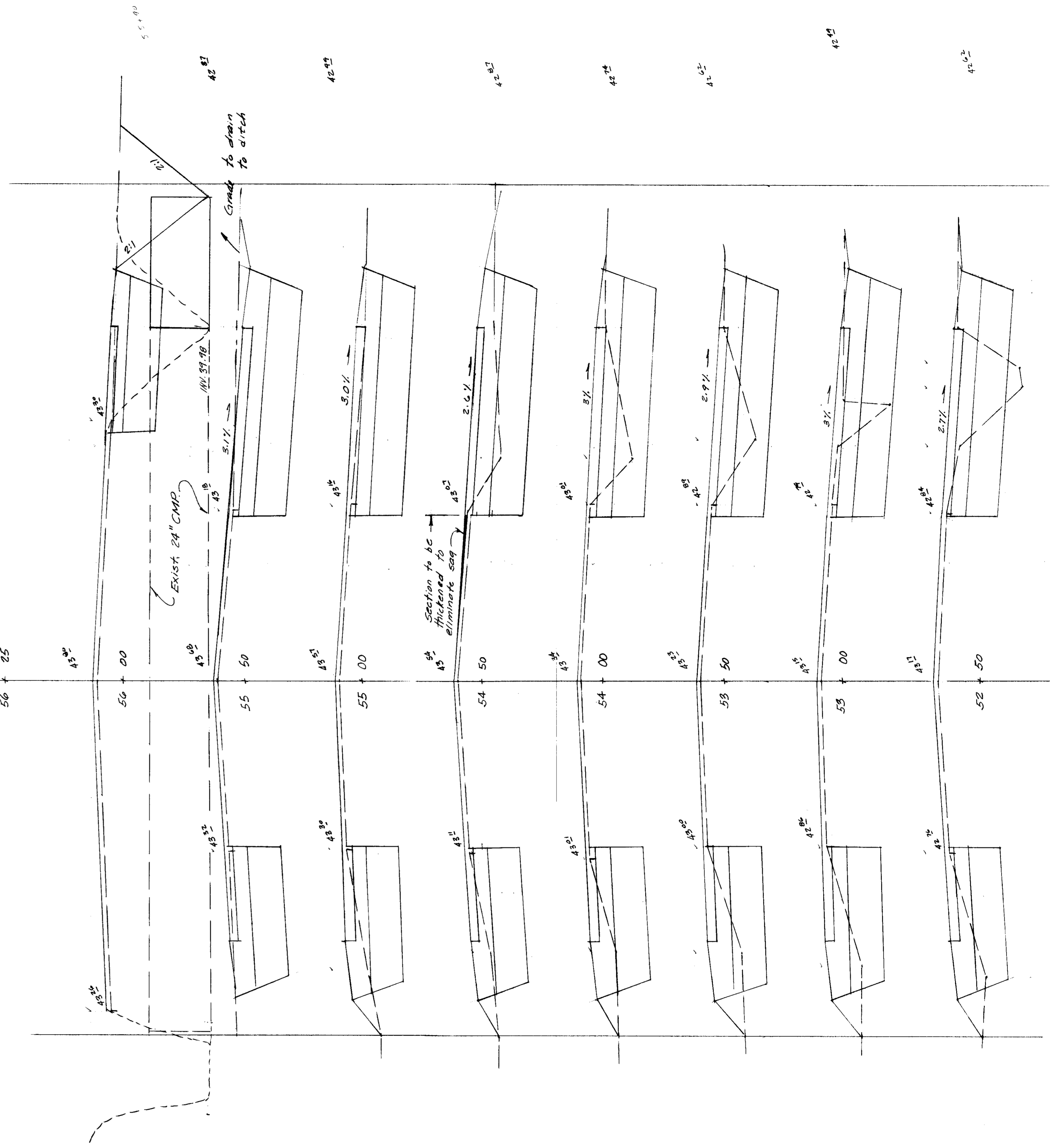

# 8735  
4/14/87

ARCH RD. Scale: Horiz: 1" = 5'  
Vert: 1" = 2'

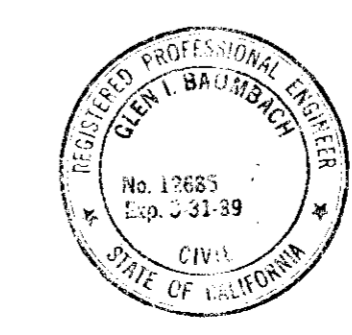

PREPARED IN THE OFFICE OF:  
**BAUMBACH & PIAZZA**  
 CIVIL ENGINEERS  
 1829 WEST ELM STREET  
 LOS ANGELES, CALIFORNIA  
*Alan J. Baumbach* 1988 17685

PREPARED FOR:  
 KITCHELL, CEM  
 510 J Street  
 Sacramento, Calif.  
 95814

SHEET 11 OF 11  
 JOB NO. 8735  
 FILE NO. **G-834**

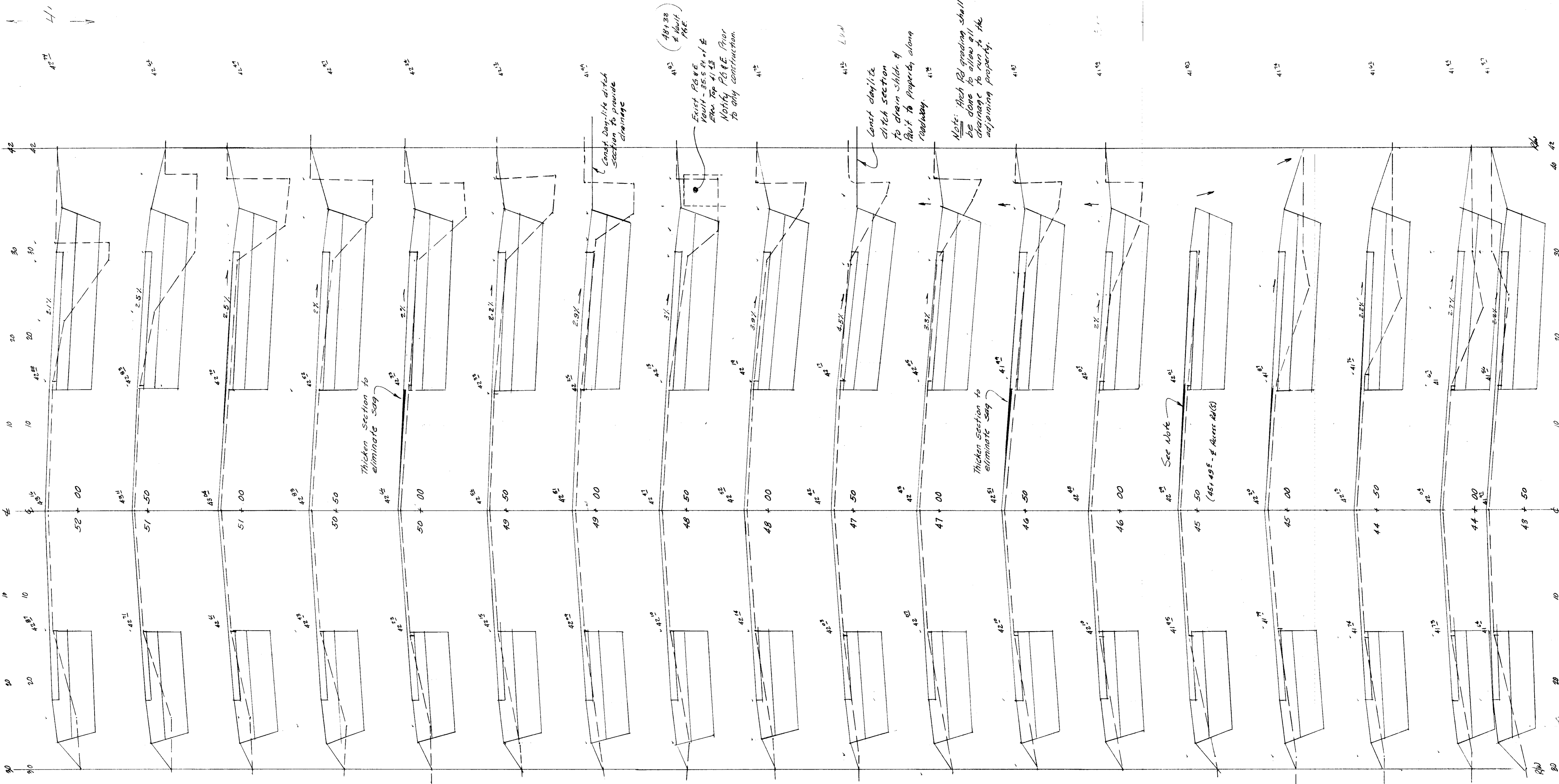

48738  
 # 1001  
 P&E  
 EXIST. P&E  
 FROM 35.5' E. of E  
 FROM TOP 41.45  
 NOTIFY P&E Prior  
 to any construction.

Const. day-like  
 ditch section  
 to drain sheet of  
 Pavt to property along  
 roadway.

Note: High Rd grading shall  
 be done to allow all  
 drainage to run to the  
 adjoining property.

Thicken section to  
 eliminate sag

Thicken section to  
 eliminate sag

See Note

(45+49.5 - E Address 44(S))

SU-1932

# 8735  
 4/14/87

Scale: Horiz: 1" = 5'  
 Vert: 1" = 2'

ARCH RD.



PREPARED IN THE OFFICE OF:  
**BAUMBACH & PIAZZA**  
 CIVIL ENGINEERS  
 328 W 7th Street  
 LOS ANGELES, CALIF. 90012  
*Kent Baumbach* No. 12685

PREPARED FOR:  
 KITCHILL CIM  
 510 J Street  
 Sacramento, Calif.  
 95814

SHEET	10	OF	11
JOB NO.	8795		
FILE NO.	G-834		

SU 1933

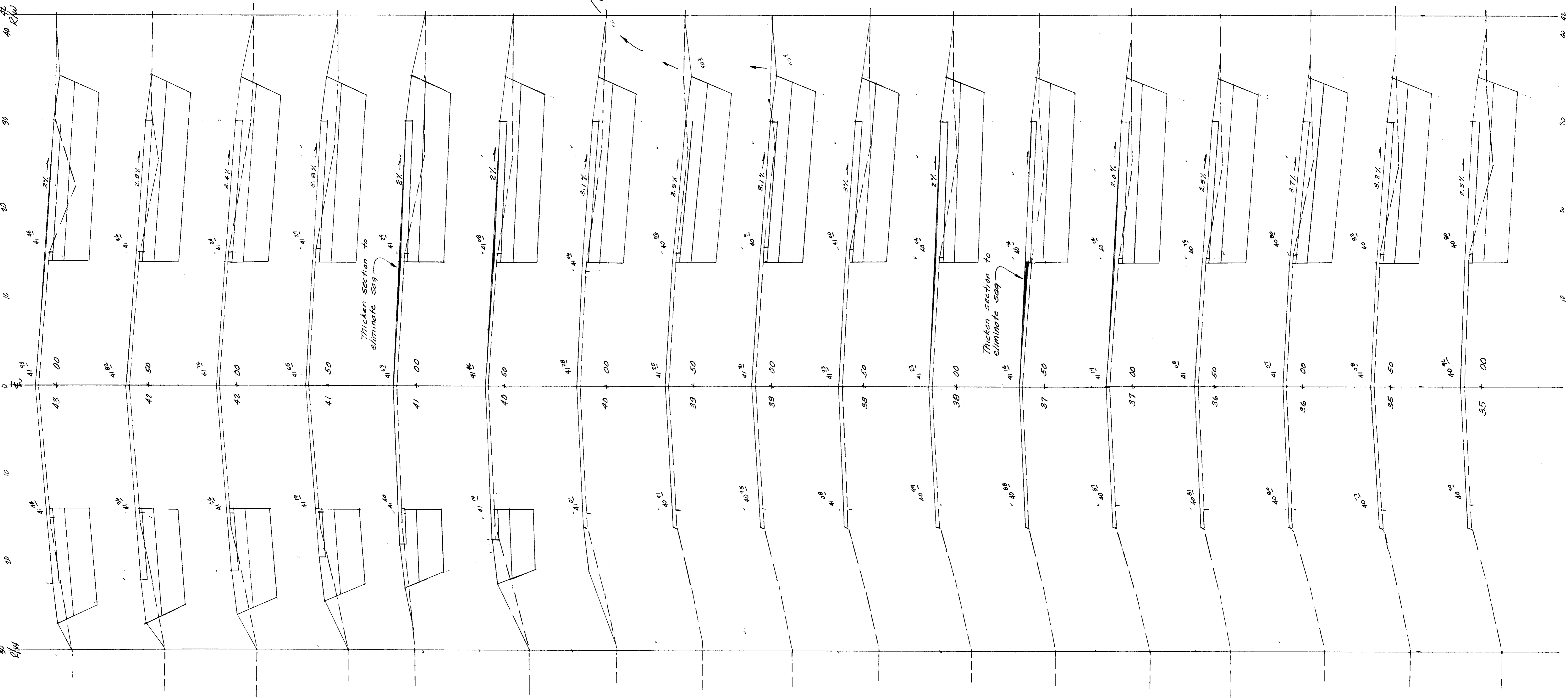

ARCH RD.



PREPARED IN THE OFFICE OF:  
**BAUMBACH & PIAZZA**  
 CIVIL ENGINEERS  
 829 WEST ELM STREET  
 SACRAMENTO, CALIF. 95814  
*Glenn Saumbach* 12095

PREPARED FOR:  
 KITCHELL, CEM  
 510 J Street  
 Sacramento, Calif.  
 95814

# 8735  
 4/14/87  
 Scale: Horiz: 1" = 5'  
 Vert: 1" = 2'

SHEET **9** of 11  
 JOB NO. 8795  
 FILE NO. **G-834**

50-1934

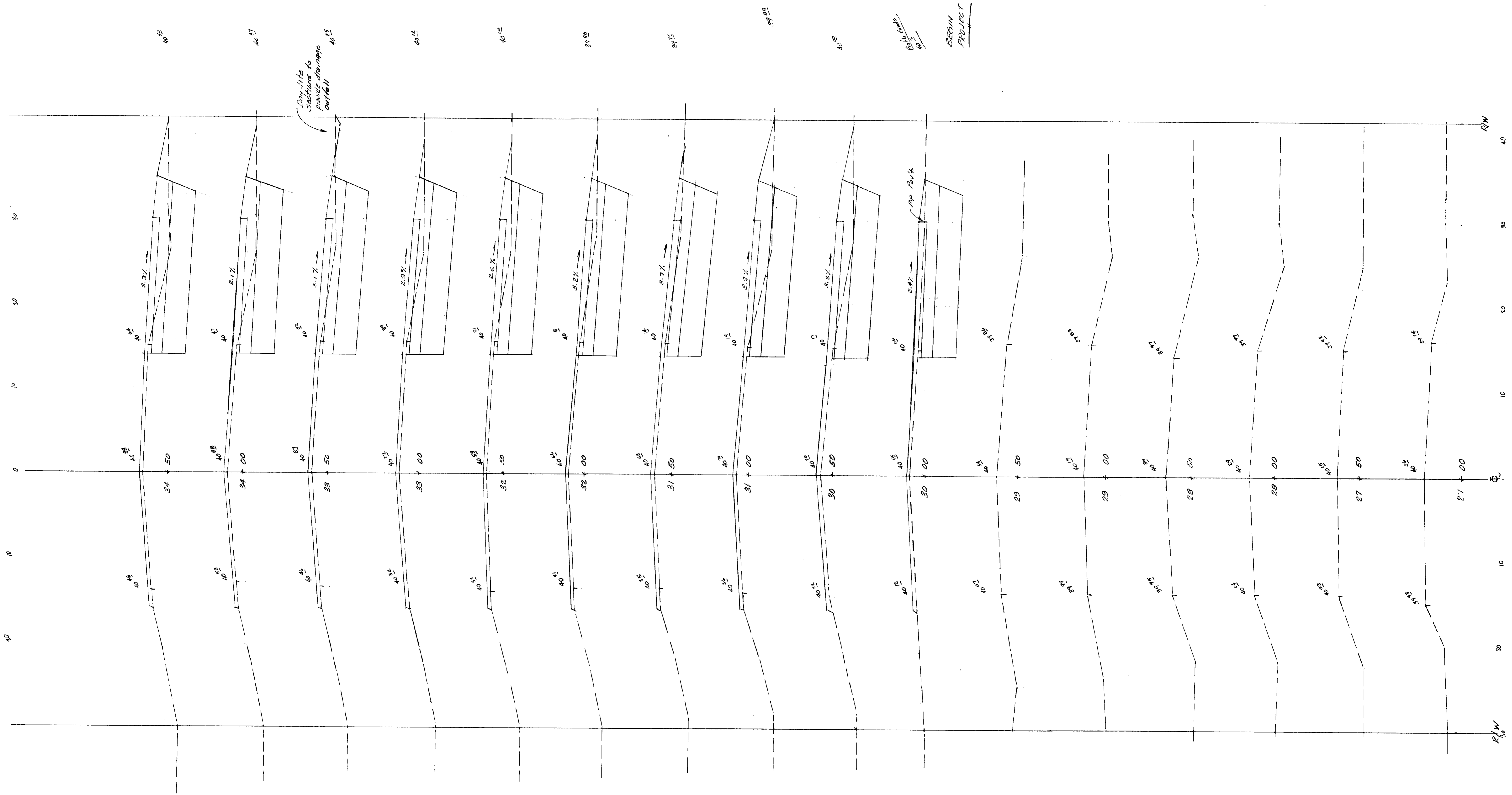

PREPARED IN THE OFFICE OF  
**BAUMBACH & PIAZZA**  
 CIVIL ENGINEERS  
 929 F ST. ELM STREET  
 SACRAMENTO, CALIF.  
*Robert Baumbach* 12685

PREPARED FOR:  
 KITCHELL CFM  
 510 J Street  
 Sacramento, Calif.  
 95814

# 8735  
 4/14/87  
 Scale: Horiz: 1"=5'  
 Vert: 1"=2'

SHEET **8** OF 11  
 JOB NO. 8735  
 FILE NO. **G-834**

ARCH RD

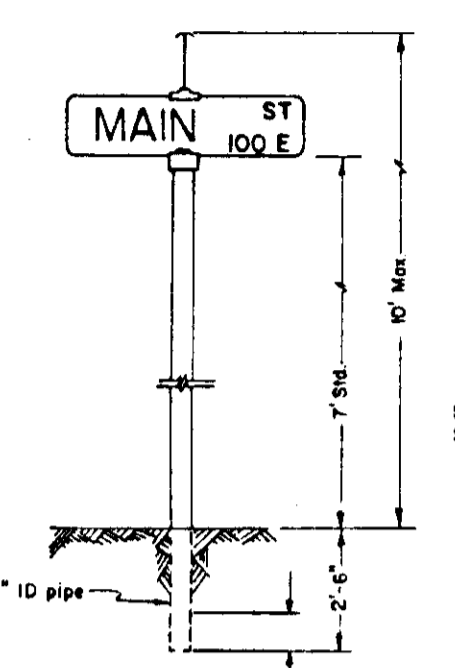
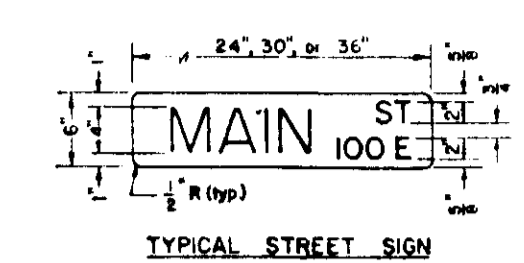
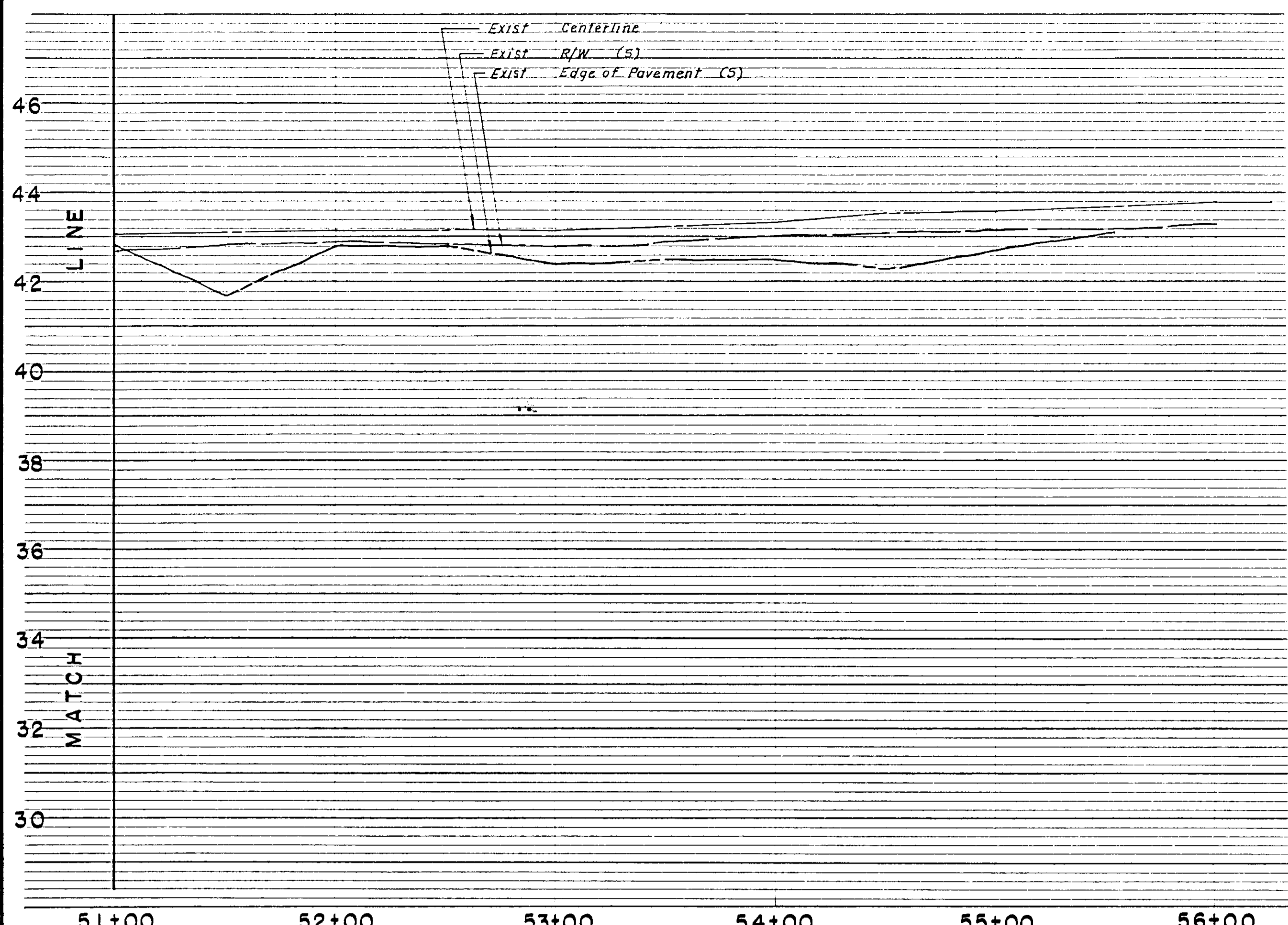

- NOTES**
- One street sign is required at each intersection.
  - Block numbers are to be acquired from the San Joaquin County Department of Planning and Building Inspection.
  - See improvement plans for location of STOP signs, when required.
  - The length of the street sign varies due to the length of the street name.

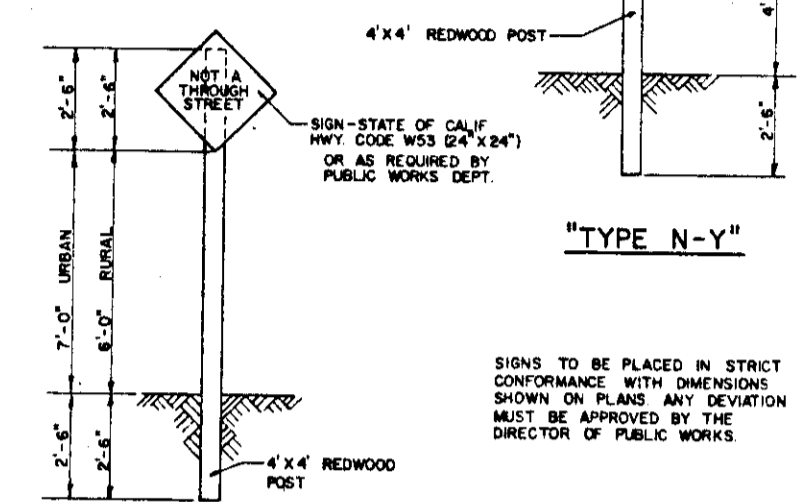
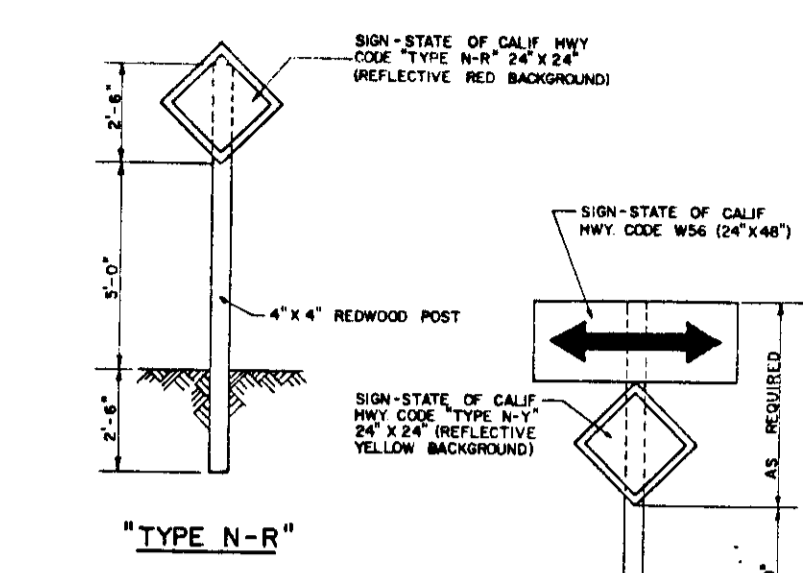
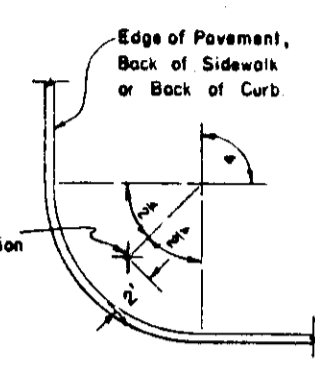

NO.	REVISED	DATE	BY

**STANDARD STREET SIGN DETAILS**

DESIGNED BY: *[Signature]*  
 CHECKED BY: *[Signature]*  
 COUNTY OF SAN JOAQUIN DEPARTMENT OF PUBLIC WORKS  
 STANDARD NO. A-10

NO.	REVISED	DATE	BY

**TYPICAL SIGN**

TRAFFIC SIGNS

DESIGNED BY: *[Signature]*  
 CHECKED BY: *[Signature]*  
 COUNTY OF SAN JOAQUIN DEPARTMENT OF PUBLIC WORKS  
 STANDARD NO. A-11

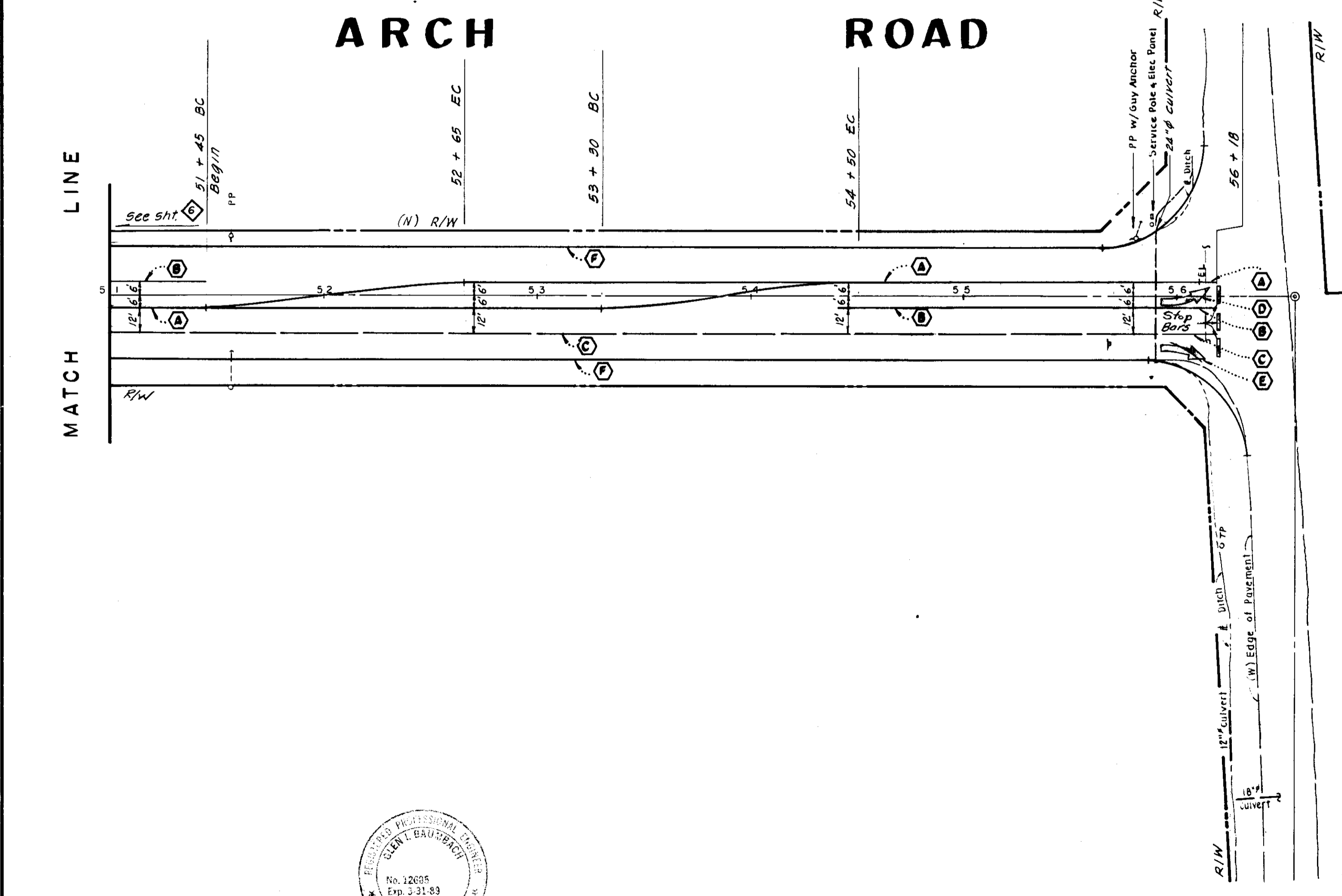

**LEGEND**

- A Double Yellow Painted
  - B 8" Solid White Stripe
  - C 4" X 6" White Stripe, 36" Spacing
  - D Left Turn Arrow
  - E 24" Right Turn Arrow
  - F 4" Solid White Stripe
- 
- R1R Stop Sign
  - W56R Double Head Arrow
  - W59R Merge

56-1 STREET SIGNS. Attention is directed to Section 56 of the Standard Specifications and these Special Provisions.

- A. Materials**
- The various materials or fabrications thereof shall conform to the following requirements:
- Street signs shall have a horizontal dimension of 24 inches, 30 inches or 36 inches and a vertical dimension of 6 inches.
  - Street signs shall be completely reflectorized on a double face flat blade sign.
  - Street sign shall be anodized aluminum with a thickness of .080 inches.
  - The legend for street signs shall be white letters on a green background.
  - Street sign posts shall be long enough to provide a minimum height of 7 feet from the base of the post to the bottom of the lower sign, an overall maximum height of 10 feet and 30 inches embedment in the ground.
  - Posts shall be galvanized steel pipe, extra strong and 2 inches nominal diameter.
- B. Installation**
- The installation of street signs shall conform to the following requirements:
- Posts shall be driven or set into the ground to a depth of 30 inches at locations shown on the plans or as directed by the Engineer.
  - The bottom 10 inches of the posts shall be flattened to prevent them from turning in the ground.

**NOTES**

- For sign installation, see County Specification Section 56.
- Paint shall be reflectorized using flotation beads.
- Install reflective pavement markings (Caltrans Type C or D) on double yellow lines per CALTRANS STD Detail A20-A, Detail 22.
- For arrow dimensions, refer to CALTRANS Traffic Manual 6-23.

SU-1935

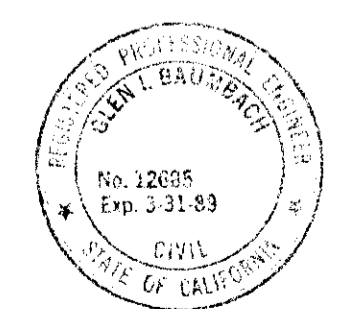

NO.	DATE	REVISIONS	BY	DESIGN	DRAWN BY	APPROVED BY:	<b>BAUMBACH &amp; PIAZZA</b> CIVIL ENGINEERS SURVEYORS 323 W. ELM ST. LODI, CALIF. 95240 PH: 209-368-6616	PREPARED FOR:	KITCHELL, CEM 510 J Street Sacramento, Calif. 95814	ARCH ROAD	SHEET 7 OF 11 JOB NO. 8735 FILE NO. C-834



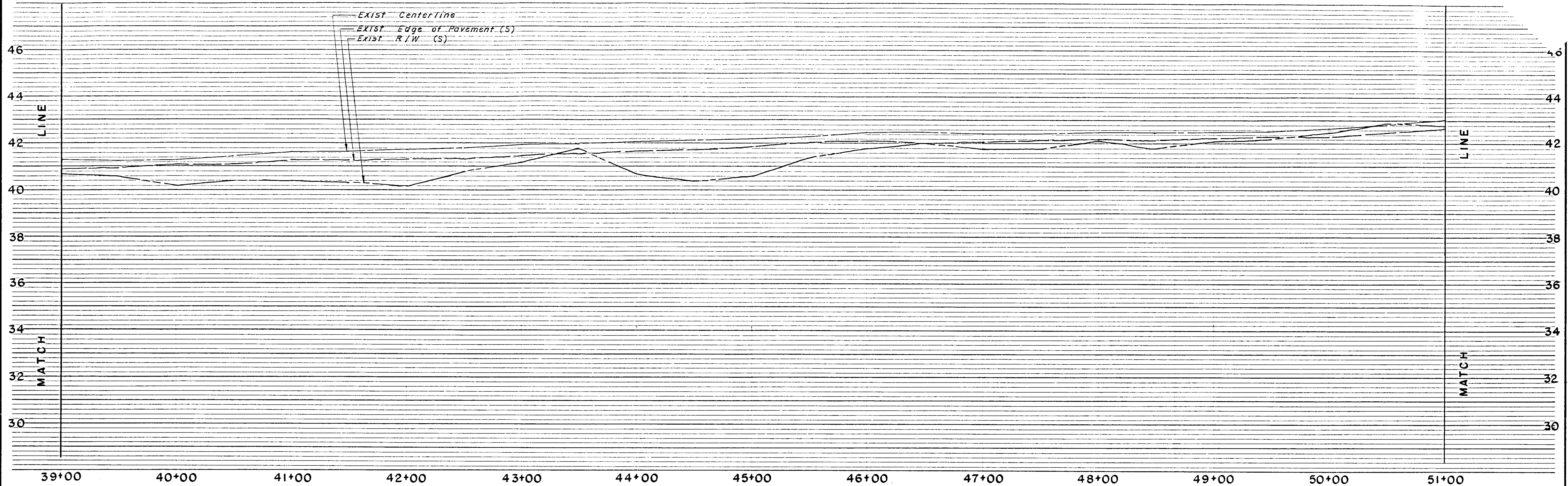

**ARCH ROAD**

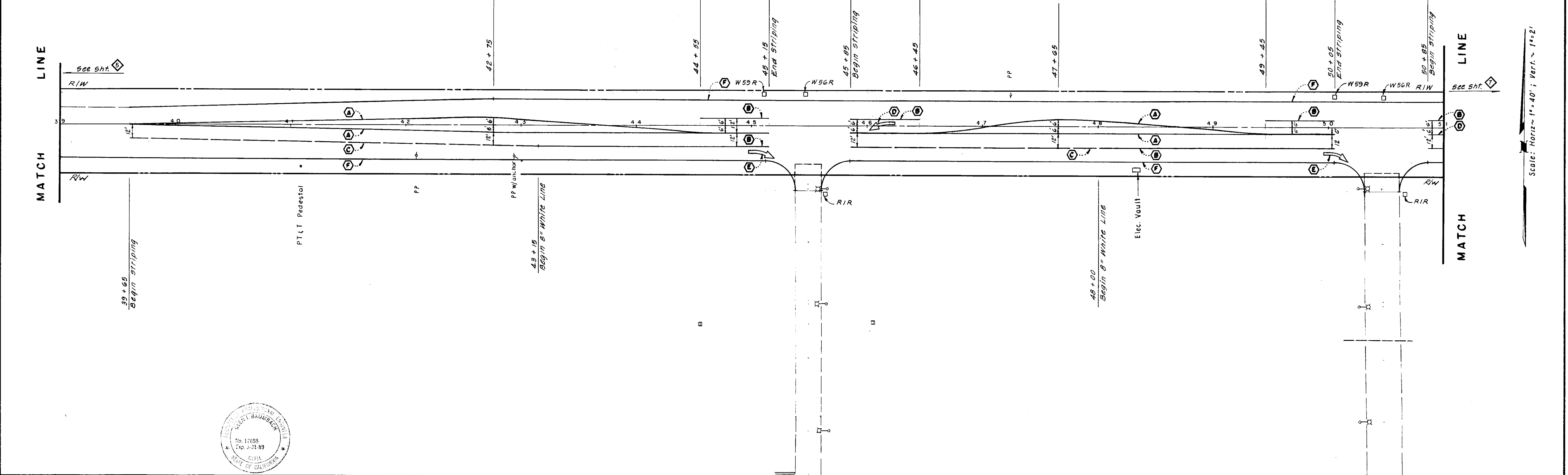

Scale: Horiz. 1" = 40'; Vert. 1" = 2'

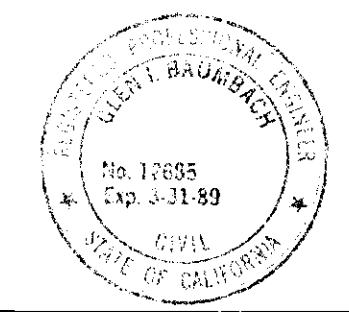

SU-1936

NO.	DATE	REVISIONS	BY	DESIGN	DRAWN BY	APPROVED BY:	PREPARED FOR:	ARCH ROAD	SHEET 6 OF 11
					<i>H. J. Baumbach</i>		KITCHELL CIM 510 J Street Sacramento, Calif. 95814	Striping Plan STA 39 + 00 to STA 51 + 00	JOB NO. 8735
					R.C.E. 12685	19__	323 W. ELM ST. LODI, CALIF. 95240 PH: 209-368-6818		FILE NO. G-834
					DATE 4/4/87	SAN JOAQUIN COUNTY DIRECTOR OF PUBLIC WORKS			

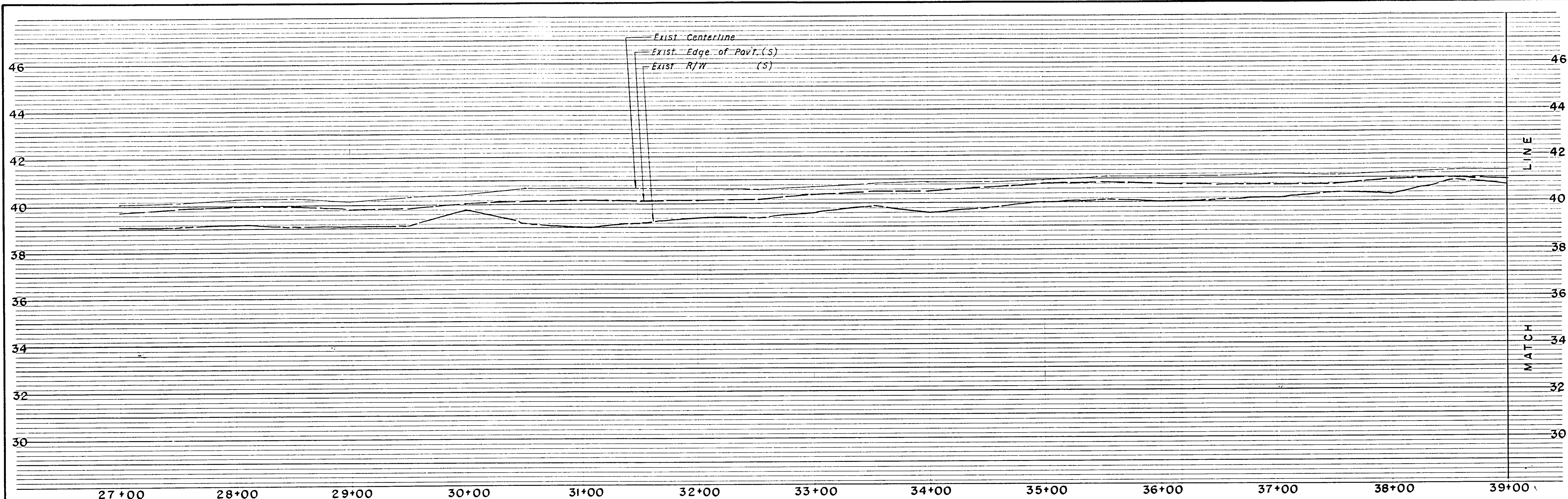

**ARCH ROAD**

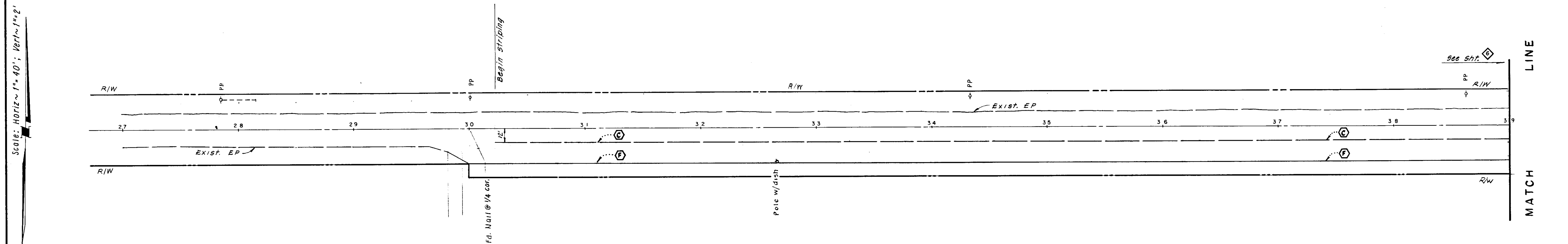

Scale: Horiz ~ 1" = 40'; Vert ~ 1" = 2'

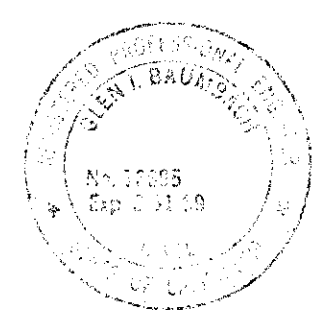

SU 1937

NO.	DATE	REVISIONS	BY	DESIGN	DRAWN BY	APPROVED BY:	<p style="text-align: center;"><b>BAUMBACH &amp; PIAZZA</b>  <b>CIVIL ENGINEERS</b>  <b>SURVEYORS</b></p> <p style="font-size: small;">323 W. ELM ST. LOOI, CALIF.  95240 PH: 209-369-6618</p>	PREPARED FOR: KITCHELL CIM 510 J Street Sacramento, Calif. 95814	ARCH ROAD Striping Plan STA 30 + 00 to STA 39 + 00	SHEET <b>5</b> OF 11 JOB NO. 8735 FILE NO. <b>G-834</b>
				SUBMITTED BY <i>West Baumbach</i> R.C.E. 12685 DATE 4/2/87		SAN JOAQUIN COUNTY DIRECTOR OF PUBLIC WORKS				

SU-1938

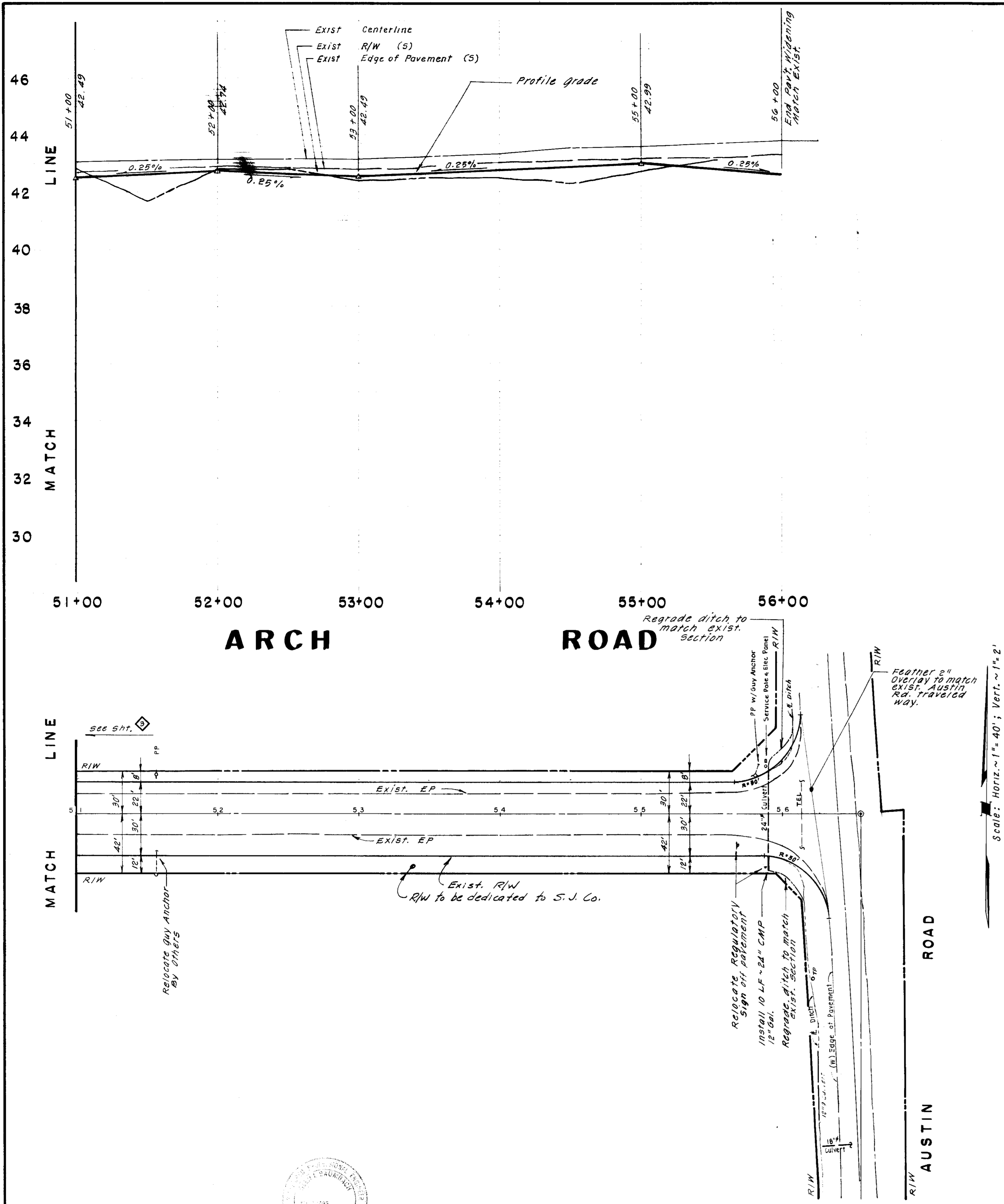

Scale: Horiz. ~ 1" = 40'; Vert. ~ 1" = 2'



NO.	DATE	REVISIONS	BY	DESIGN	DRAWN BY

SUBMITTED BY: *Steve Baumbach*  
 RCE 12685 DATE 6/2/87

APPROVED BY: \_\_\_\_\_, 19\_\_\_\_  
 SAN JOAQUIN COUNTY DIRECTOR OF PUBLIC WORKS

**BAUMBACH & PIAZZA**  
 CIVIL ENGINEERS  
 SURVEYORS  
 323 W. ELM ST. LODI, CALIF.  
 95240 PH: 209-368-8818

PREPARED FOR:  
 KITCHELL, CEM  
 510 J Street  
 Sacramento, Calif.  
 95814

ARCH ROAD  
 Street Improvements  
 STA 51 + 00 to Austin Road

SHEET 4 OF 11
JOB NO. 8735
FILE NO. C-834



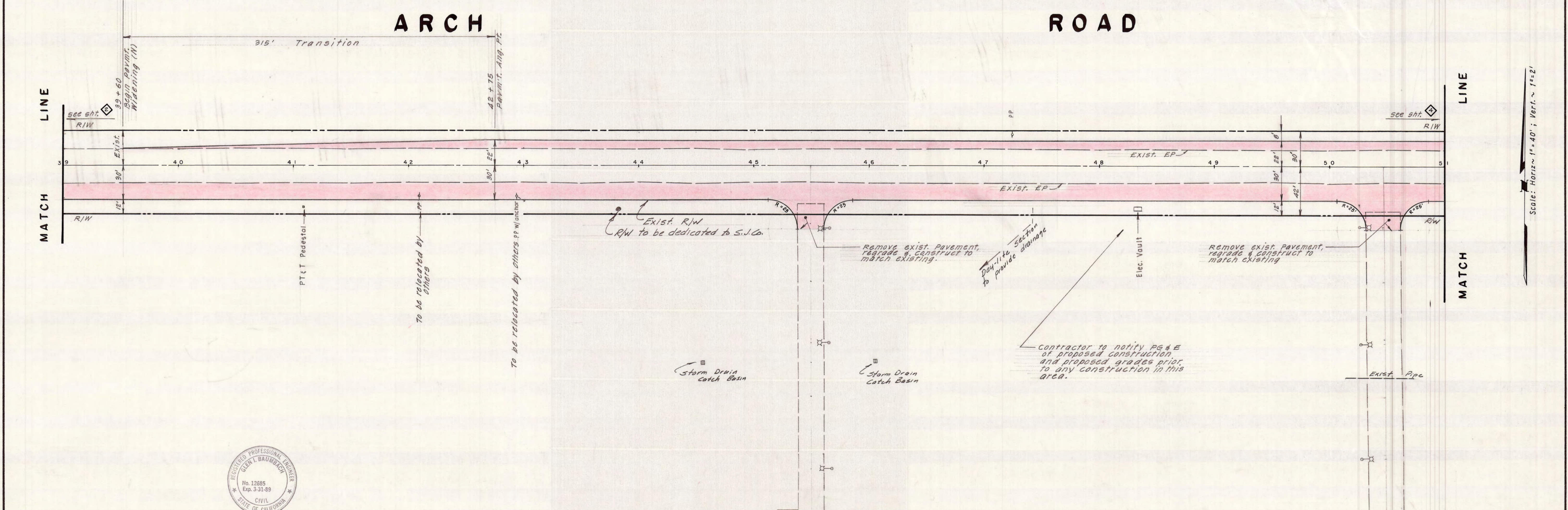
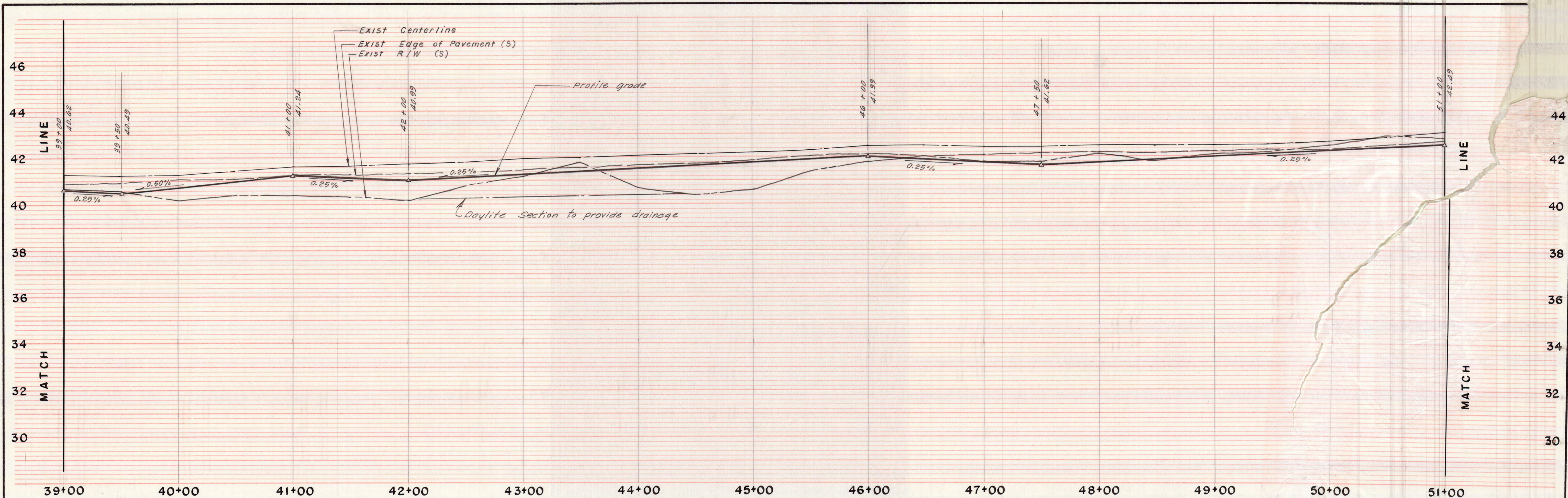

Scale: Horiz ~ 1" = 40'; Vert. ~ 1" = 2'

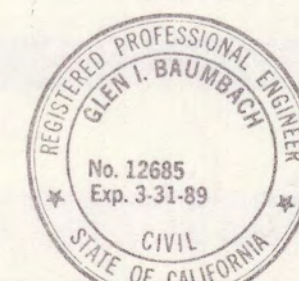

SU-1938A

NO.	DATE	REVISIONS	BY	DESIGN	DRAWN BY	APPROVED BY:	<b>BAUMBACH &amp; PIAZZA</b> CIVIL ENGINEERS SURVEYORS 323 W. ELM ST. LODI, CALIF. 95240 PH: 209-369-6618	PREPARED FOR: KITCHELL CIM 510 J Street Sacramento, Calif. 95814	ARCH ROAD Street Improvements STA 39 + 00 to STA 51 + 00	SHEET 3 OF 11
				SUBMITTED BY <i>Glen L. Baumbach</i> R.C.E. 12685 DATE 4/2/87	19____ SAN JOAQUIN COUNTY DIRECTOR OF PUBLIC WORKS	JOB NO. 8735 FILE NO. G-834				



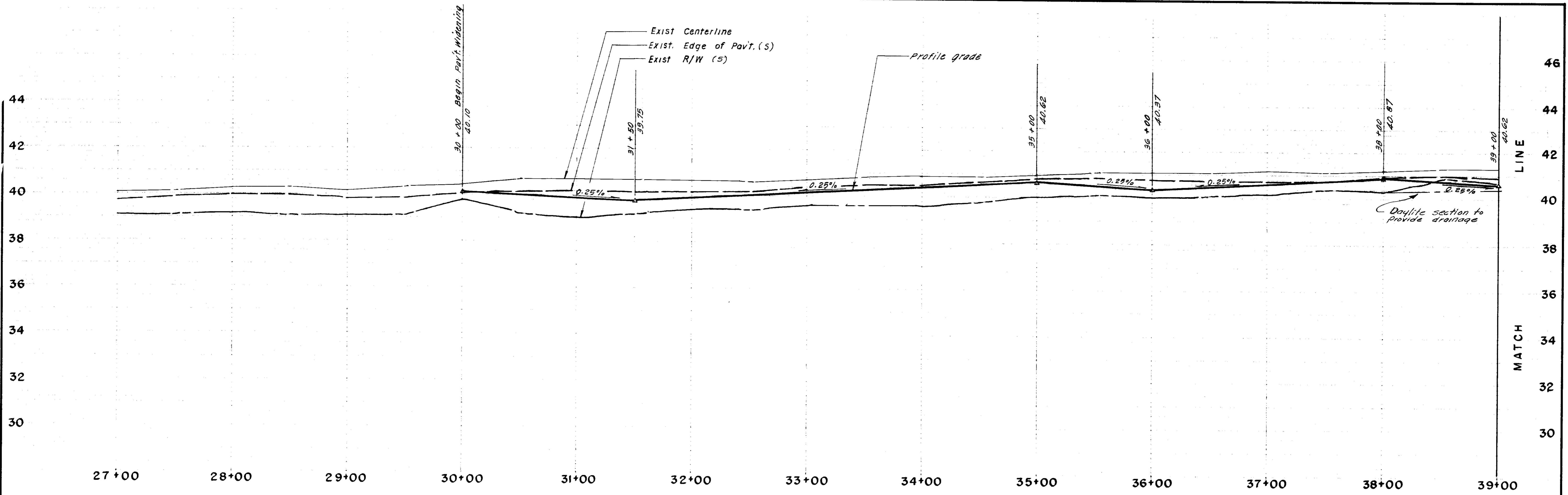

**ARCH ROAD**

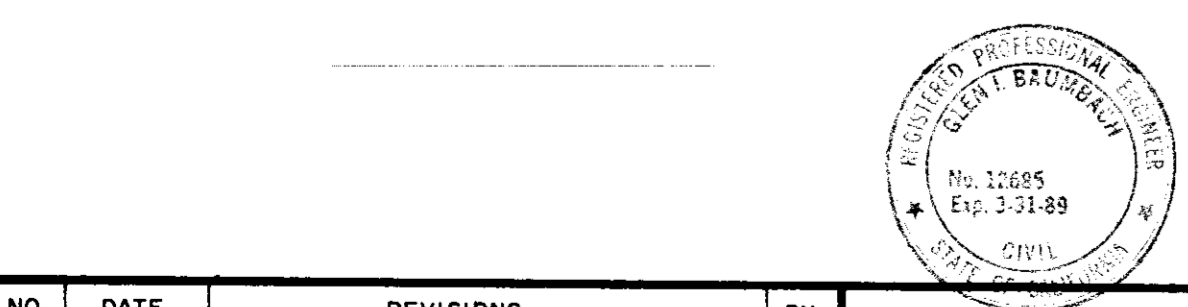
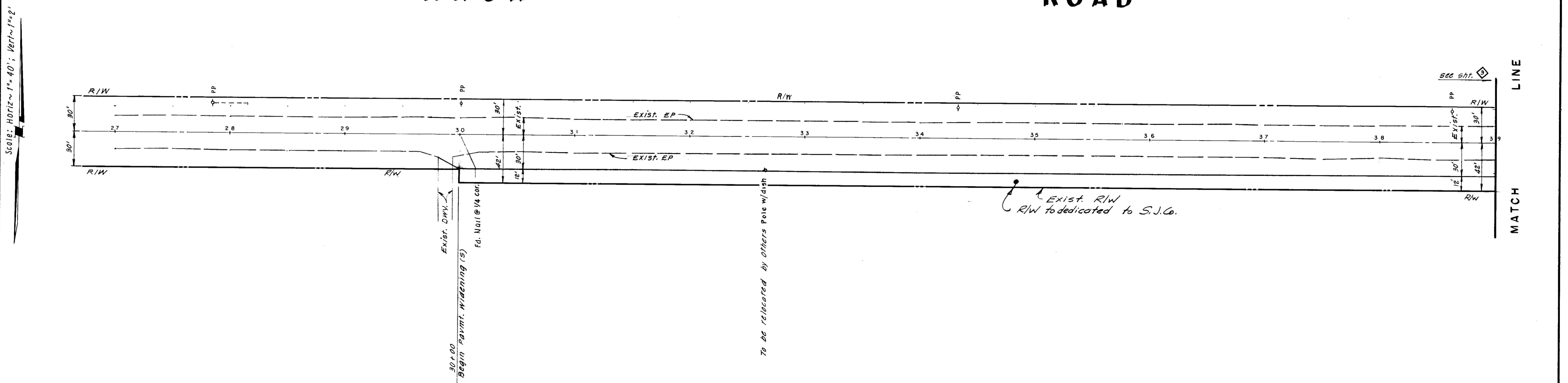

NO.	DATE	REVISIONS	BY	DESIGN	DRAWN BY
				Alan J. Baumbach	
				Submitted by	
				R.C.E. 12685	DATE 6/2/87

APPROVED BY: \_\_\_\_\_, 19\_\_  
 SAN JOAQUIN COUNTY DIRECTOR OF PUBLIC WORKS

**BAUMBACH & PIAZZA**  
 CIVIL ENGINEERS  
 SURVEYORS  
 323 W. ELM ST. LODI, CALIF.  
 95240 PH: 209-368-6818

PREPARED FOR:  
 KITCHELL CEM  
 510 J Street  
 Sacramento, Calif.  
 95814

ARCH ROAD  
 Street Improvements  
 STA 30 + 00 to STA 39 + 00

SU-1939

# ARCH ROAD

## IMPROVEMENT PLANS

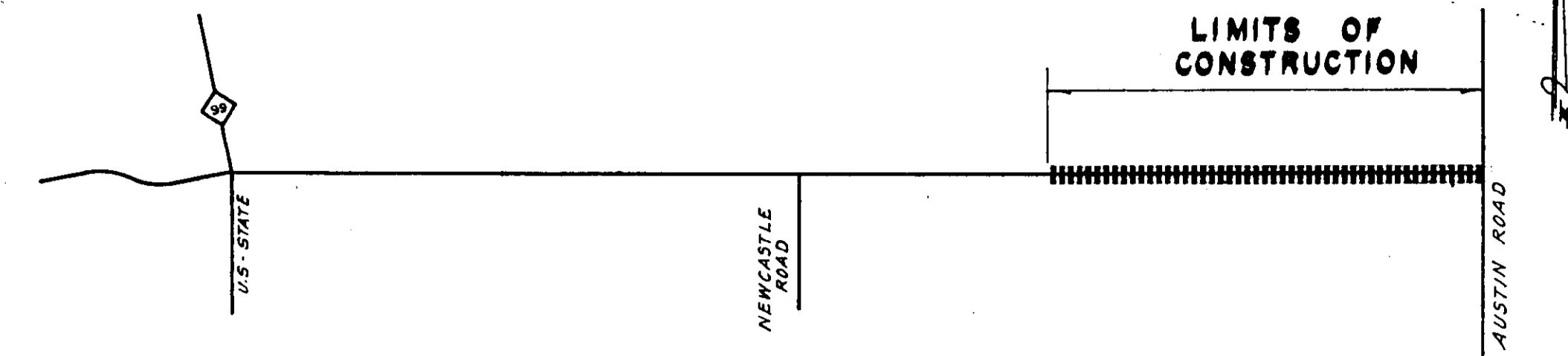

ARCH ROAD  
VICINITY MAP



### CONSTRUCTION QUANTITIES

(FOR ESTIMATING PURPOSES ONLY)

1. CLEARING & GRUBBING	LUMP SUM
2. EARTHWORK	LUMP SUM
3. COMPACT SUBGRADE	74,000 S.F.
4. AGGREGATE BASE, C.I. II	74,000 S.F.
5. ASPHALT CONCRETE, TYPE "B" (2" OVERLAY)	72,800 S.F.
6. ASPHALT CONCRETE, TYPE "B" (4")	56,000 S.F.
7. AGGREGATE SUBBASE	LUMP SUM
8. 10" C.M.P. & DITCH RELOCATION	LUMP SUM
9. TRAFFIC STRIPING	LUMP SUM
10. TRAFFIC SIGNS	LUMP SUM

### GENERAL NOTES

- All work shall conform to these plans and any special provisions for this project.
- Contractor shall receive an approved set of plans prior to beginning construction.
- The Contractor shall take precautionary measures to protect existing underground utilities. The Contractor shall do no excavation until all utility agencies have been given the opportunity to mark their facilities in the field.
- Water used in any phase of construction, such as backfill compaction, dust control, testing or other work herein required, shall be included in the unit price or lump sum bid for the respective item of construction.
- Contractor agrees that he shall assume sole and complete responsibility for job site conditions during the course of construction of this project, including safety for all persons and property; that this requirement shall apply continuously and not be limited to normal working hours, and that Contractor shall defend, indemnify, and hold the Owner and the Engineer harmless from any and all liability, real or alleged, in connection with the performance of work on this project, excepting for liability arising from the sole negligence of the Owner or the Engineer.
- Contractor shall give Engineer a minimum of 48 hours notification prior to staking any utilities.
- All work will be required to be inspected by the Department of Public Works. They shall be notified not less than 24 hours in advance of commencement of work.
- Any traffic striping, legend and signs damaged during construction are to be replaced by the Contractor.
- It is agreed that field conditions may require changes to these plans. It is further agreed that the Director of Public Works may require changes, alterations or additions to these plans, when the Director deems them to be necessary or desirable for the proper completion of the work, provided that such changes, alterations or additions shall not exceed 10% of the original estimate of the cost for the improvements without prior approval of the surety.
- An Encroachment Permit is required for work within Arch Road right-of-way.

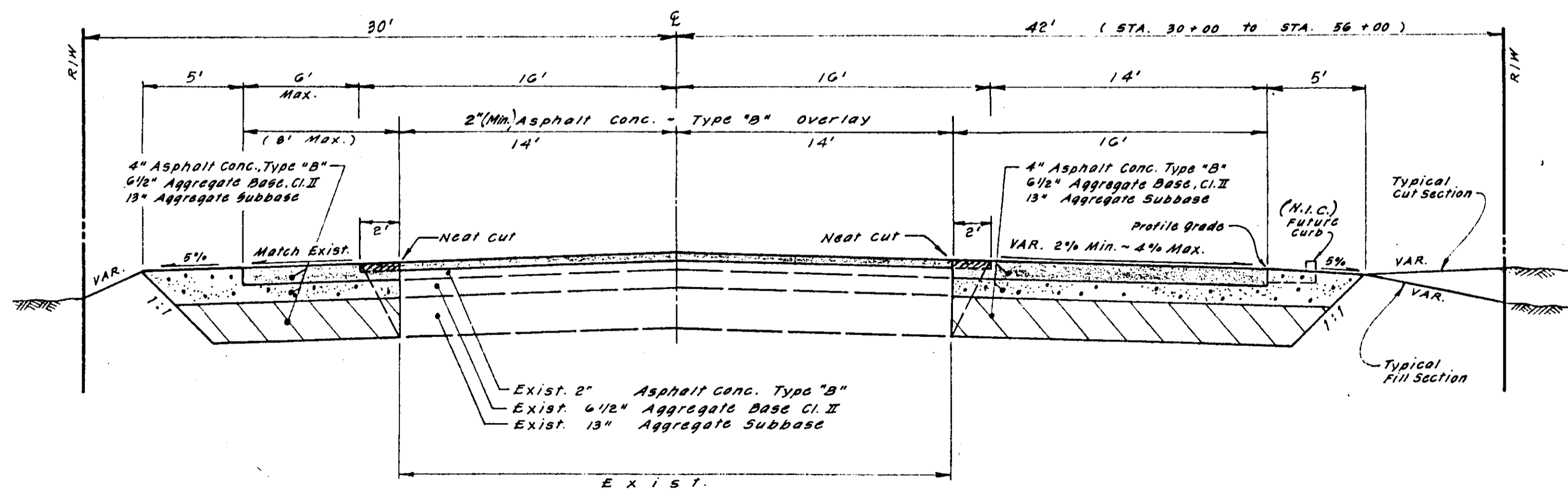

### STRUCTURAL SECTION

TYPICAL Scale: Hor. 1" = 5'

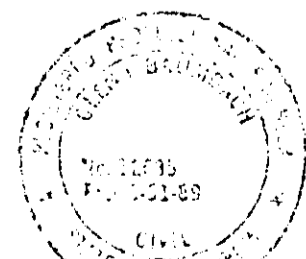

NO.	DATE	REVISIONS	BY	DESIGN	DRAWN BY	APPROVED BY	
				Steven L. Baumbach		July 17, 1987	
				Submitted by	Henry M. Hirata		
				R.C.E. 12685	DATE 6/3/87		

**BAUMBACH & PIAZZA**  
CIVIL ENGINEERS  
SURVEYORS  
323 W. ELM ST. LODI, CALIF.  
95240 PH: 909-958-8818

PREPARED FOR:  
KITCHELL CIM  
510 J Street  
Sacramento, Calif.  
95814

**ARCH ROAD**  
IMPROVEMENT PLANS  
**KEY SHEET**

SHEET 1 of 11  
JOB NO. 8795  
FILE NO. G-834

1940