

SECTION A-A
DRIVEWAY D

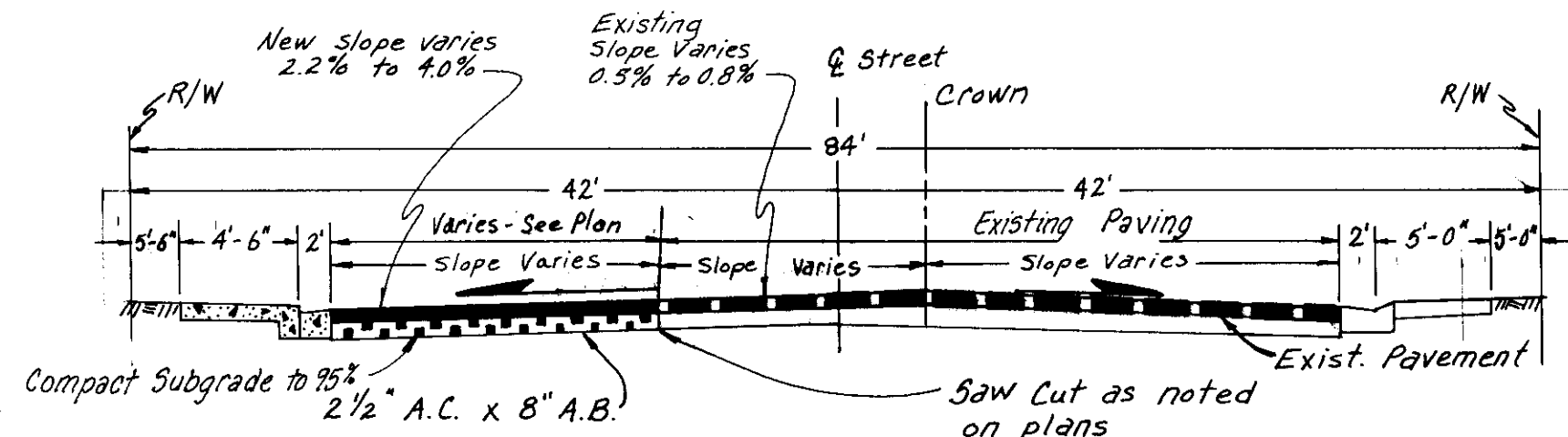

TYPICAL SECTION - J STREET
T.I. 6.0, R.V. = 40
Scale 1\"/>

GENERAL NOTES AND SPECIFICATIONS

- ALL IMPROVEMENTS SHALL BE CONSTRUCTED IN STRICT ACCORDANCE WITH THE SAN JOAQUIN COUNTY IMPROVEMENT SPECIFICATIONS AND THE LATEST EDITION OF THE STATE OF CALIFORNIA, DEPARTMENT OF TRANSPORTATION STANDARD SPECIFICATIONS AND PLANS.
- ELEVATIONS ARE REFERRED TO NGVD DATUM.
- THE CONTRACTOR SHALL BE RESPONSIBLE FOR PROTECTING FROM DAMAGE ALL EXISTING IMPROVEMENTS THAT ARE TO REMAIN. SUCH IMPROVEMENTS THAT ARE DAMAGED BY THE CONTRACTOR, SHALL BE REPLACED AT HIS EXPENSE.
- CONTRACTOR SHALL DEMOLISH, EXCAVATE, REMOVE AND DISPOSE OF ALL EXISTING CONCRETE OR ASPHALT CONCRETE PAVING, CONCRETE CURB, PIPE AND DELETERIOUS MATERIAL AS REQUIRED TO CONSTRUCT THE CONTRACT WORK. ALL EXCESS MATERIAL GENERATED BY DEMOLITION, EXCAVATION AND GRADING SHALL BE DISPOSED OF BY THE CONTRACTOR.
- THE PRICE BID FOR THIS WORK SHALL INCLUDE THE COST FOR ANY AND ALL PERMITS REQUIRED TO COMPLETE THE PROJECT WORK.
- CONTRACTOR SHALL OBTAIN AN ENCROACHMENT PERMIT FROM THE SAN JOAQUIN COUNTY PUBLIC WORKS DEPARTMENT (ACTING ON BEHALF OF THE CITY OF LATHROP), AND NOTIFY ENGINEER 24 HOURS IN ADVANCE OF STARTING ANY WORK REQUIRED BY THE PLANS.
- WORK IN STREET RIGHT-OF-WAY IS SUBJECT TO THE APPROVAL AND ACCEPTANCE OF THE SAN JOAQUIN COUNTY PUBLIC WORKS DEPARTMENT (ACTING ON BEHALF OF THE CITY OF LATHROP).
- PRIOR TO COMMENCING ANY WORK, IT SHALL BE THE CONTRACTOR'S RESPONSIBILITY TO HAVE EACH UTILITY COMPANY LOCATE IN THE FIELD THEIR MAIN AND SERVICE LINES. THE CONTRACTOR SHALL NOTIFY MEMBERS OF THE UNDERGROUND SERVICE ALERT (U.S.A.) 48 HOURS IN ADVANCE OF PERFORMING EXCAVATION WORK BY CALLING THE TOLL-FREE NUMBER 800-642-2444.
- THE CONTRACTOR SHALL CHECK WITH THE UTILITY COMPANIES AND VERIFY ALL UTILITY LOCATIONS. IT SHALL BE THE CONTRACTOR'S SOLE RESPONSIBILITY TO PROTECT ALL EXISTING UTILITIES SO THAT NO DAMAGE RESULTS TO THEM DURING THE PERFORMANCE OF HIS CONTRACT. THE CONTRACTOR SHALL BE REQUIRED TO COOPERATE WITH OTHER CONTRACTORS AND UTILITY COMPANIES INSTALLING NEW STRUCTURES UTILITIES AND SERVICES TO THE DEVELOPMENT.
- WHENEVER PAVEMENT IS BROKEN OR CUT IN THE INSTALLATION OF THE WORK COVERED BY THESE SPECIFICATIONS, THE PAVEMENT SHALL BE REPLACED, AFTER PROPER BACKFILLING, WITH PAVEMENT MATERIALS EQUAL TO OR BETTER THAN THE MATERIALS USED IN THE ORIGINAL PAVING. THE FINISHED PAVEMENT SHALL BE SUBJECT TO THE APPROVAL OF THE CITY ENGINEER.
- PAYMENT FOR PAVEMENT WILL BE MADE ONLY FOR AREAS SHOWN ON PLANS. REPLACEMENT OF PAVEMENT WHICH IS BROKEN OR CUT IN THE INSTALLATION OF THE WORK COVERED BY THESE SPECIFICATIONS, AND WHICH LIES OUTSIDE OF SAID AREAS, SHALL BE INCLUDED IN THE STREET CONTRACTOR'S UNIT PRICE FOR PAVEMENT, AND NO ADDITIONAL PAYMENT SHALL BE MADE FOR SUCH WORK.
- CONTRACTOR AGREES THAT HE SHALL ASSUME SOLE AND COMPLETE RESPONSIBILITY FOR JOBSITE CONDITIONS DURING THE COURSE OF CONSTRUCTION OF THIS PROJECT, INCLUDING SAFETY OF ALL PERSONS AND PROPERTY, THAT THIS REQUIREMENT SHALL APPLY CONTINUOUSLY AND NOT BE LIMITED TO NORMAL WORKING HOURS, AND THAT THE CONTRACTOR SHALL DEFEND, INDEMNIFY AND HOLD THE OWNER AND THE ENGINEER HARMLESS FROM ANY AND ALL LIABILITY, REAL OR ALLEGED, IN CONNECTION WITH THE PERFORMANCE OF WORK ON THIS PROJECT, EXCEPTING FOR LIABILITY ARISING FROM THE SOLE NEGLIGENCE OF THE OWNER OR THE ENGINEER.
- EXISTING UTILITIES ARE SHOWN AS THEY ARE BELIEVE TO EXIST. THE OWNER AND THE ENGINEER DO NOT ACCEPT RESPONSIBILITY FOR THEIR ACCURACY. PRIOR TO COMMENCING ANY WORK, THE CONTRACTOR SHALL HAVE EACH UTILITY COMPANY ACCURATELY LOCATE IN THE FIELD THEIR MAINS AND SERVICE LINES. IT SHALL BE THE CONTRACTOR'S SOLE RESPONSIBILITY TO PROTECT ALL EXISTING UTILITIES, SO THAT NO DAMAGE RESULTS TO THEM DURING THE PERFORMANCE OF HIS CONTRACT. (CONTACT "USA" 800-642-2444).
- CONSTRUCTION STAKING: CONSTRUCTION STAKING IS NORMALLY PERFORMED BY THE ENGINEER WHO PREPARED THE PLAN. THIS PERMITS APPROPRIATE ON-SITE INTERPRETATION AND ADJUSTMENT OF THE PLANS, IF NECESSARY.

THIS NOTE GIVES FORMAL NOTICE THAT THE FIRM OF R. W. SIEGFRIED & ASSOCIATES CANNOT, AND WILL NOT, TAKE RESPONSIBILITY FOR ERRORS OR OMISSIONS, IF ANY, WHICH MIGHT OCCUR AND WHICH COULD HAVE BEEN AVOIDED OR DETECTED AND/OR CORRECTED OR MITIGATED HAD R. W. SIEGFRIED & ASSOCIATES PERFORMED THE CONTRACTION STAKING WORK.

- ALL REFERENCES TO CONTRACTOR SHALL MEAN SUB-CONTRACTOR AWARDED THE CONTRACT FOR SITEWORK.
- ALL SURPLUS EXCAVATED MATERIALS SHALL BE DISPOSED OF OFF THE PROJECT SITE AT THE CONTRACTOR'S EXPENSE.
- CONTRACTOR AGREES THAT HE SHALL ASSUME SOLE AND COMPLETE RESPONSIBILITY FOR JOB SITE CONDITIONS DURING THE COURSE OF CONSTRUCTION OF THIS PROJECT, INCLUDING SAFETY OF ALL PERSONS AND PROPERTY; THAT THIS REQUIREMENT SHALL APPLY CONTINUOUSLY AND NOT BE LIMITED TO NORMAL WORKING HOURS; AND THAT THE CONTRACTOR SHALL DEFEND, INDEMNIFY AND HOLD HARMLESS, THE COUNTY OF SAN JOAQUIN AND CITY OF LATHROP, THEIR ELECTED OFFICIALS, OFFICERS, EMPLOYEES, AND AGENTS FROM ANY AND ALL CLAIMS, COSTS OF LITIGATION, DAMAGES, AND ATTORNEY'S FEES, FOR PERSONAL INJURY OR PROPERTY DAMAGE OF WHATEVER NATURE WHICH ARE CLAIMED TO HAVE OCCURRED DURING THE TERM OF THIS PROJECT.

STANDARD SPECIFICATIONS

SECTION 1

1-1 GENERAL.--Unless otherwise stated herein or modified below, all sections of the Standard Specifications of the State of California, Department of Transportation dated January, 1981, or revised thereafter, shall apply. The only section or portions of sections of the State Standard Specifications that shall not apply are those portions that make reference to measurement and payment.

Coordination and interpretation of plans, Standard Specification and Special provisions shall conform to the provisions of Section 5-1.04 of the Standard Specifications.

Whenever in the Standard Specifications, special provisions, Notice to Contractors, proposal, contract or other contract documents the following terms are used, the intent and meaning shall be interpreted as follows:

State, or County	County of San Joaquin
Department	County of San Joaquin
Director	Board of Supervisors
	County of San Joaquin

Department of Transportation	Department of Public Works, County of San Joaquin
State of California	County of San Joaquin
Engineer and Deputy Director	the Director of Public Works, County of San Joaquin acting either directly or through properly authorized agent and consultants
Department of Transportation for Project Development and Construction	

NOTE: San Joaquin County is acting on behalf of the City of Lathrop to provide plan check, permit and inspection services. The improvements will be accepted by the City Council of the City of Lathrop.

SECTION 16

16-1 CLEARING AND GRUBBING (MINOR).--Clearing and grubbing shall conform to the requirements in Section 16, "Clearing and Grubbing", of the Standard Specifications and these special provisions.

All shade and ornamental trees shall be preserved unless otherwise designated on the plans or marked for removal.

Plants and lawn in front of residences shall be preserved adjacent to new shoulder construction where natural ground surface and finished grade are compatible, unless otherwise designated on the plans, and as directed by the Engineer.

Tree trimming will be required only where it is necessary to clear construction equipment unless otherwise shown on the plans.

Existing tree stumps inside limits of work shall be removed to a point one foot (1.0') below finished grade, unless otherwise shown on plans. Tree roots that interfere with construction shall be cut off in a workmanlike manner.

Grass and weeds may be thoroughly incorporated with the native soil by disking or other means. Materials containing grass and weeds shall be used outside the paved portion of the roadway.

Burning will be permitted when done in conformance with "Air Pollution Control" of the General Provisions.

SECTION 19

19-1 EARTHWORK.--Earthwork shall conform to the requirements in Section 19, "Earthwork", of the Standard Specifications and these special provisions.

The requirement of the second paragraph of Section 19-5.03 will be required only in those areas shown on the plan.

In lieu of the tolerance specified in Section 19-1.03(a) of the Standard Specifications, the surface of the grading plane shall not be more than 0.05 foot above or below the grade established by the Engineer.

Before grade is approved by the Engineer all earthwork (including driveways and slopes) shall be compacted to grade. Unless otherwise shown on the plans, all surplus materials not to be salvaged, stockpiled or disposed of as provided in Section 19-2.06 shall become the property of the Contractor and disposed of as provided in Section 7-1.13 of the Standard Specifications.

Unless otherwise shown on the plans, the existing pavement, when used as embankment, shall be broken up into pieces not larger than 0.33 foot in greatest dimension.

SECTION 26

26-1 AGGREGATE BASE.--Aggregate base shall conform to the requirements in Section 26, "Aggregate Bases", of the Standard Specifications and these special provisions.

Aggregate Base shall be Class 2.

The combined aggregate shall conform to the grading specified for the 3/4-inch maximum aggregate.

The R-Value requirement may be waived provided the individual test result of the aggregate base conforms to the specified grading and durability and has a sand equivalent value of 33 or more.

SECTION 39

39-1 ASPHALT CONCRETE.--Asphalt Concrete shall conform to the requirements in Section 39, "Asphalt Concrete", of the Standard Specifications and these special provisions.

Asphalt concrete shall be Type "B". Aggregate shall conform to the 1/2-inch maximum, coarse or medium grading as determined by the Engineer. At the contractors option, and with approval of the Engineer, aggregate may be 3/4-inch maximum, medium grading with the exception of the final finish course.

Aggregate conforming to the 3/8-inch maximum grading will be permitted for use in driveways, dikes and other areas with approval of the Engineer.

The amount of asphalt binder to be mixed with the aggregate shall be between 5 percent and 7 percent by weight of the dry aggregate. The exact amount of asphalt binder to be mixed with the aggregate and the AR viscosity grade of the asphalt binder will be determined by the Engineer.

Paint binder shall be applied at a rate of approximately 0.05 gallon per square yard, unless otherwise shown on the plans.

When the asphalt concrete is to be produced in a batch plant, the asphalt concrete shall be proportioned and mixed by the automatic method.

All steel-tired rollers shall be of the tandem type.

When shown in the Engineer's Estimate prime coat liquid asphalt penetration grade shall be SC 70 or SC 250 as directed by the Engineer.

The dumping of material in a windrow, in accordance with Section 39-5.01, shall be limited to 750 feet in advance of the paving machine, unless otherwise permitted by the Engineer.

Unless otherwise shown on the plans, asphalt paver equipment used to place asphalt concrete shall be equipped with full automatic screed and grade sensing controls which shall control the longitudinal grade and transverse slope of the screed. The controls shall be actuated by grade and slope references. Corrections on account of deviations from the references shall be automatic. Guides and references required to control the longitudinal grade and transverse slopes shall be furnished and installed by the Contractor.

Should the contractor elect to use a ski device sensing from subgrade for longitudinal control, the minimum length of the device shall be 30 feet. The device shall be a rigid unit mounted on multiple supports. Each support shall act independently of others and the finished grade shall not be affected by the action of a single support.

SECTION 52

52-1 REINFORCEMENT.--Reinforcement shall conform to the requirements in Section 52, "Reinforcement", of the Standard Specifications.

SECTION 73

73-1 CONCRETE CURBS & SIDEWALKS.--Concrete curbs and sidewalks shall conform to the requirements in Section 73, "Concrete Curbs and Sidewalks", of the Standard Specifications and these special provisions.

In lieu of the requirements of Section 73-1.05, weakened plane joints shall be constructed at 12-foot maximum intervals on tangent sections and at a minimum of one-third points on radii.

The driveway construction at back of curb shall be poured monolithic with the curb and gutter or shall conform to one of the following alternatives:

- Dowels (5/8 inch diameter by 24 inches long) spaced at 4-foot intervals.
- Keyway constructed 2 inches in height and one inch in depth.

A uniform color shall be maintained by the addition of one pound of lamp black per cubic yard of concrete. Sidewalk and driveway aprons providing access to private property that are constructed behind new sidewalk shall be colored and textured as required to match existing improvements.

All concrete gutters shall be water tested for drainage before acceptance. The maximum deviation from a true grade shall not result in ponding water for a depth exceeding 0.02 foot.

Ground area to be used for landscaping purposes, which has been excavated or is below finished grade shall be backfilled with selected material or imported topsoil free of stones conforming to the provisions of Section 20-2.01, "Topsoil", of the Standard Specifications and these special provisions, unless otherwise shown on the plans.

MONOLITHIC CURB, GUTTER, & SIDEWALK

- NOTES:
- Construct expansion joints @ 200' maximum and at returns, around light poles, hydrants and other fixed objects at sidewalk.
 - Transverse weakened plane joints shall be spaced @ 12' maximum intervals.

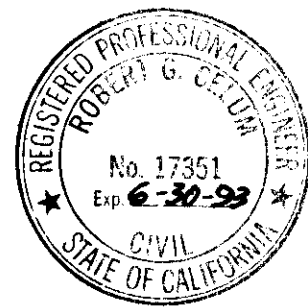

R. W. SIEGFRIED & ASSOCIATES
CONSULTING CIVIL ENGINEERS

Robert P. Selum

17351

6-30-93

5453-8
JAN 1990
606
BCD
SRT
SRT

SAN JOAQUIN COGEN
"J" STREET PAVING WIDENING
LATHROP, CALIFORNIA

2
TWO
G-3915

LEGEND

	Existing Paving
	New Paving
	Existing C.G. & S.W.
	New C.G. & S.W.
	Top of Curb Elev.
	Street Right-of-Way
	Elev. Existing Paving or Ground

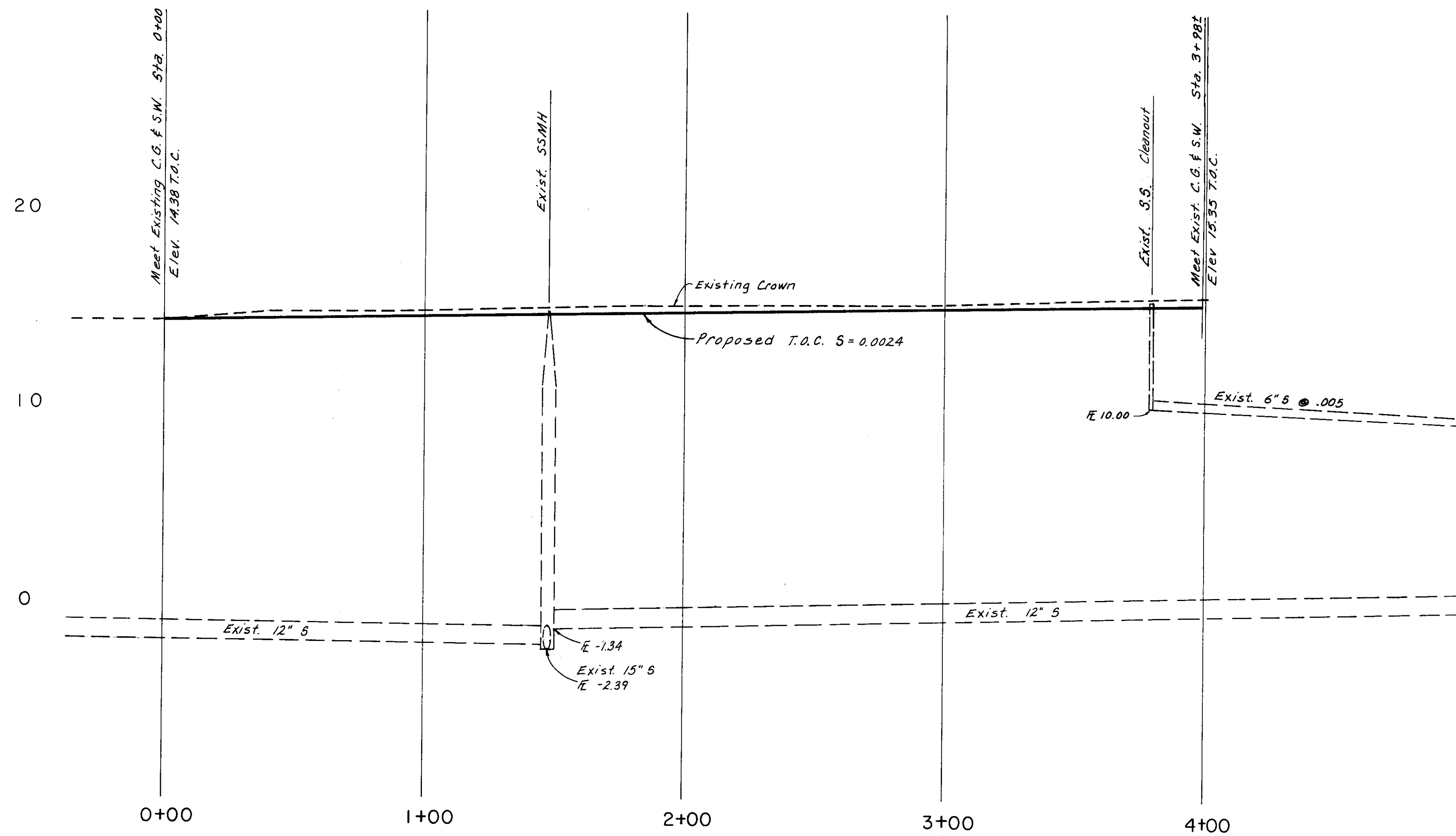

BENCH MARK
Chiseled "D" on T.O.C. In Front
of 719 J Street
ELEV. = 14.75

SCALE: Horiz. 1" = 30'
Vert. 1" = 4'

"J" STREET

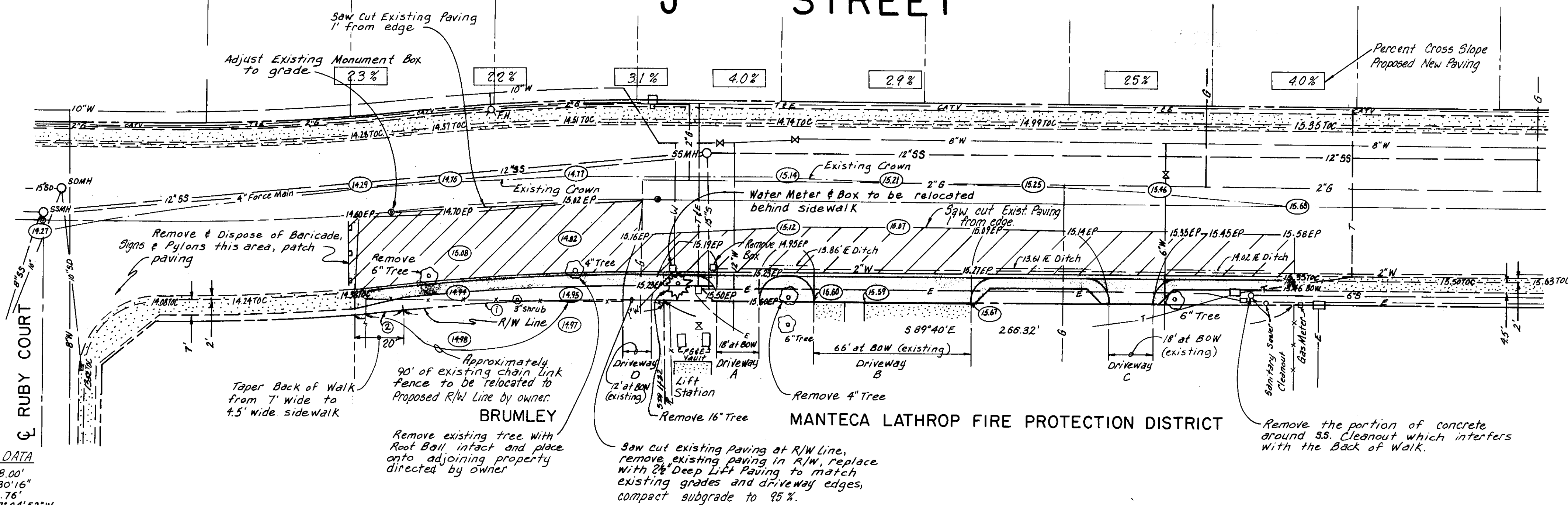
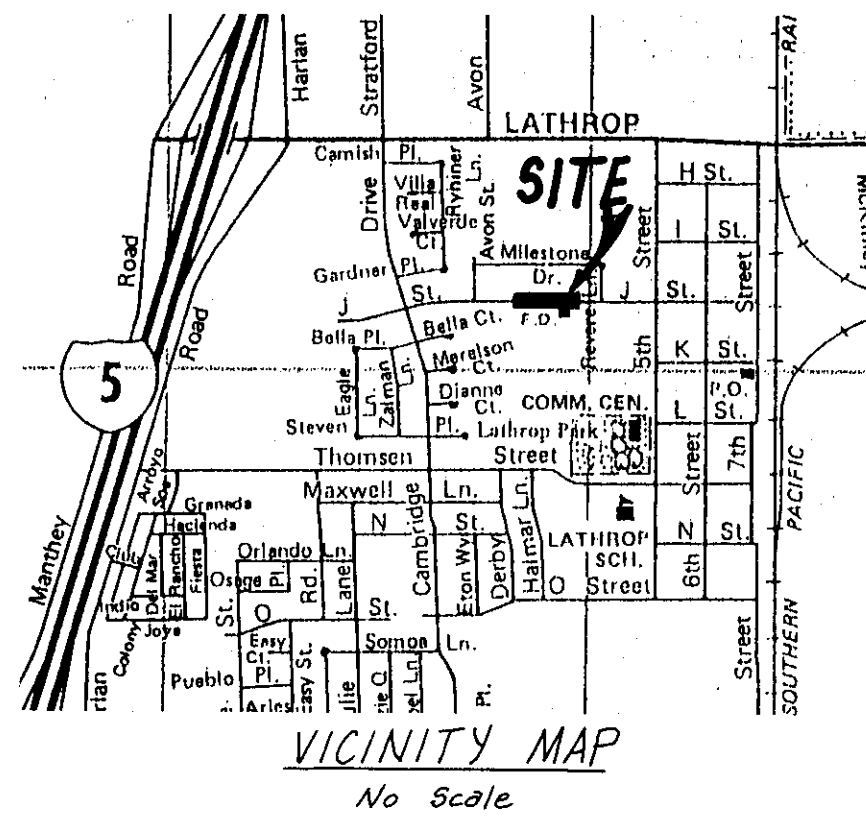

CURVE DATA

- R = 958.00'
Δ = 6° 30' 16"
L = 108.76'
Ch = 587° 04' 52" W
108.70'
- R = 1042.00'
Δ = 1° 03' 46"
L = 18.33'
Ch = 584° 21' 37" W
17.35'

NOTE:

INGRESS & EGRESS FROM THE FIREHOUSE MUST BE MAINTAINED AT ALL TIMES.
Contractor shall coordinate with the Manteca-Lathrop Fire Protection District as to the order in which Driveways A, B & C are constructed. The concrete for Driveways A, B, C & D (on the Brumley property) shall use "high early strength cement". Test cylinders shall be taken and tested at 7, 10, 14 days, etc., until a strength of 2500 psi is obtained. No traffic shall be allowed on the driveways until that strength is achieved.

ABBREVIATIONS

- PL Property Line
- FL Flowline
- CL Center Line
- EC End Curve
- BC Begin Curve
- CB Storm Drain Inlet (Catch Basin)
- M.H. Manhole
- C&G Curb & Gutter
- PRC Point of Reverse Curve
- S.W. Sidewalk
- S.S. Sanitary Sewer
- BOW Back of Walk
- S.D. Storm Drain

APPROVED:

Manuel Lopez, City Engineer, City of Lathrop, CA
R.C.E. 28,054 Expires 3-31-90

Robert L. Selum

5453-8
JAN. 1990
606
BCD
SRT
SRT

SAN JOAQUIN COGEN
"J" STREET PAVING WIDENING
LATHROP,
CALIFORNIA

TWO
G-3915