

Burgers

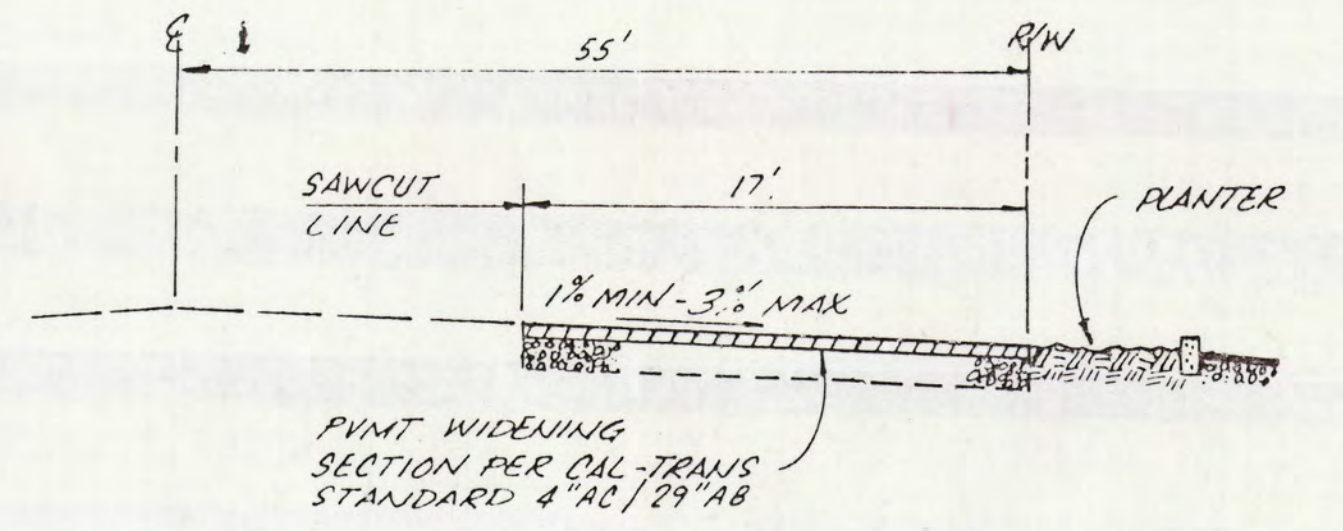

TYPICAL SECTION WATERLOO ROAD

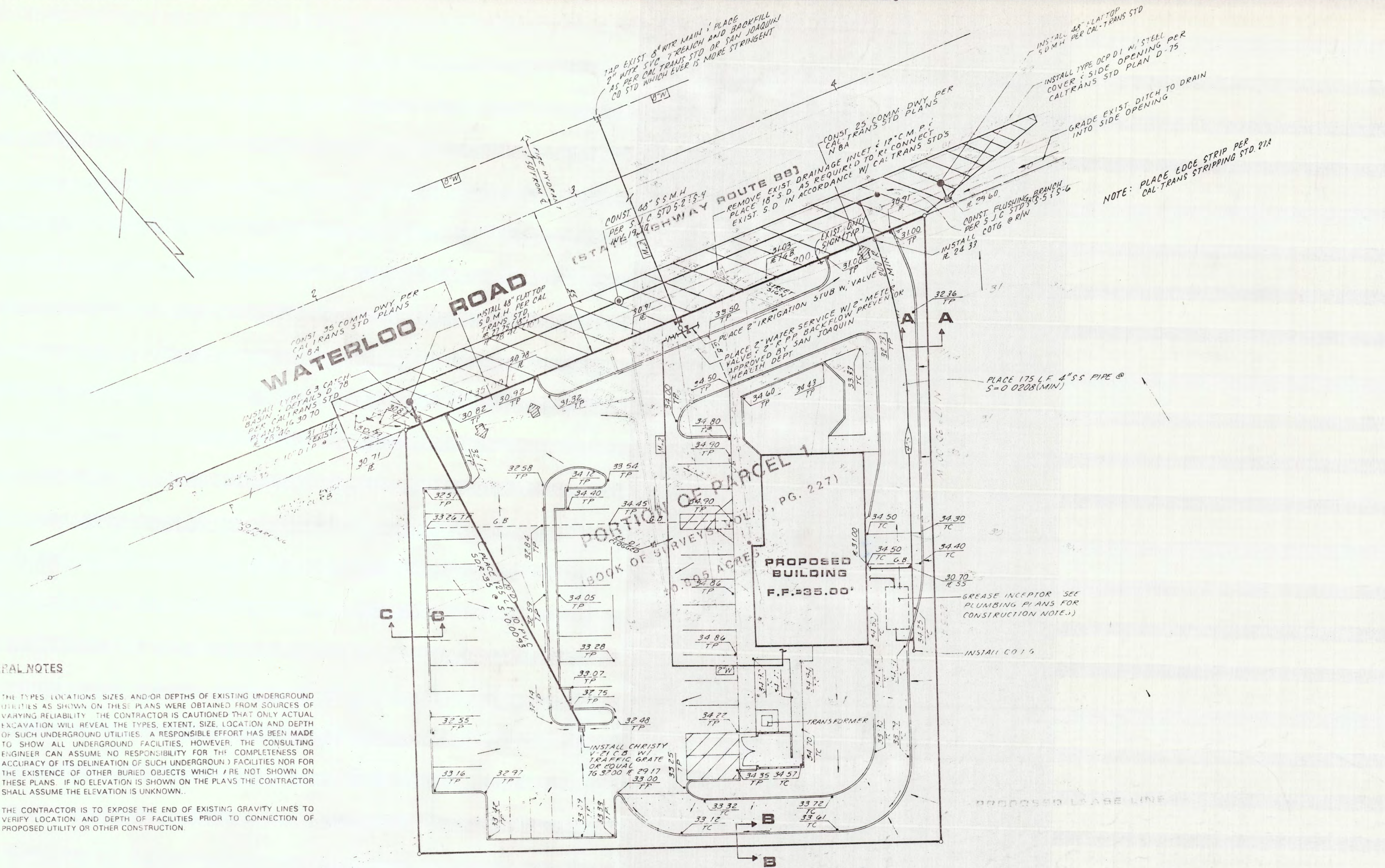
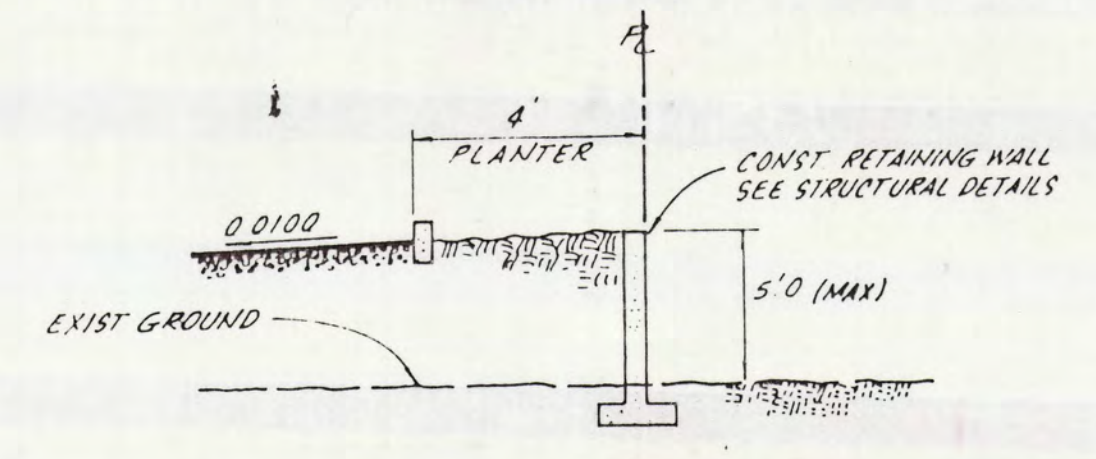

SECTION A-A

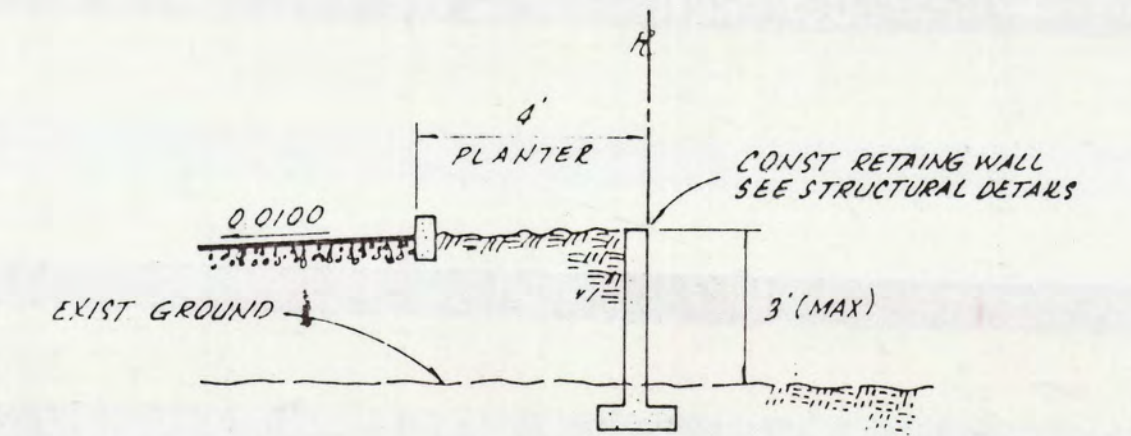

SECTION B-B

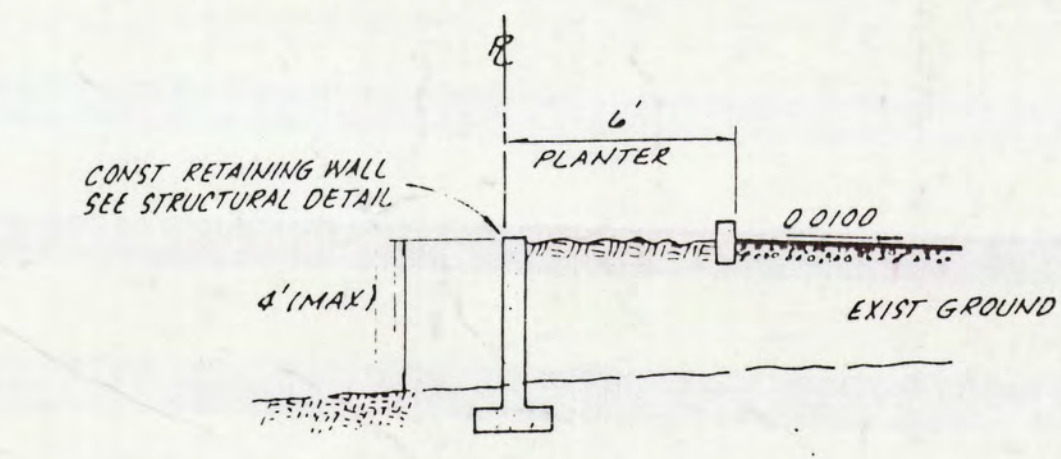

SECTION C-C

GENERAL NOTES

1. THE TYPES, LOCATIONS, SIZES, AND/OR DEPTHS OF EXISTING UNDERGROUND UTILITIES AS SHOWN ON THESE PLANS WERE OBTAINED FROM SOURCES OF VARYING RELIABILITY. THE CONTRACTOR IS CAUTIONED THAT ONLY ACTUAL EXCAVATION WILL REVEAL THE TYPES, EXTENT, SIZE, LOCATION AND DEPTH OF SUCH UNDERGROUND UTILITIES. A RESPONSIBLE EFFORT HAS BEEN MADE TO SHOW ALL UNDERGROUND FACILITIES, HOWEVER, THE CONSULTING ENGINEER CAN ASSUME NO RESPONSIBILITY FOR THE COMPLETENESS OR ACCURACY OF ITS DELINEATION OF SUCH UNDERGROUND FACILITIES NOR FOR THE EXISTENCE OF OTHER BURIED OBJECTS WHICH ARE NOT SHOWN ON THESE PLANS. IF NO ELEVATION IS SHOWN ON THE PLANS THE CONTRACTOR SHALL ASSUME THE ELEVATION IS UNKNOWN.
2. THE CONTRACTOR IS TO EXPOSE THE END OF EXISTING GRAVITY LINES TO VERIFY LOCATION AND DEPTH OF FACILITIES PRIOR TO CONNECTION OF PROPOSED UTILITY OR OTHER CONSTRUCTION.
- 3.
4. THE CONTRACTOR SHALL BE RESPONSIBLE FOR THE PROTECTIONS OF ALL EXISTING SURVEY MONUMENTS AND OTHER SURVEY MARKERS DURING CONSTRUCTION. ALL SUCH MONUMENTS OR MARKERS DESTROYED DURING CONSTRUCTION SHALL BE REPLACED AT THE CONTRACTORS EXPENSE.
5. ALL FILL AREAS ARE TO BE COMPACTED TO THE SOILS ENGINEER AND THE ARCHITECTURAL SPECIFICATION. CONTRACTOR MUST CONTACT DEVELOPER FOR SOILS REPORT AND MUST FOLLOW ALL RECOMMENDATIONS TO AVOID ANY SOIL RELATED PROBLEMS.
6. ASPHALT CONCRETE SURFACE SHALL BE CUT TO A FEET, STRAIGHT LINE PARALLEL WITH THE STREET CENTERLINE AND THE EXPOSED EDGE SHALL BE TACKED WITH EMULSION PRIOR TO PAVING. THE EXPOSED BASE MATERIAL SHALL BE GRADED, RECOMPACTED AND RESEALED PRIOR TO PAVING.
7. WINTERIZATION NOTE: THE FOLLOWING CONDITIONS ARE REQUIRED IF GRADING AND DRAINAGE IMPROVEMENTS ARE INCOMPLETE BETWEEN OCTOBER 1 AND APRIL 15:
 - A. EROSION PROTECTION ON SLOPES 10:1 OR STEEPER AND SWALES WITH SLOPES 2% OR GREATER.
 - B. GRADE GUTTER SAG POINTS TO DRAIN.
 - C. PREVENT SEDIMENTATION IN EXISTING STORM DRAIN SYSTEM AND CLEAN DOWNSIDE PIPES AS REQUIRED BY THE COUNTY.

8. ALL CONSTRUCTION AND MATERIALS SHALL BE IN ACCORDANCE WITH THE LATEST EDITION OF THE COUNTY OF SAN JOAQUIN STANDARD CONSTRUCTION SPECIFICATIONS AND IMPROVEMENT STANDARDS. THE STANDARD DRAWINGS OF THE IMPROVEMENT STANDARDS SHALL SUPERSEDE THOSE OF THE STANDARD CONSTRUCTION SPECIFICATION WHERE DISCREPANCIES EXIST.
9. WHENEVER THE WORK AREA IS ADJACENT TO A TRAFFIC LANE AND THERE IS PAVEMENT CUT, DITCH OR TRENCH OVER 2" DEEP, THE CONTRACTOR SHALL MAINTAIN CONTINUOUS BARRICADES SPACED AT APPROXIMATELY 50 FOOT INTERVALS. IF THE CUT, DITCH OR TRENCH IS MORE THAN 10' FROM A TRAFFIC LANE, THE SPACING MAY BE USED GREATER, BUT NOT EXCEED 200 FEET.
10. GERMAN ENGINEERING IS NOT RESPONSIBLE FOR GRADING, DRAINAGE, OR DIRT QUANTITIES UNLESS CONSTRUCTION STAKING IS PERFORMED BY GERMAN ENGINEERING.
11. EARTH WORK QUANTITIES DO NOT NECESSARILY BALANCE DUE TO CLEARING, GRUBBING, FOOTING SIZE, SLAB SELECTION, AND FILL FACTORS, AN EXACT BALANCE CANNOT BE DETERMINED. THE ENGINEER MAKES NO EXPRESS GUARANTEE AS TO A BALANCED PROJECT IS GIVEN.

Approved For Construction *Challen*

UNAUTHORIZED CHANGES & USES: The engineer preparing these plans will not be responsible for, or liable for, unauthorized changes to or uses of these plans. All changes to the plans must be in writing and must be approved by the preparer of these plans.

California Council of Civil Engineers & Land Surveyors

Construction contractor agrees that in accordance with generally accepted construction practices, construction contractor will be required to assume sole and complete responsibility for job site conditions during the course of construction of the project, including safety of all persons and property; that this requirement shall be made to apply continuously and not be limited to normal working hours, and construction contractor further agrees to defend, indemnify and hold design professional harmless from any and all liability, real or alleged, in connection with the performance of work on this project, excepting liability arising from the sole negligence of design professional.

California Council of Civil Engineers & Land Surveyors

BENCHMARK ELEV. 21.15
DATE OF SURVEY 12/15/04
BY SURVEYOR'S SIGNATURE
ROAD IN SE COR CORN D1 BOX
FIELD BOOK NO. 9109 PG. 32-32



GERMAN ENGINEERING
Civil Engineering
3000 Franklin Blvd.
Sacramento, CA 95818

DESIGNED	CR
DRAWN	KK/HMO
CHECKED	JAG
SUBMITTED	JOHN A. GERMAN RCE EP999

SCALE
1" = 20'

NO	DATE	REVISION	BY

GRADING PLAN
FOR
"BURGER KING ON WATERLOO ROAD"
PORTION APN 101-021-39 & 34
SAN JOAQUIN COUNTY STATE OF CALIFORNIA

DATE 6-18-97
SHEET
C1
OF
C2