

Su 2747

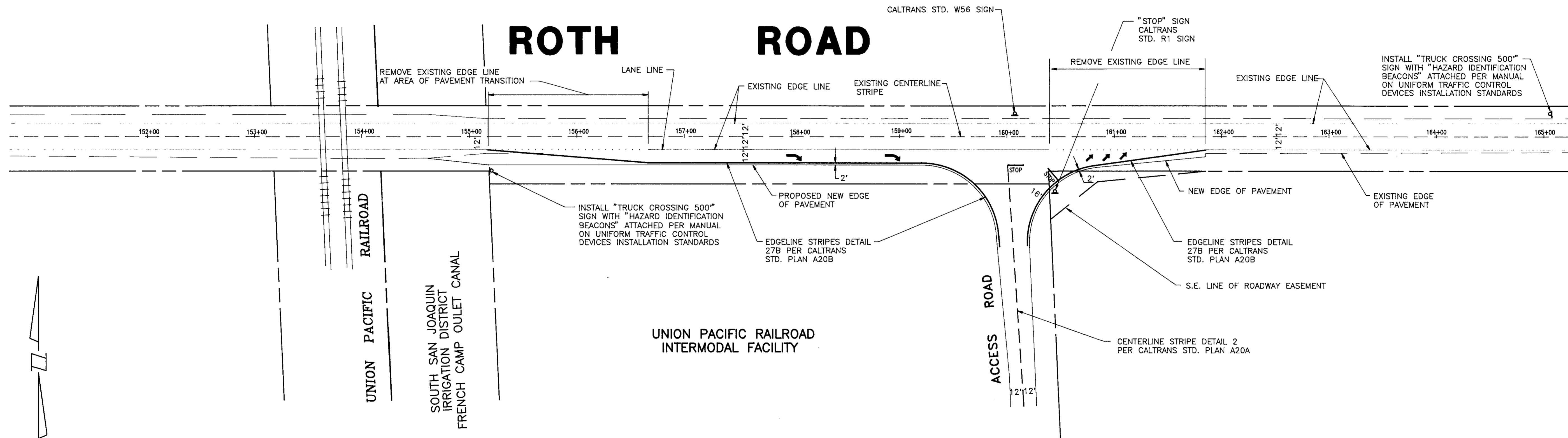

SCALE: 1" = 50'



COUNTY OF SAN JOAQUIN
DEPARTMENT OF PUBLIC WORKS

APPROVED: _____ DATE: _____
R.C.E. NO.: _____ EXP. DATE: _____
DIRECTOR OF PUBLIC WORKS

REVISIONS			
NO.	DESCRIPTION	DATE	BY

SIEGFRIED ENGINEERING, Inc.
Civil Engineering ■ Land Surveying ■ Structural Engineering ■ Planning
4045 Coronado Ave. ■ Stockton, CA 95204-2396 ■ 209 943-2021 ■ FAX 209 942-0214
Job No. 7890-R Submitted By *Robert G. Cellum* R.C.E. No. 17,351 Exp. 6/30/93



SCALE: AS SHOWN
DATE: NOVEMBER, 1993
JOB NO. 7890-R
DRAWN RAC
DESIGN RGC
CHECKED RGC

UNION PACIFIC RAILROAD
ROTH ROAD STREET WIDENING
PAVEMENT DELINEATION PLAN

SHEET
4
OF FOUR
COMPUTER FILE NO.
7890-R04
DRAWING FILE NO.
G-4809

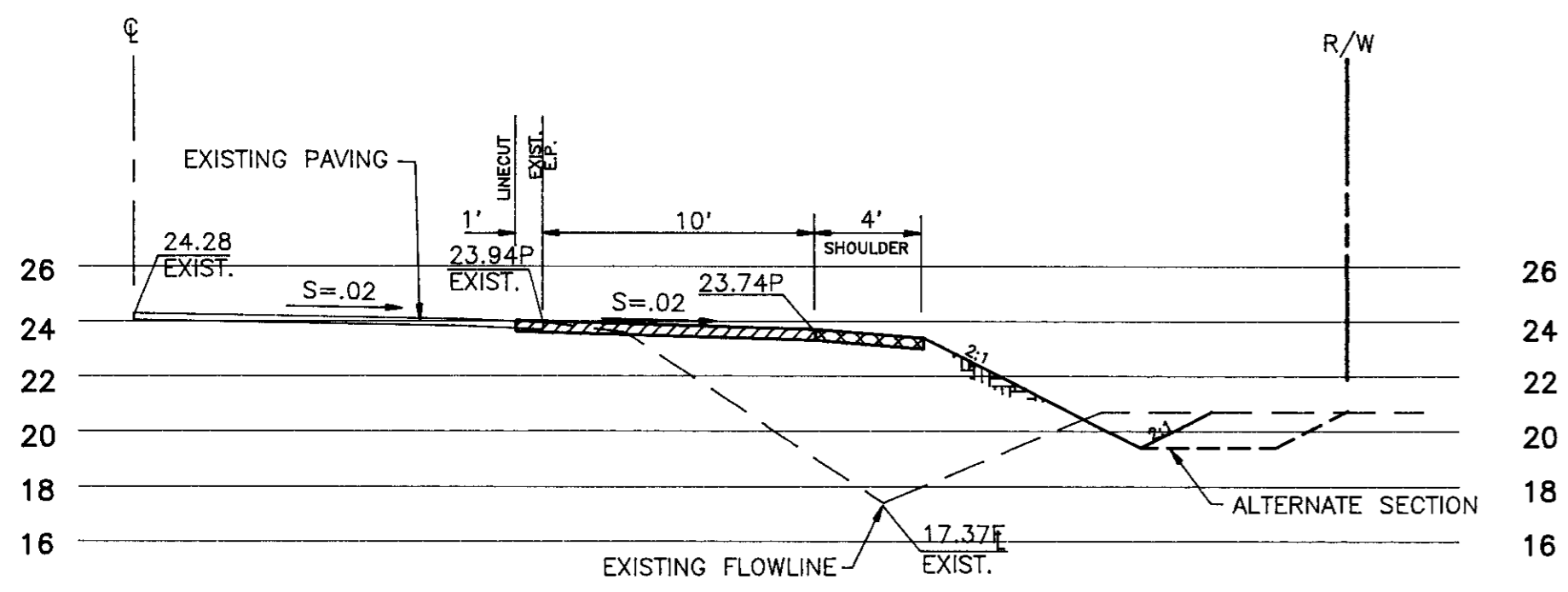

STA. 155+17
SCALE: 1"=6' HORIZ.,VERT.

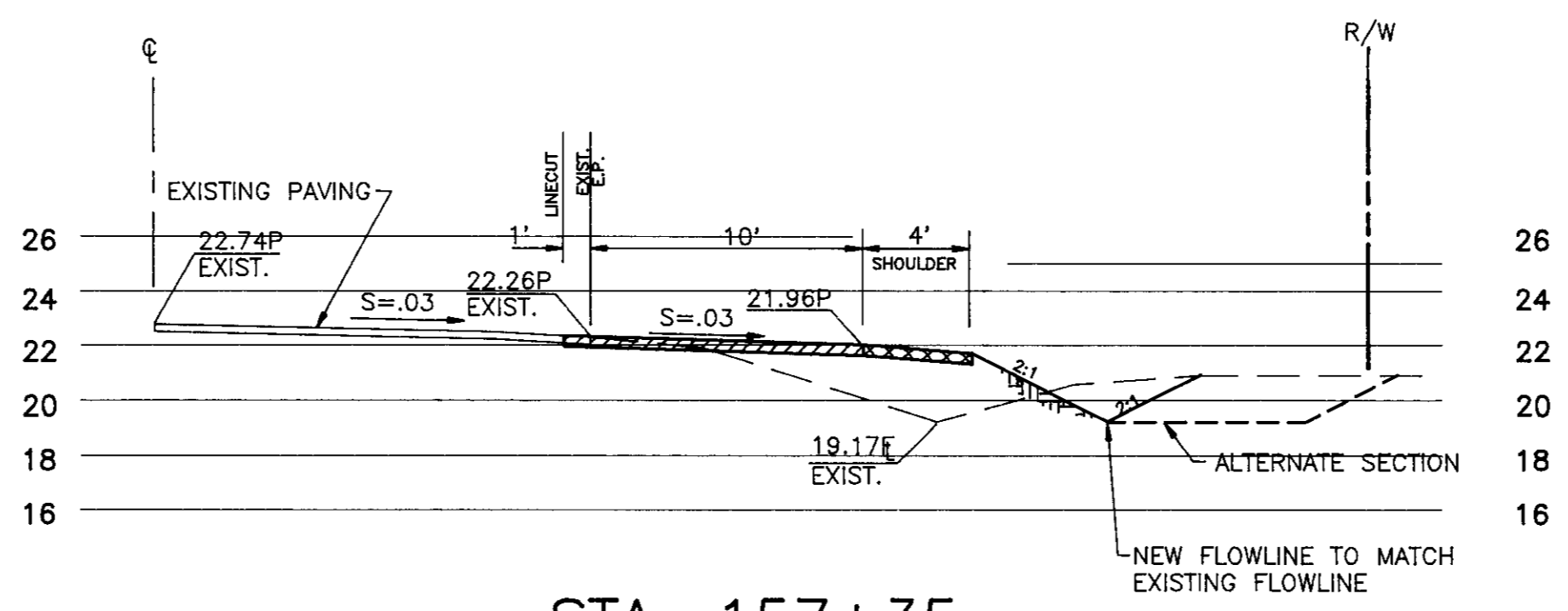

STA. 157+35
SCALE: 1"=6' HORIZ.,VERT.

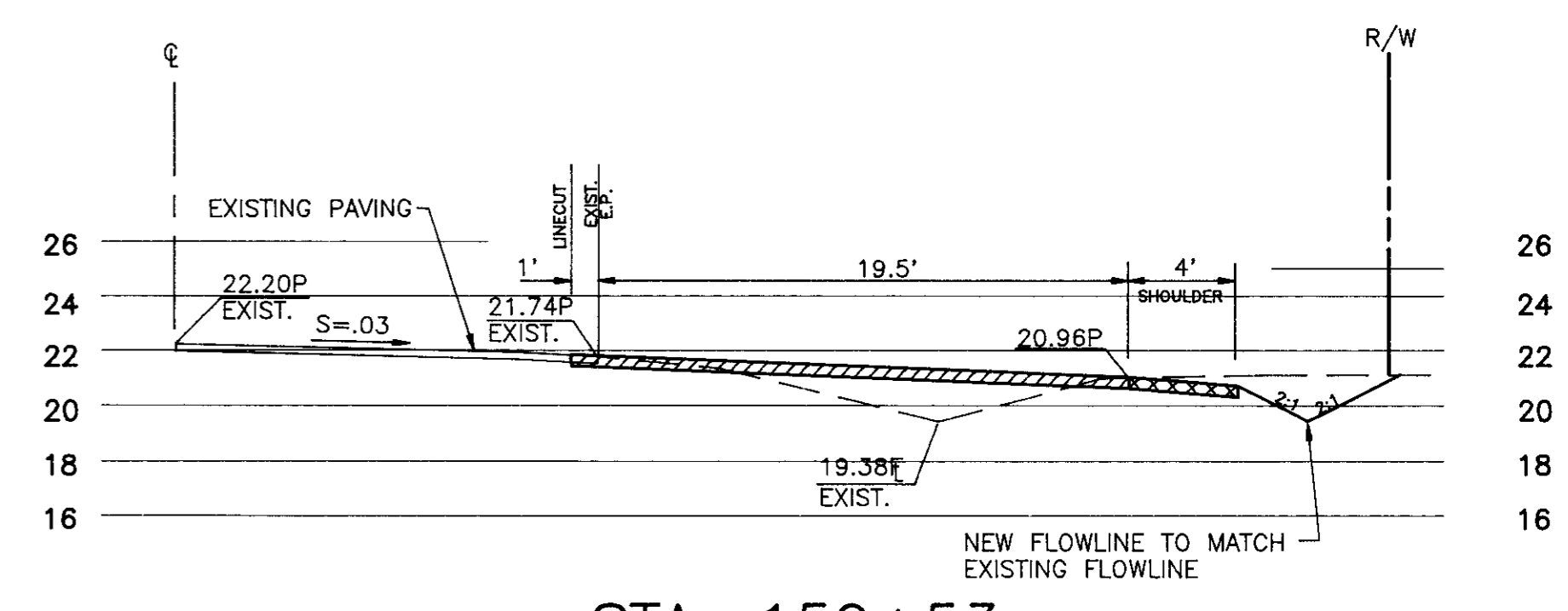

STA. 159+53
SCALE: 1"=6' HORIZ.,VERT.

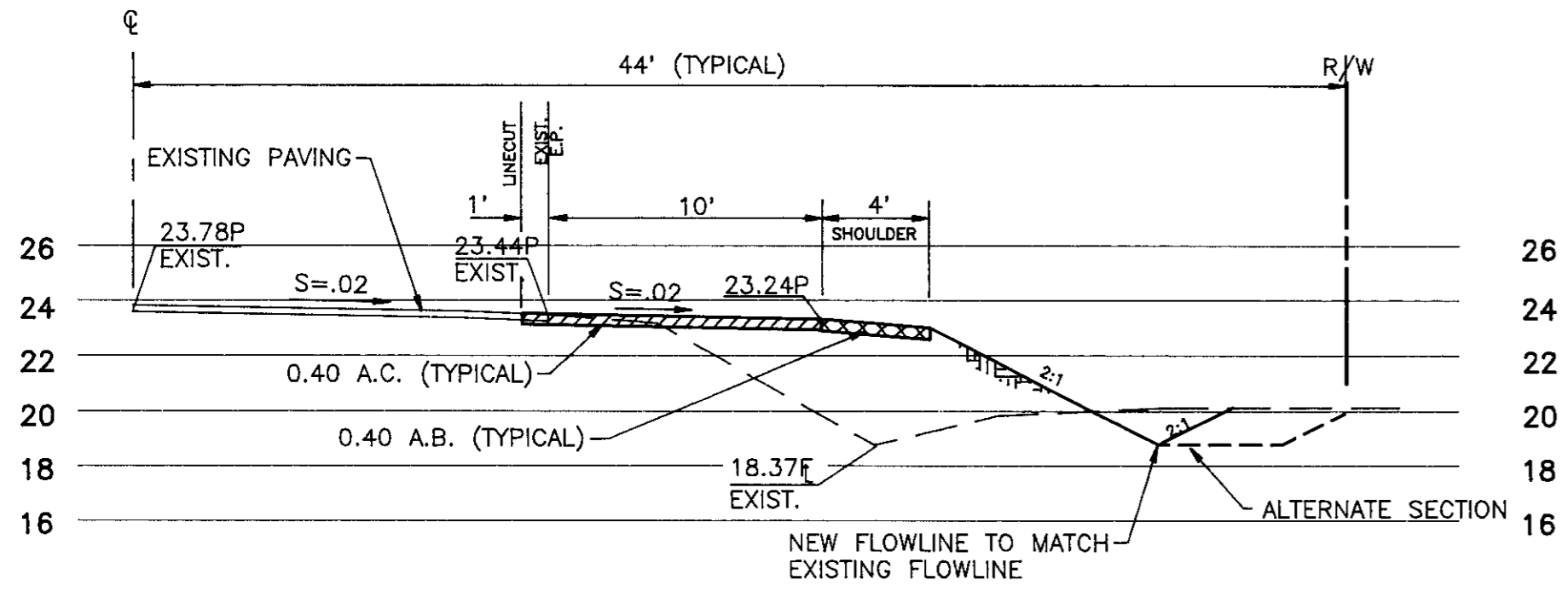

STA. 155+71
SCALE: 1"=6' HORIZ.,VERT.

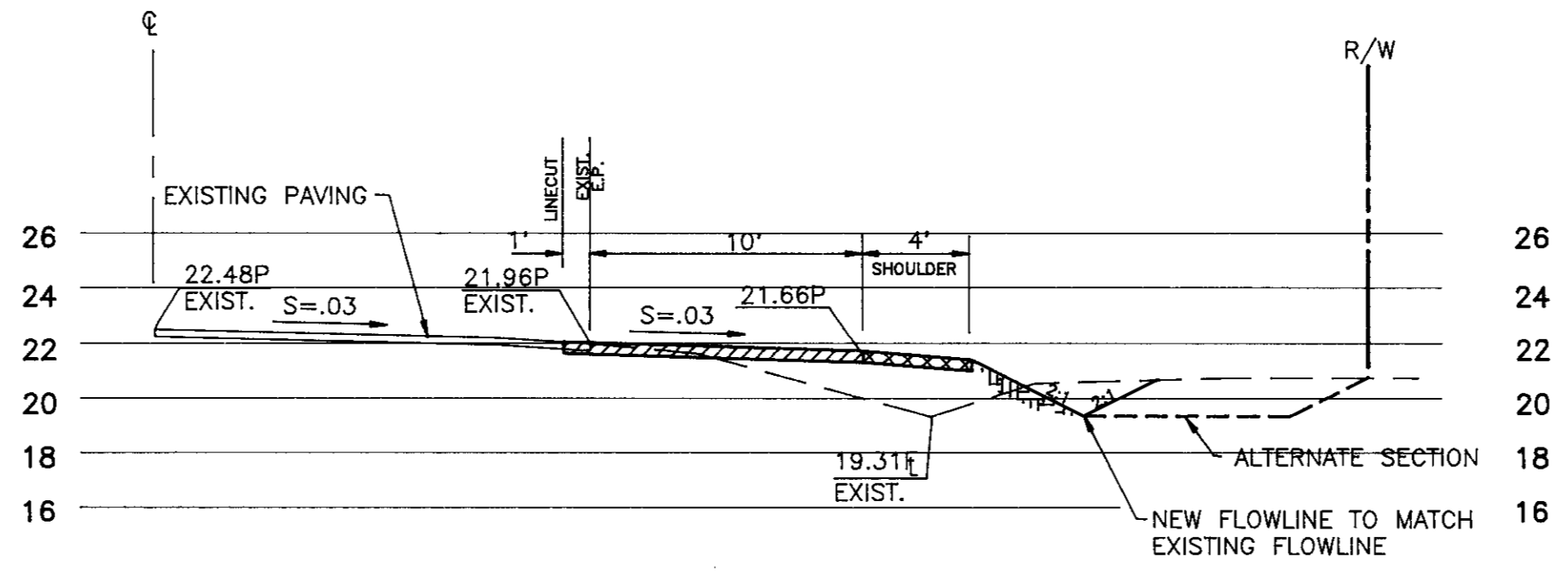

STA. 157+90
SCALE: 1"=6' HORIZ.,VERT.

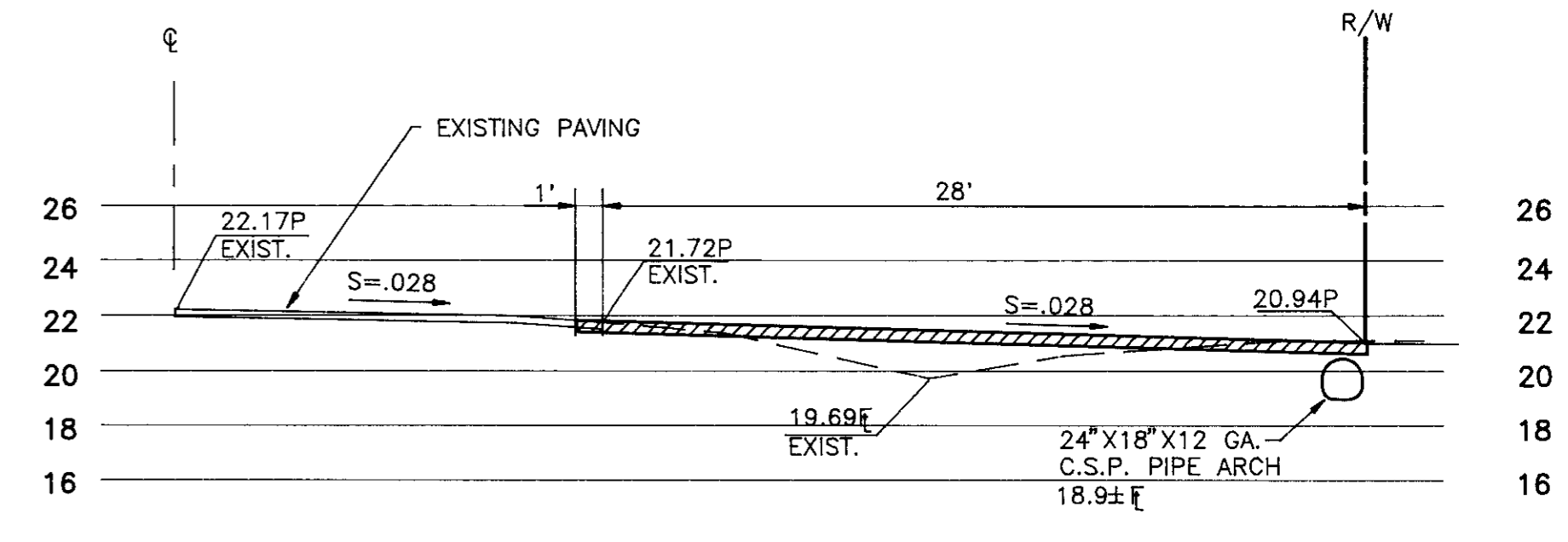

STA. 160+17
SCALE: 1"=6' HORIZ.,VERT.

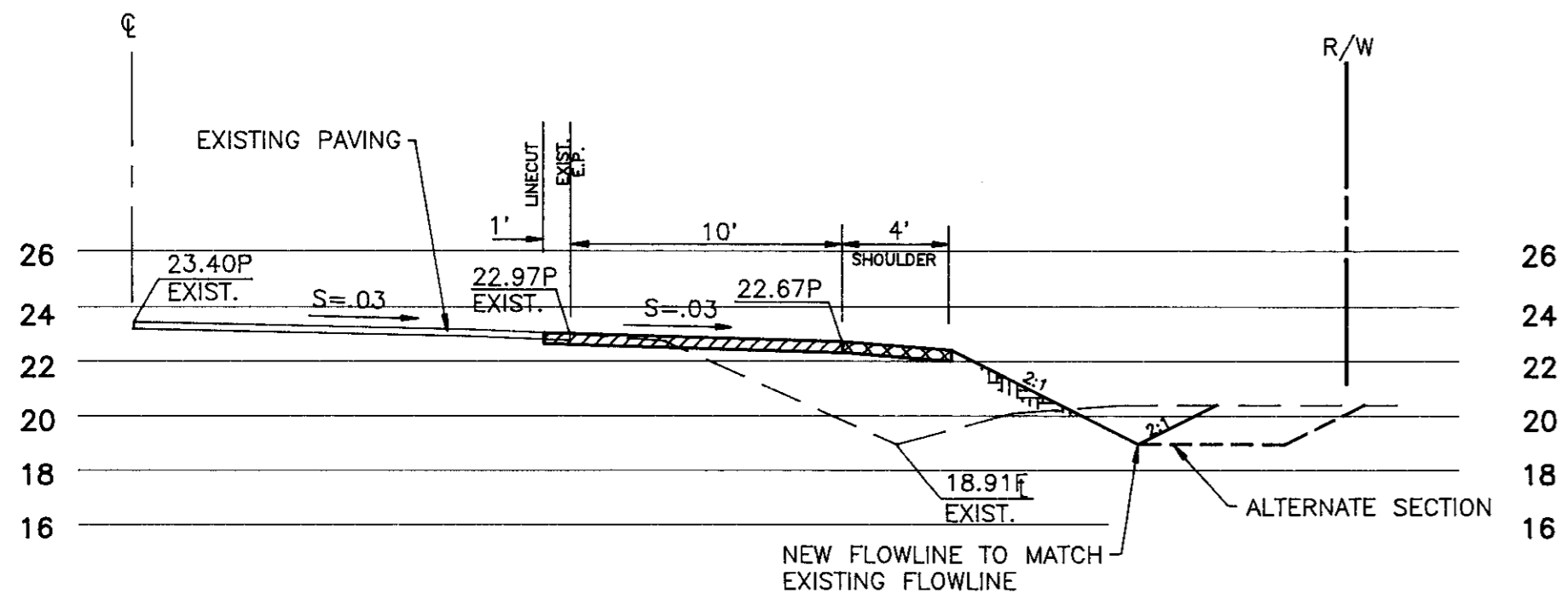

STA. 156+21
SCALE: 1"=6' HORIZ.,VERT.

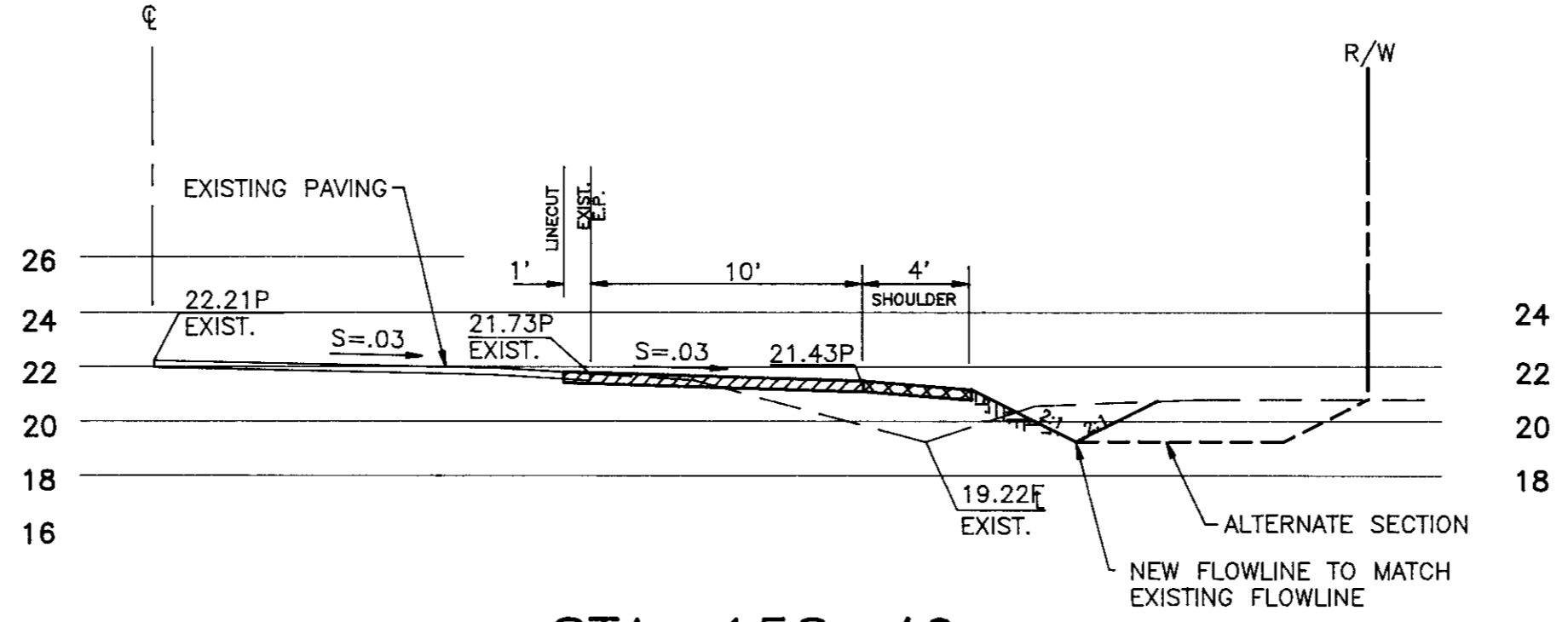

STA. 158+49
SCALE: 1"=6' HORIZ.,VERT.

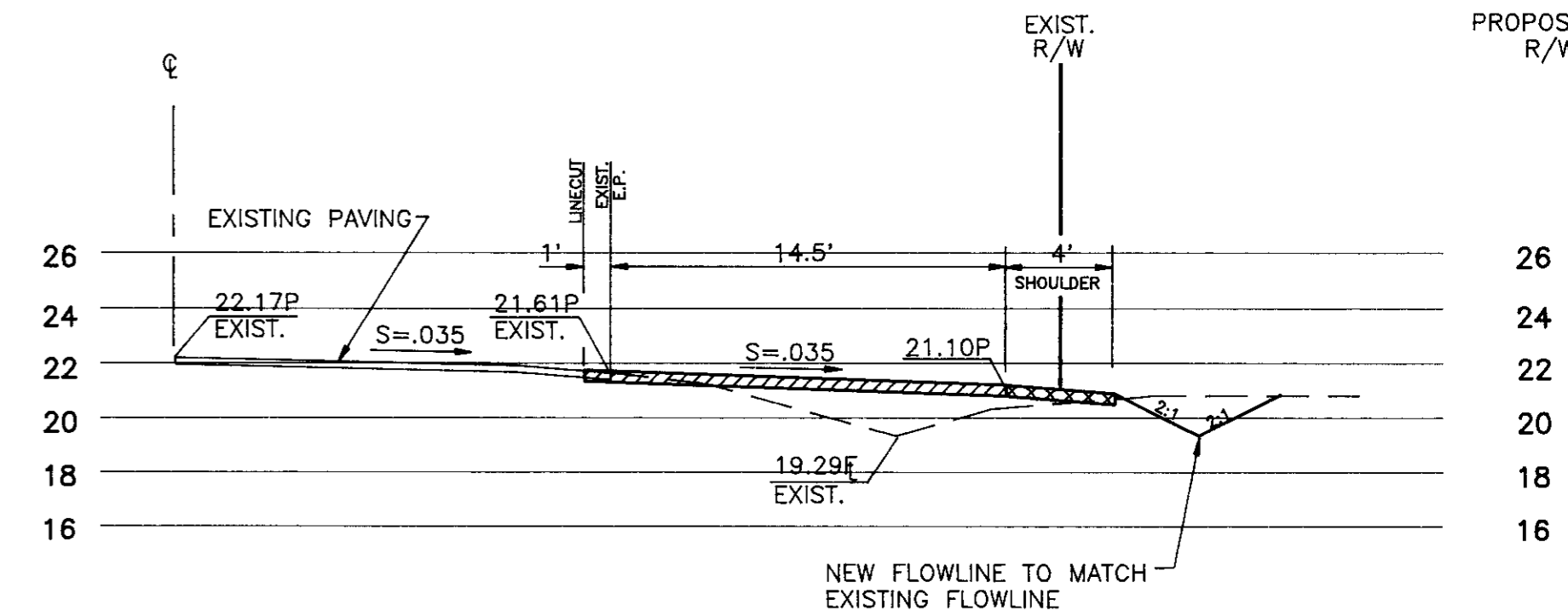

STA. 160+71
SCALE: 1"=6' HORIZ.,VERT.

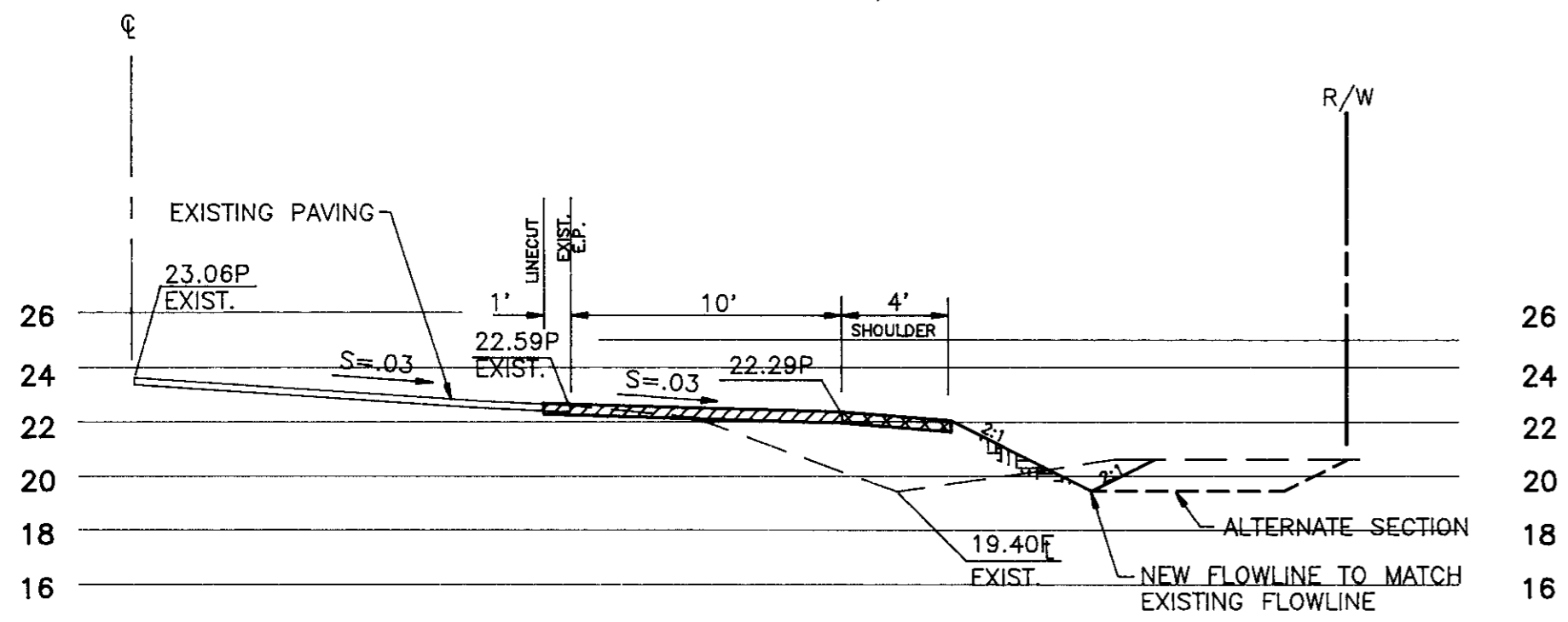

STA. 156+71
SCALE: 1"=6' HORIZ.,VERT.

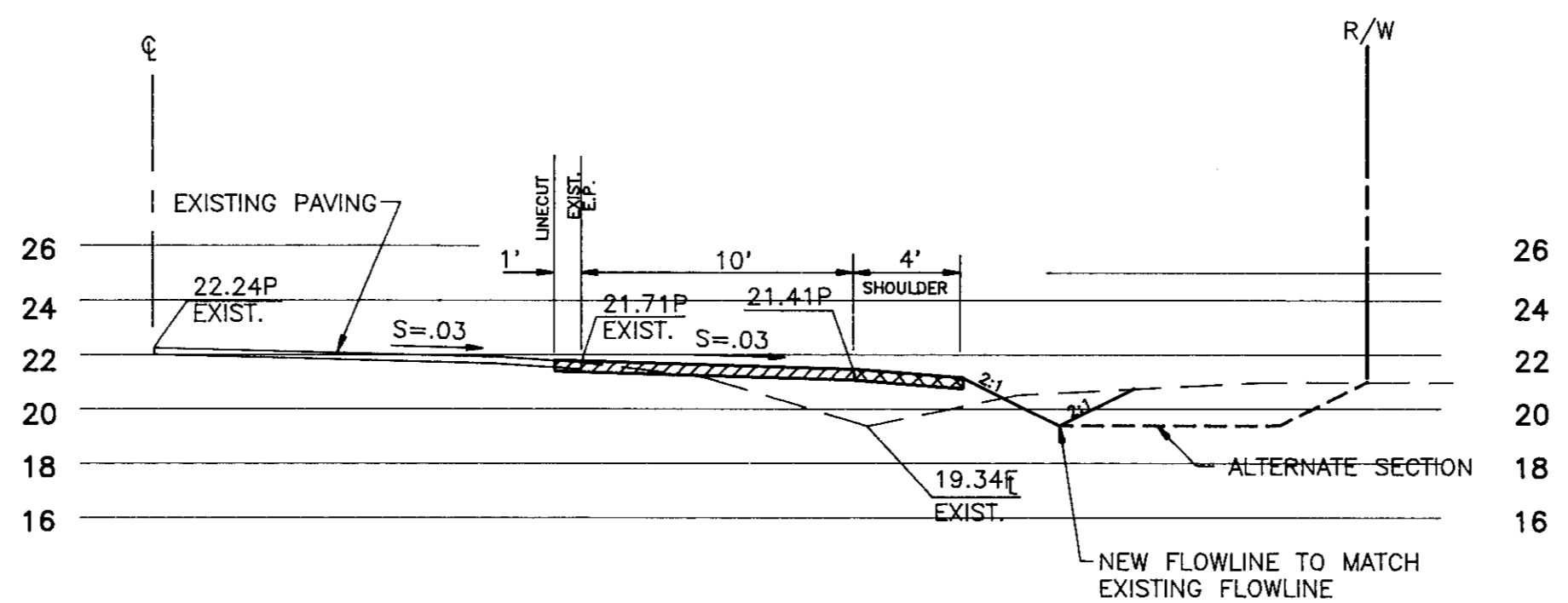

STA. 159+00
SCALE: 1"=6' HORIZ.,VERT.

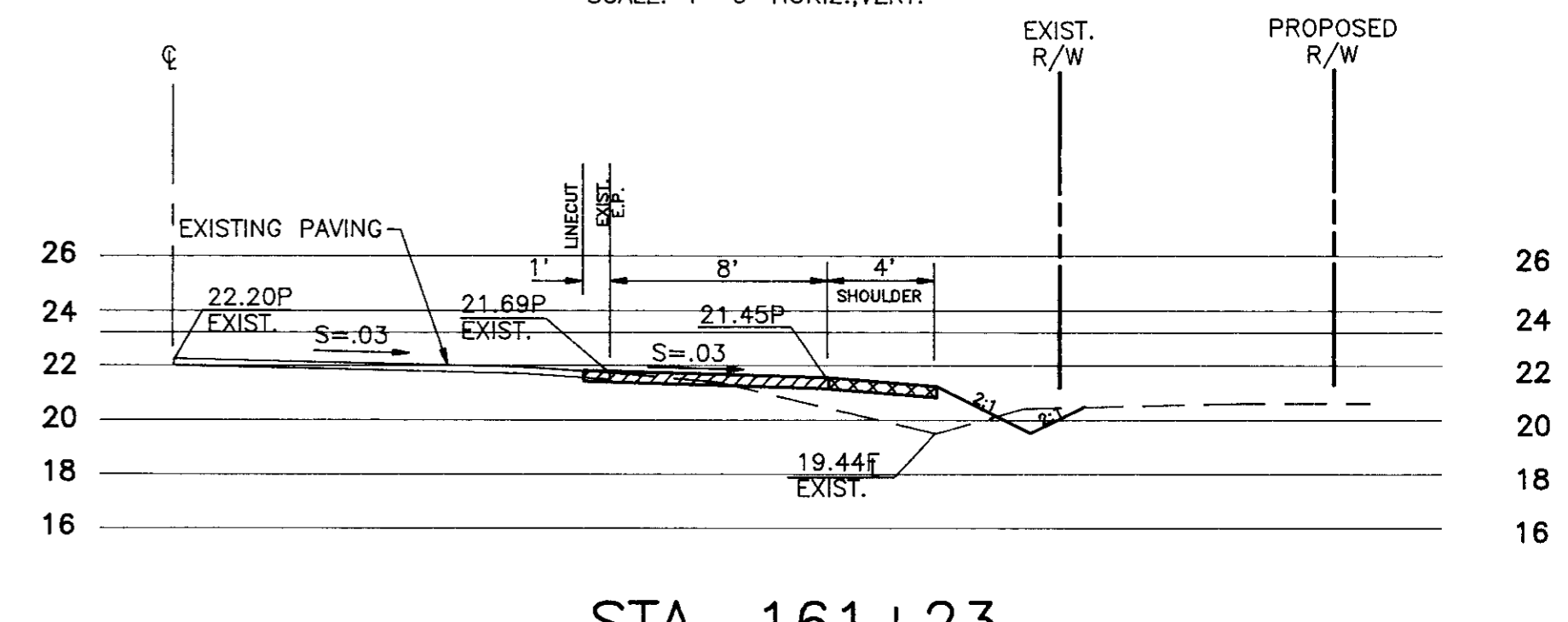

STA. 161+23
SCALE: 1"=6' HORIZ.,VERT.



COUNTY OF SAN JOAQUIN
DEPARTMENT OF PUBLIC WORKS
APPROVED: _____ DATE: _____
R.C.E. NO.: _____
DIRECTOR OF PUBLIC WORKS EXP. DATE: _____

REVISIONS			
NO.	DESCRIPTION	DATE	BY

SIEGFRIED ENGINEERING, Inc.
Civil Engineering ■ Land Surveying ■ Structural Engineering ■ Planning
4045 Coronado Ave. ■ Stockton, CA 95204-2396 ■ 209 943-2021 ■ FAX 209 942-0214
Job No. 7690-R Submitted By *Robert G. Cellum* R.C.E. No. 17,351 Exp. 6/30/93

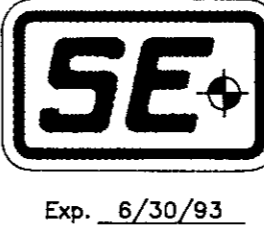

SCALE: AS SHOWN
DATE: NOVEMBER, 1993
JOB NO. 7690-R
DRAWN RAC
DESIGN RGC
CHECKED RGC

UNION PACIFIC RAILROAD
ROTH ROAD WIDENING
CROSS SECTIONS

SHEET **3**
OF FOUR
COMPUTER FILE NO. 7690-R03
DRAWING FILE NO. G-4809

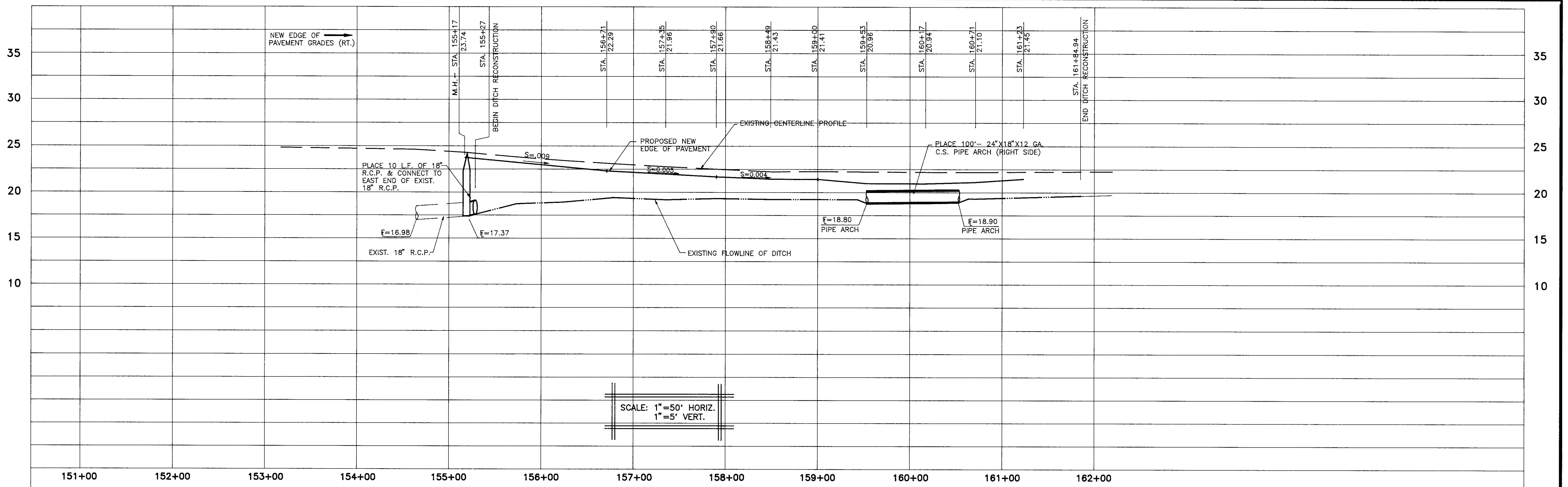

SCALE: 1"=50' HORIZ.
1"=5' VERT.

ROTH ROAD

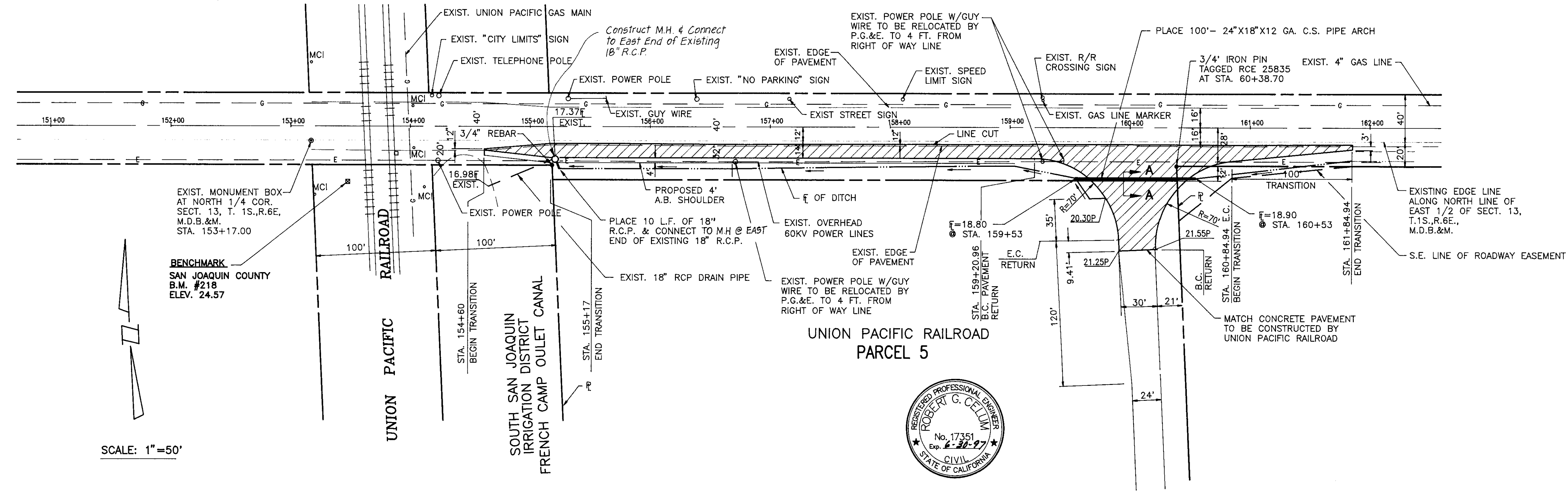

SCALE: 1"=50'

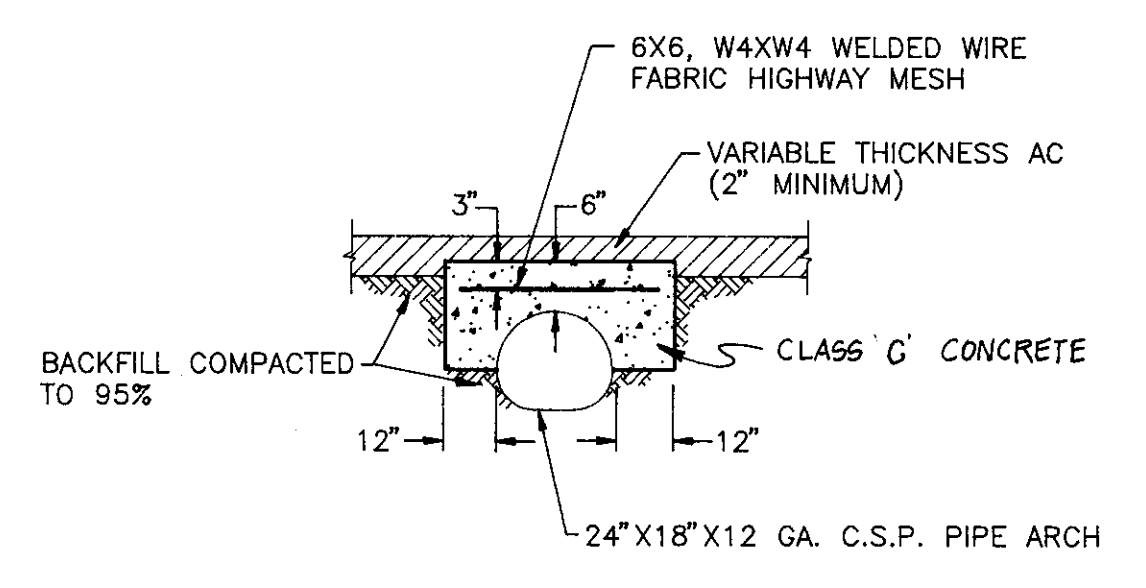

SECTION A-A
NOT TO SCALE



COUNTY OF SAN JOAQUIN
DEPARTMENT OF PUBLIC WORKS

APPROVED: _____ DATE: _____
R.C.E. NO.: _____
DIRECTOR OF PUBLIC WORKS EXP. DATE: _____

REVISIONS			
NO.	DESCRIPTION	DATE	BY

SIEGFRIED ENGINEERING, Inc.
Civil Engineering ■ Land Surveying ■ Structural Engineering ■ Planning
4045 Coronado Ave. ■ Stockton, CA 95204-2396 209 943-2021 ■ FAX 209 942-0214
Job No. 7690-R Submitted By *Robert G. Cetti* R.C.E. No. 17,351 Exp. 6/30/93



SCALE: NO SCALE
DATE: NOVEMBER, 1993
JOB NO. 7690-R
DRAWN RAC
DESIGN RGC
CHECKED RGC

UNION PACIFIC RAILROAD
ROTH ROAD STREET WIDENING

SHEET
2
OF FOUR
COMPUTER FILE NO.
7690-R02
DRAWING FILE NO.
G-4809

GENERAL NOTES:

THE FOLLOWING SPECIFICATIONS ARE TO SUPPLEMENT THE LATEST EDITION OF THE SAN JOAQUIN COUNTY IMPROVEMENT STANDARDS ADOPTED BY ORDINANCE NO. 3662. ALL CONSTRUCTION AND MATERIALS SHALL BE IN ACCORDANCE WITH THE LATEST EDITION OF THE SAN JOAQUIN COUNTY IMPROVEMENT STANDARDS.

- SPECIAL NOTICES AND PERMITS
 - PRIOR TO START OF CONSTRUCTION, THE CONTRACTOR SHALL HAVE IN HIS POSSESSION THE FOLLOWING PERMITS AND PLANS:
 - CONTRACTOR SHALL HAVE RECEIVED COUNTY APPROVED PLANS PRIOR TO CONSTRUCTION.
 - CONTRACTOR SHALL HAVE NOTIFIED ALL UTILITY COMPANIES AFFECTED BY THE DEVELOPMENT PRIOR TO BEGINNING OF WORK.
 - CONTRACTOR SHALL HAVE NOTIFIED "UNDERGROUND SERVICE ALERT" (PHONE 800-642-2444) 48 HOURS IN ADVANCE BEFORE ANY DIGGING.
 - CONTRACTOR SHALL BE RESPONSIBLE FOR THE PROTECTION OF ALL EXISTING MONUMENTS AND/OR OTHER SURVEY MONUMENTS AND SHALL NOTIFY SAN JOAQUIN COUNTY SURVEYOR OF ANY DAMAGED OR REMOVED COUNTY, STATE OR FEDERAL MONUMENTS.
 - THE CONTRACTOR SHALL HAVE VERIFIED ALL STREET NAMES WITH COMMUNITY DEVELOPMENT DEPARTMENT BEFORE ORDERING STREET SIGNS.
- EXCAVATION OF 5 FEET, OR MORE, IN DEPTH WILL REQUIRE AN EXCAVATION PERMIT FROM THE STATE OF CALIFORNIA DEPARTMENT OF INDUSTRIAL SAFETY.
- CONTRACTOR SHALL NOTIFY SAN JOAQUIN COUNTY DEPARTMENT OF PUBLIC WORKS 24 HOURS IN ADVANCE OF PERFORMING ANY WORK REQUIRED IN THE PLANS. PHONE (209) 468-3022.
- ALL IMPROVEMENTS SHALL BE CONSTRUCTED IN ACCORDANCE WITH THE ADOPTED STANDARDS OF SAN JOAQUIN COUNTY.
- BENCHMARK AS SHOWN ON SHEET 2.
- ELEVATIONS ARE REFERRED TO U.S.G.S. DATUM AND ARE BASED ON SAN JOAQUIN COUNTY CO. B.M. NO. 218, ELEVATION 24.57.
- ALL STATIONS REFER TO DISTANCES ALONG STREET CENTERLINE.
- CONTRACTOR SHALL BE RESPONSIBLE FOR PROTECTING EXISTING IMPROVEMENTS FROM DAMAGE. COST OF REPLACING EXISTING IMPROVEMENTS SHALL BE INCLUDED IN THE UNIT PRICE BID FOR ITEMS REQUIRING REMOVAL AND REPLACEMENT OF EXISTING IMPROVEMENTS.
- WHENEVER PAVEMENT IS BROKEN OR CUT IN THE INSTALLATION OF THE WORK COVERED BY THE SPECIFICATIONS, THE PAVEMENT SHALL BE REPLACED AFTER PROPER BACKFILLING WITH PAVEMENT MATERIALS EQUAL TO OR BETTER THAN THE MATERIALS USED IN THE ORIGINAL PAVING.
- DRAWING NUMBERS SHOWN ON PLANS REFER TO SAN JOAQUIN COUNTY STANDARD DETAILS.
- THE CONTRACTOR SHALL CHECK WITH THE UTILITY COMPANIES AND VERIFY ALL UTILITY LOCATIONS. IT SHALL BE THE CONTRACTOR'S SOLE RESPONSIBILITY TO PROTECT ALL EXISTING UTILITIES SO THAT NO DAMAGE RESULTS TO THEM DURING THE PERFORMANCE OF HIS CONTRACT. CONTRACTOR SHALL BE REQUIRED TO COOPERATE WITH OTHER CONTRACTORS AND UTILITY COMPANIES INSTALLING NEW STRUCTURE, UTILITIES AND SERVICE FOR THE DEVELOPMENT.
- PAYMENT FOR PAVEMENT WILL BE MADE ONLY FOR AREAS SHOWN ON PLANS. REPLACEMENT OF PAVEMENT WHICH IS BROKEN OR CUT IN THE INSTALLATION OF THE WORK COVERED BY THESE SPECIFICATIONS, AND WHICH LIES OUTSIDE OF THE SAID AREAS, SHALL BE INCLUDED IN THE STREET CONTRACTOR'S UNIT PRICE BID FOR PAVEMENT, AND NO ADDITIONAL PAYMENT SHALL BE MADE FOR SUCH WORK.
- CONTRACTOR SHALL OBTAIN ENCROACHMENT PERMIT FROM SAN JOAQUIN COUNTY PRIOR TO PERFORMING WORK ON ANY COUNTY RIGHT-OF-WAY.
- "ENGINEER" REFERS TO SIEGFRIED ENGINEERING, INC., CONSULTING CIVIL ENGINEERS.
- CONTRACTOR AGREES: THAT HE SHALL ASSUME SOLE AND COMPLETE RESPONSIBILITY FOR JOBSITE CONDITIONS DURING THE COURSE OF CONSTRUCTION OF THIS PROJECT, INCLUDING SAFETY OF ALL PERSONS AND PROPERTY, THAT THIS REQUIREMENT SHALL APPLY CONTINUOUSLY AND NOT BE LIMITED TO NORMAL WORKING HOURS, AND THAT THE CONTRACTOR SHALL DEFEND, INDEMNIFY AND HOLD THE OWNERS, THE COUNTY OF SAN JOAQUIN, AND THE ENGINEER HARMLESS FROM ANY AND ALL LIABILITY, REAL OR ALLEGED, IN CONNECTION WITH THE PERFORMANCE OF WORK ON THIS PROJECT, EXCEPT FOR THE LIABILITY ARISING FROM THE SOLE NEGLIGENCE OF THE OWNERS, THE COUNTY OF SAN JOAQUIN OR THE ENGINEER.
- CONTRACTOR'S ATTENTION IS CALLED TO THE FOLLOWING: SECTION 1540 (A)(1) OF THE CONSTRUCTION SAFETY ORDERS (TITLE 8 CALIFORNIA ADMINISTRATION CODE SECTION 1540), ISSUED BY THE OCCUPATIONAL SAFETY AND HEALTH STANDARDS BOARD PURSUANT TO THE CALIFORNIA OCCUPATIONAL SAFETY AND HEALTH ACT OF 1973 AS AMENDED WHICH STATES:
 - "PRIOR TO OPENING AN EXCAVATION, EFFORT SHALL BE MADE TO DETERMINE WHETHER UNDERGROUND INSTALLATION; I.E., SEWER, WATER, FUEL, ELECTRIC LINES, ETC., WILL BE ENCOUNTERED AND, IF SO, WHERE SUCH UNDERGROUND INSTALLATIONS ARE LOCATED. WHEN THE EXCAVATION APPROACHES THE APPROXIMATE LOCATION OF SUCH AN INSTALLATION, THE EXACT LOCATION SHALL BE DETERMINED BY CAREFUL PROBING OR HAND DIGGING; AND, WHEN IT IS UNCOVERED, ADEQUATE PROTECTION SHALL BE PROVIDED FOR THE INSTALLATION. ALL KNOWN OWNERS OF UNDERGROUND FACILITIES IN THE AREA CONCERNED SHALL BE ADVISED OF PROPOSED WORK AT LEAST 48 HOURS PRIOR TO THE START OF ACTUAL EXCAVATION, BY CALLING USA @ (800)642-2444.
- WORK IN STREET RIGHT-OF-WAY IS SUBJECT TO THE APPROVAL AND ACCEPTANCE OF THE SAN JOAQUIN COUNTY PUBLIC WORKS DEPARTMENT.
- CONSTRUCTION STAKING IS NORMALLY PERFORMED BY THE ENGINEER WHO PREPARES THE PLAN, THEREBY PERMITTING APPROPRIATE ON-SITE INTERPRETATION AND ADJUSTMENT OF THE PLANS, IF NECESSARY. THIS NOTE GIVES FORMAL NOTICE THAT THE FIRM OF SIEGFRIED ENGINEERING, INC. CANNOT, AND WILL NOT, TAKE RESPONSIBILITY FOR ERRORS OR OMISSIONS, IF ANY, WHICH MIGHT OCCUR AND WHICH COULD HAVE BEEN AVOIDED OR DETECTED AND/OR CORRECTED OR MITIGATED HAD SIEGFRIED ENGINEERING, INC. PERFORMED THE CONSTRUCTION STAKING WORK.
- CONTRACTOR SHALL PROVIDE DUST CONTROL MEASURES AT ALL TIMES DURING CONSTRUCTION AS PER SECTION 10 OF THE STANDARD SPECIFICATIONS OF THE STATE OF CALIFORNIA AND PER SAN JOAQUIN COUNTY, DEPARTMENT OF PUBLIC WORKS REQUIREMENTS.
- TRAFFIC SIGNALS AND MARKINGS SHALL CONFORM TO THE MANUAL OF UNIFORM TRAFFIC CONTROL DEVICES AND SAN JOAQUIN COUNTY STANDARDS, AND AS SHOWN ON THE PLANS.

TRACT NO. 2576
AIRPORT WAY PARK
(SU-92-5)

UNION PACIFIC RAILROAD
PROJECT PLANS FOR
ROTH ROAD WIDENING

SIEGFRIED ENGINEERING, INC.
STOCKTON, CALIFORNIA

CIVIL ENGINEERS
NOVEMBER, 1993

TO BE SUPPLEMENTED BY STANDARD PLANS DATED JULY, 1992

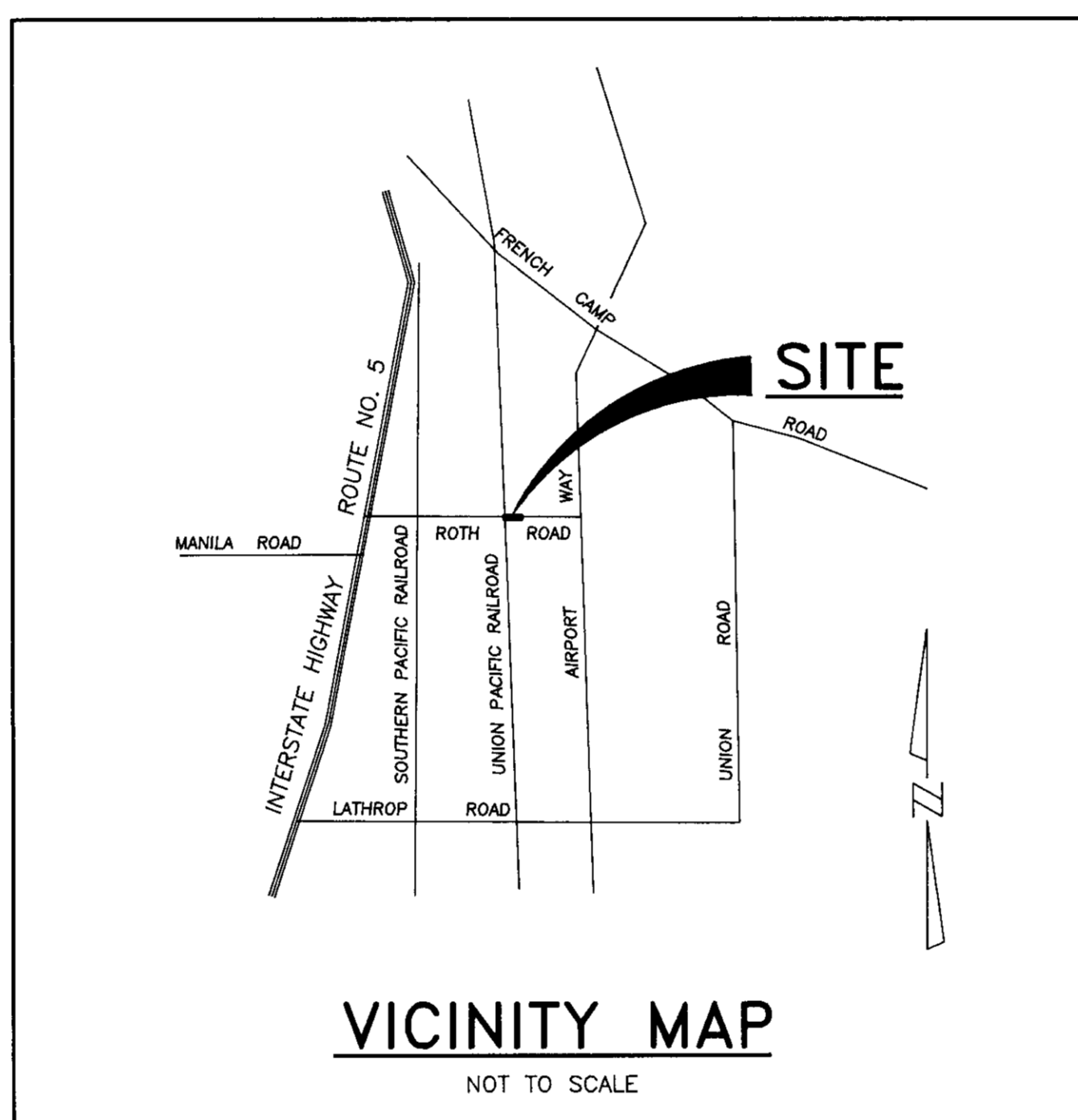

NOTE: AT TIME THE CONTRACT IS AWARDED, THE CONTRACTOR SHALL POSSESS A CLASS A LICENSE.

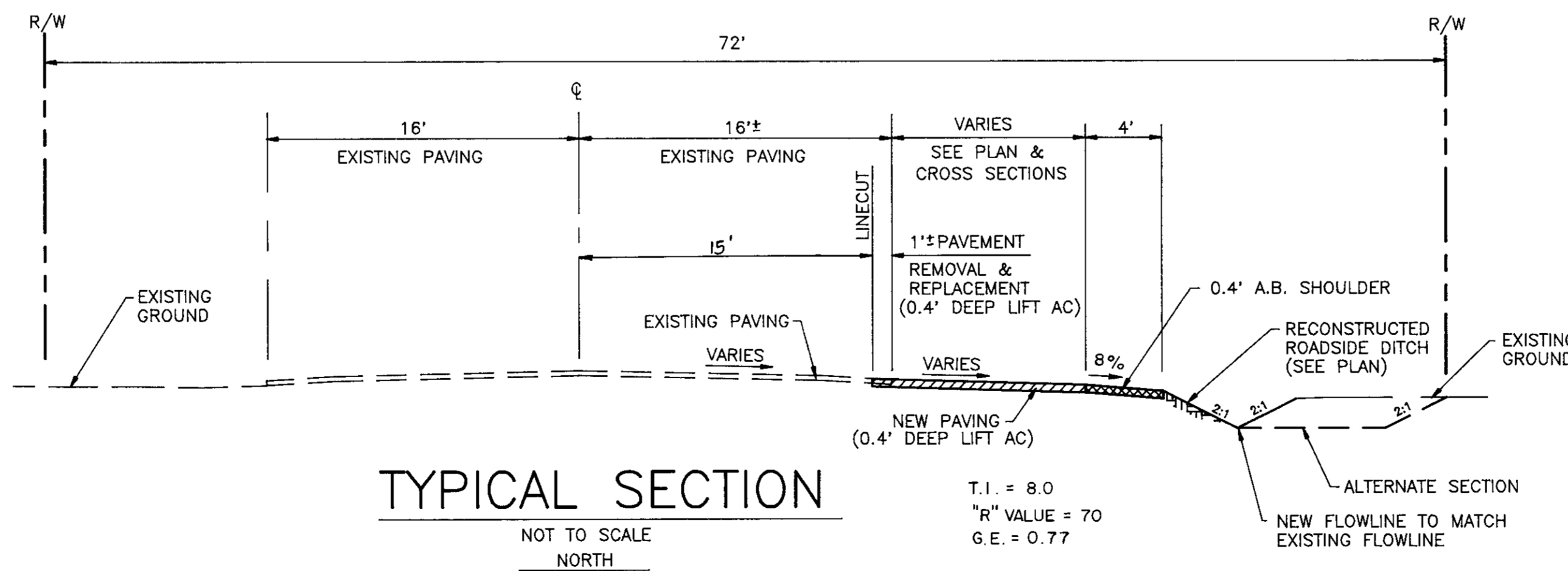

LEGEND:

DESCRIPTION	TO BE CONSTRUCTED	EXISTING
STORM SEWER	8" D	8" D
GAS LINE	G	G
WATER LINE	8" W	8" W
TELEPHONE	T	T
ELECTRIC LINE	E	E
PAVEMENT (0.40' DEEP LIFT AC)	[Hatched Pattern]	[Hatched Pattern]
FENCE	X-X	X-X
GROUND ELEVATION	105.0GND	105.0GND EXIST.
PAVEMENT ELEVATION	105.00P	105.00P EXIST.
FLOWLINE ELEVATION	105.00F	105.00F EXIST.
RIGHT-OF-WAY LINE	[Dashed Line]	[Dashed Line]
CENTERLINE	[Dashed Line]	[Dashed Line]
PUBLIC UTILITY EASEMENT	[Dashed Line]	[Dashed Line]
MONUMENT BOX	⊙	⊙
DIRECTION OF FLOW OF ROADSIDE DITCH	→	→
FLOWLINE OF ROADSIDE DITCH	[Dashed Line]	[Dashed Line]
AGGREGATE BASE	[Cross-hatched Pattern]	[Cross-hatched Pattern]
STANDARD MANHOLE (STANDARD DWG. D-17)	○	○

ABBREVIATIONS:

A.C.	ASPHALT CONCRETE	P.	PAVEMENT
A.B.	AGGREGATE BASE	ℙ	PROPERTY LINE
A.S.B.	AGGREGATE SUB BASE	P.U.E.	PUBLIC UTILITY EASEMENT
B.C.	BEGINNING OF CURVE	R/W	RIGHT OF WAY
⊕	CENTERLINE	R.C.P.	REINFORCED CONCRETE PIPE
C.S.P.	CORRUGATED STEEL PIPE	R.D.	REMOVE AND DISPOSE
D.F.	DOUGLAS FIR	R.T.	RIGHT
D.R.	DRIVEWAY	S.P.	STANDARD PLANS
E.C.	END OF CURVE	SHLD.	SHOULDER
E.P.	EDGE OF PAVEMENT		
EXIST.	EXISTING		
ℙ	FLOWLINE		
L.F.	LINEAR FEET		
M.D.B. & M.	MOUNT DIABLO BASE AND MERIDIAN		
M.H.	MANHOLE		
O.G.	ORIGINAL GROUND		

INDEX:

SHEET NO.	DESCRIPTION
1	VICINITY MAP, GENERAL NOTES, LEGEND, INDEX AND ABBREVIATIONS
2	ROTH ROAD WIDENING
3	CROSS SECTIONS
4	PAVEMENT DELINEATION PLAN



COUNTY OF SAN JOAQUIN
DEPARTMENT OF PUBLIC WORKS

APPROVED: _____ DATE: _____
R.C.E. NO.: _____ EXP. DATE: _____
DIRECTOR OF PUBLIC WORKS

REVISIONS			
NO.	DESCRIPTION	DATE	BY

SIEGFRIED ENGINEERING, Inc.
Civil Engineering ■ Land Surveying ■ Structural Engineering ■ Planning
4045 Coronado Ave. ■ Stockton, CA 95204-2396 ■ 209 943-2021 ■ FAX 209 942-0214
Job No. 7690-R Submitted By *Robert G. Cullum* R.C.E. No. 17351 Exp. 8/30/93



SCALE: NO SCALE
DATE: NOVEMBER, 1993
JOB NO. 7690-R
DRAWN: RAC
DESIGN: RGC
CHECKED: RGC

UNION PACIFIC RAILROAD
ROTH ROAD WIDENING
**VICINITY MAP, GENERAL NOTES,
LEGEND, INDEX AND ABBREVIATIONS**

SHEET **1**
OF FOUR
COMPUTER FILE NO.: 7690-R01
DRAWING FILE NO. C-4809

Su 2750