

SU 3286

8+50

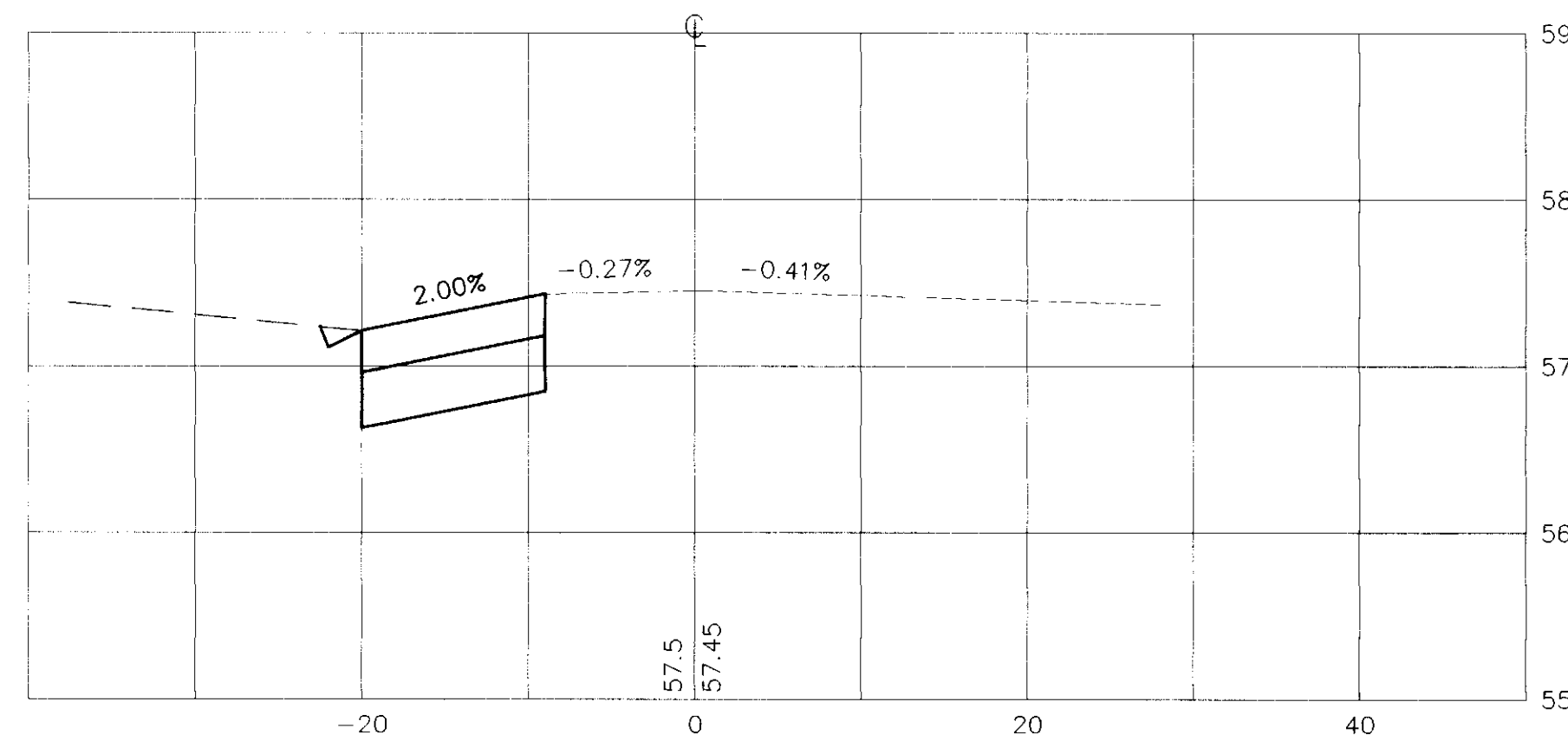

8+00

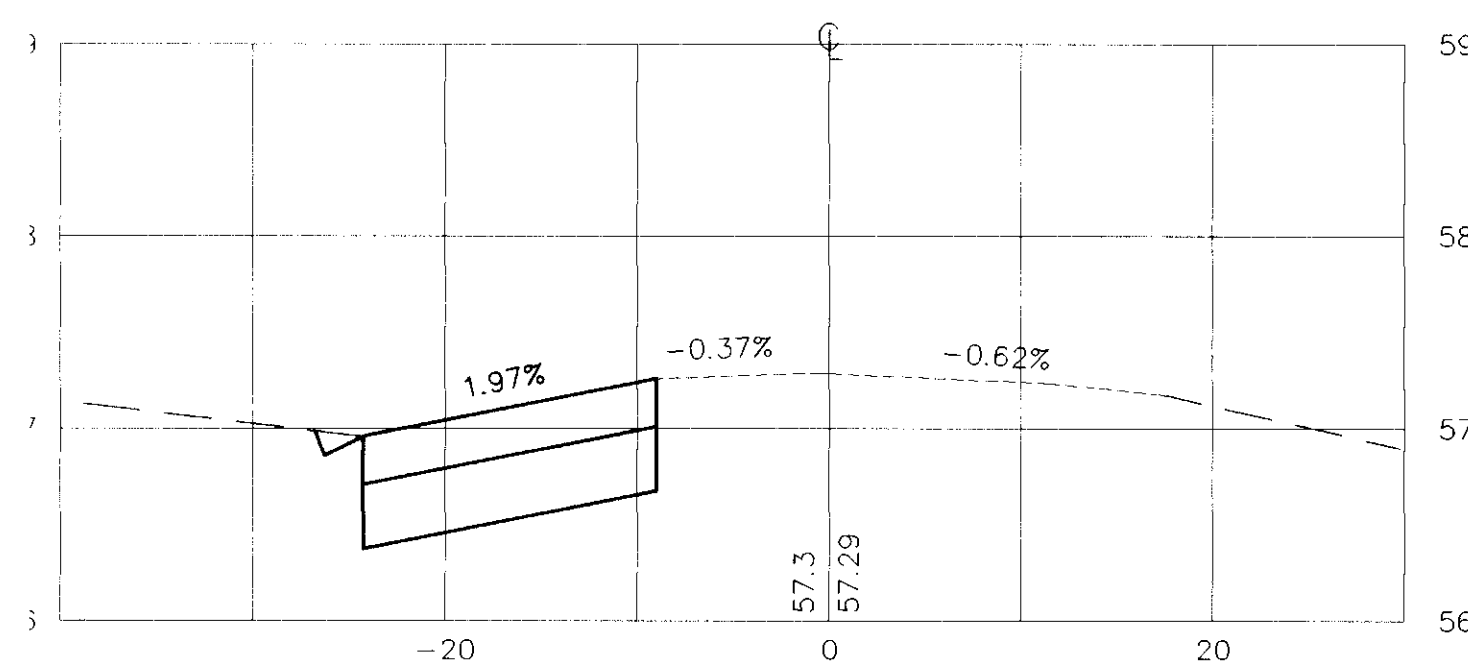

9+50

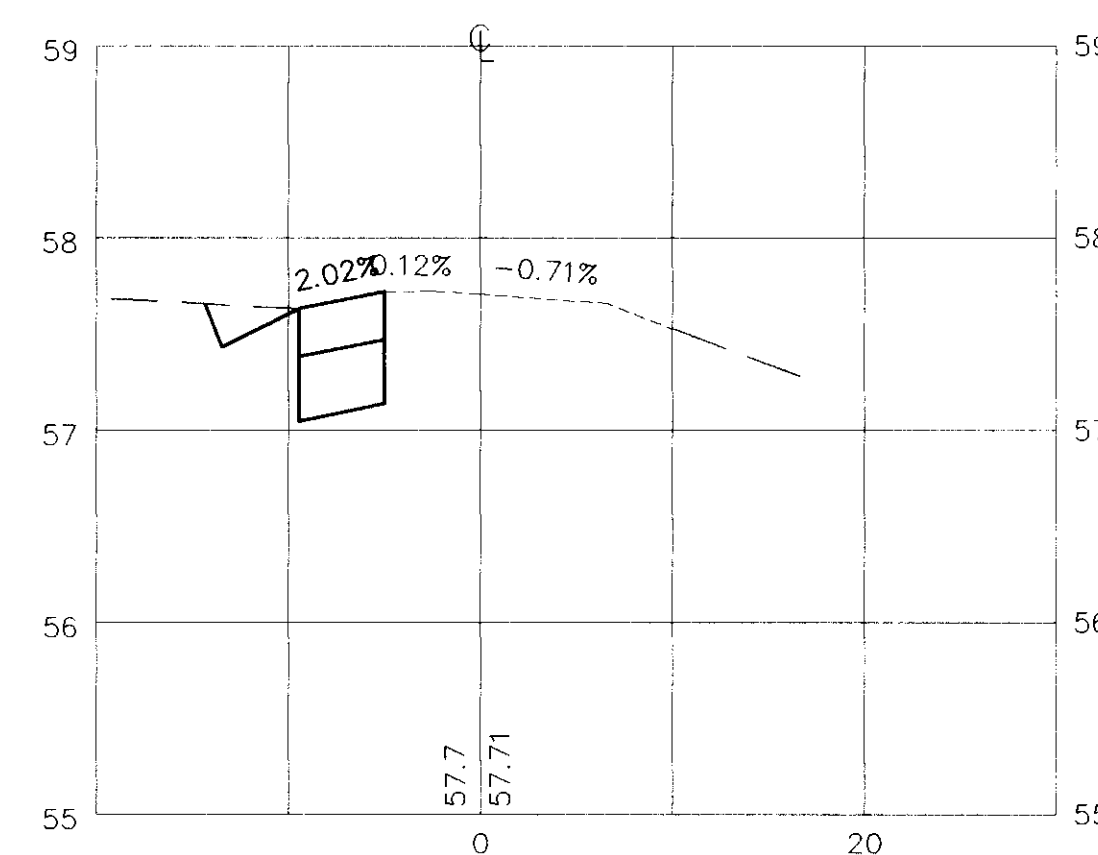

7+50

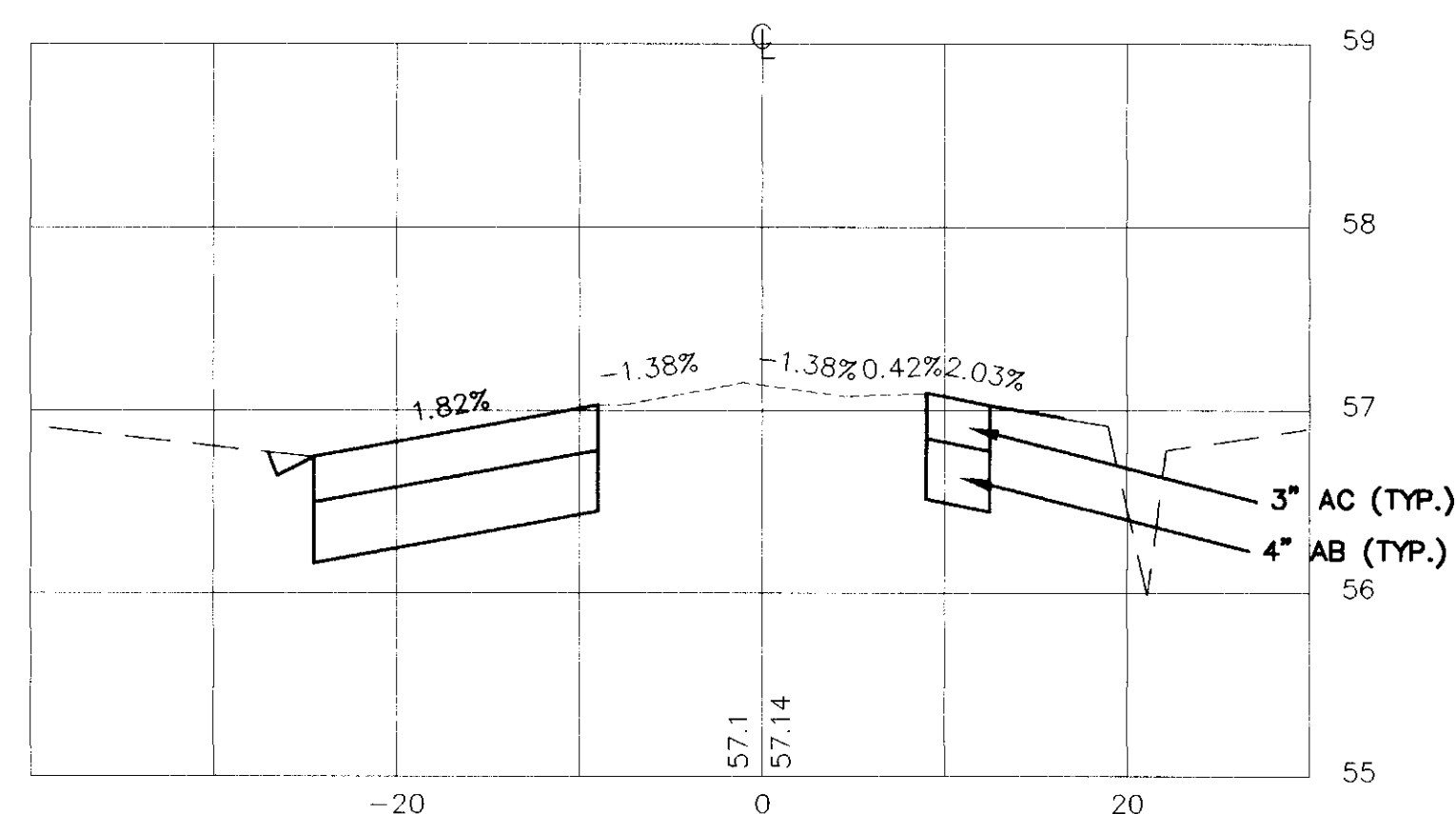

9+00

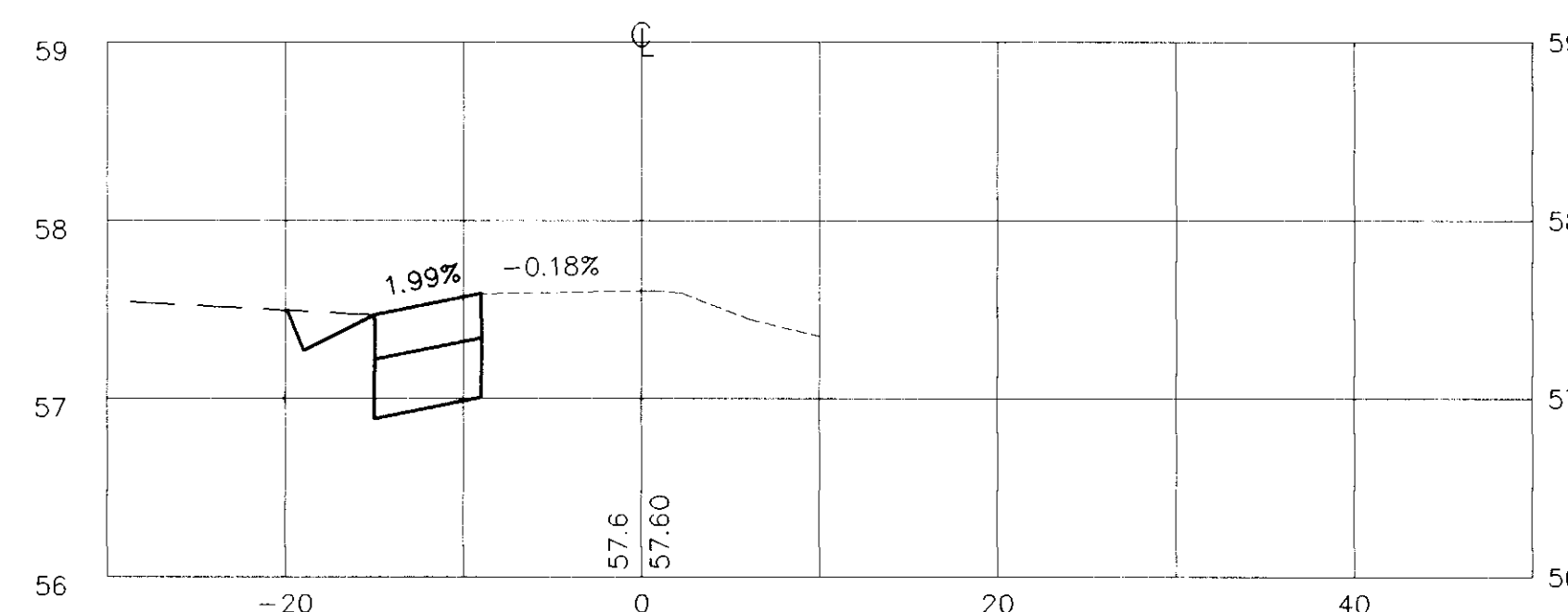

SECTION SCALE  
1" = 10' HORIZONTAL  
1" = 1' VERTICAL



NO.	DESCRIPTION	COUNTY APPROVAL	
		APPROVED BY	BY

**SIEGFRIED ENGINEERING, Inc.**

Civil Engineering ■ Land Surveying ■ Structural Engineering ■ Planning  
4045 Coronado Ave. ■ Stockton, CA 95204-2386 ■ 209 943-2021 ■ FAX 209 942-0214

Job No. \_\_\_\_\_ Submitted By \_\_\_\_\_ R.C.E. No. \_\_\_\_\_ Exp. \_\_\_\_\_



JOB NO.
DATE 11/23/98
F.B. NO.
DRAWN VGD
DESIGN VGD
CHECKED LAC

**NORTH 99 FRONTAGE ROAD**

STREET IMPROVEMENTS  
CROSS SECTIONS STA: 7+50 TO 9+50

SHEET

6

OF 6

COMPUTER FILE NO.

DRAWING FILE NO.

FA 98040\98415\CIVIL\Z15IP06.DWG

SU 3287

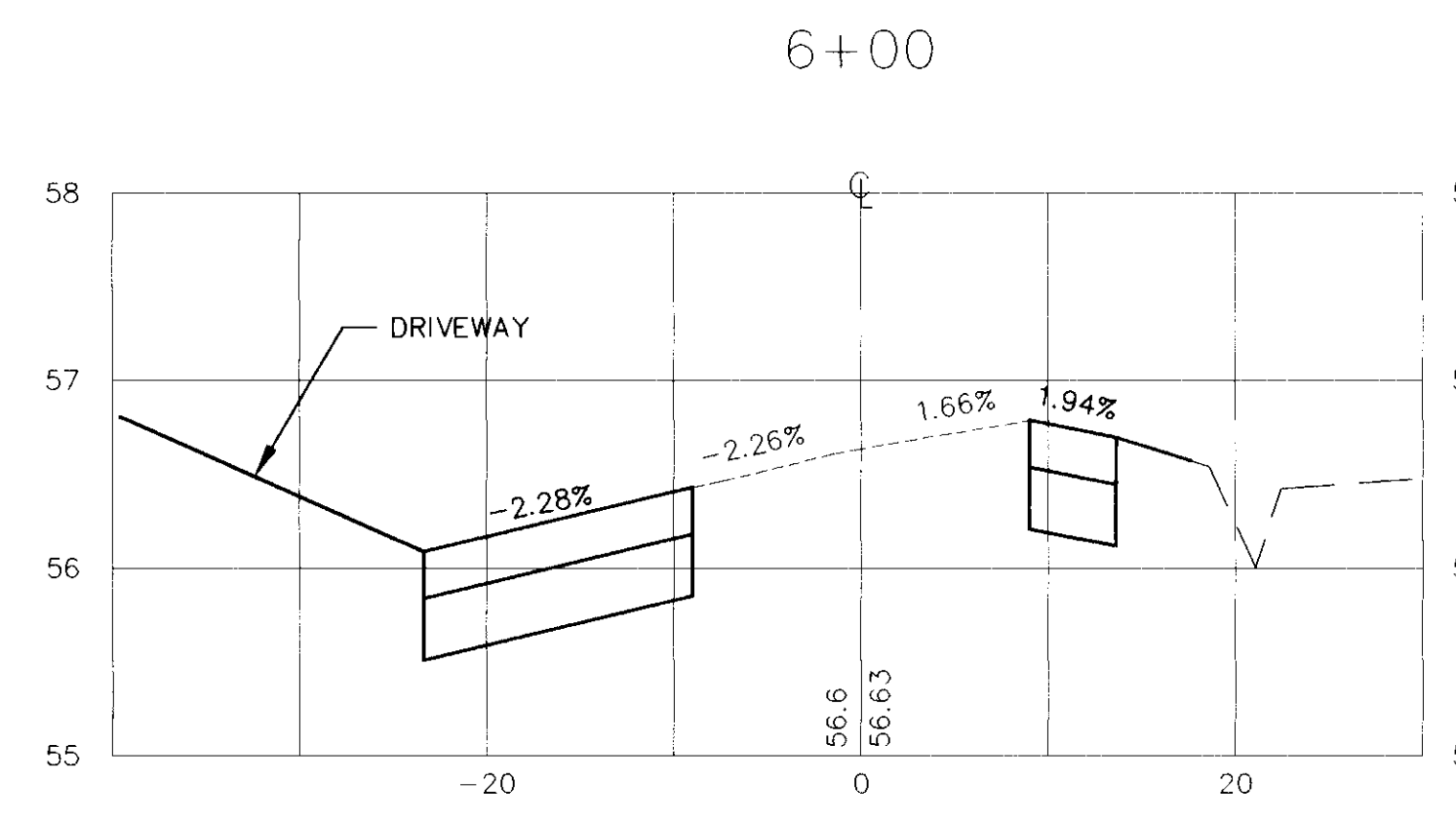
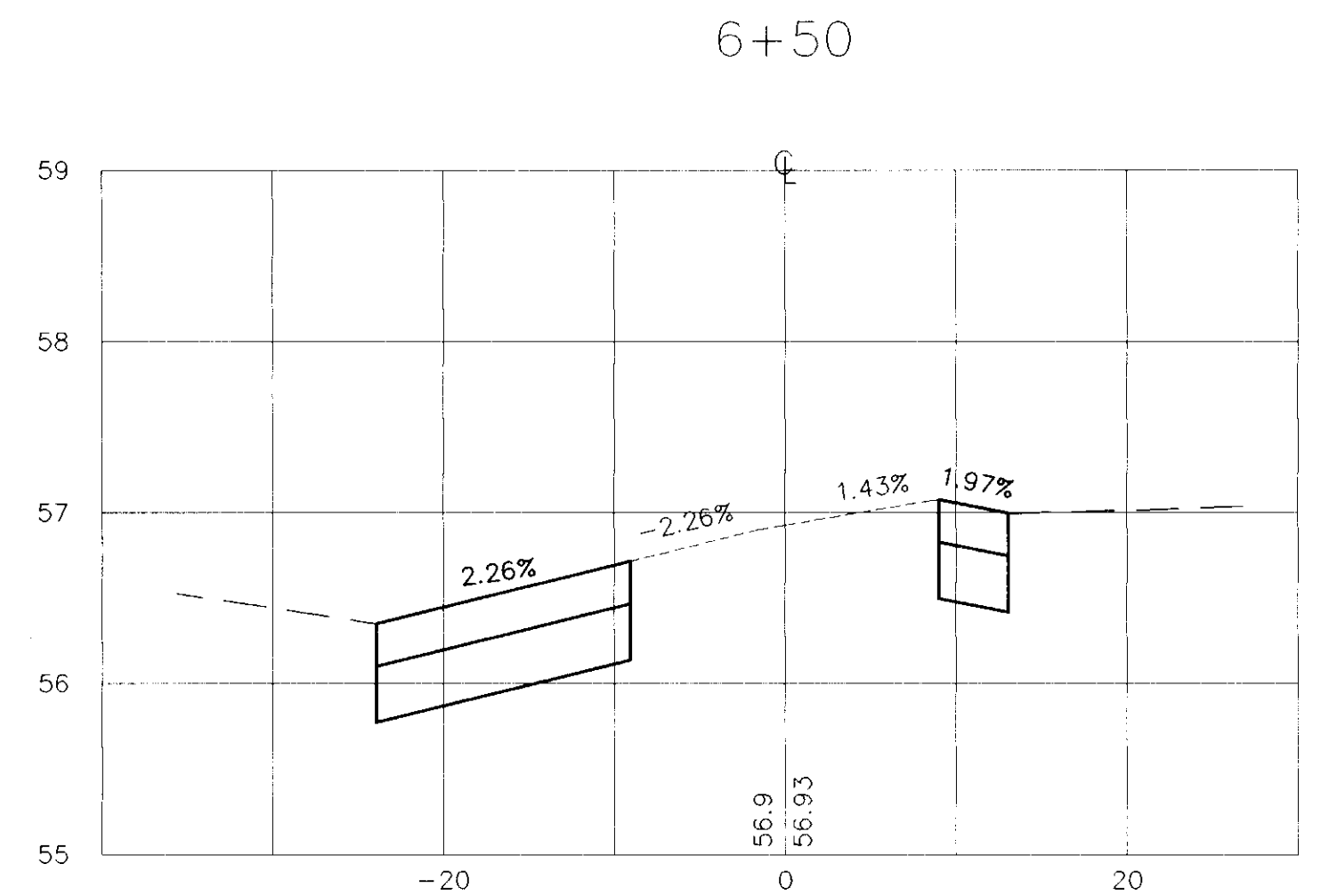
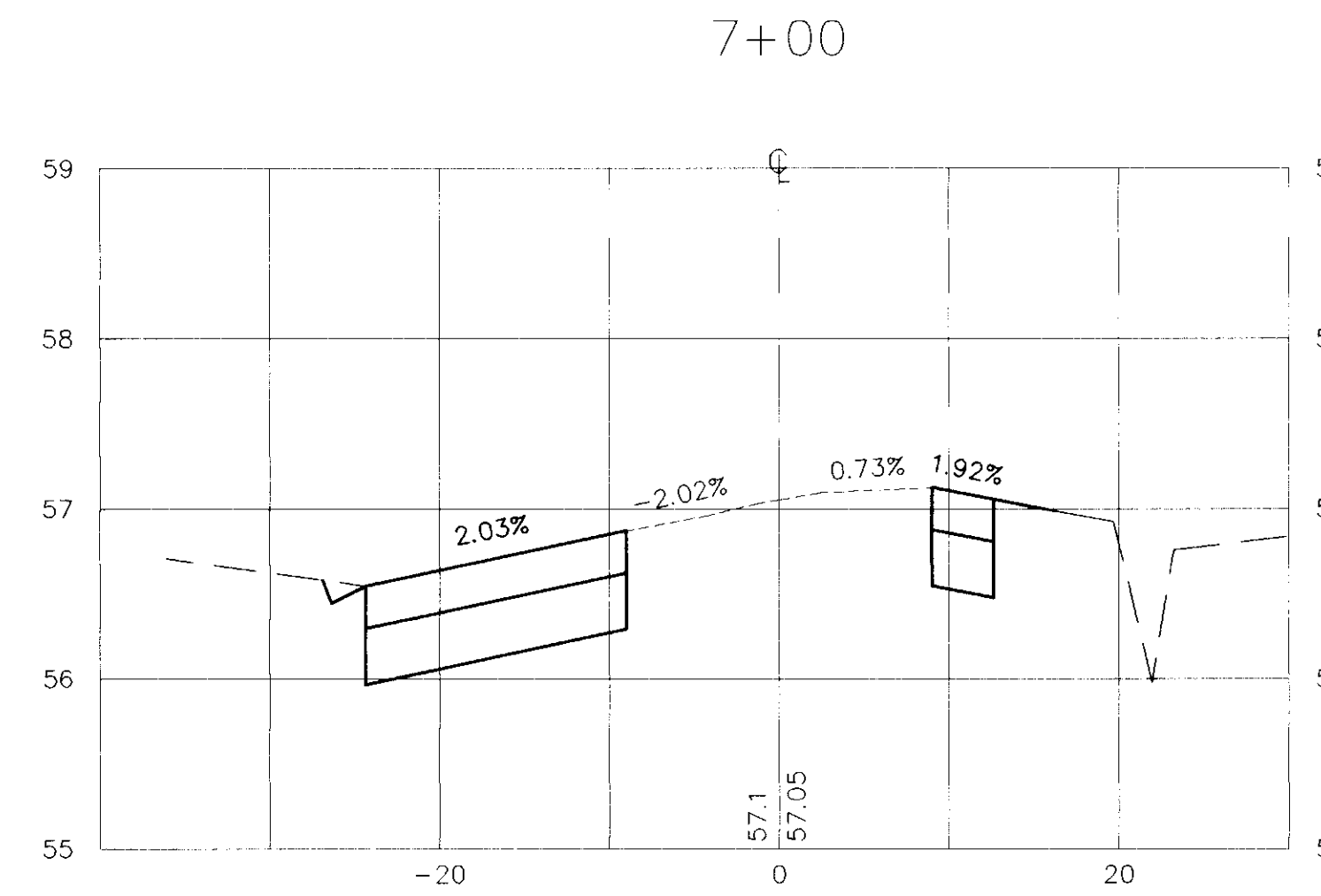
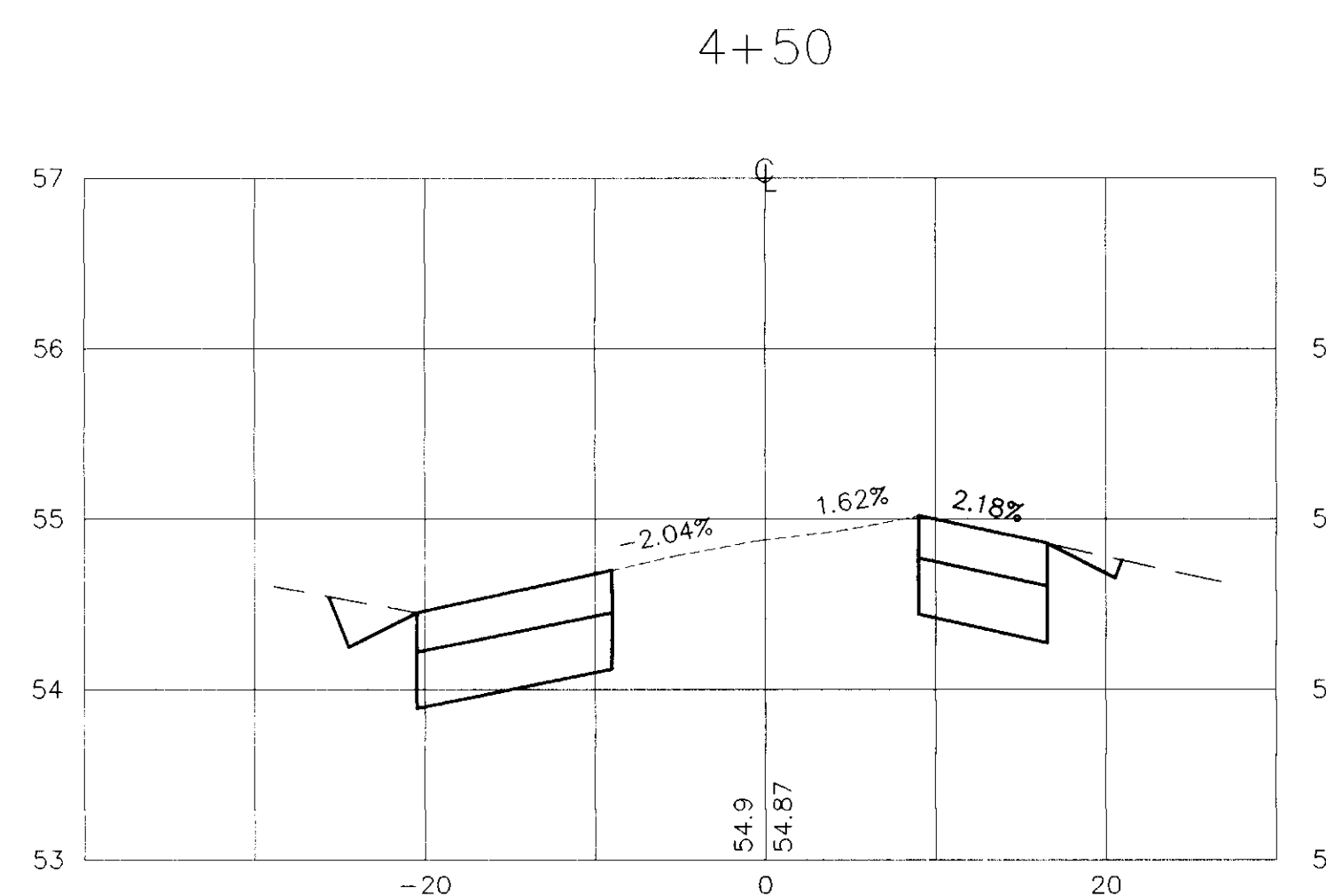
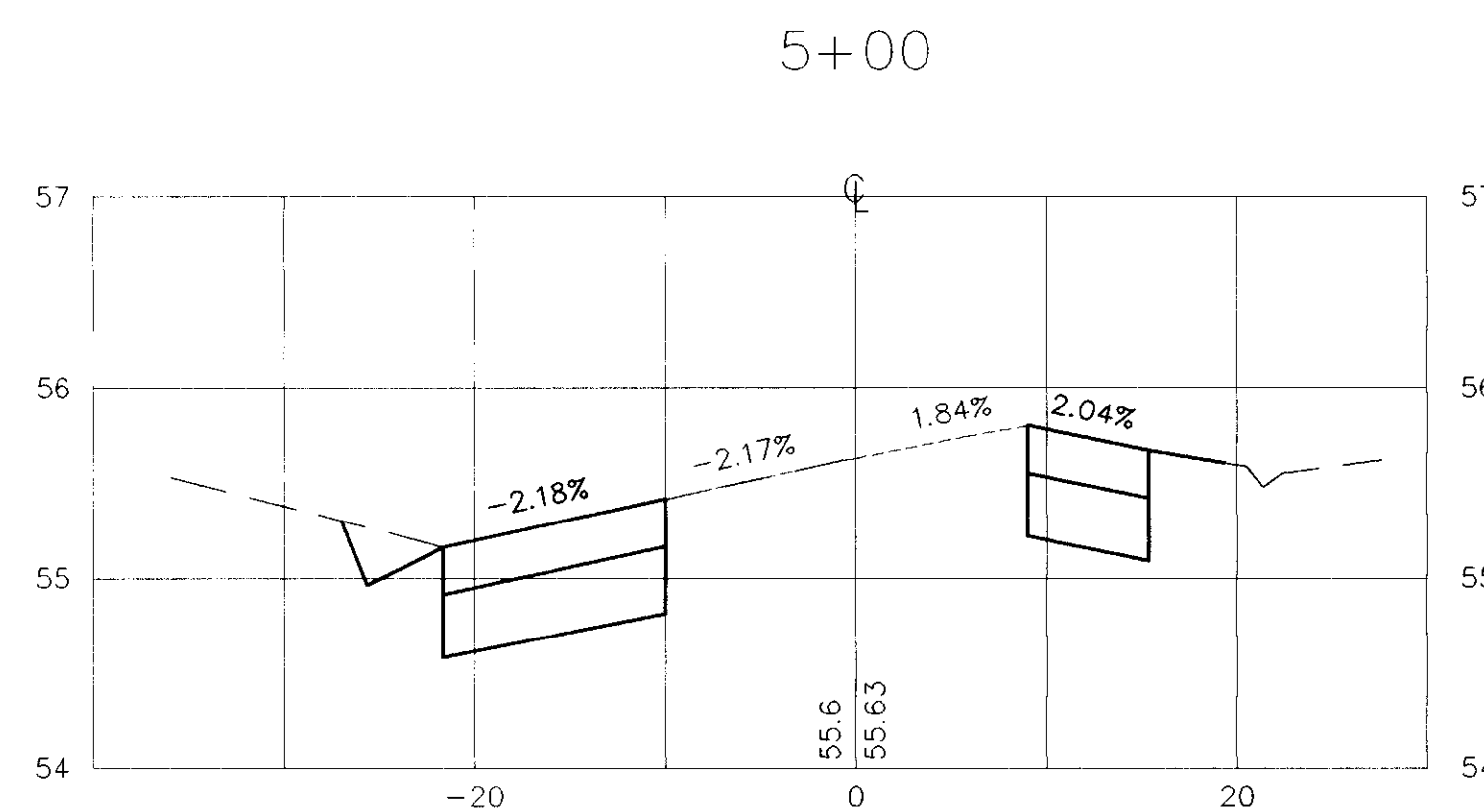
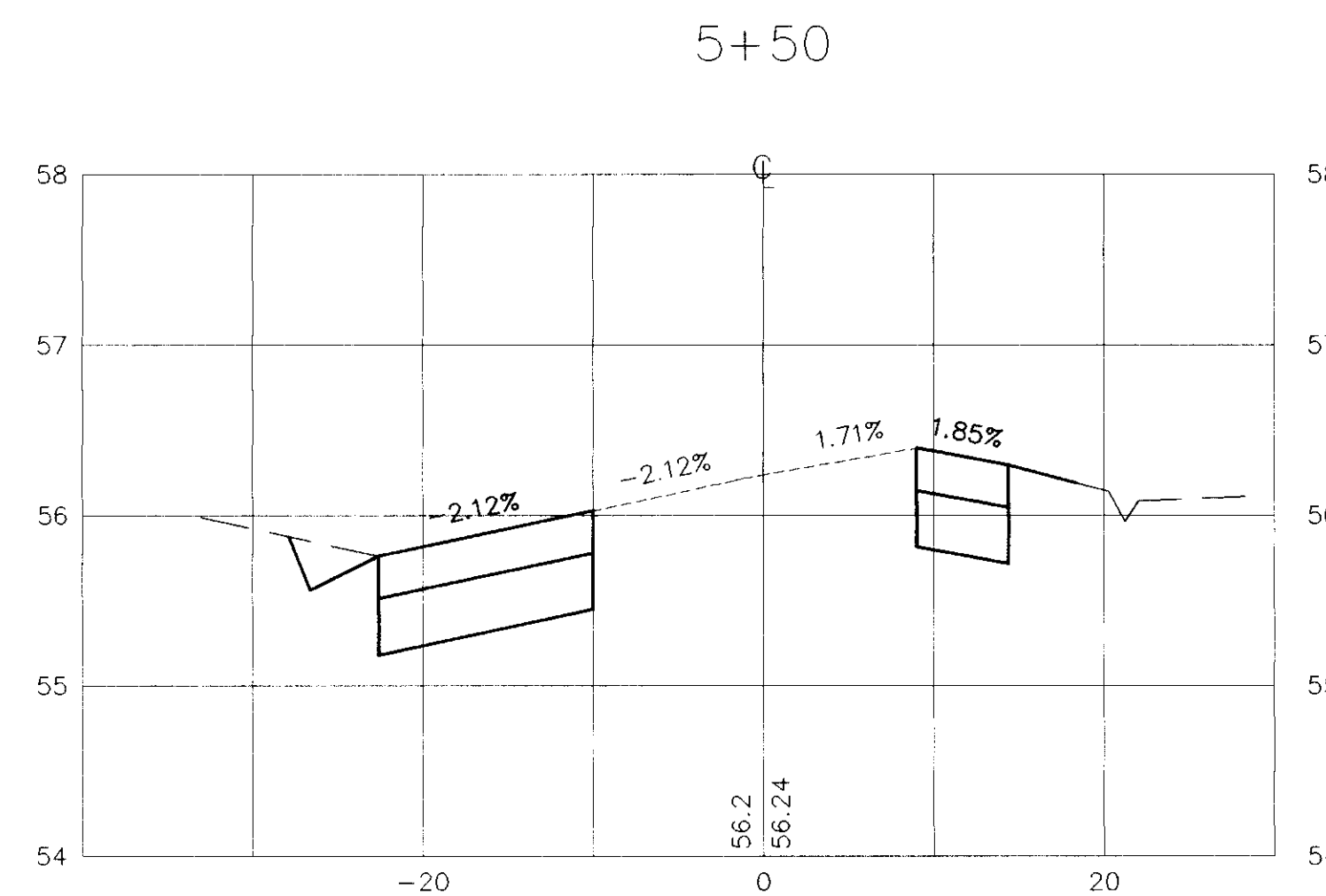
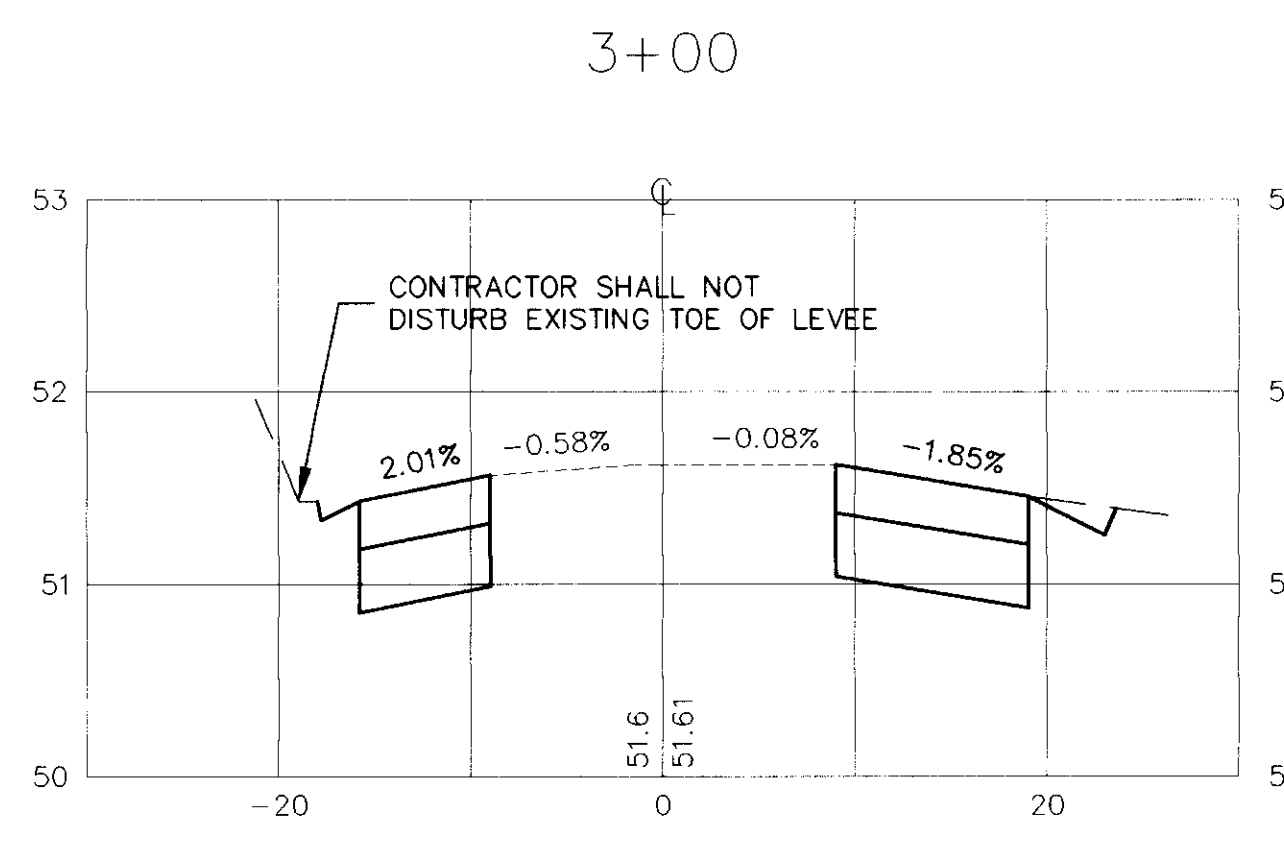
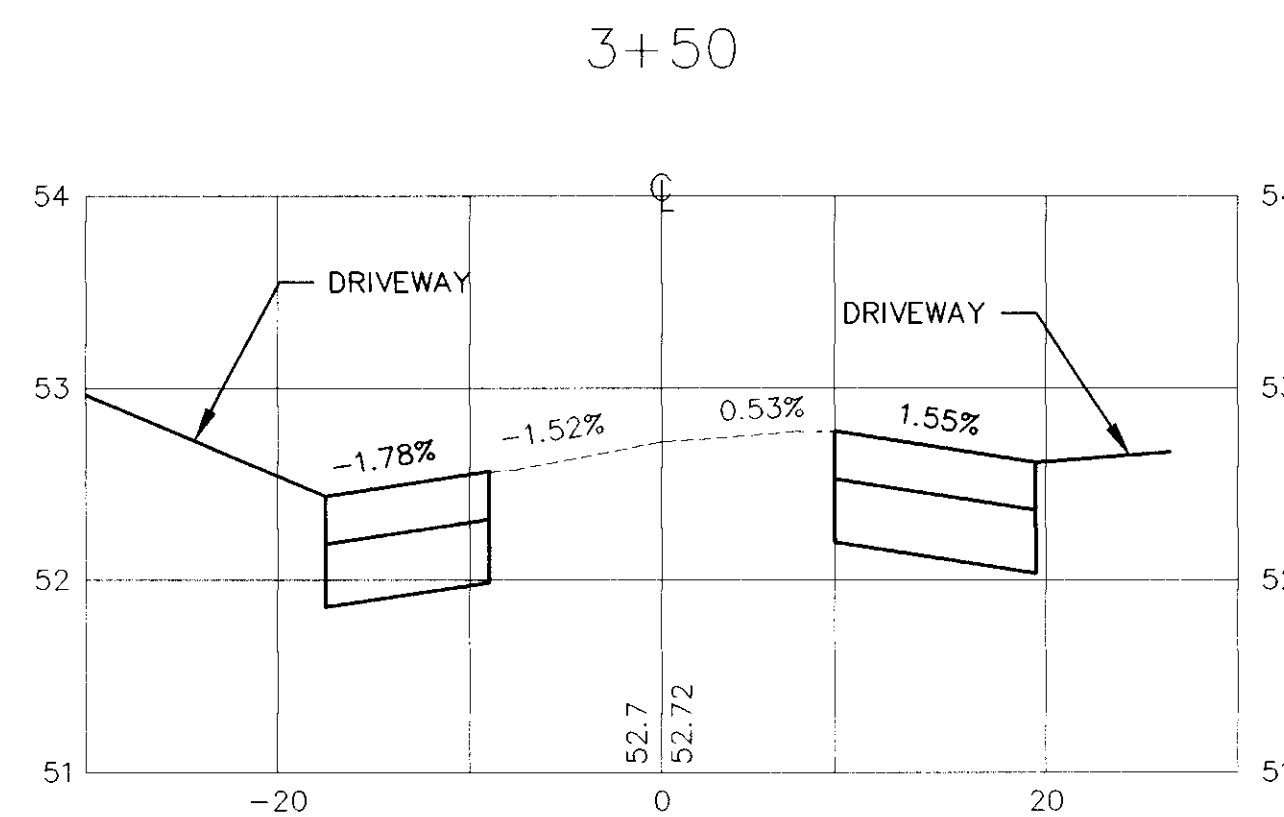
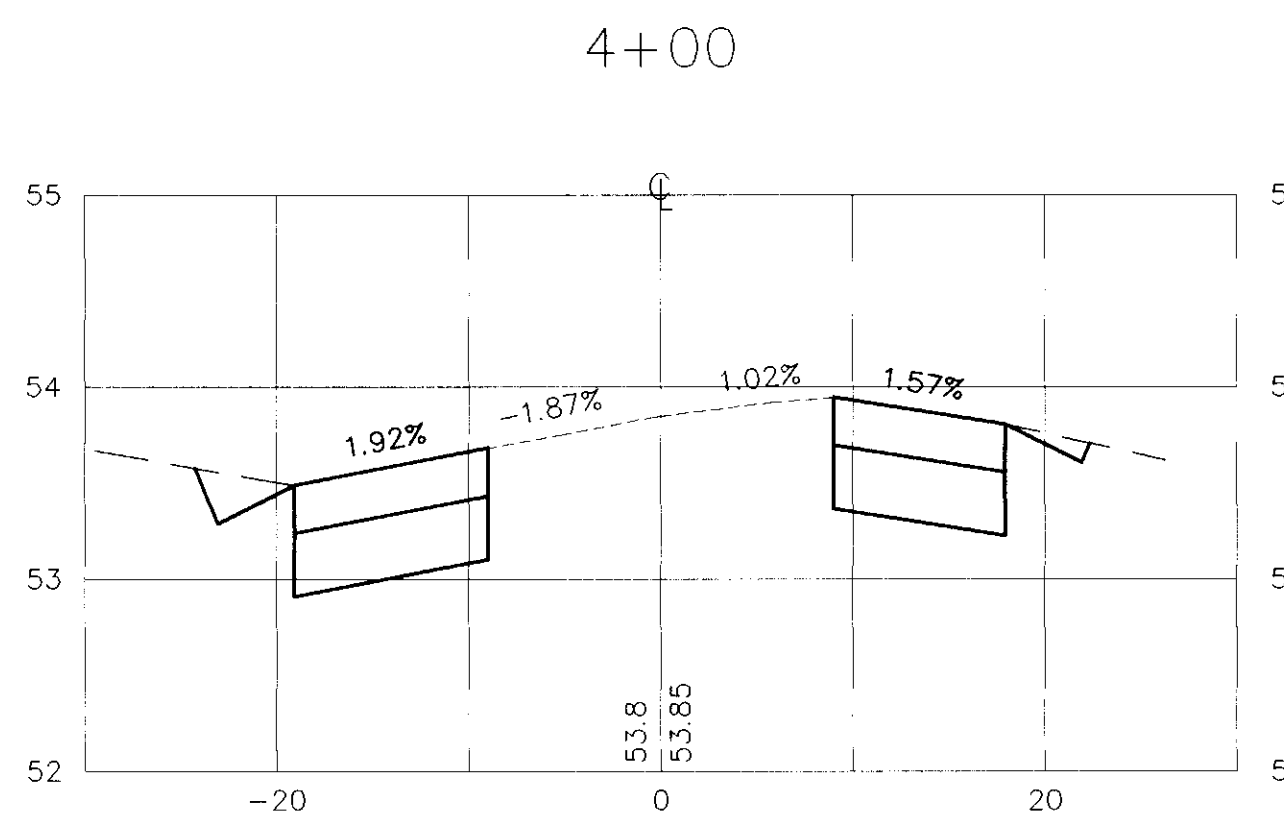
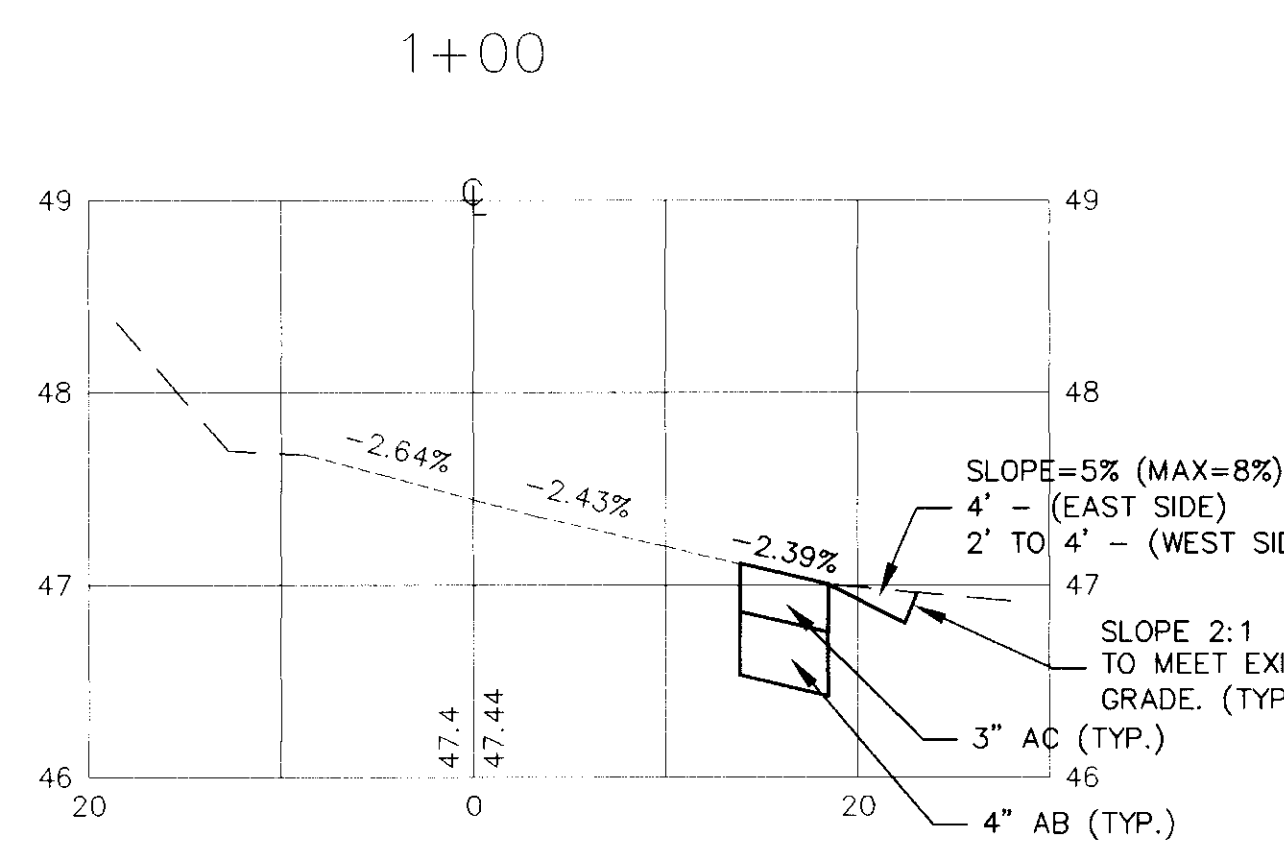
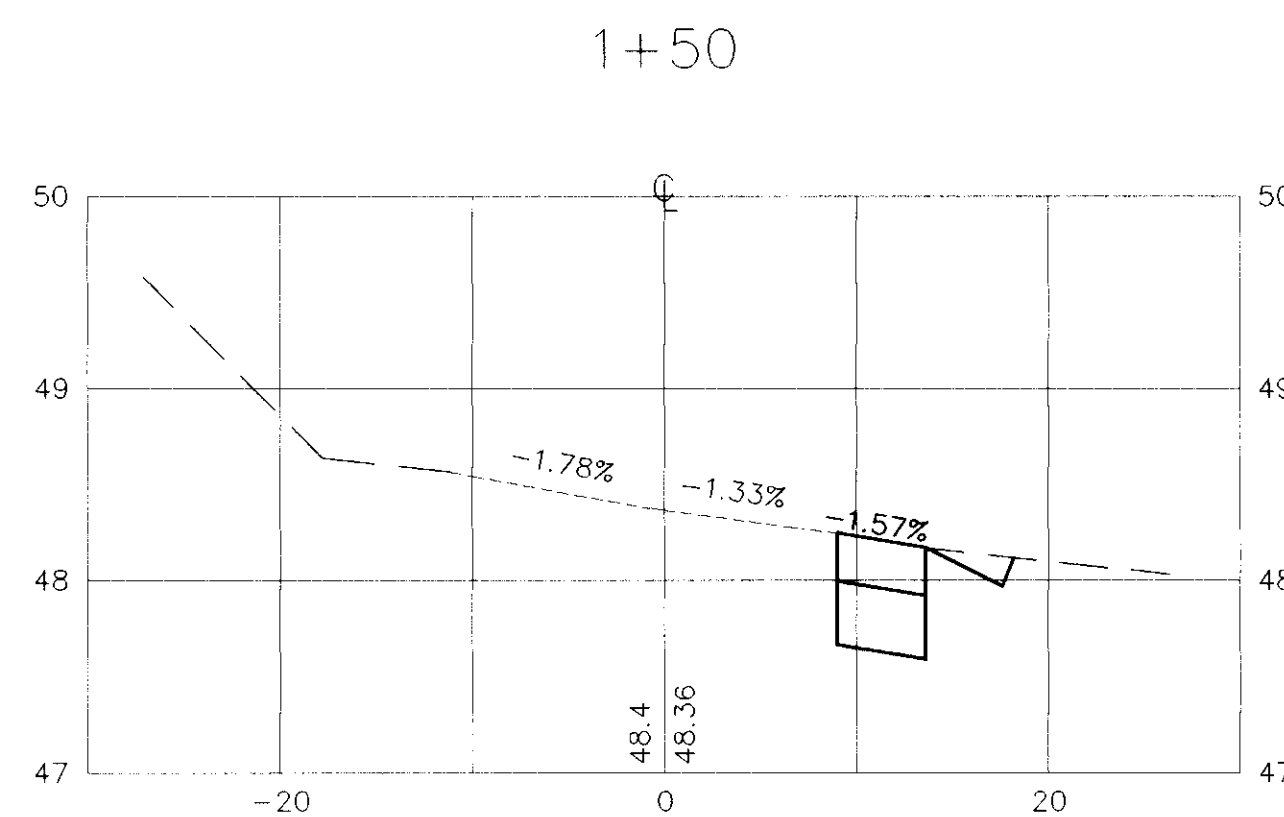
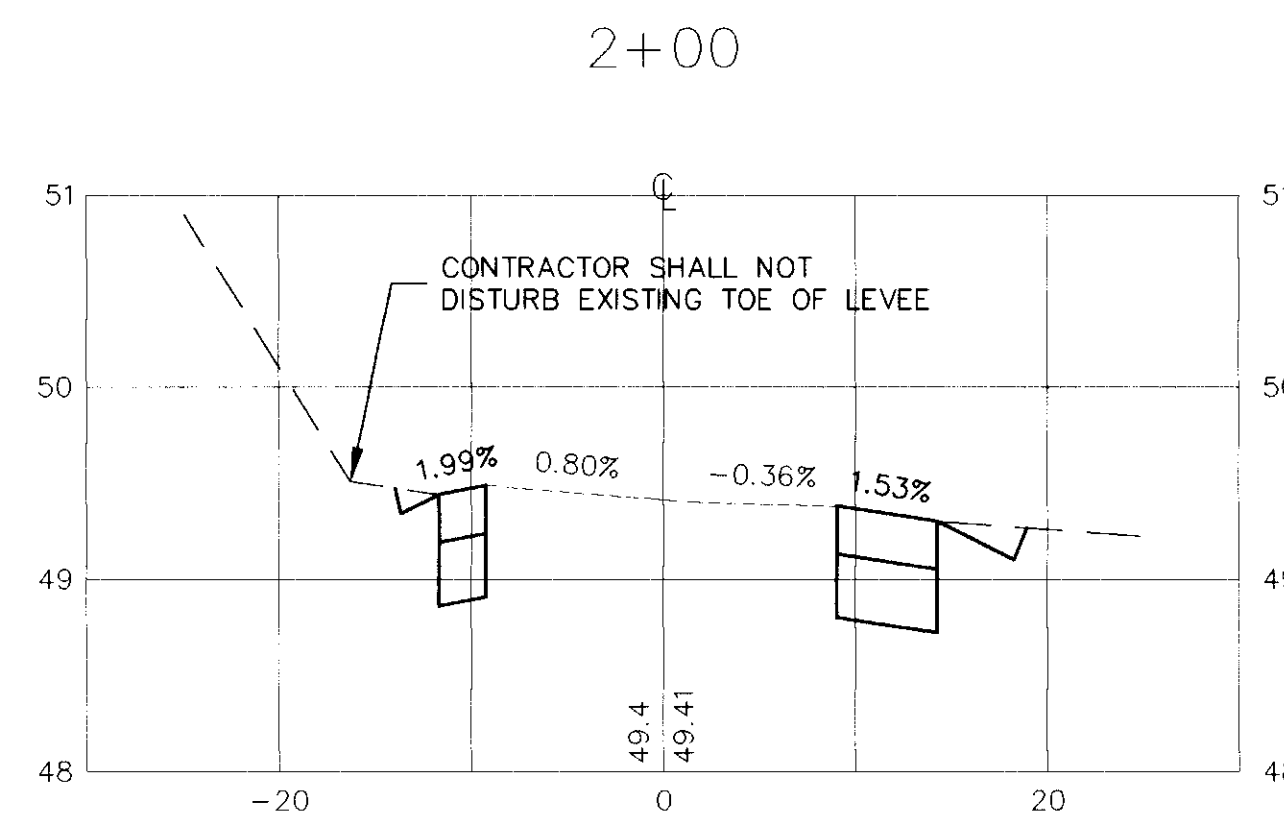
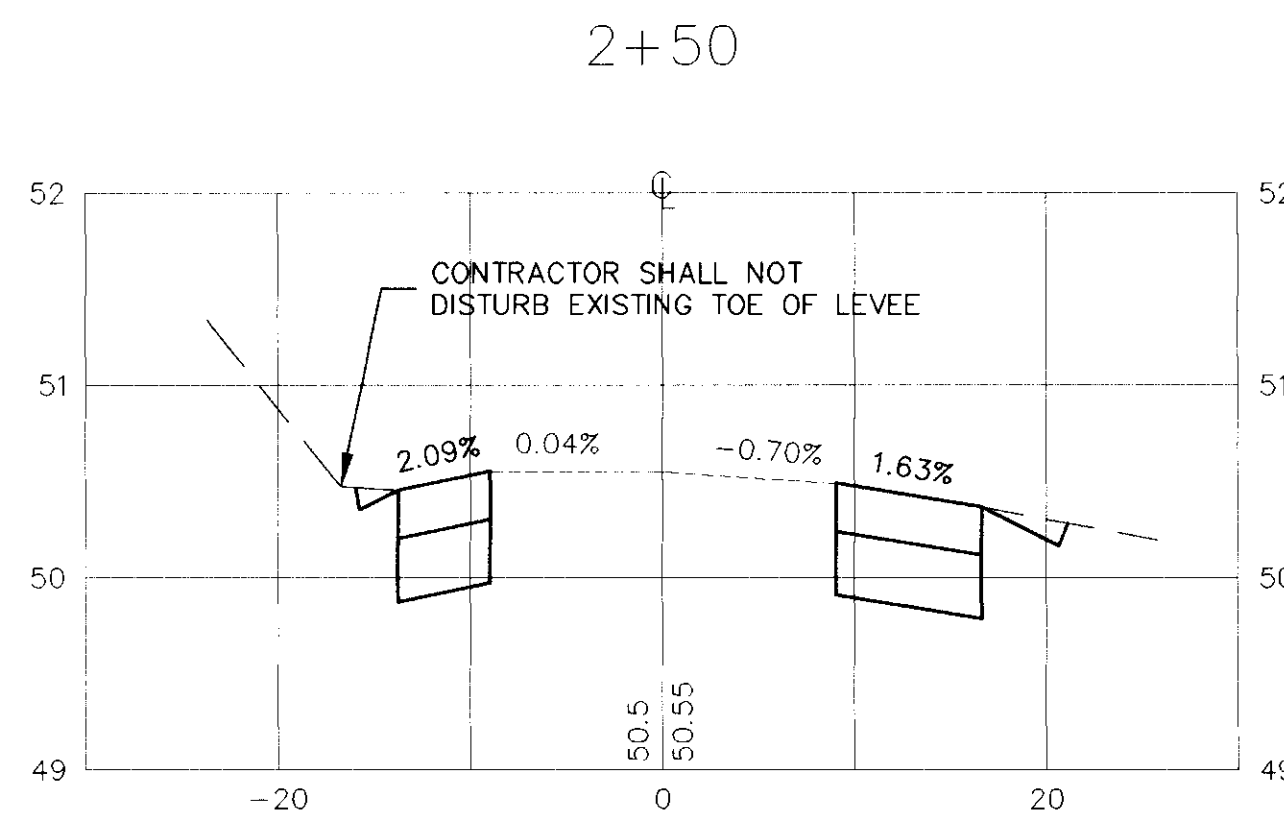

SECTION SCALE  
1" = 10' HORIZONTAL  
1" = 1' VERTICAL



NO.	DESCRIPTION	COUNTY APPROVAL	
		APPROVED BY	DATE

**SIEGFRIED ENGINEERING, Inc.**

Civil Engineering ■ Land Surveying ■ Structural Engineering ■ Planning  
4045 Coronado Ave. ■ Stockton, CA 95204-2396 ■ 209 943-2021 ■ FAX 209 942-0214



JOB NO.	DATE 11/23/98
F.B. NO.	
DRAWN VGD	
DESIGN VGD	
CHECKED LAC	

**NORTH 99 FRONTAGE ROAD**

STREET IMPROVEMENTS  
CROSS SECTIONS STA: 1+00 TO 7+00

SHEET	5
OF 6	
COMPUTER FILE NO.	
DRAWING FILE NO.	

COUNTY OF SAN JOAQUIN DEPARTMENT OF PUBLIC WORKS		DATE:
APPROVED:	DIRECTOR OF PUBLIC WORKS	RCE NO.:
		EXP. DATE:

F:\98CAD\98415\CIVIL\2415105.DWG

SU 3288

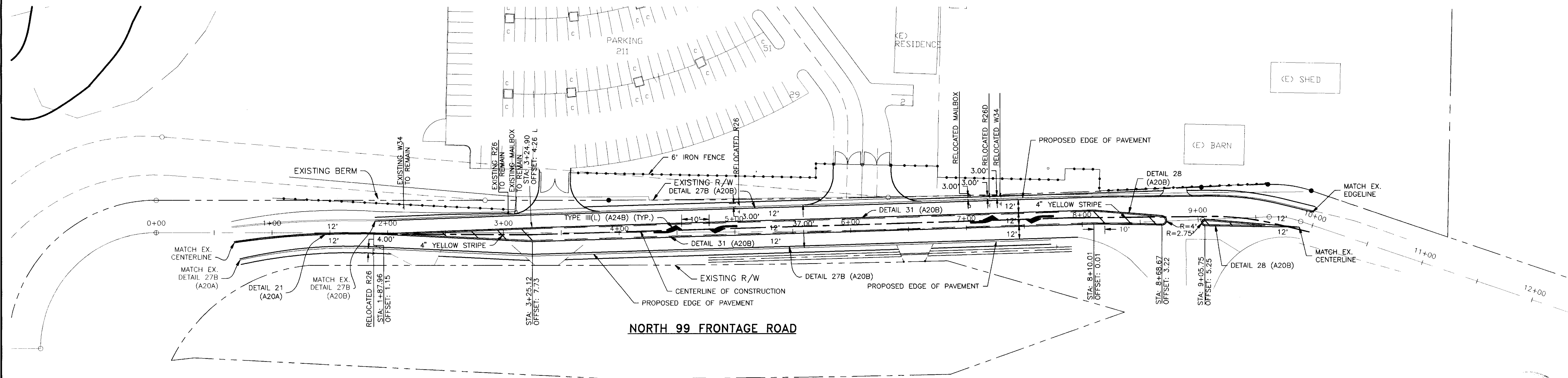

SCALE: 1"=40'



STRIPING PER CALTRANS STANDARD PLANS (JULY 1997)

NO.	DESCRIPTION	COUNTY APPROVAL	
		APPROVED BY	BY

**SIEGFRIED ENGINEERING, Inc.**

Civil Engineering ■ Land Surveying ■ Structural Engineering ■ Planning  
4045 Coronado Ave. ■ Stockton, CA 95204-2396 ■ 209 943-2021 ■ FAX 209 942-0214

Job No. \_\_\_\_\_ Submitted By \_\_\_\_\_ R.C.E. No. \_\_\_\_\_ Exp. \_\_\_\_\_



JOB NO.
DATE 11/23/98
F.B. NO.
DRAWN VGD
DESIGN VGD
CHECKED LAC

**NORTH 99 FRONTAGE ROAD**

STREET IMPROVEMENTS  
STRIPING PLAN

COUNTY OF SAN JOAQUIN DEPARTMENT OF PUBLIC WORKS	
APPROVED: _____	DATE: _____
DIRECTOR OF PUBLIC WORKS	RCE NO. _____
	EXP. DATE: _____

SHEET
4
OF 6
COMPUTER FILE NO.
DRAWING FILE NO.

F:\98CAD\98415\CIVIL\2415P04.DWG

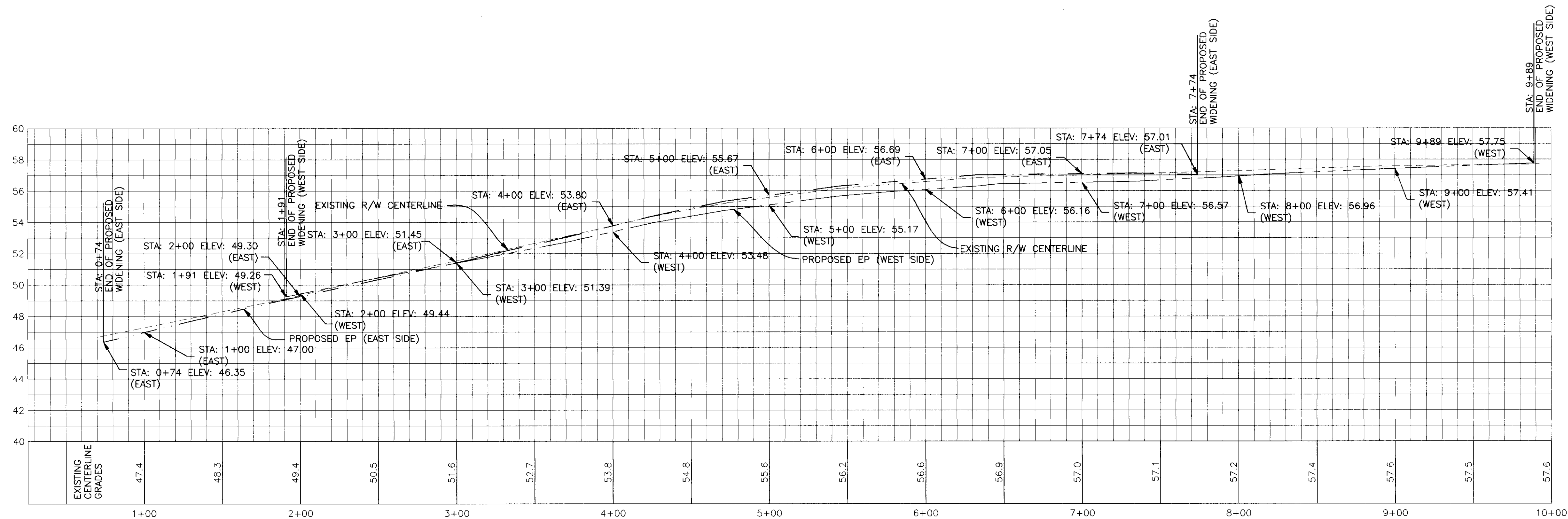

**SECTION SCALE**  
 1" = 40' HORIZONTAL  
 1" = 4' VERTICAL

## PROFILE

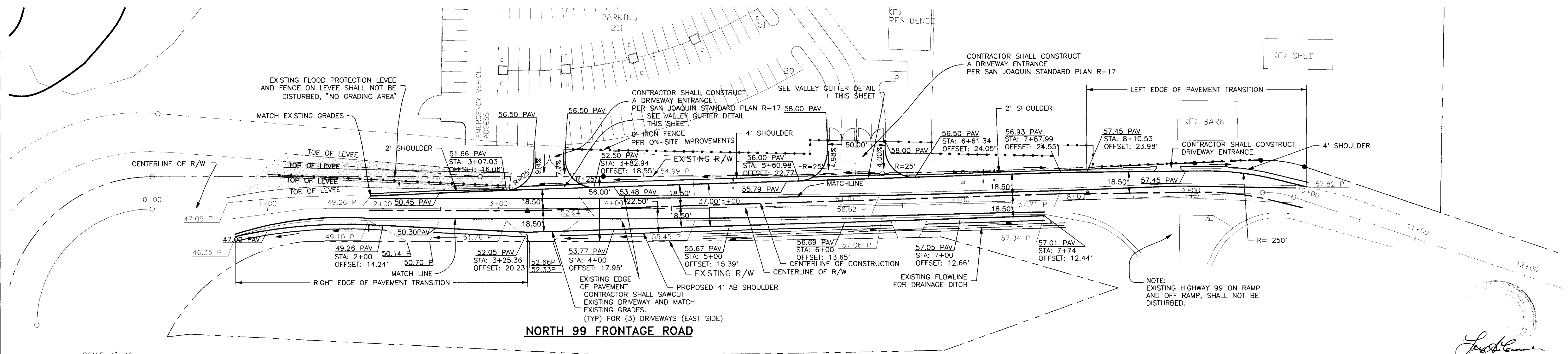

## PLAN

- NOTE:  
 1. STATIONING SHOWN IS CENTERLINE OF R/W.  
 2. RELOCATION OF EXISTING SIGNING IS SHOWN ON SHEET 4.  
 3. DIRECTION OF FLOW

SCALE: 1"=40'

VALLEY GUTTER DETAIL

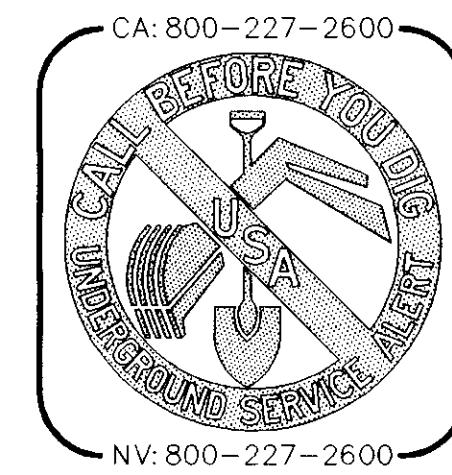
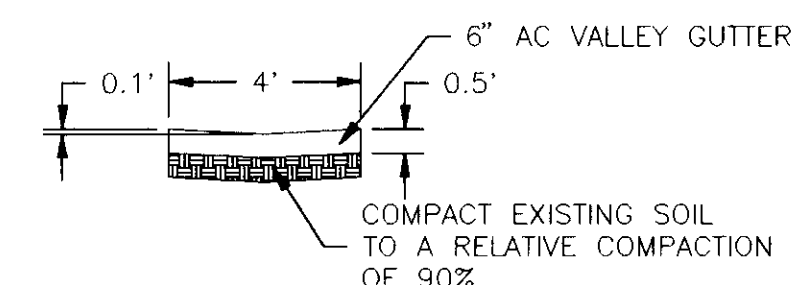

NO.	DESCRIPTION	COUNTY APPROVAL

**SIEGFRIED ENGINEERING, Inc.**

Civil Engineering ■ Land Surveying ■ Structural Engineering ■ Planning

4045 Coronado Ave. ■ Stockton, CA 95204-2396 ■ 209 943-2021 ■ FAX 209 942-0214

Job No. \_\_\_\_\_ Submitted By \_\_\_\_\_ R.C.E. No. \_\_\_\_\_ Exp. \_\_\_\_\_



JOB NO.
DATE 11/23/98
F.B. NO.
DRAWN VGD
DESIGN VGD
CHECKED LAC

**NORTH 99 FRONTAGE ROAD**

STREET IMPROVEMENTS  
 PLAN AND PROFILE

SHEET
3
OF 6
COMPUTER FILE NO.
DRAWING FILE NO.

F:\98CAD\98415\CIVIL\2415IP03.DWG

SU 3289



GENERAL NOTES

1. ALL CONSTRUCTION AND MATERIALS SHALL BE IN ACCORDANCE WITH THE LATEST EDITION OF THE SAN JOAQUIN COUNTY IMPROVEMENT STANDARDS, SPECIAL PROVISIONS.
2. THE CONTRACTOR SHALL BE IN RECEIPT OF SAN JOAQUIN COUNTY APPROVED PLANS PRIOR TO CONSTRUCTION.
3. DRAWING NUMBERS SHOWN ON THE PLANS REFER TO SAN JOAQUIN COUNTY STANDARD PLANS, SHOWN THUS: EXAMPLE: R-17
4. THE CONTRACTOR SHALL BE RESPONSIBLE FOR PROTECTING FROM DAMAGE ALL EXISTING IMPROVEMENTS THAT ARE TO REMAIN. SUCH IMPROVEMENTS THAT ARE DAMAGED BY THE CONTRACTOR SHALL BE REPLACED AT HIS EXPENSE.
5. CONTRACTOR SHALL DEMOLISH, EXCAVATE, REMOVE AND DISPOSE OF ALL EXISTING CONCRETE CURB, GUTTER OR SIDEWALK, ASPHALT CONCRETE PAVING, CONCRETE CURB, AND DELETERIOUS MATERIAL AS REQUIRED TO CONSTRUCT THE CONTRACT WORK. ALL SUCH EXCESS MATERIAL GENERATED SHALL BE DISPOSED OF FROM THE SITE BY THE CONTRACTOR. SEE THIS SHEET FOR ADDITIONAL GRADING NOTES.
6. EXCAVATION OF 5 FEET OR MORE IN DEPTH WILL REQUIRE AN EXCAVATION PERMIT FROM THE STATE OF CALIFORNIA DEPARTMENT OF INDUSTRIAL SAFETY.
7. WORK IN PUBLIC RIGHT-OF-WAY IS SUBJECT TO THE APPROVAL AND ACCEPTANCE OF THE SAN JOAQUIN PUBLIC WORKS DEPARTMENT.
8. EXCEPT WHERE SPECIFICALLY AUTHORIZED BY VALID PERMITS FROM FISH AND GAME, CORP OF ENGINEERS, AND COUNTY FLOOD CONTROL DISTRICT, THE CONTRACTOR SHALL CONDUCT HIS OPERATION ENTIRELY OUTSIDE OF ANY FLOODPLAIN ANY FLOODPLAIN BOUNDARIES. FLOODPLAIN BOUNDARIES SHALL BE CLEARLY DELINEATED IN THE FIELD PRIOR TO CONSTRUCTION.
9. THE CONTRACTOR SHALL CHECK WITH THE UTILITY COMPANIES AND VERIFY ALL UTILITY LOCATIONS. IT SHALL BE CONTRACTOR'S SOLE RESPONSIBILITY TO PROTECT ALL EXISTING UTILITIES SO THAT NO DAMAGE RESULTS TO THEM DURING THE PERFORMANCE OF HIS CONTRACT. THE CONTRACTOR SHALL BE REQUIRED TO COOPERATE WITH OTHER CONTRACTORS AND UTILITY COMPANIES INSTALLING NEW STRUCTURES, UTILITIES AND SERVICES TO THE DEVELOPMENT.
10. WHENEVER EXISTING PAVEMENT IS BROKEN OR CUT DURING THE INSTALLATION OF THE WORK COVERED BY THESE PLANS AND SPECIFICATIONS, THE PAVEMENT SHALL BE REPLACED WITH PAVEMENT MATERIALS EQUAL TO BETTER THAN THE MATERIAL USED IN THE ORIGINAL PAVING. THE FINISHED PAVEMENT SHALL BE SUBJECT TO THE APPROVAL OF THE COUNTY ENGINEER IF LOCATED WITHIN COUNTY RIGHT-OF-WAY.
11. PAYMENT FOR PAVEMENT WILL BE MADE FOR THE AREAS SHOWN ON THE PLANS. REPLACEMENT OF PAVEMENT WHICH IS BROKEN OR CUT IN THE INSTALLATION OF THE IMPROVEMENTS COVERED BY THESE PLANS AND SPECIFICATIONS AND WHICH LIES OUTSIDE OF SAID AREAS, SHALL BE INCLUDED IN THE STREET CONTRACTOR'S UNIT PRICE FOR PAVEMENT, AND NO ADDITIONAL PAYMENT SHALL BE MADE FOR SUCH WORK.
12. CONTRACTOR AGREES THAT HE SHALL ASSUME SOLE AND COMPLETE RESPONSIBILITY FOR JOBSITE CONDITIONS DURING THE COURSE OF CONSTRUCTION OF THIS PROJECT INCLUDING SAFETY OF ALL PERSONS AND PROPERTY, THAT THIS REQUIREMENT SHALL APPLY CONTINUOUSLY AND NOT BE LIMITED TO NORMAL WORKING HOURS, AND THAT THE CONTRACTOR SHALL DEFEND, INDEMNIFY AND HOLD THE OWNER AND THE ENGINEER HARMLESS FROM ANY AND ALL LIABILITY, REAL OR ALLEGED, IN CONNECTION WITH THE PERFORMANCE OF WORK ON THIS PROJECT, EXCEPTING FOR LIABILITY ARISING FROM THE SOLE NEGLIGENCE OF THE OWNER OR THE ENGINEER.
13. EXISTING UTILITIES ARE SHOWN AS THEY ARE BELIEVED TO EXIST. THE OWNER AND THE ENGINEER DO NOT ACCEPT RESPONSIBILITY FOR THEIR ACCURACY. PRIOR TO COMMENCING ANY WORK, THE CONTRACTOR SHALL HAVE EACH UTILITY COMPANY ACCURATELY LOCATE IN THE FIELD THEIR MAINS AND SERVICE LINES. IT SHALL BE THE CONTRACTOR'S RESPONSIBILITY TO PROTECT ALL EXISTING UTILITIES, SO THAT NO DAMAGE RESULTS TO THEM DURING THE PERFORMANCE OF HIS CONTRACT. CONTACT "U.S.A." (800-227-2600).
14. ATTENTION IS CALLED TO: SECTION 1540 (A) (1) OF THE CONSTRUCTION SAFETY ORDERS (TITLE 8 CALIFORNIA ADMINISTRATION CODE SECTION 1540), ISSUED BY THE OCCUPATIONAL SAFETY AND HEALTH STANDARDS BOARD PURSUANT TO THE CALIFORNIA OCCUPATIONAL SAFETY AND HEALTH ACT OF 1973, AS AMENDED, WHICH STATES:
- "PRIOR TO OPENING AN EXCAVATION, EFFORT SHALL BE MADE TO DETERMINE WHETHER UNDERGROUND INSTALLATION I.E., SEWER, WATER, FUEL, ELECTRIC LINES, ETC., WILL BE ENCOUNTERED AND, IF SO, WHERE SUCH UNDERGROUND INSTALLATIONS ARE LOCATED. WHEN THE EXCAVATION APPROACHES THE APPROXIMATE LOCATION OF SUCH AN INSTALLATION, THE EXACT LOCATION SHALL BE DETERMINED BY CAREFUL PROBING OR HAND DIGGING AND WHEN IT IS UNCOVERED, ADEQUATE PROTECTION SHALL BE PROVIDED FOR THE EXISTING INSTALLATION. ALL KNOWN OWNERS OF UNDERGROUND FACILITIES IN THE AREA CONCERNED SHALL BE ADVISED OF PROPOSED WORK AT LEAST 48 HOURS PRIOR TO THE START OF ACTUAL EXCAVATION."
15. CONSTRUCTION STAKING: CONSTRUCTION STAKING IS NORMALLY PERFORMED BY THE ENGINEER WHO PREPARED THE PLAN. THIS PERMITS APPROPRIATE ON-SITE INTERPRETATION AND ADJUSTMENT OF THE PLANS, IF NECESSARY. CONTRACTOR SHALL NOTIFY THE ENGINEER FORTY-EIGHT (48) HOURS PRIOR TO THE ACTUAL NEED FOR STAKING. ANY STAKING REQUESTED BY THE CONTRACTOR OR HIS SUBCONTRACTORS WHICH EXTENDS BEYOND THE ORIGINAL SCOPE OF WORK DEFINED IN THESE PLANS SHALL BE SUBJECT TO AN EXTRA WORK CHARGE TO THE CONTRACTOR.
- ALL MONUMENTS IN WORK SITE AREA THAT WILL BE DISTURBED DURING CONSTRUCTION SHALL BE SWING TIED BY A LAND SURVEYOR PRIOR TO STARTING WORK. CONTRACTOR SHALL BE RESPONSIBLE FOR PROTECTING MONUMENTS DURING CONSTRUCTION AND FOR RESETTING MONUMENTS IF DISTURBED.
- THIS NOTE GIVES FORMAL NOTICE THAT THE FIRM OF SIEGFRIED ENGINEERING, INC. CANNOT, AND WILL NOT, TAKE RESPONSIBILITY FOR ERRORS OR OMISSIONS, IF ANY, WHICH MIGHT OCCUR AND WHICH COULD HAVE BEEN AVOIDED OR DETECTED AND/OR CORRECTED OR MITIGATED HAD SIEGFRIED ENGINEERING, INC. PERFORMED THE CONTRACT STAKING WORK.
16. "CLASS A SUBGRADE" SHALL BE GRADED TO RELATIVE COMPACTION OF 90% TO A DEPTH OF SIX INCHES.
16. THE DESIGN OF THE FRONTAGE ROAD IMPROVEMENTS ARE BASED UPON A TOPOGRAPHIC PERFORMED BY OTHERS. SIEGFRIED ENGINEERING, INC. CANNOT, AND WILL NOT, TAKE RESPONSIBILITY FOR ERRORS OR OMISSIONS, IF ANY, WHICH MIGHT OCCUR AND WHICH COULD HAVE BEEN AVOIDED OR DETECTED AND/OR CORRECTED OR MITIGATED HAD SIEGFRIED ENGINEERING, INC. PERFORMED THE CONTRACT TOPOGRAPHIC AND BOUNDARY SURVEY.
17. THE CONTRACTOR SHALL CONDUCT HIS OPERATION ENTIRELY OUTSIDE OF ANY NO GRADING AREA. THESE AREAS SHALL BE CLEARLY DELINEATED IN THE FIELD PRIOR TO CONSTRUCTION.
18. DUST CONTROL SHALL BE PERFORMED AT ALL THE TIMES, AT THE CONTRACTOR'S EXPENSE, TO MINIMIZE ANY DUST NUISANCE AND SHALL BE IN ACCORDANCE WITH SECTION 10 OF CALTRANS STANDARD SPECIFICATIONS.
19. DELETED
20. ALL STATIONS ARE STREET CENTERLINE STATIONS.
21. BENCHMARK: CITY OF LODI BENCHMARK # 718, ELEVATION 55.58 NORTHSIDE OF TURNER ROAD, 800' EAST OF COLOMA STREET
22. DEVELOPER: CALVARY BIBLE CHURCH P.O. BOX 1503 LODI, CA 95240
23. THE CONTRACTOR SHALL BE RESPONSIBLE FOR ALL PERMITS AND LICENSES REQUIRED FOR THE CONSTRUCTION AND COMPLETION OF THE PROJECT.
24. THE CONTRACTOR SHALL FURNISH, INSTALL, OPERATE AND MAINTAIN ALL MACHINERY, APPLIANCES AND EQUIPMENT TO MAINTAIN ALL EXCAVATIONS FREE FROM WATER DURING CONSTRUCTION, AND SHALL DEWATER AND DISPOSE OF THE WATER SO AS TO NOT CAUSE INJURY TO PUBLIC OR PRIVATE PROPERTY, OR TO CAUSE A NUISANCE OR MENACE TO THE PUBLIC. THE DEWATERING SYSTEM SHALL BE INSTALLED AND OPERATED SO THE GROUNDWATER LEVEL OUTSIDE THE EXCAVATION IS NOT REDUCED TO THE EXTENT WHICH WOULD CAUSE DAMAGE OR ENDANGER ADJACENT STRUCTURES OR PROPERTY. ALL COSTS FOR DEWATERING SHALL BE INCLUDED IN THE UNIT PRICE BID FOR ALL PIPE CONSTRUCTION. THE STATIC WATER LEVEL SHALL BE DRAWN DOWN A MINIMUM OF 1 FOOT BELOW THE BOTTOM OF EXCAVATION TO MAINTAIN THE UNDISTURBED STATE OF NATURAL SOILS AND ALLOW THE PLACEMENT OF ANY FILL TO THE SPECIFIED DENSITY. DISPOSAL OF WATER SHALL BE IN ACCORDANCE WITH THE COUNTY REQUIREMENTS AND SHALL NOT DAMAGE PROPERTY, CREATE A PUBLIC NUISANCE OR VIOLATE THE LAW. THE CONTRACTOR SHALL HAVE ON HAND, PUMPING EQUIPMENT AND MACHINERY IN GOOD WORKING CONDITION FOR EMERGENCIES AND SHALL HAVE WORKMEN AVAILABLE FOR ITS OPERATION. THE DEWATERING SYSTEM SHALL OPERATE CONTINUOUSLY UNTIL BACK-FILL HAS BEEN COMPLETED TO 1 FOOT ABOVE THE NORMAL STATIC GROUNDWATER LEVEL.
25. WHERE WORK IS BEING DONE IN AN OFFSITE EASEMENT, THE CONTRACTOR SHALL NOTIFY THE PROPERTY OWNER 48 HOURS PRIOR TO COMMENCING WORK.
26. ACCESS TO EXISTING BUSINESSES SHALL BE MAINTAINED DURING CONSTRUCTION.
27. AFFECTED BUSINESSES SHALL BE NOTIFIED PRIOR TO START OF CONSTRUCTION.
28. ALL SIGNS AND PAVEMENT MARKINGS SHALL CONFORM TO THE MANUAL OF UNIFORM TRAFFIC CONTROL DEVICES AND S.J. CO. IMPROVEMENT STANDARDS.

GRADING NOTES

1. GRADING AND LAND STABILIZATION SHALL INCLUDE EXCAVATION AND FILL OF LOTS AND STREETS WITHIN THE "GRADING LIMITS" IN ACCORDANCE WITH THE SPECIFICATIONS OF THE SOILS ENGINEER AND UNDER THE DIRECTION, SUPERVISION, MONITORING, TESTING AND APPROVAL OF THE OWNER AND OWNER'S SOILS ENGINEER.
2. GRADING AND LAND STABILIZATION SHALL INCLUDE COST OF DEWATERING; REMOVING FROM THE SITE ALL STRIPPED VEGETATION, DEBRIS, STRUCTURES, POWER POLES, EXISTING PAVEMENT, BUILDINGS, TREES, AND OTHER DELETERIOUS MATERIALS.
3. ALL GRADING AND PLACEMENT OF FILL FOR BUILDING PADS SHALL BE PER SPECIFICATIONS FURNISHED BY THE SOILS ENGINEER. PREPARATION AND PLACEMENT OF FILL SHALL BE OBSERVED AND TESTED BY THE SOILS ENGINEER SO THAT HE CAN CERTIFY TO THE CONFORMANCE OF THE COMPLETED FILL SPECIFICATIONS. THE CONTRACTOR SHALL EXCAVATE, FILL AND GRADE THE PROJECT SITE IN ORDER THAT THE SITE IMPROVEMENTS CAN BE CONSTRUCTED TO THE GRADES AND SLOPES SHOWN ON THE PLANS. ANY FILL PLACED SHALL BE PROPERLY COMPACTED AS REQUIRED BY THE SPECIFICATIONS OF THE SOILS ENGINEER.
4. STOCKPILES OF EXISTING DELETERIOUS MATERIAL SHALL BE DISPOSED OF UNDER THE DIRECTION AND SUPERVISION OF THE OWNER AND OWNER'S SOILS ENGINEER.



CA: 800-227-2600

NV: 800-227-2600

NO.	DESCRIPTION	COUNTY APPROVAL	
		APPROVED BY	BY

SIEGFRIED ENGINEERING, Inc.

Civil Engineering ■ Land Surveying ■ Structural Engineering ■ Planning

4045 Coronado Ave. ■ Stockton, CA 95204-2396 ■ 209 943-2021 ■ FAX 209 942-0214

Job No. \_\_\_\_\_ Submitted By \_\_\_\_\_

R.C.E. No. \_\_\_\_\_



JOB NO.
DATE 11/23/98
F.B. NO.
DRAWN VGD
DESIGN VGD
CHECKED LAC

NORTH 99 FRONTAGE ROAD

STREET IMPROVEMENTS  
GENERAL NOTES AND SPECIFICATIONS

SHEET

2

OF 6

COMPUTER FILE NO.

DRAWING FILE NO.

F:\98CAD\98415\CIVIL\415IP02.DWG

# NORTH 99 FRONTAGE ROAD IMPROVEMENTS

## 18621 N HIGHWAY 99

### SAN JOAQUIN COUNTY

#### (CALVARY BIBLE CHURCH)

#### ABBREVIATIONS

ABBREVIATION	DESCRIPTION
@	AT
AB	AGGREGATE BASE
ABS	ACRYLONITRILE-BUTADIENE-STYRENE
AC	ASPHALT CONCRETE
BC	BEGINNING OF CURVE
BO	BLOWOFF
BOC	BACK OF CURB
BOW	BACK OF WALK
BVC	BEGINNING OF VERTICAL CURVE
BW	BOTTOM OF WALL
C & G	CURB AND GUTTER
C, G, & SW	CURB, GUTTER, AND SIDEWALK
CL	CENTERLINE
CB	CATCHBASIN
CO	CLEANOUT
C.O.S.	CITY OF STOCKTON
CR	CURB RETURN
D OR SD	STORM DRAIN
DIA	DIAMETER
DIP	DUCTILE IRON PIPE
DWG	DRAWING
(E)	EAST
EC	END OF CURVE
EEP	EXISTING EDGE OF PAVEMENT
EL OR ELEV	ELEVATION
EP	EDGE OF PAVEMENT
ESMT	EASEMENT
EVC	END OF VERTICAL CURVE
EX OR EXIST.	EXISTING
FL	FLOWLINE
FH	FIRE HYDRANT
FOC	FACE OF CURB
FT	FEET
G OR GRD	GROUND
GB	GRADE BREAK
HORIZ	HORIZONTAL
HP	HIGH POINT
HPS	HIGH PRESSURE SODIUM
ID	INSIDE DIAMETER
IN.	INCH
LF	LINEAL FEET
LH	LAMPHOLE
LP	LOW POINT
LT	LEFT
MAX	MAXIMUM
MH	MAINTENANCE HOLE
MIN	MINIMUM
(N)	NORTH
NO.	NUMBER
NRCP	NON-REINFORCED CONCRETE PIPE
NTS	NOT TO SCALE
OD	OUTSIDE DIAMETER
P OR PAV	PAVEMENT
PBMH	PACIFIC BELL MAINTENANCE HOLE
PC	POINT OF CURVATURE
PCC	POINT OF COMPOUND CURVATURE
POT	POINT OF TANGENCY
PP	POWER POLE
PRC	POINT OF REVERSE CURVATURE
PT	POINT
PUE	PUBLIC UTILITY EASEMENT
PVC	POLYVINYL CHLORIDE
PL	PROPERTY LINE
R	RADIAL OR RADIUS
R/W	RIGHT-OF-WAY
RC	ROLL-CURB
RCP	REINFORCED CONCRETE PIPE
RET	RETURN
RP	RADIUS POINT
RR	RAILROAD
RT	RIGHT
S OR SS	SANITARY SEWER
(S)	SOUTH
SL	STREET LIGHT
SW	SIDEWALK
SDMH	STORM DRAIN MAINTENANCE HOLE
SHT	SHEET
SSMH	SANITARY SEWER MAINTENANCE HOLE
STA	STATION
STD	STANDARD
TC OR TOC	TOP OF CURB
THRU	THROUGH
TI	TRAFFIC INDEX
TOB	TOP OF BANK
TOL	TOE OF LEVEE
TW	TOP OF WALL
TYP	TYPICAL
UV	UNDERGROUND VAULT
VC	VERTICAL CURVE
VCP	VITRIFIED CLAY PIPE
VERT	VERTICAL
W	WEST
(W)	PLUS OR MINUS
±	

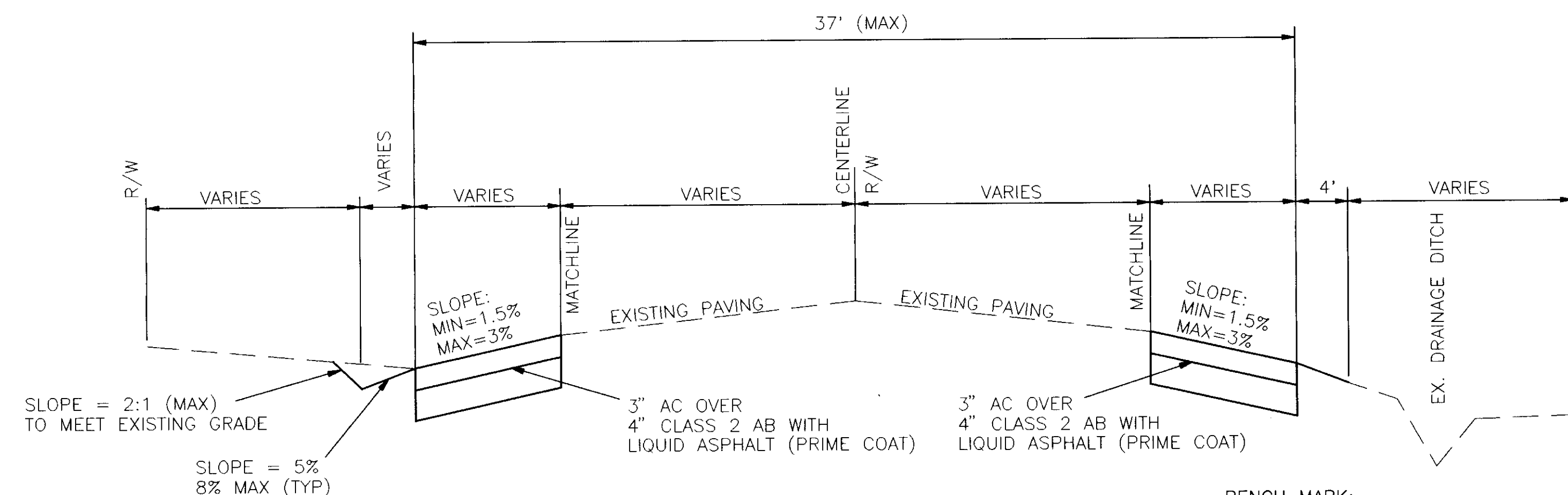
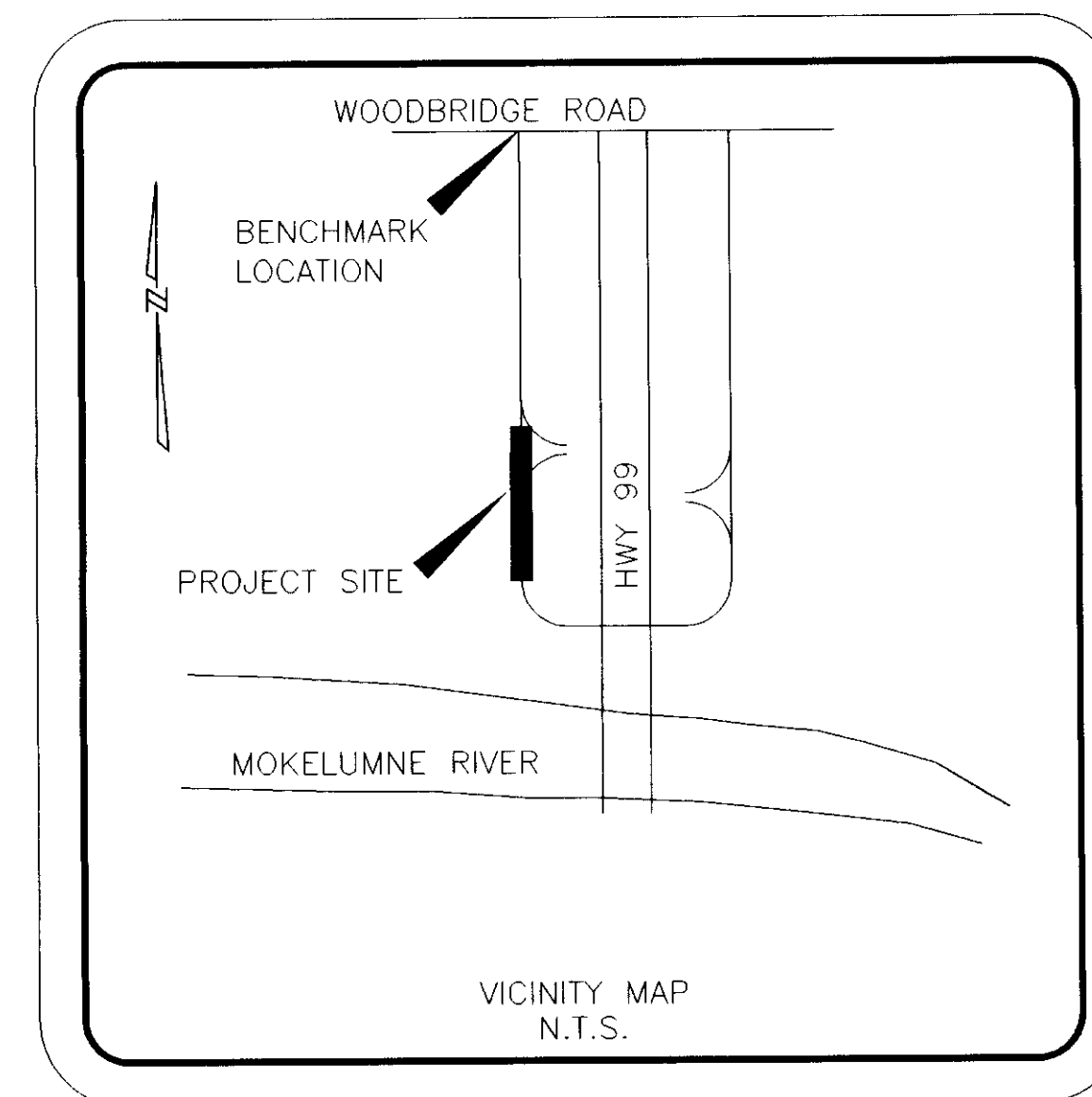

TYPICAL SECTION

NOT TO SCALE

BENCH MARK:  
U.S.G.S. DATUM  
CITY OF LODI BENCHMARK # 718  
ELEVATION 55.58  
NORTHSIDE OF TURNER ROAD, 800' EAST OF COLOMA STREET

#### SHEET INDEX:

SHEET NO.	DESCRIPTION
C-1	TITLE SHEET
C-2	NOTE SHEET
C-3	PLAN & PROFILE
C-4	STRIPING PLAN
C-5	CROSS SECTIONS
C-6	CROSS SECTIONS

#### LEGEND

EXISTING		PROPOSED
21.63 P	PAVEMENT ELEVATION	21.63 PAV
6.23 FL	FLOWLINE ELEVATION	6.23 FL
19x6	GROUND ELEVATION	19.68 G

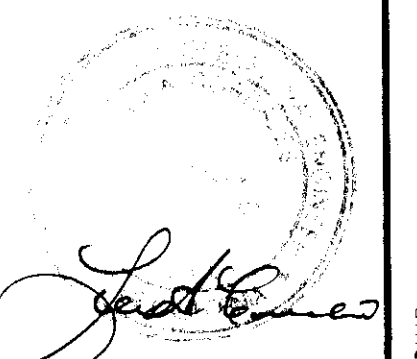

COUNTY OF SAN JOAQUIN DEPARTMENT OF PUBLIC WORKS	
APPROVED: <i>Denny M. Alarcon</i> DIRECTOR OF PUBLIC WORKS	DATE: 2/10/99 RCE NO: 21258 EXP DATE: 9/30/01
NORTH 99 FRONTAGE ROAD	
STREET IMPROVEMENTS TITLE SHEET	
SHEET 1 OF 6 COMPUTER FILE NO. DRAWING FILE NO.	

NO.	DESCRIPTION	APPROVED BY	BY
1	DESIGN		
2	CONSTRUCTION		
3	AS-BUILT		

#### SIEGFRIED ENGINEERING, Inc.

Civil Engineering ■ Land Surveying ■ Structural Engineering ■ Planning  
4045 Coronado Ave. ■ Stockton, CA 95204-2396 ■ 209 943-2021 ■ FAX 209 942-0214  
Job No. \_\_\_\_\_ Submitted By \_\_\_\_\_ R.C.E. No. \_\_\_\_\_ Exp. \_\_\_\_\_



JOB NO.	DATE 11/23/98
F.B. NO.	
DRAWN VGD	
DESIGN VGD	
CHECKED LAC	