

ADJUST MAINTENANCE HOLE FRAME AND COVER	
Locations	Quantity
Florida Avenue	
Sta. 12+54 (6' Lt)	1 SDMH
Sta. 12+73 (6' Rt)	1 SSMH
Myran Avenue	
Sta. 4+20 (5' Rt)	1 SSMH
Sta. 6+76 (4' Rt)	1 SSMH
Kenyon Street	
Sta. 2+49 (1' Lt)	1 SSMH
Sta. 4+95 (1' Lt)	1 SSMH
Sutro Avenue	
Sta. 24+34 (14' Lt)	1 SSMH
Sta. 24+42 (CL)	1 SSMH
Sta. 28+42 (CL)	1 SSMH
Sta. 28+53 (14' Lt)	1 SSMH
Report Avenue	
Sta. 32+40 (4' Rt)	1 SSMH
TOTAL	10 SSMH 1 SDMH

DRIVEWAYS				
Locations	TYPE D		TYPE E	
	No.	Area	No.	Area
Myran Avenue	10	110 SY	1	53 SY
Kenyon Street	14	145 SY	6	73 SY
Sutro Avenue	11	142 SY	1	25 SY
Report Avenue	13	139 SY	5	159 SY
TOTAL	48	536 SY	13	310 SY

18" STORM DRAIN INLET CATCH BASIN	
Locations	Quantity
Myran Avenue X Kenyon Avenue	3 EACH
Kenyon Street X Sutro Avenue	5 EACH
Kenyon Street	1 EACH
Report Avenue X Kenyon Avenue	2 EACH
Report Avenue	1 EACH
TOTAL	12 EACH

STORM DRAIN MAINTENANCE HOLE	
Locations	Quantity
Florida Avenue X Myran Avenue	1 EACH
Myran Avenue X Kenyon Avenue	1 EACH
Kenyon Street X Sutro Avenue	2 EACH
Sutro Avenue	1 EACH
Report Avenue X Kenyon Avenue	1 EACH
Report Avenue	1 EACH
TOTAL	7 EACH

PLANING ASPHALT CONCRETE PAVEMENT	
Locations	Quantity
Intersection Florida Avenue & Myran Avenue	184 SY
Myran Avenue Station. 7+37 to Sta. 7+62	67 SY
Kenyon Street Station. 2+40 to Sta. 4+07	111 SY
Sutro Avenue Station. 22+90 to Sta. 23+15	92 SY
Planing along Gutter	390 SY
Report Avenue Station. 29+60 to Sta. 29+85	61 SY
TOTAL	905 SY

ASPHALT CONCRETE (TYPE B)	
Locations	Quantity
Intersection Florida Avenue & Myran Avenue	47 Tons
Myran Avenue	173 Tons
Kenyon Street	276 Tons
Sutro Avenue	280 Tons
Report Avenue	172 Tons
Driveways (TRENCH)	141 Tons
	214 Tons
TOTAL	1,303 Tons

24" DIAMETER REINFORCED CONCRETE PIPE (CLASS III)	
Locations	Quantity
Florida Avenue	14 LF
Myran Avenue	438 LF
Kenyon Avenue	491 LF
TOTAL	943 LF

MODIFY SANITARY SEWER LATERALS	
Locations	Quantity
Myran Avenue	3 EACH
Kenyon Street	12 EACH
Sutro Avenue	2 EACH
Report Avenue	9 EACH
TOTAL	26 EACH

ASPHALT CONCRETE (TYPE B) (LEVELING)	
Locations	Quantity
Myran Avenue	74 Tons
Kenyon Street	107 Tons
Sutro Avenue	105 Tons
Report Avenue	75 Tons
TOTAL	361 Tons

18" DIAMETER REINFORCED CONCRETE PIPE (CLASS III)	
Locations	Quantity
Kenyon Street	360 LF

SHOULDER BACKING	
Locations	Quantity
Florida Avenue	15 Tons
Myran Avenue	30 Tons
Kenyon Street	50 Tons
Sutro Street	25 Tons
Report Street	40 Tons
TOTAL	160 Tons

PAVEMENT REINFORCING FABRIC	
Locations	Quantity
Myran Avenue	1,276 SY
Kenyon Street	1,913 SY
Sutro Avenue	1,670 SY
Report Avenue	1,273 SY
TOTAL	6,132 SY

12" DIAMETER REINFORCED CONCRETE PIPE (CLASS III)	
Locations	Quantity
Sutro Avenue	17 LF
Sutro Avenue	158 LF
Report Avenue	494 LF
TOTAL	669 LF

RECORD DRAWING
Date: 10/10/06
Enrique Silva

SH-4140

CONSTRUCTION NOTES

- [H] STA. 28+54 (5' LT)
CONSTRUCT STORM DRAIN MAINTENANCE HOLE.
SEE PROFILE FOR CALLOUT.
- [20] STA. 28+34 (22' RT)
EXISTING 18" STORM DRAIN
INLET CATCH BASIN
27 LF 12" RCP (CL. III) S = 0.01
INV. ● DI = 23.00' ± (OUT)
INV. ● MH = 20.73'
- [21] STA. 28+54.5 (16' RT)
EXISTING 18" STORM DRAIN
INLET CATCH BASIN
23 LF 12" RCP (CL. III) S = 0.01
INV. ● DI = 23.00' ± (OUT)
INV. ● MH = 19.55'

WATERLOO ROAD

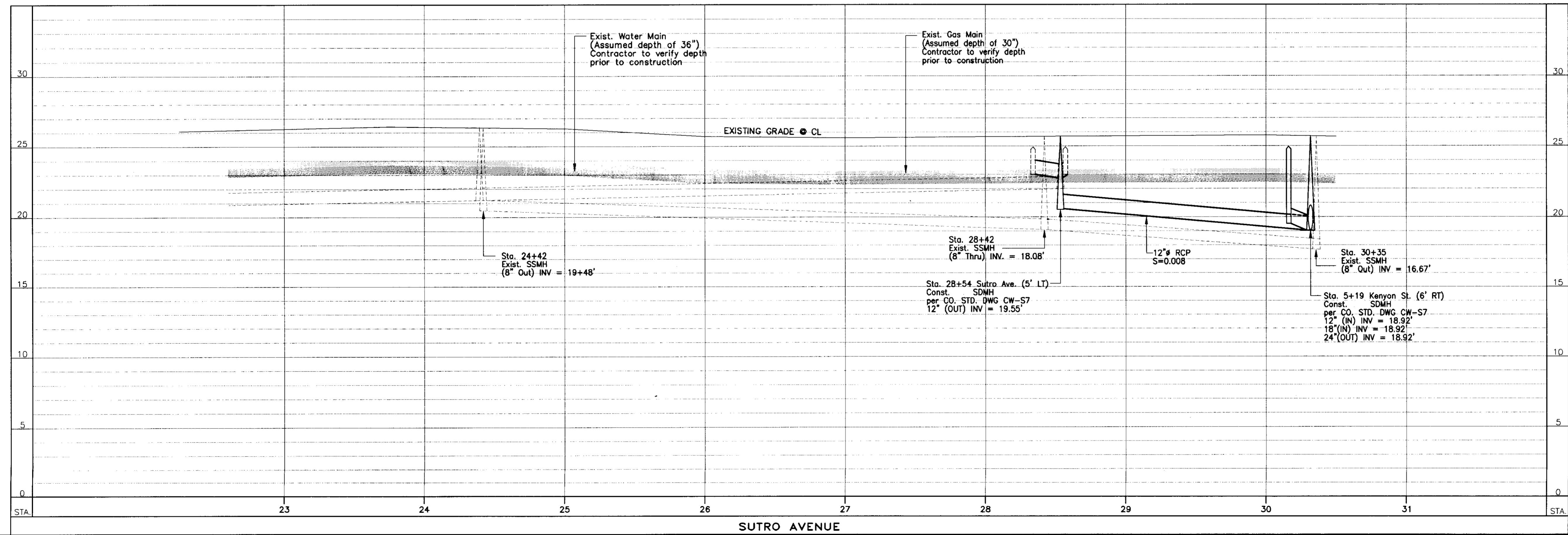
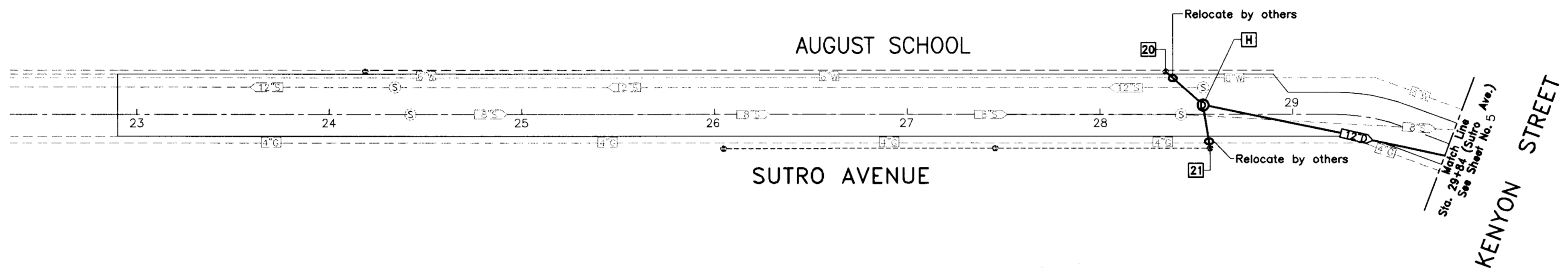

DATE: 10-08
DRAWN BY: [Signature]
CHECKED BY: [Signature]

DRAWN BY	DATE	PROJECT ENGINEER	DATE	CHECKED	DATE	APPROVAL RECOMMENDED	DATE
Enrique Silva	09/06	[Signature]	10/06	Jerry Violet	10/06	[Signature]	10/06
FILE NAME	DRAWER	SHEET NO.	ACAD		REVISIONS		DATE
E:\Projects\2007\CC Gianone 1C 75377\Plans\XGianone 1c Utilities.dwg							

SHEET NO.	TOTAL SHEETS
6	8

CONSTRUCTION NOTES

- [E] STA. 5+19 (6' RT) KENYON ST.
CONSTRUCT STORM DRAIN MAINTENANCE HOLE.
SEE PROFILE FOR CALLOUT.
- [F] STA. 8+50 (5' LT) KENYON ST.
CONSTRUCT STORM DRAIN MAINTENANCE HOLE.
SEE PROFILE FOR CALLOUT.
- [9] STA. 5+19 (22' RT) KENYON ST.
CONSTRUCT 18" STORM DRAIN INLET
CATCH BASIN
12 LF 12" RCP (CL. III) S = 0.01
INV. ● DI = 18.31'
INV. ● MH = 18.19'
- [10] STA. 5+75 (22' LT) KENYON ST.
CONSTRUCT 18" STORM DRAIN INLET
CATCH BASIN
35 LF 12" RCP (CL. III) S = 0.01
INV. ● DI = 18.66' (OUT)
- [11] STA. 5+40 (22' LT) KENYON ST.
CONSTRUCT 18" STORM DRAIN INLET
CATCH BASIN
27 LF 12" RCP (CL. III) S = 0.01
INV. ● DI = 18.36' (IN & OUT)
INV. ● MH = 18.19'
- [12] STA. 4+96 (22' LT) KENYON ST.
CONSTRUCT 18" STORM DRAIN INLET
CATCH BASIN
28 LF 12" RCP (CL. III) S = 0.01
INV. ● DI = 18.37' (IN & OUT)
INV. ● MH = 18.19'
- [13] STA. 4+71 (22' LT) KENYON ST.
CONSTRUCT 18" STORM DRAIN INLET
CATCH BASIN
25 LF 12" RCP (CL. III) S = 0.01
INV. ● DI = 18.62' (OUT)
- [14] STA. 8+34 (19' LT) KENYON ST.
CONSTRUCT 18" STORM DRAIN INLET
CATCH BASIN
29 LF 12" RCP (CL. III) S = 0.01
INV. ● DI = 19.21' (OUT)
INV. ● MH = 18.92'

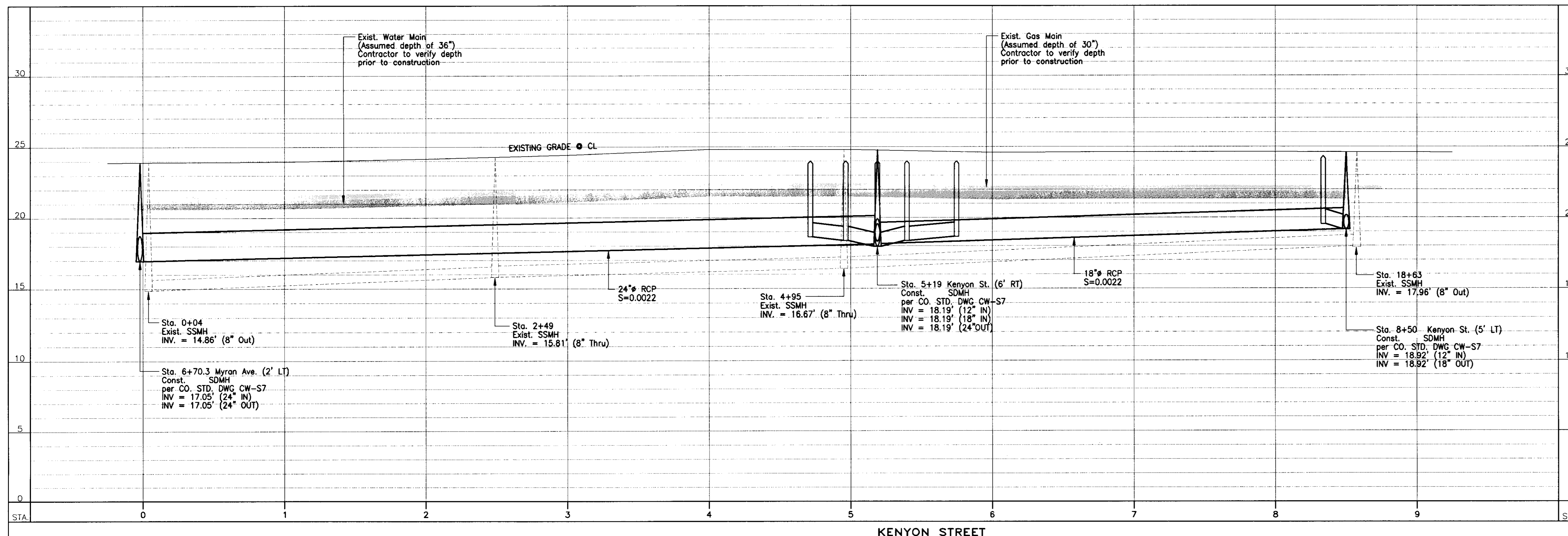
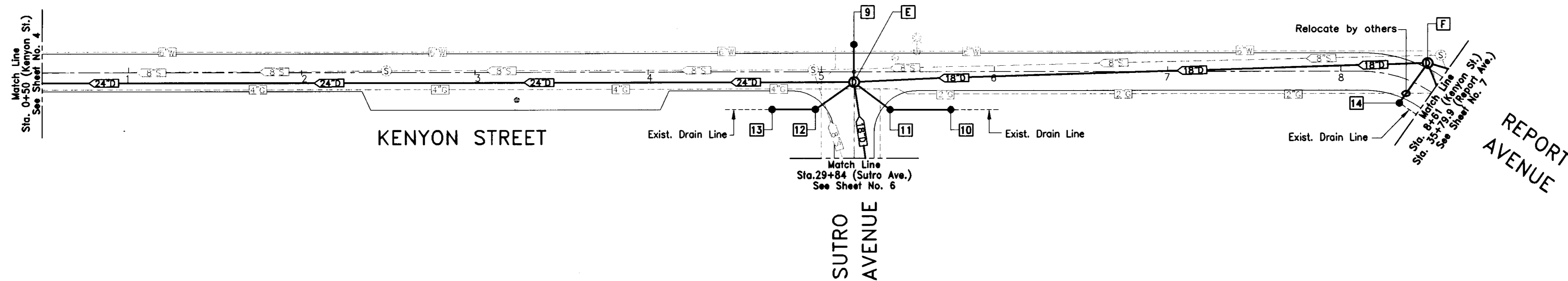

DRAWING
16-08

DRAWN BY	DATE	PROJECT ENGINEER	DATE	CHECKED	DATE	APPROVAL RECOMMENDED	DATE
Enrique Silva	09/06	[Signature]	10/5/06	Judy Violet	10/6/06	Manuel Adonis	10/12/06
FILE NAME	DRAWER	SHEET NO.	ACAD		REVISIONS	DATE	
E:\Projects\2007\CC Gianone 1C 75377\Plans\XGianone 1c Utilities.dwg							

COUNTY OF SAN JOAQUIN

SCALE : 1"=40' (Horiz.)

UTILITIES PLAN AND PROFILE

GIANONE PARK AREA STORM DRAINAGE IMPROVEMENTS PHASE 1-C
(Federal Aid Project No. SJC-06-03)

SHEET NO.	TOTAL SHEETS
5	8

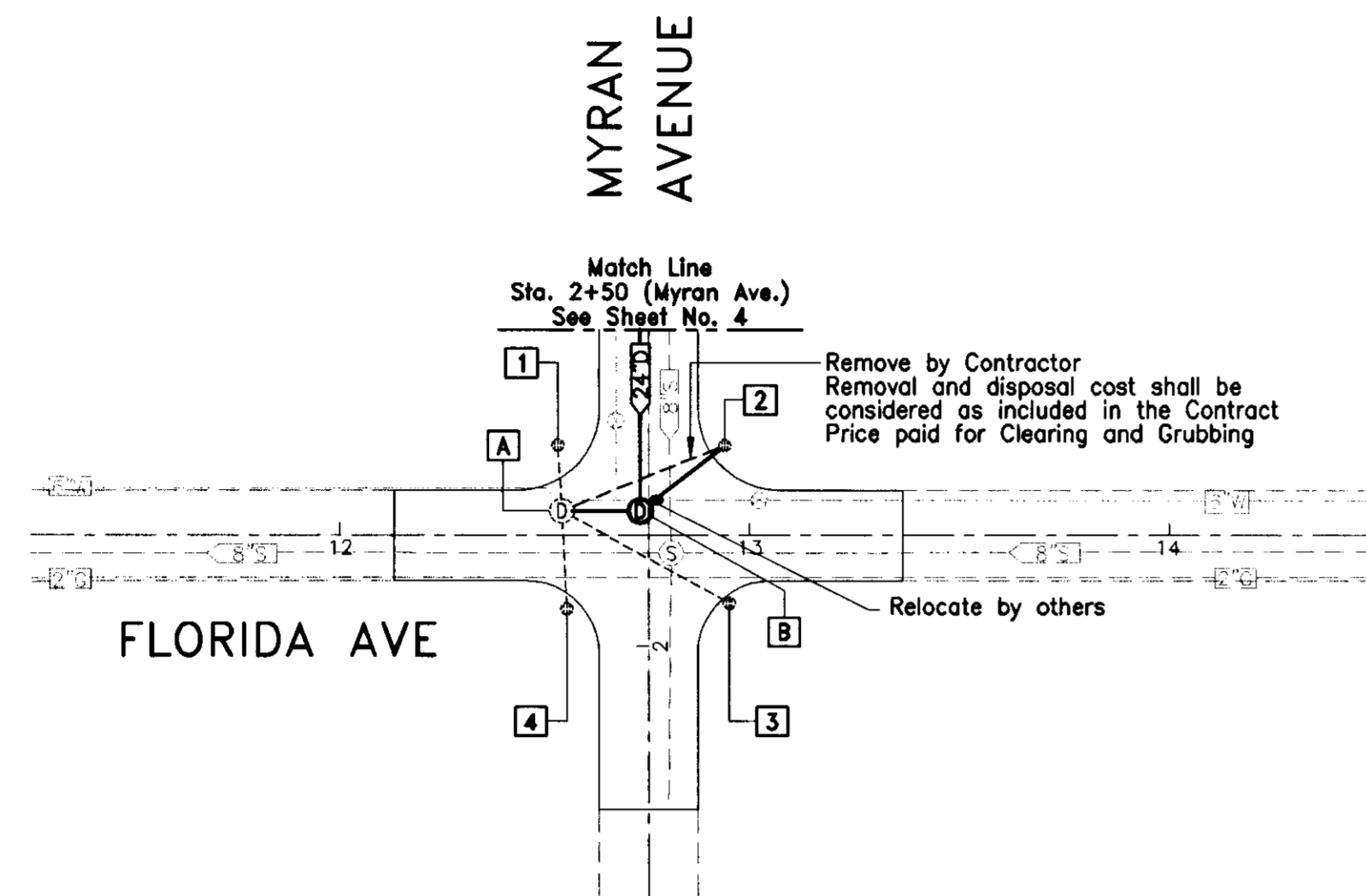

CONSTRUCTION NOTES

- [A] STA. 12+54 (6' LT) EXISTING STORM DRAIN MAINTENANCE HOLE SEE PROFILE FOR CALLOUT.
- [B] STA. 12+73 (6' LT) CONSTRUCT STORM DRAIN MAINTENANCE HOLE SEE PROFILE FOR CALLOUT.
- [1] EXISTING 18" STORM DRAIN INLET CATCH BASIN
- [2] STA. 12+94 (22' LT) EXISTING 18" STORM DRAIN INLET CATCH BASIN
26 LF 12" RCP (CL. III) S = 0.01
INV. @ DI = 16.29' ±
INV. @ MH = 16.03'
- [3] EXISTING 18" STORM DRAIN INLET CATCH BASIN
- [4] EXISTING 18" STORM DRAIN INLET CATCH BASIN

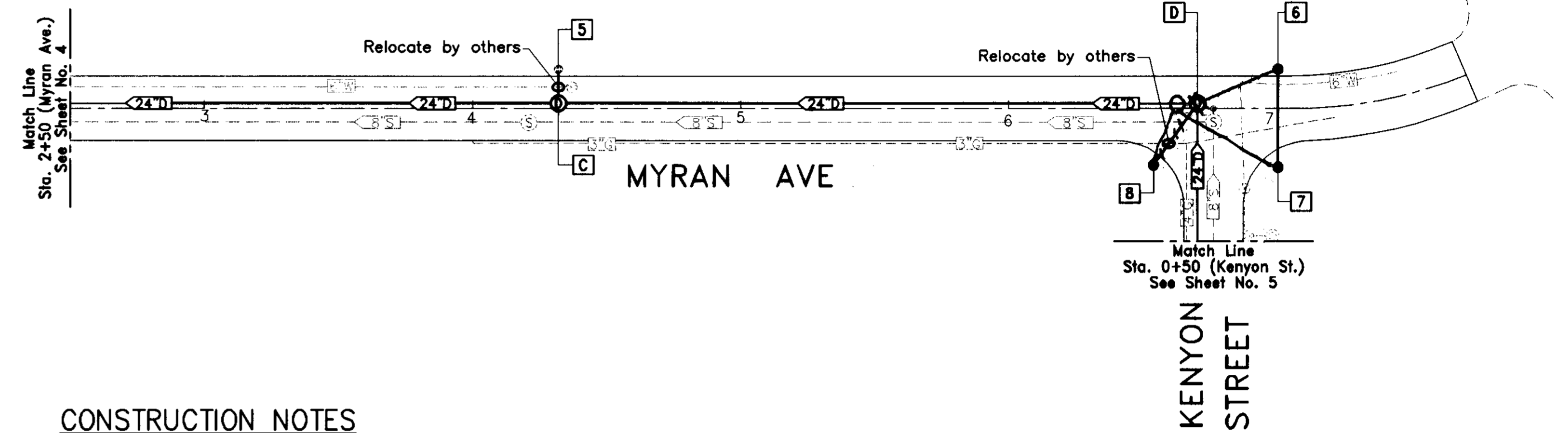

CONSTRUCTION NOTES

- [C] STA. 4+32 (2' LT) CONSTRUCT STORM DRAIN MAINTENANCE HOLE SEE PROFILE FOR CALLOUT.
- [D] STA. 6+70 (2' LT) CONSTRUCT STORM DRAIN MAINTENANCE HOLE SEE PROFILE FOR CALLOUT.
- [5] EXISTING 18" STORM DRAIN INLET CATCH BASIN
13 LF 12" RCP (CL. III) S = 0.01
INV. @ DI = 21.00' ±
INV. @ MH = 20.87'
- [6] STA. 7+00 (15' LT) CONSTRUCT 18" STORM DRAIN INLET CATCH BASIN
34 LF 12" RCP (CL. III) S = 0.01
INV. @ DI = 17.39' (IN & OUT)
INV. @ MH = 17.39'
- [7] STA. 7+00 (22' RT) CONSTRUCT 18" STORM DRAIN INLET CATCH BASIN
37 LF 12" RCP (CL. III) S = 0.01
INV. @ DI = 17.76'
- [8] STA. 6+54 (21' RT) CONSTRUCT 18" STORM DRAIN INLET CATCH BASIN
29 LF 12" RCP (CL. III) S = 0.01
INV. @ DI = 17.34'
INV. @ MH = 17.05'

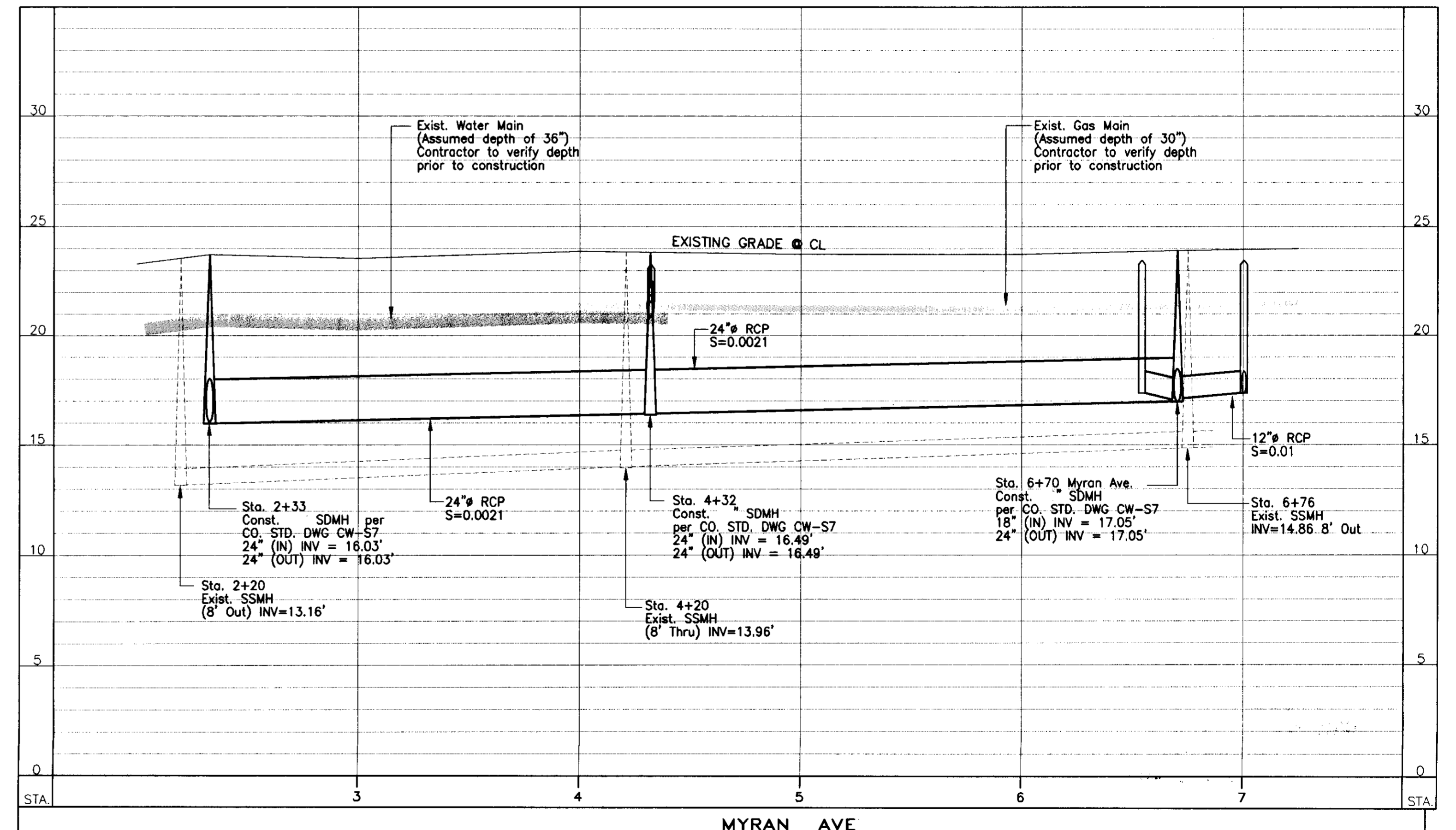
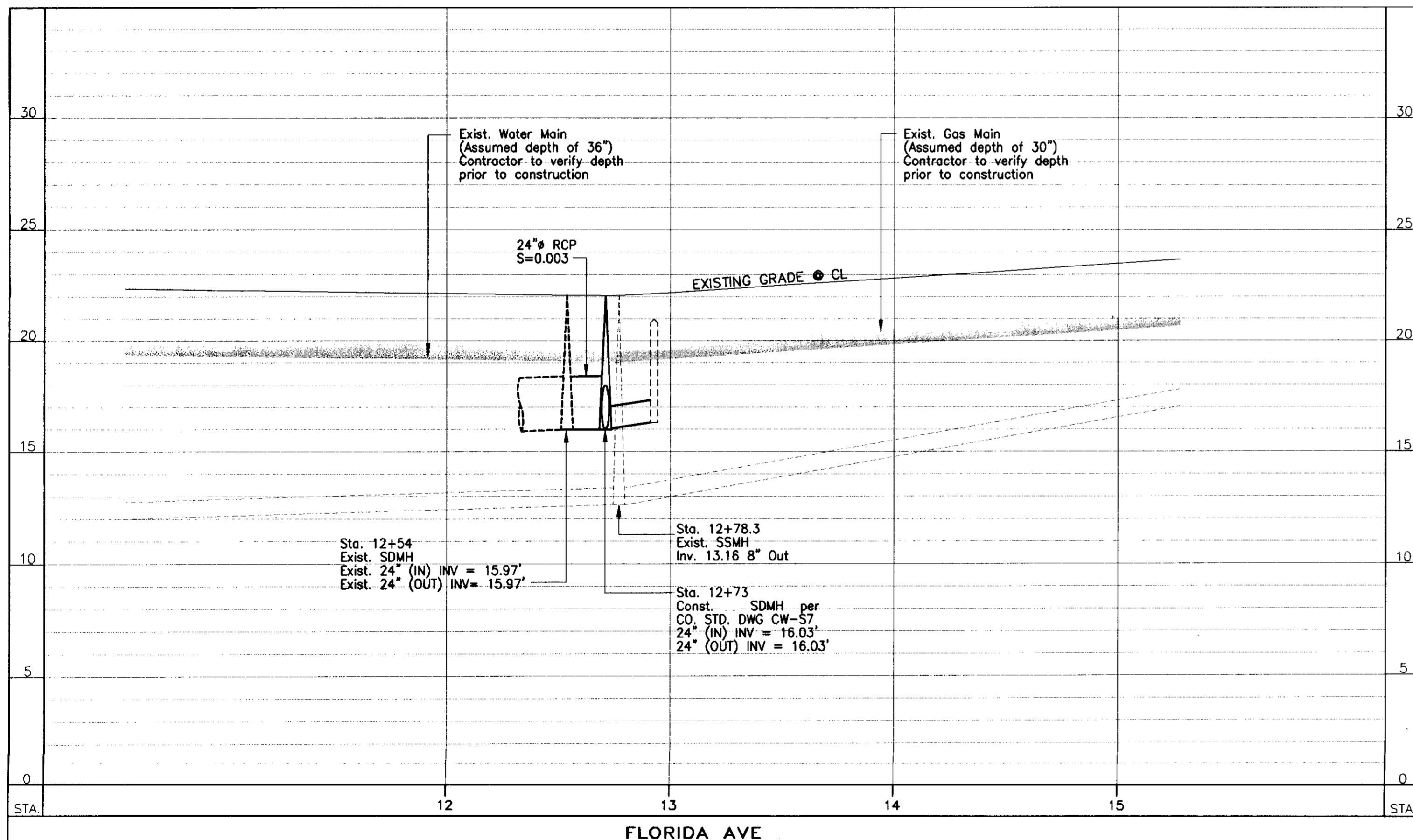

DRAWN BY	DATE	PROJECT ENGINEER	DATE	CHECKED	DATE	APPROVAL	RECOMMENDED	DATE
Enrique Silva	09/06	[Signature]	11/5/06	Jerry V. V. [Signature]	11/6/06	Manuel [Signature]		11/12/06
Vincent Li	10/06							
FILE NAME	DRAWER	SHEET NO.	ACAD	REVISIONS	DATE			
E:\Projects\2007\CC Gianone 1C 75377\Plans\XGianone 1c Utilities.dwg								

COUNTY OF SAN JOAQUIN

SCALE : 1"=40' (Horiz.)

UTILITIES PLAN AND PROFILE

GIANONE PARK AREA STORM DRAINAGE IMPROVEMENTS PHASE 1-C
(Federal Aid Project No. SJC-06-03)

SHEET NO.	TOTAL SHEETS
4	8

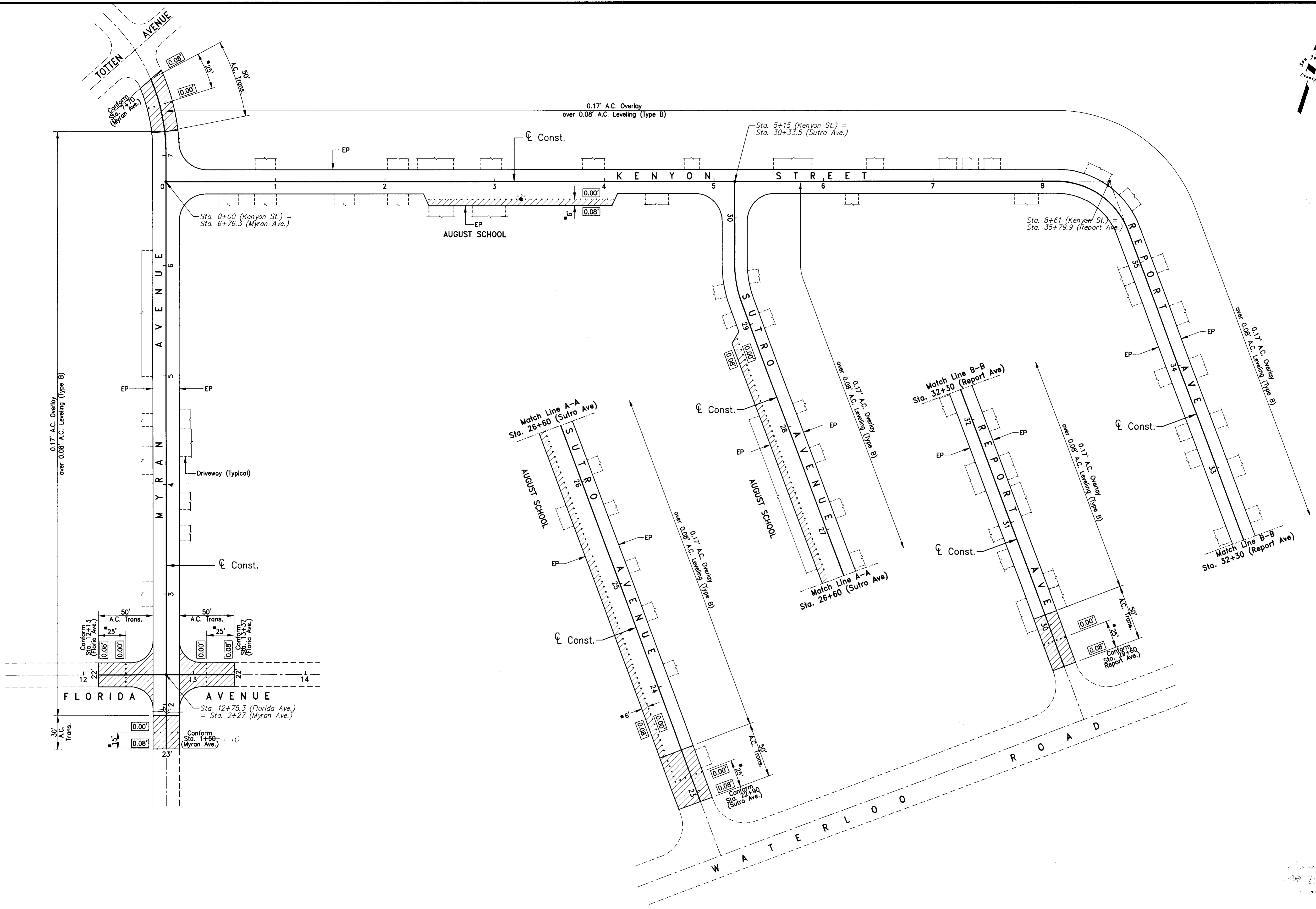

AS BUILT DRAWING
 10/12/06
 10/12/06

DRAWN BY	DATE	PROJECT ENGINEER	DATE	CHECKED	DATE	APPROVAL RECOMMENDED	DATE
Enrique Silva	09/06						
Pinson	10/06		10/5/06	Jay Violot	10/6/06	Manuel Salvo	10/12/06
FILE NAME	DRAWER	SHEET NO.	ACAD	REVISIONS	DATE		

COUNTY OF SAN JOAQUIN

SCALE : 1"=40'

STREET IMPROVEMENTS PLAN

GIANONE PARK AREA STORM DRAINAGE IMPROVEMENTS PHASE 1-C
 (Federal Aid Project No. SJC-06-03)

SHEET NO.	TOTAL SHEETS
3	8

GENERAL NOTES

- ALL NEW IMPROVEMENTS SHALL BE IN ACCORDANCE WITH THE REQUIREMENTS OF THESE PLANS AND SPECIFICATIONS, AND THE LATEST EDITION OF SAN JOAQUIN COUNTY STANDARD SPECIFICATIONS AND PLANS AND THE JULY 2002 STATE OF CALIFORNIA DEPARTMENT OF TRANSPORTATION STANDARD PLANS AND SPECIFICATIONS.
- THE INTENT IS THAT THESE PLANS REQUIRE ALL LABOR AND MATERIALS (EXCEPT AS SPECIFIED IN THE SPECIFICATIONS) NECESSARY AND PROPER FOR THE WORK CONTEMPLATED AND THAT THE WORK BE COMPLETED IN ACCORDANCE WITH THEIR TRUE INTENT AND PURPOSE. THE CONTRACTOR SHALL NOTIFY THE ENGINEER IMMEDIATELY REGARDING ANY DISCREPANCIES AND AMBIGUITIES WHICH MAY EXIST IN THE PLANS OR SPECIFICATIONS. IF THE PLANS DESCRIBE PORTIONS OF THE WORK IN GENERAL TERMS BUT NOT IN COMPLETE DETAIL, IT IS UNDERSTOOD THAT ONLY THE BEST GENERAL PRACTICES TO PREVAIL AND THAT ONLY MATERIALS AND WORKMANSHIP OF THE FIRST QUALITY ARE TO BE USED.
- THE TYPES, LOCATION, SIZES, AND/OR DEPTHS OF EXISTING UNDERGROUND UTILITIES AS SHOWN ON THESE PLANS WERE OBTAINED BY THE DESIGN ENGINEER FROM "OUTSIDE SOURCES" BELIEVED TO BE RELIABLE. HOWEVER, THE CONTRACTOR IS CAUTIONED THAT ONLY ACTUAL EXCAVATION WILL REVEAL THE TYPES, EXTENT, SIZES, LOCATION, AND DEPTHS OF SUCH UNDERGROUND UTILITIES.
- THE CONTRACTOR SHALL BE RESPONSIBLE FOR VERIFYING THE LOCATION OF ALL EXISTING UNDERGROUND UTILITIES AND SHALL CONTACT THE RESPECTIVE UTILITY COMPANIES PRIOR TO COMMENCEMENT OF WORK. HE/SHE SHALL BE RESPONSIBLE FOR THE LOCATION AND PRESERVATION OF ALL SUCH FACILITIES IN THE AREA OF CONSTRUCTION, AND SHALL NOTIFY UTILITY COMPANIES FORTY-EIGHT (48) HOURS IN ADVANCE OF ANY CONSTRUCTION (UNDERGROUND SERVICE ALERT 1-800-642-2444).
- THE CONTRACTOR'S ATTENTION IS DIRECTED TO SECTION 1540 (A)(1) OF THE CONSTRUCTION SAFETY ORDERS (TITLE 8 CALIFORNIA ADMINISTRATION CODE SECTION 1540), ISSUED BY THE OCCUPATIONAL SAFETY AND HEALTH STANDARDS BOARD PURSUANT TO THE CALIFORNIA OCCUPATIONAL SAFETY AND HEALTH ACT OF 1973, AS AMENDED, WHICH STATES:
PRIOR TO OPENING AN EXCAVATION, EFFORT SHALL BE MADE TO DETERMINE WHETHER UNDERGROUND INSTALLATION, I.E., SEWER, WATER, FUEL, ELECTRIC LINES, ETC., WILL BE ENCOUNTERED AND, IF SO, WHERE SUCH UNDERGROUND INSTALLATIONS ARE LOCATED. WHEN THE EXCAVATION APPROACHES THE APPROXIMATE LOCATION OF SUCH AN INSTALLATION, THE EXACT LOCATION SHALL BE DETERMINED BY CAREFUL PROBING OR HAND DIGGING; AND WHEN IT IS UNCOVERED, ADEQUATE PROTECTION SHALL BE PROVIDED FOR THE EXISTING INSTALLATION. ALL KNOWN OWNERS OF UNDERGROUND FACILITIES IN THE AREA CONCERNED SHALL BE ADVISED OF PROPOSED WORK AT LEAST 48 HOURS PRIOR TO THE START OF ACTUAL EXCAVATION.
- THE CONTRACTOR SHALL PROVIDE SHORING, BRACING, SLOPING OR PROVISIONS TO PROTECT WORKERS FOR ALL AREAS TO BE EXCAVATED TO A DEPTH OF FIVE FEET OR MORE. SAID PROTECTION TO BE DONE IN ACCORDANCE WITH THE REQUIREMENTS OF LOCAL, STATE, AND FEDERAL REGULATIONS (CAL-OSHA, OSHA).
- CONTRACTOR SHALL BE RESPONSIBLE FOR COORDINATION OF THE REMOVAL AND /OR RELOCATION OF ALL EXISTING UTILITIES WITH RESPECTIVE UTILITY COMPANIES.
- FINAL PAVEMENT WORK SHALL NOT OCCUR WITHIN THE ROAD RIGHT-OF-WAY PRIOR TO COMPLETION OF UTILITY RELOCATION WITHOUT SPECIFIC APPROVAL OF THE SAN JOAQUIN COUNTY PUBLIC WORKS DEPARTMENT. ALL TRENCHES AND CROSS TRENCHES WITHIN EXISTING STREETS SHALL BE BACK FILLED AND PAVED WITH TEMPORARY PAVING THE SAME DAY THE PAVEMENT CUT IS MADE OR COVERED WITH STEEL PLATES AS DIRECTED BY SAN JOAQUIN COUNTY PUBLIC WORKS DEPARTMENT.
- ASBESTOS CEMENT MATERIALS SHALL NOT BE USED IN THE CONSTRUCTION OF ANY FACILITIES WITHIN THIS PROJECT.
- THE CONTRACTOR SHALL EXPOSE ALL EXISTING SEWER, STORM DRAINS, AND CLEARANCES OF KNOWN CROSSINGS WITH OTHER UTILITIES BEFORE INSTALLING NEW PIPELINES. IF THE CONTRACTOR DETERMINES THE EXISTING INVERTS ARE NOT IN CONFORMANCE WITH THE PLANS, HE SHALL NOTIFY THE ENGINEER BEFORE PERFORMING ANY WORK. THE CONTRACTOR SHALL BE RESPONSIBLE FOR ANY FIELD CHANGES MADE WITHOUT WRITTEN AUTHORIZATION FROM THE OWNER REPRESENTATIVE.
- THE CONTRACTOR SHALL BE RESPONSIBLE FOR ANY DAMAGE TO THE SITE AND SURROUNDING AREAS RESULTING FROM THE CONTRACTOR'S OPERATIONS PRIOR TO ACCEPTANCE OF THE CONTRACTOR'S WORK.
- DURING CONSTRUCTION, THE CONTRACTOR SHALL MAINTAIN THE INTEGRITY OF EXISTING FACILITIES. THE CONTRACTOR IS RESPONSIBLE TO REPAIR, AT THE CONTRACTOR'S EXPENSE, TO THE SATISFACTION OF SAN JOAQUIN COUNTY, ANY FACILITIES DAMAGED DURING CONSTRUCTION.
- TRAFFIC CONTROL PLAN (TCP) SHALL BE SUBMITTED TO AND DEEMED ACCEPTABLE BY THE COUNTY PRIOR TO START OF WORK. THIS SHALL ADDRESS ALL PHASES OF WORK WHICH IMPACT PUBLIC TRAFFIC. CONFORMANCE WITH THE TCP SHALL BE MAINTAINED AT ALL TIMES. A MINIMUM OF ONE (1) TRAFFIC LANE SHALL BE MAINTAINED AT ALL TIMES WITH TRAFFIC DELAYS LIMITED TO A MAXIMUM OF 15 MINUTES. A MINIMUM OF TWO (2) TRAFFIC LANES SHALL BE MAINTAINED DURING NON-WORKING HOURS. TRAFFIC CONTROL SHALL BE IN ACCORDANCE WITH SECTION 12 OF THE CALTRANS STANDARD SPECIFICATIONS. ALL PAVEMENT CUTS SHALL BE NEATLY SAW CUT AND THE CONTRACTOR SHALL MAINTAIN CONTINUOUS BARRICADES SPACED AT APPROXIMATELY 20-FOOT INTERVALS FOR THE FIRST 100 FEET FROM THE BEGINNING OF THE SAWCUT AND 50-FOOT INTERVALS THEREAFTER.
- CONTRACTOR TO REFERENCE AND RESTORE ALL "RECORDED" EXISTING MONUMENTS AND/OR PROPERTY CORNER REFERENCES COVERED, DESTROYED, REMOVED, OR DISTURBED DURING THE COURSE OF CONSTRUCTION.
- WHERE EXISTING FENCES ARE TO BE REMOVED FOR CONSTRUCTION PURPOSES, THE CONTRACTOR SHALL REMOVE AND REPLACE THE FENCING IN KIND. WHERE THE EXISTING FENCE IS USED FOR PROPERTY SECURITY AND/OR CONTAINMENT, CONTRACTOR SHALL PROVIDE AND ERECT TEMPORARY FENCING (NOT SHOWN ON PLANS) DURING CONSTRUCTION AS DIRECTED BY THE ENGINEER. PAYMENT FOR REMOVING, REPLACING, OR PROVIDING AND ERECTING TEMPORARY FENCING SHALL BE CONSIDERED TO BE INCLUDED IN THE PRICE(S) PAID FOR THE ITEMS) REQUIRING SUCH, AND NO ADDITIONAL COMPENSATION SHALL BE ALLOWED THEREFOR.
- CONTRACTOR SHALL OBTAIN AN ENCROACHMENT PERMIT AND PAY ALL FEES DUE FOR SAID PERMIT PRIOR TO START OF CONSTRUCTION.
- ALL WORK IN COUNTY RIGHT-OF-WAY SHALL BE SUBJECT TO THE APPROVAL AND ACCEPTANCE OF THE SAN JOAQUIN COUNTY PUBLIC WORKS DEPARTMENT.
- CONTRACTOR AGREES TO ASSUME SOLE AND COMPLETE RESPONSIBILITY FOR JOB SITE CONDITIONS DURING THE COURSE OF CONSTRUCTION OF THIS PROJECT, INCLUDING SAFETY OF ALL PERSONS AND PROPERTY. THIS REQUIREMENT SHALL APPLY CONTINUOUSLY AND SHALL NOT BE LIMITED TO NORMAL WORKING HOURS. THE CONTRACTOR SHALL DEFEND, INDEMNIFY AND HOLD HARMLESS THE COUNTY OF SAN JOAQUIN, ITS ELECTED OFFICIALS, OFFICERS, EMPLOYEES, AND AGENTS FROM ANY AND ALL CLAIMS, COSTS OF LITIGATION, DAMAGES, AND ATTORNEY'S FEE, FOR PERSONAL INJURY OR PROPERTY DAMAGE OF WHATEVER NATURE WHICH ARE CLAIMED TO HAVE OCCURRED DURING THE TERM OF THIS PROJECT.
- THE CONTRACTOR SHALL PROVIDE AND MAINTAIN TEMPORARY SIGNS FOR ALL REGULATORY TRAFFIC SIGNS REMOVED DURING THE CONSTRUCTION, AS APPROVED BY THE ENGINEER.
- CONTRACTOR SHALL CLEAN ALL EXISTING FRONTAGE DRAINAGE PIPES. COMPENSATION SHALL BE CONSIDERED AS INCLUDED IN LUMP SUM PRICE PAID FOR CLEANING EXISTING DRAINAGE FACILITY.

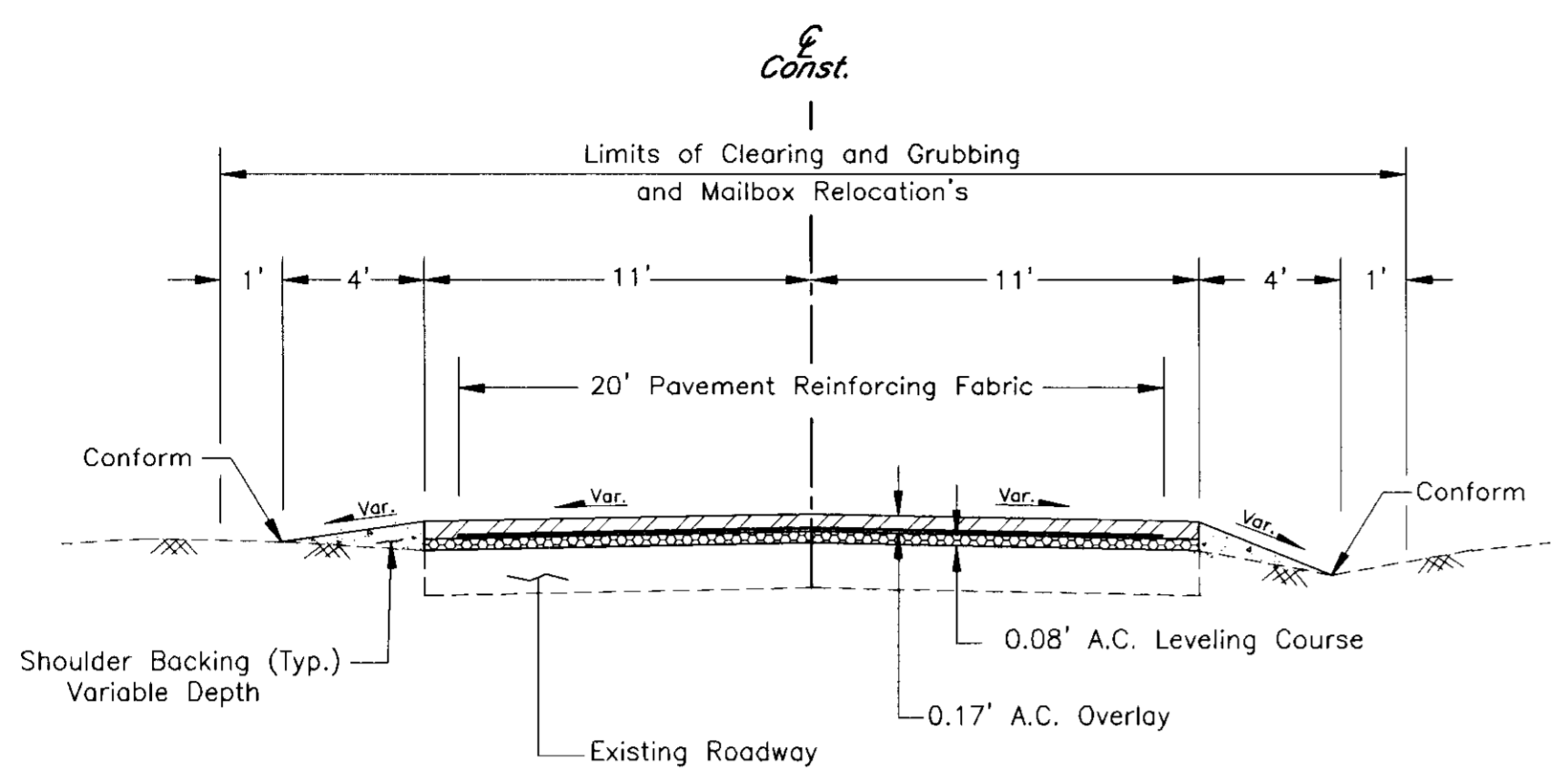

TYPICAL SECTION

Myran Avenue—STA. 1+60 to 7+70
 Kenyon Street—STA. 0+00 to 2+40
 Kenyon Street—STA. 4+08 to 8+61
 Sutro Avenue—STA. 28+95 to 30+33
 Report Avenue—STA. 29+60 to 35+79

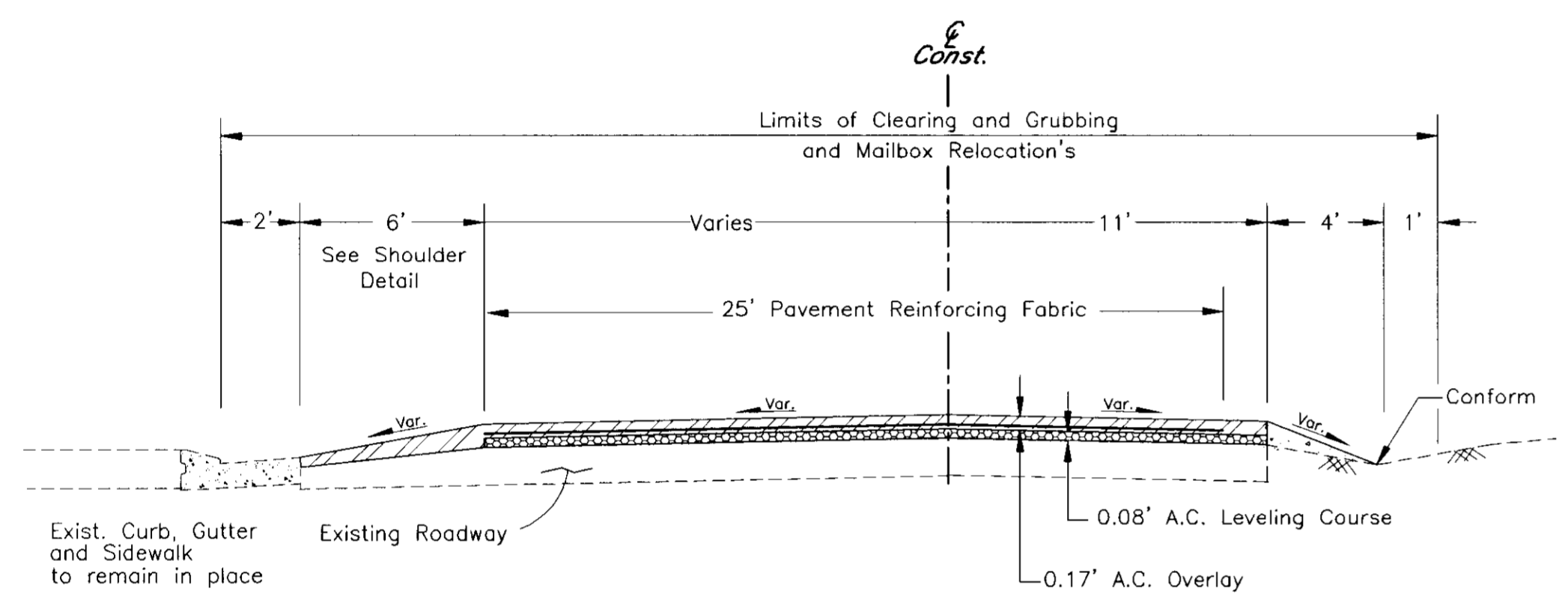
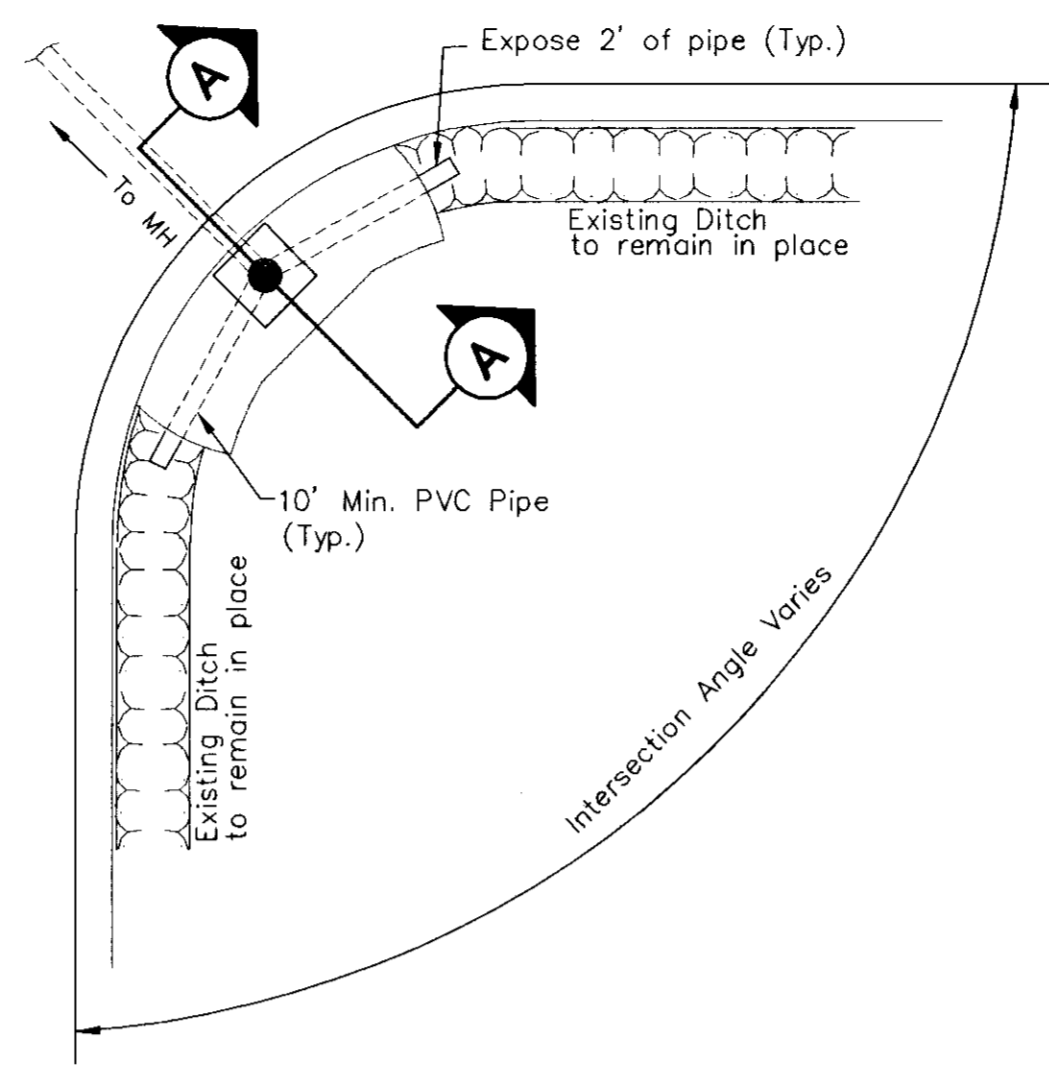

TYPICAL SECTION

Sutro Avenue—STA 22+90 TO 28+95
 Kenyon Street—STA. 2+40 TO 4+07

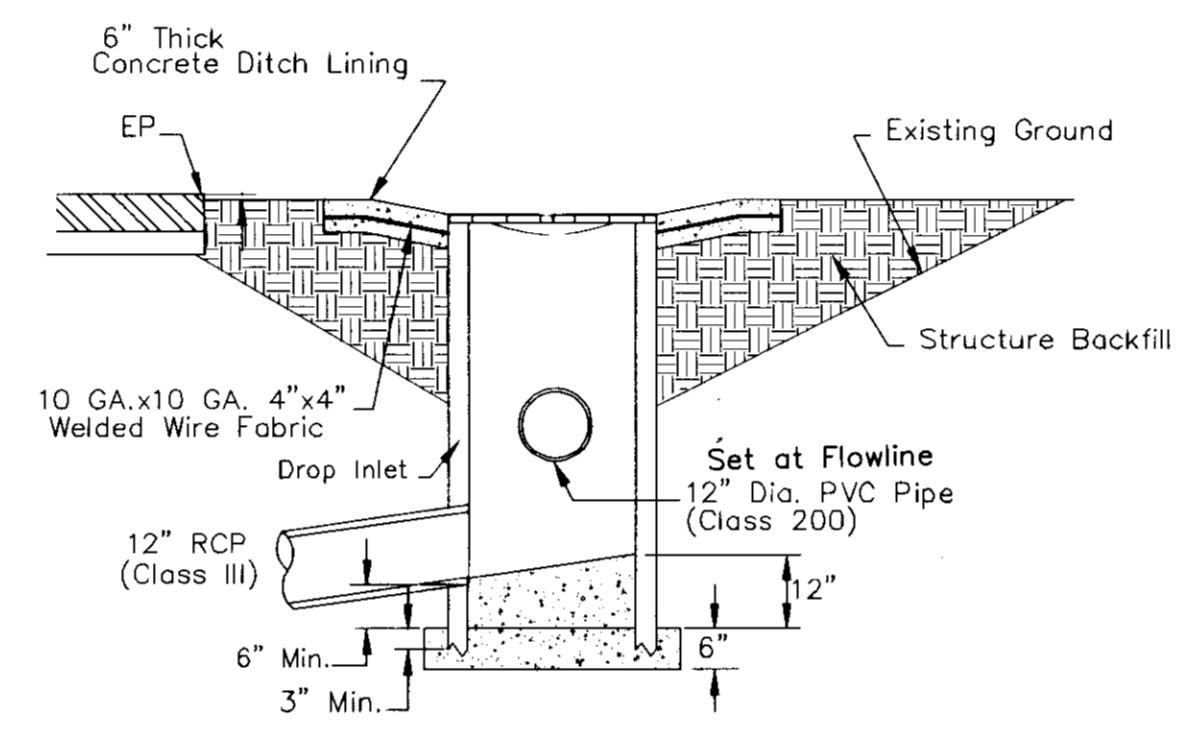

SECTION A-A

MODIFIED 18" STORM DRAIN INLET

Note: The Contract unit price paid for Storm Drainage Inlet shall include full compensation for furnishing all labor, materials, tools, equipment, and incidentals for doing all the work as shown in this detail. SDI grate to be set 0.10' below new E.P.

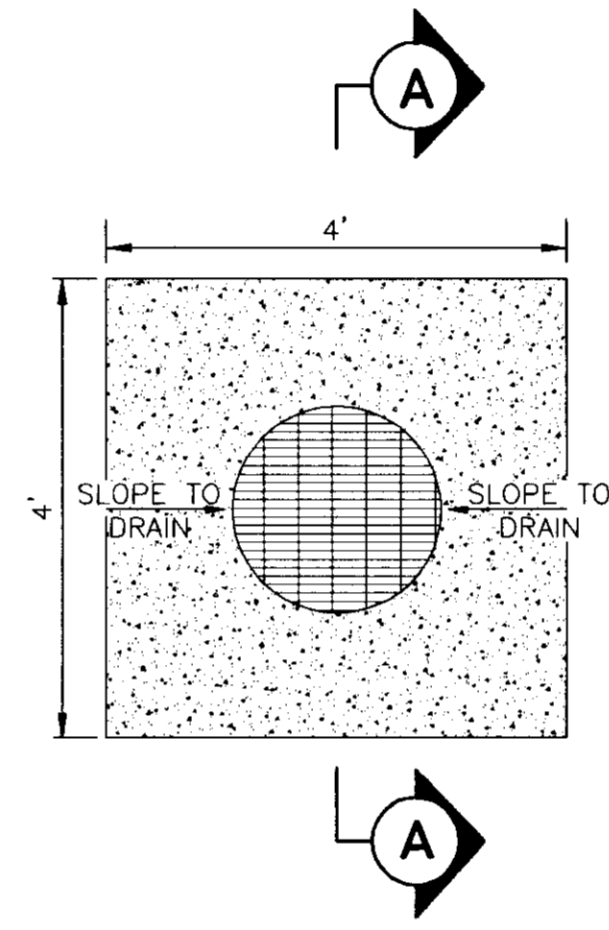

PLAN

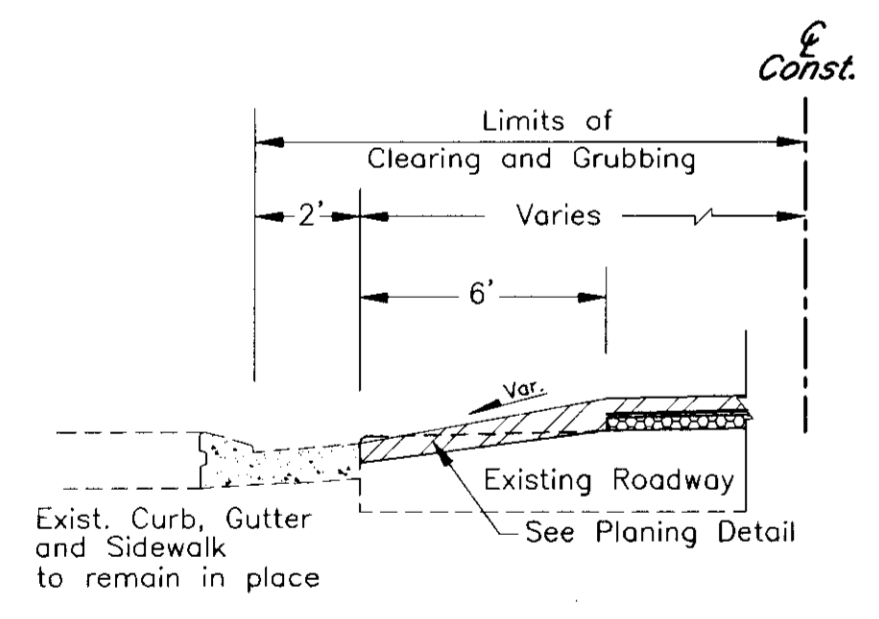

SHOULDER DETAIL

Sutro Avenue
 Sta. 23+15 to Sta. 28+95 (Lt.)
 Kenyon Street
 Sta. 2+40 to Sta. 4+07 (Rt.)

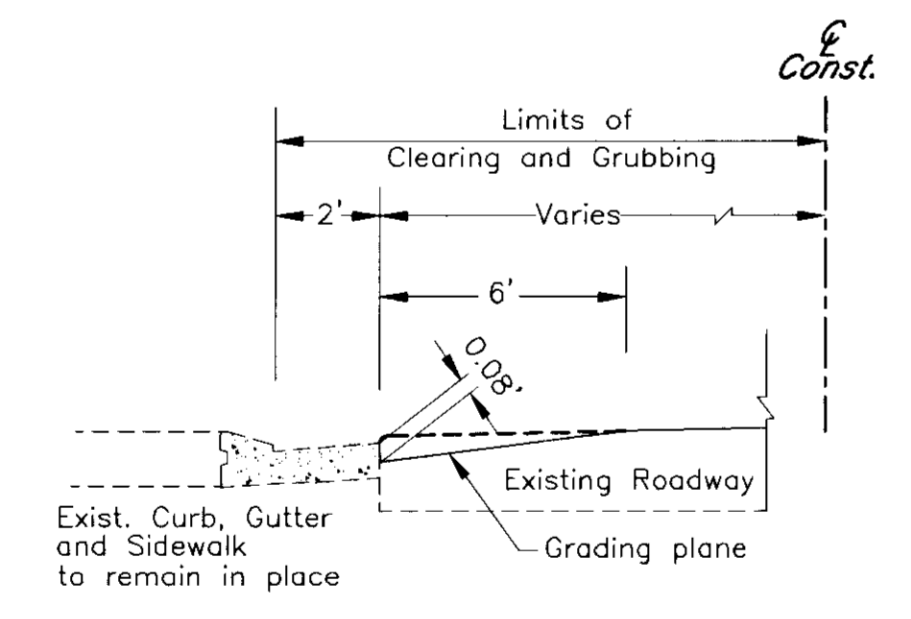

LONGITUDINAL PLANING DETAIL

Note: Contractor is to plane all Asphalt Concrete Pavement adjacent to Gutter Lip to a depth of 0.08' below the Gutter Lip.

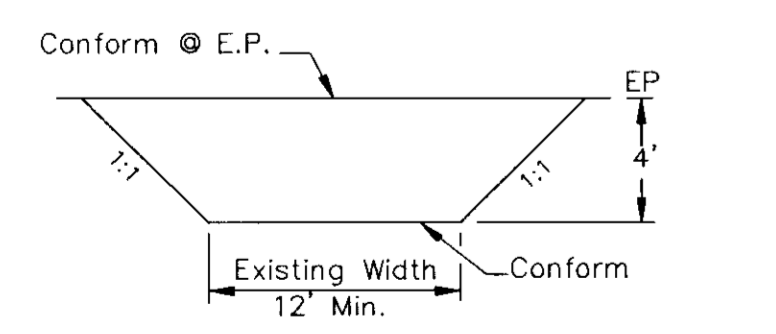

TYPE D

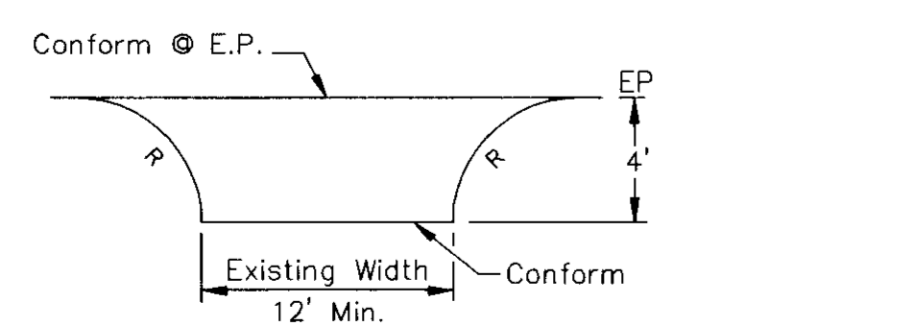

TYPE E

DRIVEWAY DETAIL

- EXISTING TOPOGRAPHIC INFORMATION SHOWN MAY DIFFER FROM ACTUAL CONDITIONS DUE TO ONGOING CONSTRUCTION IN THE AREA.
- CONTRACTOR SHALL PROVIDE DUST CONTROL MEASURES AT ALL TIMES DURING CONSTRUCTION AS PER SECTION 10 OF THE STANDARD SPECIFICATIONS OF THE STATE OF CALIFORNIA AND PER SAN JOAQUIN COUNTY DEPARTMENT OF PUBLIC WORKS REQUIREMENTS.
- ANY CHANGES TO THE APPROVED IMPROVEMENT PLANS AND SPECIFICATIONS MUST BE PREPARED AND CERTIFIED BY THE "CIVIL ENGINEER", AND SHALL BE SUBMITTED TO THE DIRECTOR OF PUBLIC WORKS FOR APPROVAL PRIOR TO IMPLEMENTATION.
- EXISTING DRAINAGE FACILITIES SHALL BE MAINTAINED DURING PERIODS OF INCLEMENT WEATHER AND RESTORED TO THEIR ORIGINAL CONDITIONS UPON COMPLETION OF THE WORK.
- ALL TRAFFIC DELINEATION (SIGNS, STRIPING, RAISED PAVEMENT MARKERS) SHALL BE RESTORED TO THEIR ORIGINAL CONDITION UPON COMPLETION OF THE WORK.
- THE CONTRACTOR SHALL NOTIFY THE SAN JOAQUIN COUNTY DEPARTMENT OF PUBLIC WORKS 24 HOURS IN ADVANCE OF PERFORMING ANY WORK REQUIRED IN THE PLANS. PHONE: (209)468-3022.
- CONTRACTOR SHALL PREPARE A STORM WATER POLLUTION PREVENTION PLAN (SWPPP) FOR APPROVAL BY SAN JOAQUIN COUNTY DEPARTMENT OF PUBLIC WORKS PRIOR TO THE START OF CONSTRUCTION.
- ALL EXISTING TREES, SHRUBS, FENCES, WALKWAYS, DRIVEWAY PIPES, AND OTHER FRONTAGE IMPROVEMENTS SHALL REMAIN IN PLACE UNLESS OTHERWISE SHOWN ON THE PLANS OR AS DIRECTED BY THE ENGINEER. ALL REMOVAL AND DISPOSAL COST SHALL BE CONSIDERED AS INCLUDED IN CLEARING AND GRUBBING.

DRAWN BY <i>Enrique Silva</i>	DATE 09/06	PROJECT ENGINEER <i>[Signature]</i>	DATE 10/15/06	CHECKED <i>[Signature]</i>	DATE 10/16/06	APPROVAL RECOMMENDED <i>[Signature]</i>	DATE 10/16/06	COUNTY OF SAN JOAQUIN	NO SCALE	TYPICAL SECTION & DETAILS	GIANONE PARK AREA STORM DRAINAGE IMPROVEMENTS PHASE 1-C (Federal Aid Project No. SJC-06-03)	SHEET NO. 2	TOTAL SHEETS 8
FILE NAME	DRAWER	SHEET NO.	ACAD	REVISIONS	DATE								

COUNTY OF SAN JOAQUIN
 DEPARTMENT OF PUBLIC WORKS
 STOCKTON, CALIFORNIA
 PROJECT PLANS FOR
GIANONE PARK AREA
STORM DRAINAGE IMPROVEMENTS PHASE 1-C
FEDERAL AID PROJECT No. SJC-06-03

(TO BE SUPPLEMENTED BY STANDARD PLANS DATED JULY 2002)

INDEX OF SHEETS

SHEET NO.	SHEET TITLE
1	COVER SHEET
2	TYPICAL SECTIONS & DETAILS
3	STREET IMPROVEMENTS PLAN
4	UTILITIES PLAN AND PROFILE - FLORIDA AVENUE AND MYRAN AVENUE
5	UTILITIES PLAN AND PROFILE - KENYON STREET
6	UTILITIES PLAN AND PROFILE - SUTRO AVENUE
7	UTILITIES PLAN AND PROFILE - REPORT AVENUE
8	SUMMARY OF QUANTITIES

LEGEND

DESCRIPTION

	DEPTH OF ASPHALT CONCRETE PAVEMENT PLANING
	VARIABLE DEPTH ASPHALT CONCRETE OVERLAY
	LIMITS OF ASPHALT CONCRETE PAVEMENT PLANING
	NEW STORM DRAIN LINE
	EXISTING SEWER LINE
	EXISTING MAINTENANCE HOLE SEWER
	NEW MAINTENANCE HOLE STORM
	EXISTING STORM DRAIN INLET TO BE CLEANED BY CONTRACTOR
	EXISTING MAINTENANCE HOLE STORM
	NEW MODIFIED 18" STORM DRAIN INLET
	EXISTING WATER MAIN
	EXISTING WATER VALVE
	EXISTING FIRE HYDRANT
	EXISTING GAS SERVICE
	EXISTING UTILITIES TO BE RELOCATED BY OTHERS

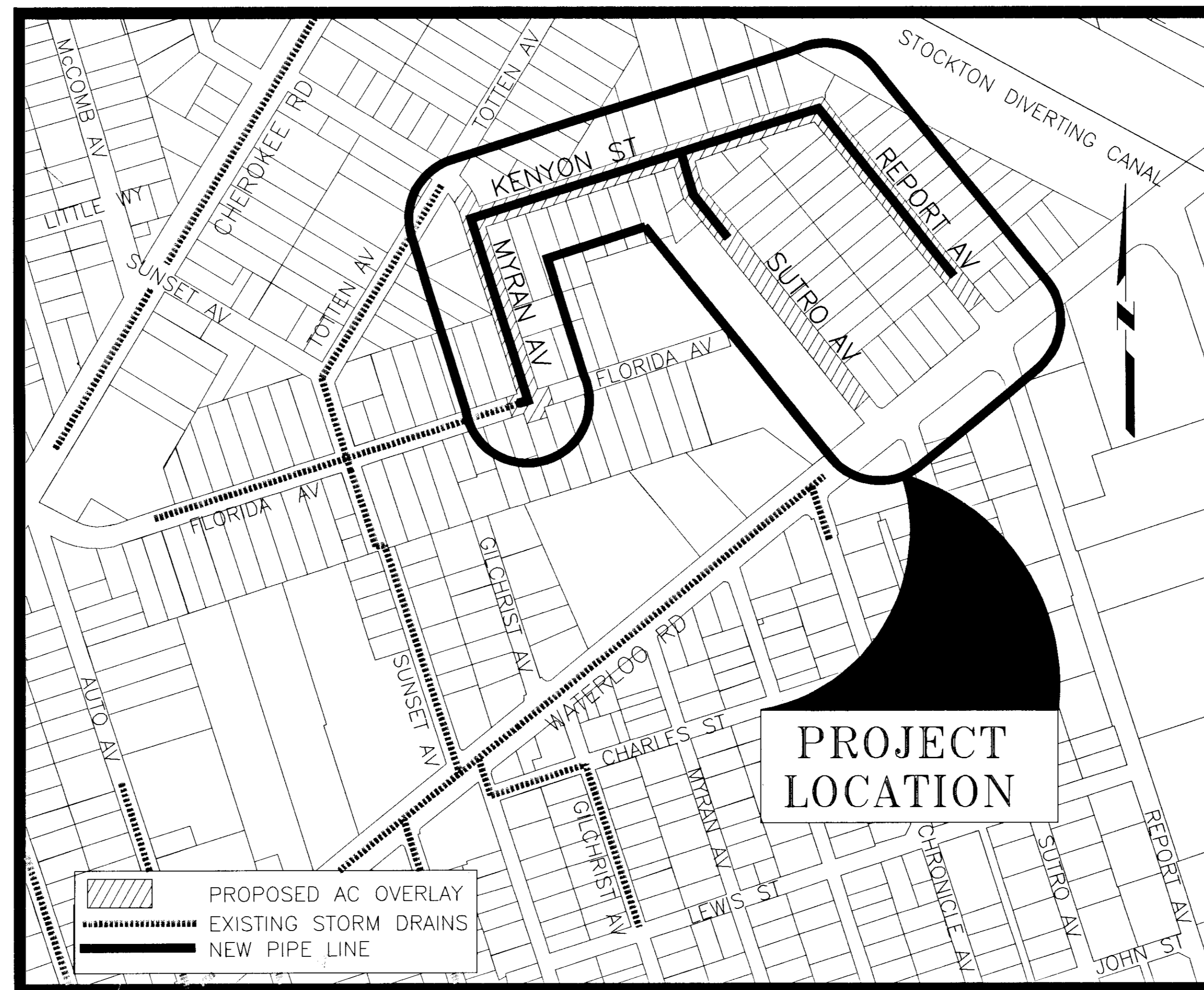

PROJECT LOCATION MAP

NOT TO SCALE

The Contractor shall possess a Class A or a Class C-34 licence at the time this contract is awarded.

COUNTY OF SAN JOAQUIN
 Submitted 12 Oct, 2006

THOMAS RYAN FLINN R.C.E. C23341
 DIRECTOR OF PUBLIC WORKS



PETER D. MARTIN
 R.C.E. 38465

APPLICABLE STANDARD PLANS

D-18, CW-S7, CW-D14
 R-29, CW-R36, CW-M7, W-7, CW-S10

CALTRANS STANDARD PLANS

A73C, A10A, A10B, T13, A62A

UTILITY	CONTACT	PHONE NUMBER
SEWER	CITY OF STOCKTON	(209) 937-8779
WATER	BRETT DAHLEN	(209) 464-0994
	JOHN E. VIRGILIO	(408) 367-8360
CABLE	LARRY BYRD	(209) 477-1747 x 243
PG&E ELECTRIC	RON COLLINS	(209) 942-1628
PG&E GAS	PAUL MAUPIN	(209) 942-1541
TELEPHONE	BILL BROMANN	(209) 474-4119

AVOID CUTTING UNDERGROUND
 UTILITY LINES IT'S COSTLY.
Call before you Dig.
 1-800-642-2444
UNDERGROUND SERVICE ALERT(USA)



PROJECT ENGINEER	DATE	CHECKED	DATE	APPROVAL RECOMMENDED	DATE
	10/5/06		10/6/06		10/12/06

Lhh-4147

PROJECT NAME: EAST STOCKTON STORM DRAINAGE IMP. GIANONE PARK 1-C