

SK-4416

DATE: 11/29/07 TIME: 3:45:27 PM  
 SERVER: LAYOUT: Layout1  
 PATH: N:\MTB014800\CADD\IP  
 DRAWING NAME: IPAA02.DWG  
 PAGE SETUP: 22X34  
 DESIGNER: PROJ. MGR:

NO.	BY	DATE	REVISIONS:

Note: All utilities & obstructions shown are approximate. It is the contractor's responsibility to verify the location & depth with the appropriate agencies. The contractor shall notify the engineer immediately regarding any discrepancies or ambiguities which may exist.

CAUTION: The engineer preparing these plans will not be responsible for, or liable for, unauthorized changes to or uses of these plans. All changes to the plans must be in writing and must be approved by the preparer of these plans.

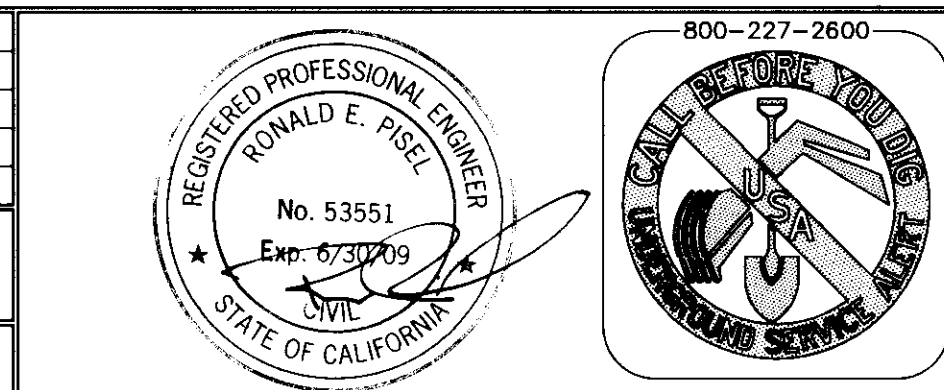

800-227-2600

# NOLTE

BEYOND ENGINEERING

1930 HOWARD ROAD, SUITE 125  
 559.8615220 TEL 559.8614440 FAX

MADERA, CA 93637  
 WWW.NOLTE.COM

**SAN JOAQUIN COUNTY**

**GARDEN ACRES - WALKER LANE AREA STORM DRAINAGE IMPROVEMENTS - PHASE 2A & 2B**

PREPARED FOR: San Joaquin County

DATE SUBMITTED: 11-29-07

SHEET NUMBER	<b>14</b>
OF	<b>15</b>
SCALE	VERTICAL: 1"=2' HORIZONTAL: 1"=20'
JOB NUMBER	<b>MTB014800</b>

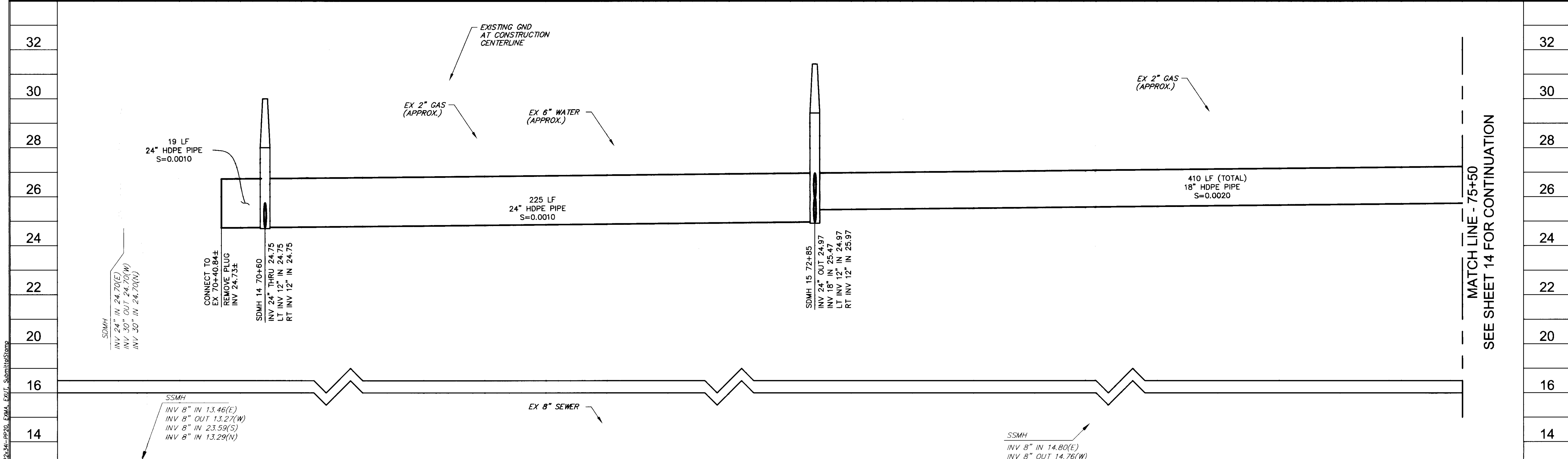
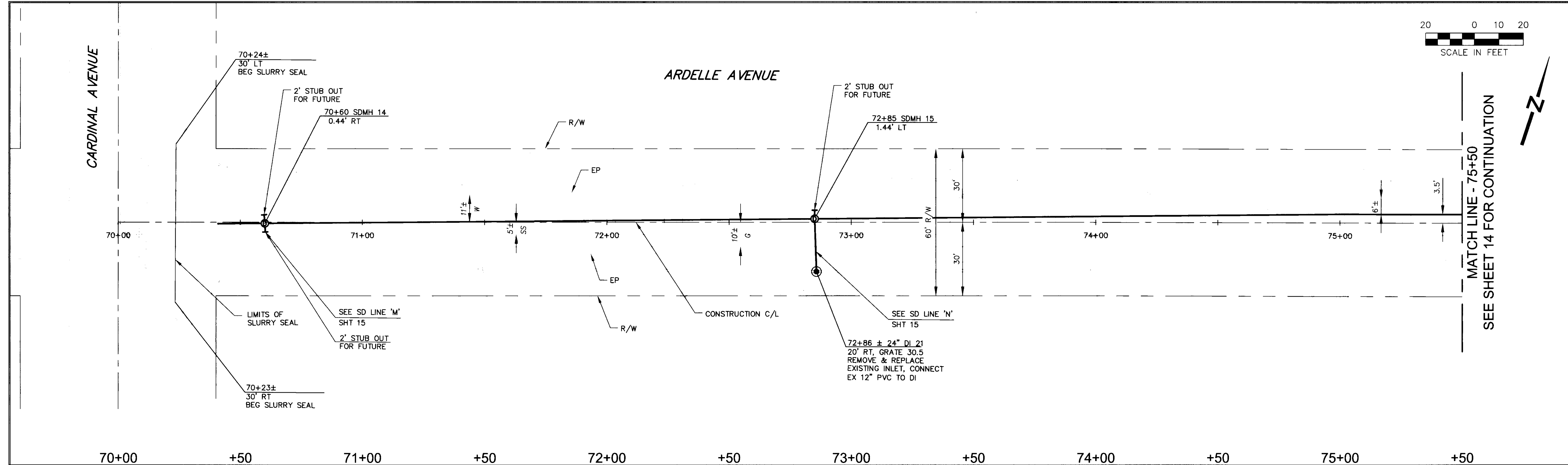
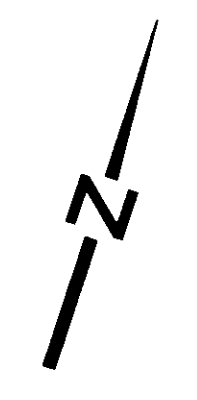

DATE: 11/29/07 TIME: 3:44:17 PM  
 SERVER: LAYOUT: Layout1  
 PATH: N:\MTB014800\CADD\IP  
 DRAWING NAME: IPAA01.DWG  
 PAGE SETUP: 22X34  
 DESIGNER: PROJ. MGR:

NO.	BY	DATE	REVISIONS:

Note: All utilities & obstructions shown are approximate. It is the contractor's responsibility to verify the location & depth with the appropriate agencies. The contractor shall notify the engineer immediately regarding any discrepancies or ambiguities which may exist.

REGISTERED PROFESSIONAL ENGINEER  
 RONALD E. PISE  
 No. 53551  
 Exp. 6/30/09  
 CIVIL  
 STATE OF CALIFORNIA

800-227-2600  
 CALIFORNIA BEFORE YOU DIG  
 CALL 811

**NOLTE**  
 BEYOND ENGINEERING

1930 HOWARD ROAD, SUITE 125  
 559.9616220 TEL. 559.9614440 FAX

MADERA, CA 93637  
 WWW.NOLTE.COM

**SAN JOAQUIN COUNTY**  
 GARDEN ACRES - WALKER LANE AREA STORM  
 DRAINAGE IMPROVEMENTS - PHASE 2A & 2B

PREPARED FOR: San Joaquin County  
 DATE SUBMITTED: 11-29-07

SHEET NUMBER	13
OF	15 SHEETS
SCALE	VERTICAL: 1"=2' HORIZONTAL: 1"=20'
JOB NUMBER	MTB014800

SH-4417

JACKSON PREPARED BY: JEFFREY A. EYTO-IA, 22-34-PP20, E-MA, E-UT, SubmitStamp

MARSH STREET

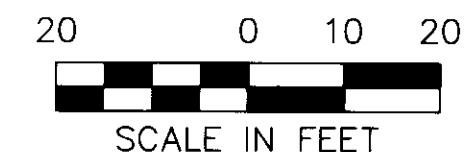

MATCH LINE - 56+50  
SEE SHEET 11 FOR CONTINUATION

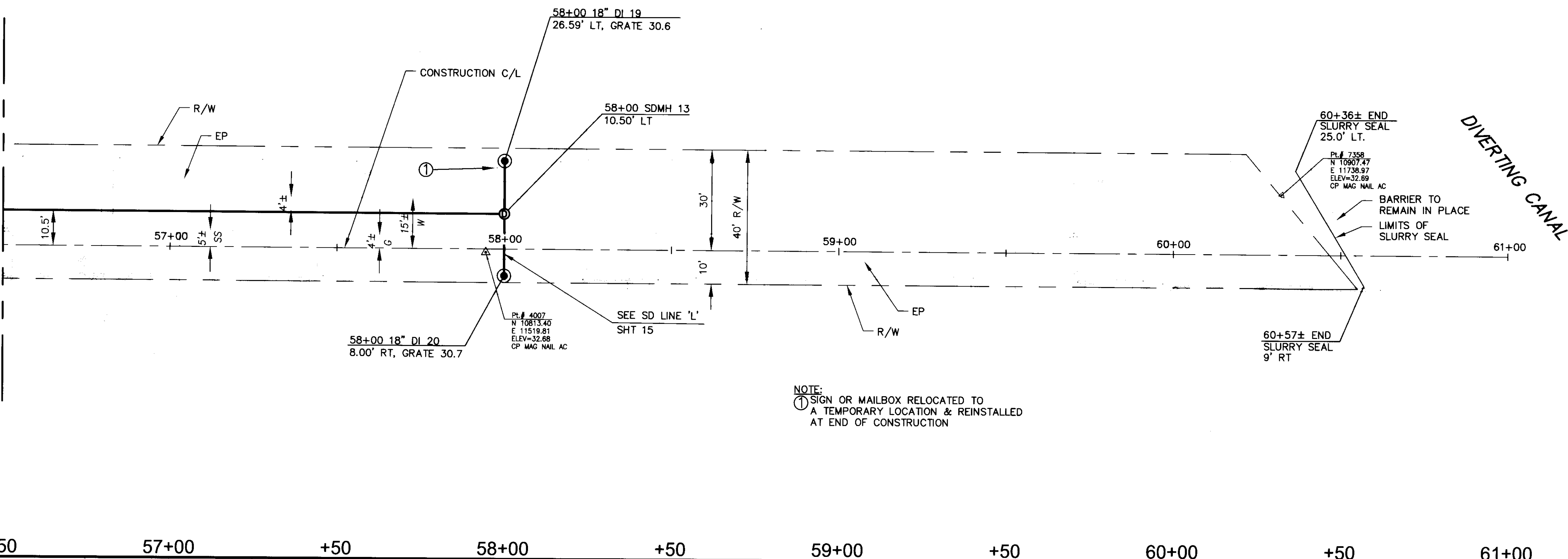

NOTE:  
① SIGN OR MAILBOX RELOCATED TO A TEMPORARY LOCATION & REINSTALLED AT END OF CONSTRUCTION

+50      57+00      +50      58+00      +50      59+00      +50      60+00      +50      61+00

MATCH LINE - 56+50  
SEE SHEET 11 FOR CONTINUATION

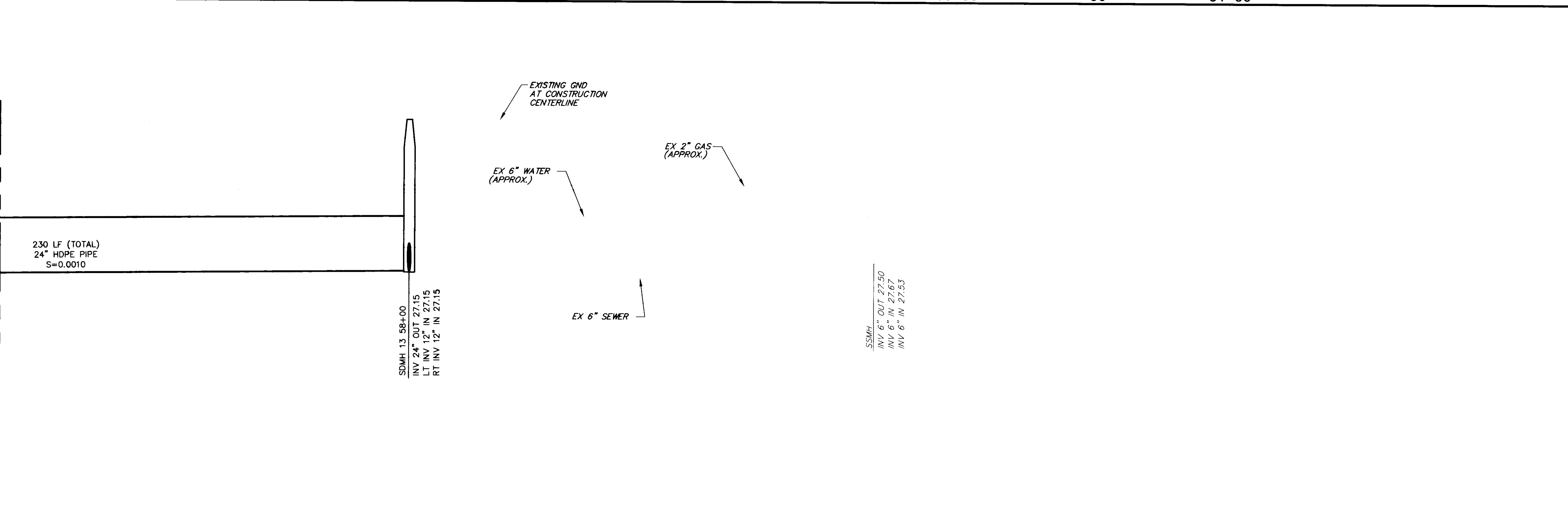

JACKSON KREBS: EX-10 - MS, PREPARED, PRRFUS2, 22-34-1, PP20, EXMA, EXCUT, Submitting Stamp

SA 4418

DATE: 11/29/07 TIME: 3:41:30 PM  
SERVER: LAYOUT: Layout1  
PATH: N:\MTB014800\CADD\VP  
DRAWING NAME: IPMS06.DWG  
PAGE SETUP: 22x34  
DESIGNER: PROJ. MGR:

NO.	BY	DATE	REVISIONS:

Note: All utilities & obstructions shown are approximate. It is the contractor's responsibility to verify the location & depth with the appropriate agencies. The contractor shall notify the engineer immediately regarding any discrepancies or ambiguities which may exist.

CAUTION: The engineer preparing these plans will not be responsible for, or liable for, unauthorized changes to or uses of these plans. All changes to the plans must be in writing and must be approved by the preparer of these plans.

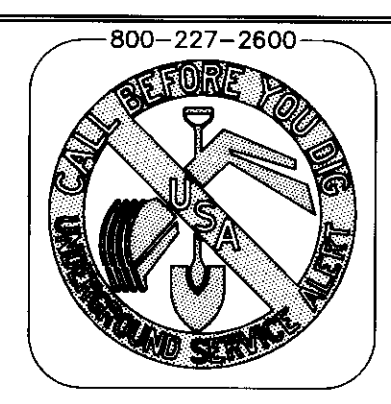
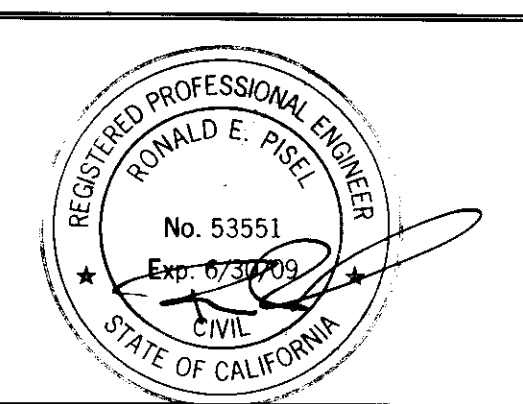

**NOLTE**  
BEYOND ENGINEERING  
1830 HOWARD ROAD, SUITE 125 MADERA, CA 93637  
568.8616220 TEL 568.8614440 FAX WWW.NOLTE.COM

**SAN JOAQUIN COUNTY**  
GARDEN ACRES - WALKER LANE AREA STORM DRAINAGE IMPROVEMENTS - PHASE 2A & 2B  
PREPARED FOR: San Joaquin County DATE SUBMITTED: 11-29-07

SHEET NUMBER	12
OF	15 SHEETS
SCALE	VERTICAL: 1" = 2' HORIZONTAL: 1" = 20'
JOB NUMBER	MTB014800

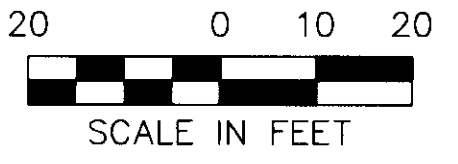

MARSH STREET

MATCH LINE - 51+00  
SEE SHEET 10 FOR CONTINUATION

MATCH LINE - 56+50  
SEE SHEET 12 FOR CONTINUATION

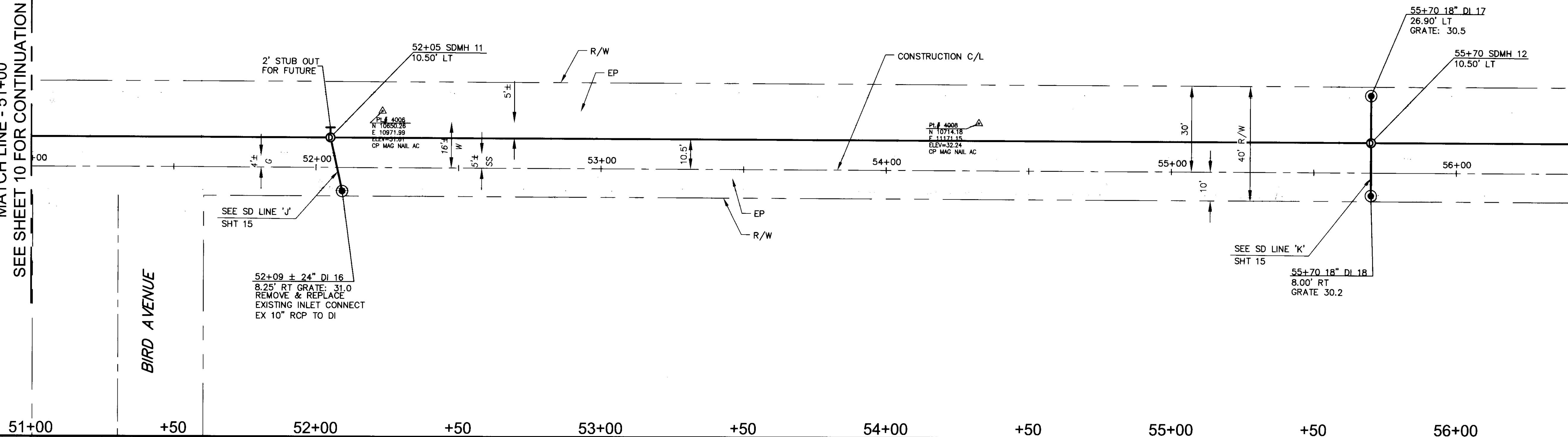

51+00      +50      52+00      +50      53+00      +50      54+00      +50      55+00      +50      56+00      +50

MATCH LINE - 51+00  
SEE SHEET 10 FOR CONTINUATION

MATCH LINE - 56+50  
SEE SHEET 12 FOR CONTINUATION

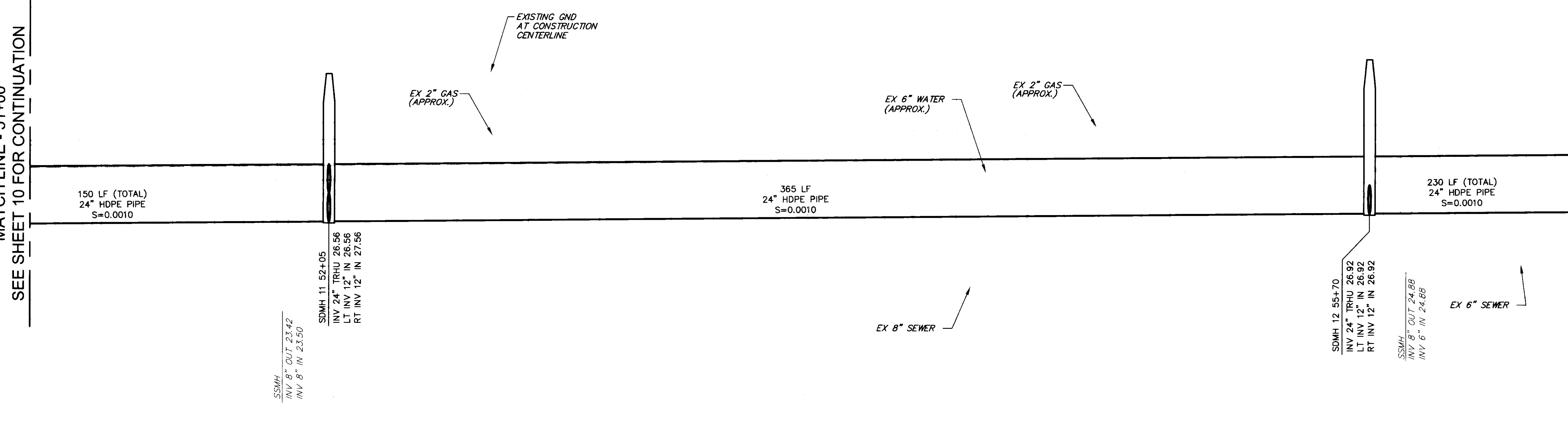

LAWSON CROSSLEY-KS, PRP/MSZ, PREP/LSZ, 22-34-PP20-EX/MA, EX/IT, Submitted Stamp

DATE:	11/29/07	TIME:	3:39:46 PM
SERVER:	LAYOUT: Layout1		
PATH:	N:\MTB014800\CADD\VP		
DRAWING NAME:	IPMS05.DWG		
PAGE SETUP:	22x34		
DESIGNER:	###	PROJ. MGR:	###

NO.	BY	DATE	REVISIONS:

Note: All utilities & obstructions shown are approximate. It is the contractor's responsibility to verify the location & depth with the appropriate agencies. The contractor shall notify the engineer immediately regarding any discrepancies or ambiguities which may exist.

CAUTION: The engineer preparing these plans will not be responsible for, or liable for, unauthorized changes to or uses of these plans. All changes to the plans must be in writing and must be approved by the preparer of these plans.

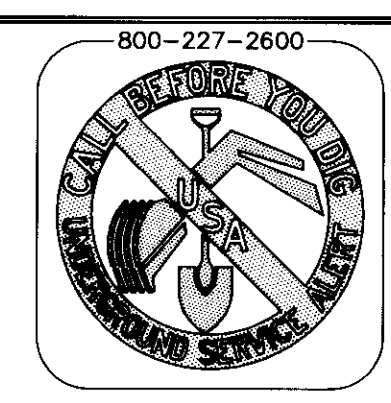
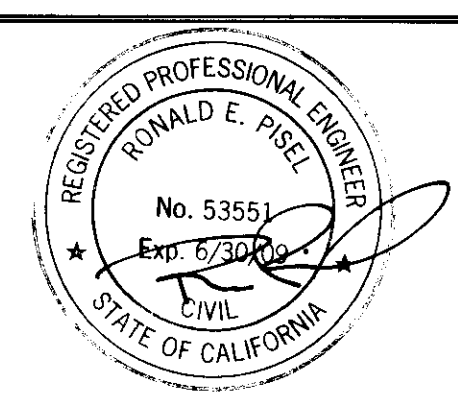

**NOLTE**  
BEYOND ENGINEERING  
1630 HOWARD ROAD, SUITE 125  
658.661.6220 TEL 658.661.4440 FAX  
MADERA, CA 93637  
WWW.NOLTE.COM

**SAN JOAQUIN COUNTY**  
GARDEN ACRES - WALKER LANE AREA STORM  
DRAINAGE IMPROVEMENTS - PHASE 2A & 2B  
PREPARED FOR: San Joaquin County  
DATE SUBMITTED: 11-29-07

SHEET NUMBER	11
OF	15 SHEETS
SCALE	VERTICAL: 1"=2' HORIZONTAL: 1"=20'
JOB NUMBER	MTB014800

SK-HH19



MARSH STREET

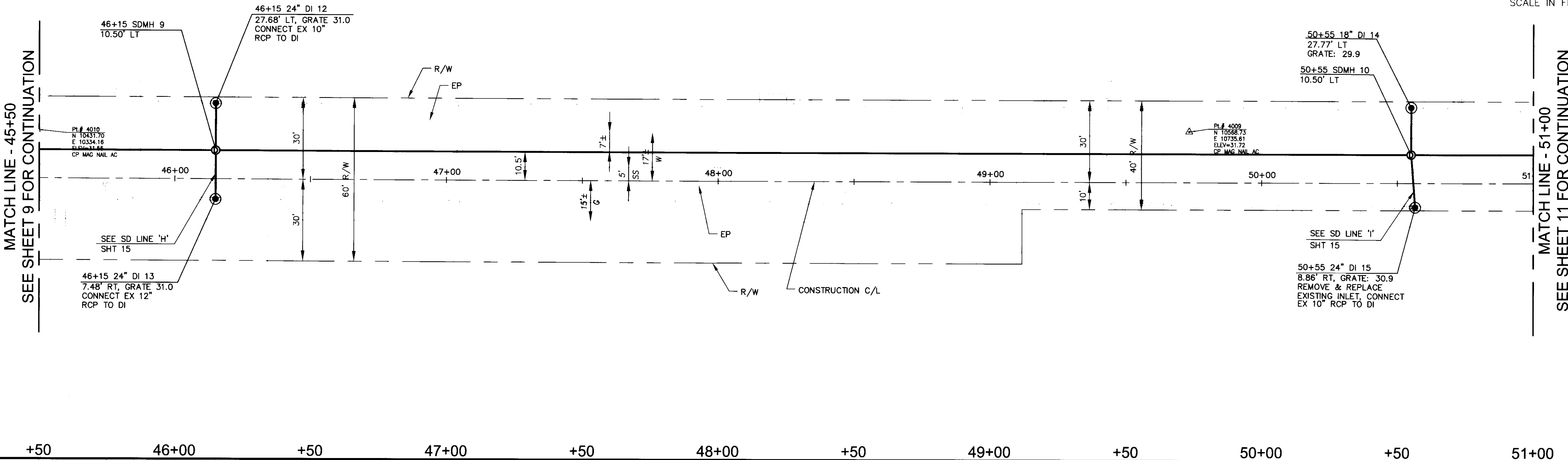
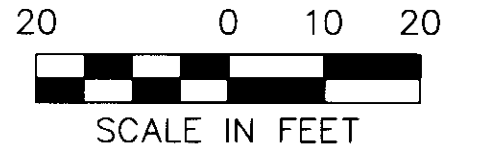

+50      46+00      +50      47+00      +50      48+00      +50      49+00      +50      50+00      +50      51+00

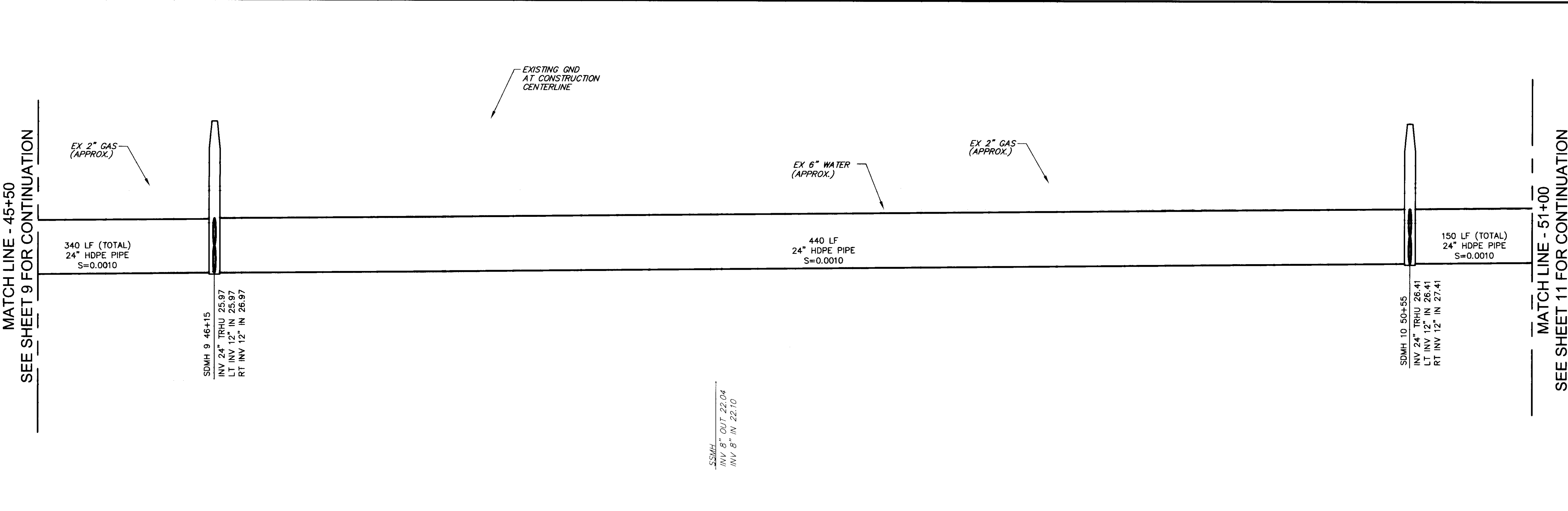

340 LF (TOTAL) 24" HDPE PIPE S=0.0010      440 LF 24" HDPE PIPE S=0.0010      150 LF (TOTAL) 24" HDPE PIPE S=0.0010

DATE: 11/29/07      TIME: 3:37:46 PM  
 SERVER: LAYOUT: Layout1  
 PATH: N:\MTB014800\CADD\VP  
 DRAWING NAME: IPMS04.DWG  
 PAGE SETUP: 22x34  
 DESIGNER: ###      PROJ. MGR: ###

NO.	BY	DATE	REVISIONS

Note: All utilities & obstructions shown are approximate. It is the contractor's responsibility to verify the location & depth with the appropriate agencies. The contractor shall notify the engineer immediately regarding any discrepancies or ambiguities which may exist.

CAUTION: The engineer preparing these plans will not be responsible for, or liable for, unauthorized changes to or uses of these plans. All changes to the plans must be in writing and must be approved by the preparer of these plans.

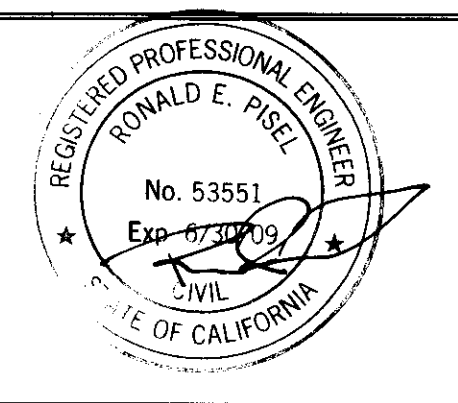

**NOLTE**  
 BEYOND ENGINEERING  
 1930 HOWARD ROAD, SUITE 125      MADERA, CA 93637  
 568.661.5220 TEL 568.661.4440 FAX      WWW.NOLTE.COM

**SAN JOAQUIN COUNTY**  
 GARDEN ACRES - WALKER LANE AREA STORM  
 DRAINAGE IMPROVEMENTS - PHASE 2A & 2B  
 PREPARED FOR: San Joaquin County      DATE SUBMITTED: 11-29-07

SHEET NUMBER  
**10**  
 OF 16 SHEETS  
 SCALE  
 VERTICAL: 1"=2'  
 HORIZONTAL: 1"=20'  
 JOB NUMBER  
**MTB014800**

SU-4420

MARSH STREET

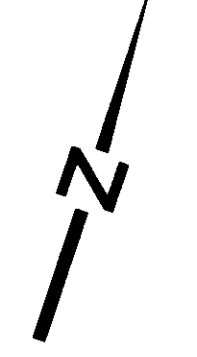
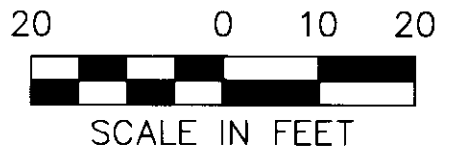

LIMITS OF SLURRY SEAL  
CARDINAL AVENUE

MATCH LINE - 45+50  
SEE SHEET 10 FOR CONTINUATION

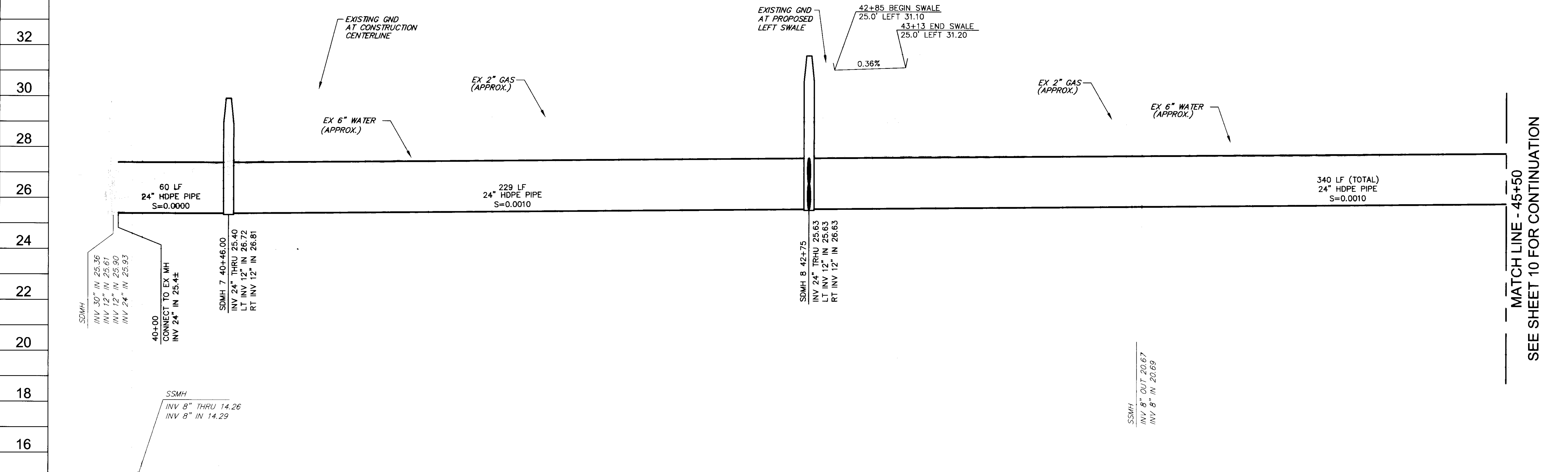
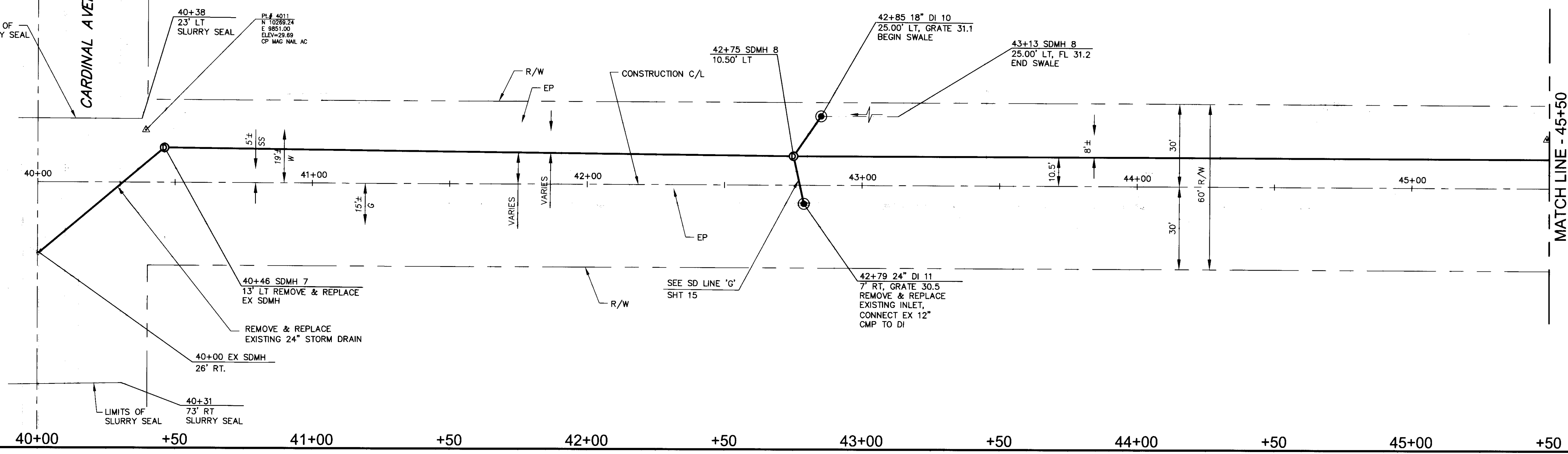

MATCH LINE - 45+50  
SEE SHEET 10 FOR CONTINUATION

DATE:	11/29/07	TIME:	3:35:43 PM
SERVER:		LAYOUT:	Layout1
PATH:	N:\MTB014800\CADD\JP		
DRAWING NAME:	IPMS03.DWG		
PAGE SETUP:	22x34		
DESIGNER:	###	PROJ. MGR:	###

NO. BY DATE REVISIONS:

Note: All utilities & obstructions shown are approximate. It is the contractor's responsibility to verify the location & depth with the appropriate agencies. The contractor shall notify the engineer immediately regarding any discrepancies or ambiguities which may exist.

CAUTION: The engineer preparing these plans will not be responsible for, or liable for, unauthorized changes to or uses of these plans. All changes to the plans must be in writing and must be approved by the preparer of these plans.

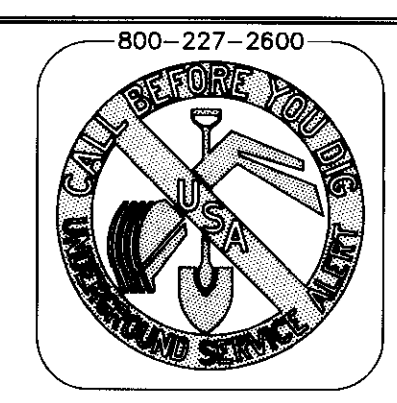
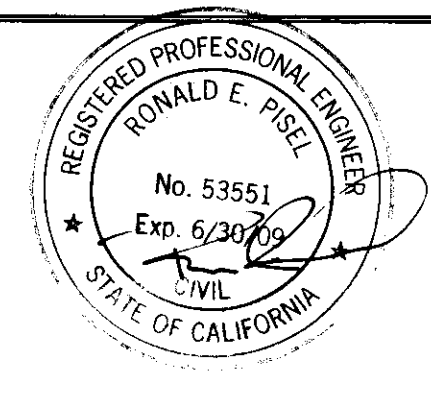

800-227-2600

# NOLTE

BEYOND ENGINEERING

1930 HOWARD ROAD, SUITE 125  
558.6615220 TEL 559.8614440 FAX

MADERA, CA 93637  
WWW.NOLTE.COM

SAN JOAQUIN COUNTY

GARDEN ACRES - WALKER LANE AREA STORM DRAINAGE IMPROVEMENTS - PHASE 2A & 2B

PREPARED FOR: San Joaquin County

DATE SUBMITTED: 11-29-07

SHEET NUMBER	9
OF	15 SHEETS
SCALE	VERTICAL: 1" = 2' HORIZONTAL: 1" = 20'
JOB NUMBER	MTB014800

SU-4421





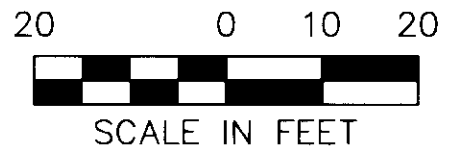

MARSH STREET

WALKER LANE

MATCH LINE - 25+50  
SEE SHEET 8 FOR CONTINUATION

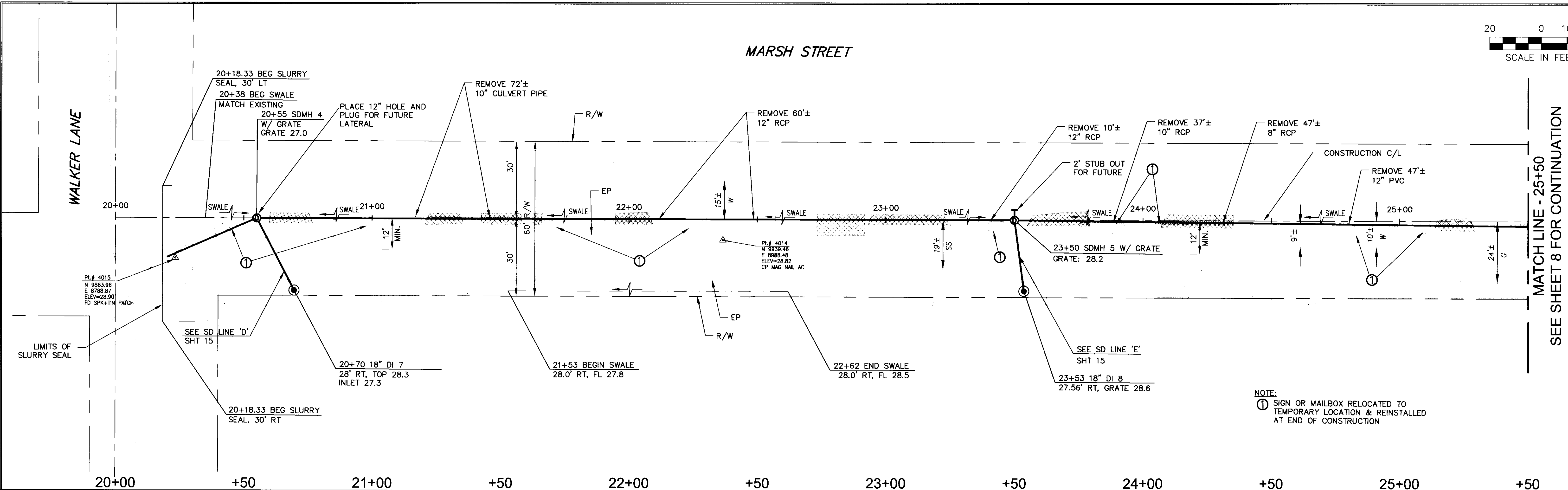

NOTE:  
① SIGN OR MAILBOX RELOCATED TO TEMPORARY LOCATION & REINSTALLED AT END OF CONSTRUCTION

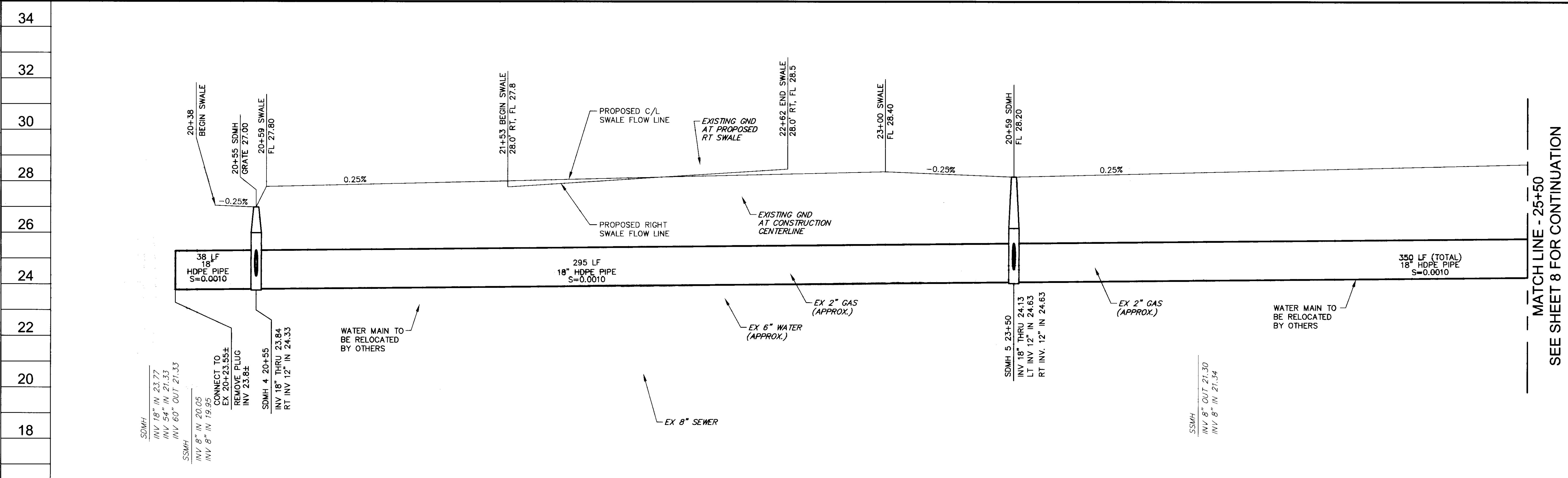

MATCH LINE - 25+50  
SEE SHEET 8 FOR CONTINUATION

DATE: 11/29/07 TIME: 3:32:37 PM  
 SERVER: LAYOUT: Layout1  
 PATH: N:\MTB014800\CADD\IP  
 DRAWING NAME: IPMS01.DWG  
 PAGE SETUP: 22x34  
 DESIGNER: JCJ PROJ. MGR: REP

NO.	BY	DATE	REVISIONS:

Note: All utilities & obstructions shown are approximate. It is the contractor's responsibility to verify the location & depth with the appropriate agencies. The contractor shall notify the engineer immediately regarding any discrepancies or ambiguities which may exist.

CAUTION: The engineer preparing these plans will not be responsible for, or liable for, unauthorized changes to or uses of these plans. All changes to the plans must be in writing and must be approved by the preparer of these plans.

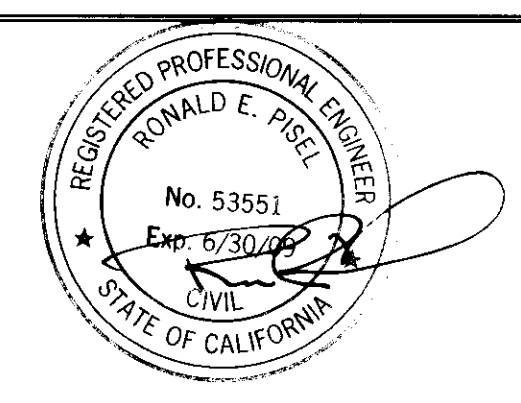

**NOLTE**  
BEYOND ENGINEERING  
1030 HOWARD ROAD, SUITE 125  
559.661.6220 TEL. 559.661.4440 FAX  
MADERA, CA 93637  
WWW.NOLTE.COM

**SAN JOAQUIN COUNTY**  
GARDEN ACRES - WALKER LANE AREA STORM DRAINAGE IMPROVEMENTS - PHASE 2A & 2B  
PREPARED FOR: San Joaquin County  
DATE SUBMITTED: 11-29-07

SHEET NUMBER	7
OF SHEETS	15
SCALE	VERTICAL: 1" = 2' HORIZONTAL: 1" = 20'
JOB NUMBER	MTB014800

SU 4423

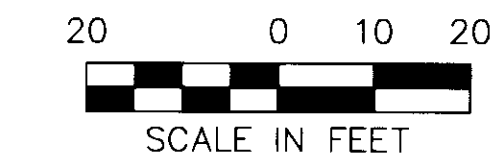

SONORA STREET

MATCH LINE - 6+50  
SEE SHEET 5 FOR CONTINUATION

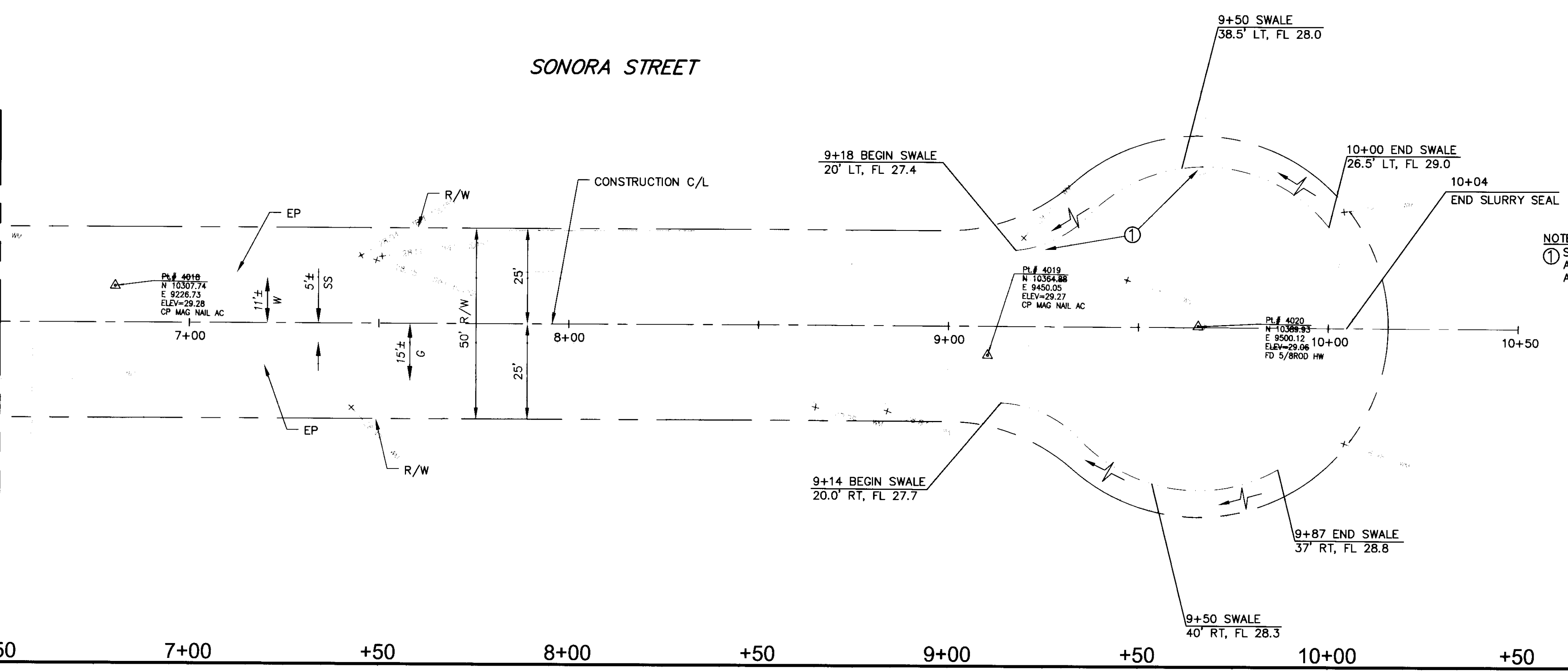

NOTE:  
① SIGN OR MAILBOX RELOCATED TO A TEMPORARY LOCATION & REINSTALLED AT END OF CONSTRUCTION

MATCH LINE - 6+50  
SEE SHEET 5 FOR CONTINUATION

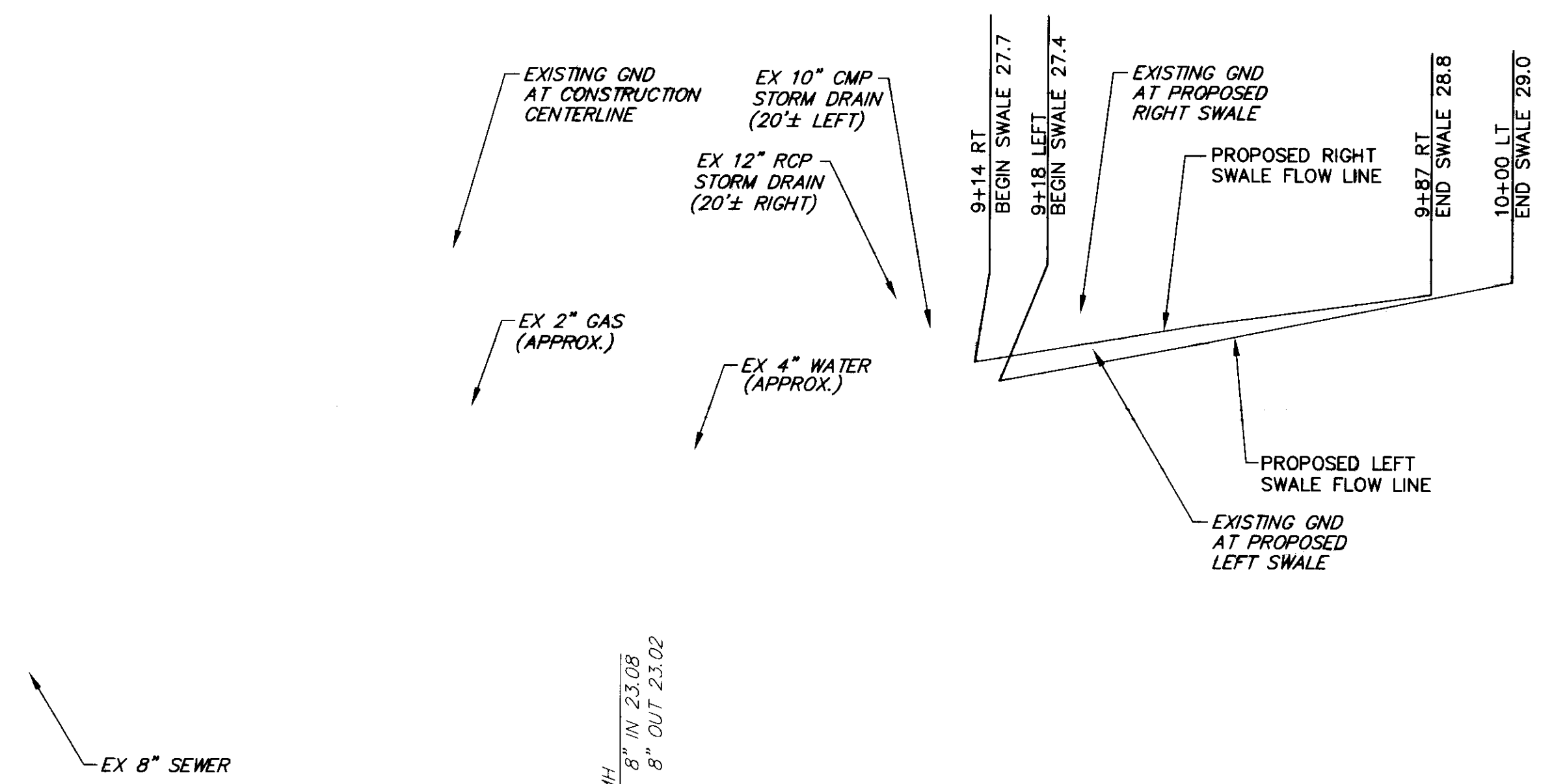

34  
32  
30  
28  
26  
24  
22  
20  
18

34  
32  
30  
28  
26  
24  
22  
20  
18

DATE: 11/29/07 TIME: 3:25:28 PM  
SERVER: LAYOUT: Layout1  
PATH: N:\MTB014800\CADD\VP  
DRAWING NAME: IPSS02.DWG  
PAGE SETUP: 22x34  
DESIGNER: PROJ. MGR:

NO.	BY	DATE	REVISIONS:

Note: All utilities & obstructions shown are approximate. It is the contractor's responsibility to verify the location & depth with the appropriate agencies. The contractor shall notify the engineer immediately regarding any discrepancies or ambiguities which may exist.

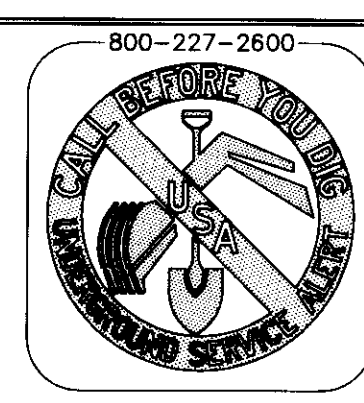
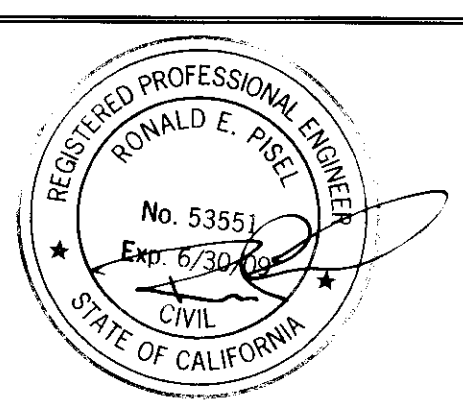

**NOLTE**  
BEYOND ENGINEERING  
1830 HOWARD ROAD, SUITE 125  
568.861.6220 TEL. 568.861.4440 FAX  
MADERA, CA 93637  
WWW.NOLTE.COM

**SAN JOAQUIN COUNTY**  
**GARDEN ACRES - WALKER LANE AREA STORM DRAINAGE IMPROVEMENTS - PHASE 2A & 2B**  
PREPARED FOR: San Joaquin County  
DATE SUBMITTED: 11-29-07

SHEET NUMBER	6
OF	15 SHEETS
SCALE	VERTICAL: 1"=2' HORIZONTAL: 1"=20'
JOB NUMBER	MTB014800

SU 4424

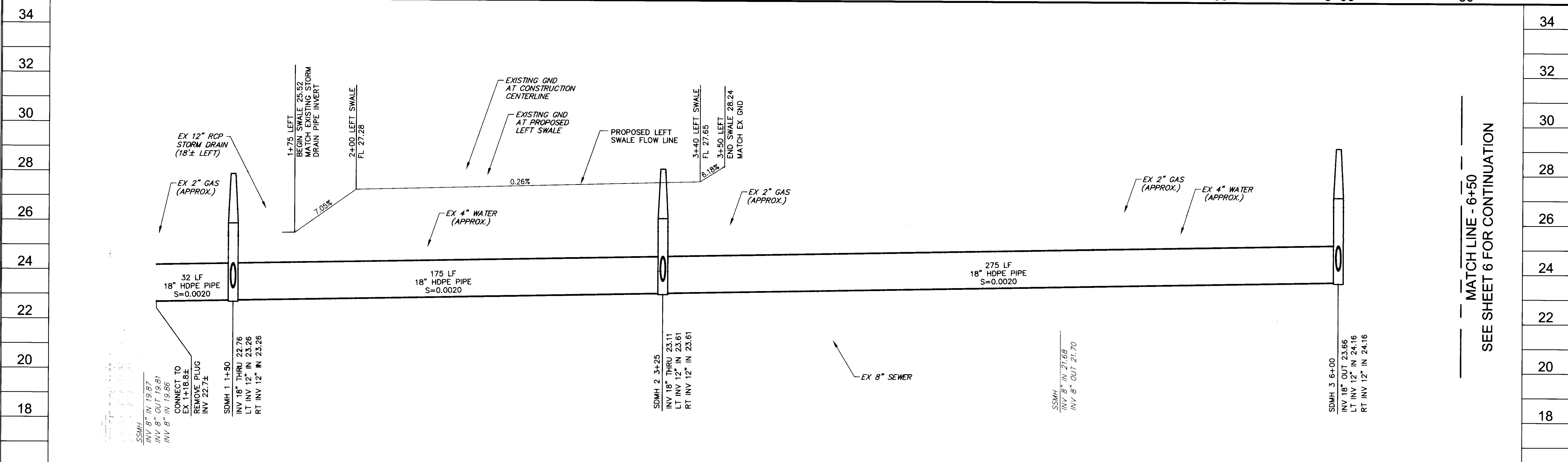
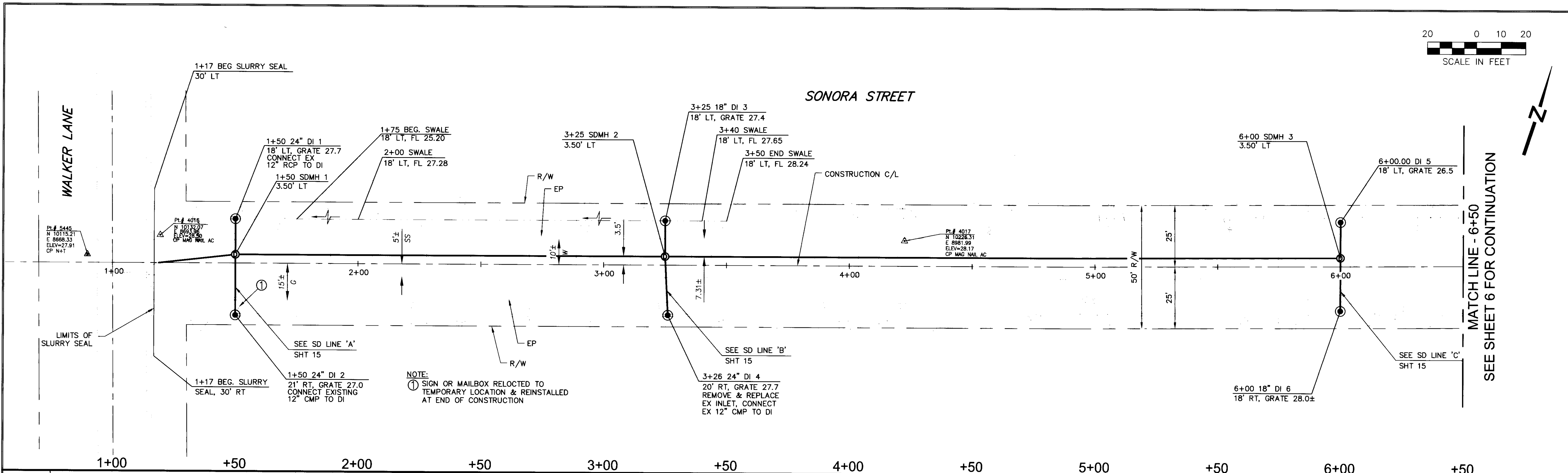
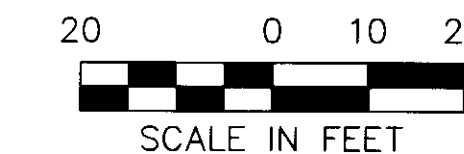

DATE:	11/29/07	TIME:	3:23:49 PM
SERVER:	LAYOUT: IP-04		
PATH:	N:\MTB014800\CADD\IP		
DRAWING NAME:	IPSS01.DWG		
PAGE SETUP:	22x34		
DESIGNER:	###	PROJ. MGR.:	###

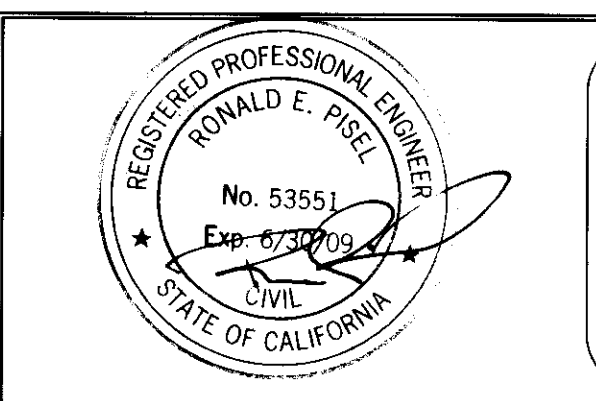

**NOLTE**  
BEYOND ENGINEERING  
1930 HOWARD ROAD, SUITE 125  
559.8618220 TEL 559.8614440 FAX  
MADERA, CA 93637  
WWW.NOLTE.COM

**SAN JOAQUIN COUNTY**  
**GARDEN ACRES - WALKER LANE AREA STORM DRAINAGE IMPROVEMENTS - PHASE 2A & 2B**  
PREPARED FOR: San Joaquin County  
DATE SUBMITTED: 11-29-07

SHEET NUMBER	5
OF	16 SHEETS
SCALE	VERTICAL: 1"=2' HORIZONTAL: 1"=20'
JOB NUMBER	MTB014800

SU-44 25

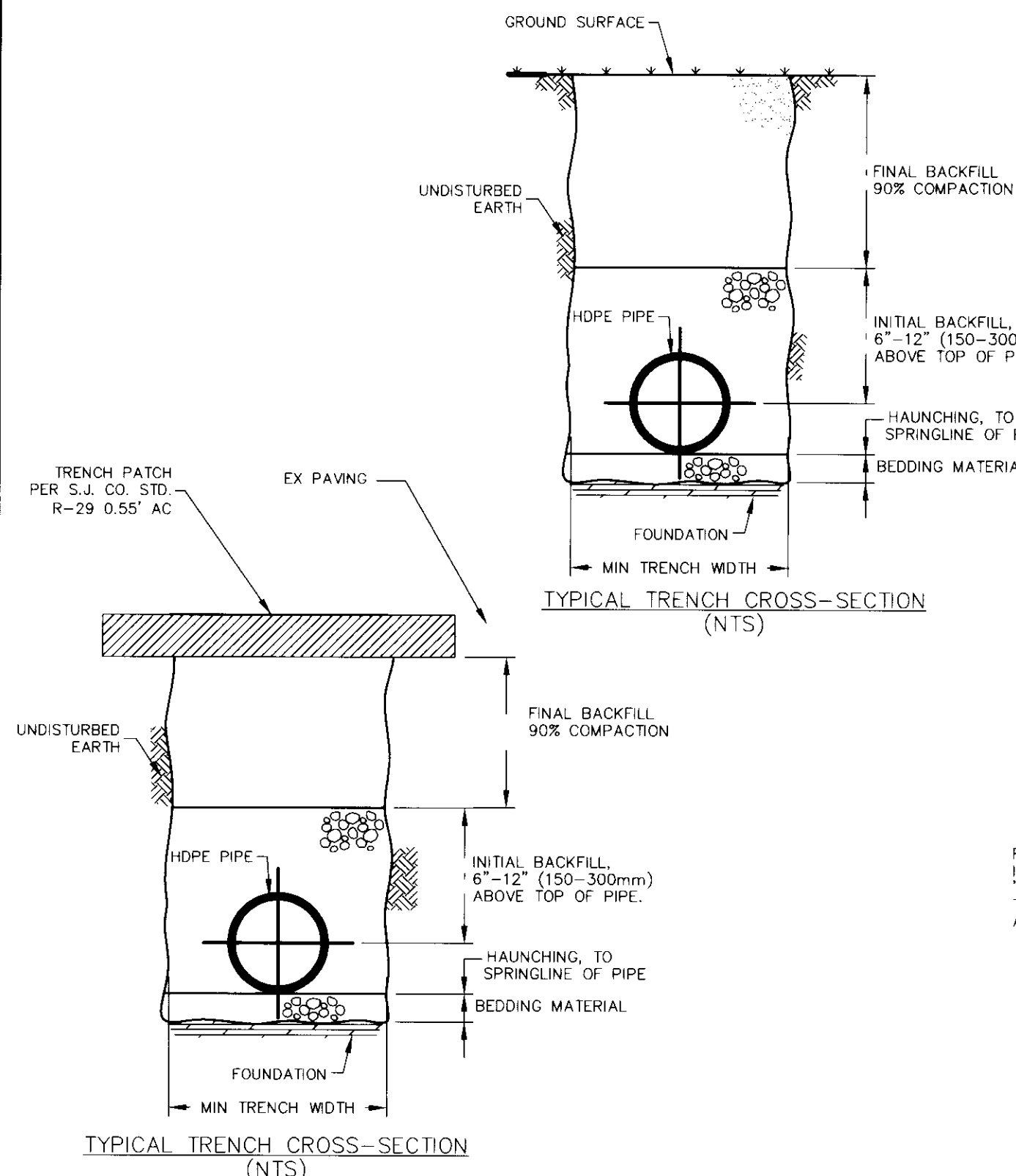

**NOTES:**

- FOUNDATION:** WHERE THE TRENCH BOTTOM IS UNSTABLE, THE CONTRACTOR SHALL EXCAVATE TO A DEPTH REQUIRED BY THE ENGINEER AND REPLACE WITH A FOUNDATION OF CLASS I OR II MATERIAL AS DEFINED IN ASTM D2321, "STANDARD PRACTICE FOR INSTALLATION OF THERMOPLASTIC PIPE FOR SEWERS AND OTHER GRAVITY-FLOW APPLICATIONS," LATEST EDITION; AS AN ALTERNATIVE AND AT THE DISCRETION OF THE ENGINEER, THE TRENCH BOTTOM MAY BE STABILIZED USING A WOVEN GEOTEXTILE FABRIC.
- BEDDING:** SUITABLE MATERIAL SHALL BE CLASS I, II OR III AND INSTALLED AS REQUIRED IN ASTM D2321, LATEST EDITION. UNLESS OTHERWISE SPECIFIED BY THE ENGINEER, MINIMUM BEDDING THICKNESS SHALL BE 4" (100mm) FOR 4"-24" (100-600mm) CORRUGATED POLYETHYLENE PIPE (CPEP); 6" (150mm) FOR 30"-60" (750-1500mm) CPEP.
- HAUNCHING AND INITIAL BACKFILL:** SUITABLE MATERIAL SHALL BE CLASS I, II OR III AND INSTALLED AS REQUIRED IN ASTM D2321, LATEST EDITION.
- UNLESS OTHERWISE SPECIFIED BY THE ENGINEER, MINIMUM TRENCH WIDTHS SHALL BE AS FOLLOWS:

NOMINAL Ø in (mm)	MIN. RECOMMENDED TRENCH WIDTH, in (mm)
4 (100)	21 (530)
6 (150)	23 (580)
8 (200)	25 (630)
10 (250)	28 (710)
12 (300)	31 (790)
15 (375)	34 (860)
18 (450)	39 (990)
24 (600)	48 (1220)
30 (750)	66 (1680)
36 (900)	78 (1980)
42 (1050)	83 (2110)
48 (1200)	89 (2260)
60 (1500)	102 (2590)

REFERENCE SECTION Y-2, "RECOMMENDATIONS FOR INCORPORATION INTO CONTRACT DOCUMENTS" OF ASTM SPECIFICATION D2321, "STANDARD PRACTICE FOR UNDERGROUND INSTALLATION OF THERMOPLASTIC PIPE FOR SEWERS AND OTHER GRAVITY-FLOW APPLICATIONS"

TRENCH INSTALLATION DETAIL

STD-101

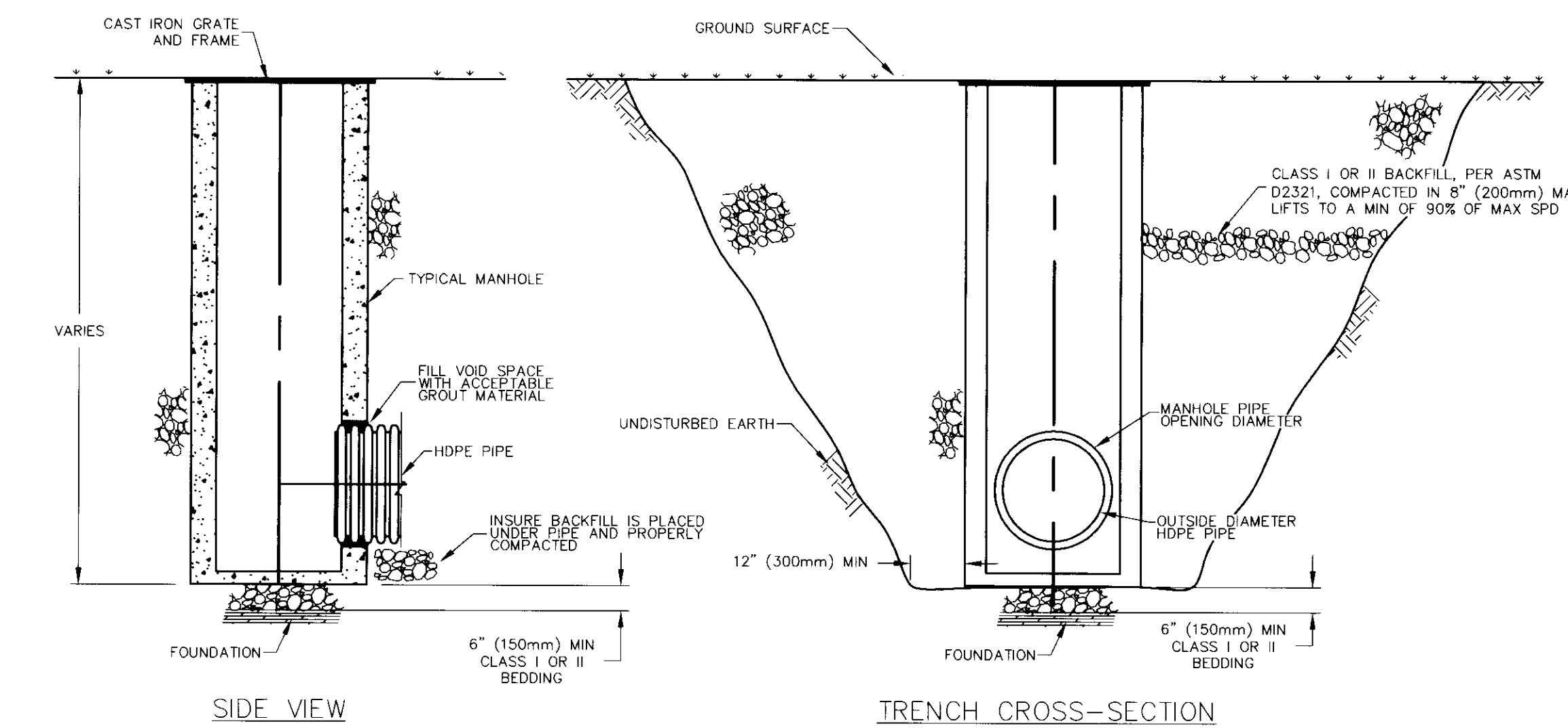

GROUTED MANHOLE CONNECTION FOR NON-WATERTIGHT APPLICATIONS ONLY

STD-201

DETAIL IS APPLICABLE FOR JOINING HDPE PIPE TO RCP UNDER SHALLOW COVER, LESS THAN 6' DEEP AND NO LIVE LOADING

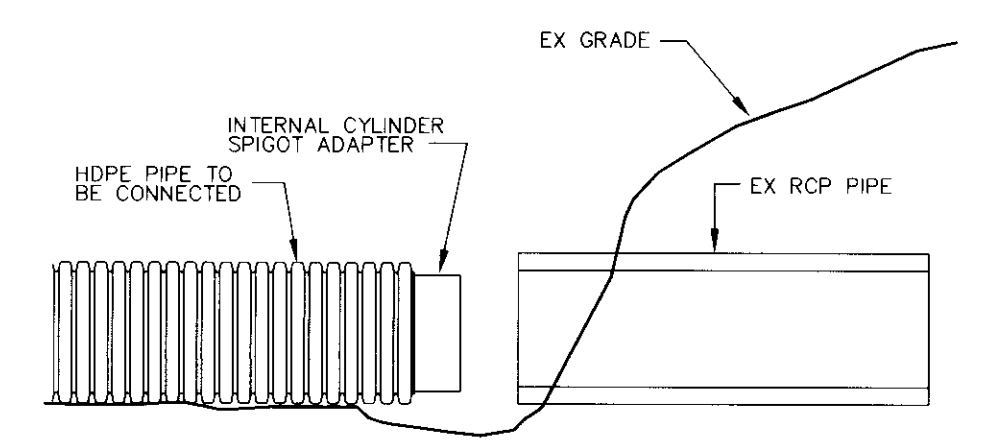

HDPE TO RCP CONNECTION

**NOTES:**

- EXISTING GRADE TO BE EXCAVATED IN SUCH A MANNER TO PROVIDE A SAFE WORK AREA.
- INTERNAL CYLINDER ADAPTER TO BE WELDED TO HDPE PIPE, OUTSIDE DIAMETER TO BE INSERTED INTO INSIDE DIAMETER OF CONCRETE PIPE OR CMP.
- AREA UNDER CONNECTION MUST BE OVEREXCAVATED TO ALLOW AMPLE WORK AREA TO WRAP NON-WOVEN GEOTEXTILE.
- NON-WOVEN GEOTEXTILE TO BE WRAPPED AROUND CONNECTION WITH FULL SEAM OVERLAP TO PROVIDE FULL PROTECTION FROM SOIL INTRUSION.
- CONNECTION AND PIPE TO BE BACKFILLED PER ASTM D2321.
- IN LIEU OF AN INTERNAL CYLINDER, A WATERTIGHT REPAIR COUPLER CAN BE USED TO CONNECT HDPE PIPE TO RCP OR CMP.
- INTERNAL CYLINDER ADAPTER IS NOT RECOMMENDED FOR DOWNSTREAM CONNECTIONS.

NOTE: ALL DIMENSIONS ARE NOMINAL

STD-601

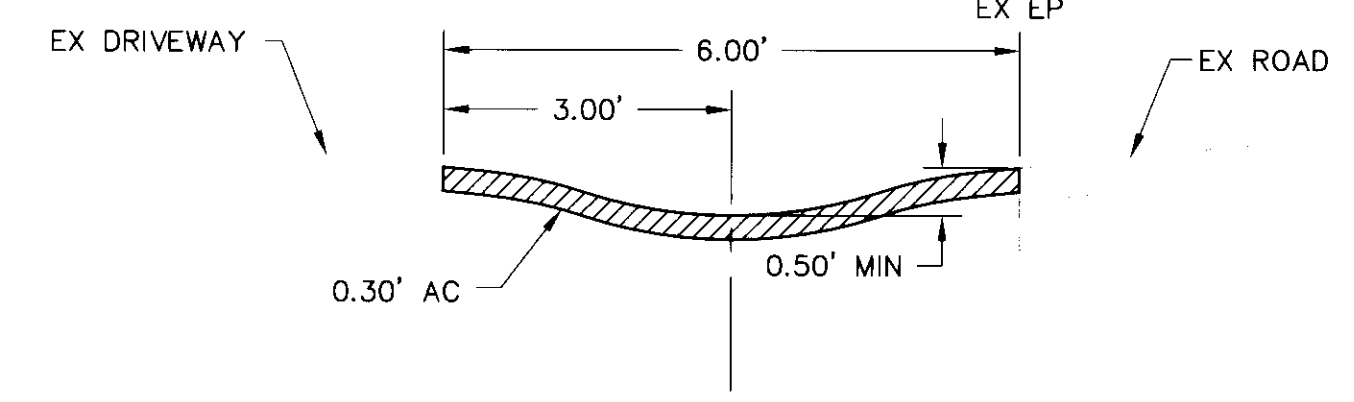

DEPRESSED DRIVEWAY DETAIL:

NTS SEE SUMMARY OF QUANTITIES ON SHEET 3 FOR LOCATIONS

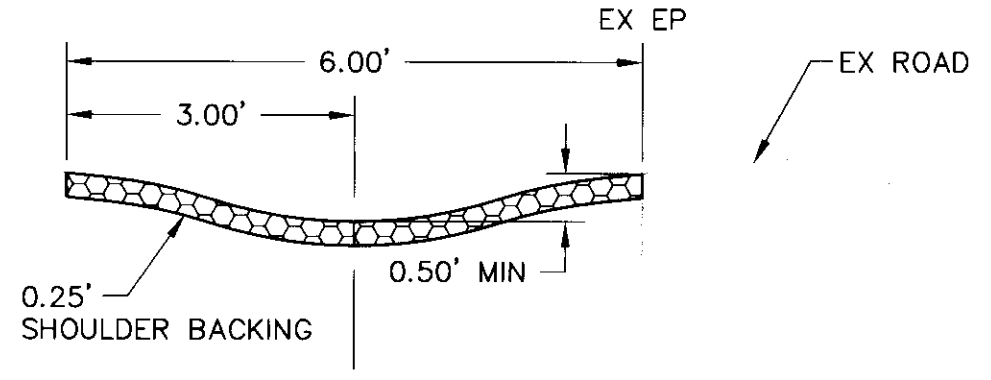

TYPICAL SWALE DETAIL:

NTS  
 SONORA STREET, STA 1+75 TO 3+50, 18' LT      MARSH STREET, STA 20+38 TO 27+19  
 SONORA STREET, STA 9+14 TO 9+87, 27.7' RT      MARSH STREET, STA 21+53 TO 22+62, 28' RT  
 SONORA STREET, STA 9+18 TO 10+00, 27.4' RT      MARSH STREET, STA 42+85 TO 43+13, 25' LT

DETAIL IS APPLICABLE FOR JOINING HDPE PIPE TO CMP WITH COVER OVER 6'

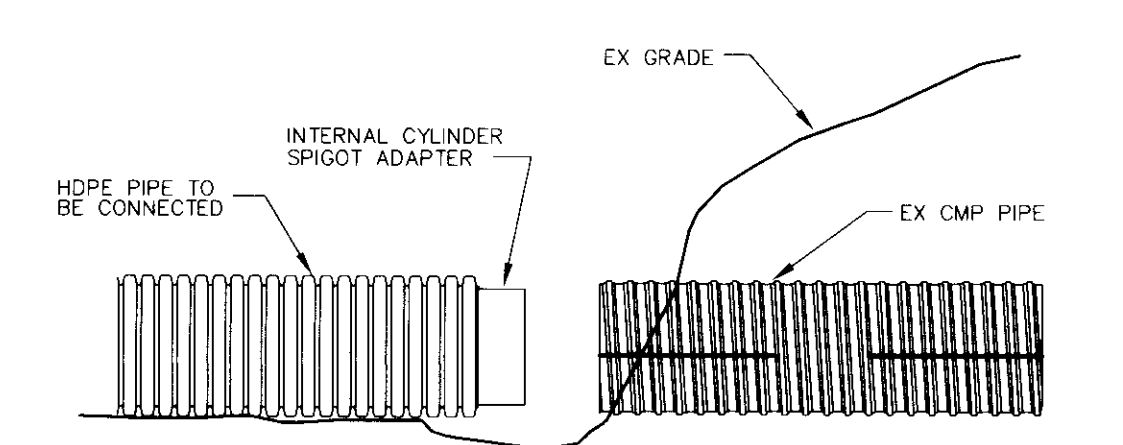

HDPE TO CMP CONNECTION

**NOTES:**

- EXISTING GRADE TO BE EXCAVATED IN SUCH A MANNER TO PROVIDE A SAFE WORK AREA.
- INTERNAL CYLINDER ADAPTER TO BE WELDED TO HDPE PIPE, OUTSIDE DIAMETER TO BE INSERTED INTO INSIDE DIAMETER OF CMP PIPE.
- AREA UNDER CONNECTION MUST BE OVEREXCAVATED TO ALLOW AMPLE WORK AREA TO WRAP NON-WOVEN GEOTEXTILE.
- NON-WOVEN GEOTEXTILE TO BE WRAPPED AROUND CONNECTION WITH FULL SEAM OVERLAP TO PROVIDE FULL PROTECTION FROM SOIL INTRUSION.
- CONCRETE ENCASEMENT TO BE CAST IN PLACE AROUND CONNECTION.
- CONNECTION AND PIPE TO BE BACKFILLED PER ASTM D2321.
- IN LIEU OF AN INTERNAL CYLINDER, A WATERTIGHT REPAIR COUPLER CAN BE USED TO CONNECT HDPE TO CMP.
- INTERNAL CYLINDER ADAPTER IS NOT RECOMMENDED FOR DOWNSTREAM CONNECTIONS.

NOTE: ALL DIMENSIONS ARE NOMINAL

STD-605

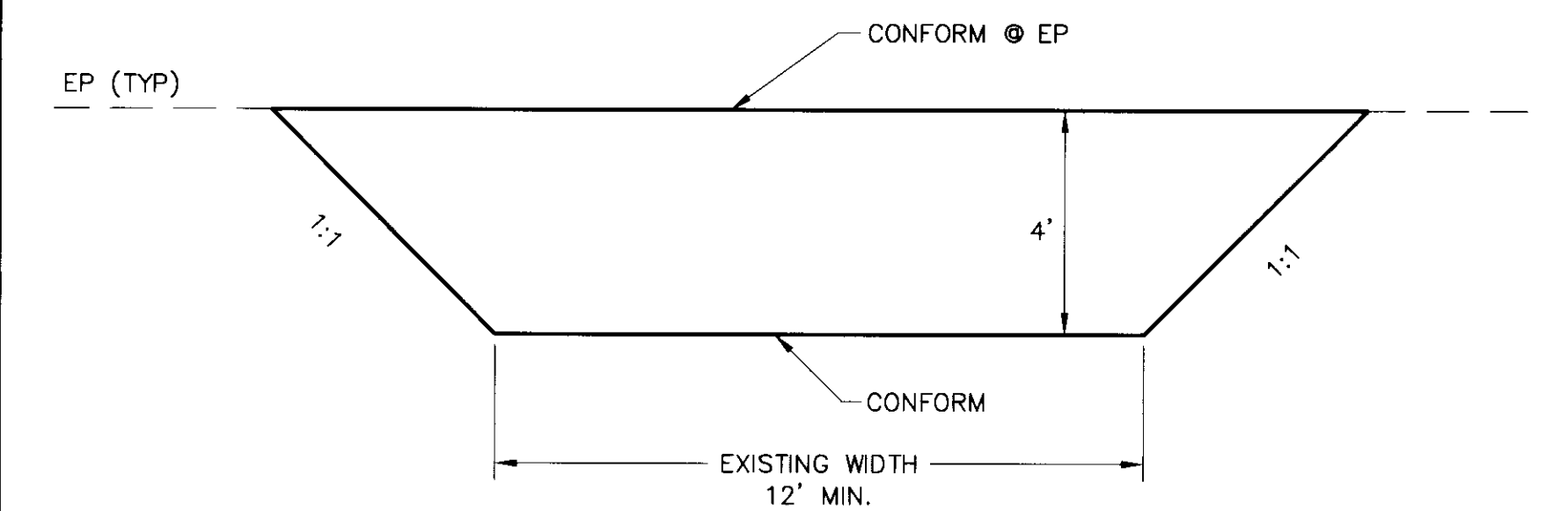

TYPE D

0.30' ASPHALT CONCRETE OVER SHAPED AND COMPACTED NATIVE MATERIAL.

JACKSON CROSSINGS, 22441, STD-101, STD-601, STD-605, Submitted Stamp

50-4426

DATE: 11/29/07 TIME: 3:21:46 PM  
 SERVER: LAYOUT: Layout1  
 PATH: N:\MTB014800\CADD\IP  
 DRAWING NAME: IP-04.DWG  
 PAGE SETUP: 22x34  
 DESIGNER: JGJ PROJ. MGR: REP

NO.	BY	DATE	REVISIONS:

Note: All utilities & obstructions shown are approximate. It is the contractor's responsibility to verify the location & depth with the appropriate agencies. The contractor shall notify the engineer immediately regarding any discrepancies or ambiguities which may exist.

CAUTION: The engineer preparing these plans will not be responsible for, or liable for, unauthorized changes to or uses of these plans. All changes to the plans must be in writing and must be approved by the preparer of these plans.

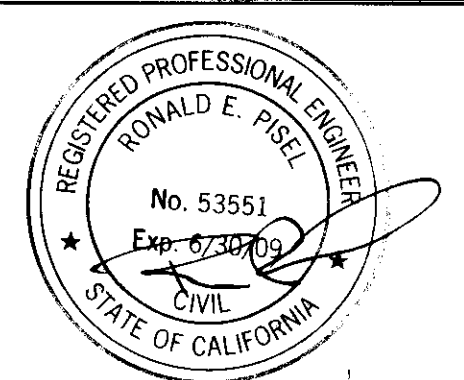

800-227-2600

# NOLTE

BEYOND ENGINEERING

1930 HOWARD ROAD, SUITE 125      MADERA, CA 93637  
 560.661.6220 TEL 560.661.4440 FAX      WWW.NOLTE.COM

SAN JOAQUIN COUNTY  
 GARDEN ACRES - WALKER LANE AREA STORM  
 DRAINAGE IMPROVEMENTS - PHASE 2A & 2B

PREPARED FOR: SAN JOAQUIN COUNTY      DATE SUBMITTED: 11-29-07

SHEET NUMBER  
**4**  
 OF 15 SHEETS  
 SCALE  
 VERTICAL: 1"=N/A  
 HORIZONTAL: 1"=N/A  
 JOB NUMBER  
**MTB014800**



EARTHWORK (MISCELLANEOUS AREAS)	
Location	Quantity
SONORA STREET	
Sta 1+75 - 3+50 (18' LT)	117 SY
Sta 9+18 - 10+00 (20' LT)	55 SY
Sta 9+14 - 9+87 (20' RT)	49 SY
MARSH STREET	
Sta 42+85 - 43+13 (25' LT)	19 SY
<b>TOTAL</b>	<b>240 SY</b>

SHOULDER BACKING	
Location	Quantity
SONORA STREET	
Sta 1+75-3+50	9.7 CY
Sta 9+14-9+87	4.1 CY
Sta 9+18-10+00	4.6 CY
MARSH STREET	
Sta 20+54-27+19	36.7 CY
Sta 21+53-22+62	6.1 CY
Sta 42+85-43+13	1.6 CY
<b>TOTAL</b>	<b>63 CY</b>

DRIVEWAY (TYPE D)	
Location	Quantity
MARSH STREET	
Sta 20+68±	9.4 SY
Sta 21+28±	8.3 SY
Sta 21+52±	10.7 SY
Sta 22+02±	6.7 SY
Sta 22+82±	18.4 SY
Sta 23+10±	12.4 SY
Sta 23+68±	13.3 SY
Sta 24+22±	15.6 SY
Sta 25+20±	7.1 SY
Sta 26+25±	18.0 SY
ARDELLE AVENUE	
Sta 78+00±	35.3 SY
<b>TOTAL</b>	<b>156 SY</b>

SLURRY SEAL (TYPE II)	
Location	Quantity
SONORA STREET	
Sta 1+17-10+05	2,813 SY
MARSH STREET	
Sta 20+18-Cardinal	2,229 SY
Cardinal Intersection	429 SY
Cardinal-Sta 60+57	5,429 SY
ARDELLE AVENUE	
Sta 70+23-81+21	3,135 SY
<b>TOTAL</b>	<b>14,035 SY</b>

12" HDPE	
Location	Quantity
SONORA STREET	
Sta 1+50	40 LF
Sta 3+25	39 LF
Sta 6+00	37 LF
MARSH STREET	
Sta 20+55	32 LF
Sta 23+50	30 LF
Sta 27+00	27 LF
Sta 42+75	36 LF
Sta 46+15	36 LF
Sta 50+55	38 LF
Sta 52+05	22 LF
Sta 55+70	36 LF
Sta 58+00	35 LF
ARDELLE AVENUE	
Sta 70+60	4 LF
Sta 72+85	24 LF
Sta 76+95	14 LF
Sta 77+70	39 LF
Sta 78+50	76 LF
<b>TOTAL</b>	<b>565 LF</b>

18" HDPE	
Location	Quantity
SONORA STREET	
Sta 1+18-6+00	482 LF
MARSH STREET	
Sta 20+23-27+00	683 LF
ARDELLE STREET	
Sta 72+85-77+70	485 LF
<b>TOTAL</b>	<b>1,650 LF</b>

24" HDPE	
Location	Quantity
MARSH STREET	
Sta 40+00-58+00	1814 LF
ARDELLE AVENUE	
Sta 70+41-72+85	244 LF
<b>TOTAL</b>	<b>2,058 LF</b>

18" STORM DRAIN INLET	
Location	Quantity
SONORA STREET	
Sta 3+25	1 EACH
Sta 6+00	2 EACH
MARSH STREET	
Sta 20+70	1 EACH
Sta 23+53	1 EACH
Sta 42+85	1 EACH
Sta 50+55	1 EACH
Sta 55+70	2 EACH
Sta 58+00	2 EACH
ARDELLE AVENUE	
Sta 77+80	1 EACH
Sta 78+50	1 EACH
<b>TOTAL</b>	<b>13 EACH</b>
18" DI FRAMES AND GRATES	13 EACH

24" STORM DRAIN INLET	
Location	Quantity
SONORA STREET	
Sta 1+50	2 EACH
Sta 3+26	1 EACH
MARSH STREET	
Sta 27+00	1 EACH
Sta 42+79	1 EACH
Sta 46+15	2 EACH
Sta 50+55	1 EACH
Sta 52+09	1 EACH
ARDELLE AVENUE	
Sta 72+86	1 EACH
Sta 76+98	1 EACH
Sta 77+71	1 EACH
<b>TOTAL</b>	<b>12 EACH</b>
24" DI FRAMES AND GRATES	12 EACH

STORM DRAIN MANHOLE	
Location	Quantity
SONORA STREET	
Sta 1+50	1 EACH
Sta 3+25	1 EACH
Sta 6+00	1 EACH
MARSH STREET	
Sta 20+55	1 EACH
Sta 23+50	1 EACH
Sta 27+00	1 EACH
Sta 40+46	1 EACH
Sta 42+75	1 EACH
Sta 46+15	1 EACH
Sta 50+55	1 EACH
Sta 52+05	1 EACH
Sta 55+70	1 EACH
Sta 58+00	1 EACH
ARDELLE AVENUE	
Sta 70+60	1 EACH
Sta 72+85	1 EACH
Sta 76+95	1 EACH
Sta 77+70	1 EACH
<b>TOTAL</b>	<b>17 EACH</b>
SDMH FRAMES AND GRATES	3 EACH
SDMH FRAMES AND SOLID COVERS	14 EACH

MISCELLANEOUS SEWER LATERAL CONNECTIONS	
Description	Quantity
VARIOUS LOCATIONS THROUGHOUT PROJECT	33 EACH

RELOCATE MAILBOXES	
Description	Quantity
MARSH STREET (VARIOUS LOCATIONS)	9 EACH
SONORA STREET (VARIOUS LOCATIONS)	2 EACH
<b>TOTAL:</b>	<b>11 EACH</b>

RELOCATE ROADSIDE SIGNS	
Description	Quantity
MARSH STREET	
Sta 20+45 (3' RT)	1 EACH
Sta 57+98 (24' LT)	1 EACH
SONORA STREET	
Sta 1+50 (18' RT)	1 EACH
<b>TOTAL:</b>	<b>3 EACH</b>

DATE: 11/29/07	TIME: 3:20:56 PM	NO.	BY	DATE	REVISIONS:
SERVICES: _____	LAYOUT: Layout1				
PATH: N:\MTB014800\CADD\VP					
DRAWING NAME: IP-03.DWG					
PAGE SETUP: 22x34					
DESIGNER: JCJ	PROJ. MGR: REP				

Note: All utilities & obstructions shown are approximate. It is the contractor's responsibility to verify the location & depth with the appropriate agencies. The contractor shall notify the engineer immediately regarding any discrepancies or ambiguities which may exist.

CAUTION: The engineer preparing these plans will not be responsible for, or liable for, unauthorized changes to or uses of these plans. All changes to the plans must be in writing and must be approved by the preparer of these plans.

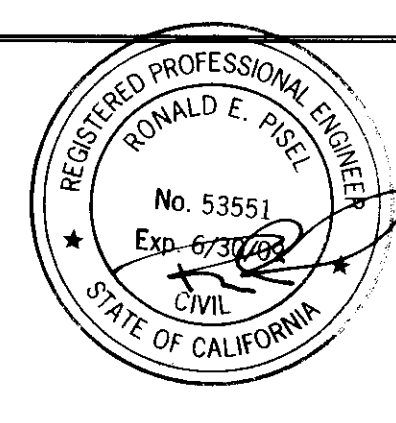

**NOLTE**  
BEYOND ENGINEERING

1830 HOWARD ROAD, SUITE 125  
558.861.6220 TEL. 558.861.4440 FAX

MADERA, CA 93637  
WWW.NOLTE.COM

**SAN JOAQUIN COUNTY**  
GARDEN ACRES - WALKER LANE AREA STORM DRAINAGE IMPROVEMENTS - PHASE 2A & 2B

PREPARED FOR: SAN JOAQUIN COUNTY

DATE SUBMITTED: 11-29-07

SHEET NUMBER	3
OF	15 SHEETS
SCALE	VERTICAL: 1"=N/A HORIZONTAL: 1"=N/A
JOB NUMBER	MTB014800

54-4427



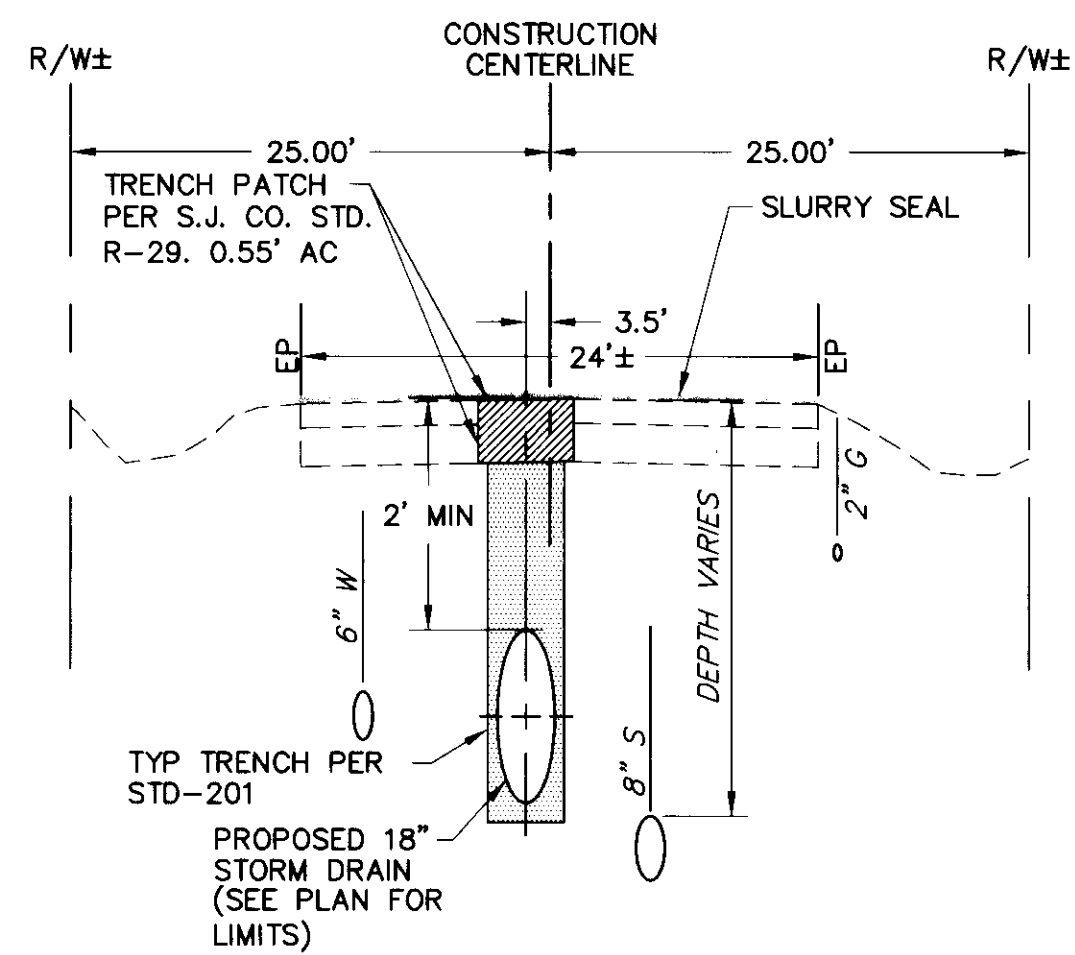

**SONORA STREET - TYPICAL SECTION**  
 BETWEEN WALKER LANE AND EAST END  
 STA 1+17± TO 10+04±  
 NO SCALE

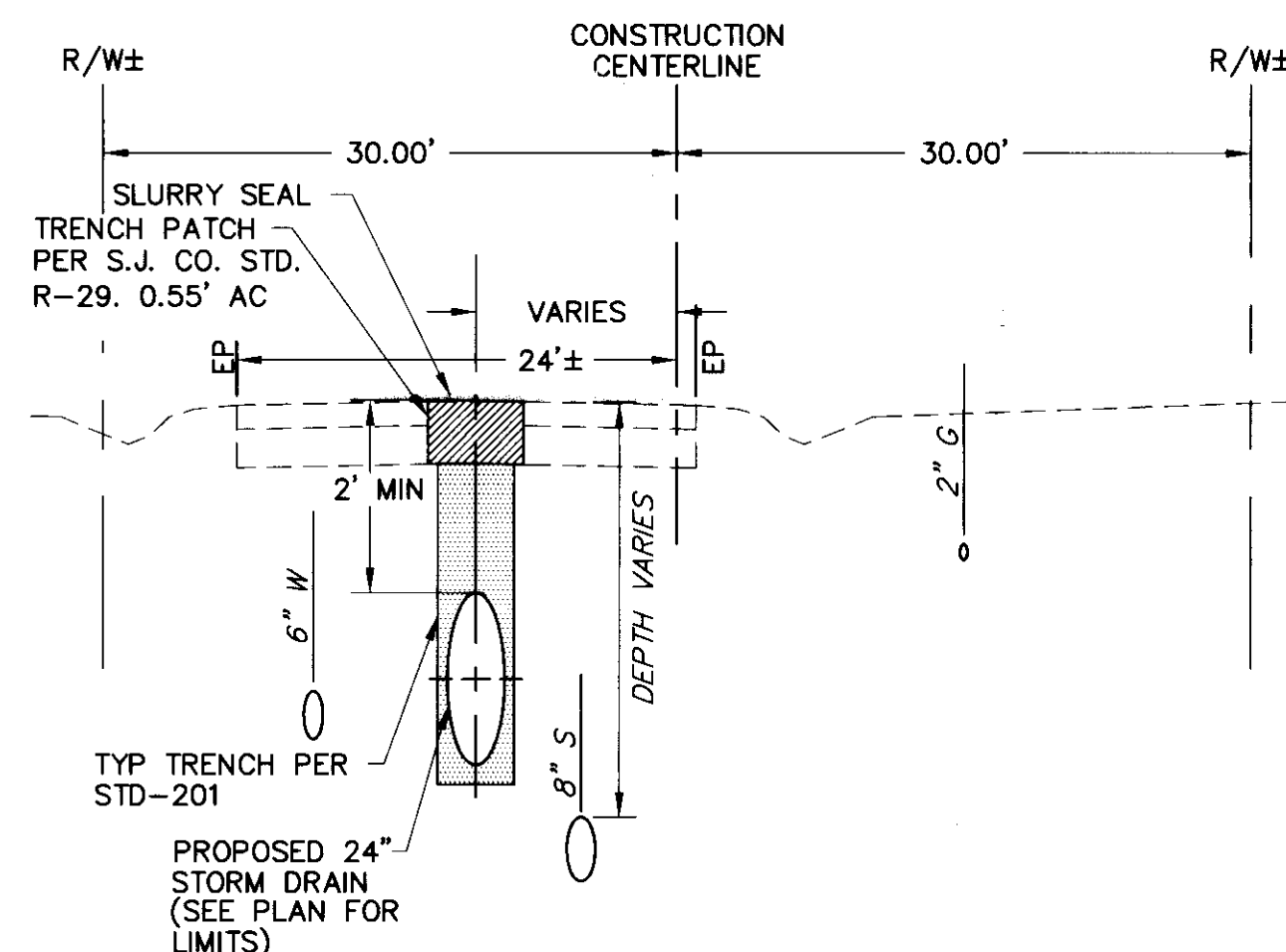

**MARSH STREET - TYPICAL SECTION**  
 BETWEEN CARDINAL AVENUE AND BIRD AVENUE  
 STA 40+26± TO 49+11±  
 NO SCALE

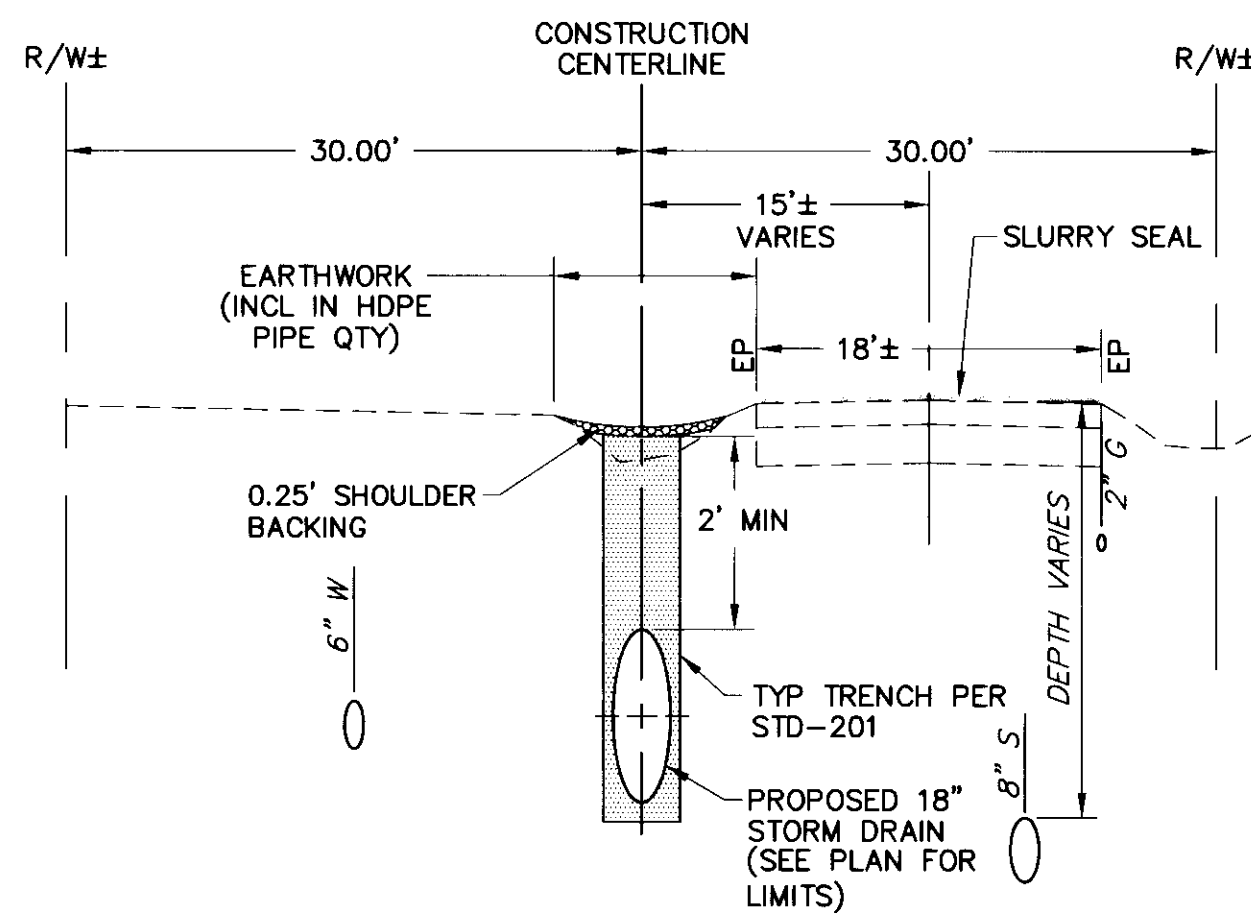

**MARSH STREET - TYPICAL SECTION**  
 BETWEEN WALKER LANE AND CARDINAL AVENUE  
 STA 20+18± TO 25+57±  
 NO SCALE

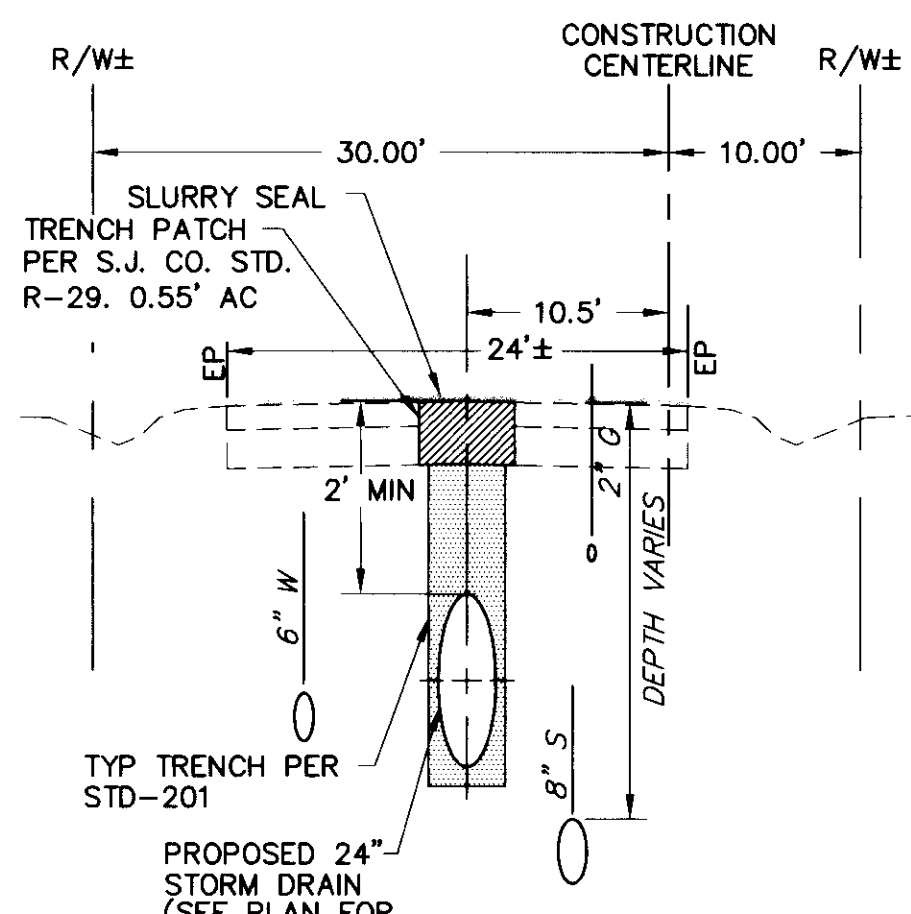

**MARSH STREET - TYPICAL SECTION**  
 BETWEEN BIRD AVENUE AND THE DIVERTING CANAL  
 STA 49+11± TO 60+57±  
 NO SCALE

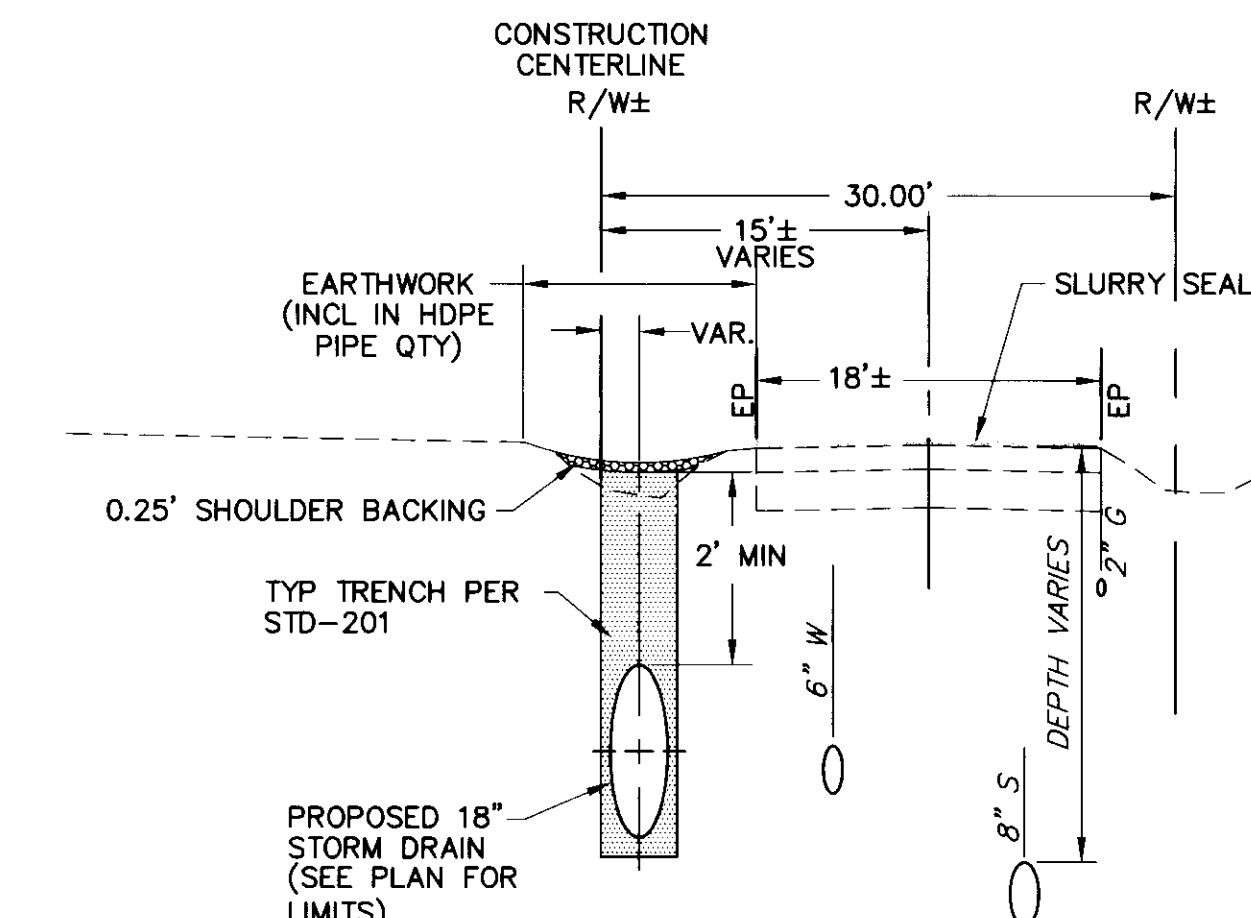

**MARSH STREET - TYPICAL SECTION**  
 BETWEEN WALKER LANE AND CARDINAL AVENUE  
 STA 25+57± TO 31+13±  
 NO SCALE

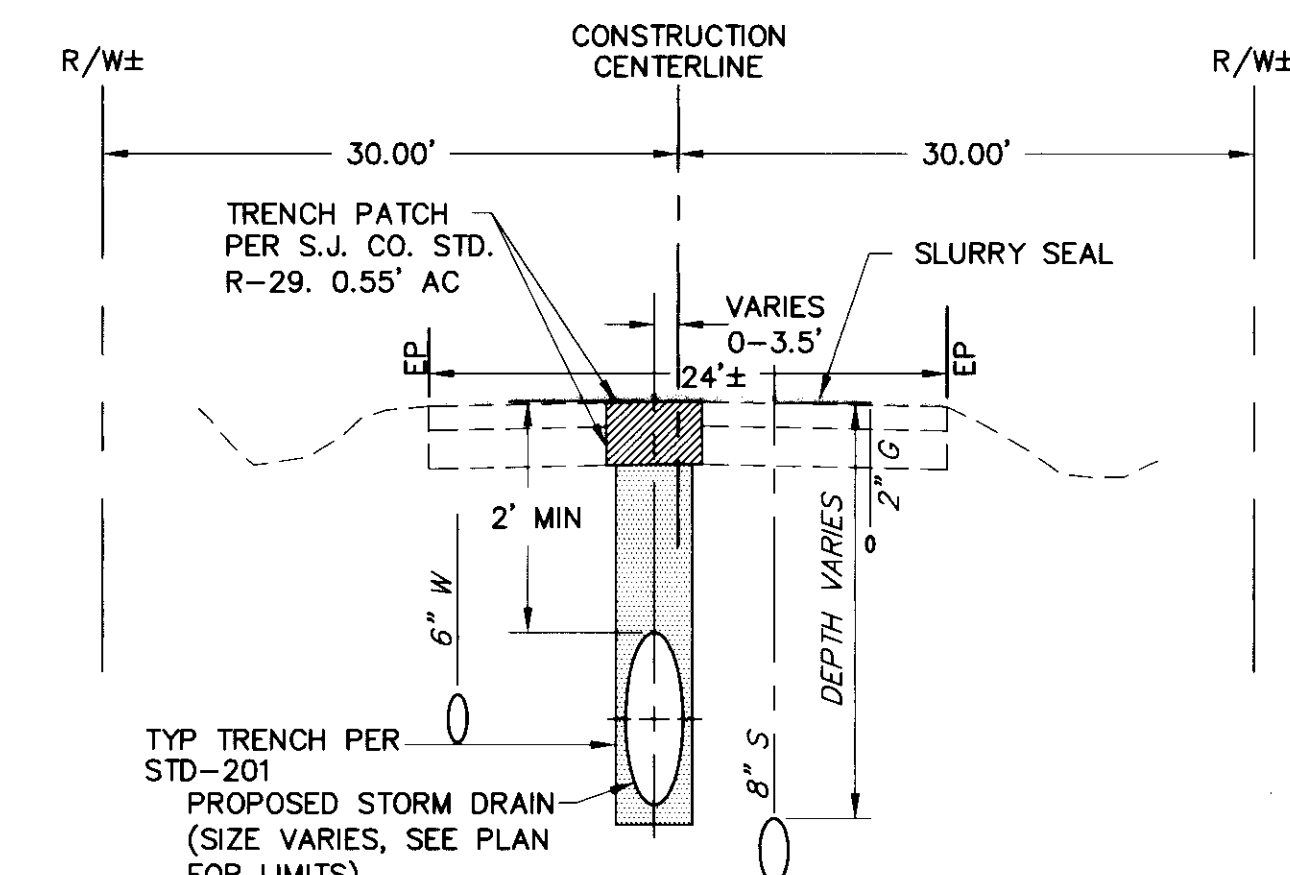

**ARDELLE AVENUE - TYPICAL SECTION**  
 BETWEEN CARDINAL AVENUE AND BIRD AVENUE  
 STA 70+23± TO 81+21±  
 NO SCALE

**GENERAL NOTES:**

- ALL IMPROVEMENTS SHALL BE CONSTRUCTED IN STRICT ACCORDANCE WITH THE COUNTY OF SAN JOAQUIN OR CITY OF STOCKTON STANDARD PLANS AND SPECIFICATIONS, AND ALL AMENDMENTS THERETO TO DATE. ALL WORK SHALL BE UNDER THE INSPECTION OF THE COUNTY, SANITARY SEWER WORK BY THE CITY OF STOCKTON DEPARTMENT OF PUBLIC WORKS.
- IT IS INTENDED THAT THESE PLANS AND THE COUNTY STANDARD SPECIFICATIONS REQUIRE ALL LABOR AND MATERIALS NECESSARY AND PROPER FOR THE WORK CONTEMPLATED BE PROVIDED AND THAT THE WORK BE COMPLETED IN ACCORDANCE WITH THEIR TRUE INTENT AND PURPOSE.
- THE CONTRACTOR SHALL NOTIFY THE ENGINEER IMMEDIATELY REGARDING ANY DISCREPANCIES OR AMBIGUITIES WHICH MAY EXIST IN THE PLANS OR SPECIFICATIONS. THE ENGINEER'S INTERPRETATION OR CORRECTION THEREOF SHALL BE CONCLUSIVE.
- DRAWING NUMBERS SHOWN ON THE PLANS REFER TO COUNTY OF SAN JOAQUIN STANDARD PLANS, SHOWN THUS: S.J. CO. STD.
- WHERE THE PLANS OR SPECIFICATIONS DESCRIBE PORTIONS OF THE WORK IN GENERAL TERMS BUT NOT IN COMPLETE DETAIL, IT IS UNDERSTOOD THAT ONLY THE BEST GENERAL PRACTICE IS TO PREVAIL AND THAT ONLY MATERIALS AND WORKMANSHIP OF THE FIRST QUALITY ARE TO BE USED.
- CONSTRUCTION STAKING FOR ALL WORK SHALL BE DONE BY THE CONTRACTOR.
- THE CONTRACTOR SHALL EXERCISE DUE CAUTION AND SHALL CAREFULLY PRESERVE BENCH MARKS, REFERENCE POINTS AND ALL SURVEY STAKES, AND SHALL BEAR ALL EXPENSES FOR REPLACEMENT AND/OR ERRORS CAUSED BY THEIR UNNECESSARY LOSS OR DISTURBANCE.
- THE CONTRACTOR SHALL BE HELD RESPONSIBLE FOR ANY FIELD CHANGES MADE WITHOUT WRITTEN AUTHORIZATION FROM THE COUNTY.
- ALL UNDERGROUND UTILITIES SHALL BE IN PLACE PRIOR TO INSTALLATION OF ANY CURB, GUTTER, SIDEWALK, AND STREET PAVING.
- ALL STATIONS REFER TO DISTANCES ALONG CONSTRUCTION CENTERLINE, PERPENDICULAR TO OR RADIAL FROM THE CENTERLINE STATIONS, UNLESS OTHERWISE NOTED.
- ALL UTILITIES AND OBSTRUCTIONS SHOWN ARE APPROXIMATE. IT IS THE CONTRACTOR'S RESPONSIBILITY TO VERIFY THE LOCATION AND DEPTH WITH THE APPROPRIATE AGENCIES. THE CONTRACTOR SHALL NOTIFY THE ENGINEER IMMEDIATELY REGARDING ANY DISCREPANCIES OR AMBIGUITIES WHICH MAY EXIST.
- THE CONTRACTOR SHALL EXPOSE AND CHECK INVERTS ON EXISTING UTILITIES AND CLEARANCE OF KNOWN CROSSINGS OF UTILITIES BEFORE CONSTRUCTING NEW PIPELINES, IN ACCORDANCE WITH SPECIAL PROVISIONS. THE CONTRACTOR SHALL NOTIFY THE ENGINEER IMMEDIATELY REGARDING ANY DISCREPANCIES OR AMBIGUITIES WHICH MAY EXIST.
- IT SHALL BE THE CONTRACTOR'S RESPONSIBILITY TO NOTIFY THE ENGINEER OF ANY DIFFERENCES IN LOCATION OF EXISTING UTILITIES FROM THAT SHOWN, OR ANY OTHER CONFLICTS WITH THE DESIGN BEFORE CONTINUING WITH WORK IN THAT AREA.
- IT SHALL BE THE CONTRACTOR'S SOLE RESPONSIBILITY TO PROTECT ALL EXISTING UTILITIES SO THAT NO DAMAGE RESULTS TO THEM DURING THE PERFORMANCE OF THIS CONTRACT.
- THE CONTRACTOR SHALL BE REQUIRED TO COOPERATE WITH OTHER CONTRACTORS AND UTILITY COMPANIES INSTALLING NEW STRUCTURES, UTILITIES AND SERVICE TO THE PROJECT.
- PRIOR TO COMMENCING ANY WORK, IT SHALL BE THE CONTRACTORS RESPONSIBILITY TO HAVE EACH UTILITY COMPANY LOCATE IN THE FIELD THEIR MAIN AND SERVICE LINES.
- THE CONTRACTOR SHALL NOTIFY THE MEMBERS OF THE UNDERGROUND SERVICE ALERT (U.S.A.) 48 HOURS IN ADVANCE OF PERFORMING EXCAVATION WORK BY CALLING THE TOLL-FREE NUMBER 1-800-227-2600.
- THE CONTRACTOR SHALL BE RESPONSIBLE FOR PROTECTING EXISTING IMPROVEMENTS FROM DAMAGE. THE COST OF REPLACING EXISTING IMPROVEMENTS SHALL BE DONE AT CONTRACTOR'S EXPENSE.
- A CITY OF STOCKTON REPRESENTATIVE SHALL BE PRESENT DURING ALL CONSTRUCTION WORK RELATED TO SANITARY SEWERS.
- THE CONTRACTOR'S ATTENTION IS DIRECTED TO: SECTION 1540 (a) (1) OF THE CONSTRUCTION SAFETY ORDERS (TITLE 8 CALIFORNIA ADMINISTRATION CODE SECTION 1540), ISSUED BY THE OCCUPATIONAL SAFETY AND HEALTH STANDARDS BOARD PURSUANT TO THE CALIFORNIA OCCUPATIONS SAFETY AND HEALTH ACT OF 1973 AS AMENDED WHICH STATES:  
 "PRIOR TO OPENING AN EXCAVATION, EFFORT SHALL BE MADE TO DETERMINE WHETHER UNDERGROUND INSTALLATIONS; I.E., SEWER, WATER, FUEL, ELECTRIC LINES, ETC., WILL BE ENCOUNTERED AND IF SO, WHERE SUCH UNDERGROUND INSTALLATIONS ARE LOCATED. WHEN THE EXCAVATION APPROACHES THE APPROXIMATE LOCATION OF SUCH AN INSTALLATION, THE EXACT LOCATION SHALL BE DETERMINED BY CAREFUL PROBING OR HAND DIGGING; AND, WHEN IT IS UNCOVERED, ADEQUATE PROTECTION SHALL BE PROVIDED FOR THE EXISTING INSTALLATION. ALL KNOWN OWNERS OF UNDERGROUND FACILITIES IN THE AREA CONCERNED SHALL BE ADVISED OF PROPOSED WORK AT LEAST 48 HOURS PRIOR TO THE START OF ACTUAL EXCAVATION".

**STORM DRAIN:**

- THE CONTRACTOR SHALL EXPOSE EXISTING STORM DRAINS, WHERE CONNECTION IS TO BE MADE, TO VERIFY EXISTING FLOW LINES AND LOCATIONS. CONTRACTOR SHALL IMMEDIATELY NOTIFY THE ENGINEER OF ANY DISCREPANCIES FROM THE PLANS.
- CONTRACTOR TO BE RESPONSIBLE FOR ALL TESTING OF STORM DRAIN FACILITIES. ALL TESTING SHALL BE AT CONTRACTOR'S EXPENSE AND SHALL BE INCLUDED IN THE PRICE BID FOR STORM DRAIN INSTALLATION.
- STORM DRAIN STUBS SHALL BE PLUGGED WITH A REMOVABLE PLUG RECOMMENDED BY PIPE MANUFACTURER.
- STORM DRAIN INLETS SHALL BE 18" OR 24" DIA. PER S.J. CO. STD. CW-D14, UNLESS OTHERWISE NOTED.
- STORM DRAIN MANHOLES PER S.J. CO. STD. CW-S7 AND D-18.
- WHEN TRENCH AND EXCAVATION IS IN EXISTING PAVED STREETS AND/OR DRIVEWAYS, REPLACE PAVEMENT 6" ON EACH SIDE OF TRENCH. REFER TO S.J. CO. STD. DRAWING NO. R-29. MAXIMUM PAYMENT WIDTH FOR AC WILL BE O.D. +20" +12" (6" ON EACH SIDE OF TRENCH).
- IF THE WATER MAIN PARALLELING THE STORM DRAIN MAIN DOES NOT MEET THE CASE 2 ZONE B REQUIREMENTS, THE STORM DRAIN MAIN SHOULD BE CONSTRUCTED OF HIGH-DENSITY-POLYETHYLENE (HDPE) PIPE WITH FUSION WELDED JOINTS (PER AWWA C906-99).

**BITUMINOUS SEAL:**

- THE CONTRACTOR SHALL SEAL EXISTING PAVEMENT THE LIMITS OF THE PROJECT WITH LATEX MODIFIED SLURRY SEAL (TYPE II), REFER TO TYPICAL SECTIONS FOR ROAD WIDTHS AND STATIONING.

DATE: 11/29/07	TIME: 3:20:09 PM	NO.	BY	DATE	REVISIONS:
SERVER:	LAYOUT: Layout1				
PATH:	N:\MTB014800\CADD\IP				
DRAWING NAME:	IP-02.DWG				
PAGE SETUP:	22x34				
DESIGNER:	JCJ	PROJ. MGR:	REP		

Note: All utilities & obstructions shown are approximate. It is the contractor's responsibility to verify the location & depth with the appropriate agencies. The contractor shall notify the engineer immediately regarding any discrepancies or ambiguities which may exist.

CAUTION: The engineer preparing these plans will not be responsible for, or liable for, unauthorized changes to or uses of these plans. All changes to the plans must be in writing and must be approved by the preparer of these plans.

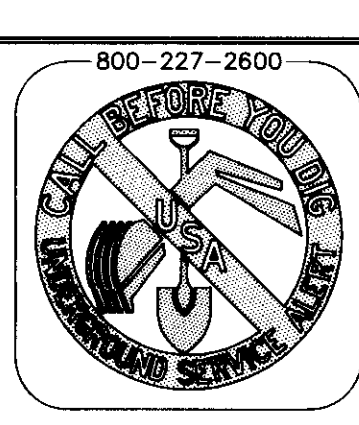
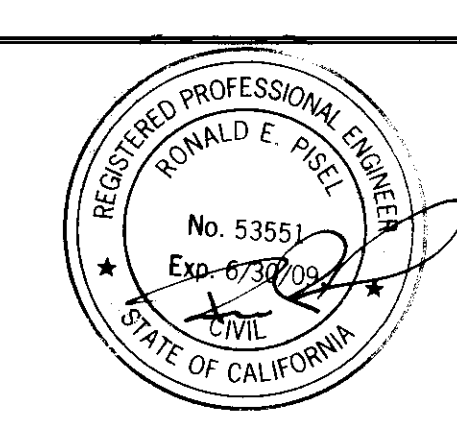

**NOLTE**  
 BEYOND ENGINEERING  
 1930 HOWARD ROAD, SUITE 125  
 659.8615220 TEL 659.8614440 FAX  
 MADERA, CA 93637  
 WWW.NOLTE.COM

**SAN JOAQUIN COUNTY**  
 GARDEN ACRES - WALKER LANE AREA STORM  
 DRAINAGE IMPROVEMENTS - PHASE 2A & 2B  
 PREPARED FOR: SAN JOAQUIN COUNTY  
 DATE SUBMITTED: 11-29-07

SHEET NUMBER	2
OF	15 SHEETS
SCALE	VERTICAL: 1"=N/A HORIZONTAL: 1"=N/A
JOB NUMBER	MTB014800

SHEET	TITLE
SHEET NO. 1	TITLE SHEET
SHEET NO. 2	GENERAL NOTES - TYPICAL SECTIONS
SHEET NO. 3	SUMMARY OF QUANTITIES
SHEET NO. 4	DETAIL SHEET
SHEET NO. 5	PLAN AND PROFILE - SONORA STREET
SHEET NO. 6	PLAN AND PROFILE - SONORA STREET
SHEET NO. 7	PLAN AND PROFILE - MARSH STREET
SHEET NO. 8	PLAN AND PROFILE - MARSH STREET
SHEET NO. 9	PLAN AND PROFILE - MARSH STREET
SHEET NO. 10	PLAN AND PROFILE - MARSH STREET
SHEET NO. 11	PLAN AND PROFILE - MARSH STREET
SHEET NO. 12	PLAN AND PROFILE - MARSH STREET
SHEET NO. 13	PLAN AND PROFILE - ARDELLE AVENUE
SHEET NO. 14	PLAN AND PROFILE - ARDELLE AVENUE
SHEET NO. 15	PROFILES - STORM DRAIN INLETS & LATERALS

# COUNTY OF SAN JOAQUIN DEPARTMENT OF PUBLIC WORKS STOCKTON, CALIFORNIA

## GARDEN ACRES - WALKER LANE AREA STORM DRAINAGE IMPROVEMENTS - PHASE 2A & 2B

TO BE SUPPLEMENTED BY STANDARD PLANS DATED JULY 2002

**LEGEND (existing features):**

	ASPHALT CONCRETE (AC)
	CONCRETE (CONC)
	STRUCTURES(BLDG) w/OVERHANG
	SPOT ELEVATION & DESCRIPTION
	SURVEY CONTROL POINT
	SURVEY BENCH MARK
	NAIL AND TIN SURVEY POINT
	ELECTRICAL
	TELEPHONE OR COMMUNICATIONS
	UTILITY PULL BOX (PB)
	LIGHT (SL)
	UTILITY POLE (UP)
	GUY ANCHOR (GU)
	APPROXIMATED UNDERGROUND UTILITY LINE(S)
	OVERHEAD UTILITY LINE(S)
	WATER LINE (6")
	GAS LINE
	EXISTING FENCE
	EXISTING GROUND FLOW LINE
	EXISTING GROUND GRADE BREAK
	SPRINKLER HEAD (SPR)
	WATER METER (WM)
	WATER VALVE (WV)
	FIRE HYDRANT (FH)
	GAS METER (GM)
	GAS VALVE (GV)
	MONITORING WELL (MW)
	SANITARY SEWER MANHOLE
	SANITARY SEWER CLEANOUT
	SANITARY SEWER LINE (8")
	STORM DRAIN MANHOLE
	STORM DRAIN INLET
	STORM DRAIN PIPE (18")
	TREE

**LEGEND (proposed features):**

	REMOVE & REPLACE DRIVEWAY W/ 3" AC (SEE DEPRESSED DRIVE DETAIL ON SHEET NO. 4)
	STORM DRAIN MANHOLE
	DRAIN INLET
	STORM DRAIN PIPE
	RIGHT OF WAY
	CONSTRUCTION LINE
	FLOW ARROW

**SURVEY CONTROL DATUM**  
**HORIZONTAL (BASIS OF BEARINGS):**  
 LOCAL AND ASSUMED COORDINATES.  
**VERTICAL (BENCH MARK):**  
 COUNTY OF SAN JOAQUIN TBM NO. 5B,  
 BRIDGE NAIL IN JOINT POLE, NORTH SIDE  
 ARDELLE AVENUE, 50 FEET ± WEST OF  
 CARDINAL AVENUE. (S.J. CO. BM BOOK  
 31, PAGE 41)  
 ELEV. = 30.55 FEET

**APPLICABLE S.J. COUNTY  
IMPROVEMENT STANDARDS**  
 R-29, CW-M3, CW-D14, CW-M7  
 CW-S7, D-18, W-7

**APPLICABLE STANDARD PLANS**  
 A10A, A10B, T13, D75A

**APPLICABLE CITY OF STOCKTON  
STANDARD PLANS**  
 50A, 50B, 61, 61A, 62, 63

**ABBREVIATIONS**  
 (IN ADDITION TO LISTINGS IN S.P. A10A)

AGG.	AGGREGATE
C/L	CENTER LINE
φ	DIAMETER
DI	DRAIN INLET
DW	DRIVEWAY
EX	EXISTING
EXEP	EXISTING EDGE OF PAVEMENT
EXFL	EXISTING FLOW LINE
FD	FOUND
GB	GRADE BREAK
GND	GROUND
HDPE	HIGH DENSITY POLYETHYLENE
INCL	INCLUDED
IP	IRON PIPE
NTS	NOT TO SCALE
OG	ORIGINAL GROUND
PRFL	PROPOSED FLOW LINE
PVI	POINT OF VERTICAL INTERSECTION
Rdwy.	ROADWAY
RG	RUBBER GASKET
S.J. Co. Std.	SAN JOAQUIN COUNTY STANDARD
S.P.	STANDARD PLANS
SF	SQUARE FEET
SHT	SHEET
SY	SQUARE YARD
QTY	QUANTITY

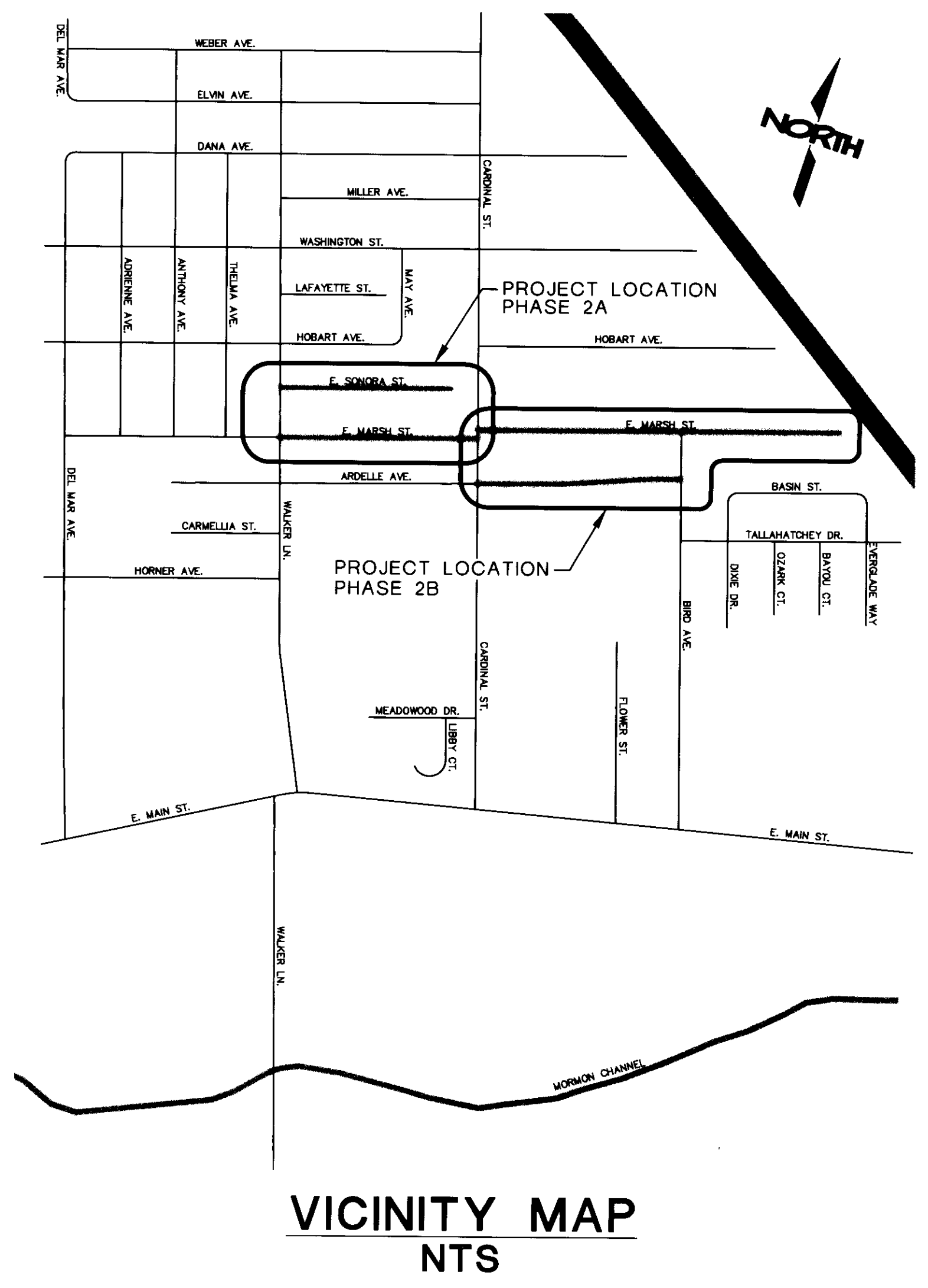

UTILITY	CONTACT	PHONE NUMBER
AT&T	JAMES JELLEY	(209) 474-4110
PG&E	MARSIAL FERNANDEZ	(209) 942-1496
CALIFORNIA WATER CO.	BRET DAHLEN	(209) 464-8311
COMCAST CABLE	ROBERT GONZALEZ	(209) 955-6542
CITY OF STOCKTON	TONY TOVAR	(209) 937-8790

DEPARTMENT OF PUBLIC WORKS  
 SAN JOAQUIN COUNTY, CALIFORNIA

APPROVAL RECOMMENDED BY:

*Pete D. Mark*  
 ENGINEERING SERVICES MANAGER  
 DATE: 4/8/08

*[Signature]*  
 DIRECTOR OF PUBLIC WORKS  
 DATE: 4/14/08

DATE: 11/29/07 TIME: 3:19:29 PM  
 SERVER: LAYOUT: Layout1  
 PATH: N:\MTB014800\CADD\IP  
 DRAWING NAME: IP-01.DWG  
 PAGE SETUP: 22x34  
 DESIGNER: JGJ PROJ. MGR: REP

NO.	BY	DATE	REVISIONS:

Note: All utilities & obstructions shown are approximate. It is the contractor's responsibility to verify the location & depth with the appropriate agencies. The contractor shall notify the engineer immediately regarding any discrepancies or ambiguities which may exist.

CAUTION: The engineer preparing these plans will not be responsible for, or liable for, unauthorized changes to or uses of these plans. All changes to the plans must be in writing and must be approved by the preparer of these plans.



**NOLTE**  
 BEYOND ENGINEERING  
 1930 HOWARD ROAD, SUITE 125  
 559.6615220 TEL 559.6614440 FAX  
 MADERA, CA 93637  
 WWW.NOLTE.COM

**SAN JOAQUIN COUNTY**  
**GARDEN ACRES - WALKER LANE AREA STORM  
DRAINAGE IMPROVEMENTS - PHASE 2A & 2B**

PREPARED FOR: SAN JOAQUIN COUNTY  
 DATE SUBMITTED: 11-29-07

SHEET NUMBER  
**1**  
 OF 15 SHEETS  
 SCALE  
 VERTICAL: 1"= N/A  
 HORIZONTAL: 1"= N/A  
 JOB NUMBER  
**MTB014800**

54-4429

JACKSON XREFS: 22x34, Submit to S:\ipmt, M:\SSS, G:\e\p\user\_20061211\_08430657, G:\e\p\user\_20061211\_08391292, G:\e\p\user\_20061211\_08393645, G:\e\p\user\_20061211\_08394445, G:\e\p\user\_20061211\_08370938, Pp